

PROP. CURVEPR-CPRN-1 PI STA. =253+35.86 Δ =15° 53' 07" (RT) D =54° 34' 03" R =105.00' T =14.65' L =29.11' E =1.02' e = ---- T.R. = ---- S.E. RUN = ---- P.C. STA. =253+21.21 P.T. STA. =253+50.32 DESIGN SPEED = 20 MPH	PROP. CURVEPR-CPRN-2 PI STA. =261+11.47 Δ =19° 28' 11" (LT) D =54° 34' 03" R =105.00' T =18.01' L =35.68' E =1.53' e = ---- T.R. = ---- S.E. RUN = ---- P.C. STA. =260+93.45 P.T. STA. =261+29.13 DESIGN SPEED = 20 MPH	PROP. CURVEPR-CPRN-3 PI STA. =261+95.34 Δ =4° 37' 09" (RT) D =3° 29' 25" R =1,641.60' T =66.21' L =132.35' E =1.33' e = ---- T.R. = ---- S.E. RUN = ---- P.C. STA. =261+29.13 P.T. STA. =262+61.48 DESIGN SPEED = 20 MPH
--	--	---

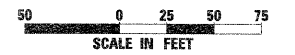

CHAIN OF ROCKS CANAL

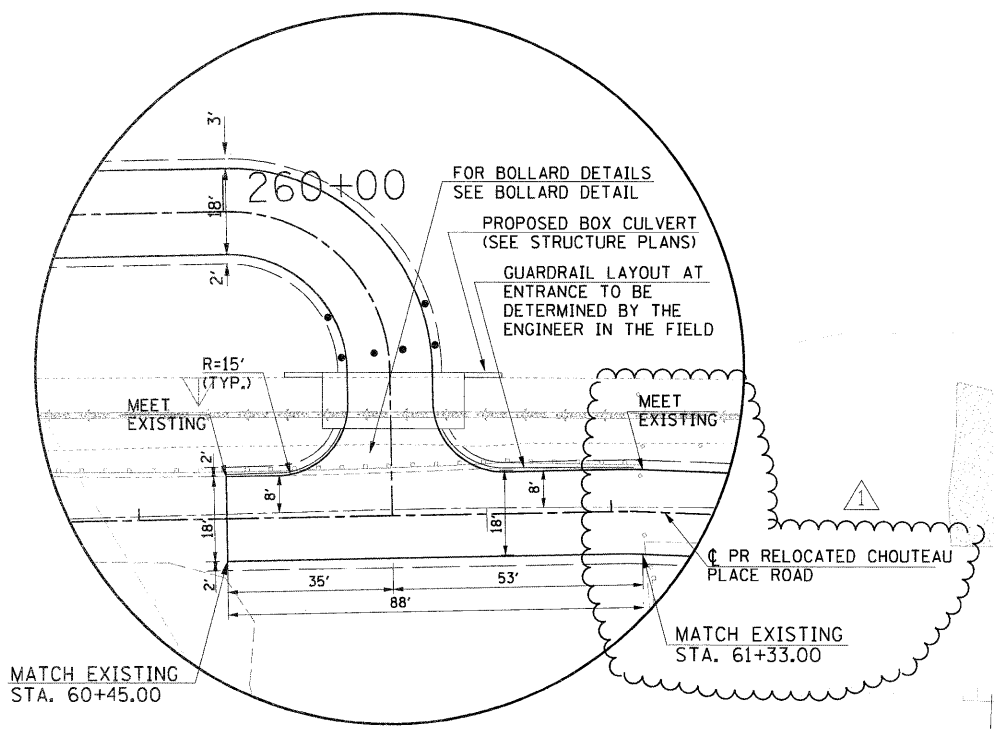

DETAIL

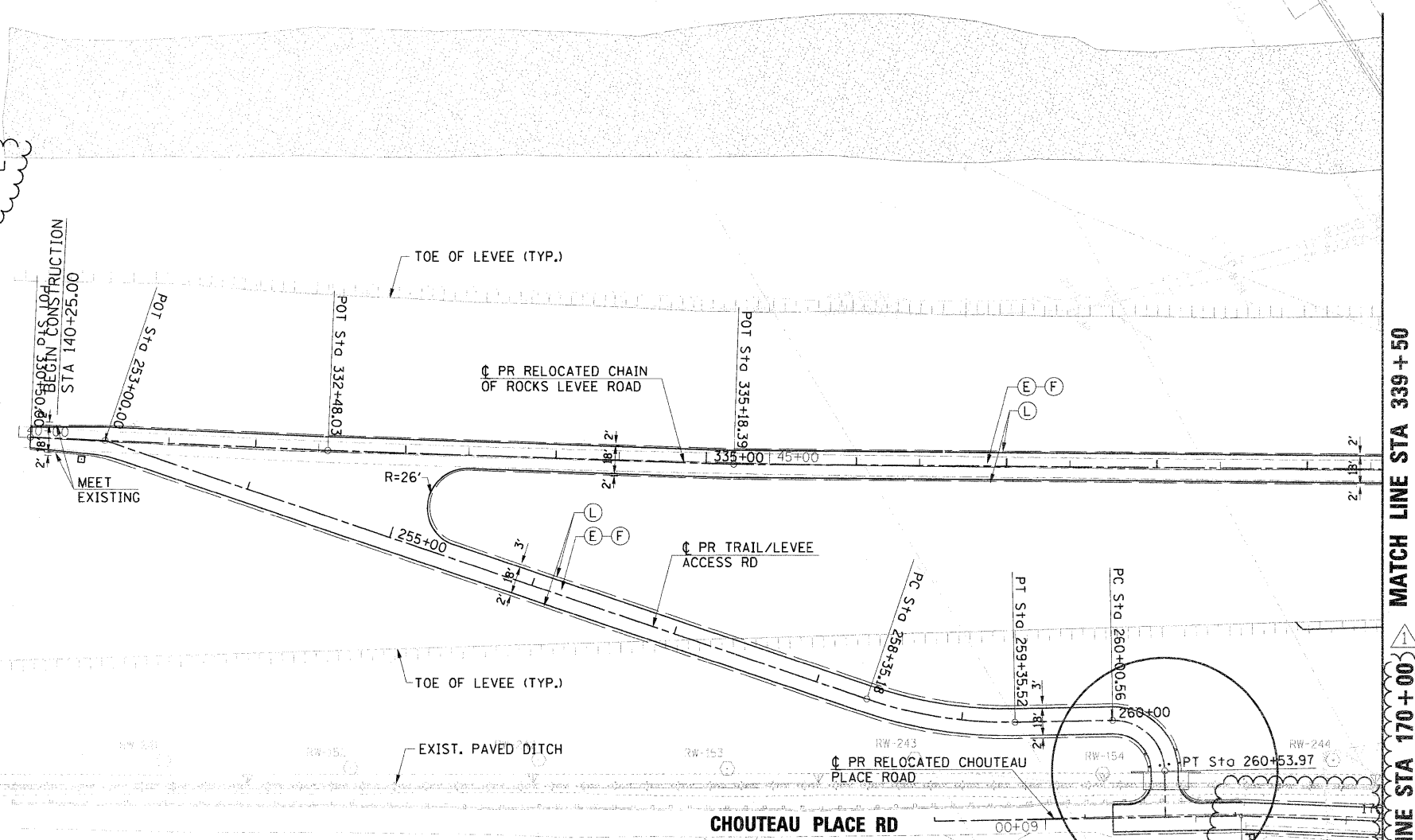

PROPOSED ROADWAY LEGEND

- | | |
|----------------------------------|----------------------------------|
| (A) CONT REINF PCC PVT 12 | (M) TOPSOIL EXC & PLAC |
| (B) HMA SC "D" N50 | (N) CONC BAR 2F 42HT |
| (C) HMA BC IL-12.5 N50 | (O) CONC BAR 1F 42HT SPL |
| (D) STABILIZED SUBBASE 4" | (P) MECH ST EARTH RET WL |
| (E) BIT SURF TREAT CL A-3 | (R) SPBGR TY A 6FT POSTS |
| (F) AGG BASE CSE A 8 | (S) PCC PVT 12 JOINTED |
| (G) SUB GRAN MAT A 12 | (T) HMA PAVT FD 13 |
| (H) PCC SHOULDERS 12 | (U) PROCESS MOD SOIL 12 AND LIME |
| (I) PCC SHOULDERS 12 SPL | (W) SUB GRAN MAT C |
| (J) HMA SHOULDERS 10 1/2 | (X) WOV W FENCE 4 |
| (K) SHLDR STABILIZATION (NOTE 1) | (Y) SPBGR TY A 9FT POST |
| (L) AGGREGATE SHLDS A 6 | (AA) SHOULDER RUMBLE STRIP |
- NOTE 1: (K) PAID FOR AS (H) OR (J) TO MATCH ADJACENT SHOULDER
NOTE 2: SEE PLAT OF HIGHWAY FOR FULL EXTENT OF GENERAL PURPOSE LICENSE. (GPL)

MATCH LINE STA 339+50
MATCH LINE STA 170+00

KEY MAP

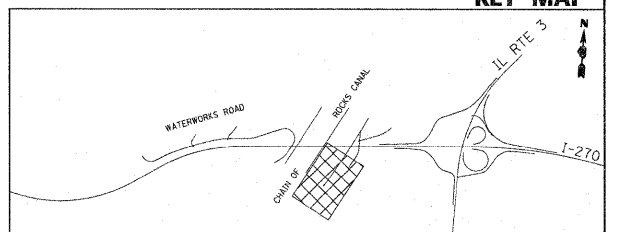

FILE NAME = DB76A91-Sht-Plan1.dgn	USER NAME = obliven	DESIGNED - SJM	REVISED - 01-04-11	STATE OF ILLINOIS DEPARTMENT OF TRANSPORTATION	PROPOSED PLAN CHAIN OF ROCKS LEVEE ROAD			F.A.I. RTE. 270	SECTION 60-1B-1	COUNTY MADISON	TOTAL SHEETS 712	SHEET NO. 60
PLOT SCALE = #SCALE#	CHECKED - SJM	REVISOR - 6/7/11 ADDENDUM	REVISOR -		SCALE: 1" = 50'	SHEET NO. 11 OF 12 SHEETS	STA. 140+00 TO STA. 149+00	ILLINOIS FED. AID PROJECT CONTRACT NO. 76A91				
PLOT DATE = 5/19/2011	DATE - 06-30-10	REVISOR -	REVISOR -									