

PLAN	SURVEYED	BY	DATE
	ALIGNED		
	GRADES CHECKED		
	RT. OF WAY CHECKED		
	NO.		
	DATE		

PROFILE	DESIGNED	BY	DATE
	PLOTTED		
	GRADES CHECKED		
	DATE NOTED		
	NO.		
	DATE		

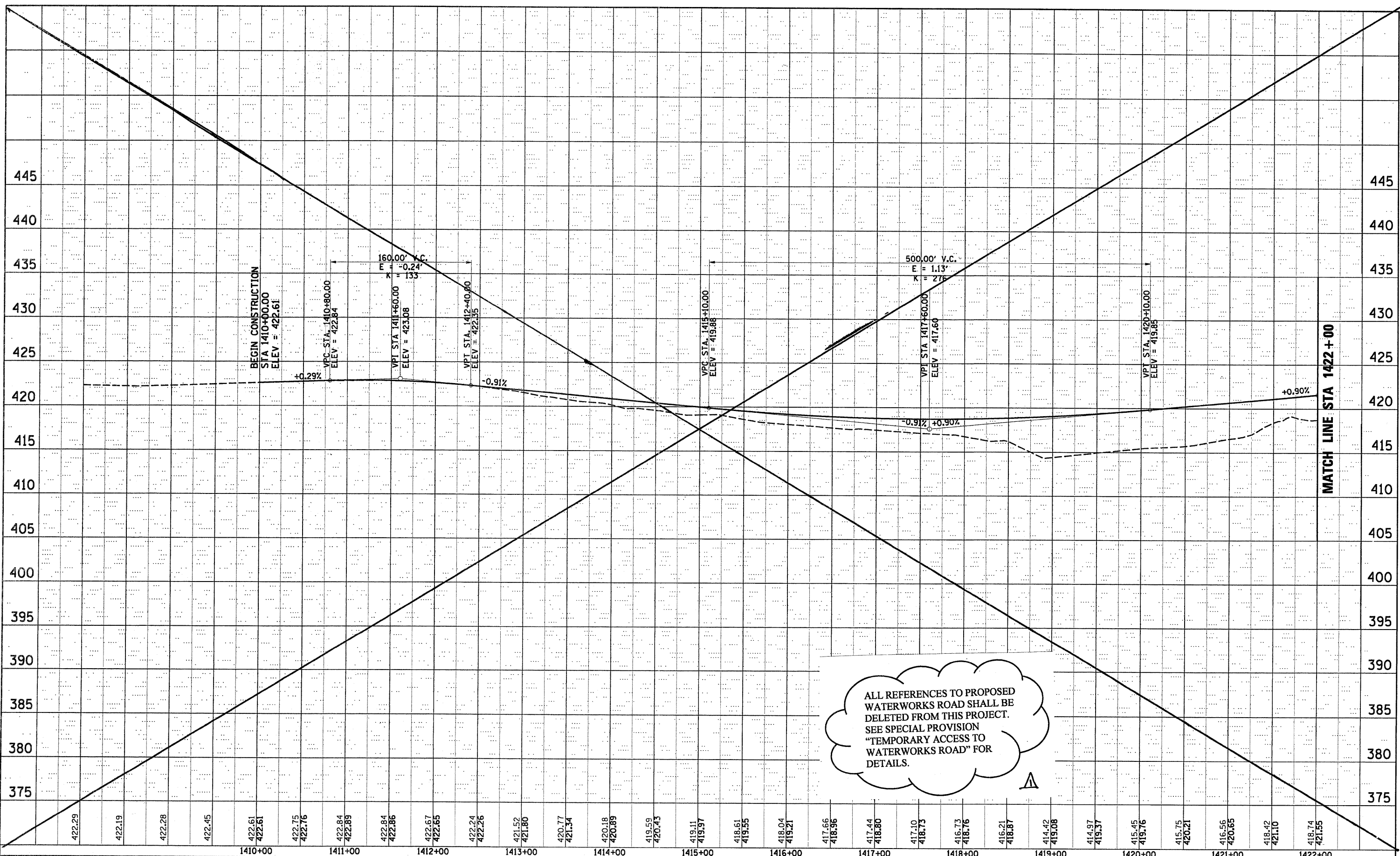

ALL REFERENCES TO PROPOSED WATERWORKS ROAD SHALL BE DELETED FROM THIS PROJECT. SEE SPECIAL PROVISION "TEMPORARY ACCESS TO WATERWORKS ROAD" FOR DETAILS.

422.29	422.19	422.28	422.45	422.61	422.61	422.75	422.76	422.84	422.89	422.84	422.86	422.67	422.65	422.24	422.26	421.52	421.80	420.77	421.34	420.18	420.89	419.59	420.43	419.11	419.97	418.61	419.55	418.04	419.21	417.66	418.96	417.44	418.80	417.10	418.73	416.73	418.76	416.21	418.87	414.42	419.08	414.97	419.37	415.45	419.76	415.75	420.21	416.56	420.65	418.42	421.10	418.74	421.55
1410+00		1411+00		1412+00		1413+00		1414+00		1415+00		1416+00		1417+00		1418+00		1419+00		1420+00		1421+00		1422+00																													

FILE NAME = 0876A91-Sht-Prof12.DGN	USER NAME = molopez	DESIGNED - SJM	REVISOR - 07-30-10	STATE OF ILLINOIS DEPARTMENT OF TRANSPORTATION	PROPOSED PROFILE WATERWORKS ROAD	F.A.I. RTE. 270	SECTION 60-1B-1	COUNTY MADISON	TOTAL SHEETS 712	SHEET NO. 73
PLOT SCALE = *SCALE*	CHECKED - SJM	REVISOR - 6/7/11 ADD. Δ	SCALE: 1"=(H)50'(V)5'			SHEET NO. 12 OF 16 SHEETS	STA. 1410+00 TO STA. 1422+00	CONTRACT NO. 76A91		
PLOT DATE = 3/16/2011	DATE - 06-30-10	REVISOR -	FED. ROAD DIST. NO.			ILLINOIS FED. AID PROJECT				