

MOT LEGEND

- WORK ZONE AREA
 - WORK ZONE FOR TEMPORARY PAVEMENT CONSTRUCTION
 - COMPLETED TEMPORARY PAVEMENT IN PREVIOUS STAGES
 - IMPACT ATTENUATOR
 - DIRECTION OF TRAFFIC
 - TEMPORARY CONCRETE BARRIER
 - SIGN ON PORTABLE OR PERMANENT SUPPORT
 - TYPE III BARRICADES
 - TYPE II WITH STEADY BURNING MONODIRECTIONAL LIGHT *
 - MESSAGE BOARD
- * DRUM OR BARRICADE SPACING:
 50' C-C ON TANGENTS
 25' C-C ON TAPERS OR LANE SHIFTS
 12' C-C ON RADII'S OR RAMP
 5' C-C FOR RAMP OR ROAD CLOSURES

ALL REFERENCES TO PROPOSED WATERWORKS ROAD SHALL BE DELETED FROM THIS PROJECT. SEE SPECIAL PROVISION "TEMPORARY ACCESS TO WATERWORKS ROAD" FOR DETAILS.

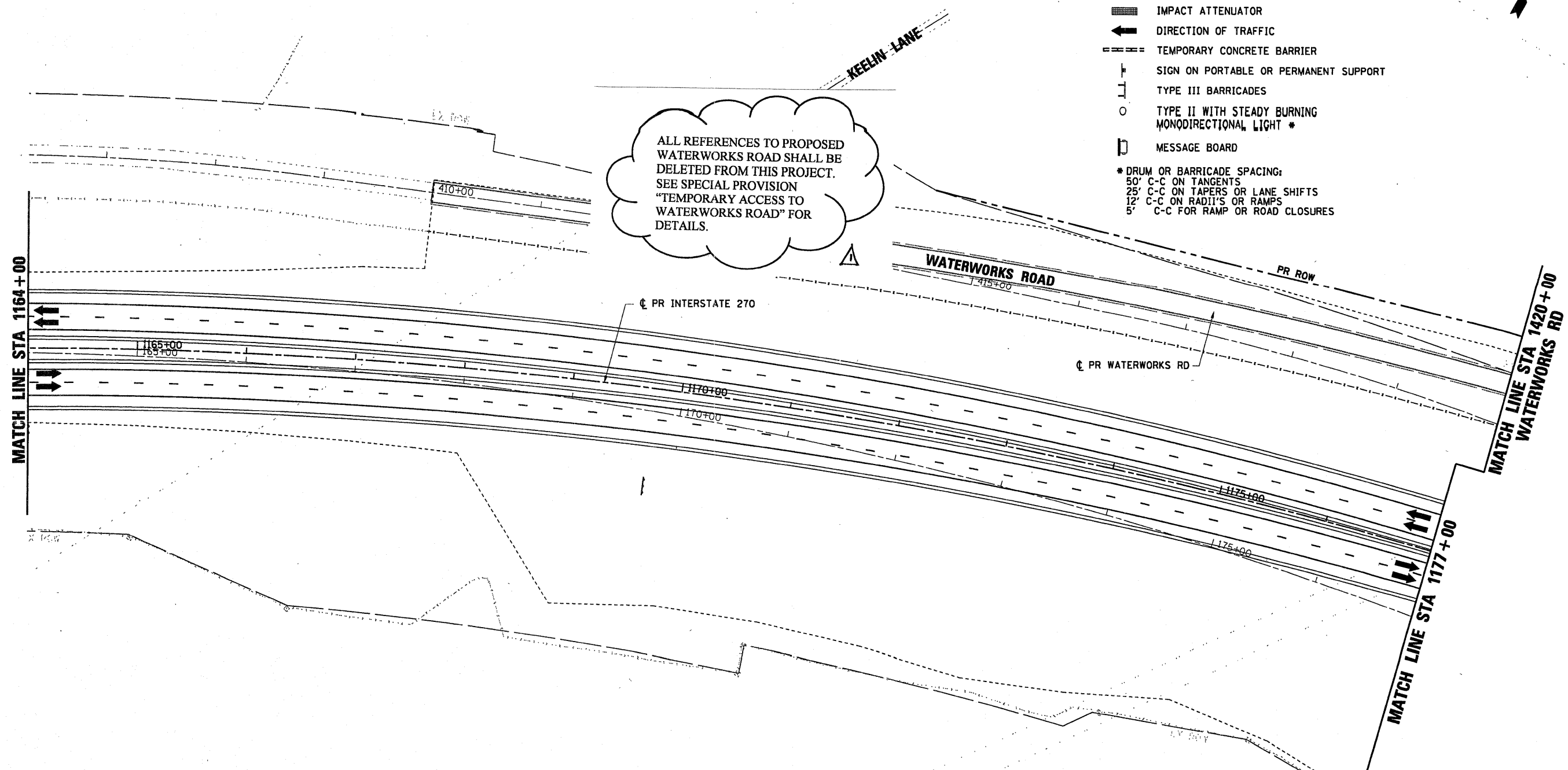

MOT PAVEMENT MARKING LEGEND

- (A) TEMP PVT MK LINE 4 (SOLID YELLOW)
- (B) TEMP PVT MK LINE 4 (SOLID WHITE)
- (C) TEMP PVT MK LINE 4 (SKIP-DASH, WHITE, 10' DASH, 30' SKIP)
- (D) NOT USED
- (E) TEMP PVT MK LINE 24 (SOLID WHITE)
- (F) TEMP PVT MK LTR & SYM (SOLID WHITE)
- (G) EPOXY PVT MK LINE 4 (SOLID YELLOW)
- (H) EPOXY PVT MK LINE 4 (SOLID WHITE)
- (I) EPOXY PVT MK LINE 4 (SKIP-DASH, WHITE, 10' DASH, 30' SKIP)
- (J) NOT USED
- (K) WET PAVT TAPE T3 4 (SOLID YELLOW)
- (L) WET PAVT TAPE T3 4 (SOLID WHITE)
- (M) WET PAVT TAPE T3 4 (SOLID WHITE) (SKIP-DASH, WHITE, 10' DASH, 30' SKIP)
- (N) WET PAVT TAPE T3 6 (SOLID WHITE)
- (O) WET PAVT TAPE T3 24 (SOLID WHITE)

NOTE: REFER TO PROPOSED PAVEMENT MARKING AND SIGNAGE PLANS FOR PROPOSED PAVEMENT MARKINGS AND SIGNAGE LOCATIONS THAT WILL BE PLACED IN STAGE 6.

KEY MAP

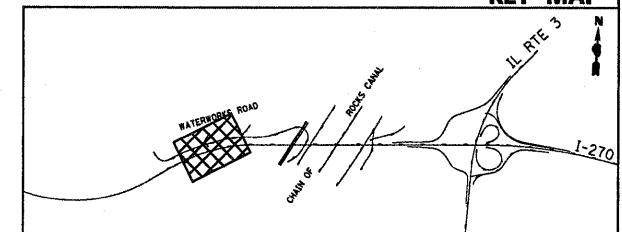

FILE NAME =	USER NAME = sbliven
0876A91-Sh-t-MOT86-03.dgn	

DESIGNED - JC	REVISD - 1-01-11
DRAWN - BH	REVISD - 4-20-11
CHECKED -	REVISD - 6/7/11 ADD. Δ
PLOT SCALE = #SCALE#	REVISD -
PLOT DATE = 4/28/2011	REVISD -

DESIGNED - JC	REVISD - 1-01-11
DRAWN - BH	REVISD - 4-20-11
CHECKED -	REVISD - 6/7/11 ADD. Δ
PLOT SCALE = #SCALE#	REVISD -
PLOT DATE = 4/28/2011	REVISD -

**STATE OF ILLINOIS
DEPARTMENT OF TRANSPORTATION**

**SUGGESTED MAINTENANCE OF TRAFFIC STAGE 6
INTERSTATE 270**

SCALE: 1" = 50' SHEET NO. 3 OF 9 SHEETS STA. TO STA.

F.A.I. RTE.	SECTION	COUNTY	TOTAL SHEETS	SHEET NO.
270	60-1B-1	MADISON	712	194
CONTRACT NO. 76A91				
ILLINOIS FED. AID PROJECT				