

CHAIN OF ROCKS CANAL

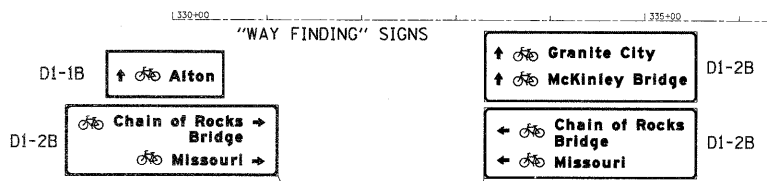

LEVEE ROAD

CHOUTEAU PLACE ROAD

INTERSTATE I-270

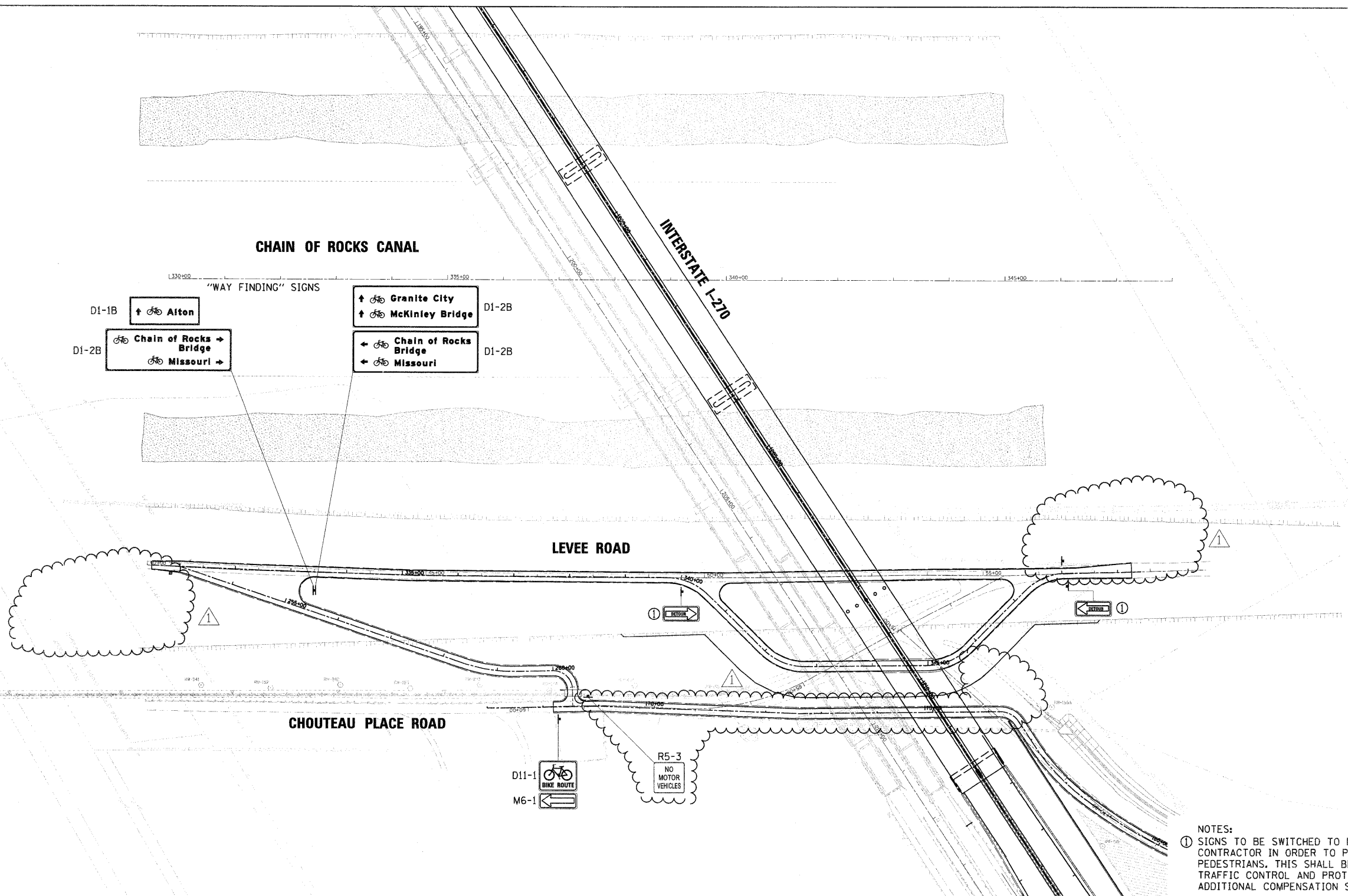

- NOTES:
- ① SIGNS TO BE SWITCHED TO REFLECT I-270 BRIDGE STAGING BY CONTRACTOR IN ORDER TO PROVIDE A SAFE TRAVEL PATH FOR PEDESTRIANS. THIS SHALL BE INCLUDED IN THE PAY ITEM TRAFFIC CONTROL AND PROTECTION, (SPECIAL) AND NO ADDITIONAL COMPENSATION SHALL BE ALLOWED.
 - ② THE CONTRACTOR WILL BE RESPONSIBLE TO SIGNING LEVEE ROAD INCLUDING ADDITIONAL SIGNING AS NEEDED TO ACCOMMODATE PEDESTRIANS DURING THE REMOVAL OF THE EXISTING I-270 BRIDGE. THIS SHALL BE INCLUDED IN THE PAY ITEM TRAFFIC CONTROL AND PROTECTION, (SPECIAL) AND NO ADDITIONAL COMPENSATION SHALL BE ALLOWED.

SIGNING SCHEDULE					
LOCATION	OFFSET	TYPE	SIZE (IN X IN)	SIGN PANEL TYPE 1 (SQ FT)	WOOD SIGN SUPPORT (FT)
LEVEE RD					
333+43	33' RT	D1-1B	30 X 10	2.08	12
	33' RT	D1-2B	54 X 18	6.75	
	33' RT	D1-2B	54 X 18	6.75	
	33' RT	D1-2B	54 X 18	6.75	
CHOUTEAU PLACE RD					
168+27	23' RT	D11-1	24 X 18	3.00	11
	23' RT	M6-1	12 X 9	0.75	
168+81	23' LT	R5-3	24 X 24	4.00	11
TOTAL				31	34

KEY MAP

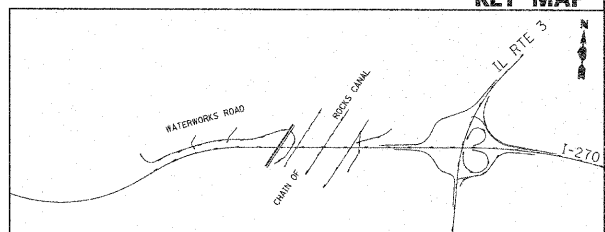

FILE NAME = DB76A91-Sh1-MDTDET09.dgn	USER NAME = abivern	DESIGNED - JC	REVISED - 4-20-11
		DRAWN - BH	REVISED - 6/7/11 ADDENDUM
		CHECKED -	REVISED -
		DATE - 1-01-11	REVISED -

**STATE OF ILLINOIS
DEPARTMENT OF TRANSPORTATION**

**SUGGESTED MAINTENANCE OF TRAFFIC
MISCELLANEOUS DETAIL**

SCALE: SHEET NO. 9 OF 9 SHEETS STA. TO STA.

F.A.I. RTE. 270	SECTION 60-1B-1	COUNTY MADISON	TOTAL SHEETS 712	SHEET NO. 210
CONTRACT NO. 76A91				