

SEE PROPOSED DRAINAGE LEGEND ON SHEET NO. 1 OF 11

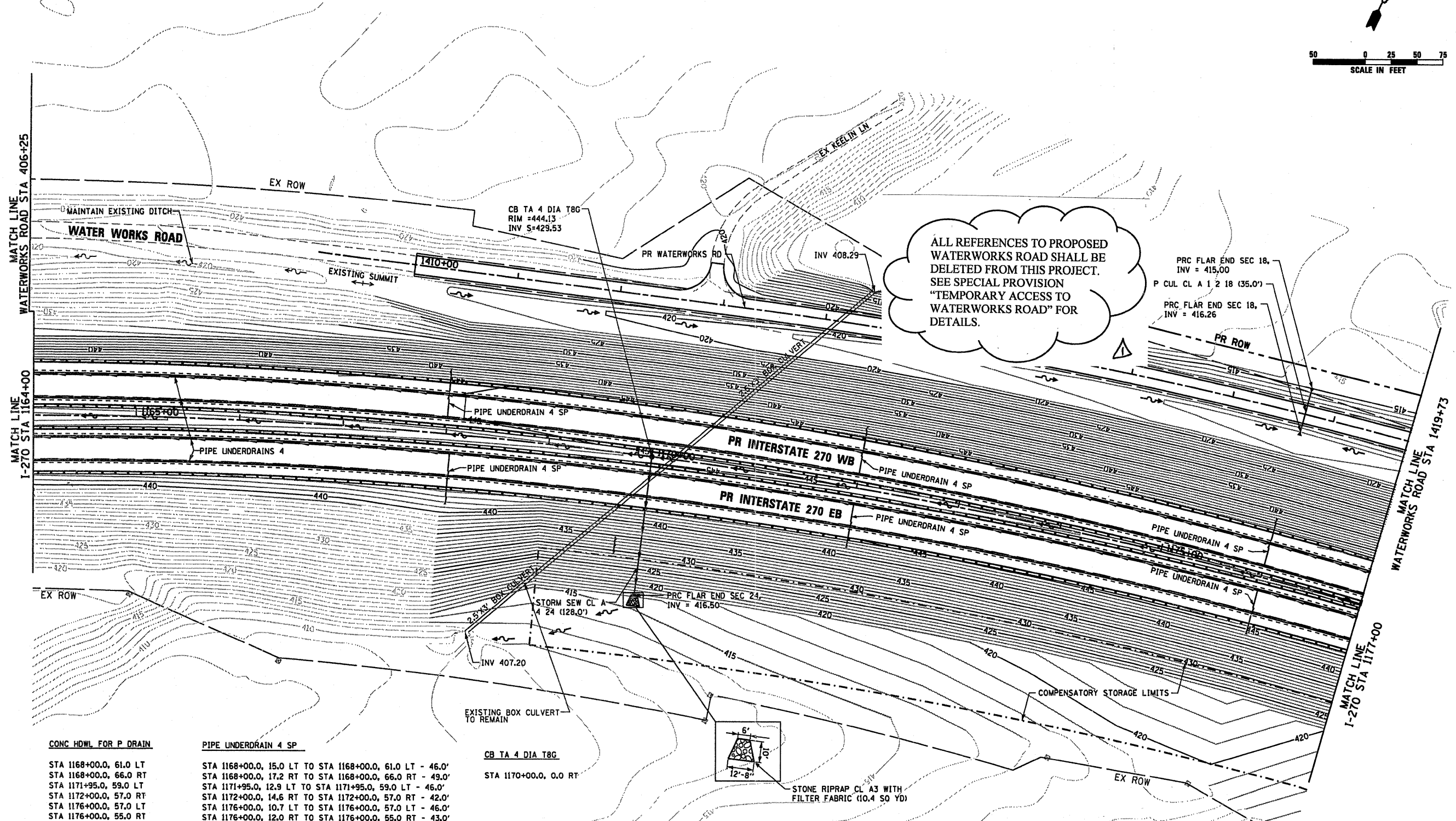
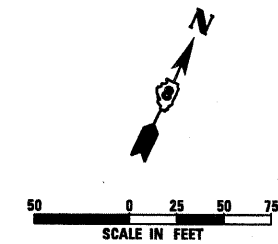

ALL REFERENCES TO PROPOSED WATERWORKS ROAD SHALL BE DELETED FROM THIS PROJECT. SEE SPECIAL PROVISION "TEMPORARY ACCESS TO WATERWORKS ROAD" FOR DETAILS.

PRC FLAR END SEC 18, INV = 415.00  
 P CUL CL A 1 2 18 (35.0')  
 PRC FLAR END SEC 18, INV = 416.26

CB TA 4 DIA T8C  
 RIM = 444.13  
 INV S = 429.53

STORM SEW CL A 4 24 (128.0')  
 INV = 416.50

EXISTING BOX CULVERT TO REMAIN

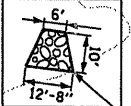

STONE RIPRAP CL A3 WITH FILTER FABRIC (10.4 SQ YD)

**CONC HDWL FOR P DRAIN**  
 STA 1168+00.0, 61.0 LT  
 STA 1168+00.0, 66.0 RT  
 STA 1171+95.0, 59.0 LT  
 STA 1172+00.0, 57.0 RT  
 STA 1176+00.0, 57.0 LT  
 STA 1176+00.0, 55.0 RT

**PIPE UNDERDRAIN 4 SP**  
 STA 1168+00.0, 15.0 LT TO STA 1168+00.0, 61.0 LT - 46.0'  
 STA 1168+00.0, 17.2 RT TO STA 1168+00.0, 66.0 RT - 49.0'  
 STA 1171+95.0, 12.9 LT TO STA 1171+95.0, 59.0 LT - 46.0'  
 STA 1172+00.0, 14.6 RT TO STA 1172+00.0, 57.0 RT - 42.0'  
 STA 1176+00.0, 10.7 LT TO STA 1176+00.0, 57.0 LT - 46.0'  
 STA 1176+00.0, 12.0 RT TO STA 1176+00.0, 55.0 RT - 43.0'

**CB TA 4 DIA T8C**  
 STA 1170+00.0, 0.0 RT

**PRC FLAR END SEC 18**  
 STA 1418+71.4, 15.0 RT  
 STA 1418+72.0, 20.0 LT

**PIPE UNDERDRAINS 4**  
 STA 1164+00.0, 41.1 LT TO STA 1177+00.0, 34.1 LT - 1,310.7'  
 STA 1164+00.0, 17.1 LT TO STA 1177+00.0, 10.1 LT - 1,304.0'  
 STA 1164+00.0, 19.7 RT TO STA 1177+00.0, 11.3 RT - 1,295.7'  
 STA 1164+00.0, 43.7 RT TO STA 1177+00.0, 35.3 RT - 1,289.0'

**PRC FLAR END SEC 24**  
 STA 1170+00.0, 130.0 RT

**P CUL CL A 1 18**  
 STA 1418+71.4, 15.0 RT TO STA 1418+72.0, 20.0 LT - 35.0'

**TRENCH BACKFILL**  
 [5 CY]

**STORM SEW CL A 4 24**  
 STA 1170+00.0, 0.0 RT TO STA 1170+00.0, 130.0' RT - 128.0'

**TRENCH BACKFILL**  
 [135 CY]

**KEY MAP**

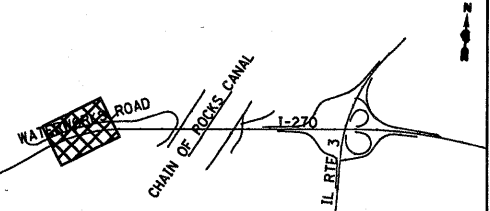

FILE NAME = D876A91-Sht-PrDrain82.dgn	USER NAME = EDean	DESIGNED - JM	REVISED - 6/7/11 ADD A
PLOT SCALE = 1/50	DRAWN - JM	CHECKED - MBL	REVISED -
PLOT DATE = 3/18/11	DATE - 3/18/11	REVISED -	

**STATE OF ILLINOIS  
 DEPARTMENT OF TRANSPORTATION**

**PROPOSED DRAINAGE PLAN  
 INTERSTATE 270**

SCALE: 1" = 50'    SHEET NO. 2 OF 11 SHEETS    STA. 1164+00 TO STA. 1177+00

F.A.I. RTE.	SECTION	COUNTY	TOTAL SHEETS	SHEET NO.
270	60-1B-1	MADISON	712	262
			CONTRACT NO. 76A91	
ILLINOIS FED. AID PROJECT				