

LEFT SIDE LIGHTS		
POLE NO.	STATION	OFFSET
P27	1178+70	48.18'
P29	1180+65	47.08'
P31	1182+60	45.98'
P33	1184+55	44.87'
P35	1186+50	44.50'
P37	1188+45	44.50'

RIGHT SIDE LIGHTS		
POLE NO.	STATION	OFFSET
P26	1177+72.5	49.82'
P28	1179+67.5	48.49'
P30	1181+62.5	47.16'
P32	1183+57.5	45.82'
P34	1185+52.5	44.52'
P36	1187+47.5	44.50'
P38	1189+42.5	44.50'

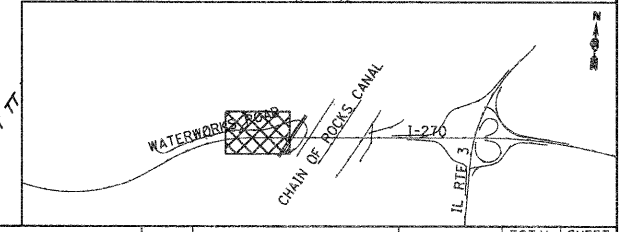
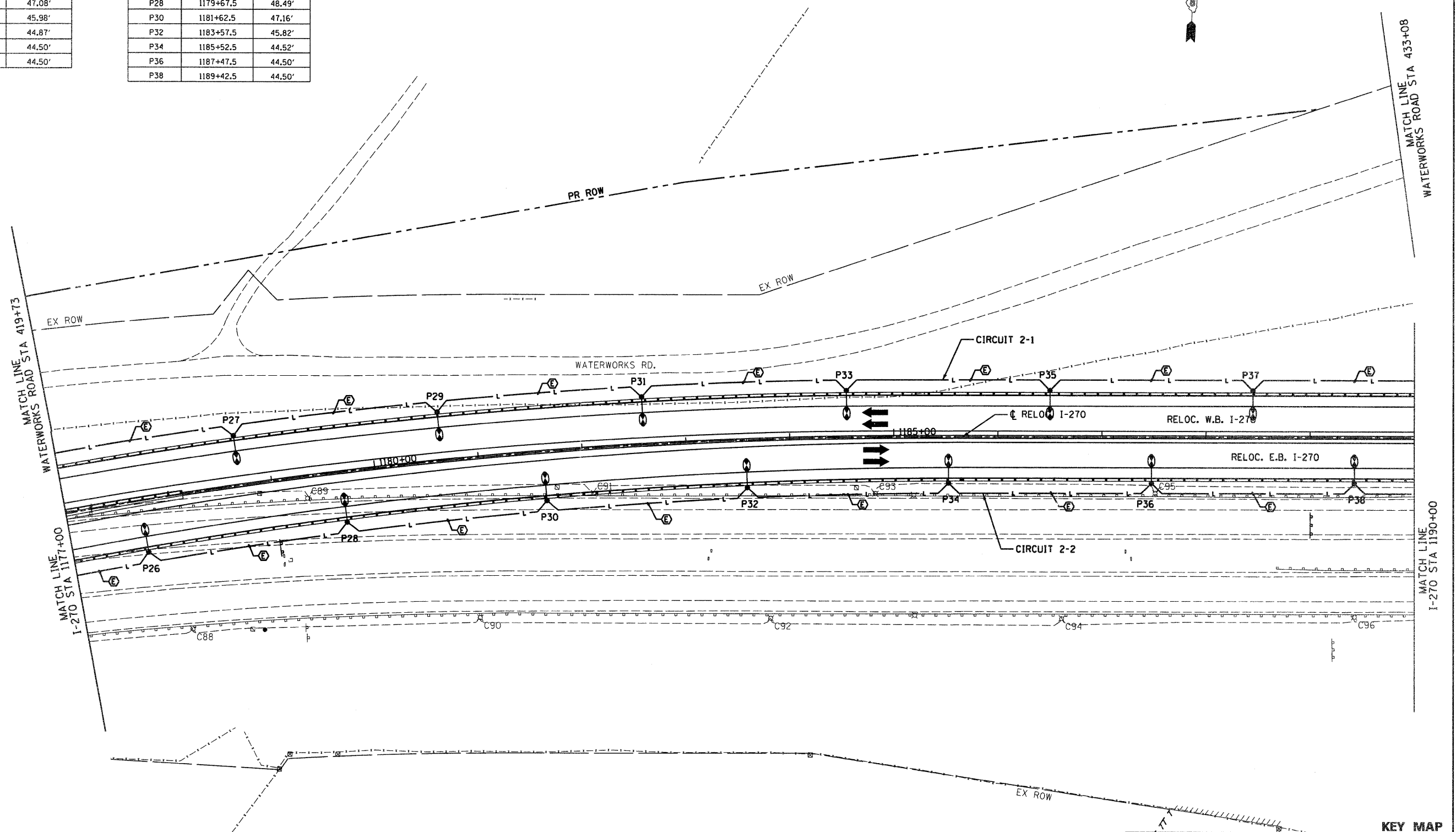
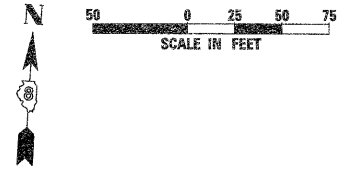

PROPOSED LIGHTING LINE STYLE CHANGE

FILE NAME =	USER NAME = #USER#	DESIGNED - FSM	REVISED -	STATE OF ILLINOIS DEPARTMENT OF TRANSPORTATION	HIGHWAY LIGHTING PLANS INTERSTATE 270		FAI	SECTION	COUNTY	TOTAL SHEETS	SHEET NO.
#FILE#		DRAWN - MNR	REVISED -		270	60-1B-1	MADISON	712	332	CONTRACT NO. 76A91	
	PLT SCALE = #SCALE#	CHECKED - AAB	REVISED - 6/7/11 ADDENDUM		SCALE: 1" = 50'	SHEET NO. 4 OF 10 SHEETS	STA. 1177+00 TO STA. 1190+00	ILLINOIS FED. AID PROJECT			
	PLT DATE = #DATE#	DATE - 3/18/11	REVISED -								