

LEFT SIDE LIGHTS		
POLE NO.	STATION	OFFSET
P51	21193+17.7	9.49'
P53	21191+52.1	11.00'
P55	21189+87.1	11.00'
P57	21188+37.1	11.00'
P59	1218+45	47.95'

CENTER LIGHTS	
POLE NO.	STATION
P48	1206+69.8
P49	1208+64.8
P50	1210+59.8

RIGHT SIDE LIGHTS		
POLE NO.	STATION	OFFSET
P52	1213+04.5	61.50'
P54	11214+70.7	20.00'
P56	11216+11.7	11.00'
P58	11217+60.9	11.00'
P60	11218+70.2	20.00'

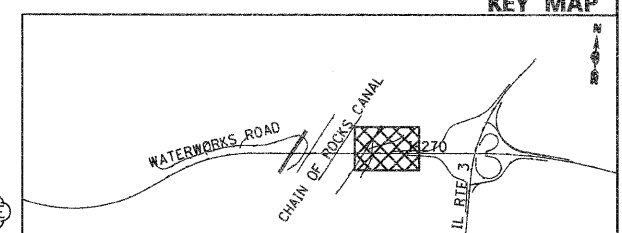
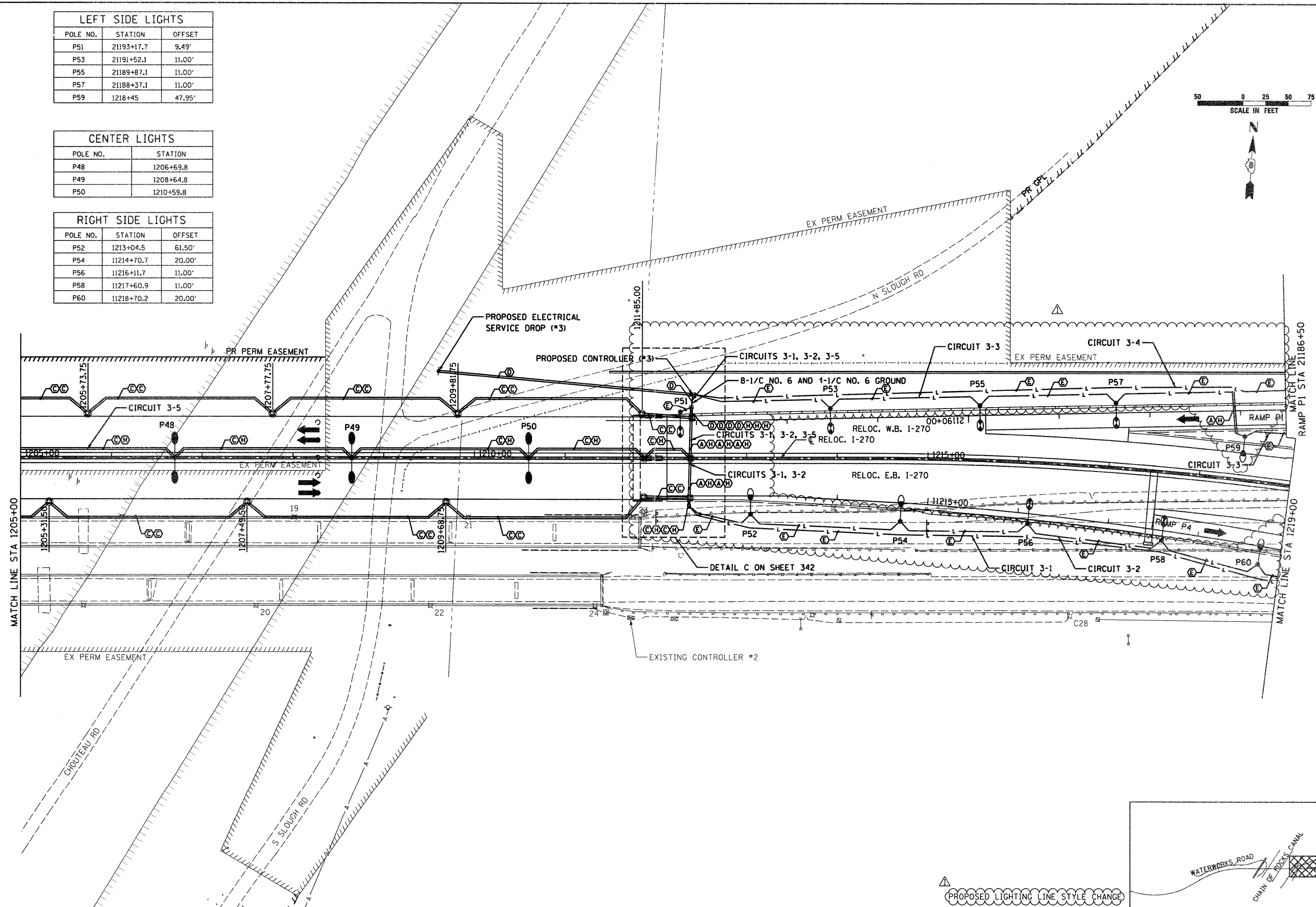
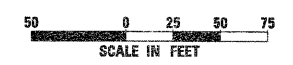

PROPOSED LIGHTING LINE STYLE CHANGE

FILE NAME =	USER NAME = #USER#	DESIGNED - FSM	REVISED -	STATE OF ILLINOIS DEPARTMENT OF TRANSPORTATION	HIGHWAY LIGHTING PLANS INTERSTATE 270	FAI	SECTION	COUNTY	TOTAL SHEETS	SHEET NO.	
#FILE#	PLOT SCALE = #SCALE#	DRAWN - MNR	REVISED -			270	60-18-1	MADISON	712	334	
	PLOT DATE = #DATE#	CHECKED - AAB	REVISED - 6/7/11 ADDENDUM			CONTRACT NO. 76A91					
		DATE - 3/18/11	REVISED -			ILLINOIS FED. AID PROJECT					
				SCALE: 1" = 50'		SHEET NO. 6 OF 10 SHEETS		STA. 1205+00 TO STA. 1219+00			