

**SUGGESTED LOCATIONS FOR EMBANKMENT
CONSTRUCTION AND MONITORING**

POINT	ALIGNMENT	MEASUREMENT DEVICE	STATION	OFFSET
1	I-70	S, P	194+17.33	0'
2	I-70	S, P	195+00.00	0'
3	I-70	S, P	196+00.00	0'
4	RAMP 70E55N	S, P	50+90.39	31.5' LT
5	RAMP 70E55N	S, P	51+90.39	31.5' LT
6	I-70	I	195+00.00	161.19' RT
7	RAMP 70E55N	I	51+50.00	151.90' RT
8	RAMP 70E55N	I	52+87.68	119.07' RT
9	RAMP 70E55N	I	53+06.10	31.5' LT
10	RAMP 70E55N	I	52+61.20	171.63' LT

MEASUREMENT DEVICE (SEE TABLE ABOVE)

- I - SLOPE INCLINOMETER
- P - PORE PRESSURE MEASUREMENT DEVICES
- S - SETTLEMENT PLATFORM

TEMPORARY CHAIN LINK FENCE LAYOUT

POINT	ALIGNMENT	STATION	OFFSET
A	I-70	194+11.34	142.53
B	I-70	193+91.21	142.53
C	I-70	193+91.21	180.2
D	I-70	194+10.95	196.96
E	I-70	194+50.69	190.43
F	RAMP 70E55N	50+46.53	160.30
G	RAMP 70E55N	50+87.67	171.61
H	RAMP 70E55N	51+50.67	175.45
I	RAMP 70E55N	51+70.87	171.64
J	RAMP 70E55N	52+28.07	142.34
K	RAMP 70E55N	52+28.07	120.13

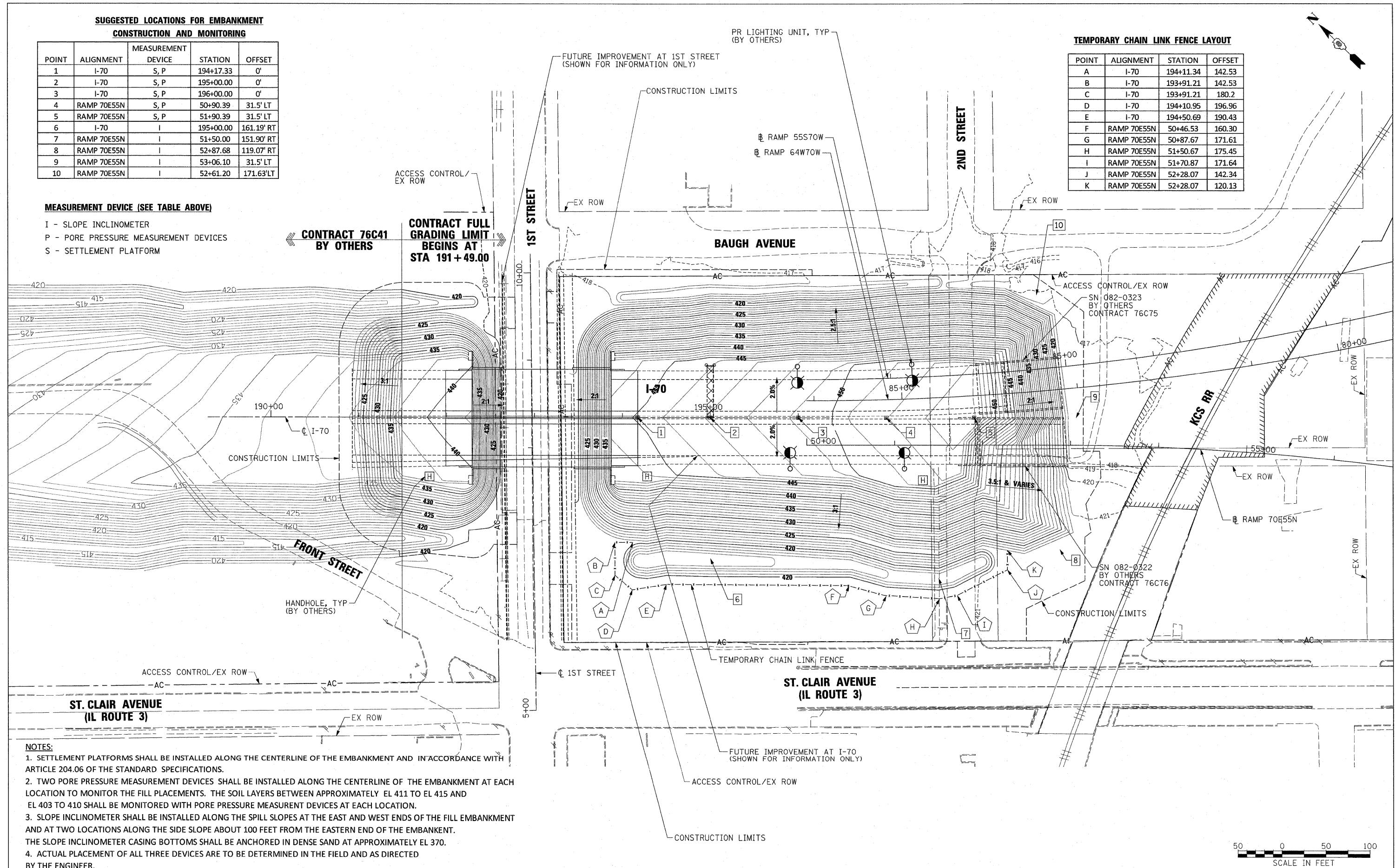

- NOTES:**
1. SETTLEMENT PLATFORMS SHALL BE INSTALLED ALONG THE CENTERLINE OF THE EMBANKMENT AND IN ACCORDANCE WITH ARTICLE 204.06 OF THE STANDARD SPECIFICATIONS.
 2. TWO PORE PRESSURE MEASUREMENT DEVICES SHALL BE INSTALLED ALONG THE CENTERLINE OF THE EMBANKMENT AT EACH LOCATION TO MONITOR THE FILL PLACEMENTS. THE SOIL LAYERS BETWEEN APPROXIMATELY EL 411 TO EL 415 AND EL 403 TO 410 SHALL BE MONITORED WITH PORE PRESSURE MEASUREMENT DEVICES AT EACH LOCATION.
 3. SLOPE INCLINOMETER SHALL BE INSTALLED ALONG THE SPILL SLOPES AT THE EAST AND WEST ENDS OF THE FILL EMBANKMENT AND AT TWO LOCATIONS ALONG THE SIDE SLOPE ABOUT 100 FEET FROM THE EASTERN END OF THE EMBANKMENT. THE SLOPE INCLINOMETER CASING BOTTOMS SHALL BE ANCHORED IN DENSE SAND AT APPROXIMATELY EL 370.
 4. ACTUAL PLACEMENT OF ALL THREE DEVICES ARE TO BE DETERMINED IN THE FIELD AND AS DIRECTED BY THE ENGINEER.

FILE NAME = DBTRI-76C50-sht-grading-01.dgn	USER NAME = pmsarino	DESIGNED OP	REVISED -
		DRAWN PHP/OP	REVISED -
		CHECKED DBM	REVISED -
		DATE 03-18-11	REVISED -

**STATE OF ILLINOIS
DEPARTMENT OF TRANSPORTATION**

PROPOSED GRADING PLAN

SCALE: 1"=50' SHEET NO. 1 OF 1 SHEETS STA. TO STA.

F.A.P. RTE. 998	SECTION 82-1-2HB	COUNTY ST. CLAIR	TOTAL SHEETS 72	SHEET NO. 26
FED. ROAD DIST. NO.		ILLINOIS FED. AID PROJECT		