

Notes:

See Sheet 15 of 30 for Sections B-B, C-C, & D-D and Views E-E & G-G.

Bars indicated thus: 46x2-#5 etc. indicates 46 lines of bars with 2 lengths per line.

*** Cost included with Concrete Superstructure.

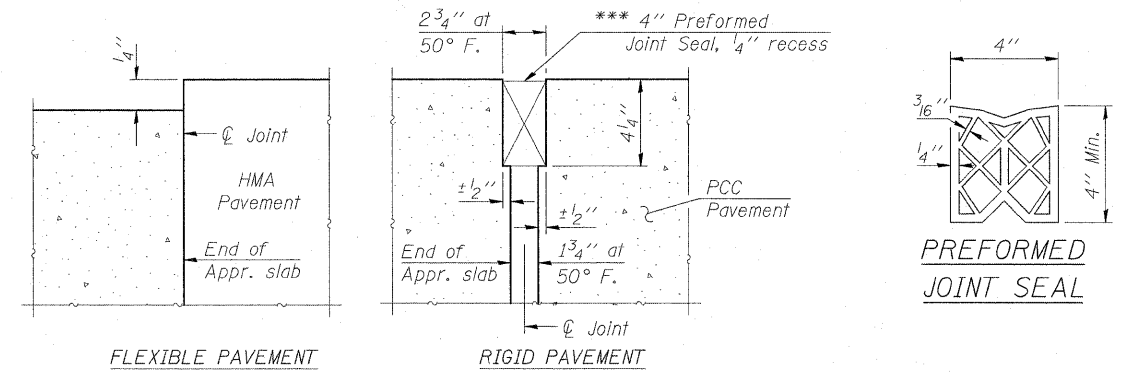

DETAIL A

1" ϕ Anchor bolts
Type 5 terminal connections only.

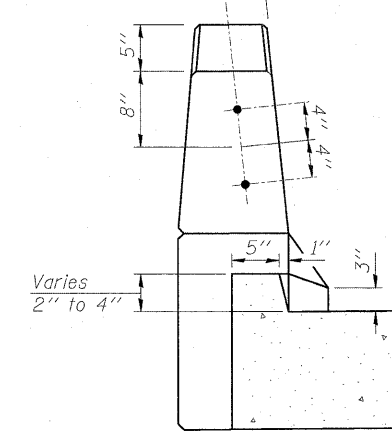

VIEW H-H
(Exit ends only)

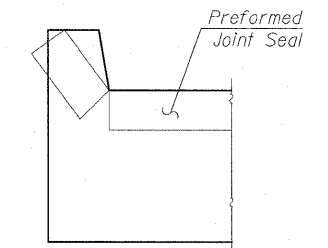

VIEW F-F

Angle Preformed Joint Seal at 45° at curbs when req'd for drainage.

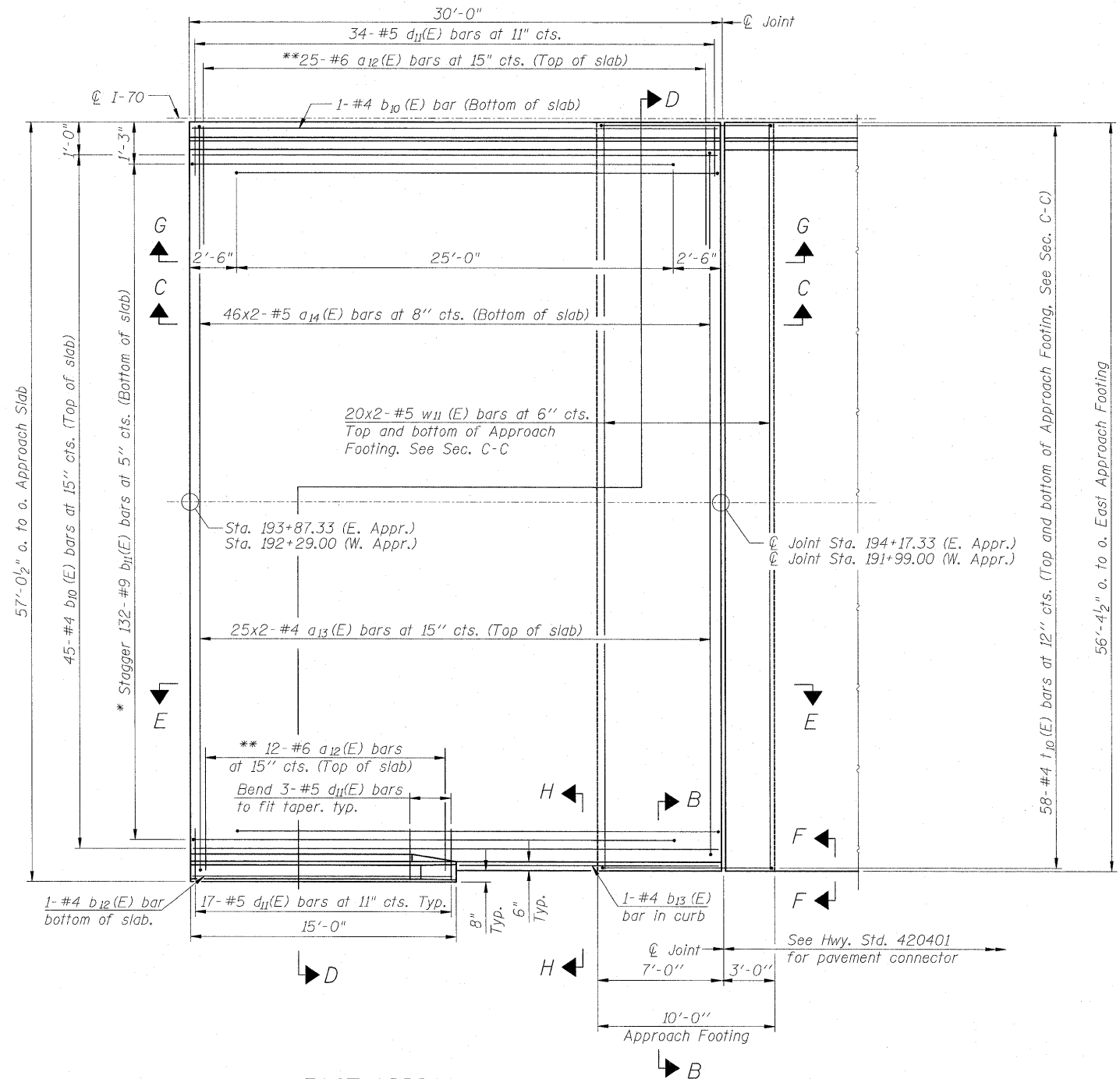

EAST APPROACH SLAB PLAN
(West Approach Slab Similar)

* Tilt #9 b11(E) bars as required to maintain clearance.
** Alternate with a10(E) bars, typ. ea. parapet.

MIN. BAR LAPS

#4 bar = 1'-8"
#5 bar = 2'-2"

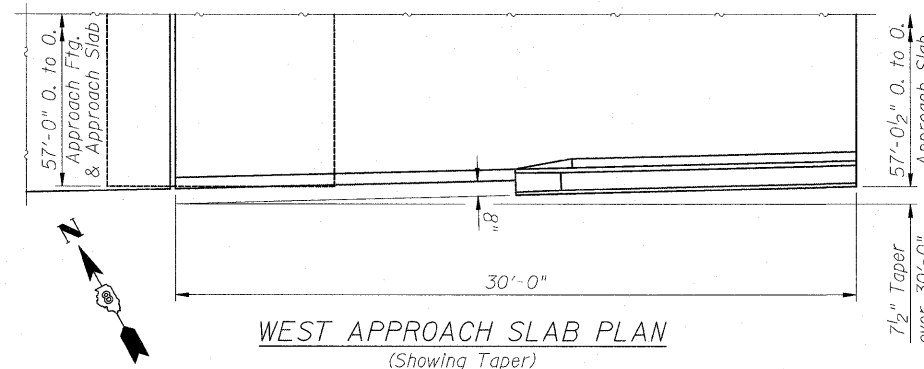

WEST APPROACH SLAB PLAN
(Showing Taper)



Zroka Engineering, P.C.
4216 North Hermitage
Chicago, IL 60613

FILE NAME =	USER NAME = SAW	DESIGNED - LAS	REVISED -
...N081R1-0820312-0820313-76C50-014-EBAppr	...approachSlab1.dgn	DRAWN - SAW	REVISED -
	PLOT SCALE = 1/8" = 1'-0"	CHECKED - LAS	REVISED -
	PLOT DATE = 2/25/2011	DATE - 3-18-11	REVISED -

STATE OF ILLINOIS
DEPARTMENT OF TRANSPORTATION

EASTBOUND BRIDGE APPROACH SLAB DETAILS 1

SCALE: NONE SHEET NO. 14 OF 30 SHEETS STA. TO STA.

F.A.P. RTE.	SECTION	COUNTY	TOTAL SHEETS	SHEET NO.
998	82-1-2HB	ST. CLAIR	72	44
SN 082-0312 & 082-0313		CONTRACT NO. 76C50		
FED. ROAD DIST. NO.		ILLINOIS FED. AID PROJECT		

EASTBOUND BRIDGE
APPROACH SLAB DETAILS 1
INTERSTATE 70 OVER 1ST STREET
FAI-70
SECTION 82-1-2HB
ST. CLAIR COUNTY
STA. 192+97.45
STRUCTURE NO. 082-0312 (EB)
STRUCTURE NO. 082-0313 (WB)