

**NOTES:**

- EXISTING UTILITIES ARE SHOWN FOR INFORMATION PURPOSES ONLY. ALL LOCATIONS AND ELEVATIONS ARE APPROXIMATE. UTILITIES IN ADDITION TO THOSE SHOWN MAY BE PRESENT. THE CONTRACTOR SHALL FIELD VERIFY THE LOCATION OF ALL UTILITIES BEFORE STARTING CONSTRUCTION.
- THE EXISTING WATER MAIN IS SHOWN FOR INFORMATION PURPOSES ONLY. ALL SIZES, LOCATIONS, AND LENGTHS ARE APPROXIMATE. WATER MAINS IN ADDITION TO THOSE SHOWN MAY BE PRESENT. THE CONTRACTOR SHALL FIELD VERIFY THE SIZE, LOCATION, AND LENGTH OF ALL WATER MAINS PRIOR TO THE START OF CONSTRUCTION.



STA. 7+84.36 (CSX)  
O/S 43.48' LT  
METAL END SECTIONS 15"  
INV = 414.20



67' PIPE CULVERTS  
CLASS D, TYPE 2 15" @ 0.45%



STA. 8+63.79 (CSX)  
O/S 53.23' LT  
METAL END SECTIONS 15"  
INV = 413.90



STA. 9+99.37 (CSX)  
O/S 11.07' LT  
CATCH BASINS, TYPE A 4'-DIAM.  
TYPE B GRATE  
RIM = 412.00  
INV = 409.59



118' STORM SEWER  
(WATER MAIN REQUIREMENTS) 15 INCH @ 0.50%  
TBF = 6.9 CU YD



STA. 10+93.53 (CSX)  
O/S 56.14' RT  
PRC FLAR END SEC 15  
INV = 409.00

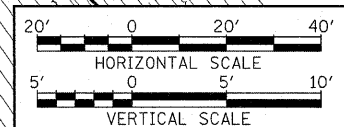
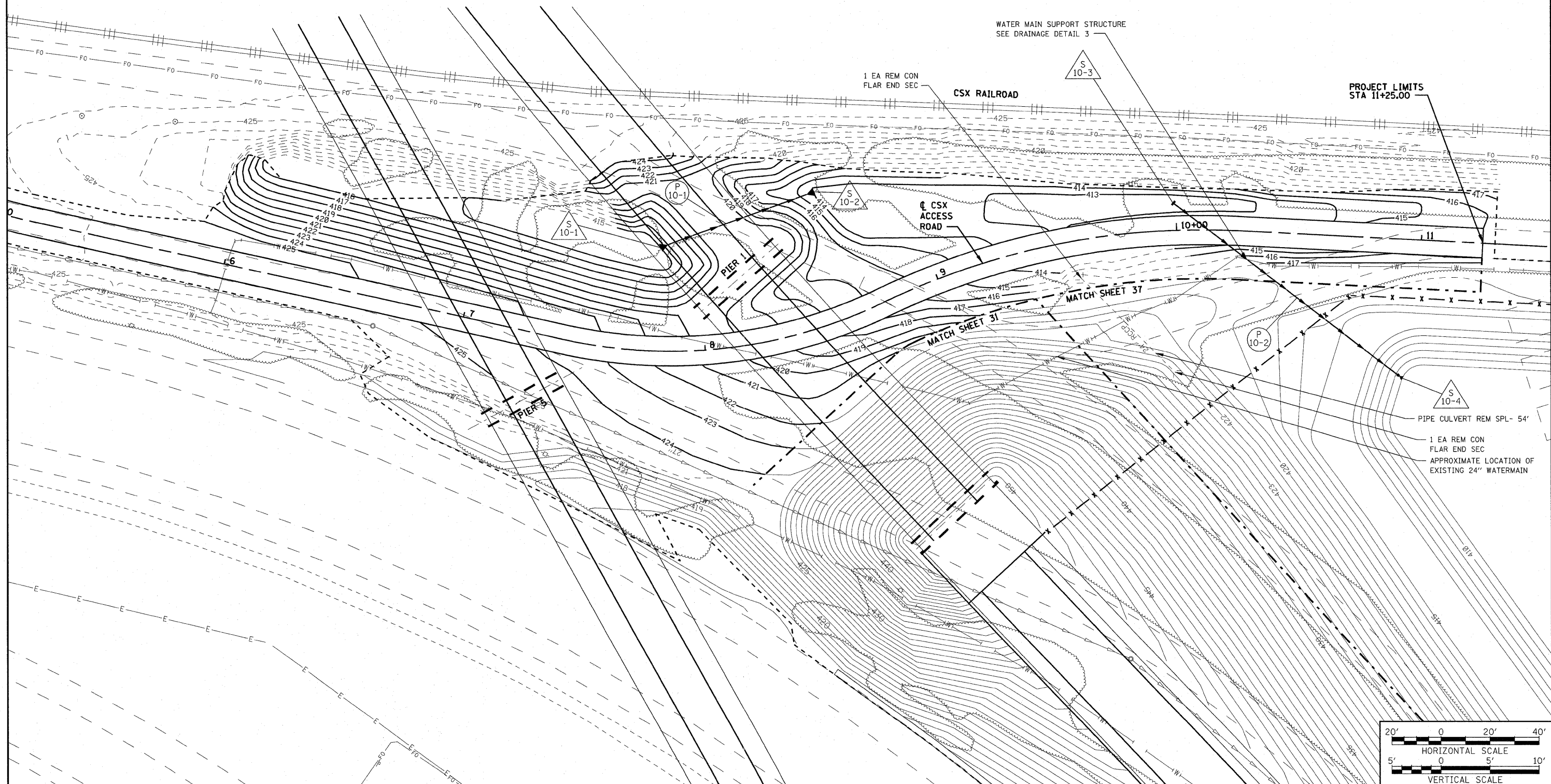

FILE NAME =	USER NAME = afrankenberg	DESIGNED - AGF	REVISED -	<b>STATE OF ILLINOIS DEPARTMENT OF TRANSPORTATION</b>	<b>DRAINAGE AND GRADING PLAN CSX ACCESS RD.</b>	F.A.I. RTE. 70	SECTION 82-1-B-1	COUNTY ST. CLAIR	TOTAL SHEETS 319	SHEET NO. 66A		
#FILEL#	PLOT SCALE = 40.0000' / IN.	DRAWN - AGF	REVISED -			SCALE: 1" = 20'	SHEET NO. 10 OF 10 SHEETS	STA. N/A	TO STA. N/A	CONTRACT NO. 76C75		
	PLOT DATE = 3/24/2011	CHECKED - MPW	REVISED -			ILLINOIS FED. AID PROJECT						
		DATE - 3-18-11	REVISED -									