

MATCHLING (SEE SHEET 3)

MATCHLINE (SEE SHEET 5)

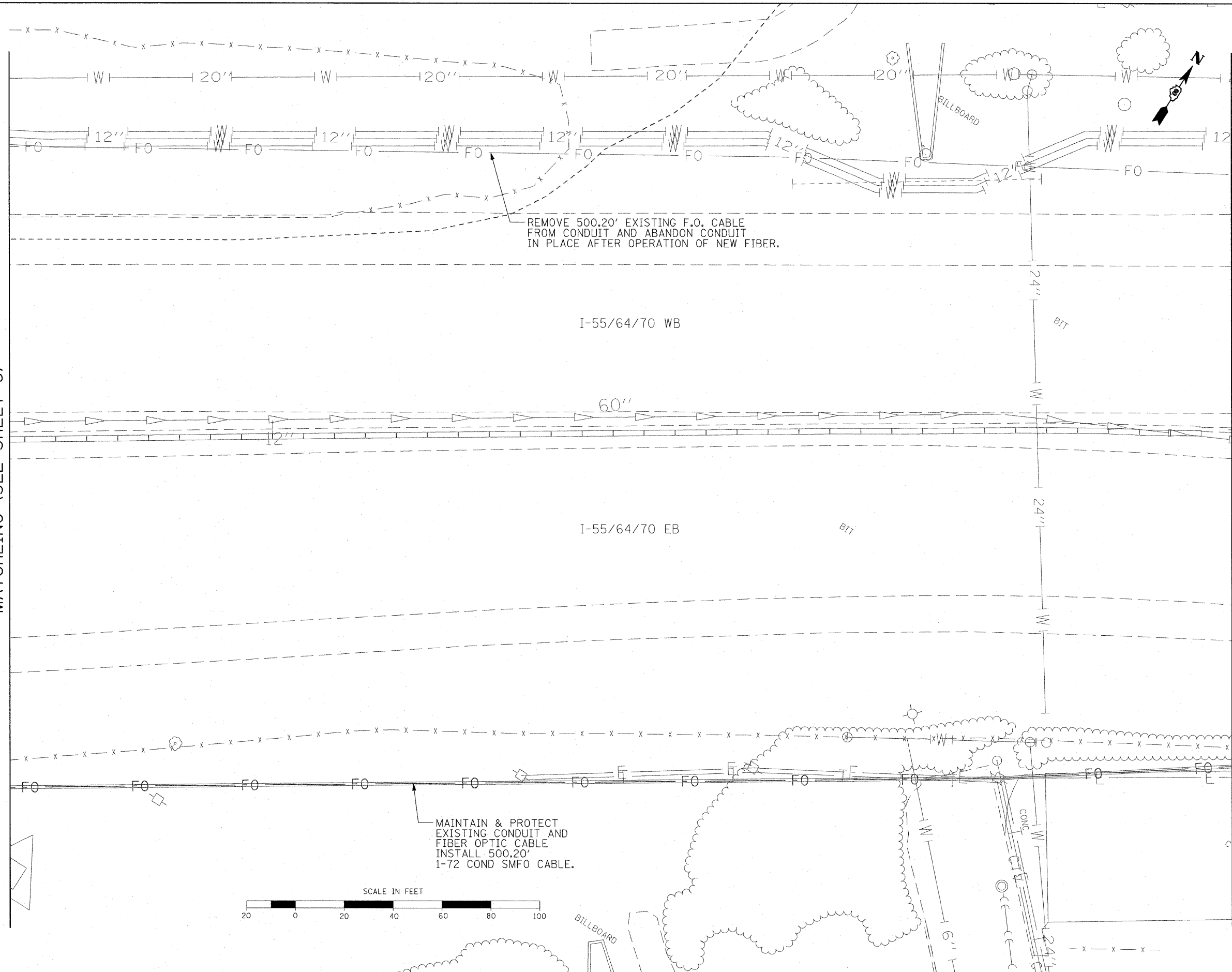

REMOVE 500.20' EXISTING F.O. CABLE FROM CONDUIT AND ABANDON CONDUIT IN PLACE AFTER OPERATION OF NEW FIBER.

MAINTAIN & PROTECT EXISTING CONDUIT AND FIBER OPTIC CABLE. INSTALL 500.20' 1-72 COND SMFO CABLE.

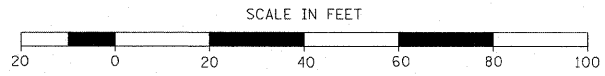

FILE NAME = DBTr1-00-shc-1TS02-378602.dgn	USER NAME = bmarron	DESIGNED - PB	REVISED -	STATE OF ILLINOIS DEPARTMENT OF TRANSPORTATION	ITS CABLE RELOCATION PLAN			F.A.I. RTE. 70	SECTION DIST 8 ITS 2010-2	COUNTY ST. CLAIR	TOTAL SHEETS 319	SHEET NO. 99
	PLOT SCALE = 40.0000' / IN.	CHECKED - DS	REVISED -		SCALE: 1" = 20'	SHEET NO. 4 OF 16 SHEETS	STA. TO STA.	CONTRACT NO. 76C75 ILLINOIS FED. AID PROJECT				
PLOT DATE = 3/11/2011	DATE = 02/25/11	REVISED -	REVISED -									