

CSX R.R. - Top of Rail

**CURVE DATA**  
 Curve 55S-5  
 P.I. STA. = 93+80.20  
 $\Delta = 30^\circ 29' 46.07''$  (LT)  
 $D = 6^\circ 28' 13.22''$   
 $T = 241.39'$   
 $L = 471.32'$   
 $R = 885.51'$   
 $E = 32.31'$   
 P.C. STA. = 91+38.81  
 P.T. STA. = 96+10.13

**CURVE DATA**  
 Curve 55S70W-4  
 P.I. STA. = 81+39.12  
 $\Delta = 26^\circ 52' 21.21''$  (RT)  
 $D = 2^\circ 00' 32.29''$   
 $T = 681.35'$   
 $L = 1,337.63'$   
 $R = 2,852.00'$   
 $E = 80.26'$   
 $S.E. = 3.5\%$   
 ATTAINMENT T.R. = 0  
 ATTAINMENT S.E. RUN = 0  
 P.C. STA. = 74+57.77  
 P.T. STA. = 87+95.40  
 REMOVAL S.E. RUN = 169'  
 REMOVAL T.R. = 72'

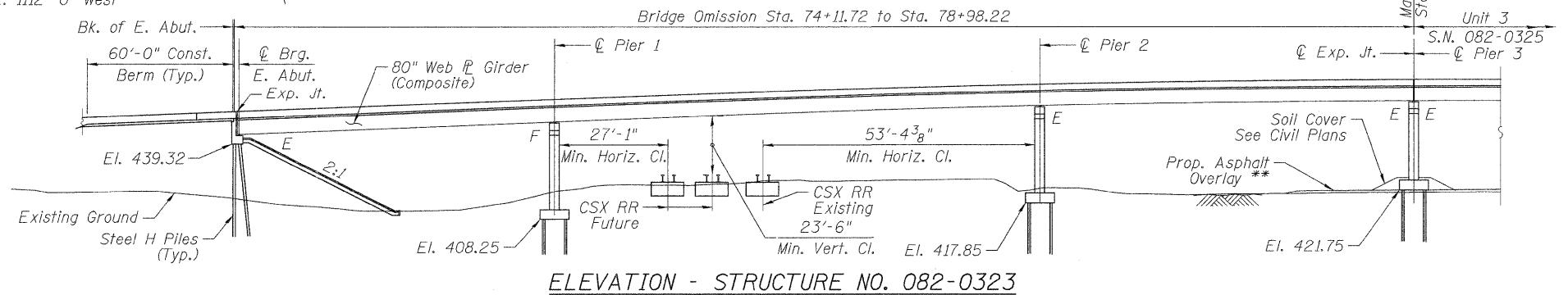
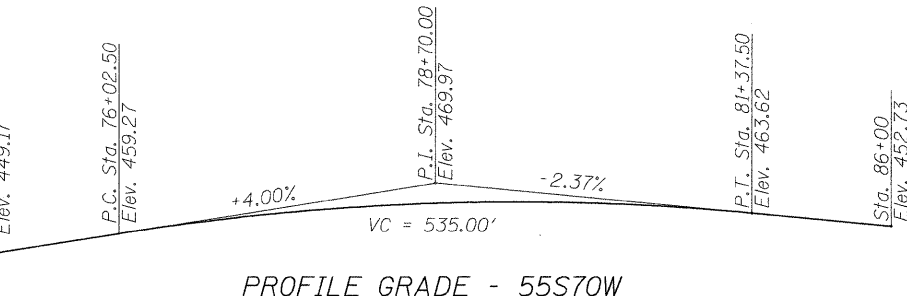
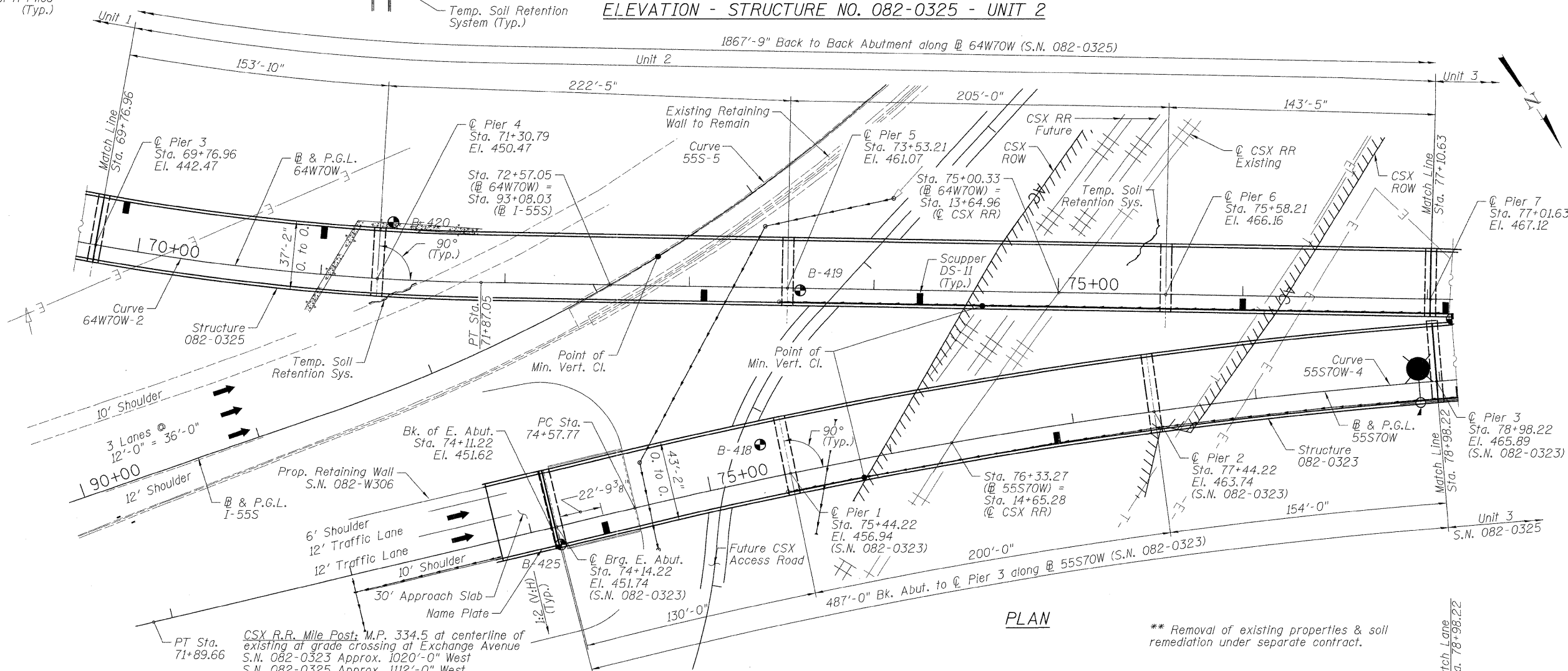

\*\* Removal of existing properties & soil remediation under separate contract.

P:\P0204660\9000\_CAD\9000\_Drawing\767C75\767C75\_Sheets\Structural\082-0323\_Sheets\082-0323-2325\_767C75\_OPE\_2.dgn



USER NAME = Bhatta	DESIGNED - DD	REVISED -
DRAWN - DD	REVISED -	
CHECKED - ATB	REVISED -	
DATE - 3-30-11	REVISED -	

STATE OF ILLINOIS  
 DEPARTMENT OF TRANSPORTATION

GENERAL PLAN AND ELEVATION - II  
 I-70W OVER I-55, CSX & KCS RAILROADS  
 SCALE: NONE SHEET NO. S-3 OF S-138 SHEETS STA. TO STA.

F.A.I. RTE.	SECTION	COUNTY	TOTAL SHEETS	SHEET NO.
70	82-1-B-1	ST. CLAIR	319	118
S.N. 082-0323 & S.N. 082-0325			CONTRACT NO. 76C75	
FED. ROAD DIST. NO.		ILLINOIS FED. AID PROJECT		