

Notes:
See sheet S-52 for Sections C-C & D-D and View E-E.

*** Cost included with Concrete Superstructure.

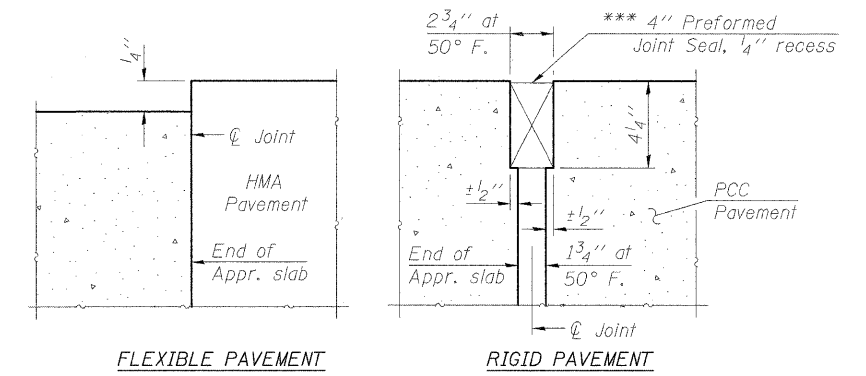

DETAIL A

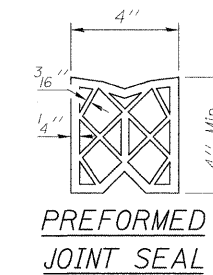

MIN. BAR LAPS
#4 bar = 2'-7"
#5 bar = 3'-3"

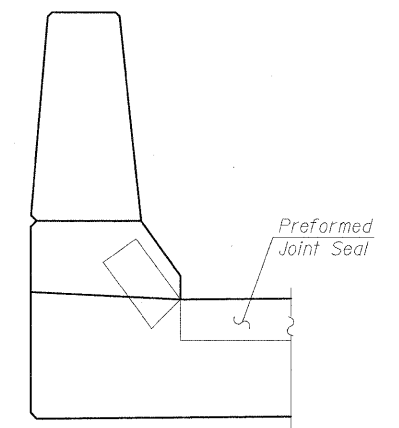

VIEW B-B

Angle Preformed Joint Seal at 45° at curbs when req'd for drainage.

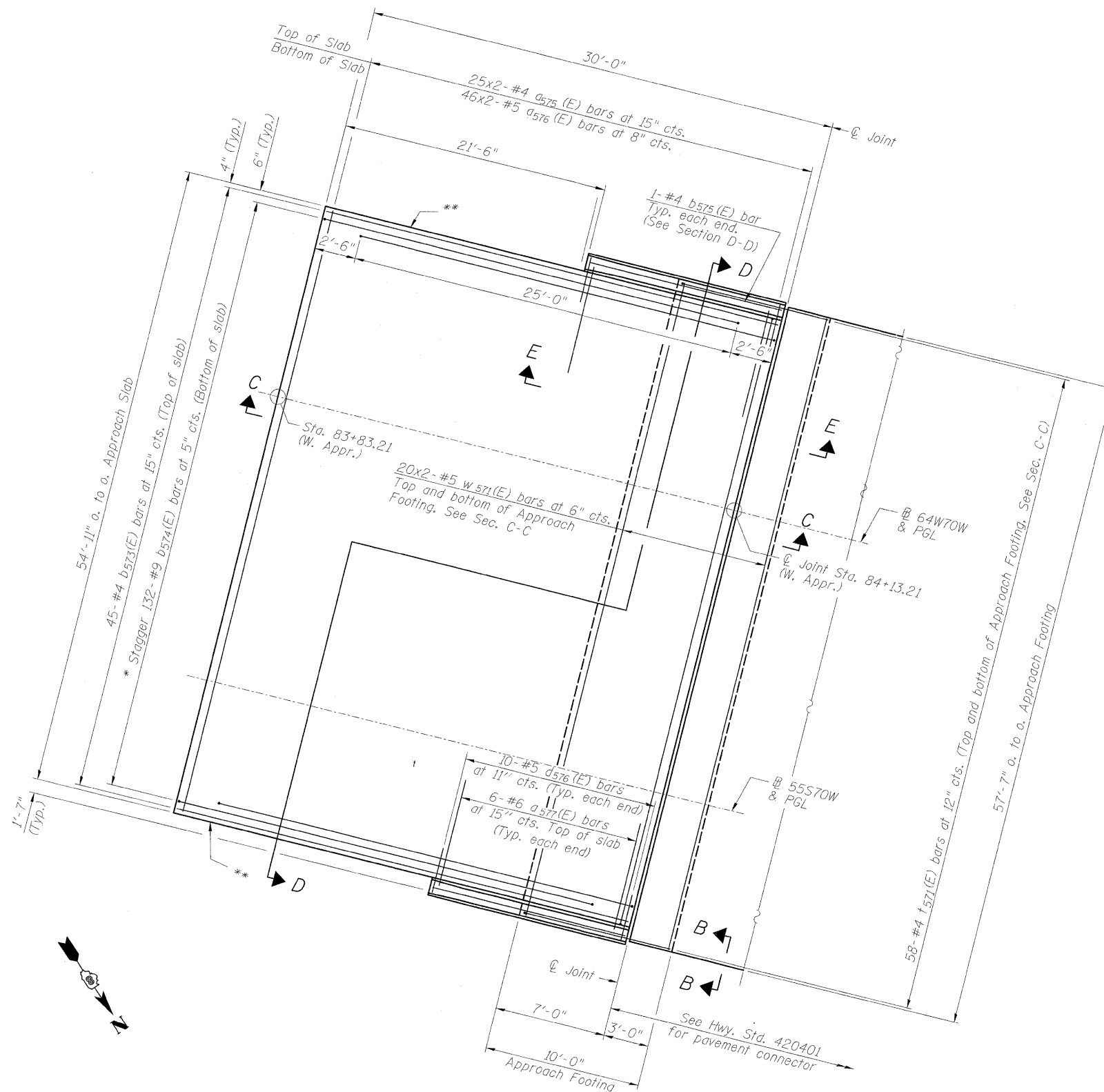

WEST APPROACH SLAB PLAN - S.N. 082-0325

* Tilt #9 b574(E) bars as required to maintain clearance.
** Closed cell joint filler according to Article 1051.08 of the Standard Specifications, full depth of slab, full length of parapet. Typical each parapet.

D:\ITL\0820325-0820325-76C75-851-WApp-Slab-025.dgn

		USER NAME = BhattA	DESIGNED - JLA	REVISED -	STATE OF ILLINOIS DEPARTMENT OF TRANSPORTATION	WEST APPROACH SLAB PLAN - S.N. 082-0325 I-70W OVER I-55, CSX & KCS RAILROADS	F.A.I. RTE.	SECTION	COUNTY	TOTAL SHEETS	SHEET NO.
		PLOT SCALE = 1/8" = 1' / in.	DRAWN - DAZ	REVISED -			70	82-1-B-1	ST. CLAIR	319	166
PLOT DATE = #DATE#		CHECKED - SAW	DATE - 04-26-11	REVISED -	SCALE: NONE	SHEET NO. S-51 OF S-138 SHEETS	STA.	TO STA.	S.N. 082-0323 & S.N. 082-0325 CONTRACT NO. 76C75		
							FED. ROAD DIST. NO.	ILLINOIS FED. AID PROJECT			