

**BEARING LAYOUT - S.N. 082-0325 - UNIT 1**

Notes:  
 A = Angle between Tangent to Girder and Direction of Movement.  
 B = Angle between Tangent to Girder and  $\phi$  of Pier or Abutment.  
 C = Setting angle between  $\phi$  of Bearing Base Plate and  $\phi$  of Pier or Abutment.  
 D = Set Bearing Base Plates at right angles to the Direction of Movement/Chord.

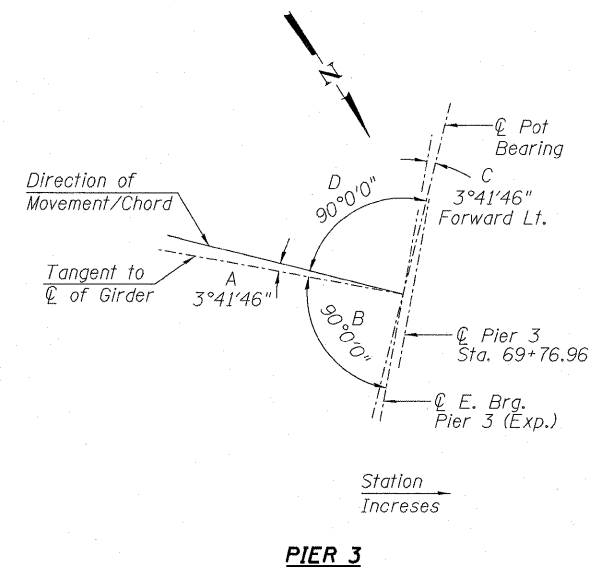
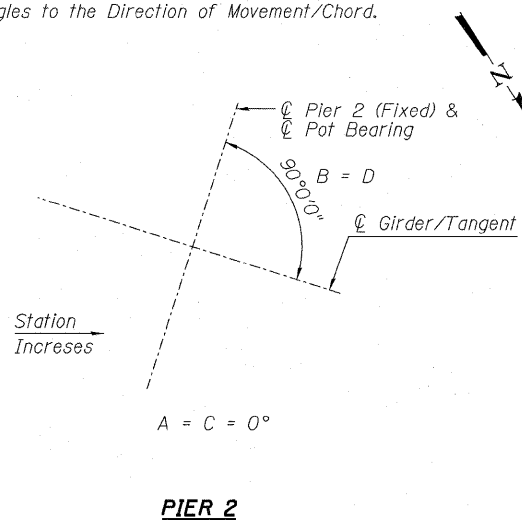
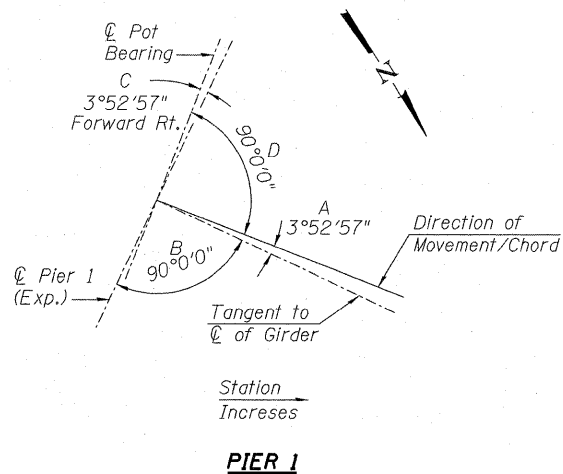
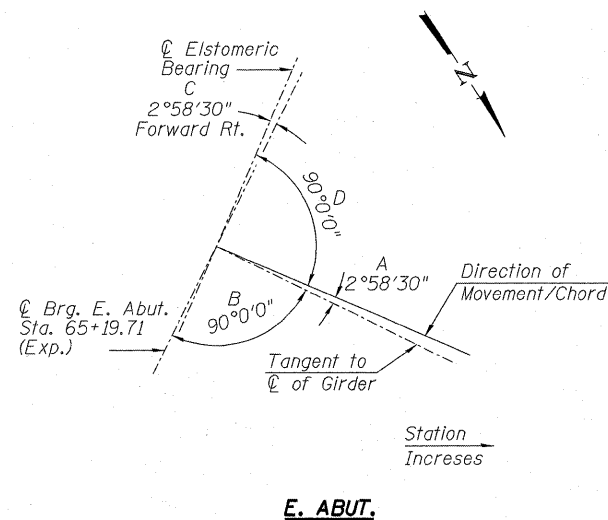

**BEARING ORIENTATION - S.N. 082-0325 - UNIT 1**

P:\6680\6680\980\CA01\981\Drawings\Structural\082-0325\Sheet\58884\_082-0325\_76C75\_Bearing-Unit1.dgn



USER NAME = BhattA	DESIGNED - LLV	REVISED -
PLOT SCALE = 0.1867' / in.	DRAWN - BRD	REVISED -
PLOT DATE = *DATE*	CHECKED -	REVISED -
	DATE - 03/18/2011	REVISED -

STATE OF ILLINOIS  
DEPARTMENT OF TRANSPORTATION

**BEARING LAYOUT & ORIENTATION - S.N. 082-0325 UNIT 1**  
**I-70W OVER I-55, CSX & KCS RAILROADS**

SCALE: NONE SHEET NO. S-84 OF S-138 SHEETS STA. TO STA.

F.A.I. RTE. 70	SECTION 82-1-B-1	COUNTY ST. CLAIR	TOTAL SHEETS 319	SHEET NO. 199
S.N. 082-0323 & S.N. 082-0325		CONTRACT NO. 76C75		
FED. ROAD DIST. NO.		ILLINOIS FED. AID PROJECT		