

**ELEVATION**  
(Looking @ front face of wall)

4" dia x 2'-6" long Sch 80 PVC pipe with end cap, 12-1/2" evenly distributed holes and fabric wrapped. Pushed or predrilled into backfill. Cost of installing weep holes included with Permanent Steel Sheet Piling.

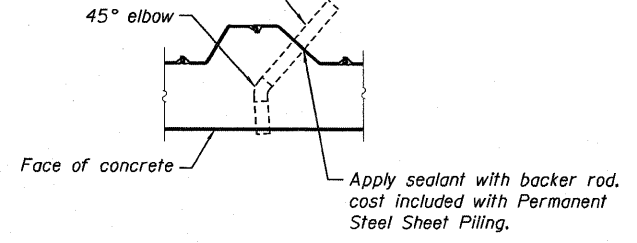

**WEEP HOLE DETAIL**

**DESIGN SPECIFICATIONS**  
2002 AASHTO - Standard Specifications for Highway Bridges

**DESIGN STRESSES**  
f'c = 3,500 psi  
fy = 60,000 psi (reinf.)  
fy = 39,000 psi (M202 Grade 39)

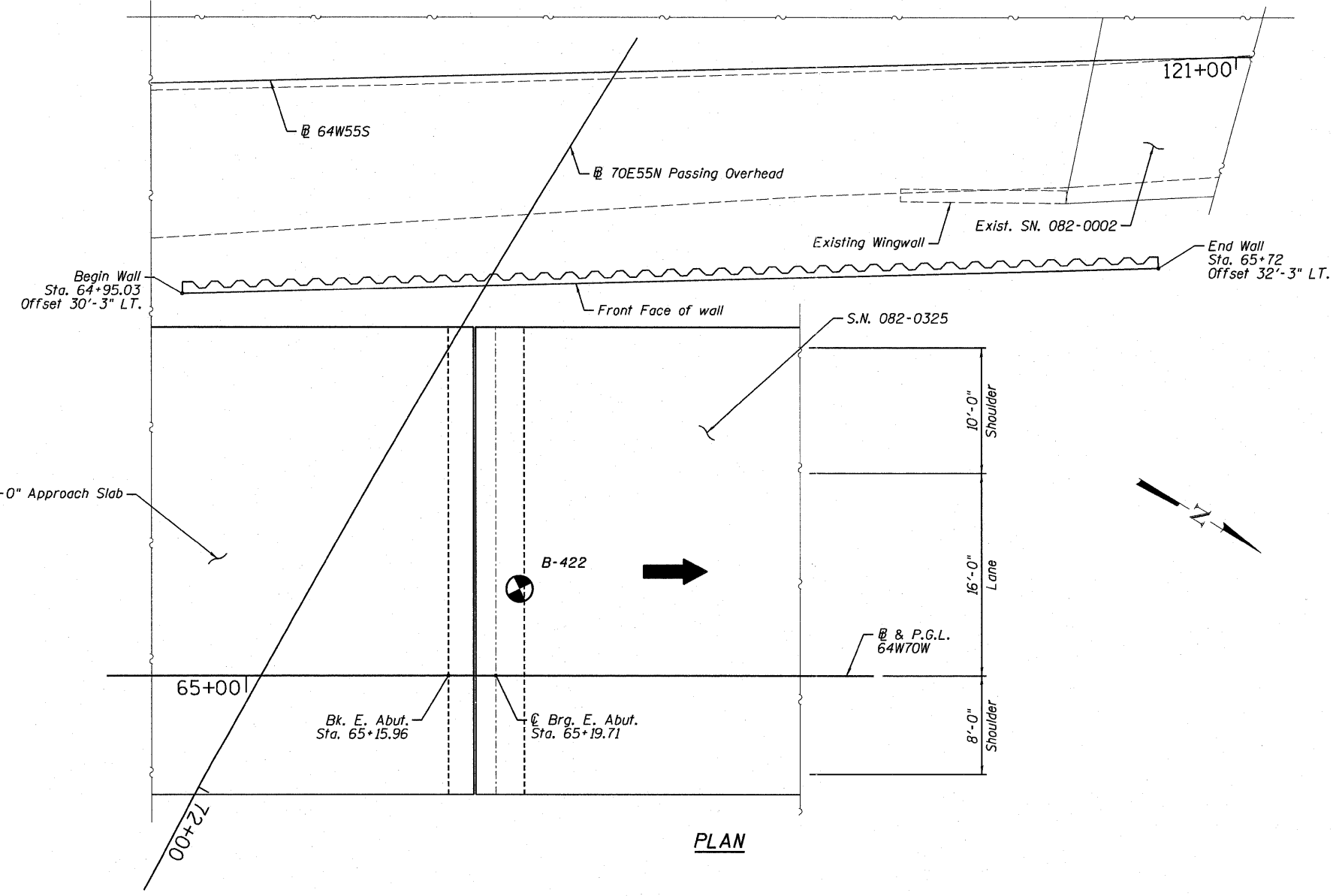

**PLAN**

**BILL OF MATERIAL**

Bar	No.	Size	Length	Shape
h210(E)	4	#5	22'-6"	—
h211(E)	2	#5	21'-11"	—
h212(E)	1	#5	20'-6"	—
h213(E)	1	#5	10'-0"	—
h214(E)	1	#5	7'-0"	—
h215(E)	1	#5	17'-0"	—
h216(E)	22	#5	21'-0"	—
h217(E)	9	#5	19'-10"	—
v210(E)	6	#5	2'-6"	—
v211(E)	7	#5	11'-0"	—
v212(E)	4	#5	18'-6"	—
v213(E)	6	#5	20'-5"	—
v214(E)	5	#5	19'-7"	—
v215(E)	5	#5	18'-0"	—
v216(E)	11	#5	12'-4"	—
v217(E)	2	#5	2'-5"	—
v218(E)	2	#5	3'-10"	—
u210(E)	9	#5	4'-6"	—
Concrete Structures	Cu. Yd.		27.2	
Reinforcement Bars, Epoxy Coated	Pound		1560	
Permanent Steel Sheet Piling	Sq. Ft.		2430	

P:\960846509\9608\_040\981\_Drawing\76C75\_Master-Consolidated\Structural\082-0323\_Sheet\082-0323\_0325\_76C75\_RetWall-1.dwg

<b>AECOM</b>	USER NAME = BhattA	DESIGNED - LLV	REVISED -	<b>STATE OF ILLINOIS DEPARTMENT OF TRANSPORTATION</b>	<b>PERMANENT STEEL SHEET PILE WALL - GENERAL PLAN</b>		F.A.I. RTE.	SECTION	COUNTY	TOTAL SHEETS	SHEET NO.	
	PLOT SCALE = 0.166666' / 1"	DRAWN - BRD	REVISED -		SCALE: NONE	SHEET NO. S-125 OF S-138 SHEETS	STA.	TO STA.	70	82-1-B-1	ST. CLAIR	319 240
	PLOT DATE = #DATE#	CHECKED - P.J.L	REVISED -							S.N. 082-0323 & S.N. 082-0325	CONTRACT NO. 76C75	
		DATE - 03/18/2011	REVISED -							FED. ROAD DIST. NO.	ILLINOIS FED. AID PROJECT	