

STATE OF ILLINOIS
DEPARTMENT OF TRANSPORTATION
DIVISION OF HIGHWAYS

**PROPOSED
HIGHWAY PLANS**

FAP ROUTE 789 (IL 143)
SECTION (7Z, 125)RS-4
PROJECT ACF-0789(049)
RESURFACING
MADISON COUNTY

F.A. RTE.	SECTION	COUNTY	TOTAL SHEETS	SHEET NO.
789	(7Z, 125)RS-4	Madison	19	1
ILLINOIS			CONTRACT NO. 76E39	

FOR INDEX OF SHEETS, SEE SHEET NO. 2



C-98-124-10
BRIDGE OMISSION
STA. 416+44.78 TO STA. 418+79.75

BRIDGE OMISSION
STA. 407+39.41 TO STA. 409+77.38

BRIDGE OMISSION
STA. 425+47.56 TO STA. 427+44.85

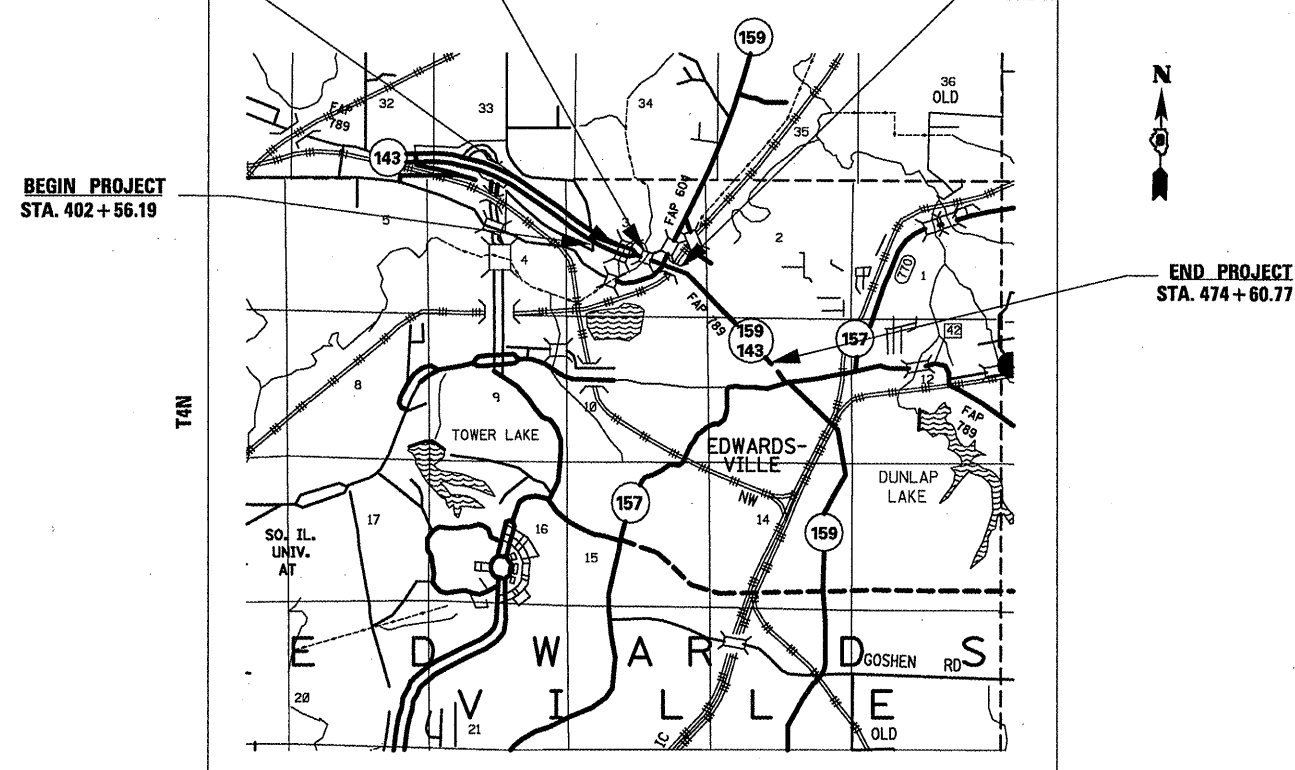

BEGIN PROJECT
STA. 402+56.19

END PROJECT
STA. 474+60.77

DESIGN DESIGNATION N/A

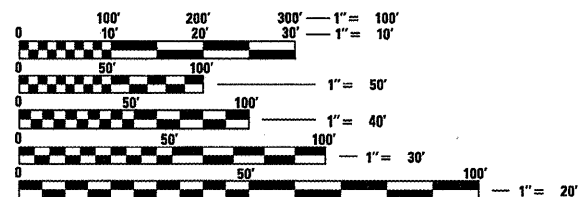

FULL SIZE PLANS HAVE BEEN PREPARED USING STANDARD ENGINEERING SCALES. REDUCED SIZED PLANS WILL NOT CONFORM TO STANDARD SCALES. IN MAKING MEASUREMENTS ON REDUCED PLANS, THE ABOVE SCALES MAY BE USED.

J.U.L.I.E.
JOINT UTILITY LOCATION INFORMATION FOR EXCAVATION
1-800-892-0123
OR 811

PROJECT ENGINEER PATTI LEBEAU 618-346-3179
PROJECT MANAGER ART MUEHLFELD 618-346-3209

CONTRACT NO. 76E39

GROSS LENGTH = 7204.58 FT. = 1.36 MILE
NET LENGTH = 6534.35 FT. = 1.24 MILE

GROSS LENGTH = 7204.58'
BRIDGE OMISSION 1 = 237.29'
BRIDGE OMISSION 2 = 234.97'
BRIDGE OMISSION 3 = 197.97'
NET LENGTH = 6534.35'

LOCATION MAP
NOT TO SCALE

STATE OF ILLINOIS
DEPARTMENT OF TRANSPORTATION
DIVISION OF HIGHWAYS

SUBMITTED *March 24 20 11*
Mary C. Jamie
DEPUTY DIRECTOR OF HIGHWAYS, REGION 5 ENGINEER

May 13 20 11
Scott E. Stippel
actg ENGINEER OF DESIGN AND ENVIRONMENT

May 13 20 11
Christine M. Reed
DIRECTOR OF HIGHWAYS, CHIEF ENGINEER

PRINTED BY THE AUTHORITY
OF THE STATE OF ILLINOIS