







**LEGEND**

- |   |                                      |  |                                     |
|---|--------------------------------------|--|-------------------------------------|
|  | 1/2" HOT MIX ASPHALT SURFACE REMOVAL |  | MEDIAN REMOVAL                      |
|  | 3/4" HOT MIX ASPHALT SURFACE REMOVAL |  | MEDIAN SURFACE REMOVAL              |
|  | PAVEMENT REMOVAL                     |  | COMBINATION CURB AND GUTTER REMOVAL |
|  | PAVED SHOULDER REMOVAL               |  |                                     |

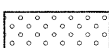
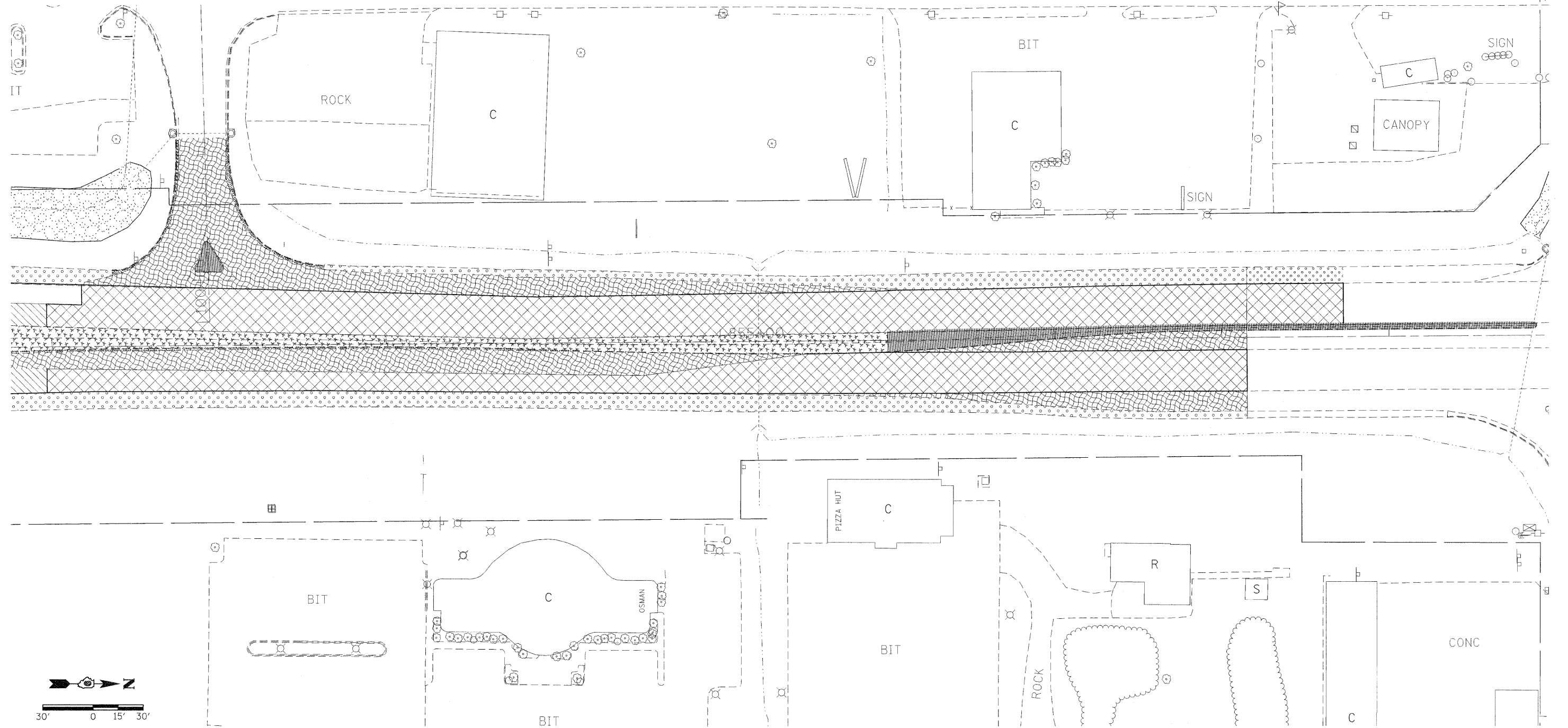

FILE NAME =	USER NAME = thomashf	DESIGNED -	REVISED -	<b>STATE OF ILLINOIS DEPARTMENT OF TRANSPORTATION</b>	<b>REMOVAL PLAN IL 13</b>				F.A.P. RTE.	SECTION	COUNTY	TOTAL SHEETS	SHEET NO.
ci:\pwork\pwsdot\thomashf\d0157472\shtr	removal.dgn	DRAWN -	REVISED -		331	(IX-1R-1,RS-2,N-2,TS-3	WILLIAMSON	167	48				
	PLOT SCALE = 30.0000' / IN.	CHECKED -	REVISED -		SCALE: 1"=30'				CONTRACT NO. 78155				
	PLOT DATE = 4/19/2011	DATE -	REVISED -		SHEET NO. OF SHEETS STA. TO STA.				ILLINOIS FED. AID PROJECT				