

STAGE 1 NOTES:

REMOVE EXISTING SHOULDER AND PAVEMENT, PLACE EMBANKMENT, HMA SHOULDER AND HMA PAVEMENT, CURB AND GUTTER AND SIDEWALK.

CLOSE OUTSIDE EASTBOUND THROUGH LANE AND WESTBOUND OUTSIDE THROUGH LANE ACCORDING TO STD 701601. TRAFFIC CONTROL ON SIDEROADS SHALL BE ACCORDING TO 701601.

FOR EACH PARTIAL DAY OR FULL DAY UNDER THIS SET UP A LANE RENTAL WILL BE CHARGED AS FOLLOWS:
 1 DAY IL 13 EB THROUGH LANE, 1 DAY IL 13 WB THROUGH LANE
 2 LANE RENTAL DAYS MAY BE CHARGED IN SAME TIME PERIOD

STAGE 1

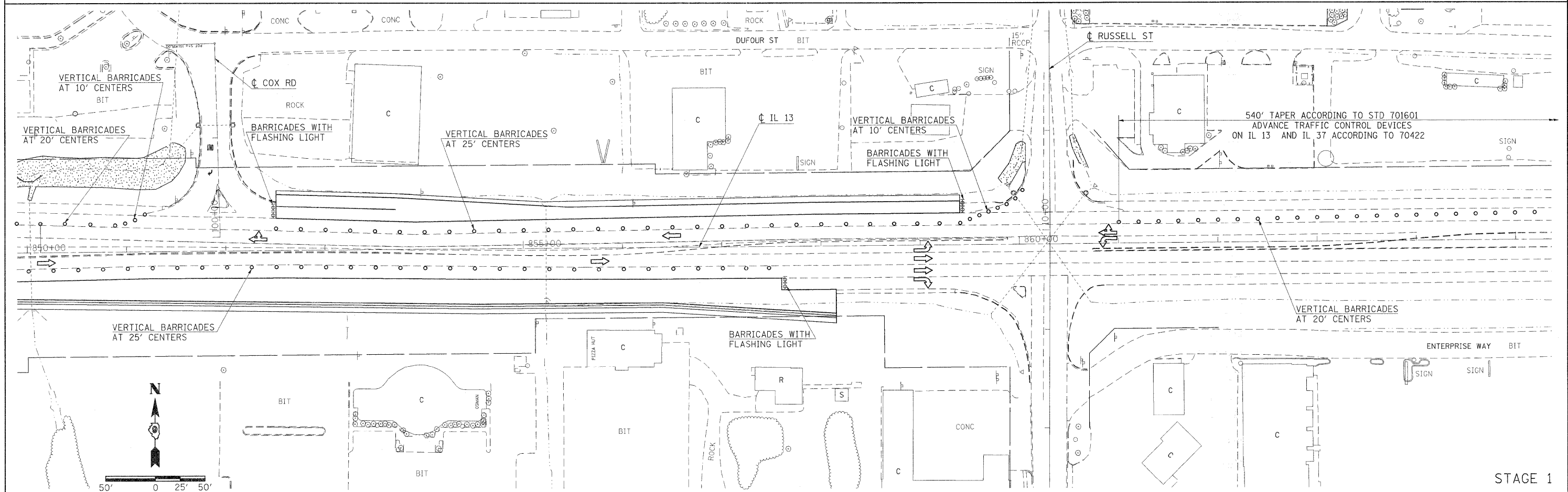

STAGE 1

FILE NAME =	USER NAME = thomashf	DESIGNED -	REVISED -	STATE OF ILLINOIS DEPARTMENT OF TRANSPORTATION	STAGING PLAN STAGE 1			F.A.P. RTE.	SECTION	COUNTY	TOTAL SHEETS	SHEET NO.			
c:\pwwork\pwwork\thomashf\d0157472\staging.dgn		DRAWN -	REVISED -		SCALE: 1=50'	SHEET NO.	OF	SHEETS	STA.	TO STA.	331	(1X-1)R-1,RS-2,N-2,TS-3	WILLIAMSON	167	55
		CHECKED -	REVISED -												
		DATE -	REVISED -												
	PLOT SCALE = 50.0000' / IN.														
	PLOT DATE = 3/22/2011														
											CONTRACT NO. 78155				
											ILLINOIS FED. AID PROJECT				