

STAGE 6 NOTES:
 REMOVE EXISTING PAVEMENT. PLACE PCC PAVEMENT
 CLOSE WESTBOUND OUTSIDE THROUGH LANE ACCORDING TO 701601.
 CLOSE SOUTHBOUND THROUGH, LEFT AND RIGHT TURN LANE ACCORDING TO BLR 21.
 CLOSE NORTHBOUND THROUGH LANE AND ONE NORTHBOUND LEFT TURN LANE ACCORDING TO STA 701701.
 CLOSE EASTBOUND LEFT TURN LANE ACCORDING TO STANDARD 701701.
 FOR EACH PARTIAL OR FULL DAY UNDER THIS SET UP AN INTERSECTION RENTAL WILL BE CHARGED.
 FOR EACH PARTIAL DAY OR FULL DAY UNDER THIS SET UP A LANE RENTAL WILL BE CHARGED AS FOLLOWS:
 1 DAY IL 13 WB THROUGH LANE

STAGE 6

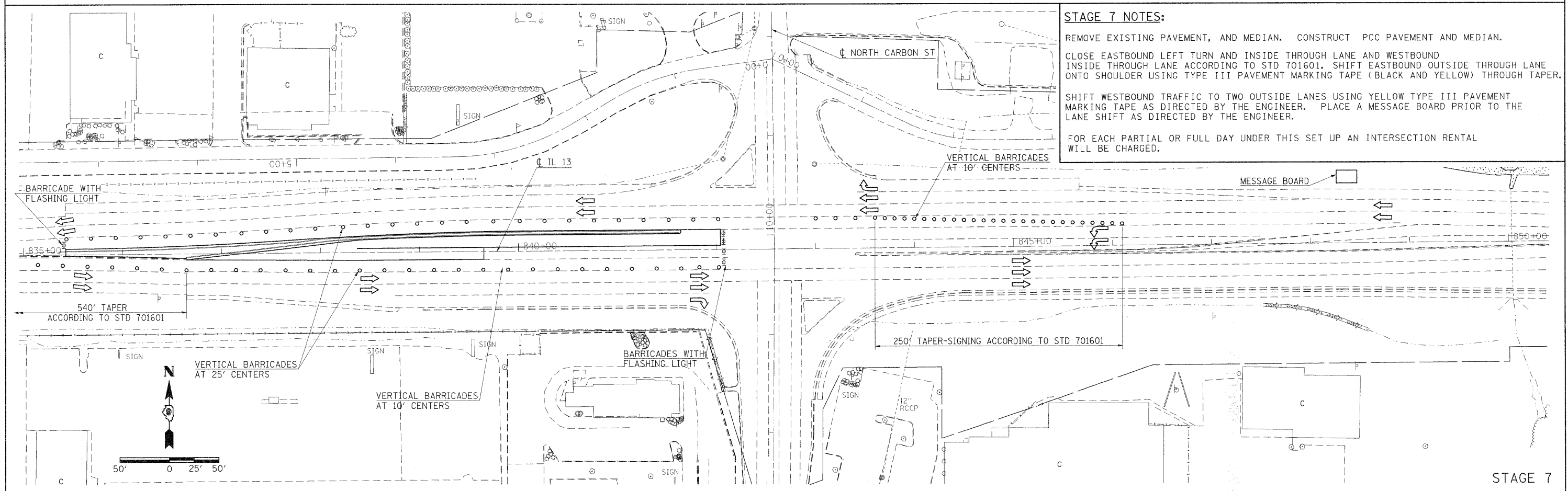

STAGE 7 NOTES:
 REMOVE EXISTING PAVEMENT, AND MEDIAN. CONSTRUCT PCC PAVEMENT AND MEDIAN.
 CLOSE EASTBOUND LEFT TURN AND INSIDE THROUGH LANE AND WESTBOUND INSIDE THROUGH LANE ACCORDING TO STD 701601. SHIFT EASTBOUND OUTSIDE THROUGH LANE ONTO SHOULDER USING TYPE III PAVEMENT MARKING TAPE (BLACK AND YELLOW) THROUGH TAPER.
 SHIFT WESTBOUND TRAFFIC TO TWO OUTSIDE LANES USING YELLOW TYPE III PAVEMENT MARKING TAPE AS DIRECTED BY THE ENGINEER. PLACE A MESSAGE BOARD PRIOR TO THE LANE SHIFT AS DIRECTED BY THE ENGINEER.
 FOR EACH PARTIAL OR FULL DAY UNDER THIS SET UP AN INTERSECTION RENTAL WILL BE CHARGED.

STAGE 7

FILE NAME =	USER NAME = thomashf	DESIGNED -	REVISED -	STATE OF ILLINOIS DEPARTMENT OF TRANSPORTATION	STAGING PLAN STAGES 6 & 7			F.A.P. RTE.	SECTION	COUNTY	TOTAL SHEETS	SHEET NO.
ci:\p\work\p\widot\thomashf\09157472\staging.dgn		DRAWN -	REVISED -		331	(1X-1)R-1,RS-2,N-2,TS-3	WILLIAMSON	167	58			
PLOT SCALE = 50.0000' / IN.		CHECKED -	REVISED -		CONTRACT NO. 78155							
PLOT DATE = 3/22/2011		DATE -	REVISED -		ILLINOIS FED. AID PROJECT							
				SCALE: 1"=50'	SHEET NO.	OF	SHEETS	STA.	TO STA.			