

STAGE 9 NOTES:

REMOVE EXISTING PAVEMENT, CURB, MEDIAN SURFACE AND SOLID MEDIAN. CONSTRUCT PCC PAVEMENT, CURB AND GUTTER, MEDIAN SURFACE AND SOLID MEDIAN.

USE YELLOW AND BLACK TYPE III TAPE TO DELINEATE LANE SHIFTS AND REALIGN LANES AS DIRECTED BY THE ENGINEER. PLACE A MESSAGE BOARD PRIOR TO THE EASTBOUND LANE SHIFT AS DIRECTED BY THE ENGINEER.

FOR EACH PARTIAL DAY OR FULL DAY UNDER THIS SET UP A LANE RENTAL WILL BE CHARGED AS FOLLOWS:
1 DAY IL 13 WB THROUGH LANE

FOR EACH PARTIAL OR FULL DAY THERE IS A RUSSELL ST LT TURN LANE CLOSURE AN INTERSECTION RENTAL WILL BE CHARGED.

CLOSE EASTBOUND LEFT TURN LANE AT RUSSELL ACCORDING TO STANDARD 701701.

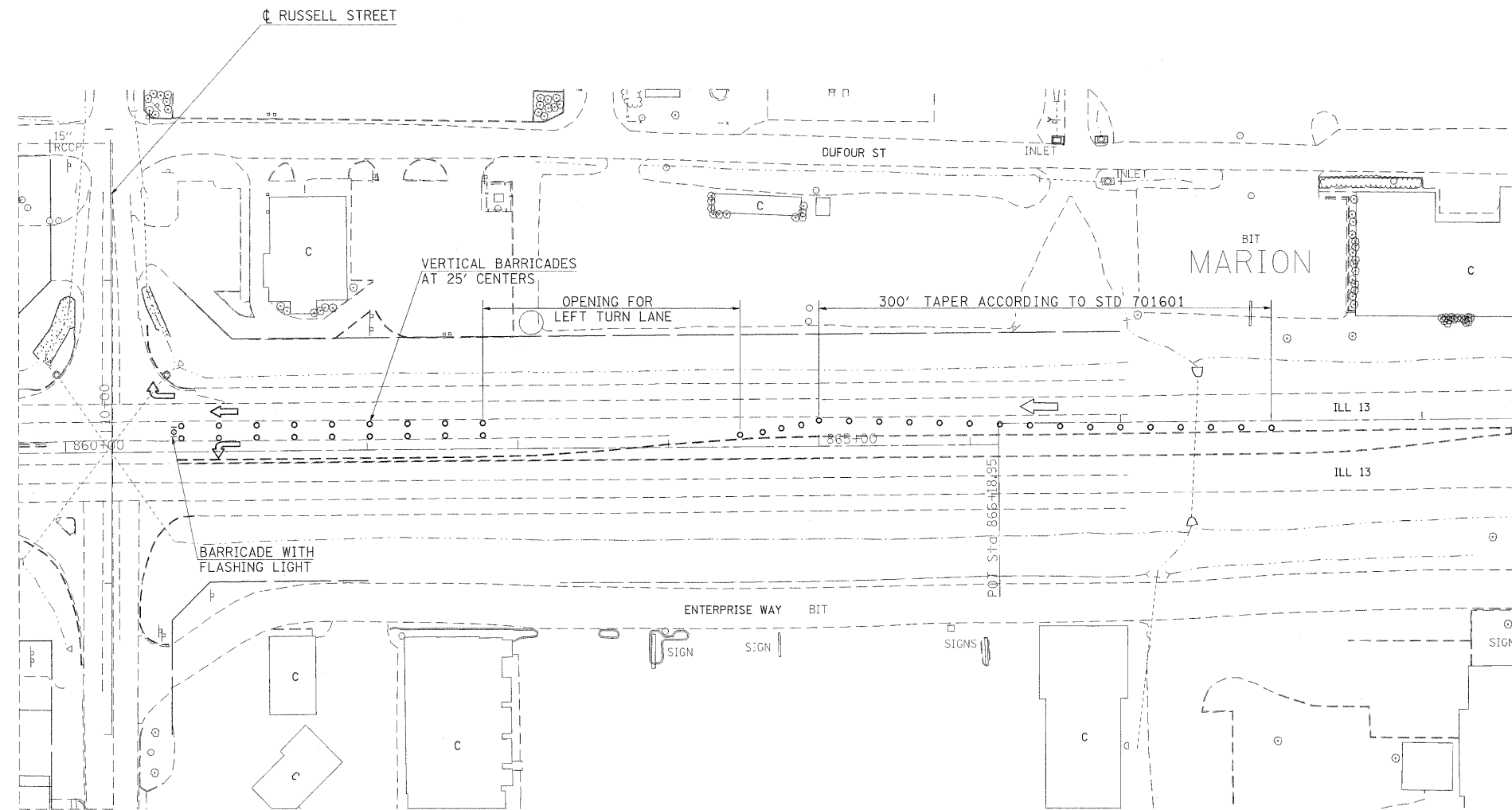

STAGE 9

FILE NAME = c:\pw_work\pw\dot\thomashf\d0157472\sh-t\staging.dgn	USER NAME = thomashf	DESIGNED -	REVISED -	STATE OF ILLINOIS DEPARTMENT OF TRANSPORTATION	STAGING PLAN STAGE 9				F.A.P. RTE.	SECTION	COUNTY	TOTAL SHEETS	SHEET NO.
	PLOT SCALE = 50.0000' / IN.	CHECKED -	REVISED -		SCALE: 1"=50'	SHEET NO.	OF	SHEETS	STA.	TO STA.	WILLIAMSON	167	61
PLOT DATE = 3/22/2011	DATE -	REVISED -	REVISED -					CONTRACT NO. 78155					
ILLINOIS FED. AID PROJECT													