

F.A.U. RTE.	SECTION	COUNTY	TOTAL SHEETS	SHEET NO.
5141	10-00573-00-BR	WINNEBAGO	20	1
FED. ROAD DIST. NO. 2	ILLINOIS	CONTRACT NO. 85540		

INDEX OF SHEETS

SHEET NO.	DESCRIPTION
1	COVER SHEET
2	GENERAL NOTES & LIST OF STATE STANDARDS
3	SUMMARY OF QUANTITIES
4	TYPICAL SECTIONS
5	TEMPORARY DETOUR PLAN
6	REMOVAL PLAN
7	PLAN AND PROFILE
8	EROSION CONTROL, STRIPING & RESTORATION PLAN
9-19	BRIDGE PLANS
20	CROSS SECTIONS

STATE STANDARDS

000001-06	STANDARD SYMBOLS, ABBREVIATIONS AND PATTERNS
280001-05	TEMPORARY EROSION CONTROL SYSTEM
424001-05	CURB RAMPS FOR SIDEWALKS
515001-03	NAME PLATE FOR BRIDGES
601101-01	CONCRETE HEADWALL FOR PIPE DRAIN
602001-02	CATCH BASIN TYPE A
604006-04	FRAME AND GRATE TYPE 3
606001-04	CONCRETE CURB TYPE B AND COMBINATION CONCRETE CURB AND GUTTER
606301-04	PC CONCRETE ISLANDS AND MEDIANS
701101-02	OFF-RD OPERATIONS, MULTILANE, 15' (4.5M) TO 24" (600mm) FROM PAVEMENT EDGE
701427	LANE CLOSURE, MULTILANE, INTERMITTENT OR MOVING OPER., FOR SPEEDS ≤ 40 MPH
701501-06	URBAN LANE CLOSURE, 2L 2W, UNDIVIDED
701606-07	URBAN LANE CLOSURE, MULTILANE, 2W WITH MOUNTABLE MEDIAN
701801-04	LANE CLOSURE MULTILANE 1W OR 2W CROSSWALK OR SIDEWALK CLOSURE
701901-01	TRAFFIC CONTROL DEVICES
728001-01	TELESCOPING STEEL SIGN SUPPORT
729001-01	TELESCOPING STEEL SIGN SUPPORT
780001-02	APPLICATIONS OF TYPES A & B METAL POSTS (FOR SIGNS & MARKERS)
BLR 21-8	TYPICAL APPLICATION OF TRAFFIC CONTROL DEVICES FOR CONSTRUCTION ON RURAL LOCAL HIGHWAYS

CITY OF ROCKFORD PLANS FOR PROPOSED FEDERAL AID HIGHWAY

**FAU ROUTE 5141
FAIRVIEW BOULEVARD
OVER KEITH CREEK
SECTION 10-00573-00-BR
BRIDGE SUPERSTRUCTURE REPLACEMENT
PROJECT NO. BHM-5099 (106)
EXIST. S.N. 101-6060
WINNEBAGO COUNTY
C-92-102-11**



LOCATION OF SECTION INDICATED THIS: [Symbol]

STRUCTURE INFORMATION:

EXISTING SN# 101-6060:
THE EXISTING STRUCTURE BUILT IN 1955 CONSISTS OF A TWO SPAN CONTINUOUS REINFORCED CONCRETE SLAB SUPERSTRUCTURE WITH AN OUT-TO-OUT WIDTH OF 66'-0" AND A TOTAL LENGTH OF 60'-7" BK. TO BK. ABUTMENTS WITH A 30°3'45" SKEW. SUPERSTRUCTURE TO BE REMOVED AS SHOWN.
PROPOSED WORK INCLUDES PLACING A NEW REINFORCED CONCRETE SLAB SUPERSTRUCTURE AS SHOWN.

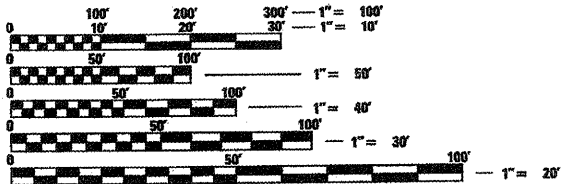

FULL SIZE PLANS HAVE BEEN PREPARED USING STANDARD ENGINEERING SCALES. REDUCED SIZED PLANS WILL NOT CONFORM TO STANDARD SCALES. IN MAKING MEASUREMENTS ON REDUCED PLANS, THE ABOVE SCALES MAY BE USED.

J.U.L.I.E.
JOINT UTILITY LOCATION INFORMATION FOR EXCAVATION
1-800-392-0123



1330 E. STATE STREET, SUITE 4 | ROCKFORD, ILLINOIS 61104
Phone: 815.968.7986 | Toll Free: 800.728.7805 | Fax: 815.968.9256 | HRGreen.com
ILLINOIS PROFESSIONAL DESIGN FIRM #184-001322

PROJECT ENGINEER: KEVIN M. ARFT, P.E.
PROJECT MANAGER: ROBERT G. DAVIES, S.E., P.E.

CONTRACT NO. 85540

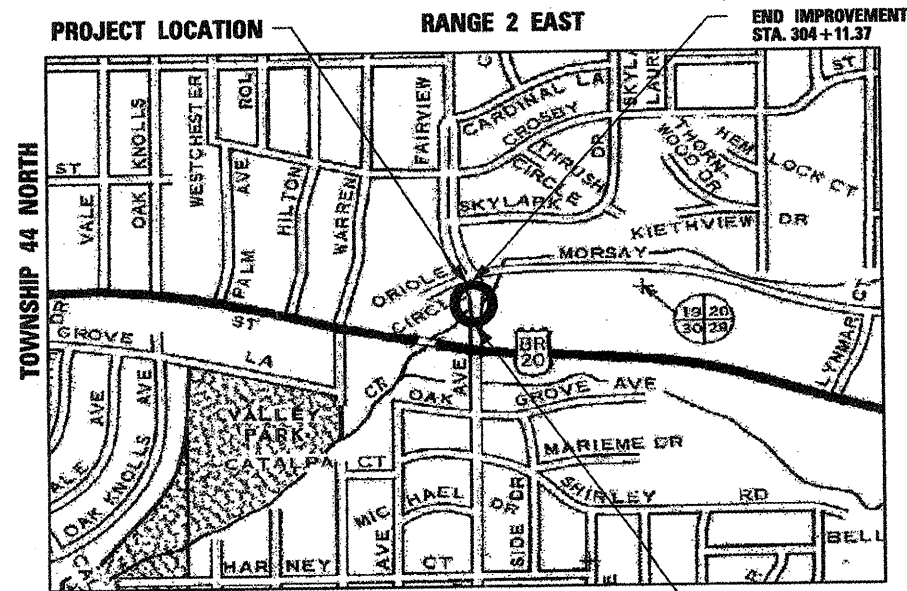

ROCKFORD TOWNSHIP
GROSS LENGTH OF IMPROVEMENT = 160.37 FT. = 0.030 MILES
NET LENGTH OF IMPROVEMENT = 160.37 FT. = 0.030 MILES

FUNCTIONAL CLASSIFICATION
ARTERIAL (URBAN)

DESIGN SPEED
FAIRVIEW BOULEVARD: 30 MPH

SPEED LIMIT
FAIRVIEW BOULEVARD: 30 MPH

TRAFFIC DATA:
FAIRVIEW BOULEVARD:
ADT = 9,200 (2011)
ADT = 12,350 (2030)
9% TRUCKS

**PRINTED BY THE AUTHORITY
OF THE STATE OF ILLINOIS**

CITY OF ROCKFORD

APPROVED: 3/29/2011 (DATE)
Kevin M. Arft, P.E.
CITY OF ROCKFORD, CITY ENGINEER

PASSED: April 14, 2011 (DATE)
Robert G. Davies, S.E., P.E.
DISTRICT 2 ENGINEER OF LOCAL ROADS & STREETS

RELEASING FOR BID
BASED ON LIMITED
REVIEW: April 14, 2011 (DATE)
Kevin M. Arft, P.E.
DEPUTY DIRECTOR OF HIGHWAYS, REGION 2 ENGINEER

STRUCTURAL ENGINEER'S SIGN & SEAL

Robert G. Davies
ROBERT G. DAVIES, S.E., P.E.
DATE: 3/25/2011
11/30/2012
EXPIRES



PROFESSIONAL ENGINEER'S SIGN & SEAL

Kevin M. Arft
KEVIN M. ARFT, P.E.
DATE: 3/25/2011
11/30/2011
EXPIRES



FEDERAL AID DESIGN ENGINEER: LAURA CONNOLLY (815) 284-2271