

**ROAD CLOSURE GENERAL NOTES:**

1. THE CONTRACTOR WILL BE ALLOWED TO CLOSE FAIRVIEW BLVD. TO THRU TRAFFIC AT THE LOCATION SHOWN IN ACCORDANCE WITH THE SPECIAL PROVISIONS.
2. THE DETOUR ROUTE SHALL BE POSTED PRIOR TO CLOSING THE ROAD.
3. ALL TRAFFIC CONTROL WORK ASSOCIATED WITH THE ROAD CLOSURE, SIGNING, TEMPORARY FENCING AND BARRICADING SHALL BE INCLUDED IN THE PAY ITEM FOR 'TRAFFIC CONTROL AND PROTECTION, SPECIAL'.
4. THE CONTRATOR SHALL GIVE THE ENGINEER, IDOT AND THE CITY A 72 HOUR NOTICE PRIOR TO PLACING THE ADVANCE NOTICE SIGNS.
5. ADVANCE NOTICE SIGNS, (11), SHALL BE PLACED TWO WEEKS PRIOR TO CLOSING THE ROADWAY.
6. ALL SIGNS SHALL CONFORM TO SPACING REQUIREMENTS SET FORTH IN THE 'MANUAL ON UNIFORM TRAFFIC CONTROL DEVICES FOR STREETS AND HIGHWAYS'.
7. THE CONTRACTOR SHALL MAINTAIN ACCESS TO ADJACENT DRIVEWAYS IN ACCORDANCE WITH THE SPECIAL PROVISIONS. THE EXISTING COMMERCIAL DRIVEWAY AT THE SOUTHEAST CORNER OF THE BRIDGE MAY BE CLOSED AS SHOWN.
8. PROVIDE "SIDEWALK CLOSED" SIGNS AT THE LIMITS OF THE IMPROVEMENTS AND AS SHOWN. (8 SIGNS REQUIRED). COST INCLUDED IN "TRAFFIC CONTROL AND PROTECTION, SPECIAL."
9. IF TEMPORARY CONCRETE BARRIER IS USED TO DELINEATE CONTRACTOR USE AREAS, IT SHALL BE IN ACCORDANCE WITH HIGHWAY STANDARD 704001 AND THE ENDS SHALL BE PROTECTED. THE TEMPORARY CONCRETE BARRIER LAYOUT AND END PROTECTION SHALL BE TO THE SATISFACTION OF THE ENGINEER. THE COST FOR THIS WORK SHALL BE INCLUDED IN THE UNIT BID PRICE FOR "TRAFFIC CONTROL AND PROTECTION, SPECIAL."
10. IF TEMPORARY LANE CLOSURES ARE REQUIRED AFTER THE ROADWAY IS OPEN TO TRAFFIC, THEY SHALL CONFORM TO THE APPLICABLE HIGHWAY STANDARDS AND SPECIAL PROVISIONS TO THE SATISFACTION OF THE ENGINEER. THE COST FOR THIS WORK SHALL BE INCLUDED IN THE UNIT BID PRICE FOR "TRAFFIC CONTROL AND PROTECTION, SPECIAL."
11. AN ADDITIONAL QUANTITY OF UP TO SIX (6) TYPE III BARRICADES IN ADDITION TO THOSE SHOWN ON THIS PLAN AND IN ADDITION TO THOSE REQUIRED IN THE SPECIAL PROVISIONS MAY BE REQUIRED AT THE DISCRETION OF THE ENGINEER. THE ADDITIONAL TYPE III BARRICADES WILL BE PROVIDED AT NO ADDITIONAL COST TO THE CONTRACT.
12. IF REQUIRED, STAGGERED TYPE III BARRICADES SHALL BE IN ACCORDANCE WITH HIGHWAY STANDARD BLR 22-6 TO THE SATISFACTION OF THE ENGINEER.

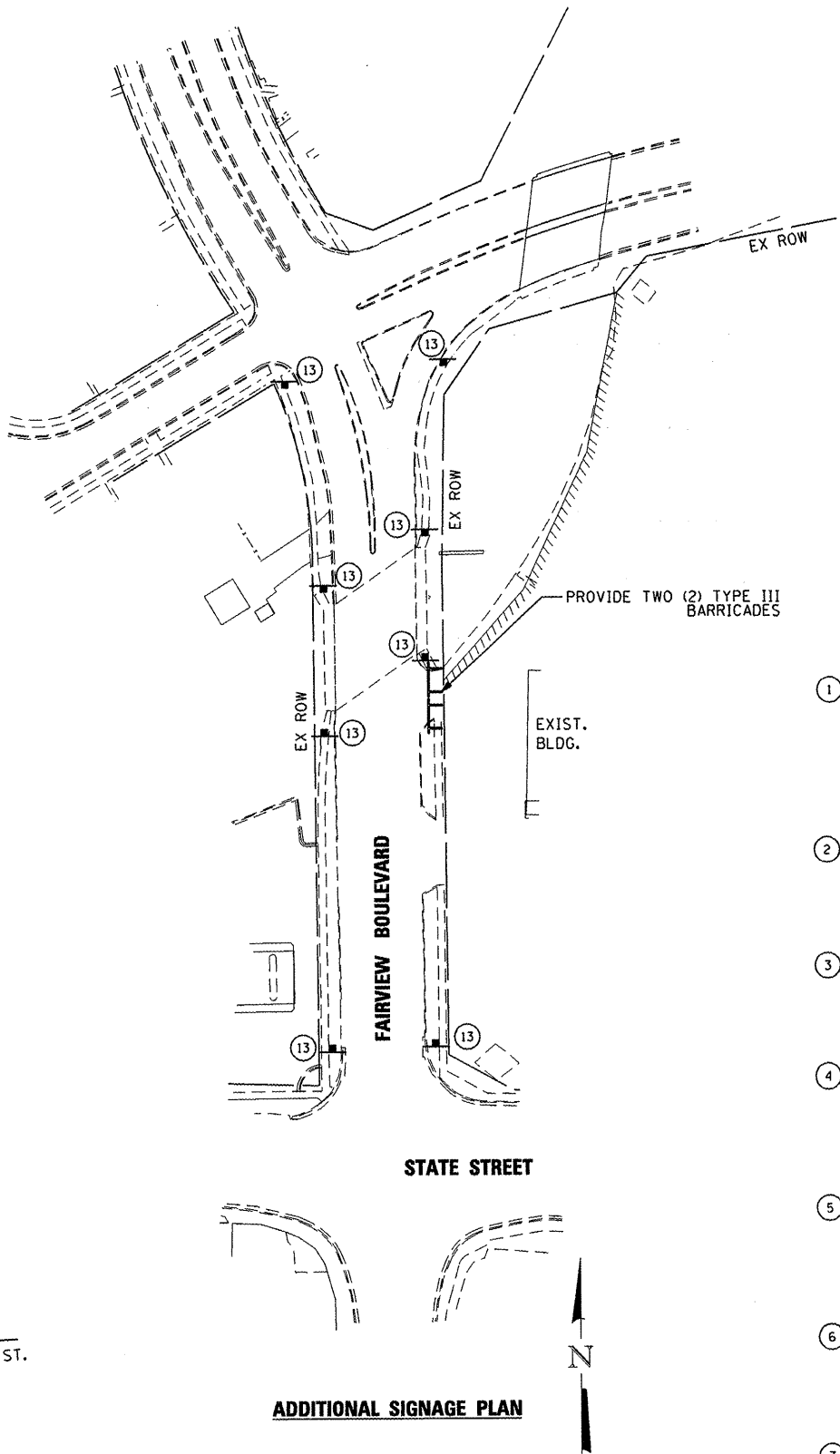
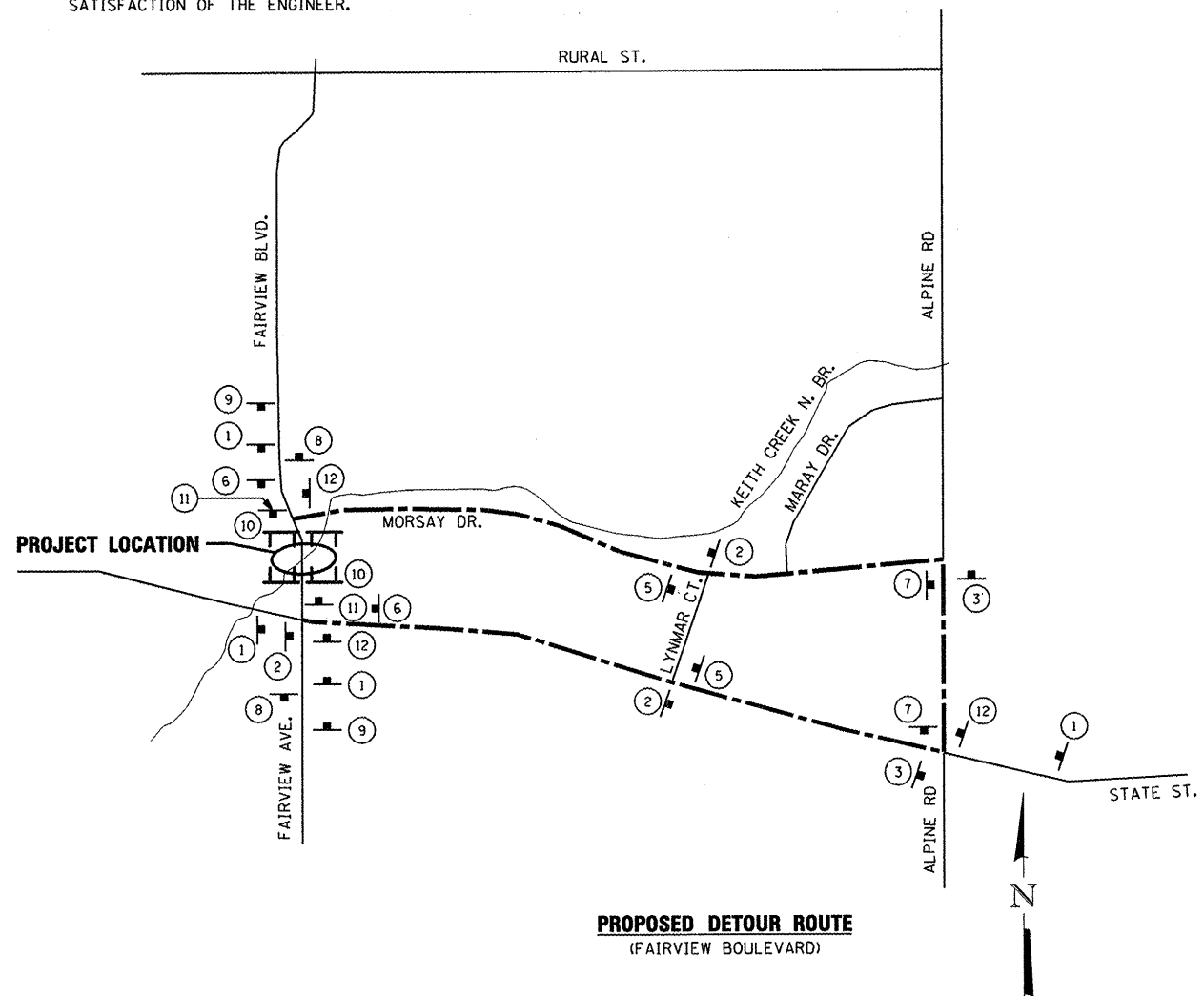

**SIGN LEGEND**

- 1. W20-2 (48"x48") WITH STREET SIGN AND FLASHING AMBER LIGHT
  - 2. M4-9 (30"x24") WITH STREET SIGN AND DIRECTION OF TRAFFIC
  - 3. M4-9L (30"x24") WITH STREET SIGN AND DIRECTION OF TRAFFIC
  - 4. M4-8a (24"x18") WITH STREET SIGN AND INFORMATION SIGN
  - 5. M4-9 (30"x24") WITH STREET SIGN AND DIRECTION OF TRAFFIC
  - 6. M4-9L (30"x24") WITH STREET SIGN AND DIRECTION OF TRAFFIC
  - 7. M4-9R (30"x24") WITH STREET SIGN AND DIRECTION OF TRAFFIC
  - 8. M4-8a (24"x18") WITH STREET SIGN AND INFORMATION SIGN
  - 9. W20-3 (48"x48") WITH FLASHING AMBER LIGHT
  - 10. R11-2 (48"x30") WITH 2 FLASHING AMBER LIGHTS
  - 11. INFO (48"x30") BLACK LETTERING ON ORANGE SIGN PANEL
  - 12. M4-9R (30"x24") WITH STREET SIGN AND DIRECTION OF TRAFFIC
  - 13. R9-9 (24"x12") ON TYPE II BARRICADE
- DETOUR ROUTE

COMPANY NAME: HRGreen.com  
 PROJECT CONTACT: HRGreen.com  
 CLIENT: HRGreen.com  
 FILE NAME: 86100021-Dtr.dgn  
 PLOT DATE: 3/31/2011

**HRGreen.com**  
 Illinois Professional Design Firm  
 #194-001322

USER NAME = Korf	DESIGNED - KMA	REVISED -
FILE NAME = 86100021-Dtr.dgn	DRAWN - WJH	REVISED -
PLOT SCALE = N.T.S.	CHECKED - RGD	REVISED -
PLOT DATE = 3/31/2011	DATE - 3/31/11	REVISED -

**CITY OF ROCKFORD**

**TEMPORARY DETOUR PLAN**  
**FAIRVIEW BOULEVARD OVER KEITH CREEK**

SCALE: N.T.S. SHEET NO. OF SHEETS STA. TO STA.

F.A.U. RTE. 5141	SECTION 10-00573-00-BR	COUNTY WINNEBAGO	TOTAL SHEETS 20	SHEET NO. 5
FED. ROAD DIST. NO. 2 ILLINOIS FED. AID PROJECT				

CONTRACT NO. 85540