

F.A.U. RTE.	SECTION	COUNTY	TOTAL SHEETS	SHEET NO.
5141	10-00573-00-BR	WINNEBAGO	20	1
FED. ROAD DIST. NO. 2	ILLINOIS	CONTRACT NO. 85540		

INDEX OF SHEETS

SHEET NO.	DESCRIPTION
1	COVER SHEET
2	GENERAL NOTES & LIST OF STATE STANDARDS
3	SUMMARY OF QUANTITIES
4	TYPICAL SECTIONS
5	TEMPORARY DETOUR PLAN
6	REMOVAL PLAN
7	PLAN AND PROFILE
8	EROSION CONTROL, STRIPING & RESTORATION PLAN
9-19	BRIDGE PLANS
20	CROSS SECTIONS

STATE STANDARDS

000001-06	STANDARD SYMBOLS, ABBREVIATIONS AND PATTERNS
280001-05	TEMPORARY EROSION CONTROL SYSTEM
424001-05	CURB RAMPS FOR SIDEWALKS
515001-03	NAME PLATE FOR BRIDGES
601101-01	CONCRETE HEADWALL FOR PIPE DRAIN
602001-02	CATCH BASIN TYPE A
604006-04	FRAME AND GRATE TYPE 3
606001-04	CONCRETE CURB TYPE B AND COMBINATION CONCRETE CURB AND GUTTER
606301-04	PC CONCRETE ISLANDS AND MEDIANS
701101-02	OFF-RD OPERATIONS, MULTILANE, 15' (4.5M) TO 24" (600MM) FROM PAVEMENT EDGE
701427	LANE CLOSURE, MULTILANE, INTERMITTENT OR MOVING OPER., FOR SPEEDS ≤ 40 MPH
701501-06	URBAN LANE CLOSURE, 2L 2W, UNDIVIDED
701606-07	URBAN LANE CLOSURE, MULTILANE, 2W WITH MOUNTABLE MEDIAN
701801-04	LANE CLOSURE MULTILANE 1W OR 2W CROSSWALK OR SIDEWALK CLOSURE
701901-01	TRAFFIC CONTROL DEVICES
728001-01	TELESCOPING STEEL SIGN SUPPORT
729001-01	TELESCOPING STEEL SIGN SUPPORT
780001-02	APPLICATIONS OF TYPES A & B METAL POSTS (FOR SIGNS & MARKERS)
BLR 21-8	TYPICAL APPLICATION OF TRAFFIC CONTROL DEVICES FOR CONSTRUCTION ON RURAL LOCAL HIGHWAYS

CITY OF ROCKFORD PLANS FOR PROPOSED FEDERAL AID HIGHWAY

**FAU ROUTE 5141
FAIRVIEW BOULEVARD
OVER KEITH CREEK
SECTION 10-00573-00-BR
BRIDGE SUPERSTRUCTURE REPLACEMENT
PROJECT NO. BHM-5099 (106)
EXIST. S.N. 101-6060
WINNEBAGO COUNTY
C-92-102-11**

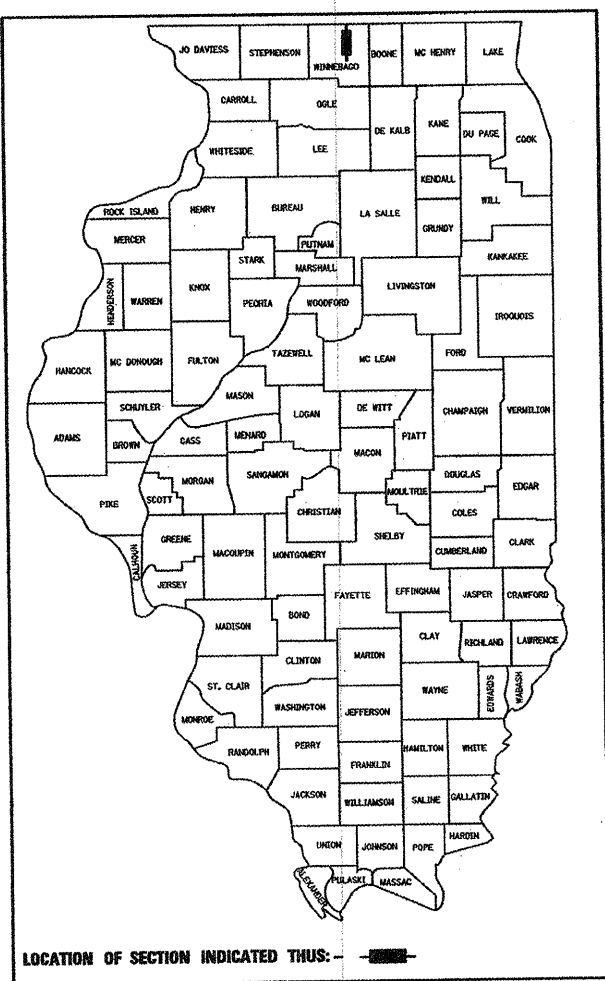

STRUCTURE INFORMATION:
EXISTING SN# 101-6060:
THE EXISTING STRUCTURE BUILT IN 1955 CONSISTS OF A TWO SPAN CONTINUOUS REINFORCED CONCRETE SLAB SUPERSTRUCTURE WITH AN OUT-TO-OUT WIDTH OF 66'-0" AND A TOTAL LENGTH OF 60'-7" BK. TO BK. ABUTMENTS WITH A 30°3'45" SKEW. SUPERSTRUCTURE TO BE REMOVED AS SHOWN.
PROPOSED WORK INCLUDES PLACING A NEW REINFORCED CONCRETE SLAB SUPERSTRUCTURE AS SHOWN.

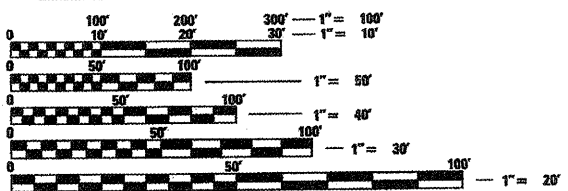

FULL SIZE PLANS HAVE BEEN PREPARED USING STANDARD ENGINEERING SCALES. REDUCED SIZED PLANS WILL NOT CONFORM TO STANDARD SCALES. IN MAKING MEASUREMENTS ON REDUCED PLANS, THE ABOVE SCALES MAY BE USED.

J.U.L.I.E.
JOINT UTILITY LOCATION INFORMATION FOR EXCAVATION
1-800-392-0123

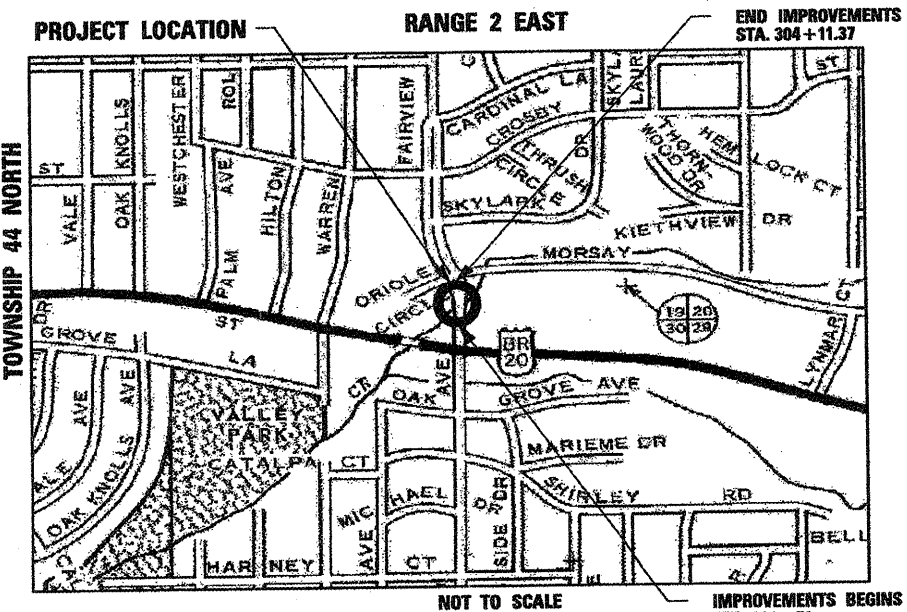

ROCKFORD TOWNSHIP
GROSS LENGTH OF IMPROVEMENT = 160.37 FT. = 0.030 MILES
NET LENGTH OF IMPROVEMENT = 160.37 FT. = 0.030 MILES

FUNCTIONAL CLASSIFICATION
ARTERIAL (URBAN)

DESIGN SPEED
FAIRVIEW BOULEVARD: 30 MPH

SPEED LIMIT
FAIRVIEW BOULEVARD: 30 MPH

TRAFFIC DATA:
FAIRVIEW BOULEVARD:
ADT = 9,200 (2011)
ADT = 12,350 (2030)
9% TRUCKS

**PRINTED BY THE AUTHORITY
OF THE STATE OF ILLINOIS**

CITY OF ROCKFORD

APPROVED: 3/29/2011 (DATE)
Kevin M. Arft, P.E.
CITY OF ROCKFORD, CITY ENGINEER

PASSED: April 14, 2011 (DATE)
[Signature]
DISTRICT 2 ENGINEER OF LOCAL ROADS & STREETS

RELEASING FOR BID
BASED ON LIMITED
REVIEW: April 14, 2011 (DATE)
[Signature]
DEPUTY DIRECTOR OF HIGHWAYS, REGION 2 ENGINEER

FEDERAL AID DESIGN ENGINEER: LAURA CONNOLLY (815) 284-2271



1330 E. STATE STREET, SUITE 4 | ROCKFORD, ILLINOIS 61104
Phone: 815.968.7986 | Toll Free: 800.728.7805 | Fax: 815.968.9256 | HRGreen.com
ILLINOIS PROFESSIONAL DESIGN FIRM #184-001322

PROJECT ENGINEER: KEVIN M. ARFT, P.E.
PROJECT MANAGER: ROBERT G. DAVIES, S.E., P.E.

CONTRACT NO. 85540

STRUCTURAL ENGINEER'S SIGN & SEAL

Robert G. Davies
ROBERT G. DAVIES, S.E., P.E.
DATE: 3/25/2011
EXPIRES: 11/30/2012

PROFESSIONAL ENGINEER'S SIGN & SEAL

Kevin M. Arft
KEVIN M. ARFT, P.E.
DATE: 2/25/2011
EXPIRES: 11/30/2011

GENERAL NOTES

- REMOVAL AND DISPOSAL OF UNSUITABLE MATERIAL, AND POROUS GRANULAR EMBANKMENT SUBGRADE HAS BEEN ADDED FOR USE IF UNSUITABLE MATERIAL IS ENCOUNTERED IN THE FIELD, AS DETERMINED BY THE ENGINEER. IF UNSUITABLE AND/OR UNSTABLE MATERIAL IS NOT ENCOUNTERED, THEN THE QUANTITY SHALL BE DEDUCTED AND NO COMPENSATION WILL BE DUE THE CONTRACTOR.
- FORTY EIGHT HOURS BEFORE STARTING EXCAVATION THE CONTRACTOR WILL CALL J.U.L.I.E. (1-800-892-0123) TO HAVE THE LOCATION OF EXISTING UTILITIES STAKED.
- THE CONTRACTOR SHALL CONTACT THE CITY OF ROCKFORD AT LEAST 72 HOURS IN ADVANCE OF BEGINNING ANY WORK ON FAIRVIEW BOULEVARD.
- THE CONTRACTOR WILL NOT BE ALLOWED TO SET UP A YARD OR FIELD OFFICE ON CITY PROPERTY WITHOUT WRITTEN PERMISSION FROM THE CITY OF ROCKFORD.
- PRIOR TO COMMENCEMENT OF CONSTRUCTION, THE CONTRACTOR SHALL VERIFY ALL DIMENSIONS AND CONDITIONS AFFECTING THEIR WORK WITH THE ACTUAL CONDITIONS AT THE JOB SITE. IN ADDITION, THE CONTRACTOR MUST VERIFY THE ENGINEER'S LINE AND GRADE STAKES. IF THERE ARE ANY DISCREPANCIES FROM WHAT IS SHOWN ON THE CONSTRUCTION PLANS, HE MUST IMMEDIATELY REPORT SAME TO THE ENGINEER BEFORE DOING ANY WORK, OTHERWISE THE CONTRACTOR ASSUMES FULL RESPONSIBILITY. IN THE EVENT OF DISAGREEMENT BETWEEN THE CONSTRUCTION PLANS, STANDARD SPECIFICATIONS AND/OR SPECIAL DETAILS, THE CONTRACTOR SHALL SECURE WRITTEN INSTRUCTIONS FROM THE ENGINEER PRIOR TO PROCEEDING WITH ANY PART OF THE WORK AFFECTED BY OMISSIONS OR DISCREPANCIES. FAILING TO SECURE SUCH INSTRUCTIONS, THE CONTRACTOR WILL BE CONSIDERED TO HAVE PROCEEDED AT HIS OWN RISK AND EXPENSE. IN THE EVENT OF ANY DOUBT OR QUESTION ARISING WITH RESPECT TO THE TRUE MEANING OF THE CONSTRUCTION PLANS OR SPECIFICATIONS, THE DECISION OF THE ENGINEER SHALL BE FINAL AND CONCLUSIVE.
- THE WORK UNDER THIS CONTRACT SHALL CONFORM TO ALL REGULATIONS GIVEN IN THE ARMY CORPS OF ENGINEERS PERMIT ISSUED FOR THE PROJECT.
- THE CONTRACTOR SHALL PROVIDE ACCESS TO ALL ABUTTING PROPERTY AT ALL TIMES DURING THE CONSTRUCTION OF THIS PROJECT, EXCEPT FOR PERIODS OF SHORT DURATION AS DETERMINED BY THE ENGINEER.
- EXCEPT AS NOTED ON THE PLANS, PAVEMENT GRADES SHOWN ARE AT THE TOP OF PAVEMENT SURFACES.
- OFFSET LOCATIONS GIVEN IN THE PLANS FOR STRUCTURES, EDGE OF PAVEMENT, ETC. ARE FROM THE ROADWAY CENTERLINE UNLESS NOTED OTHERWISE.
- ALL ELEVATIONS REFERRING TO U.S.G.S. MEAN SEA LEVEL DATUM.
- THE EXISTING BRIDGE DESIGN PLANS ARE AVAILABLE FOR REVIEW AT THE CITY OF ROCKFORD.

12. THE LOCATION OF EXISTING DRAINAGE STRUCTURES, STORM SEWERS, WATER MAINS, SANITARY SEWERS, AND ANY OTHER PUBLIC OR PRIVATE UTILITIES AS SHOWN ON THE PLANS IS APPROXIMATE AND THEIR EXACT LOCATION IS TO BE DETERMINED IN THE FIELD BY THE CONTRACTOR. THIS WORK SHALL BE CONSIDERED AS INCLUDED IN THE UNIT BID PRICES OF THE CONTRACT, AND NO ADDITIONAL COMPENSATION WILL BE ALLOWED.

13. THE CONTRACTOR SHALL BE RESPONSIBLE FOR THE PROTECTION OF ALL UNDERGROUND AND SURFACE UTILITIES EVEN THOUGH THEY MIGHT NOT BE SHOWN ON THE PLANS. ANY UTILITY PROPERTY DAMAGED DURING CONSTRUCTION SHALL BE REPAIRED OR REPLACED TO THE SATISFACTION OF THE OWNER AT THE CONTRACTOR'S EXPENSE.

14. ANY LOOSE MATERIAL DEPOSITED IN THE FLOWLINES OF DRAINAGE STRUCTURES WHICH OBSTRUCT THE NATURAL FLOW OF WATER SHALL BE REMOVED AT THE CLOSE OF EACH WORKING DAY. PRIOR TO ACCEPTANCE OF THE IMPROVEMENT, ALL DRAINAGE STRUCTURES SHALL BE FREE OF DIRT AND DEBRIS. THIS WORK SHALL NOT BE PAID FOR SEPARATELY BUT SHALL BE CONSIDERED AS INCLUDED IN THE UNIT BID PRICES OF THE CONTRACT.

15. WHERE NEW WORK MEETS EXISTING FEATURES TO REMAIN, THE CONTRACTOR SHALL FIELD CHECK ALL DIMENSIONS AND ELEVATIONS PRIOR TO PROCEEDING WITH CONSTRUCTION AND NOTIFY THE ENGINEER IMMEDIATELY OF ANY DISCREPANCIES.

16. SEEDING WILL NOT BE PERMITTED AT ANY TIME WHEN THE GROUND IS FROZEN, WET, OR IN AN UNTILLABLE CONDITION. LOCATIONS TO BE SEEDED WILL BE DETERMINED BY THE ENGINEER. SEE ARTICLE 250.06 OF THE STANDARD SPECIFICATIONS.

17. SAW CUTTING WILL BE REQUIRED FOR ALL REMOVAL ITEMS LISTED IN SECTION 440 OF THE STANDARD SPECIFICATIONS, SHOWN IN THE PLANS, AND AS DIRECTED BY THE ENGINEER. THE COST OF SAW CUTTING WILL BE INCLUDED IN CONTRACT UNIT BID PRICES FOR THE ITEMS BEING REMOVED.

SYMBOL LEGEND

	EXISTING	PROPOSED
SANITARY MANHOLE	⊙	⊙
STORM MANHOLE	⊙	⊙
STORM CATCH BASIN	□	●
INLET	□	■
FLARED END SECTION	▽	▶
VALVE VAULT	⊙	⊙
FIRE HYDRANT	⊙	⊙
LIGHT POLE	*	*
STREET SIGN	+	+
REGULATORY SIGN	+	+
UTILITY POLE	⊙	⊙
UTILITY BOX	⊙	⊙
MAILBOX	⊙	⊙
WELL	⊙	⊙
SANITARY SEWER	—	—
STORM SEWER	—	—
CULVERT	-----	=====
WATER MAIN	—	—
WATER MAIN ENCASEMENT	—	-----
STORM UNDERDRAIN	—	—
ELECTRIC LINE	—	—
TELEPHONE LINE	—	—
GAS LINE	—	—
CABLE TV LINE	—	—
TREELINE	⊙	⊙
TREE	⊙	⊙
FENCE	—	—
EROSION CONTROL FENCE	—	—
DITCH CHECK	—	—
DRAINAGE ARROW	—	—
100 YEAR OVERFLOW	—	—

UTILITY CONTACTS

CITY OF ROCKFORD WATER DIVISION	GREG CASSARO	(815) 987-3084
ROCK RIVER WATER RECLAMATION DISTRICT	MIKE OLSON	(815) 387-7663
KENTUCKY DATA LINK	JIM KOSTUCH	(262) 792-7938
COMCAST	MICHAEL OWENS	(815) 509-7876
COMED	MIKE LENOX	(815) 490-2869
AT&T	STEVEN JONES	(815) 394-7270
NICOR	CHRIS WINTERS	(815) 455-0271

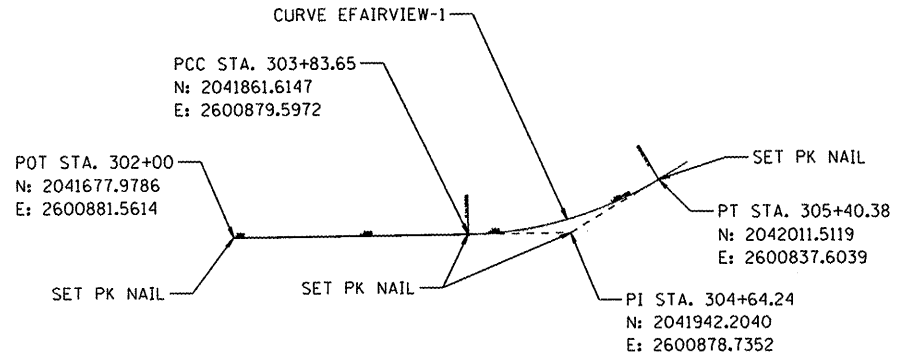

ALIGNMENT DETAIL
SEE PLAN AND PROFILE FOR ADDITIONAL CURVE INFORMATION

EXIST. CURVE EFAIRVIEW-1
 P.I. STA. = 304+64.24
 $\Delta = 30^\circ 04' 28''$ (LT)
 $D = 19^\circ 11' 17''$
 $R = 300.00'$
 $T = 80.59'$
 $L = 156.73'$
 $E = 10.64'$
 $\theta = \text{-----}$
 $T.R. = \text{-----}$
 $S.E. RUN = \text{-----}$
 P.C. STA. = 303+83.65
 P.T. STA. = 305+40.38

STANDARD ABBREVIATIONS

- B-B - BACK TO BACK OF CURB
- B.C. - BACK OF CURB
- B.O.C. - BACK OF CURB
- B.S.L. - BUILDING SETBACK LINE
- C.B. - STORM CATCH BASIN
- C.E. - COMMONWEALTH EDISON CO.
- D.E. - DRAINAGE EASEMENT
- E-E - EDGE TO EDGE OF PAVEMENT
- E.O.P. - EDGE OF PAVEMENT
- E.O.S. - EDGE OF SHOULDER
- E.P. - EDGE OF PAVEMENT
- E.S. - EDGE OF SHOULDER
- F.E.S. - FLARED END SECTION
- I.B.T. - ILLINOIS BELL TELEPHONE CO.
- L.E. - LANDSCAPE EASEMENT
- M.H. - MANHOLE (TYPE SPECIFIED ON PLANS)
- R.O.W. - RIGHT OF WAY
- T.B.F. - TRENCH BACKFILL
- T.C. - TOP OF CURB
- T.C.E. - TEMPORARY CONSTRUCTION EASEMENT
- T.O.B. - TOP OF BERM
- T.O.C. - TOP OF CURB
- U.E. - UTILITY EASEMENT

COMPANY NAME: HRGreen.com
 PROJECT CONTACT: HRGreen.com
 CLIENT: HRGreen.com
 DATE PLOTTED: 3/31/2011 12:06:56 AM
 PLOT DRIVER: hrplotter-hrmod1.dgn
 PEN TABLE: STYCPLOT 22x34.tbl

SUMMARY OF QUANTITIES			URBAN	CONSTRUCTION TYPE CODE
PAY ITEM NUMBER	PAY ITEMS	UNITS	TOTAL QUANTITY	0014
△ 20201200	REMOVAL AND DISPOSAL OF UNSUITABLE MATERIAL	CU YD	230	230
20800150	TRENCH BACKFILL	CU YD	14	14
21101615	TOPSOIL FURNISH AND PLACE, 4"	SO YD	55	55
25000210	SEEDING, CLASS 2A	ACRE	0.1	0.1
25000400	NITROGEN FERTILIZER NUTRIENT	POUND	1	1
25000500	PHOSPHORUS FERTILIZER NUTRIENT	POUND	1	1
25000600	POTASSIUM FERTILIZER NUTRIENT	POUND	1	1
25100630	EROSION CONTROL BLANKET	SO YD	110	110
28000250	TEMPORARY EROSION CONTROL SEEDING	POUND	5	5
28000400	PERIMETER EROSION BARRIER	FOOT	57	57
28000500	INLET AND PIPE PROTECTION	EACH	7	7
28100109	STONE RIPRAP, CLASS A5	SO YD	495	495
28200200	FILTER FABRIC	SO YD	495	495
31101200	SUB-BASE GRANULAR MATERIAL, TYPE B 4"	SO YD	680	680
35501316	HOT-MIX ASPHALT BASE COURSE, 8"	SO YD	580	580
40600100	BITUMINOUS MATERIALS (PRIME COAT)	GALLON	120	120
△ 40603085	HOT-MIX ASPHALT BINDER COURSE, IL-19.0, N70	TON	85	85
△ 40603340	HOT-MIX ASPHALT SURFACE COURSE, MIX "D", N70	TON	50	50
42300200	PORTLAND CEMENT CONCRETE DRIVEWAY PAVEMENT, 6 INCH	SO YD	25	25
42400200	PORTLAND CEMENT CONCRETE SIDEWALK 5 INCH	SO FT	1,265	1,265
42400800	DETECTABLE WARNINGS	SO FT	20	20
44000100	PAVEMENT REMOVAL	SO YD	615	615
44000200	DRIVEWAY PAVEMENT REMOVAL	SO YD	25	25.0
44000500	COMBINATION CURB AND GUTTER REMOVAL	FOOT	237	237
44000600	SIDEWALK REMOVAL	SO FT	851	851
50101500	REMOVAL OF EXISTING SUPERSTRUCTURES	EACH	1	1
50300255	CONCRETE SUPERSTRUCTURE	CU YD	240.4	240.4
50300260	BRIDGE DECK GROOVING	SO YD	317	317
50300300	PROTECTIVE COAT	SO YD	459	459
50800205	REINFORCEMENT BARS, EPOXY COATED	POUNDS	48,590	48,590
* 50901750	PARAPET RAILING	FOOT	113	113
51500100	NAME PLATES	EACH	1	1
52100010	ELASTOMERIC BEARING ASSEMBLY, TYPE I	EACH	24	24
59000200	EPOXY CRACK INJECTION	FOOT	221	221
60200305	CATCH BASINS, TYPE A, 4'-DIAMETER, TYPE 3 FRAME AND GRATE	EACH	1	1
60235700	INLETS, TYPE A, TYPE 3 FRAME AND GRATE	EACH	1	1
60604400	COMBINATION CONCRETE CURB AND GUTTER, TYPE B - 6.18	FOOT	170	170
67000400	ENGINEER'S FIELD OFFICE, TYPE A	CAL MO	4	4
67100100	MOBILIZATION	L SUM	1	1
70106800	CHANGEABLE MESSAGE SIGN	CAL MO	16	16
70300220	TEMPORARY PAVEMENT MARKING - LINE 4"	FOOT	2,440	2,440
70300260	TEMPORARY PAVEMENT MARKING - LINE 12"	FOOT	80	80
* 78005110	EPOXY PAVEMENT MARKING - LINE 4"	FOOT	610	610
* 78005150	EPOXY PAVEMENT MARKING - LINE 12"	FOOT	20	20
△ X2070304	POROUS GRANULAR EMBANKMENT, SPECIAL	CU YD	15.8	15.8
△ X4021000	TEMPORARY ACCESS (PRIVATE ENTRANCE)	EACH	1	1
* X5091755	PARAPET RAILING, SPECIAL	FOOT	59.0	59.0
△ X6061900	CONCRETE MEDIAN, TYPE SB-6.12 (SPECIAL)	SO FT	200.0	200.0
△ X7010216	TRAFFIC CONTROL AND PROTECTION, SPECIAL	L SUM	1.0	1.0
△ Z0012754	STRUCTURAL REPAIR OF CONCRETE (DEPTH EQUAL TO OR LESS THAN 5 INCHES)	SO FT	170.0	170.0
△ Z0013798	CONSTRUCTION LAYOUT	L SUM	1.0	1.0
△ Z0021904	SILICONE JOINT SEALER, 1"	FOOT	155.0	155.0
△ Z0042002	POROUS GRANULAR EMBANKMENT, SUBGRADE	CU YD	226.0	226.0
△ Z0056648	STORM SEWERS, TYPE 1, WATER MAIN QUALITY PIPE, 12 INCH	FOOT	66.0	66.0

* SPECIAL TY ITEM
 △ SPECIAL PROVISION PROVIDED

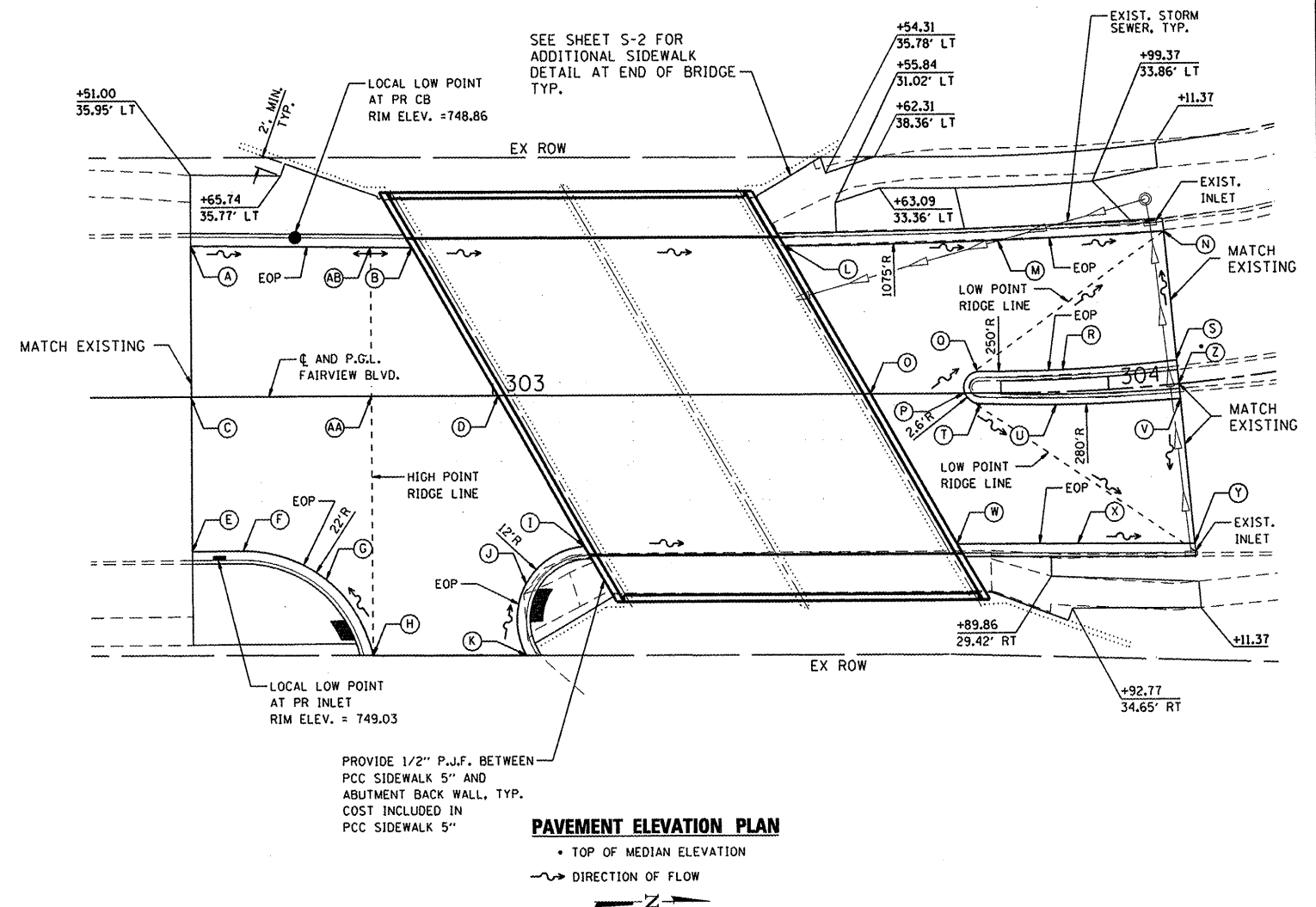

POINT	STATION	OFFSET (FT)	ELEVATION
A	302+51.00	24.36 LT	748.88
B	302+86.93	24.00 LT	749.01
C	302+51.00	0.00 LT	749.37
D	303+00.82	0.00 LT	749.30
E	302+51.00	24.59 RT	749.05
F	302+59.28	24.58 RT	749.01
G	302+72.74	29.29 RT	749.25
H	302+80.29	41.39 RT	749.48
I	303+14.73	24.00 RT	748.87
J	303+05.17	30.13 RT	749.15
K	303+05.11	41.47 RT	749.42
L	303+47.51	24.00 LT	748.70
M	303+78.35	24.58 LT	748.43
N	304+11.37	24.86 LT	748.14

POINT	STATION	OFFSET (FT)	ELEVATION
O	303+61.40	0.00 LT	748.99
P	303+76.73	0.00 LT	748.92
Q	303+79.21	3.53 LT	748.85
R	303+95.27	3.61 LT	748.90
S	304+11.37	3.89 LT	749.22
T	303+79.13	1.66 RT	748.88
U	303+95.28	2.06 RT	748.92
V	304+11.37	2.35 RT	749.12
W	303+75.29	24.00 RT	748.56
X	303+93.98	24.28 RT	748.34
Y	304+11.37	25.57 RT	748.13
Z	304+11.37	0.00 LT	749.58
AA	302+80.00	0.00 LT	749.40
AB	302+80.00	24.06 LT	749.04

PAVEMENT ELEVATION TABLE
 OFFSETS ARE BASED ON ϵ ROADWAY

COMPANY NAME: HRGreen.com
 PROJECT CONTACT: WJH
 CLIENT: HRGreen.com
 DATE PLOTTED: 3/31/2011 12:56:02 AM
 FILE NAME: 86100021-Soq.dgn
 PLOT SCALE: N.T.S.
 PEN TABLE: 3/11/2011 22:54:41



USER NAME: Kof	DESIGNED: KMA	REVISED:
FILE NAME: 86100021-Soq.dgn	DRAWN: WJH	REVISED:
PLOT SCALE: N.T.S.	CHECKED: RGD	REVISED:
PLOT DATE: 3/31/2011	DATE: 3/31/11	REVISED:

CITY OF ROCKFORD

SUMMARY OF QUANTITIES			
FAIRVIEW BOULEVARD OVER KEITH CREEK			
SCALE: N.T.S.	SHEET NO.	OF SHEETS	STA. TO STA.

F.A.U. RTE.	SECTION	COUNTY	TOTAL SHEETS	SHEET NO.
5141	10-00573-00-BR	WINNEBAGO	20	3
CONTRACT NO. 85540				
FED. ROAD DIST. NO. 2 (ILLINOIS) FED. AID PROJECT				

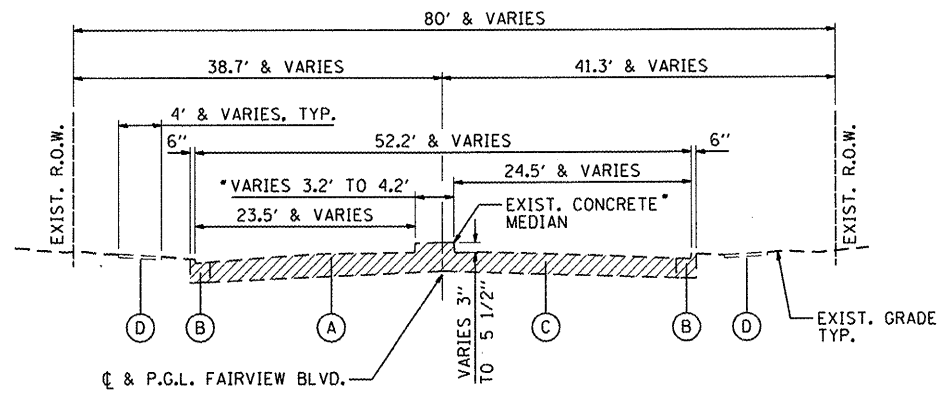

**EXISTING APPROACH ROADWAY
TYPICAL SECTION**

STA. 302+51.00 TO STA. 303+00.82
 STA. 303+61.40 TO STA. 304+11.37
 • STA. 303+76.55 TO 304+11.37

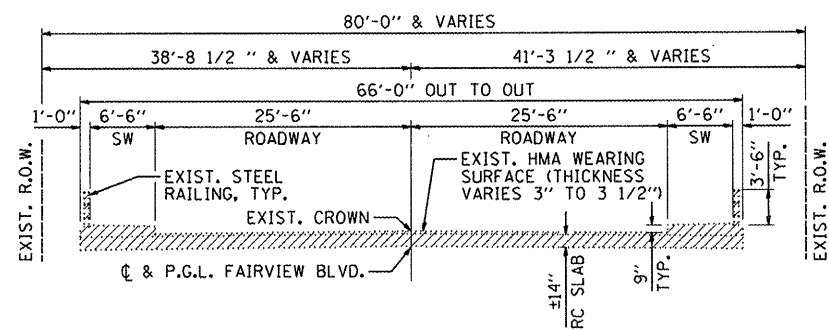

**EXISTING BRIDGE
TYPICAL SECTION**

COST FOR REMOVAL OF EXISTING STEEL RAILING, HMA WEARING SURFACE AND REINFORCED CONCRETE SLAB INCLUDED IN UNIT PRICE BID FOR "REMOVAL OF EXISTING SUPERSTRUCTURES."

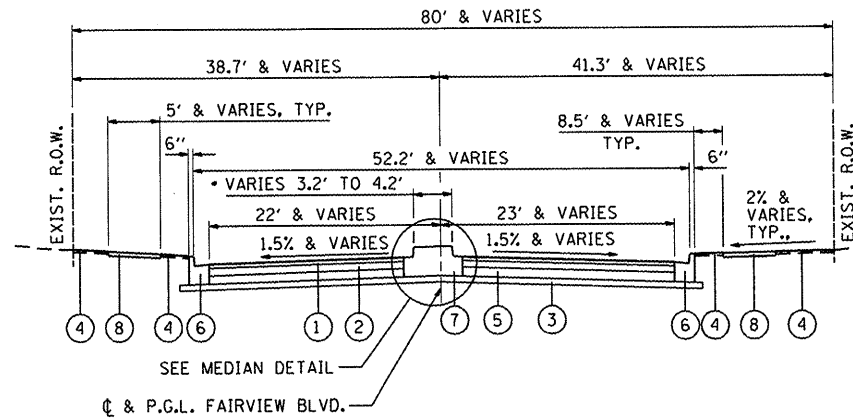

**PROPOSED ROADWAY
TYPICAL SECTION**

STA. 303+76.73 TO 304+11.37

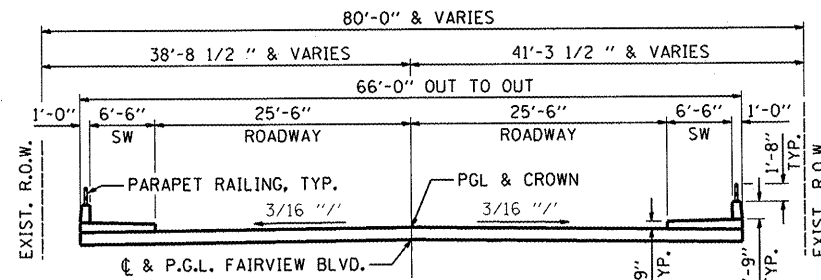

**PROPOSED BRIDGE
TYPICAL SECTION**

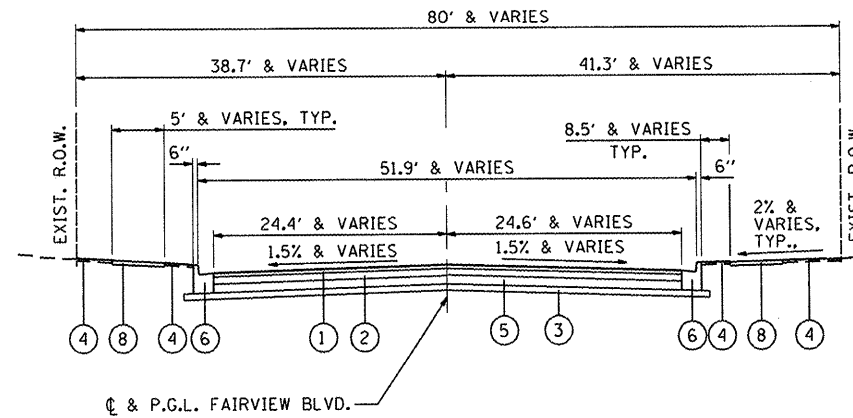

**PROPOSED ROADWAY
TYPICAL SECTION**

STA. 302+51.00 TO 303+00.82
 STA. 303+61.40 TO 303+76.73

NOTES

1. COST FOR REMOVAL INCLUDED IN THE ITEM REMOVAL OF EXISTING SUPERSTRUCTURE
2. SEE PAVEMENT ELEVATION DETAIL ON SHEET 3 AND THE CROSS SECTIONS.
3. SOUTH APPROACH ONLY
4. SEE STRIPING, EROSION CONTROL & RESTORATION PLAN FOR LIMITS
5. SEE CROSS SECTIONS

EXISTING LEGEND

- (A) EXIST. HMA SURFACE (THICKNESS VARIES 2" TO 3")
- (B) EXIST. COMB. CC&G TB6.18
- (C) EXIST. CONCRETE BASE (THICKNESS VARIES 6" TO 7")
- (D) EXIST. PCC SIDEWALK

PROPOSED LEGEND

- (1) HOT-MIX ASPHALT SURFACE COURSE MIX "D" N70 @ 1 1/2"
- (2) HOT-MIX ASPHALT BINDER COURSE IL - 19.0, N70 @ 2 1/2"
- (3) SUBBASE GRANULAR MATERIAL, TYPE B 4"
- (4) TOPSOIL FURNISH & PLACE 4" WITH SEEDING CLASS 2A
- (5) HOT MIX ASPHALT BASE COURSE, 8"
- (6) COMBINATION CONCRETE CURB AND GUTTER, TYPE B-6.18
- (7) CONCRETE MEDIAN, TYPE SB-6.12 (SPECIAL)
- (8) PORTLAND CEMENT CONCRETE SIDEWALK, 5"

INDICATES ITEMS TO BE REMOVED

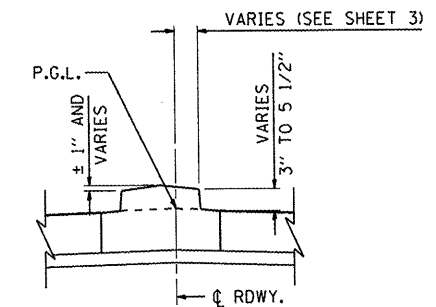

MEDIAN DETAIL

HOT-MIX ASPHALT MIXTURE REQUIREMENTS		
MIXTURE USE	SURFACE	BINDER
PG:	PG 64-22	PG 64-22
DESIGN AIR VOIDS	4.0 @ N70	4.0 @ N70
MIXTURE COMPOSITION (GRADIATION MIXTURE)	IL 9.5 OR 12.5	IL 19.0
FRICTION AGGREGATE	D	N/A
20 YEAR ESAL	6.0	6.0
MIX UNIT WEIGHT	112 LBS/SY/IN	

COMPANY NAME: HRGreen.com
 PROJECT CONTACT: Korf
 CLIENT: CITY OF ROCKFORD
 DATE: 3/25/08 AM
 FILE NAME: 86100021-1.dgn
 PLOT DRIVER: pdefeat
 PEN TABLE: Struct 22x34.tbl



USER NAME = Korf	DESIGNED - KMA	REVISED -
FILE NAME = 86100021-1.dgn	DRAWN - WJH	REVISED -
PLOT SCALE = N.T.S.	CHECKED - RGD	REVISED -
PLOT DATE = 3/31/2011	DATE - 3/31/11	REVISED -

CITY OF ROCKFORD

TYPICAL SECTIONS FAIRVIEW BOULEVARD OVER KEITH CREEK			
SCALE: N.T.S.	SHEET NO. OF SHEETS	STA. TO STA.	F.A.U. RTE. SECTION COUNTY TOTAL SHEETS SHEET NO.
			5141 10-00573-00-BR WINNEBAGO 20 4
			CONTRACT NO. 85540
FED. ROAD DIST. NO. 2 ILLINOIS FED. AID PROJECT			

ROAD CLOSURE GENERAL NOTES:

1. THE CONTRACTOR WILL BE ALLOWED TO CLOSE FAIRVIEW BLVD. TO THRU TRAFFIC AT THE LOCATION SHOWN IN ACCORDANCE WITH THE SPECIAL PROVISIONS.
2. THE DETOUR ROUTE SHALL BE POSTED PRIOR TO CLOSING THE ROAD.
3. ALL TRAFFIC CONTROL WORK ASSOCIATED WITH THE ROAD CLOSURE, SIGNING, TEMPORARY FENCING AND BARRICADING SHALL BE INCLUDED IN THE PAY ITEM FOR 'TRAFFIC CONTROL AND PROTECTION, SPECIAL'.
4. THE CONTRATOR SHALL GIVE THE ENGINEER, IDOT AND THE CITY A 72 HOUR NOTICE PRIOR TO PLACING THE ADVANCE NOTICE SIGNS.
5. ADVANCE NOTICE SIGNS, (11), SHALL BE PLACED TWO WEEKS PRIOR TO CLOSING THE ROADWAY.
6. ALL SIGNS SHALL CONFORM TO SPACING REQUIREMENTS SET FORTH IN THE 'MANUAL ON UNIFORM TRAFFIC CONTROL DEVICES FOR STREETS AND HIGHWAYS'.
7. THE CONTRACTOR SHALL MAINTAIN ACCESS TO ADJACENT DRIVEWAYS IN ACCORDANCE WITH THE SPECIAL PROVISIONS. THE EXISTING COMMERCIAL DRIVEWAY AT THE SOUTHEAST CORNER OF THE BRIDGE MAY BE CLOSED AS SHOWN.
8. PROVIDE "SIDEWALK CLOSED" SIGNS AT THE LIMITS OF THE IMPROVEMENTS AND AS SHOWN. (8 SIGNS REQUIRED). COST INCLUDED IN "TRAFFIC CONTROL AND PROTECTION, SPECIAL."
9. IF TEMPORARY CONCRETE BARRIER IS USED TO DELINEATE CONTRACTOR USE AREAS, IT SHALL BE IN ACCORDANCE WITH HIGHWAY STANDARD 704001 AND THE ENDS SHALL BE PROTECTED. THE TEMPORARY CONCRETE BARRIER LAYOUT AND END PROTECTION SHALL BE TO THE SATISFACTION OF THE ENGINEER. THE COST FOR THIS WORK SHALL BE INCLUDED IN THE UNIT BID PRICE FOR "TRAFFIC CONTROL AND PROTECTION, SPECIAL."
10. IF TEMPORARY LANE CLOSURES ARE REQUIRED AFTER THE ROADWAY IS OPEN TO TRAFFIC, THEY SHALL CONFORM TO THE APPLICABLE HIGHWAY STANDARDS AND SPECIAL PROVISIONS TO THE SATISFACTION OF THE ENGINEER. THE COST FOR THIS WORK SHALL BE INCLUDED IN THE UNIT BID PRICE FOR "TRAFFIC CONTROL AND PROTECTION, SPECIAL."
11. AN ADDITIONAL QUANTITY OF UP TO SIX (6) TYPE III BARRICADES IN ADDITION TO THOSE SHOWN ON THIS PLAN AND IN ADDITION TO THOSE REQUIRED IN THE SPECIAL PROVISIONS MAY BE REQUIRED AT THE DISCRETION OF THE ENGINEER. THE ADDITIONAL TYPE III BARRICADES WILL BE PROVIDED AT NO ADDITIONAL COST TO THE CONTRACT.
12. IF REQUIRED, STAGGERED TYPE III BARRICADES SHALL BE IN ACCORDANCE WITH HIGHWAY STANDARD BLR 22-6 TO THE SATISFACTION OF THE ENGINEER.

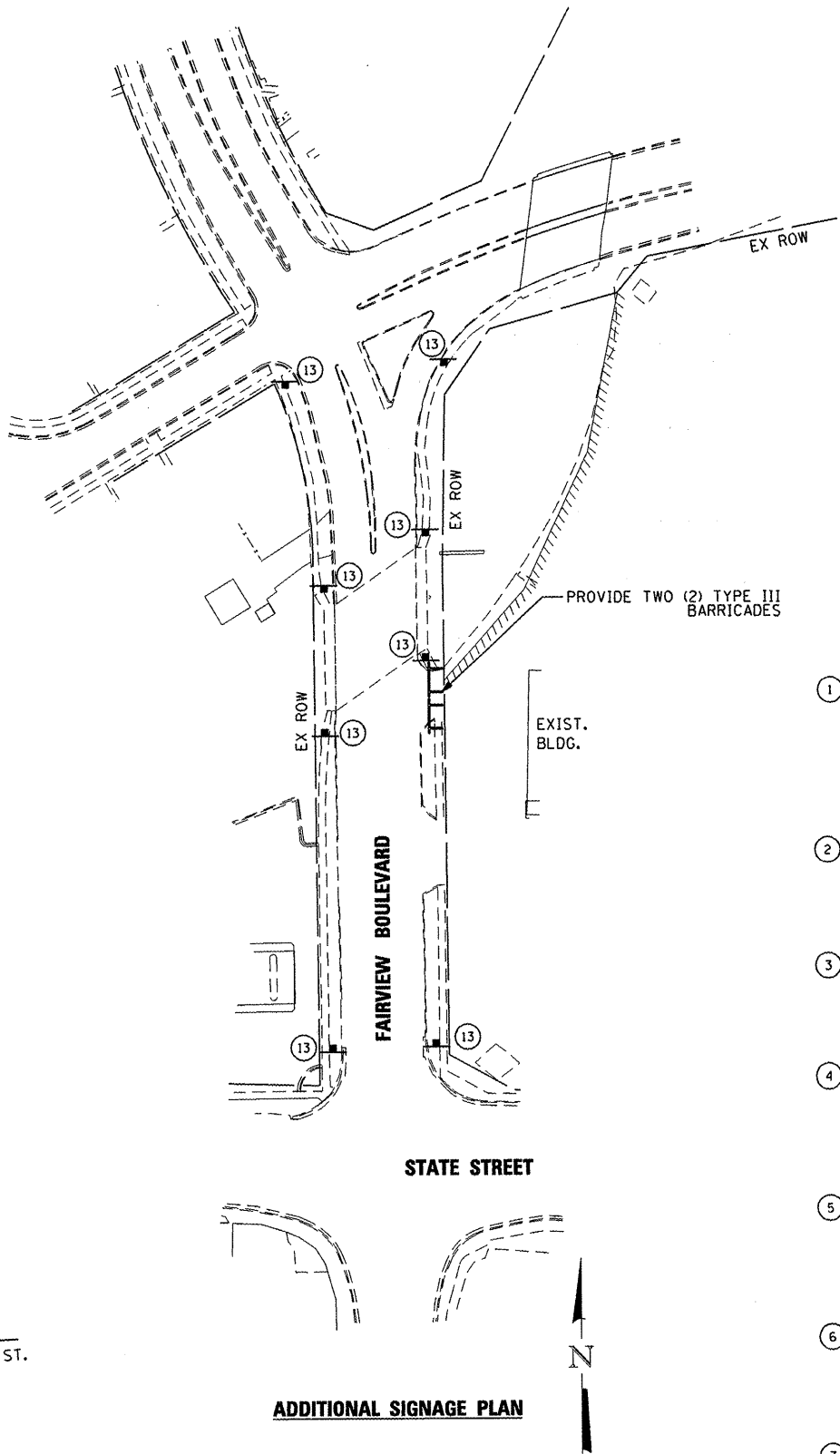
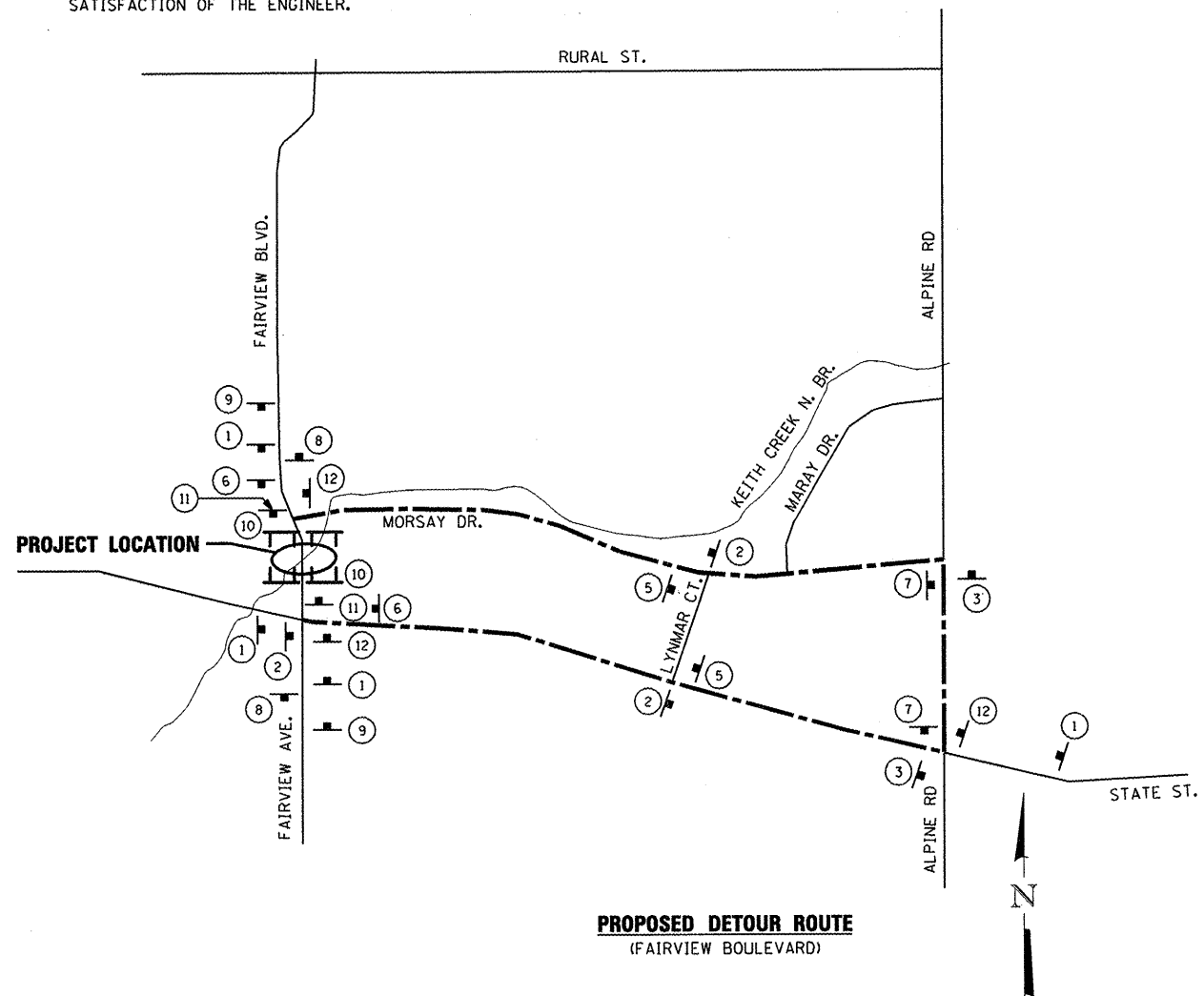

SIGN LEGEND

- | | |
|---|--|
| <p>① W20-2 (48"x48") WITH STREET SIGN AND FLASHING AMBER LIGHT</p> <p>② M4-9 (30"x24") WITH STREET SIGN AND DIRECTION OF TRAFFIC</p> <p>③ M4-9L (30"x24") WITH STREET SIGN AND DIRECTION OF TRAFFIC</p> <p>④ M4-8a (24"x18") WITH STREET SIGN AND INFORMATION SIGN</p> <p>⑤ M4-9 (30"x24") WITH STREET SIGN AND DIRECTION OF TRAFFIC</p> <p>⑥ M4-9L (30"x24") WITH STREET SIGN AND DIRECTION OF TRAFFIC</p> <p>⑦ M4-9R (30"x24") WITH STREET SIGN AND DIRECTION OF TRAFFIC</p> | <p>⑧ M4-8a (24"x18") WITH STREET SIGN AND INFORMATION SIGN</p> <p>⑨ W20-3 (48"x48") WITH FLASHING AMBER LIGHT</p> <p>⑩ R11-2 (48"x30") WITH 2 FLASHING AMBER LIGHTS</p> <p>⑪ INFO (48"x30") BLACK LETTERING ON ORANGE SIGN PANEL</p> <p>⑫ M4-9R (30"x24") WITH STREET SIGN AND DIRECTION OF TRAFFIC</p> <p>⑬ R9-9 (24"x12") ON TYPE II BARRICADE</p> |
|---|--|
- DETOUR ROUTE

PROPOSED DETOUR ROUTE
(FAIRVIEW BOULEVARD)

ADDITIONAL SIGNAGE PLAN

COMPANY NAME: HRGreen.com
 PROJECT CONTACT: KMA
 CLIENT: WJH
 FILE NAME: 86100021-Dtr.dgn
 PLOT DATE: 3/31/2011
 PLOT SCALE: N.T.S.
 PLOT DRIVER: RGD
 PEN TABLE:

HRGreen.com
 Illinois Professional Design Firm
 # 194-001322

USER NAME = KofT	DESIGNED - KMA	REVISED -
FILE NAME = 86100021-Dtr.dgn	DRAWN - WJH	REVISED -
PLOT SCALE = N.T.S.	CHECKED - RGD	REVISED -
PLOT DATE = 3/31/2011	DATE - 3/31/11	REVISED -

CITY OF ROCKFORD

TEMPORARY DETOUR PLAN	
FAIRVIEW BOULEVARD OVER KEITH CREEK	
SCALE: N.T.S.	SHEET NO. OF SHEETS STA. TO STA.

F.A.U. RTE. 5141	SECTION 10-00573-00-BR	COUNTY WINNEBAGO	TOTAL SHEETS 20	SHEET NO. 5
CONTRACT NO. 85540				
FED. ROAD DIST. NO. 2 ILLINOIS FED. AID PROJECT				

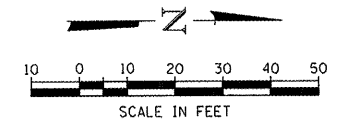
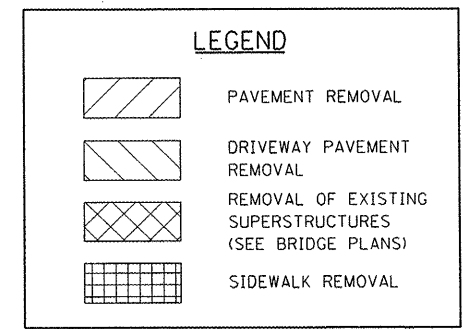
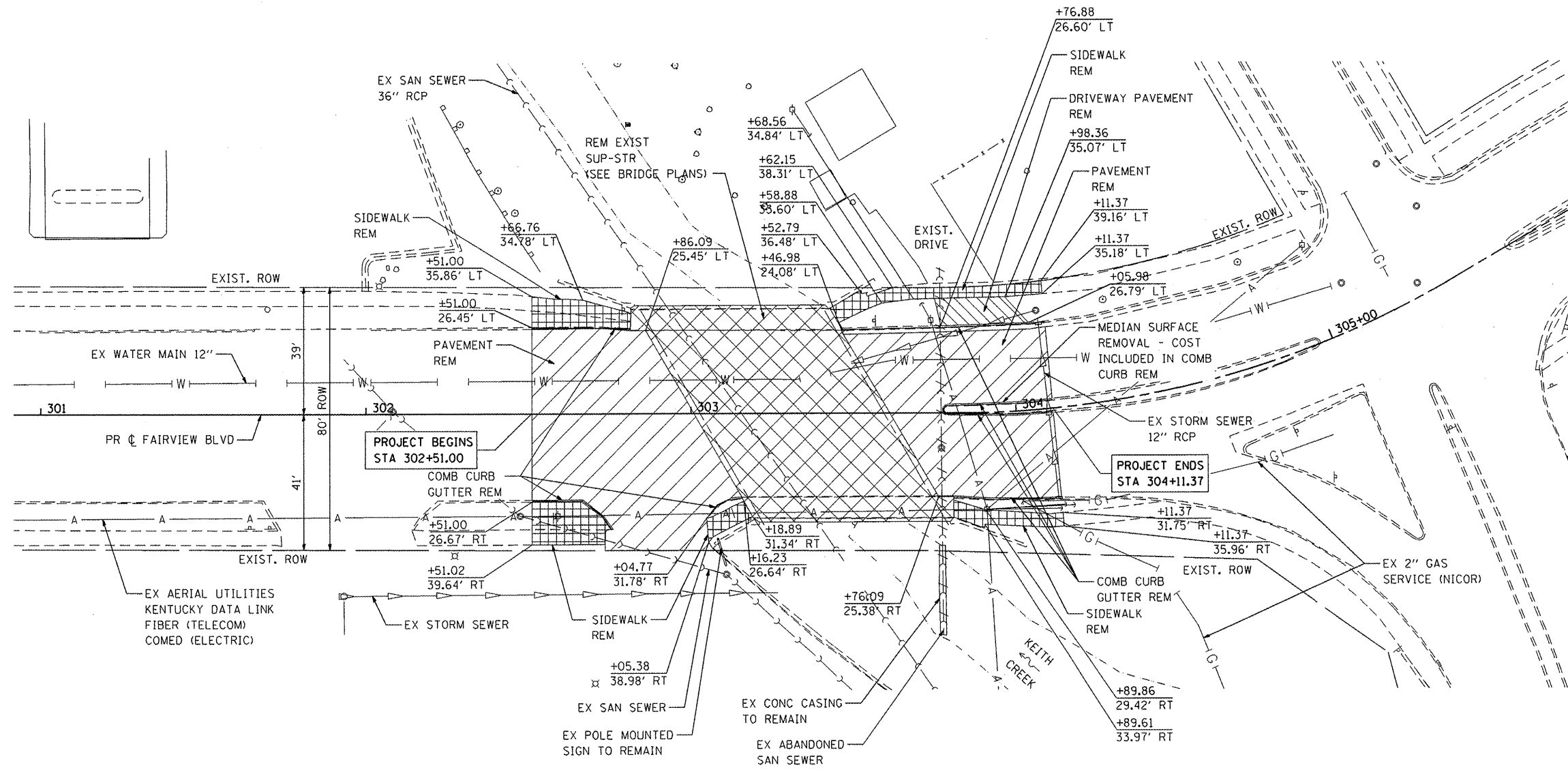

COMPANY NAME: SEC GROUP, INC.
 PROJECT CONTACT: CONTACT
 CLIENT: CONTACT
 DATE PLOTTED: 3/31/2011 10:24:41 AM
 PLOT DRIVER: 800022-Rem.dgn
 PEN TABLE: STRUCT 22x3478

HRGreen.com
 Illinois Professional Design Firm
 # 194-001322

USER NAME = Karft	DESIGNED - KMA	REVISED -
FILE NAME = 86100021-Rem.dgn	DRAWN - WJH	REVISED -
PLOT SCALE = 1"=20'	CHECKED - RGD	REVISED -
PLOT DATE = 3/31/2011	DATE - 3/31/11	REVISED -

CITY OF ROCKFORD

REMOVAL PLAN
FAIRVIEW BOULEVARD OVER KEITH CREEK

SCALE: 1"=20' SHEET NO. OF SHEETS STA. TO STA.

F.A.U. RTE.	SECTION	COUNTY	TOTAL SHEETS	SHEET NO.
5141	10-00573-00-BR	WINNEBAGO	20	6
CONTRACT NO. 85540				
FED. ROAD DIST. NO. 2 ILLINOIS FED. AID PROJECT				

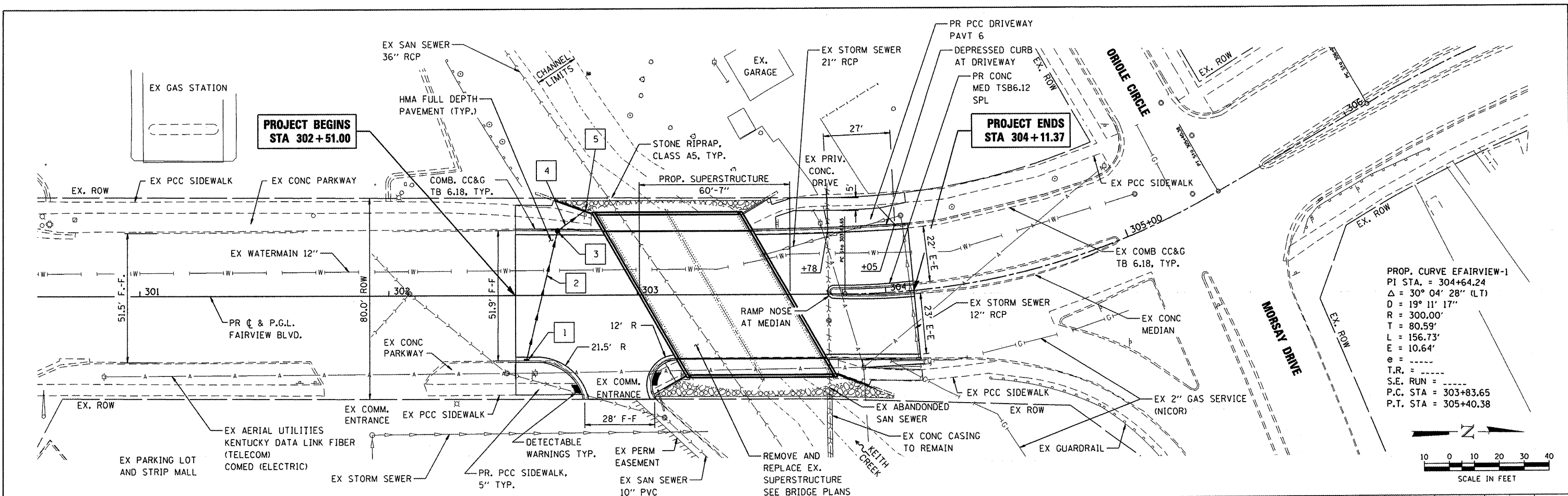

PROP. CURVE FAIRVIEW-1
 PI STA. = 304+64.24
 Δ = 30° 04' 28" (LT)
 D = 19° 11' 17"
 R = 300.00'
 T = 80.59'
 L = 156.73'
 E = 10.64'
 e = -----
 T.R. = -----
 S.E. RUN = -----
 P.C. STA = 303+83.65
 P.T. STA = 305+40.38

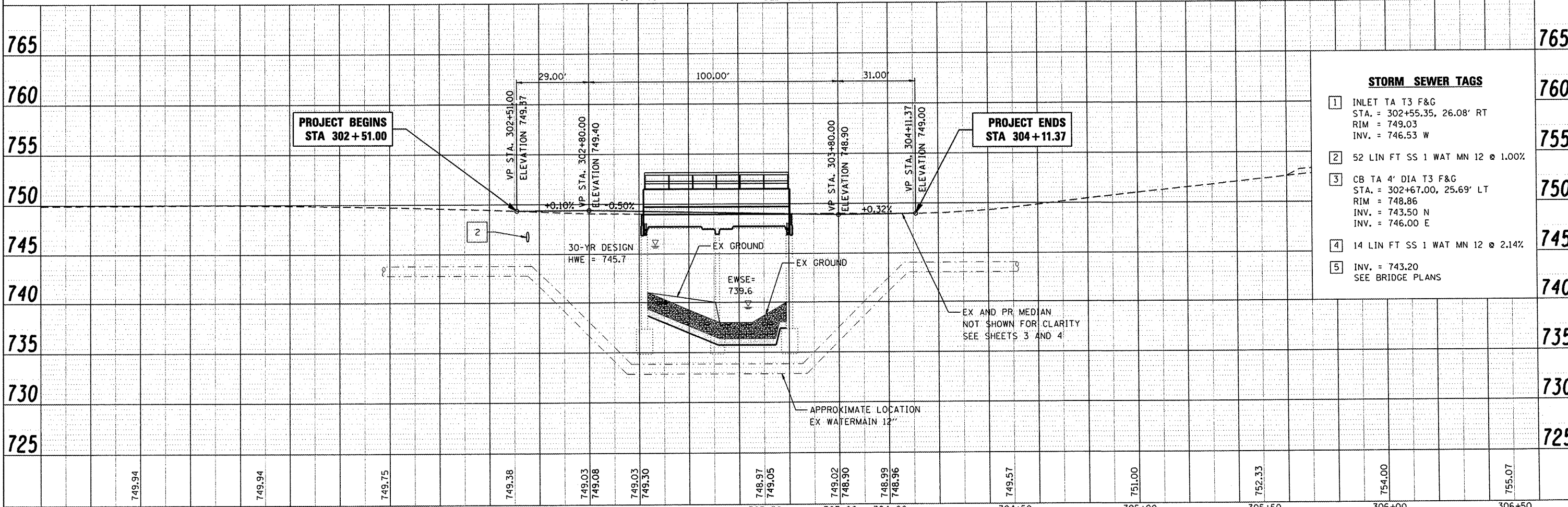
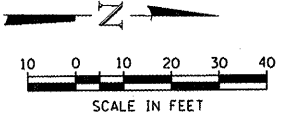

STORM SEWER TAGS

- 1 INLET TA T3 F&G
 STA. = 302+55.35, 26.08' RT
 RIM = 749.03
 INV. = 746.53 W
- 2 52 LIN FT SS 1 WAT MN 12 @ 1.00%
- 3 CB TA 4' DIA T3 F&G
 STA. = 302+67.00, 25.69' LT
 RIM = 748.86
 INV. = 743.50 N
 INV. = 746.00 E
- 4 14 LIN FT SS 1 WAT MN 12 @ 2.14%
- 5 INV. = 743.20
 SEE BRIDGE PLANS





COMPANY NAME: HRGreen PROJECT CONTACT: Karft CLIENT: KMA DATE PLOTTED: 3/31/2011 12:58:17 AM PLOT SCALE: 1"=20' PLOT DATE: 3/31/2011	USER NAME: Karft FILE NAME: 86100021-PNP.dgn PLOT SCALE: 1"=20' PLOT DATE: 3/31/2011	DESIGNED - KMA DRAWN - WJH CHECKED - RGD DATE - 3/31/11	REVISED - REVISED - REVISED - REVISED -	CITY OF ROCKFORD	PLAN AND PROFILE FAIRVIEW BOULEVARD OVER KEITH CREEK SCALE: 1"=20' SHEET NO. 1 OF 1 SHEETS STA. TO STA.	F.A.U. RTE. SECTION COUNTY TOTAL SHEETS SHEET NO. 09-00559-00-BR Winnebago 20 7	CONTRACT NO. XXXX FED. ROAD DIST. NO. 2 ILLINOIS FED. AID PROJECT
---	---	--	--	------------------	---	--	--

COMPANY NAME: HRGreen
 PROJECT CONTACT: Karft
 CLIENT: KMA
 DATE PLOTTED: 3/31/2011 12:58:17 AM
 PLOT SCALE: 1"=20'
 PLOT DATE: 3/31/2011

EROSION CONTROL NOTES

1. THE CONTRACTOR WILL BE REQUIRED TO IMPLEMENT AND MAINTAIN EROSION CONTROL MEASURES IMMEDIATELY AFTER STRIPPING OF EXISTING VEGETATION.
2. STOCKPILES OF SOIL AND OTHER BUILDING MATERIALS TO REMAIN IN PLACE MORE THAN THREE (3) DAYS SHALL BE FURNISHED WITH EROSION AND SEDIMENT CONTROL MEASURES (I.E. PERIMETER SILT FENCE). STOCKPILES TO REMAIN IN PLACE FOR 14 DAYS OR MORE SHALL RECEIVE TEMPORARY SEEDING.
3. THE CONTRACTOR SHALL TAKE ALL PRECAUTIONS TO PREVENT POLLUTION OF STORM WATER AND SHALL FOLLOW IEPA REGULATIONS & IDOT CONSTRUCTION MEMORANDUM NO. 06-60.
4. STABILIZATION MEASURES SHALL BE INITIATED WITHIN 7 DAYS OF CONSTRUCTION ACTIVITY TEMPORARILY OR PERMANENTLY CEASING IN AREAS WHERE IT WILL NOT OCCUR FOR A PERIOD OF 14 OR MORE CALENDAR DAYS.
5. THE SOIL EROSION AND SEDIMENT CONTROL PRACTICES WILL BE INSPECTED WEEKLY AND AFTER 1/2 INCH OF RAIN OR MORE BY THE INDIVIDUAL ON SITE IN CHARGE OF SOIL EROSION AND SEDIMENT CONTROL DURING THE CONSTRUCTION OF THE PROJECT.
6. SILT FENCE SHALL BE INSTALLED FOLLOWING THE COMPLETION AND STABILIZATION OF THE STORMWATER FACILITIES AND WILL REMAIN IN PLACE UNTIL THE CONTRIBUTING AREA IS STABILIZED.
7. ALL ADJACENT STREETS MUST BE KEPT CLEAR OF DEBRIS. INSPECTED DAILY AND CLEANED WHEN NECESSARY OR AS DIRECTED BY THE ENGINEER.
8. ALL SOIL EROSION AND SEDIMENT CONTROL PRACTICES ARE REFERENCED FROM THE ILLINOIS URBAN MANUAL.

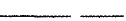
LEGEND

	PERIMETER EROSION BARRIER		FINAL RESTORATION OF DISTURBED AREAS - TOPSOIL FURNISH AND PLACE, 4" - SEEDING CLASS 2A - EROSION CONTROL BLANKET
	EXISTING R.O.W.		INLET AND PIPE PROTECTION

TEMPORARY EROSION CONTROL SEQUENCE OF CONSTRUCTION

1. ESTABLISH TEMPORARY EROSION CONTROL MEASURES AND ERECT PERIMETER EROSION BARRIER ALONG SITE BOUNDARIES PRIOR TO EARTHWORK.
2. INSTALL TEMPORARY EROSION CONTROL SEEDING.

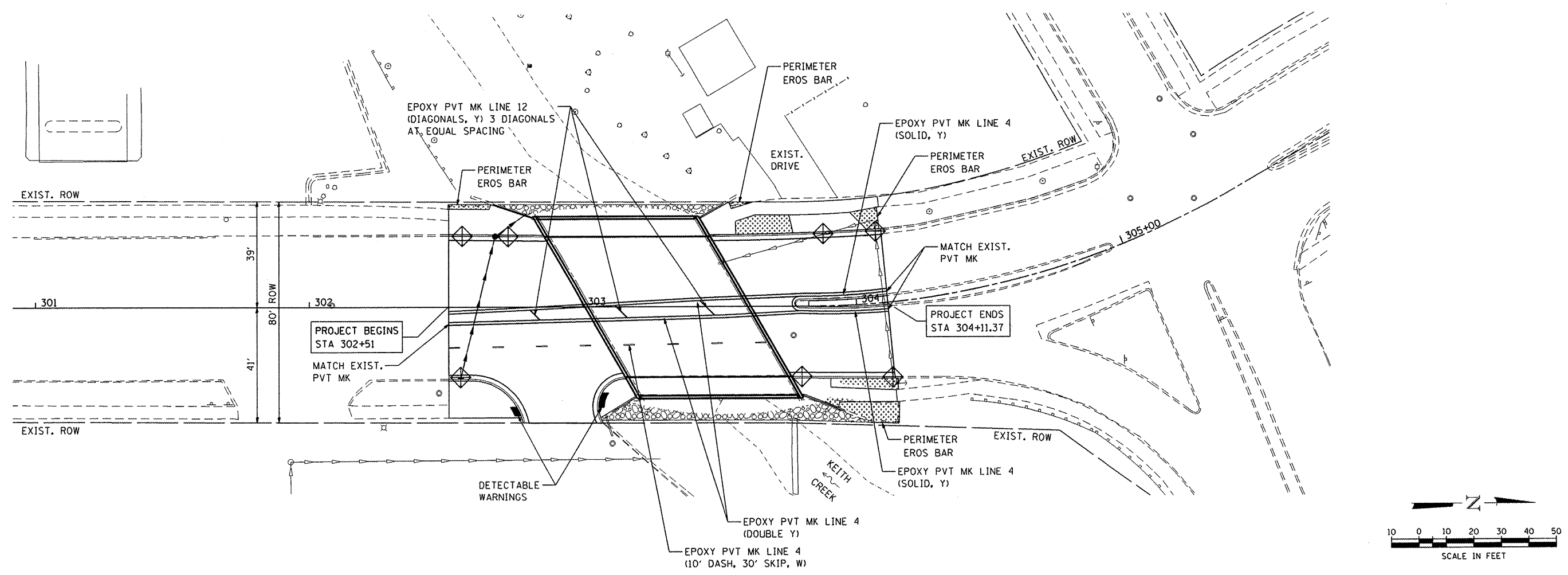

COMPANY NAME: HRGreen
 PROJECT CONTACT: CONTACT
 CLIENT: CONTACT
 DATE PLOTTED: 2/26/2011 7:25:23 AM
 PLOT DRIVER: hr-green-plot.dgn
 PEN TABLE: Struct 22x31.tbl

 HRGreen.com
 Illinois Professional Design Firm
 #194-001322

USER NAME = Kerf	DESIGNED - KMA	REVISED -
FILE NAME = 86100021-Eros.dgn	DRAWN - WJH	REVISED -
PLOT SCALE = 1"=20'	CHECKED - RGD	REVISED -
PLOT DATE = 3/31/2011	DATE - 3/31/11	REVISED -

CITY OF ROCKFORD

EROSION CONTROL, STRIPING AND RESTORATION PLAN
FAIRVIEW BOULEVARD OVER KEITH CREEK

SCALE: 1"=20' SHEET NO. OF SHEETS STA. TO STA.

F.A.U. RTE.	SECTION	COUNTY	TOTAL SHEETS	SHEET NO.
5141	10-00573-00-BR	WINNEBAGO	20	8
CONTRACT NO. 85540				
FED. ROAD DIST. NO. 2 ILLINOIS FED. AID PROJECT				

Benchmark:
 BM#1 Arrow bolt on top flange of hydrant located at the northwest corner of Fairview Blvd. and State Street
 Elevation=751.91 NAVD88

BM#2 Chiseled square in the northeast corner of concrete wall located on the east side of Fairview Blvd. over Keith Creek.
 Elevation=749.05 NAVD88

Existing Structure SN: 101-6060:
 The existing structure built in 1955 consists of a two span continuous reinforced concrete slab superstructure with an out-to-out width of 66'-0" and a total length of 60'-7" Bk. To Bk. Abutments with a 30°3'45" skew. Existing superstructure to be removed and replaced. The substructure is to remain. Traffic is to be detoured during construction.

No Salvage

KEITH CREEK
 RE-BUILT 20__ BY
 CITY OF ROCKFORD
 SEC 10-00573-00-BR
 STRUCTURE NO. 101-6060
 LOADING HS20-44

NAME PLATE
 See Std. 515001

Existing Name Plate shall be cleaned and relocated next to the new Name Plate. Cost included with Name Plates.

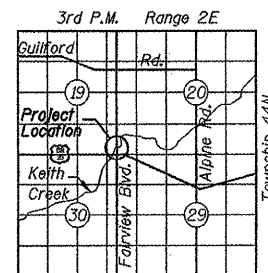
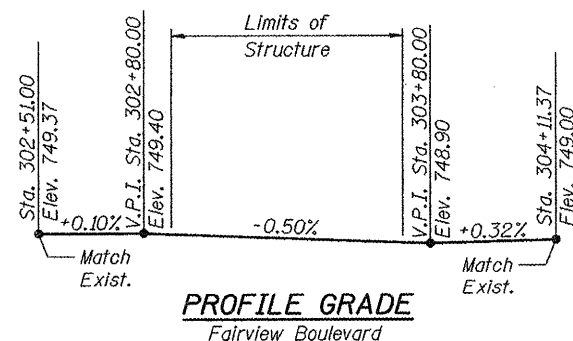

WATERWAY INFORMATION

Drainage Area = 7.4 sq. mi. Low Grade Elev. 748.50 @ Sta. 303+61.4

Flood	Freq. Yr.	Q C.F.S.	Opening Sq. Ft.		Nat. H.W.E.	Head - Ft.		Headwater El.	
			Exist.	Prop.		Exist.	Prop.	Exist.	Prop.
Design	10	735	176	176	744.3	0.2	0.2	744.5	744.5
Base	30	1257	241	241	745.7	0.3	0.3	746.0	746.0
Max. Calc.	100	1790	301	301	746.8	1.0	1.0	747.8	747.8
	500	2500	309	309	747.9	0.3	0.3	748.2	748.2

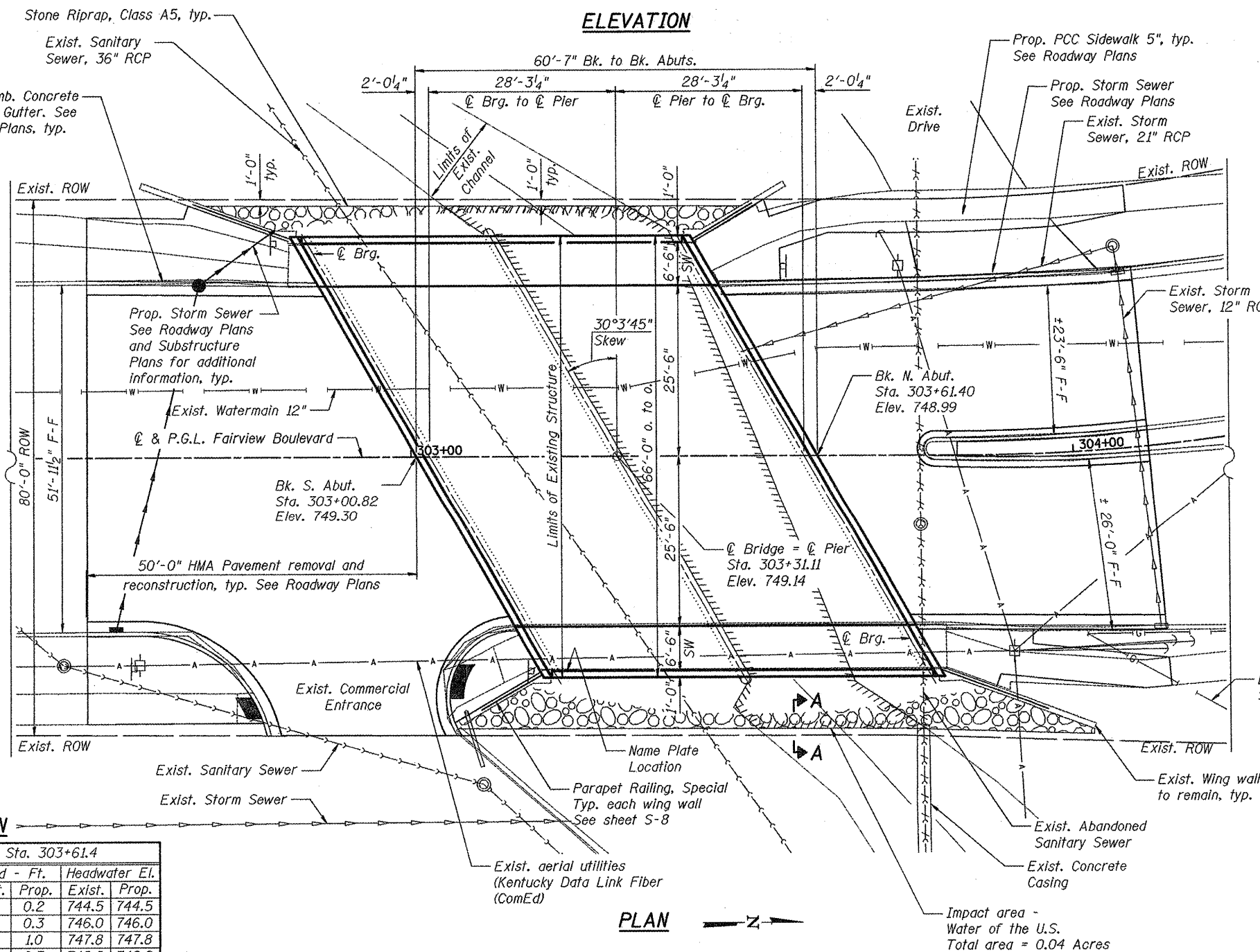
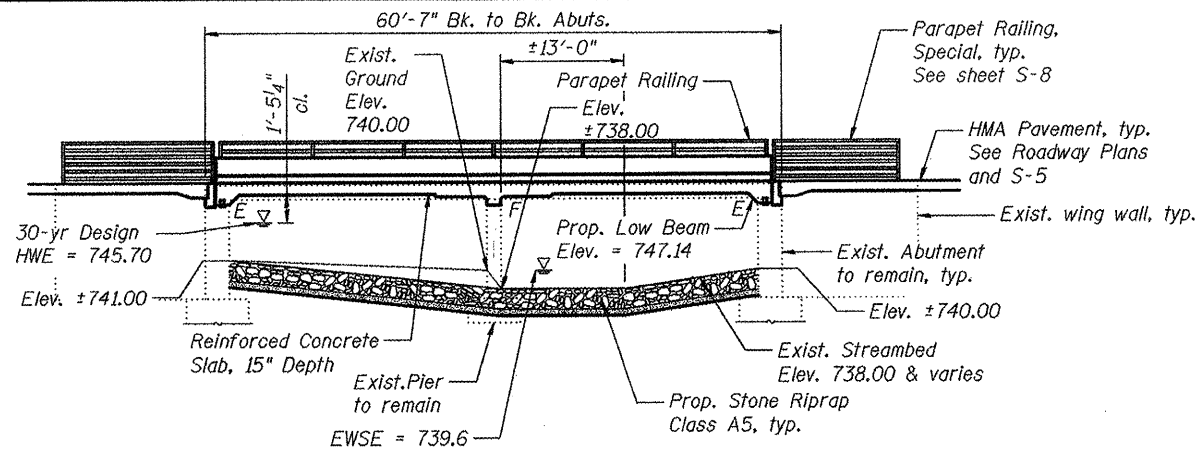

LOADING HS20-44
 No future wearing surface allowed
DESIGN SPECIFICATIONS
 2002 AASHTO Standard Specifications

DESIGN STRESSES
FIELD UNITS
 f'c = 3,500 psi
 fy = 60,000 psi (Reinforcement)
 fy = 50,000 psi (M270 Grade 50)

SEISMIC DATA
 Seismic Performance Category (SPC) = A
 Bedrock Acceleration Coefficient (A) = 4Zg
 Site Coefficient (S) = 1.0



To the best of my knowledge, information and belief, this bridge design is structurally adequate for the design loading shown on the plans. The design is an economical one for the style of structure and complies with requirements of the current "AASHTO Standard Specifications for Highway Bridges".

Robert Green
 Structural Engineer Expires 11/30/2012
 HR Green, Inc.

GENERAL PLAN AND ELEVATION
FAIRVIEW BOULEVARD (FAU RTE 514)
OVER KEITH CREEK
SECTION NO. 10-00573-00-BR
CITY OF ROCKFORD
WINNEBAGO COUNTY
STRUCTURE NO. 101-6060

SEC GROUP, INC.
 PROJECT CONTACT
 CLIENT
 DATE PLOTTED
 FILE NAME
 PLOT USER
 PEN TABLE



USER NAME = Kar-ft	DESIGNED - KMA	REVISED -
	CHECKED - RGD	REVISED -
PLOT SCALE = N.T.S.	DRAWN - WJH	REVISED -
PLOT DATE = 3/29/2011	CHECKED - 3/29/11	REVISED -

STATE OF ILLINOIS
DEPARTMENT OF TRANSPORTATION

GENERAL PLAN AND ELEVATION
FAIRVIEW BOULEVARD - S.N. 101-6060
 SHEET NO. S-1 OF S-11 SHEETS

F.A. RTE.	SECTION	COUNTY	TOTAL SHEETS	SHEET NO.
5141	10-00573-00-BR	WINNEBAGO	20	9
			CONTRACT NO. 85540	
ILLINOIS FED. AID PROJECT				

GENERAL NOTES:

Reinforcement bars shall conform to the requirements of ASTM A 706 Gr 60. See Special Provisions.

Reinforcement bars designated (E) shall be epoxy coated.

Plan dimensions and details relative to existing plans are subject to nominal construction variations. The Contractor shall field verify existing dimensions and details affecting new construction and make necessary approved adjustments prior to construction or ordering of materials. Such variations shall not be cause for additional compensation for a change in scope of the work, however, the Contractor will be paid for the quantity actually furnished at the unit price bid for the work.

Layout of Slope Protection System may be varied to suit ground conditions in field as directed by the Engineer. Incidental excavation / shaping required to place Stone Riprap shall be in accordance with the applicable portions of Sections 202 and 203 of the Standard Specifications. The cost for this work shall be included in Stone Riprap, Class A5.

The Contractor shall make allowance for the deflection of forms, shrinkage and settlement of falsework, in addition to allowance for dead load deflection. Forms for deck slab shall be removed prior to placement of bridge approach pavement.

TOTAL BILL OF MATERIAL

ITEM	UNIT	SUPER	SUB	TOTAL
Stone Riprap, Class A5	Sq. Yd.	---	495	495
Filter Fabric	Sq. Yd.	---	495	495
Removal of Existing Superstructures	Each	1	---	1
Concrete Superstructure	Cu. Yd.	240.4	---	240.4
Bridge Deck Grooving	Sq. Yd.	317	---	317
Protective Coat	Sq. Yd.	459	---	459
Reinforcement Bars, Epoxy Coated	Pound	48,590	---	48,590
Parapet Railing	Foot	113	---	113
Name Plates	Each	1	---	1
Elastomeric Bearing Assembly, Type I	Each	24	---	24
Epoxy Crack Injection	Foot	---	221	221
Porous Granular Embankment, Special	Cu. Yd.	---	15.8	15.8
Parapet Railing, Special	Foot	59	---	59
Structural Repair of Concrete (Depth Less than or Equal to 5")	Sq. Ft.	---	170	170
Silicone Joint Sealer, 1"	Foot	155	---	155

INDEX OF SHEETS

- S-1 General Plan and Elevation
- S-2 General Notes and Total Bill of Materials
- S-3 Top of Slab Elevations
- S-4 Superstructure Plan
- S-5 Cross Section and Superstructure Details
- S-6 Superstructure Details
- S-7 Bearing and Expansion Joint Details
- S-8 Railing Details
- S-9 South Abutment Details
- S-10 North Abutment Details
- S-11 Pier Details

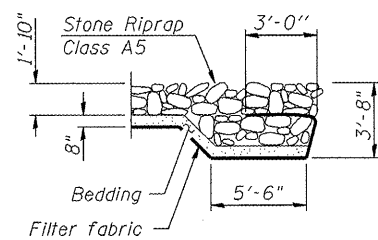
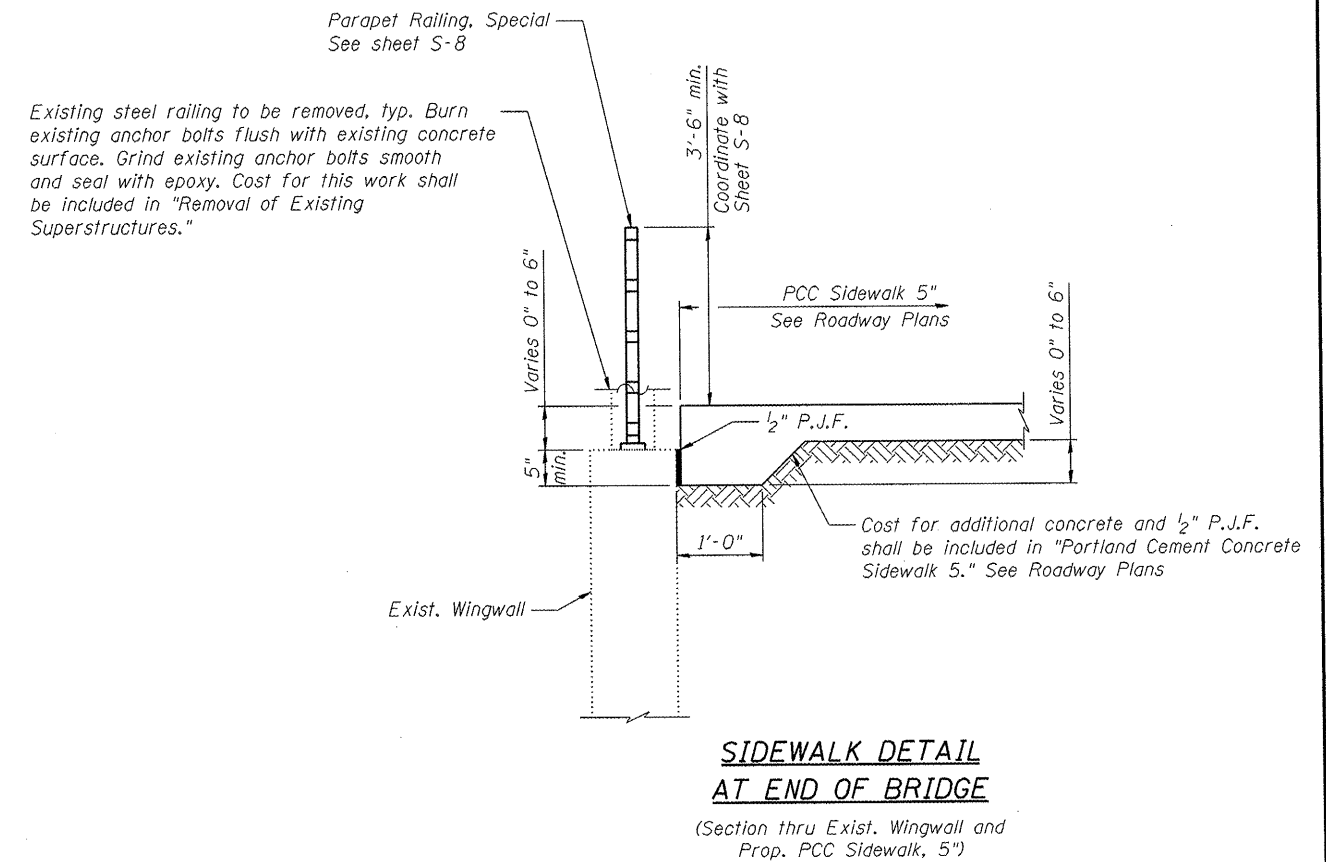

SECTION A-A

COMPANY NAME: HRGreen
 PROJECT CONTACT: HRGreen
 DATE PLOTTED: 3/31/2011 2:26:33 AM
 FILE NAME: 8610021-Riprap.dgn
 PLOT DRIVER: defplot
 PEN TABLE: Struct 22x34.tbl



USER NAME = KorFt	DESIGNED - KMA	REVISED -
PLOT SCALE = N.T.S.	CHECKED - RGD	REVISED -
PLOT DATE = 3/31/2011	DRAWN - WJH	REVISED -
	CHECKED - 3/31/11	REVISED -

**STATE OF ILLINOIS
 DEPARTMENT OF TRANSPORTATION**

**GENERAL NOTES AND TOTAL BILL OF MATERIALS
 FAIRVIEW BOULEVARD - S.N. 101-6060**

SHEET NO. S-2 OF S-11 SHEETS

F.A. RTE.	SECTION	COUNTY	TOTAL SHEETS	SHEET NO.
5141	10-00573-00-BR	WINNEBAGO	20	10
CONTRACT NO. 85540			ILLINOIS FED. AID PROJECT	

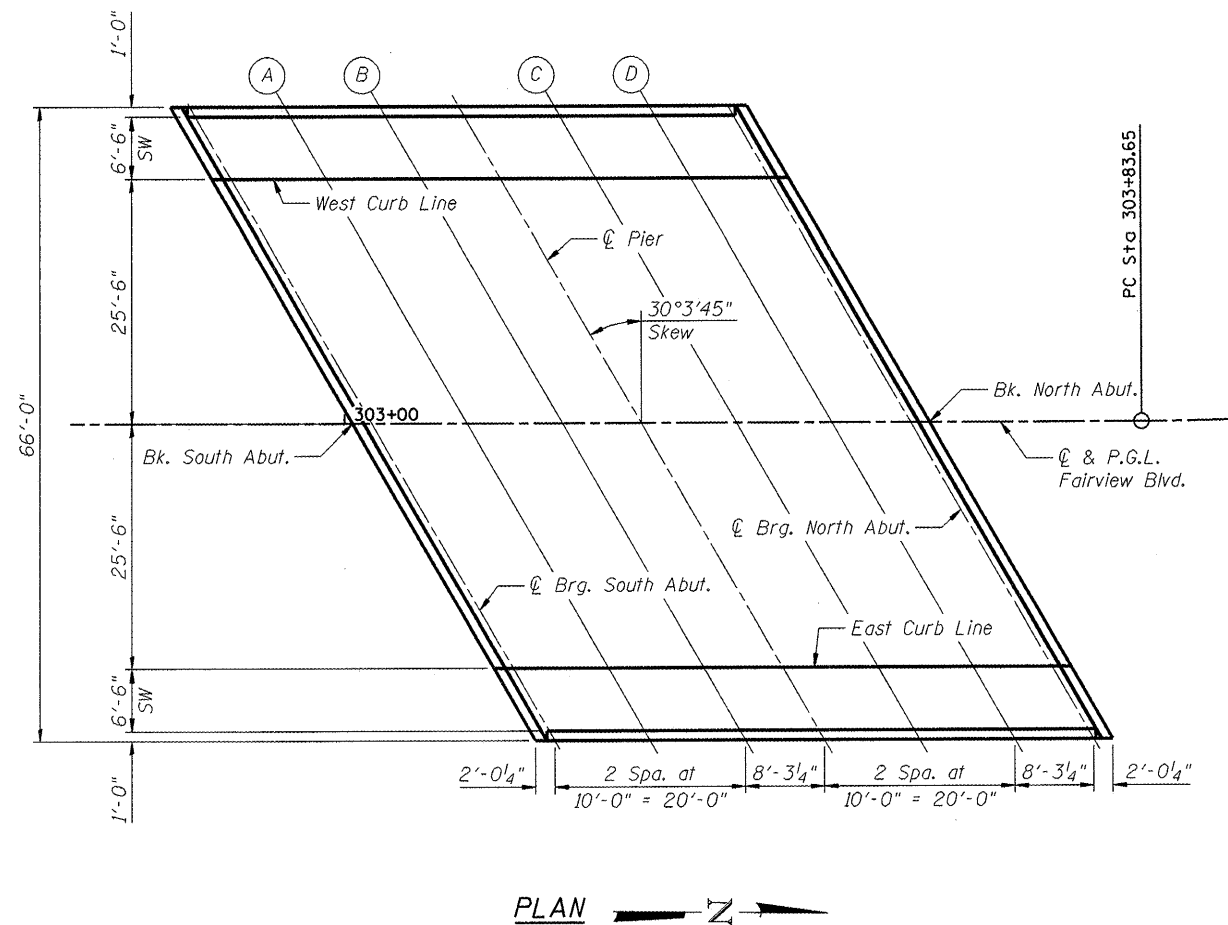

PLAN

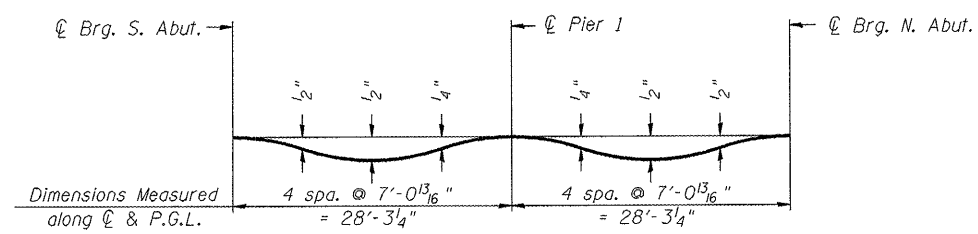

DEAD LOAD DEFLECTION DIAGRAM
(Includes weight of concrete only.)

Note:
The above deflections are not to be used in the field if the engineer is working from the grade elevations adjusted for dead load deflections as shown.

WEST CURB LINE

Location	Station	Offset	Theoretical Grade Elevations	Theoretical Grade Elevations Adjusted For Dead Load Deflection
Bk. South Abutment	302+86.06	-25.50	748.97	748.97
CL Bearing South Abutment	302+88.08	-25.50	748.96	748.96
A	302+98.08	-25.50	748.91	748.95
B	303+08.08	-25.50	748.86	748.89
CL of Pier	303+16.35	-25.50	748.82	748.82
C	303+26.35	-25.50	748.77	748.79
D	303+36.35	-25.50	748.72	748.76
CL Bearing North Abutment	303+44.62	-25.50	748.68	748.68
Bk. North Abutment	303+46.64	-25.50	748.67	748.67

CENTERLINE & PROFILE GRADE LINE

Location	Station	Offset	Theoretical Grade Elevations	Theoretical Grade Elevations Adjusted For Dead Load Deflection
Bk. South Abutment	303+00.82	0.00	749.30	749.30
CL Bearing South Abutment	303+02.84	0.00	749.29	749.29
A	303+12.84	0.00	749.24	749.28
B	303+22.84	0.00	749.19	749.21
CL of Pier	303+31.11	0.00	749.14	749.14
C	303+41.11	0.00	749.09	749.12
D	303+51.11	0.00	749.04	749.09
CL Bearing North Abutment	303+59.38	0.00	749.00	749.00
Bk. North Abutment	303+61.40	0.00	748.99	748.99

EAST CURB LINE

Location	Station	Offset	Theoretical Grade Elevations	Theoretical Grade Elevations Adjusted For Dead Load Deflection
Bk. South Abutment	303+15.58	25.50	748.82	748.82
CL Bearing South Abutment	303+17.60	25.50	748.81	748.81
A	303+27.60	25.50	748.76	748.81
B	303+37.60	25.50	748.71	748.74
CL of Pier	303+45.87	25.50	748.67	748.67
C	303+55.87	25.50	748.62	748.65
D	303+65.87	25.50	748.57	748.62
CL Bearing North Abutment	303+74.14	25.50	748.5	748.53
Bk. North Abutment	303+76.16	25.50	748.52	748.52

COMPANY NAME: HRGreen
PROJECT CONTACT: Karft
CLIENT: Winnebago
DATE PLOTTED: 3/31/2011 12:55:39 AM
PLOT SCALE: N.T.S.
PLOT ORIGIN: 800000-186000
PEN TABLE: Struct 22x34.tbl



USER NAME = Karft	DESIGNED - KMA	REVISED -
PLOT SCALE = N.T.S.	CHECKED - RGD	REVISED -
PLOT DATE = 3/31/2011	DRAWN - WJH	REVISED -
	CHECKED - 3/31/11	REVISED -

**STATE OF ILLINOIS
DEPARTMENT OF TRANSPORTATION**

**TOP OF SLAB ELEVATIONS
FAIRVIEW BOULEVARD - S.N. 101-6060**
SHEET NO. S-3 OF S-11 SHEETS

F.A. RTE. 5141	SECTION 10-00573-00-BR	COUNTY WINNEBAGO	TOTAL SHEETS 20	SHEET NO. 11
CONTRACT NO. 85540			ILLINOIS FED. AID PROJECT	

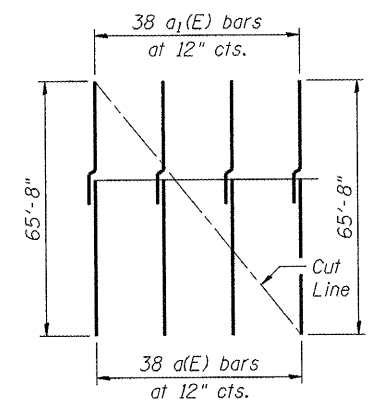
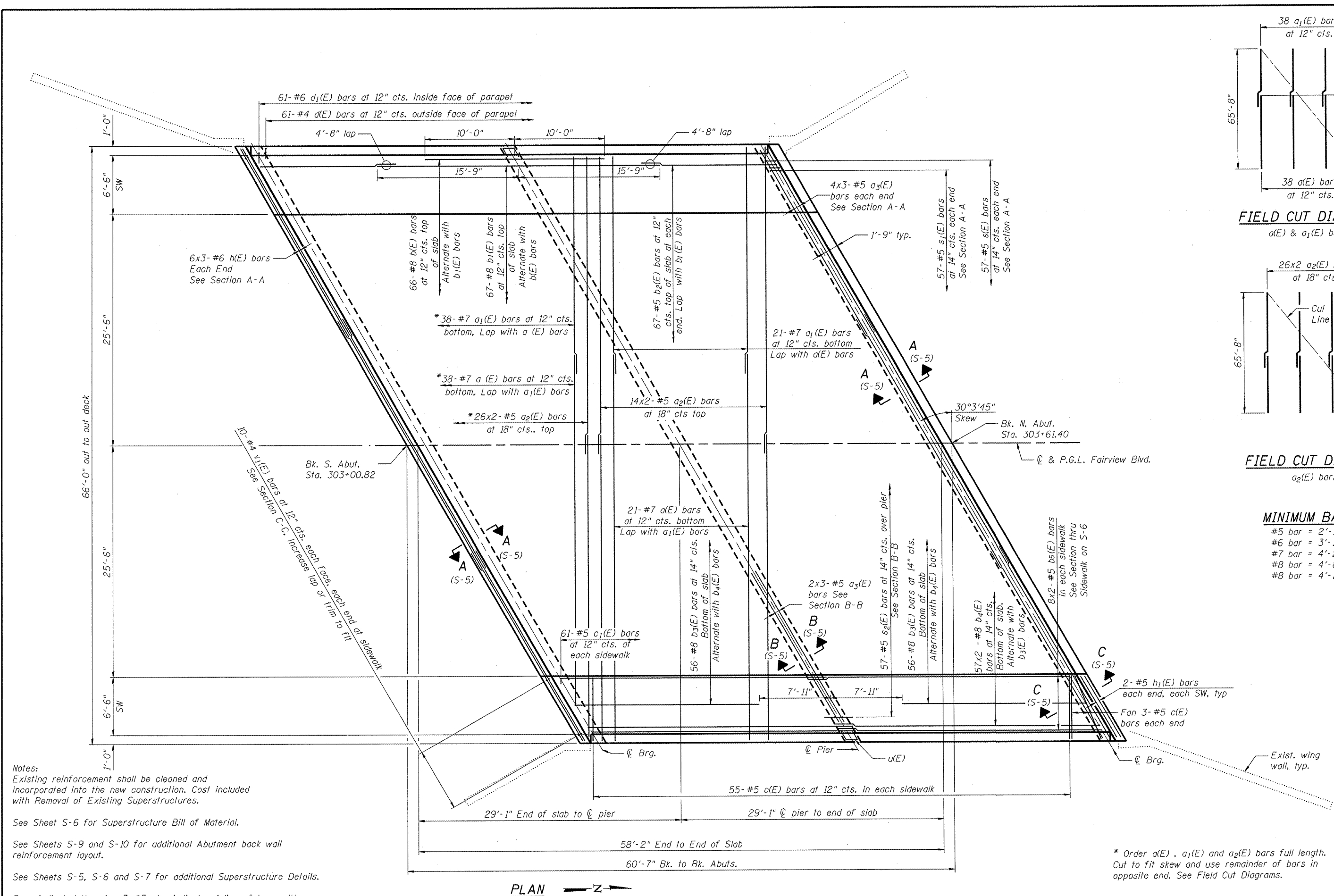

FIELD CUT DIAGRAM
a₁(E) & a₁(E) bars

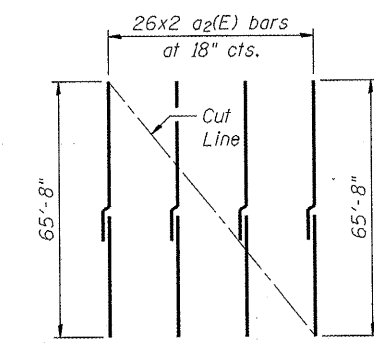

FIELD CUT DIAGRAM
a₂(E) bars

MINIMUM BAR LAP

#5 bar	= 2'-11"
#6 bar	= 3'-1"
#7 bar	= 4'-2"
#8 bar	= 4'-8" Top Bars
#8 bar	= 4'-2" Bottom Bars

Notes:
Existing reinforcement shall be cleaned and incorporated into the new construction. Cost included with Removal of Existing Superstructures.

See Sheet S-6 for Superstructure Bill of Material.

See Sheets S-9 and S-10 for additional Abutment back wall reinforcement layout.

See Sheets S-5, S-6 and S-7 for additional Superstructure Details.

Bars indicated thus 1 x 3-#5 etc. indicates 1 line of bars with 3 lengths per line.

* Order a₁(E), a₁(E) and a₂(E) bars full length. Cut to fit skew and use remainder of bars in opposite end. See Field Cut Diagrams.

COMPANY NAME: HRGreen.com
PROJECT CONTACT: HRGreen.com
CLIENT: HRGreen.com
DATE: 3/31/2011
FILE NAME: HRGreen.com
PLOT DRIVER: HRGreen.com
PEN TABLE: HRGreen.com



USER NAME = Karft	DESIGNED - KMA	REVISED -
PLLOT SCALE = N.T.S.	CHECKED - RGD	REVISED -
PLLOT DATE = 3/31/2011	DRAWN - WJH	REVISED -
	CHECKED - 3/31/11	REVISED -

STATE OF ILLINOIS
DEPARTMENT OF TRANSPORTATION

SUPERSTRUCTURE PLAN
FAIRVIEW BOULEVARD - S.N. 101-6060
SHEET NO. S-4 OF S-11 SHEETS

F.A. RTE.	SECTION	COUNTY	TOTAL SHEETS	SHEET NO.
5141	10-00573-00-BR	WINNEBAGO	20	12
CONTRACT NO. 85540				
ILLINOIS FED. AID PROJECT				

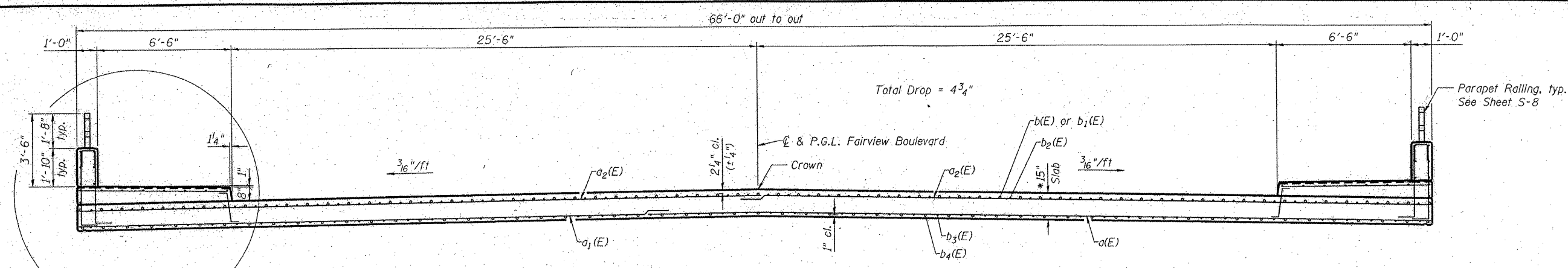

CROSS SECTION
(Looking North)

* 18" at Pier - See Section B-B this sheet

Hatched area to be poured after superstructure false work has been removed. Quantity of concrete included with Concrete Superstructure. See abutment details for additional information.

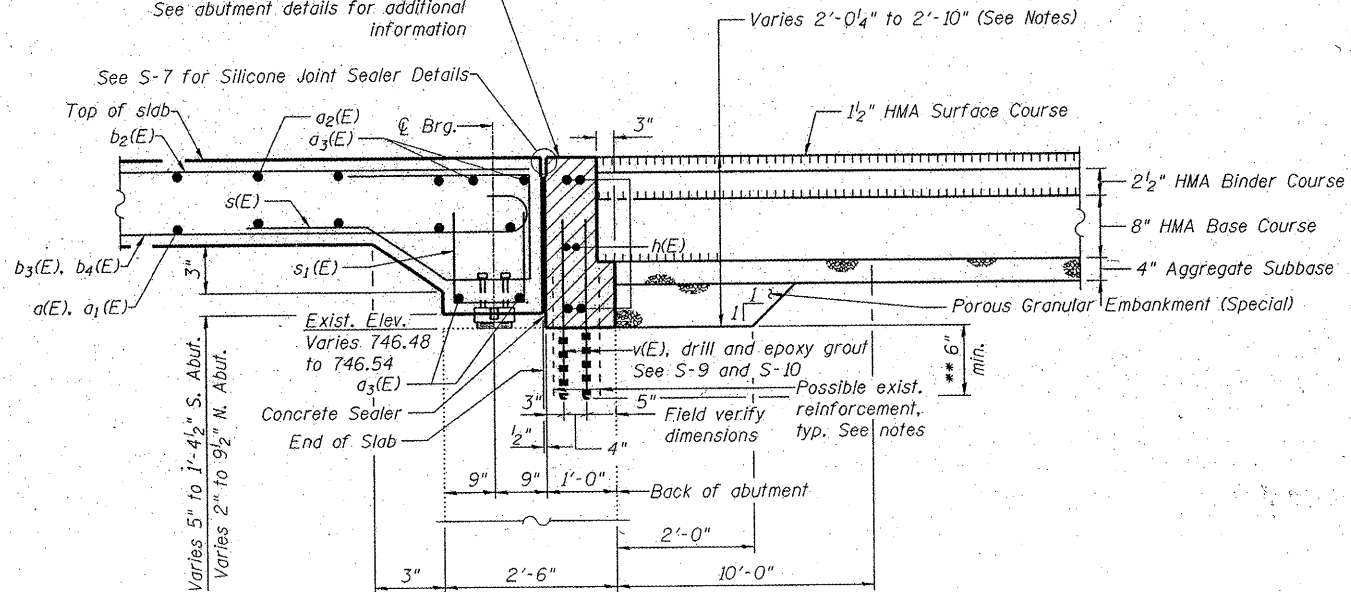

SECTION A-A

Horizontal dimensions at Rt. L's
See S-9 and S-10 for additional information

** Increase horizontal embedment depth of v(E) bars or trim to fit depth. Coordinate required embedment depth with Manufacturer specifications.

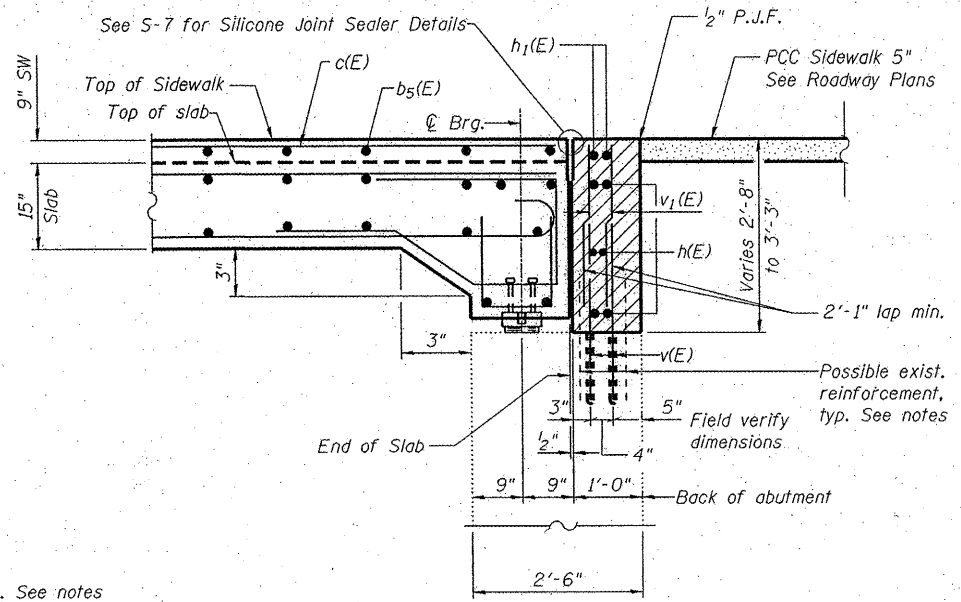

SECTION C-C

Horizontal dimensions at Rt. L's
See Section A-A, S-9 and S-10 for additional information

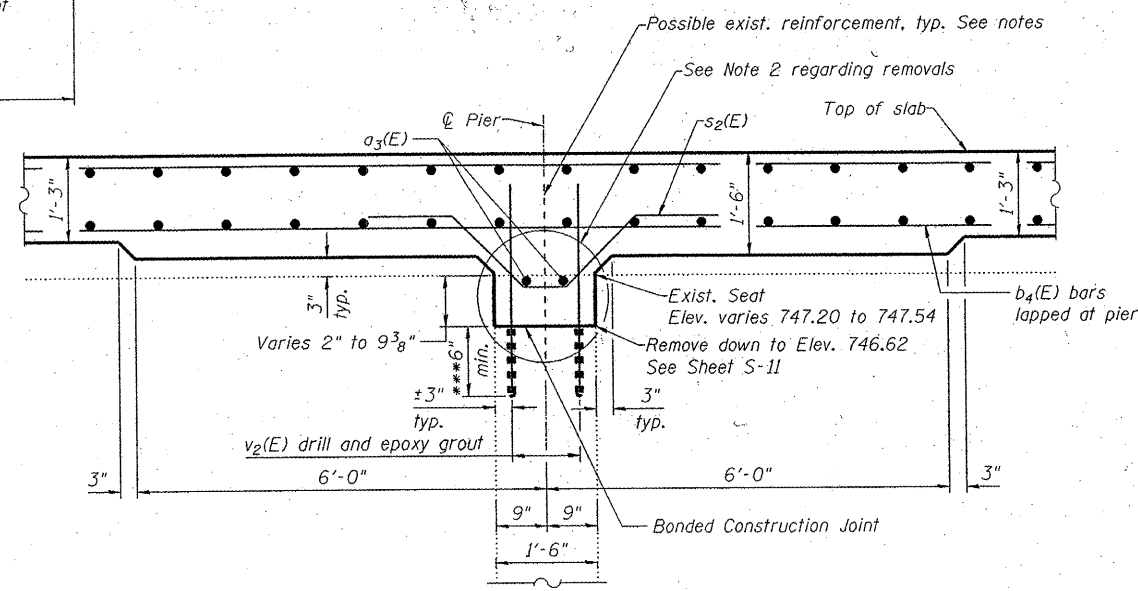

SECTION B-B

Horizontal dimensions at Rt. L's

*** Coordinate required embedment depth with Manufacturer specifications.

Notes:

- Existing reinforcement shall be cleaned and incorporated into the new construction. Cost included with Removal of Existing Superstructures.
- Removal shall be performed in accordance with Article 501.05 of the Standard Specifications. The cost for this work is included in the Item "Removal of Existing Superstructures." Contractor is reminded that chipping hammers shall be limited to 15 pounds when within 1'-0" of elements to remain in place. When outside the 1'-0" limit a maximum 1200 lb may be used provided the elements to remain are not damaged. Repair to damaged elements to remain shall be the responsibility of the Contractor.
- See Sheets S-4, S-6 and S-7 for additional Superstructure Details.
- See Sheet S-6 for Superstructure Bill of Material.
- Incidental excavation required behind abutments shall be done according to the applicable portions of Section 502 of the Standard Specifications. The cost shall be included in Pavement Removal.
- The cost for drilling and epoxy grouting bars shall be included in Reinforcement Bars, Epoxy Coated.

COMPANY NAME: HRGreen
PROJECT CONTACT: HRGreen
CLIENT: HRGreen
DATE PLOTTED: 4/11/2011 8:55:53 AM
FILE NAME: 8510001-10e02.dgn
PLOT DRIVER: perf.plt
STANDARD: TRANS.TBL



USER NAME = Kof-f	DESIGNED - KMA	REVISED -
PLOT SCALE = N.T.S.	CHECKED - RGD	REVISED -
PLOT DATE = 4/11/2011	DRAWN - WJH	REVISED -
	CHECKED - 4/11/11	REVISED -

STATE OF ILLINOIS
DEPARTMENT OF TRANSPORTATION

CROSS SECTION AND SUPERSTRUCTURE DETAILS
FAIRVIEW BOULEVARD - S.N. 101-6060

SHEET NO. S-5 OF S-11 SHEETS

F.A. RTE.	SECTION	COUNTY	TOTAL SHEETS	SHEET NO.
5141	10-00573-00-BR	WINNEBAGO	20	13
CONTRACT NO. 85540			ILLINOIS FED. AID PROJECT	

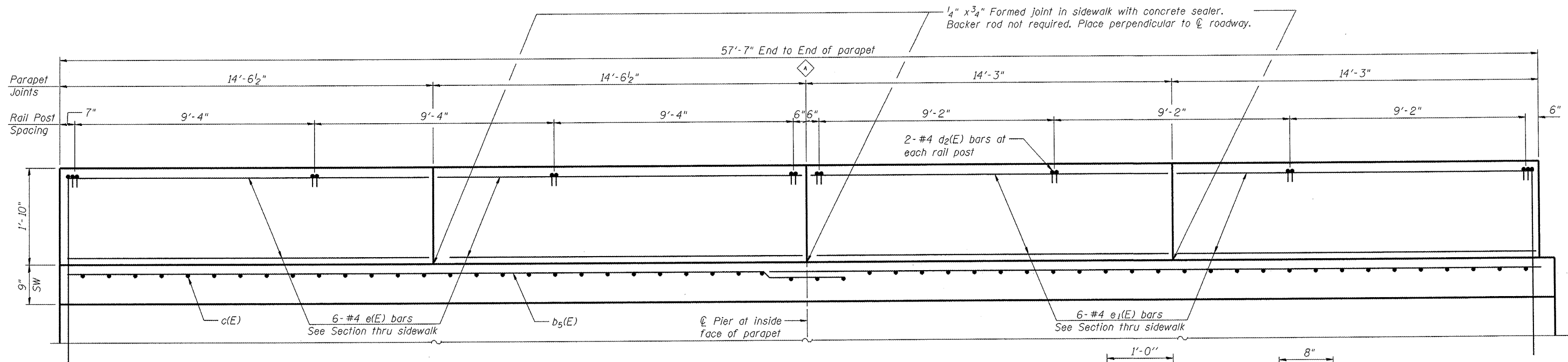

INSIDE PARAPET ELEVATION

See S-8

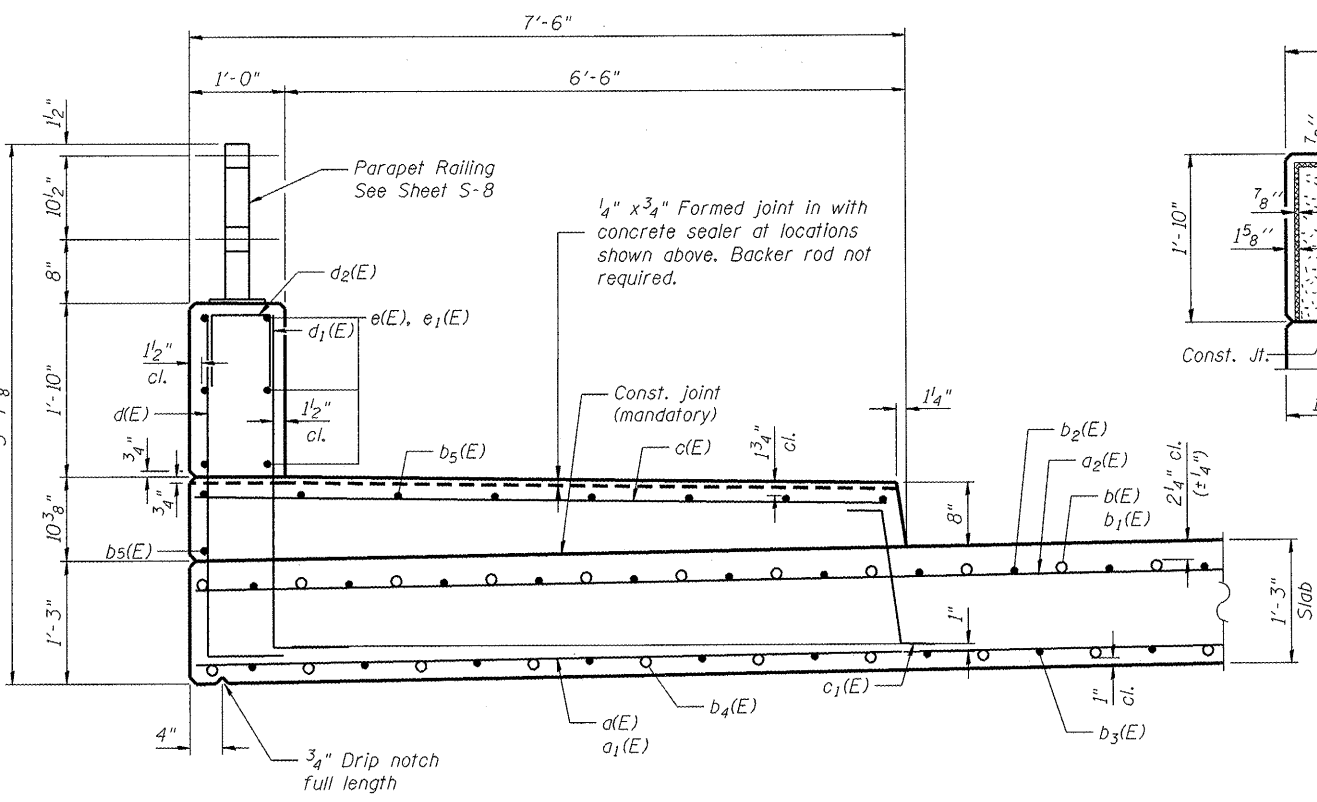

SECTION THRU SIDEWALK

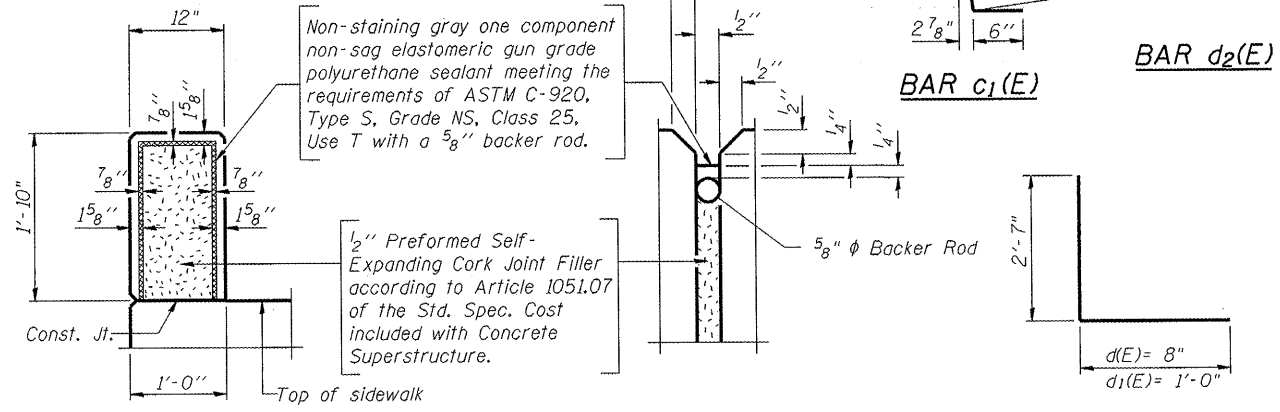

PARAPET JOINT DETAILS

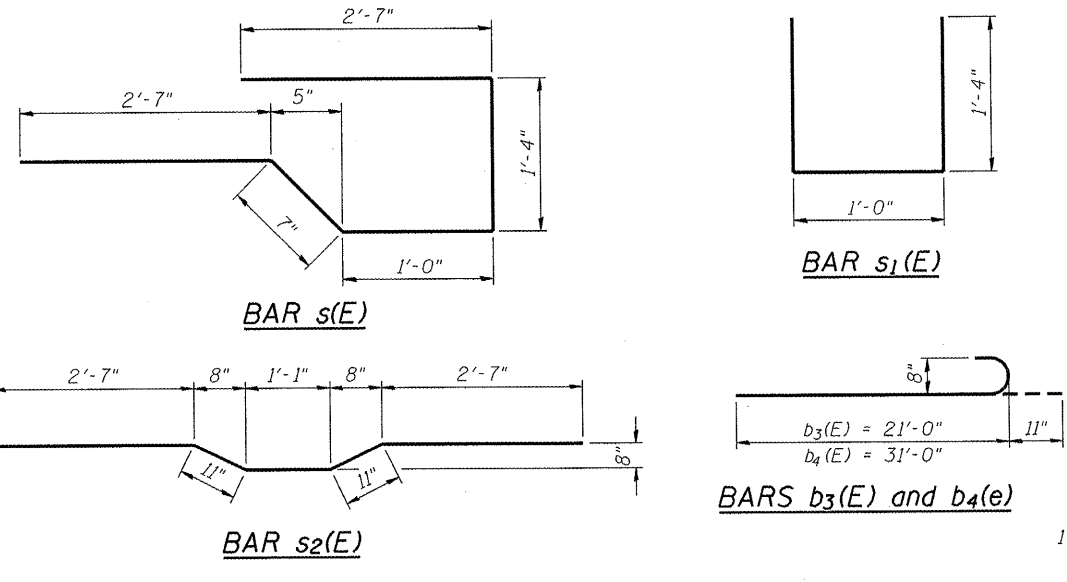

SUPERSTRUCTURE BILL OF MATERIAL

Bar	No.	Size	Length	Shape
a(E)	59	#7	40'-0"	
a1(E)	59	#7	29'-10"	
a2(E)	80	#5	34'-4"	
a3(E)	30	#5	27'-3"	
b(E)	66	#8	20'-0"	
b1(E)	67	#8	31'-6"	
b2(E)	134	#5	17'-10"	
b3(E)	112	#8	21'-11"	
b4(E)	114	#8	31'-11"	
b5(E)	32	#5	30'-5"	
c(E)	122	#5	7'-2"	
c1(E)	122	#5	3'-1"	
d(E)	122	#4	3'-3"	
d1(E)	122	#6	3'-7"	
d2(E)	32	#4	2'-2"	
e(E)	24	#4	14'-2"	
e1(E)	24	#4	13'-11"	
f(E)	36	#6	27'-4"	
h(E)	8	#5	8'-4"	
s(E)	114	#5	8'-1"	
s1(E)	114	#5	3'-8"	
s2(E)	57	#5	8'-1"	
v(E)	308	#5	3'-1"	
v1(E)	80	#4	2'-6"	
v2(E)	102	#5	1'-11"	
u(E)	6	#5	7'-2"	
Concrete Superstructure			Cu. Yd.	240.4
Reinforcement Bars, Epoxy Coated			Pound	48,590
Bridge Deck Grooving			Sq. Yd.	317
Protective Coat			Sq. Yd.	459

Bars indicated thus 1 x 3-#5 etc. indicates 1 line of bars with 3 lengths per line.

COMPANY NAME: HRGreen.com
 PROJECT CONTACT: CONTACT7
 CLIENT: CLIENT1
 DATE PLOTTED: 08/08/2011 10:56:51 AM
 FILE NAME: 08100201-Sub11.dwg
 PLOT DRIVER: pdfplot
 PEN TABLE: Struct 22x34.tbl



USER NAME = Karft	DESIGNED - KMA	REVISED -
PLOT SCALE = N.T.S.	CHECKED - RGD	REVISED -
PLOT DATE = 3/31/2011	DRAWN - WJH	REVISED -
	CHECKED - 3/31/11	REVISED -

STATE OF ILLINOIS DEPARTMENT OF TRANSPORTATION

SUPERSTRUCTURE DETAILS FAIRVIEW BOULEVARD - S.N. 101-6060

SHEET NO. S-6 OF S-11 SHEETS

F.A. RTE.	SECTION	COUNTY	TOTAL SHEETS	SHEET NO.
5141	10-00573-00-BR	WINNEBAGO	20	14
CONTRACT NO. 85540			ILLINOIS FED. AID PROJECT	

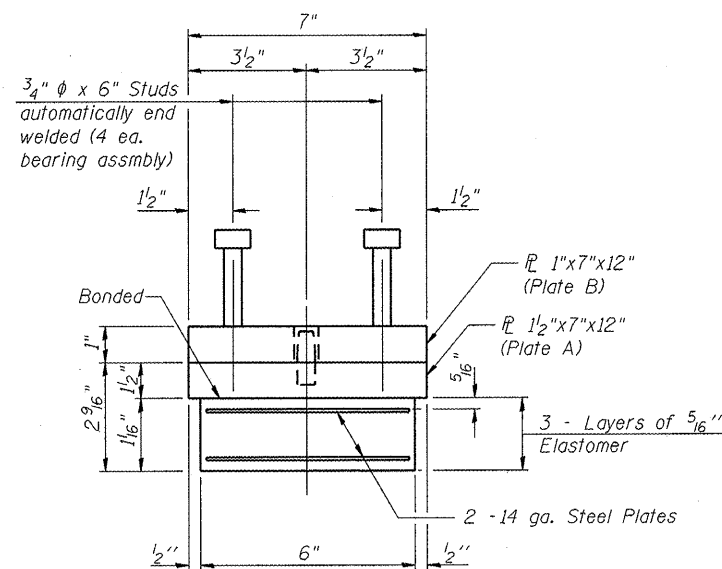

BEARING ASSEMBLY

Note:
Shim plates shall not be placed under Bearing Assembly.

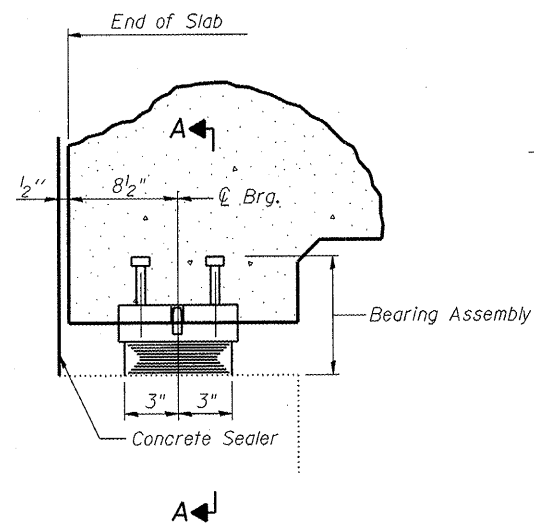

ELEVATION AT ABUT.
Horizontal dimensions at right L's

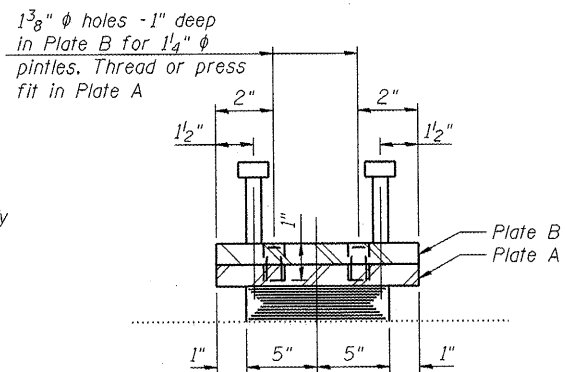

SECTION A-A

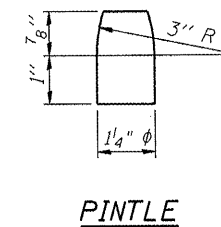

PINTLE

TYPE I ELASTOMERIC EXP. BRG.

Notes:
Pintles, studs and other steel members required for the elastomeric bearing assembly shall be included in the cost of Elastomeric Bearing Assembly, Type I.

Shim plates shall not be placed under Bearing Assembly.

All (embedded and separate) bearing plates, studs, and pintles shall be galvanized according to AASHTO M111 or M232 as applicable.

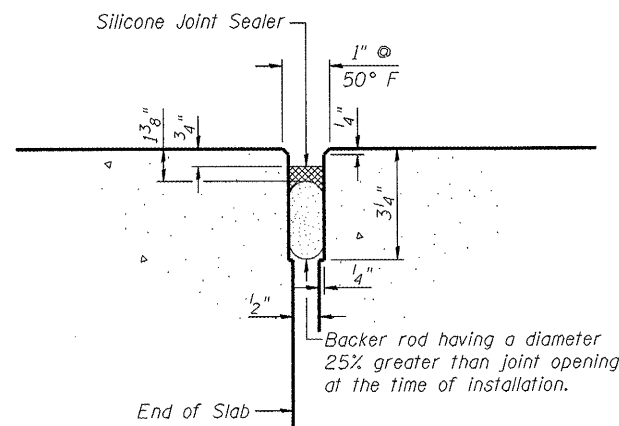

SILICONE JOINT SEALER

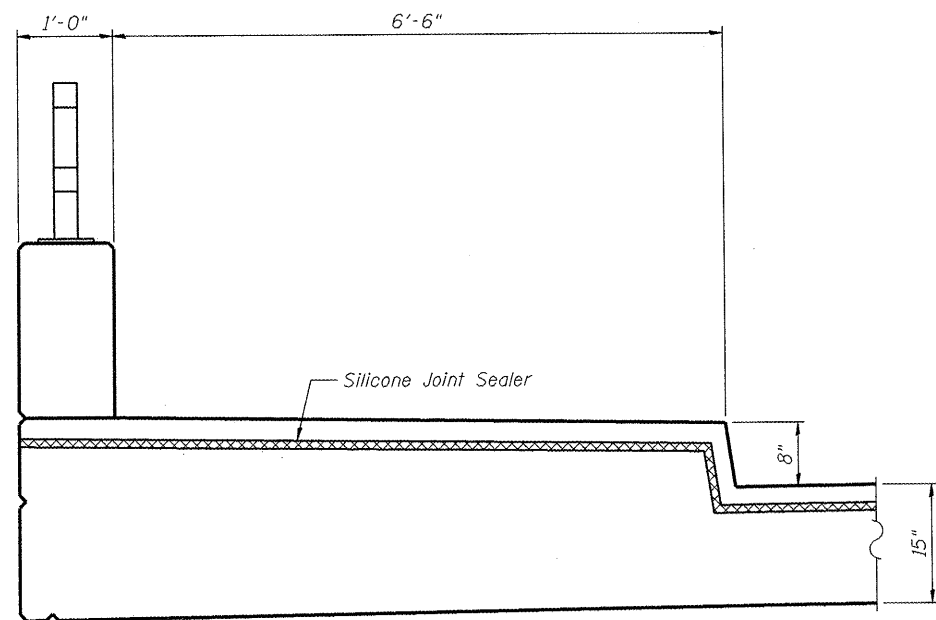

SECTION AT SIDEWALK

BILL OF MATERIAL

Item	Unit	Total
Elastomeric Bearing Assembly Type I	Each	24
Silicone Joint Sealer, 1"	Foot	155

COMPANY NAME: HRGreen
PROJECT CONTACT: HRGreen
CLIENT: OTTECH
FILE NAME: 86100201-Brp-ppp
PLOT DRIVER: pdfcut
PEN TABLE: Struct 22x34.tbl



USER NAME: Korf
PLOT SCALE: N.T.S.
PLOT DATE: 3/31/2011

DESIGNED - KMA
CHECKED - RGD
DRAWN - WJH
CHECKED - 3/31/11

REVISED -
REVISED -
REVISED -
REVISED -

STATE OF ILLINOIS
DEPARTMENT OF TRANSPORTATION

BEARING AND EXPANSION JOINT DETAILS
FAIRVIEW BOULEVARD - S.N. 101-6060

SHEET NO. 5-7 OF 5-11 SHEETS

F.A. RTE.	SECTION	COUNTY	TOTAL SHEETS	SHEET NO.
5141	10-00573-00-BR	WINNEBAGO	20	15
CONTRACT NO. 85540			ILLINOIS FED. AID PROJECT	

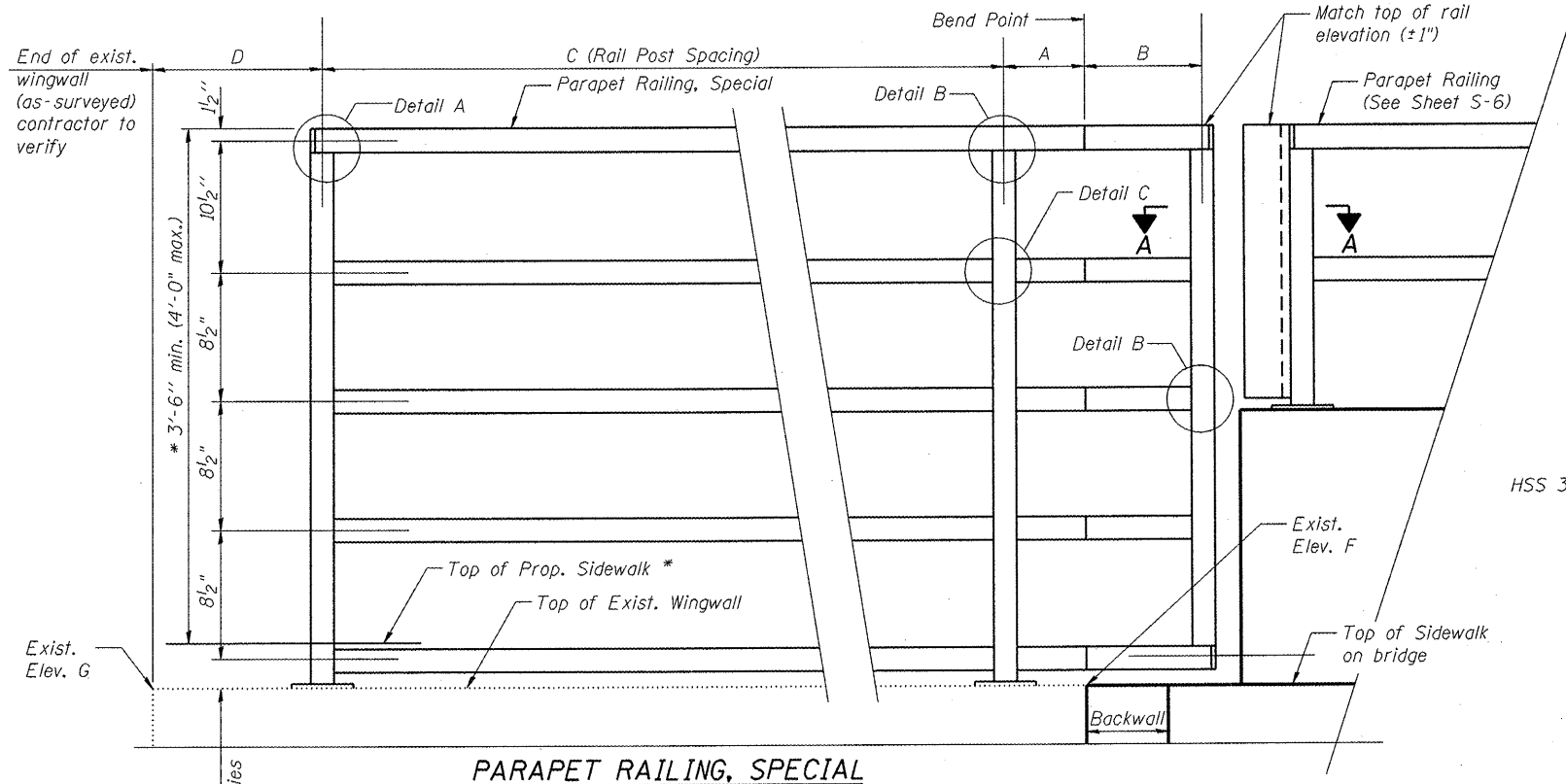

PARAPET RAILING, SPECIAL

Looking at inside face
Northeast corner shown;
other corners similar

* Coordinate with Sidewalk Detail
at end of bridge on Sheet S-2

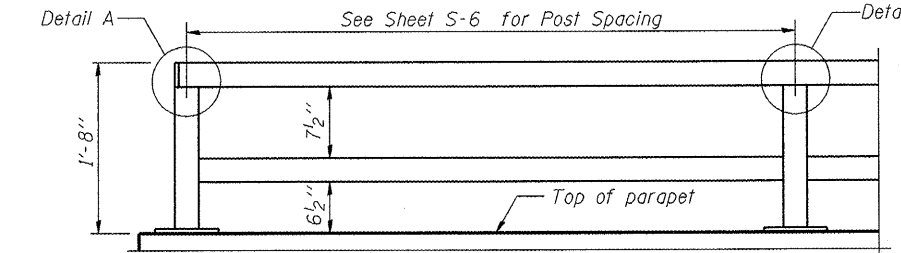

**PARAPET RAILING
ELEVATION**
(Inside Face of Two Element Rail)

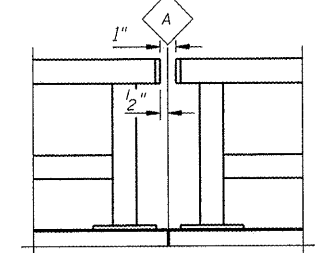

**PARAPET RAILING
ELEVATION AT EXPANSION JOINT**

See Sheet S-6

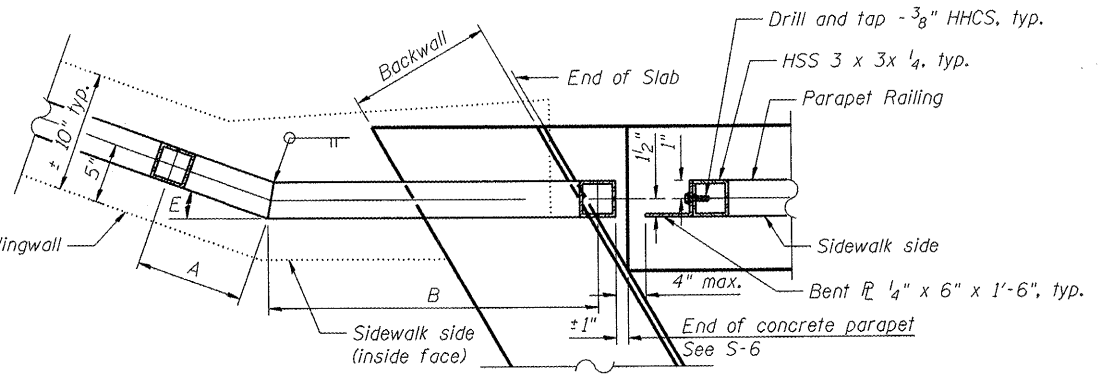

SECTION A-A

Northeast Corner shown
Southeast Corner similar,
but opposite hand

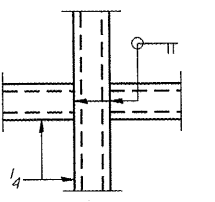

DETAIL C

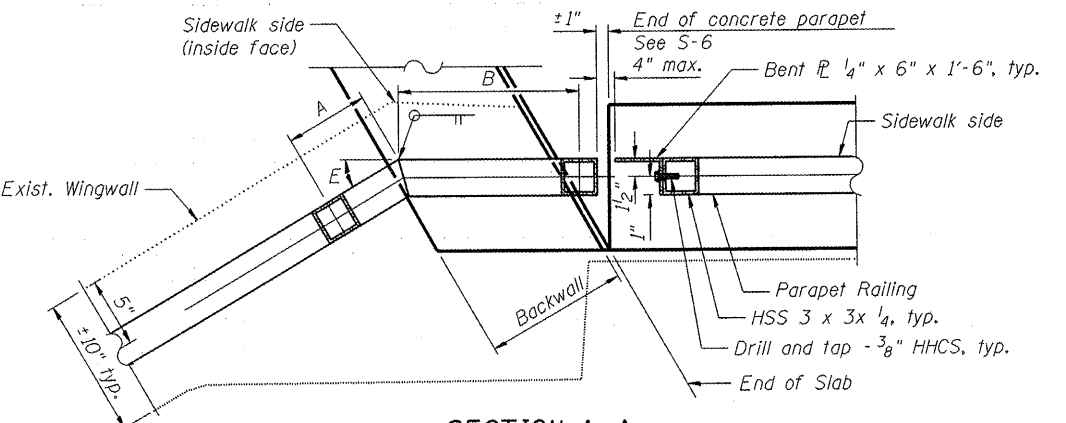

SECTION A-A

Northwest Corner shown
Southeast Corner similar,
but opposite hand

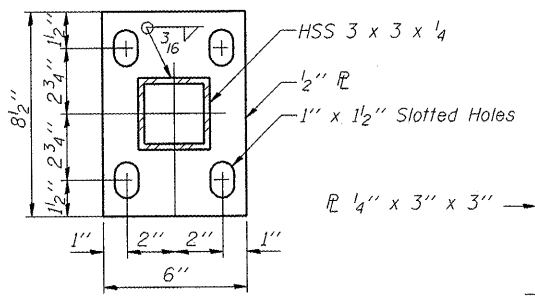

BASE PL

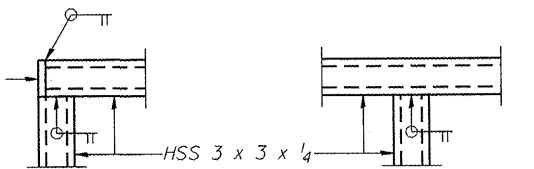

DETAIL A

DETAIL B

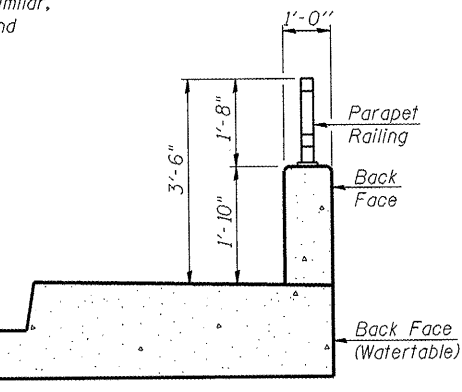

SECTION THRU SIDEWALK

All steel rail elements shall be galvanized according
to Article 509.05 of the Standard Specifications.

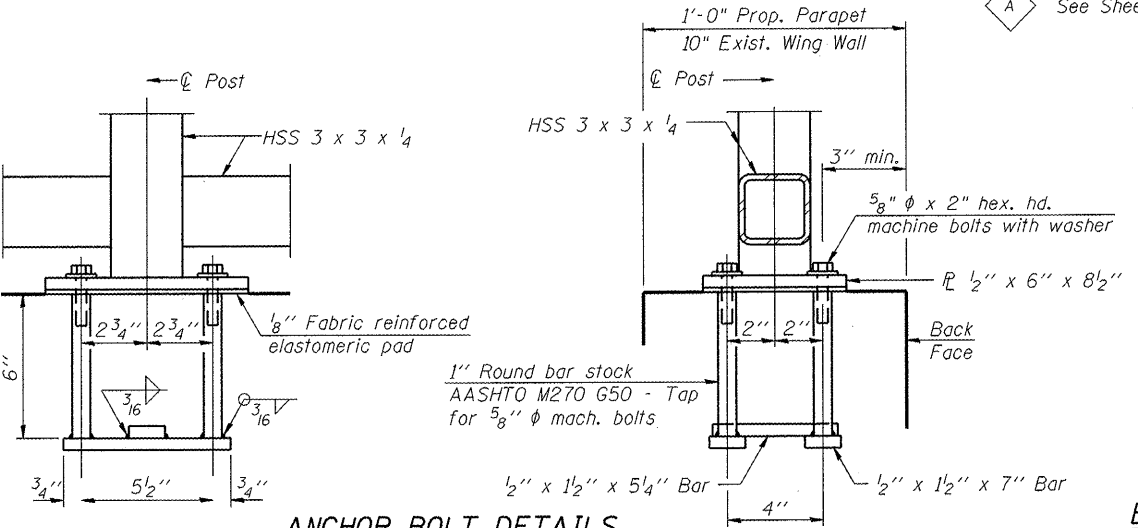

ANCHOR BOLT DETAILS

In lieu of the cast-in-place anchor device shown, the Contractor has the option
of drilling and setting 5/8" ϕ anchor rods according to Article 509.06 of the
Standard Specifications. Embedment shall be according to the manufacturer's
specifications. Anchor rods shall be used for Parapet Railings, Special.

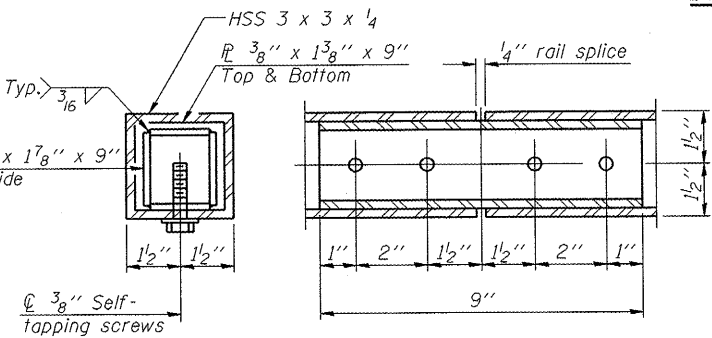

RAIL SPLICE

BILL OF MATERIAL

Item	Unit	Quantity
Parapet Railing	Foot	113
Parapet Railing, Special	Foot	59

TABLE OF DIMENSIONS

Location	A	B	C	D	E	F	G
NW Corner	7"	1'-3 1/8"	1 spa. At 10'-0"=10'-0"	5'-8 3/8"	30°20'	749.15	749.03
SE Corner	7"	1'-2 3/4"	1 spa. At 10'-0"=10'-0"	3'-9 1/8"	29°23'	749.15	749.02
NE Corner	9"	2'-3 5/8"	2 spa. At 7'-6"=15'-0"	7'-7"	19°37'	749.16	749.16
SW Corner	11 1/8"	1'-2 1/4"	2 spa. At 7'-6"=15'-0"	8'-5 1/4"	19°51'	749.15	749.04

COMPANY NAME: HRGreen.com
PROJECT CONTACT: HRGreen.com
CLIENT: OTTECH
FILE NAME: 06100201-680.dwg
PLOT DRIVER: pldrvr
PEN TABLE: S:\Struct 22x34.tbl

HRGreen.com
Illinois Professional Design Firm
#184-001322

USER NAME = KarFt	DESIGNED - KMA	REVISED -
PLOT SCALE = N.T.S.	CHECKED - RGD	REVISED -
PLOT DATE = 3/31/2011	DRAWN - WJH	REVISED -
	CHECKED - 3/31/11	REVISED -

**STATE OF ILLINOIS
DEPARTMENT OF TRANSPORTATION**

RAILING DETAILS
FAIRVIEW BOULEVARD - S.N. 101-6060

F.A. RTE.	SECTION	COUNTY	TOTAL SHEETS	SHEET NO.
5141	10-00573-00-BR	WINNEBAGO	20	16
CONTRACT NO. 85540			ILLINOIS FED. AID PROJECT	

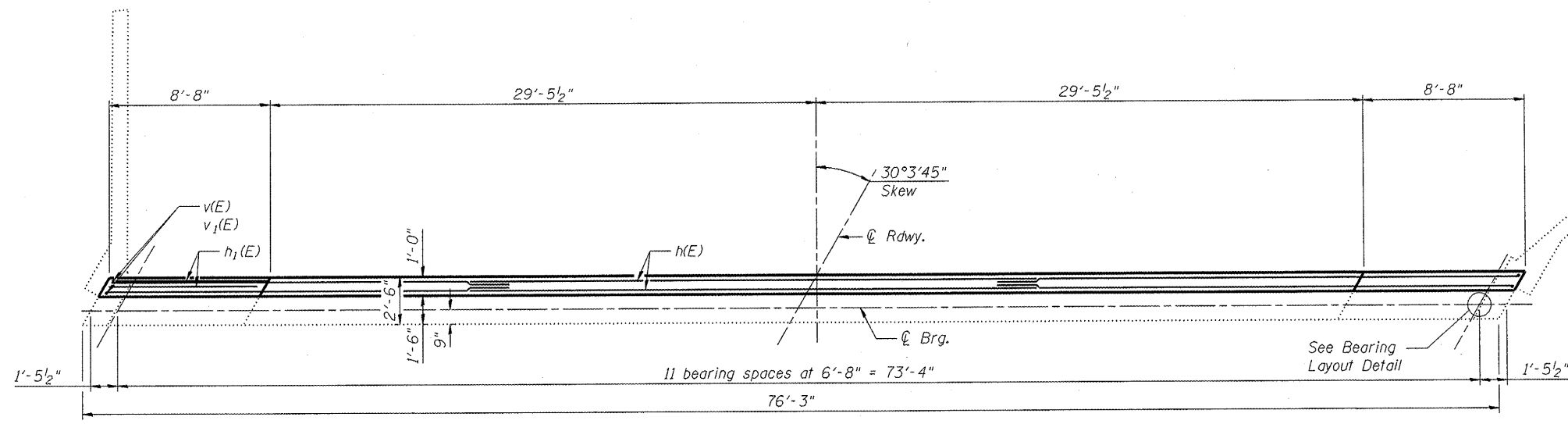

PLAN

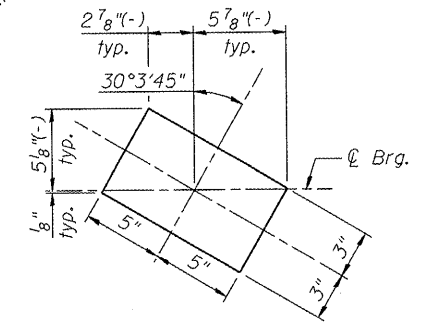

BEARING LAYOUT DETAIL
See Sheet S-7 for Bearing Details

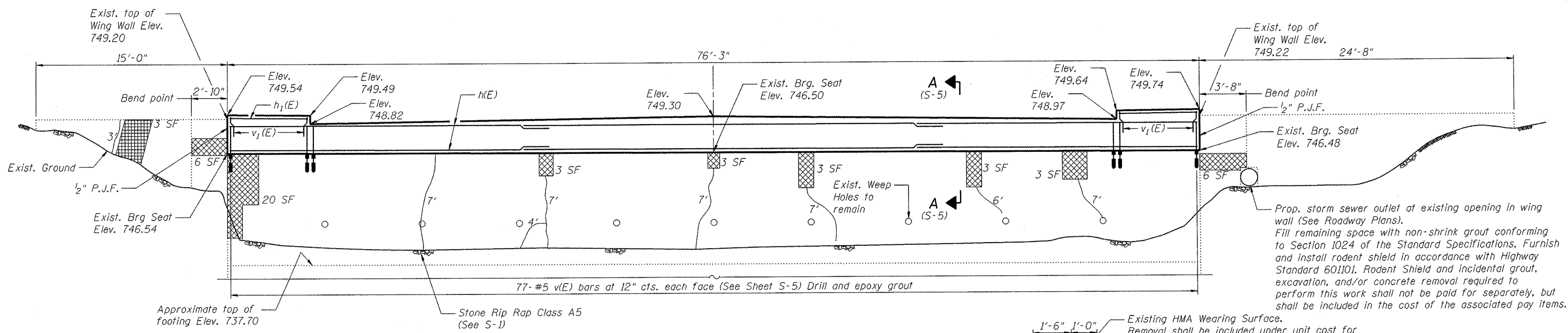

ELEVATION

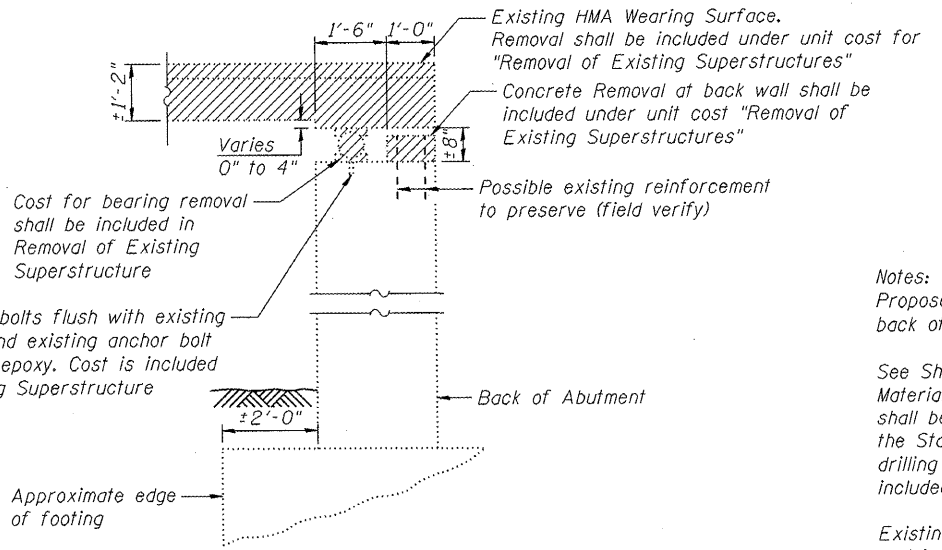

REMOVAL SECTION THRU ABUT.
Horizontal dimensions at Rt. L's

Notes:
Proposed Elevations are given at the back of abutment.
See Sheet S-6 for superstructure Bill of Materials. Drilling and epoxy grouting bars shall be in accordance with Section 584 of the Standard Specifications. The cost for drilling and epoxy grouting bars shall be included in Reinforcement Bars, Epoxy Coated.
Existing reinforcement shall be cleaned and incorporated into the new construction. Cost included with Removal of Existing Superstructures.

LEGEND
 x SF Indicates Structural Repair of Concrete (Depth less than or Equal to 5")
 x' Indicates Epoxy Crack Injection
 [Hatched Box] Indicates Removal Item

COMPANY NAME: HRGreen
 PROJECT CONTACT: CONTACT
 CLIENT: CONTACT
 FILE NAME: 101101-5001.rvt
 PLOT DRIVER: P:\Struct\22x34.tbl
 PLOT DATE: 3/31/2011



USER NAME = Kar-Ft	DESIGNED - KMA	REVISED -
PLOT SCALE = N.T.S.	CHECKED - RGD	REVISED -
PLOT DATE = 3/31/2011	DRAWN - WJH	REVISED -
	CHECKED - 3/31/11	REVISED -

STATE OF ILLINOIS
 DEPARTMENT OF TRANSPORTATION

SOUTH ABUTMENT DETAILS
 FAIRVIEW BOULEVARD - S.N. 101-6060
 SHEET NO. S-9 OF S-11 SHEETS

F.A. RTE.	SECTION	COUNTY	TOTAL SHEETS	SHEET NO.
5141	10-00573-00-BR	WINNEBAGO	20	17
CONTRACT NO. 85540				
ILLINOIS FED. AID PROJECT				

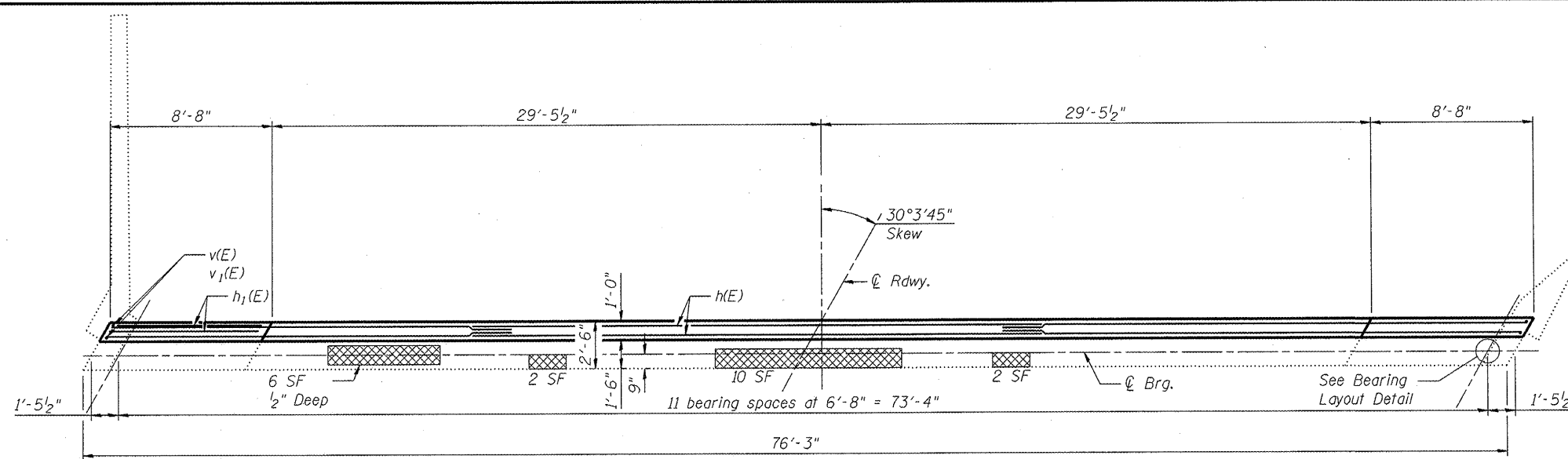

PLAN

BEARING LAYOUT DETAIL

See Sheet S-7 for Bearing Details

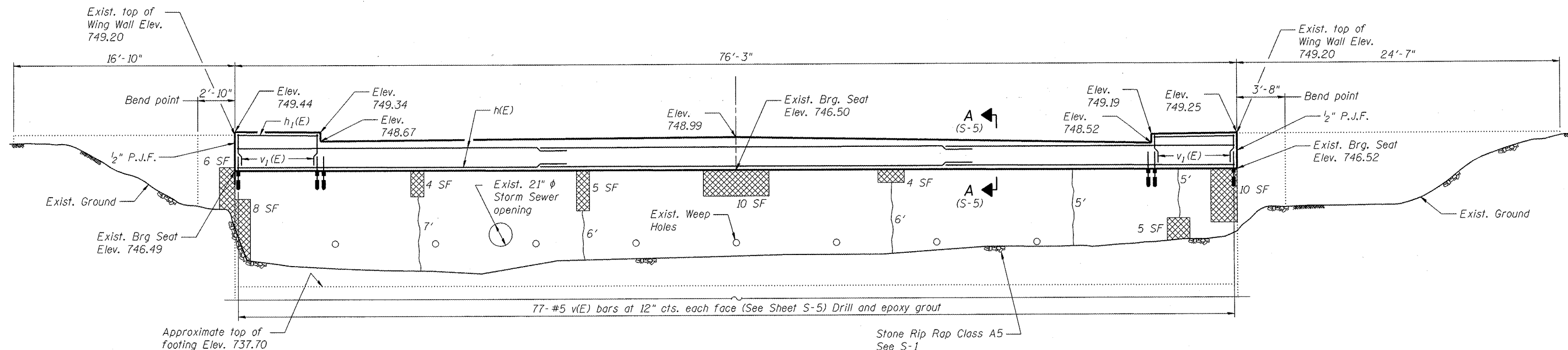
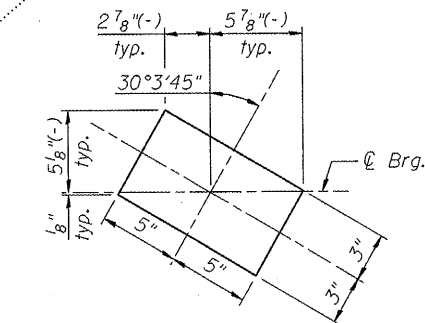

ELEVATION

Notes:
Proposed Elevations are given at the back of abutment.

See S-9 for Removal Section Thru Abutment

See Sheet S-6 for superstructure Bill of Materials. Drilling and epoxy grouting bars shall be in accordance with Section 584 of the Standard Specifications. The cost for drilling and epoxy grouting bars shall be included in Reinforcement Bars, Epoxy Coated.

Existing reinforcement shall be cleaned and incorporated into the new construction. Cost included with Removal of Existing Superstructures.

LEGEND

- x SF Indicates Structural Repair of Concrete (Depth less than or Equal to 5")
- x' Indicates Epoxy Crack Injection
- Indicates Removal Item

COMPANY NAME: HRGreen
 PROJECT CONTACT: HRGreen
 CLIENT: HRGreen
 FILE NAME: HRGreen
 PLOT DRIVER: HRGreen
 PEN TABLE: HRGreen



USER NAME = Karft	DESIGNED - KMA	REVISED -
PLOT SCALE = N.T.S.	CHECKED - RGD	REVISED -
PLOT DATE = 3/31/2011	DRAWN - WJH	REVISED -
	CHECKED - 3/31/11	REVISED -

STATE OF ILLINOIS
DEPARTMENT OF TRANSPORTATION

NORTH ABUTMENT DETAILS
FAIRVIEW BOULEVARD - S.N. 101-6060

SHEET NO. S-10 OF S-11 SHEETS

F.A. RTE.	SECTION	COUNTY	TOTAL SHEETS	SHEET NO.
5141	10-00573-00-BR	WINNEBAGO	20	18
CONTRACT NO. 85540			ILLINOIS FED. AID PROJECT	

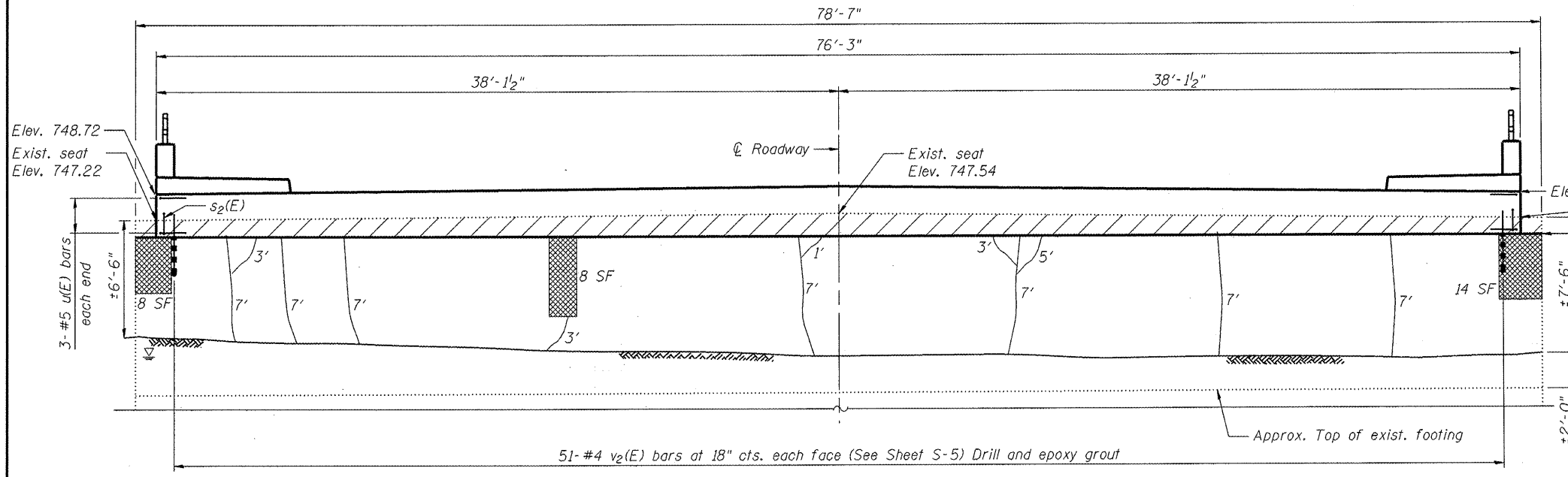

PIER ELEVATION
South Face Looking North

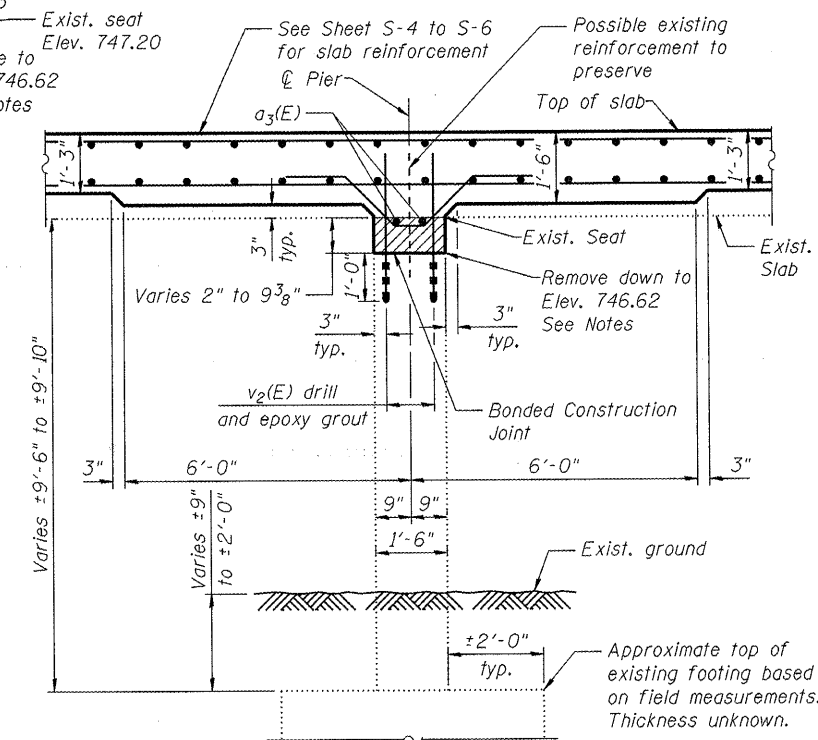

SECTION THRU PIER
Horizontal dimensions at Rt. L's

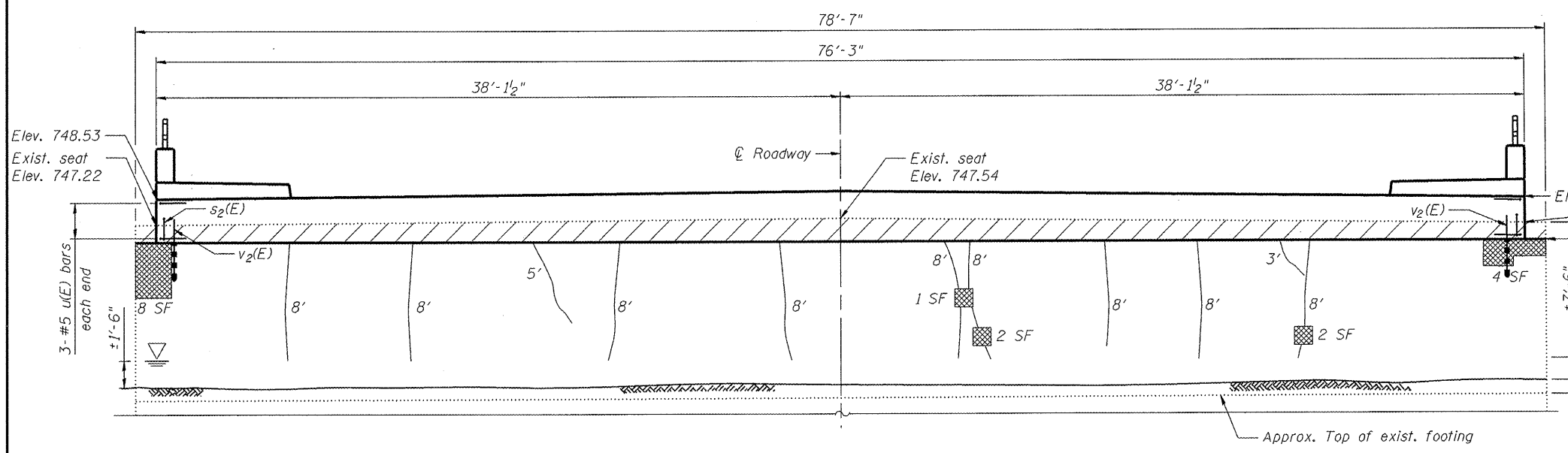

PIER ELEVATION
North Face Looking South

LEGEND

- Indicates Removal Item (See Notes)
- Indicates Structural Repair of Concrete (Depth less than or Equal to 5')
- Indicates Epoxy Crack Injection

Notes:
Existing reinforcement shall be cleaned and incorporated into the new construction. Cost included with Removal of Existing Superstructures.
Concrete removal at pier shall be in accordance with Section 501 of the Standard Specifications. Cost included in Removal of Existing Superstructures.
See Sheet S-6 for superstructure Bill of Materials. Drilling and epoxy grouting bars shall be in accordance with Section 584 of the Standard specifications. The cost for drilling and epoxy grouting bars shall be included in Reinforcement Bars, Epoxy Coated.

COMPANY NAME: HRGreen
 PROJECT CONTACT: HRGreen
 CLIENT: ILL. DOT
 FILE NAME: 10-00573-00-BR
 PLOT DRIVER: pldrvr
 PLOT DATE: 3/31/11



USER NAME = Karft	DESIGNED - KMA	REVISED -
	CHECKED - RGD	REVISED -
PLOT SCALE = N.T.S.	DRAWN - WJH	REVISED -
PLOT DATE = 3/31/11	CHECKED - 3/31/11	REVISED -

**STATE OF ILLINOIS
DEPARTMENT OF TRANSPORTATION**

PIER DETAILS
FAIRVIEW BOULEVARD - S.N. 101-6060
SHEET NO. S-11 OF S-11 SHEETS

F.A. RTE.	SECTION	COUNTY	TOTAL SHEETS	SHEET NO.
5141	10-00573-00-BR	WINNEBAGO	20	19
CONTRACT NO. 85540				
ILLINOIS FED. AID PROJECT				

COMPANY NAME: HRGreen
 CLIENT: CONTACT
 DATE PLOTTED: 3/31/2011 7:56:13 AM
 FILE NAME: 86100021-ss.dgn
 PLOT DRIVER: pdfcut
 PEN TABLE: Struct 2x24.tbl

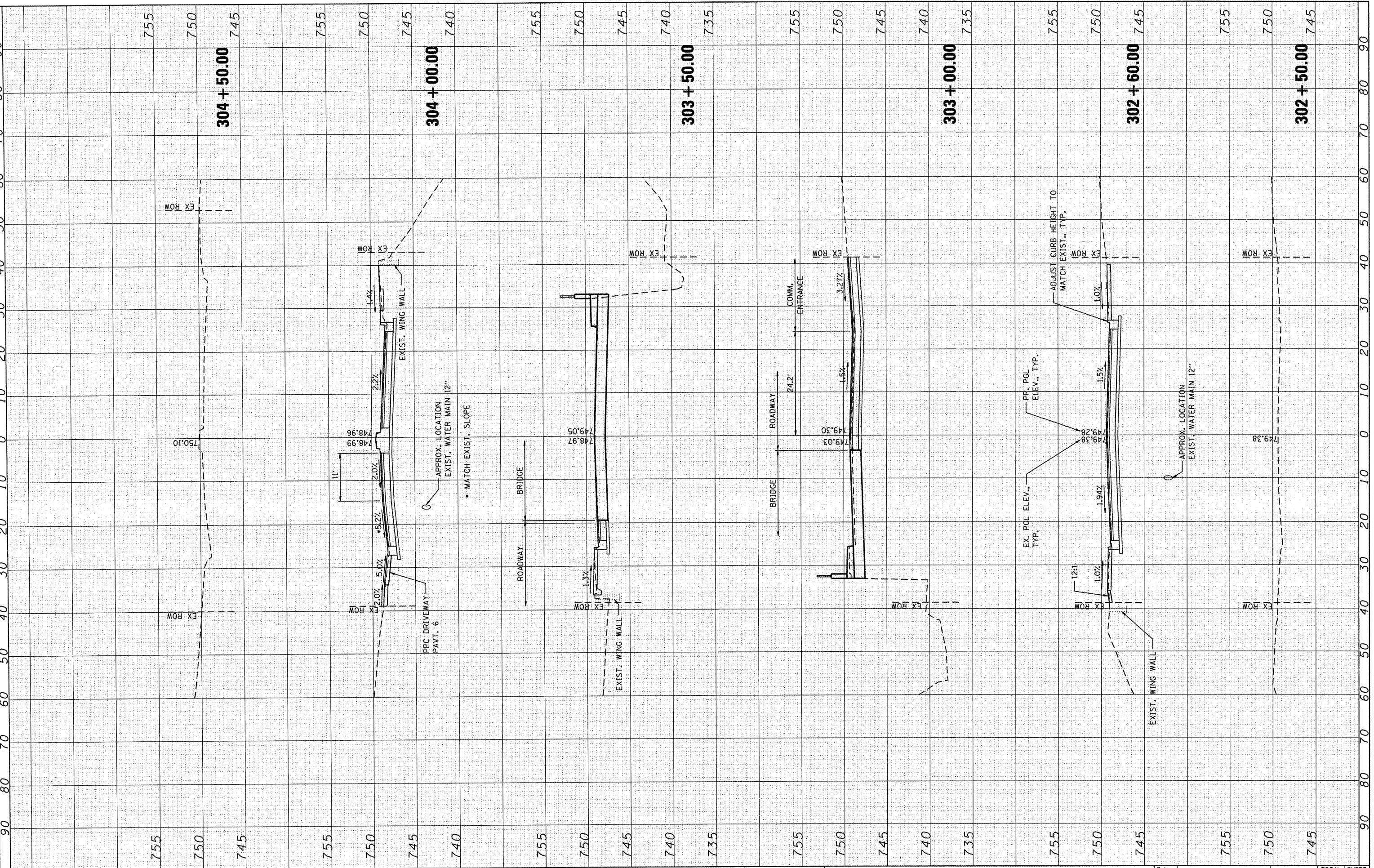

USER NAME = Ker-ft	DESIGNED - KMA	REVISED -
FILE NAME = 86100021-ss.dgn	DRAWN - WJH	REVISED -
PLOT SCALE = 10H:5V	CHECKED - RGD	REVISED -
PLOT DATE = 3/31/2011	DATE - 3/31/11	REVISED -

CITY OF ROCKFORD

SCALE: 10H:5V		SHEET NO. 1 OF 1 SHEETS		STA. 302+50.00 TO STA. 304+50.00	
---------------	--	-------------------------	--	----------------------------------	--

CROSS SECTIONS
FAIRVIEW BOULEVARD OVER KEITH CREEK

F.A. RTE.	SECTION	COUNTY	TOTAL SHEETS	SHEET NO.
	10-00573-00-BR	Winnebago	20	20
CONTRACT NO.				
FED. ROAD DIST. NO. 2 ILLINOIS FED. AID PROJECT				