

1. ALL ADJUSTMENT OF EXISTING UTILITY VALVES, MANHOLES, ETC., NOT OWNED BY THE CITY OF JACKSONVILLE, WILL BE COORDINATED BY THE CONTRACTOR WITH THE INDIVIDUAL UTILITY.

PLAN	SURVEYED	DATE
	PLOTTED	
	CHECKED	
	BY	
	NO.	

PROFILE	SURVEYED	DATE
	PLOTTED	
	CHECKED	
	BY	
	NO.	

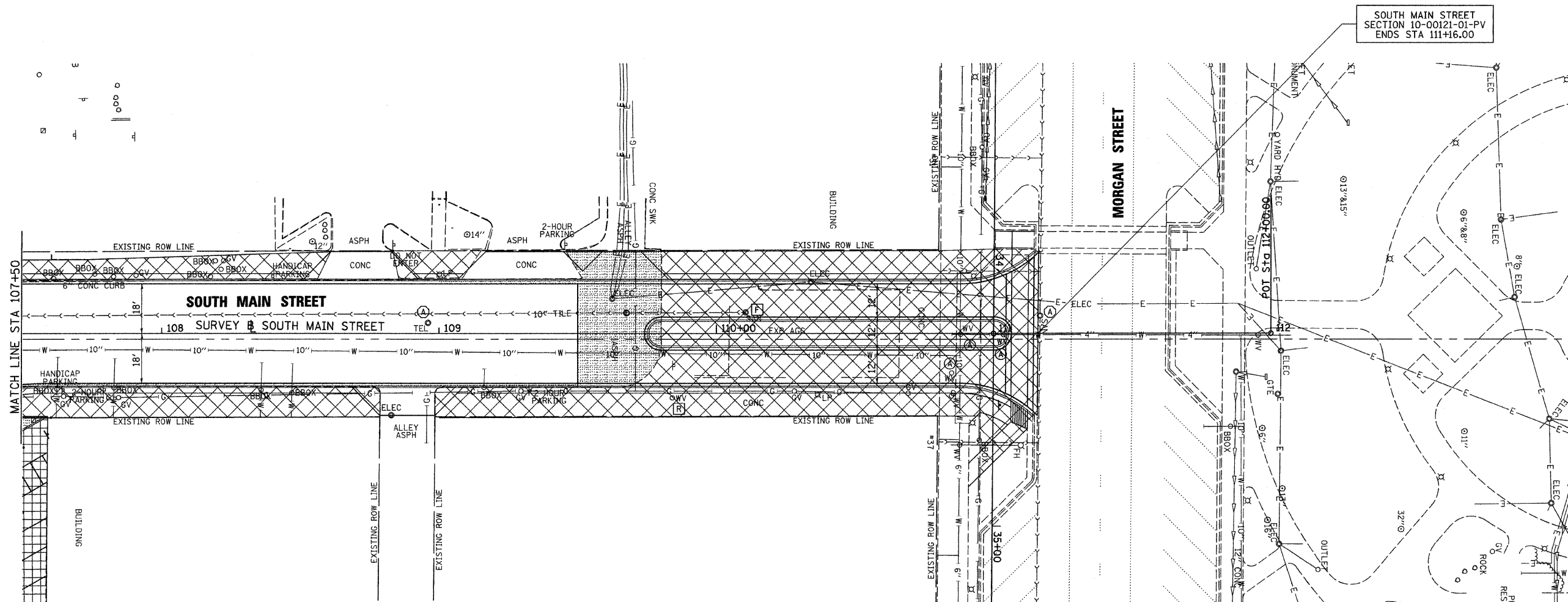

- LEGEND**
- (A) FRAME AND LID TO BE ADJUSTED
 - (A) DOMESTIC SERVICE BOX TO BE ADJUSTED
 - (A) WATER VALVE TO BE ADJUSTED
 - (R) STRUCTURE TO BE REMOVED
 - (F) STRUCTURE TO BE FILLED
 - (AB) STRUCTURE TO BE ABANDONED
 - (ADJ) STRUCTURE TO BE ADJUSTED
 - [Hatched Box] PAVEMENT REMOVAL
 - [Vertical Lines Box] PAVEMENT PATCHING
 - [Horizontal Lines Box] HOT-MIX ASPHALT SURFACE REMOVAL
 - [Cross-hatched Box] CURB & GUTTER, SIDEWALK, ETC. TO BE REMOVED
 - [Dotted Box] DRIVEWAY PAVEMENT REMOVAL

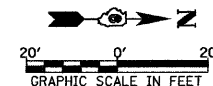

FILE NAME = V:\Transportation\2893\SM1NR002.dgn	USER NAME = joison	DESIGNED - JRB	REVISED -	STATE OF ILLINOIS DEPARTMENT OF TRANSPORTATION	CITY OF JACKSONVILLE DOWNTOWN STREETS RECONSTRUCTION SOUTH MAIN STREET REMOVAL SHEET	F.A. RTE.	SECTION	COUNTY	TOTAL SHEETS	SHEET NO.	
	PLOT SCALE = 20,0000' / IN.	DRAWN - JMO	REVISED -			N/A	10-00121-01-PV	MORGAN	77	19	
	PLOT DATE = 2/23/2011	CHECKED - JRB	REVISED -			CONTRACT NO. 93547					
		DATE - 2/22/11	REVISED -			SCALE: 1" = 20'	SHEET NO.	OF	SHEETS	STA. 107+50.00 TO STA. 111+00.00	FED. ROAD DIST. NO.