

NOTE: ADDITIONAL CABLING MAY BE REQUIRED FOR THE ACCESSIBLE PEDESTRIAN SIGNALS PER THE MANUFACTURERS REQUIREMENTS. SEE ACCESSIBLE PEDESTRIAN SIGNALS SPECIAL PROVISION FOR ADDITIONAL DETAILS.

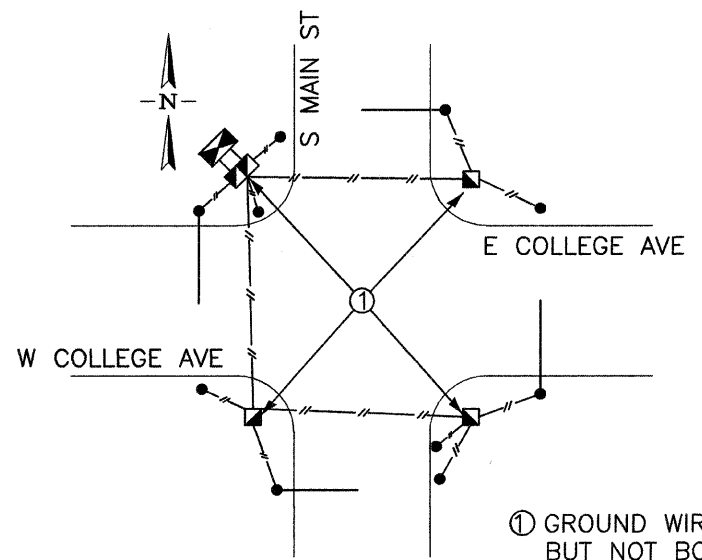

① GROUND WIRE SPLICE BUT NOT BONDED TO COMPOSITE HANDHOLE

GROUNDING SCHEMATIC

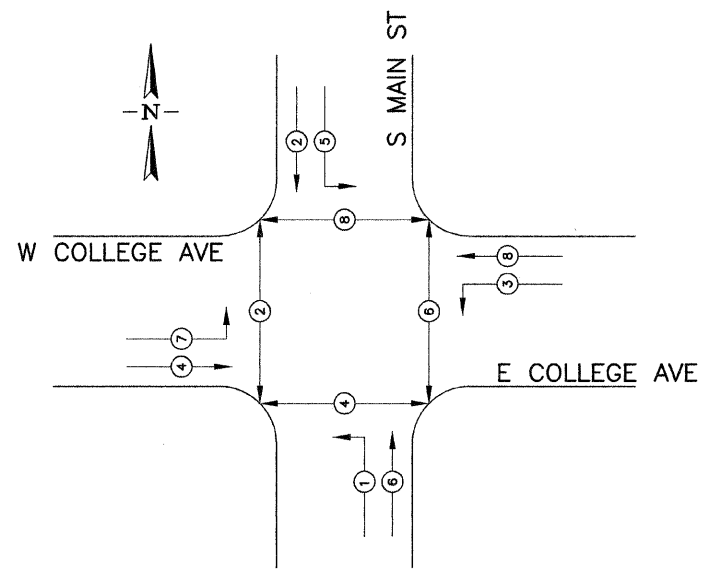

PHASE ASSIGNMENT

| | | | | | | | | | | | | |
|----------------------|------------------------|----------------|-----------|---|--|-----------|----|---------------|------------------------|---------------|---------------------------|--------------|
| FILE NAME = \$FILE\$ | USER NAME = \$USER\$ | DESIGNED — EF | REVISED — | STATE OF ILLINOIS DEPARTMENT OF TRANSPORTATION | CITY OF JACKSONVILLE DOWNTOWN STREETS CONSTRUCTION SOUTH MAIN ST & COLLEGE AVE - TRAFFIC SIGNAL | | | F.A. RTE. N/A | SECTION 10-00121-01-PV | COUNTY MORGAN | TOTAL SHEETS 77 | SHEET NO. 38 |
| | PLOT SCALE = \$SCALE\$ | DRAWN — MH | REVISED — | | SCALE: | SHEET NO. | OF | SHEETS | STA. | TO STA. | CONTRACT NO. 0354 | |
| | PLOT DATE = \$DATE\$ | CHECKED — RS | REVISED — | | | | | | | | ILLINOIS FED. AID PROJECT | |
| | | DATE — 2/21/11 | REVISED — | | | | | | | | | |