

UHRIG, ROBERT E  
ROBERT E UHRIG TRUST  
23-1-08-04-01-101-001

CONTRACT NO. 97456

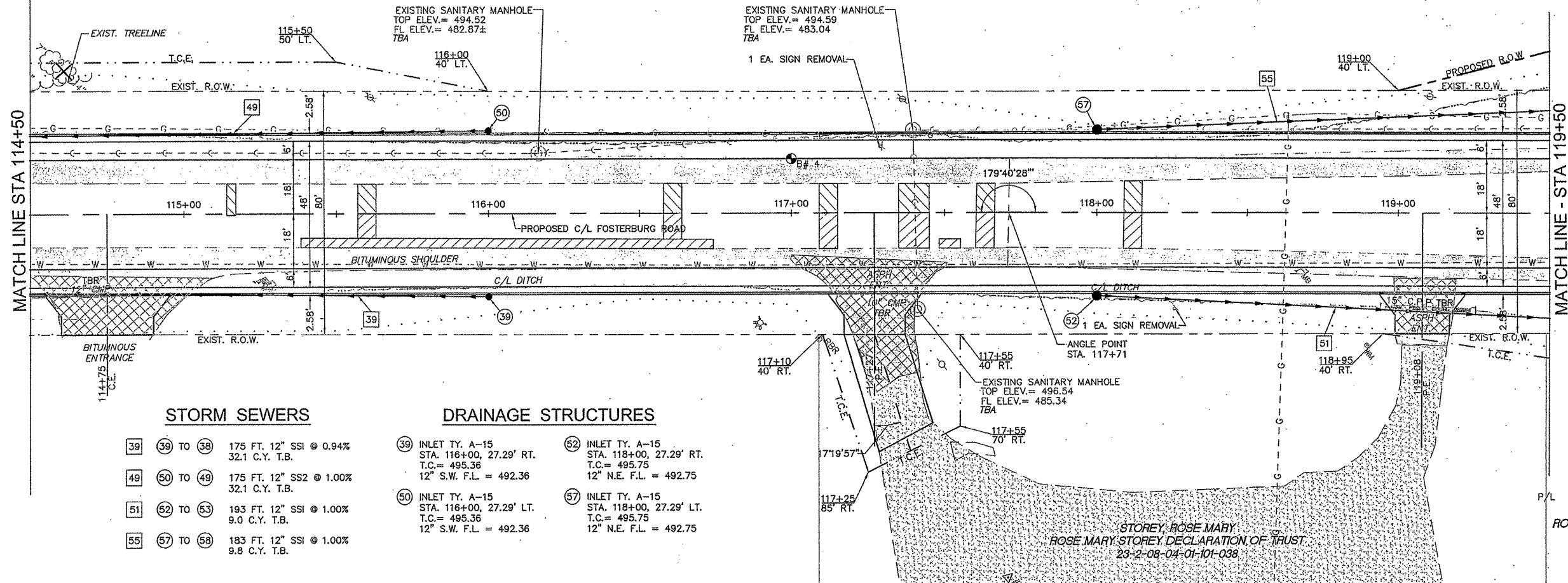
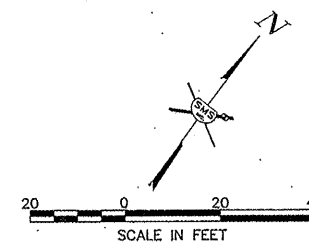

**STORM SEWERS**

- 39 39 TO 38 175 FT. 12" SSI @ 0.94%  
32.1 C.Y. T.B.
- 49 50 TO 49 175 FT. 12" SS2 @ 1.00%  
32.1 C.Y. T.B.
- 51 52 TO 53 193 FT. 12" SSI @ 1.00%  
9.0 C.Y. T.B.
- 55 57 TO 58 183 FT. 12" SSI @ 1.00%  
9.8 C.Y. T.B.

**DRAINAGE STRUCTURES**

- 39 INLET TY. A-15  
STA. 116+00, 27.29' RT.  
T.C. = 495.36  
12" S.W. F.L. = 492.36
- 50 INLET TY. A-15  
STA. 116+00, 27.29' LT.  
T.C. = 495.36  
12" S.W. F.L. = 492.36
- 52 INLET TY. A-15  
STA. 118+00, 27.29' RT.  
T.C. = 495.75  
12" N.E. F.L. = 492.75
- 57 INLET TY. A-15  
STA. 118+00, 27.29' LT.  
T.C. = 495.75  
12" N.E. F.L. = 492.75

STOREY, ROSE MARY  
ROSE MARY STOREY DECLARATION OF TRUST  
23-1-08-04-01-101-005.005

STOREY, ROSE MARY  
ROSE MARY STOREY DECLARATION OF TRUST  
23-1-08-04-01-101-005

REVISIONS

**SMS ENGINEERS**  
Sheppard, Morgan & Schwaab, Inc.  
CONSULTING ENGINEERS AND LAND SURVEYORS  
215 Market Street, P.O. Box E, Alton, IL 62002 6184623785 Email: mms@smsengineers.com  
10 Conrad Industrial Drive, Granite City, IL 62040 618877-4760 Email: mms@smsengineers.com  
DESIGN FIRM # 184-000992

BENCHMARKS: SEE SHEET NO. 2

Station	Proposed C/L Profile	Existing C/L Profile
114+50	494.74	485.20
115+00	494.85	495.41
115+50	495.03	495.55
116+00	495.16	495.70
116+50	495.30	495.82
117+00	495.42	495.94
117+50	495.52	496.08
118+00	495.69	496.20
118+50	495.74	496.34
119+00	495.88	496.40
119+50	495.94	496.40

CITY OF ALTON, ILLINOIS  
SECTION 05-00218-01-WR  
FOSTERBURG ROAD - PHASE 2  
PLAN AND PROFILE

DWG. NO. FBR PHS 2-PP6.dwg  
REF. BK. PG.  
JOB NO. 206612  
DSN. BY: DEG  
DWN. BY: CDP  
CHK. BY: DEG  
DATE: JAN, 2011  
SCALE: 1" = 20' H.  
1" = 5' V.  
SHEET 13 OF 55