

STAGE 2 CONSTRUCTION DETAIL

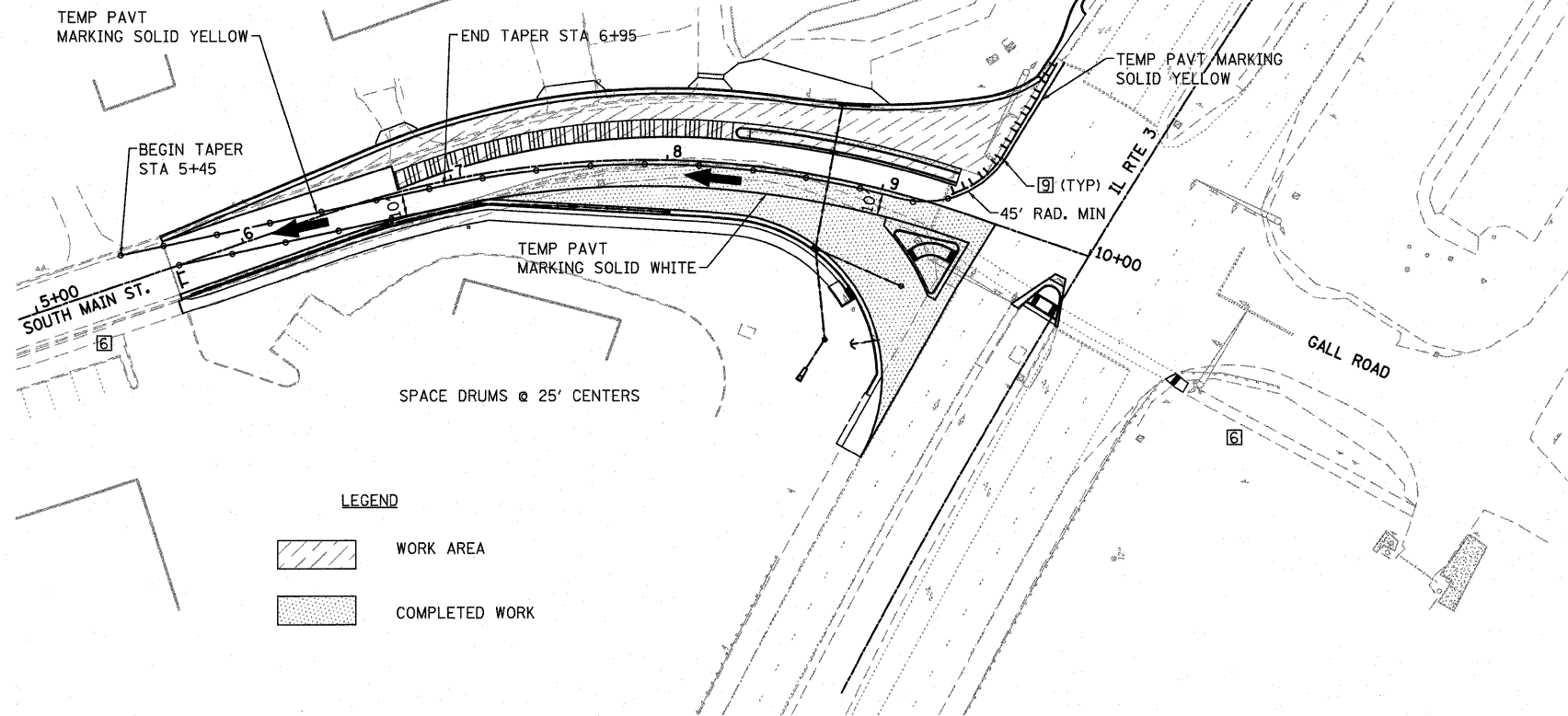
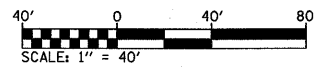

LEGEND

- WORK AREA
- COMPLETED WORK

LEGEND

- ROAD CLOSED AHEAD-W20-3(O)-48
 - ROAD CONSTRUCTION AHEAD-W20-1103(O)-48
 - WORKERS-W21-1d(O)-48
 - 24" x 24"
 - 24" x 24"
 - SIDEWALK CLOSED-R11-1101-2418
 - NO RIGHT TURN ON RED-R-10-11-1824
 - LOCAL BUSINESS OPEN 36" x 48" •
 - TYPE III BARRICADES, R-11-2-6030 (ROAD CLOSED) SIGNS, AND TYPE A LOW INTENSITY FLASHING LIGHTS
 - 24" x 18" 1/2 MILE
 - 24" x 18" 1500 FEET
 - 24" x 18" 500 FEET
- BLACK TEXT ON ORANGE BACKGROUND
- BARRICADES WITH TYPE A LOW INTENSITY FLASHING LIGHT
- BARRICADE OR DRUM WITH FLASHING LIGHT
- 48" x 48" FLUORESCENT ORANGE

NOTES

- ALL CONSTRUCTION SIGNS TO BE INCLUDED IN THE COST OF TRAFFIC CONTROL AND PROTECTION, (SPECIAL).
- ACCESS TO ENTRANCES SHALL BE MAINTAINED AT ALL TIMES.
- STAGE 2 SHALL BE CONSTRUCTED UNDER TRAFFIC IN ACCORDANCE WITH STD 701101.
- THE CONTRACTOR SHALL MAINTAIN DRAINAGE THROUGHOUT THE STAGE CONSTRUCTION.
- THE CONTRACTOR MAY BEGIN TRAFFIC SIGNAL IMPROVEMENTS AT ANY TIME DURING THIS STAGE.

SUGGESTED SEQUENCE OF CONSTRUCTION
STAGE II - NORTHBOUND TRAVEL LANE & MEDIAN CONSTRUCTION

1. SET UP TRAFFIC CONTROL USING HIGHWAY STD 701101, BLR 21, AND ACCORDING TO THE LAYOUT SHOWN ON THIS SHEET.
2. REMOVE STAGE 1 PAVEMENT MARKINGS & PLACE TEMPORARY MARKINGS AS SHOWN.
3. REMOVE ALL CC&G ALONG EAST EDGE OF ROADWAY.
4. CONSTRUCT REMAINING STORM SEWER.
5. PLACE CC&G ALONG EAST EDGE OF ROADWAY AND CONSTRUCT ALL PRIVATE ENTRANCES. SEE "SEQUENCE OF CONSTRUCTION OPERATIONS" IN THE CONTRACT SPECIAL PROVISIONS FOR SUGGESTED METHODS OF MAINTAINING ACCESS TO ALL PROPERTY OWNERS.
6. REMOVE EX PAVEMENT WITHIN THE WORK ZONE TO THE LIMITS SHOWN ON THE PAVEMENT REMOVAL SHEET.
7. CONSTRUCT CONCRETE MEDIAN FROM APPROXIMATE STA 6+75 TO STA 9+32, EXCLUDING THE MEDIAN NOSE.
8. PLACE HMA BINDER COURSE FROM STA 6+75 TO STA 9+55 AND AT ALL WIDENING AREAS.
9. PLACE HMA OVER EXISTING PAVEMENT TO SERVE AS RAMP FOR STAGE 3 TRAFFIC (SEE DETAIL BELOW) FROM APPROXIMATE STA 5+65 TO STA 6+75.
10. SET UP TRAFFIC CONTROL FOR STAGE 3.

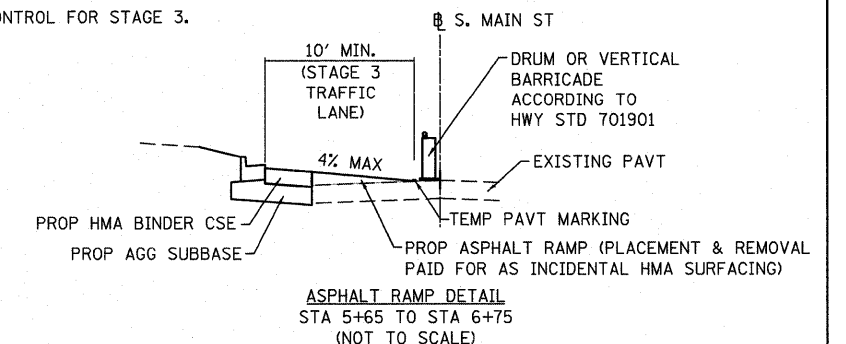
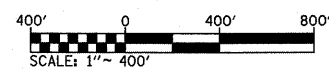
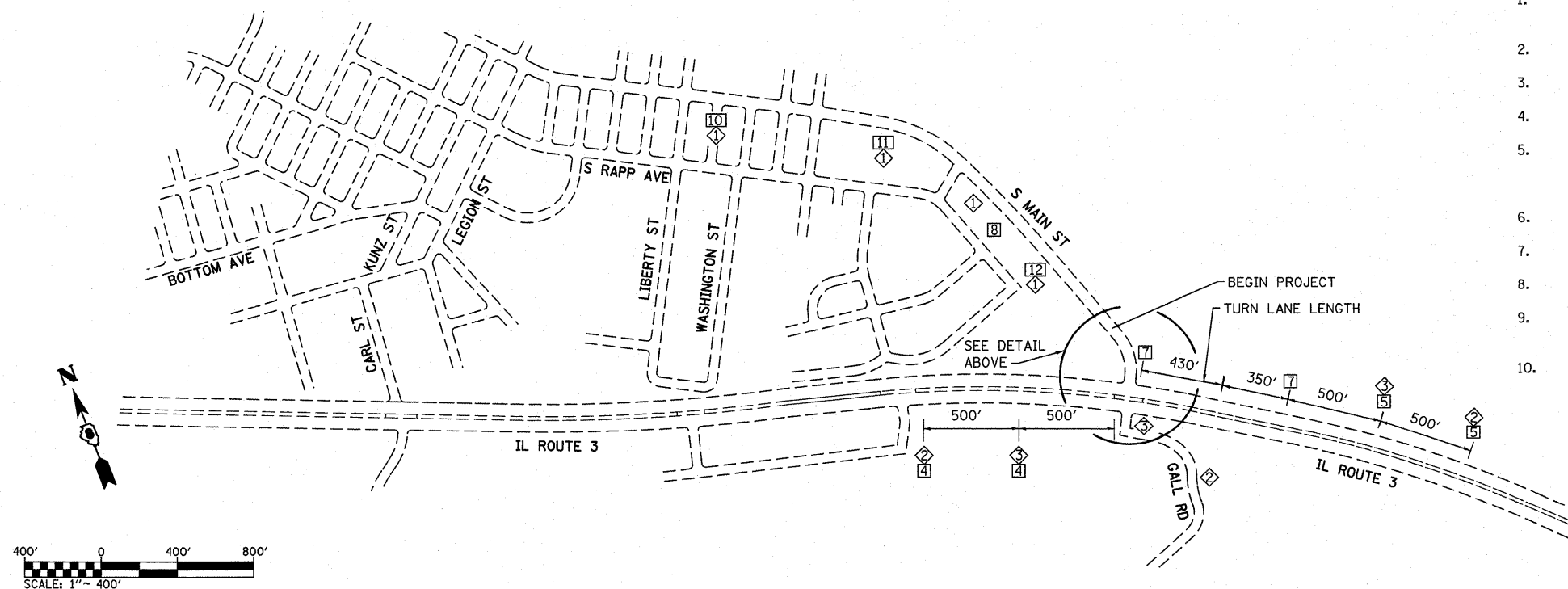

FILE NAME =	USER NAME = randy	DESIGNED - TLC	REVISED -
h:\p\28813\micr\station\cadd sheets\082013-sh2-staging.dgn		DRAWN - RGV	REVISED -
	PLOT SCALE = 48.0000' / IN.	CHECKED -	REVISED -
	PLOT DATE = 4/22/2011	DATE -	REVISED -

STATE OF ILLINOIS
DEPARTMENT OF TRANSPORTATION

STAGING & TRAFFIC CONTROL SHEETS
STAGE 2 HIGHWAY CONSTRUCTION

SCALE: SHEET NO. 2 OF 3 SHEETS STA. TO STA.

F.A.U. RTE.	SECTION	COUNTY	TOTAL SHEETS	SHEET NO.
9302	08-00047-00-PV	MONROE	27	9
S MAIN ST RECONSTRUCTION			CONTRACT NO. 97467	
ILLINOIS FED. AID PROJECT				