

STATE OF ILLINOIS
DEPARTMENT OF TRANSPORTATION

F.A.P. RTE.	SECTION	COUNTY	TOTAL SHEETS	SHEET NO.
554	(18BR)BDR-BJR	BROWN	9	1
		ILLINOIS	CONTRACT NO. 72N42	

FOR INDEX OF SHEETS, SEE SHEET NO. 2

PROPOSED CONTRACT MAINTENANCE

FAP ROUTE 554 (IL 107)
SECTION (18BR)BDR-BJR
PROJECT (STATE)
BRIDGE DECK REPAIRS
BROWN COUNTY

C-96-023-22

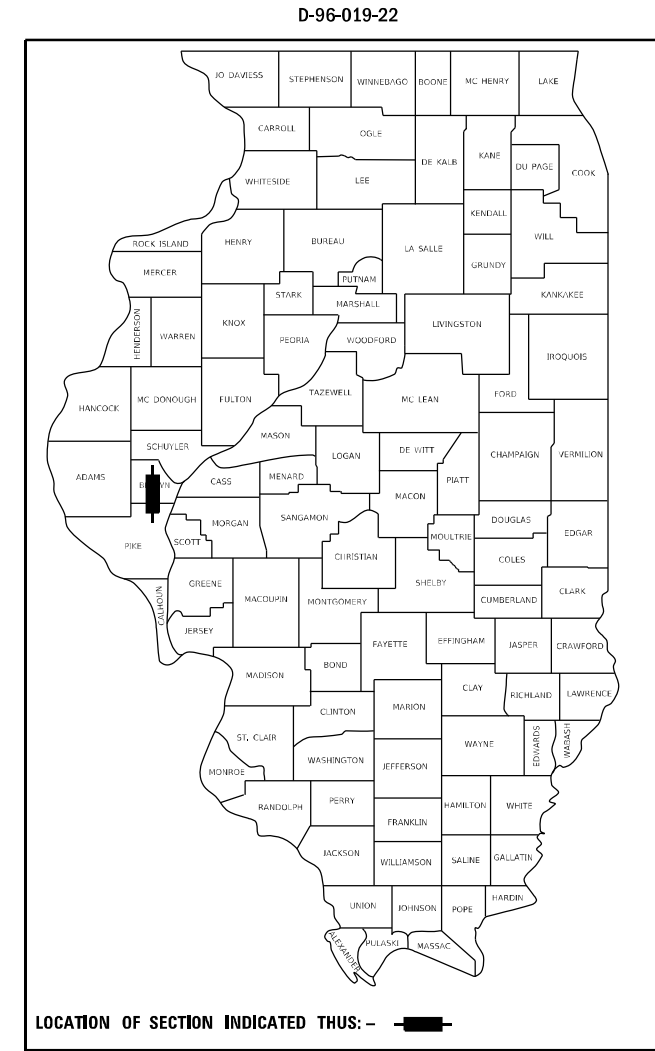

PROJECT LOCATION
SN 005-0002
IL 107 OVER
MCKEE CREEK
7.2 MI S MT STERLING

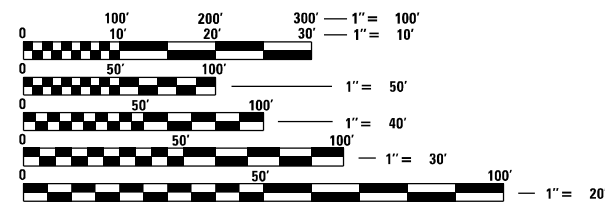
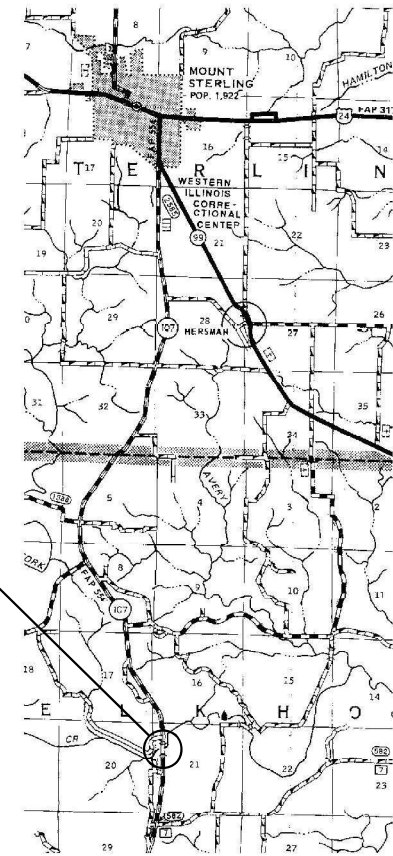

FULL SIZE PLANS HAVE BEEN PREPARED USING STANDARD ENGINEERING SCALES, REDUCED SIZED PLANS WILL NOT CONFORM TO STANDARD SCALES. IN MAKING MEASUREMENTS ON REDUCED PLANS, THE ABOVE SCALES MAY BE USED.

J.U.L.I.E.
JOINT UTILITY LOCATION INFORMATION FOR EXCAVATORS
1-800-892-0123
OR 811

BRIDGE MAINTENANCE ENGINEER: BRANDON DUDLEY - (217) 785-9290

GROSS LENGTH = 625 FT. = 0.12 MILE
NET LENGTH = 625 FT. = 0.12 MILE

CONTRACT NO. 72N42

STATE OF ILLINOIS
DEPARTMENT OF TRANSPORTATION

SUBMITTED March 24, 2022

John P. Meyer
REGIONAL ENGINEER

May 13, 2022 *Scott A. Etk*
ENGINEER OF DESIGN AND ENVIRONMENT

May 13, 2022 *Stephen M. Lewis*
DIRECTOR OF HIGHWAYS PROJECT IMPLEMENTATION

PRINTED BY THE AUTHORITY
OF THE STATE OF ILLINOIS

INDEX OF SHEETS

- 1 COVER SHEET
- 2 INDEX, STANDARDS, SIGNATURES, & GENERAL NOTES
- 3 SUMMARY OF QUANTITIES
- 4 STAGING PLAN
- 5-6 TRAFFIC CONTROL PLAN
- 7-9 SN 005-0002 BRIDGE PLANS



STANDARDS

- 000001-08
- 001001-02
- 001006
- 701001-02
- 701006-05
- 701201-05
- 701301-04
- 701316-13
- 701901-08

GENERAL NOTES:

AREAS OF DECK REPAIRS SHOWN ARE ESTIMATED. THE ENGINEER SHALL SHOW ACTUAL LOCATIONS ON AS-BUILT PLANS.

FULL DEPTH PATCHES SHALL BE COVERED WITH STEEL PLATES WHEN WORKERS ARE NOT PRESENT.

STATE OF ILLINOIS DEPARTMENT OF TRANSPORTATION DIVISION OF HIGHWAYS DISTRICT 6	
EXAMINED <u>March 21</u> 20 <u>22</u>	 ENGINEER OF OPERATIONS
EXAMINED <u>March 14</u> 20 <u>22</u>	 ENGINEER OF PROJECT IMPLEMENTATION
EXAMINED <u>March 18</u> 20 <u>22</u>	 ENGINEER OF PROGRAM DEVELOPMENT

MODEL: Default
FILE NAME: S:\Addresses\Bridges\plans_CAD\72N42 - 0050002 deck patching & joint repairs.dgn

	USER NAME = dudleybm	DESIGNED -	REVISED -	STATE OF ILLINOIS DEPARTMENT OF TRANSPORTATION	INDEX OF SHEETS, STANDARDS, GENERAL NOTES, & SIGNATURES	F.A.P. RTE.	SECTION	COUNTY	TOTAL SHEETS	SHEET NO.	
		DRAWN -	REVISED -			554	(18BR)BDR-BJR	BROWN	9	2	
	PLOT SCALE = 100,0000 ' / in.	CHECKED -	REVISED -			CONTRACT NO. 72N42					
	PLOT DATE = 3/22/2022	DATE -	REVISED -			SCALE:		SHEET OF SHEETS		STA. TO STA.	

0-02177-6003
SN 005-0002

100% STATE

BRIDGE/RURAL
0047
BROWN

CODE NO.	ITEM	UNIT	TOTAL QUANTITY	
50102400	CONCRETE REMOVAL	CU YD	0.1	0.1
50300300	PROTECTIVE COAT	SQ YD	190	190
52000030	PREFORMED JOINT SEAL 2-1/2"	FOOT	96	96
59300100	CONTROLLED LOW-STRENGTH MATERIAL	CU YD	5	5
67100100	MOBILIZATION	L SUM	1	1
70100100	TRAFFIC CONTROL AND PROTECTION, STANDARD 701316	EACH	1	1
70100450	TRAFFIC CONTROL AND PROTECTION, STANDARD 701201	L SUM	1	1
70106500	TEMPORARY BRIDGE TRAFFIC SIGNALS	EACH	1	1
70106700	TEMPORARY RUMBLE STRIPS	EACH	6	6
70107025	CHANGEABLE MESSAGE SIGNS	CAL DAY	90	90
X7200201	WIDTH RESTRICTION SIGNING	L SUM	1	1
Z0001800	APPROACH SLAB REPAIR (PARTIAL DEPTH)	SQ YD	5	5
Z0016001	DECK SLAB REPAIR (FULL DEPTH, TYPE I)	SQ YD	5	5
Z0016002	DECK SLAB REPAIR (FULL DEPTH, TYPE II)	SQ YD	5	5

0-02177-6003
SN 005-0002

100% STATE

BRIDGE/RURAL
0047
BROWN

CODE NO.	ITEM	UNIT	TOTAL QUANTITY	
Z0016200	DECK SLAB REPAIR (PARTIAL)	SQ YD	175	175
Z0032500	JOINT SEALING (PATCHES)	FOOT	2200	2200
Z0041895	POLYMER CONCRETE	CU FT	16	16

MODEL: Default
FILE NAME: S:\Addresses\Bridges\Bridges_CAD\72N42 - 0050002 deck patching & joint repair\sheet.dgn

USER NAME = dudleybm	DESIGNED -	REVISED -
PLOT SCALE = 100,0000' / in.	DRAWN -	REVISED -
PLOT DATE = 3/22/2022	CHECKED -	REVISED -
	DATE -	REVISED -

**STATE OF ILLINOIS
DEPARTMENT OF TRANSPORTATION**

SUMMARY OF QUANTITIES

SCALE: SHEET OF SHEETS STA. TO STA.

F.A.P. RTE.	SECTION	COUNTY	TOTAL SHEETS	SHEET NO.
554	(18BR)BDR-BJR	BROWN	9	3
			CONTRACT NO. 72N42	
ILLINOIS FED. AID PROJECT				

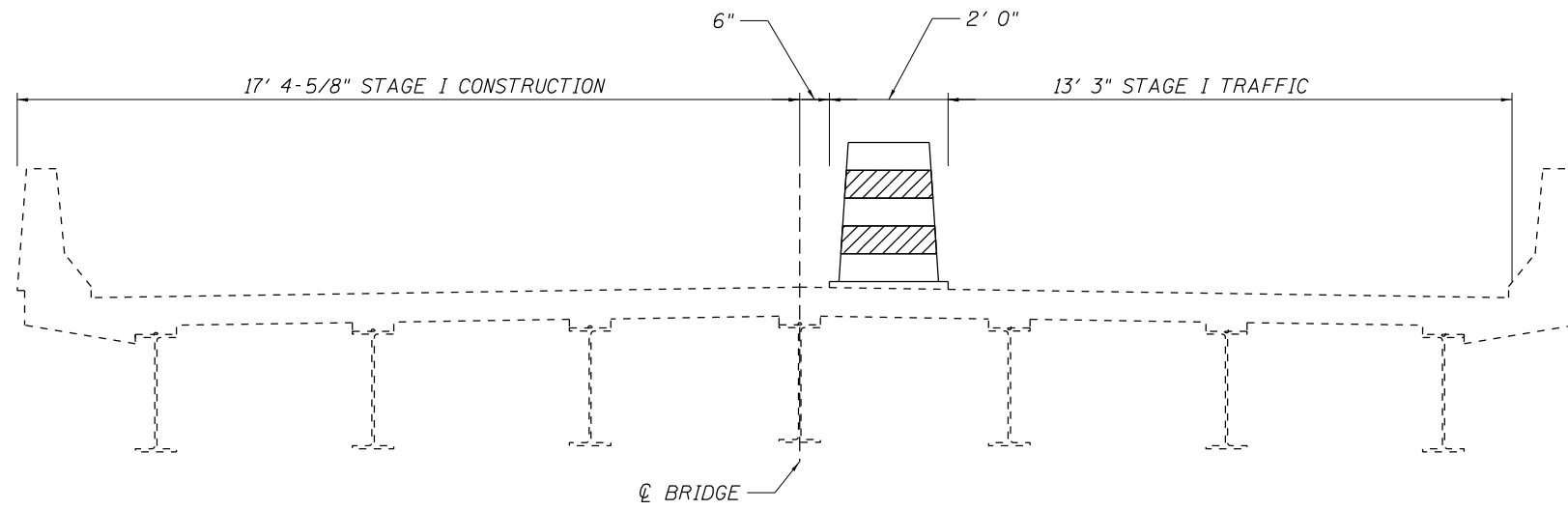

STAGE I TRAFFIC, LOOKING NORTH

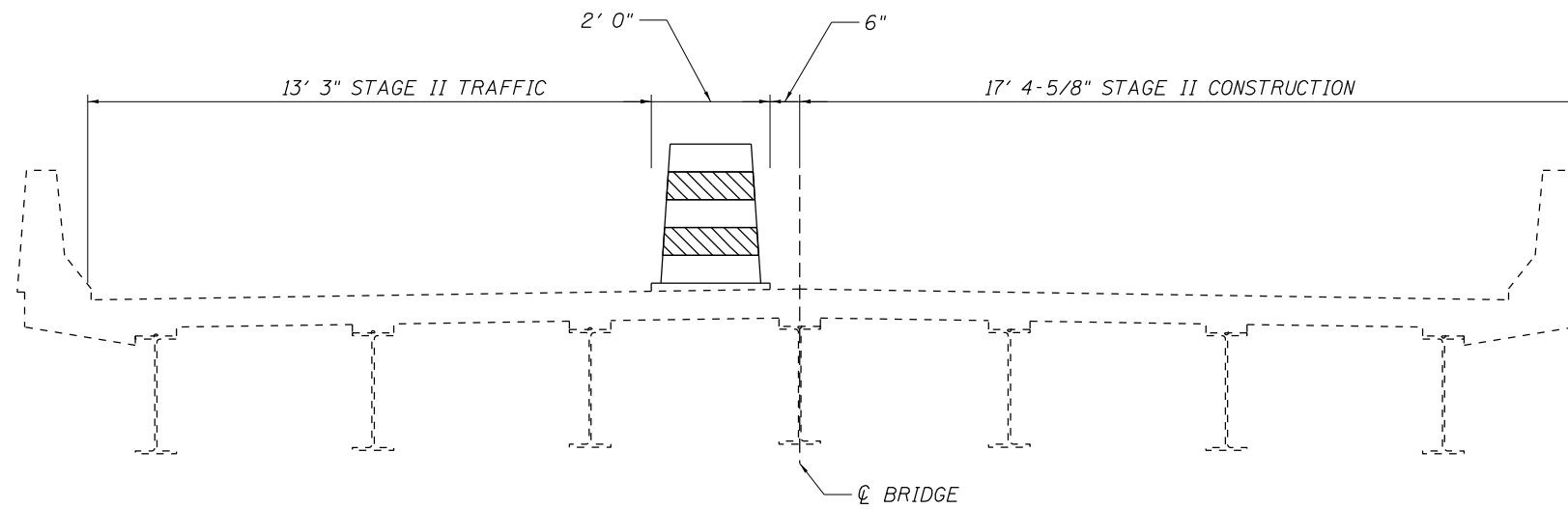

STAGE II TRAFFIC, LOOKING NORTH

MODEL: Default
 FILE NAME: S:\Addresses\Bridges\BDR\72N42 - 0053002 deck staging & joint\pdr\staging.dgn

USER NAME = dudleybm	DESIGNED -	REVISED -
	DRAWN -	REVISED -
PLOT SCALE = 100,0000' / in.	CHECKED -	REVISED -
PLOT DATE = 3/22/2022	DATE -	REVISED -



STATE OF ILLINOIS
DEPARTMENT OF TRANSPORTATION

TRAFFIC STAGING DETAIL				
SCALE:	SHEET	OF	SHEETS	STA. TO STA.

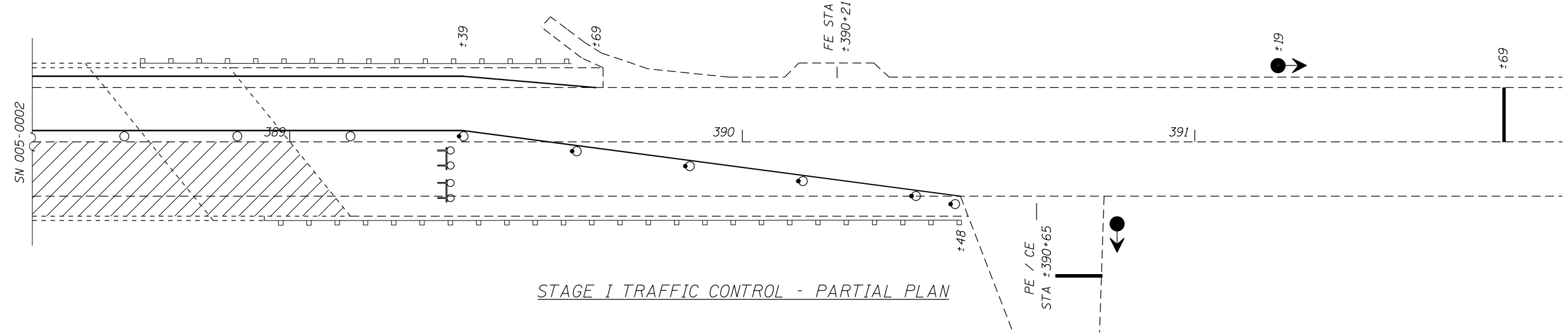
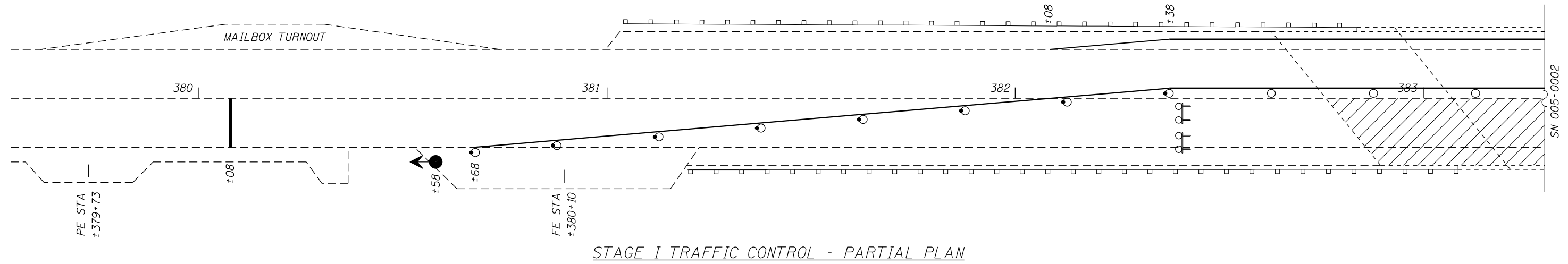
F.A.P. RTE.	SECTION	COUNTY	TOTAL SHEETS	SHEET NO.
554	(18BR)BDR-BJR	BROWN	9	4
ILLINOIS FED. AID PROJECT			CONTRACT NO. 72N42	

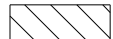

SYMBOLS

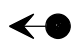
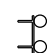
-  WORK AREA
-  DRUM WITH STEADY BURN BI-DIRECTIONAL LIGHT
-  DRUM
-  TRAFFIC SIGNAL
-  TYPE III BARRICADE WITH FLASHING LIGHTS

TRAFFIC CONTROL NOTES:

1. TRAFFIC CONTROL DEVICES NOT SHOWN IN THIS DETAIL SHALL BE PER STANDARD 701316. DEVICES AND TEMPORARY PAVEMENT MARKINGS SHOWN IN THIS DETAIL SHALL BE INCLUDED IN THE COST OF TRAFFIC CONTROL AND PROTECTION, STANDARD 701316. TEMPORARY RUMBLE STRIPS, AND TEMPORARY BRIDGE TRAFFIC SIGNALS SHALL BE PAID SEPARATELY.

MODEL: Default
 FILE NAME: S:\Addresses\Bridges\plans_CADD\72N42 - 0050002.dwg
 FILE ADDRESS: Bridges\plans_CADD\72N42 - 0050002.dwg

USER NAME = dudleybm	DESIGNED -	REVISED -
	DRAWN -	REVISED -
PLOT SCALE = 100,0000' / in.	CHECKED -	REVISED -
PLOT DATE = 3/22/2022	DATE -	REVISED -

**STATE OF ILLINOIS
DEPARTMENT OF TRANSPORTATION**



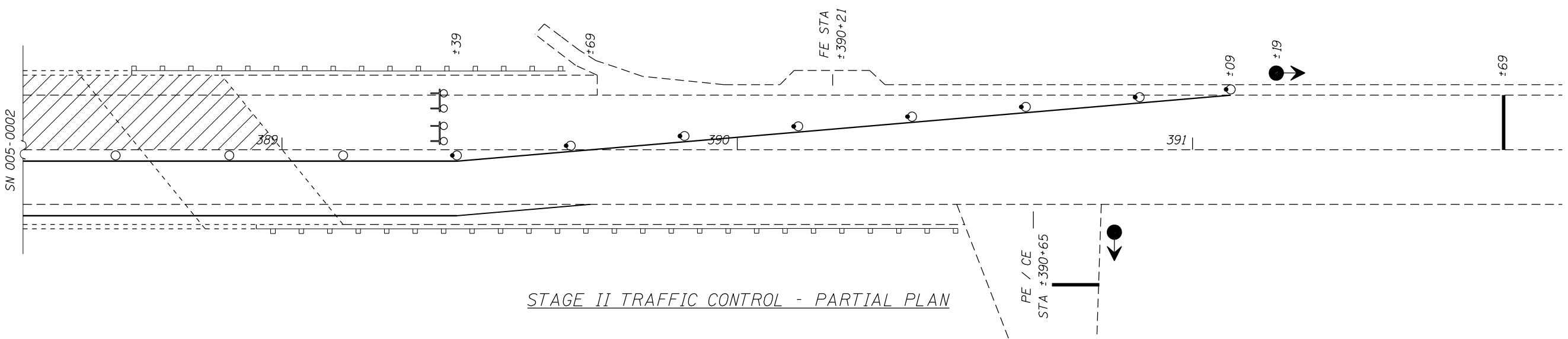
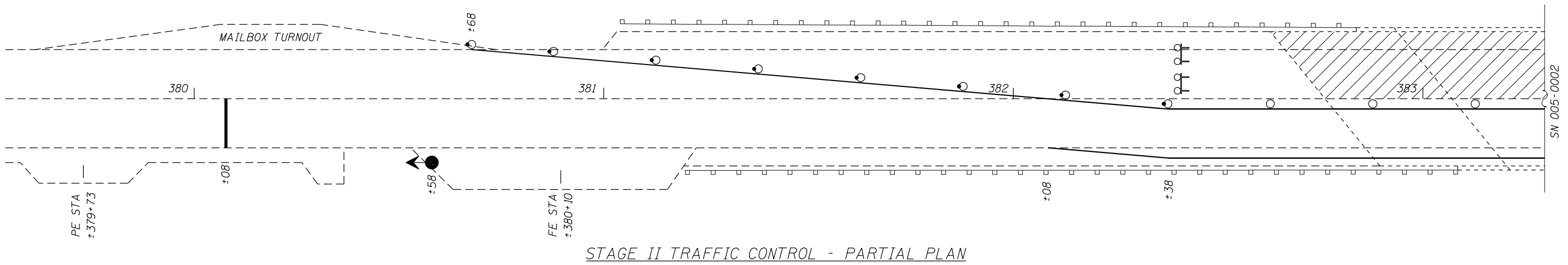

STAGE I TRAFFIC CONTROL

SCALE: SHEET OF SHEETS STA. TO STA.

F.A.P. RTE.	SECTION	COUNTY	TOTAL SHEETS	SHEET NO.
554	(18BR)BDR-BJR	BROWN	9	5
ILLINOIS FED. AID PROJECT			CONTRACT NO. 72N42	

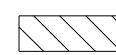

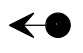
SYMBOLS

-  WORK AREA
-  DRUM WITH STEADY BURN BI-DIRECTIONAL LIGHT
-  DRUM
-  TRAFFIC SIGNAL
-  TYPE III BARRICADE WITH FLASHING LIGHTS

TRAFFIC CONTROL NOTES:

1. TRAFFIC CONTROL DEVICES NOT SHOWN IN THIS DETAIL SHALL BE PER STANDARD 701316. DEVICES AND TEMPORARY PAVEMENT MARKINGS SHOWN IN THIS DETAIL SHALL BE INCLUDED IN THE COST OF TRAFFIC CONTROL AND PROTECTION, STANDARD 701316. TEMPORARY RUMBLE STRIPS, AND TEMPORARY BRIDGE TRAFFIC SIGNALS SHALL BE PAID SEPARATELY.

MODEL: Default
 FILE NAME: S:\Addresses\Bridges\plans_CADD\72N42 - 0050002.dwg
 FILE ADDRESS: Bridges\plans_CADD\72N42 - 0050002.dwg

USER NAME = dudleybm	DESIGNED -	REVISED -
	DRAWN -	REVISED -
PLOT SCALE = 100,0000' / in.	CHECKED -	REVISED -
PLOT DATE = 3/22/2022	DATE -	REVISED -

**STATE OF ILLINOIS
DEPARTMENT OF TRANSPORTATION**

STAGE II TRAFFIC CONTROL

SCALE: SHEET OF SHEETS STA. TO STA.

F.A.P. RTE. 554	SECTION (18BR)BDR-BJR	COUNTY BROWN	TOTAL SHEETS 9	SHEET NO. 6
ILLINOIS FED. AID PROJECT			CONTRACT NO. 72N42	

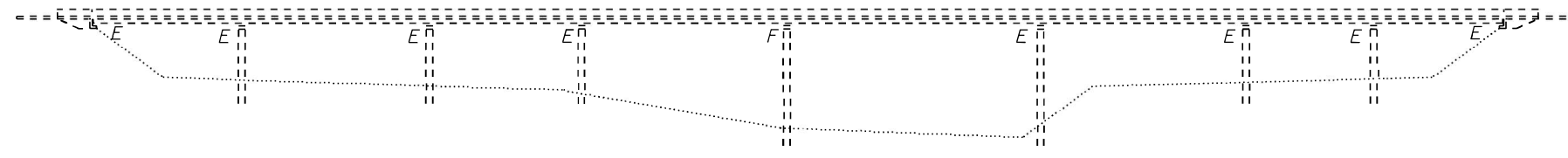

ELEVATION

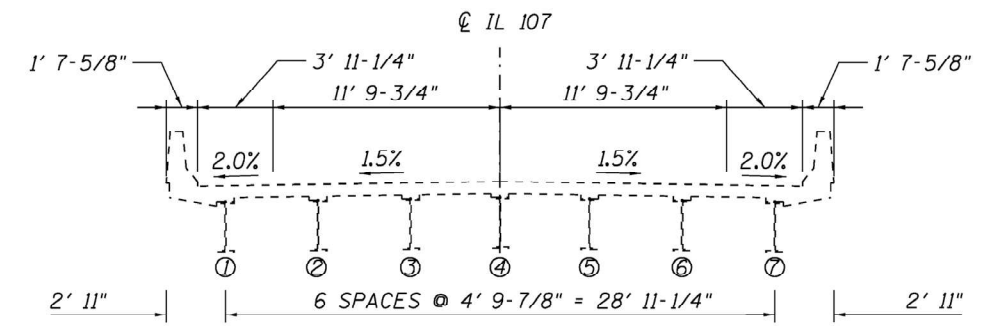

CROSS SECTION - LOOKING NORTH

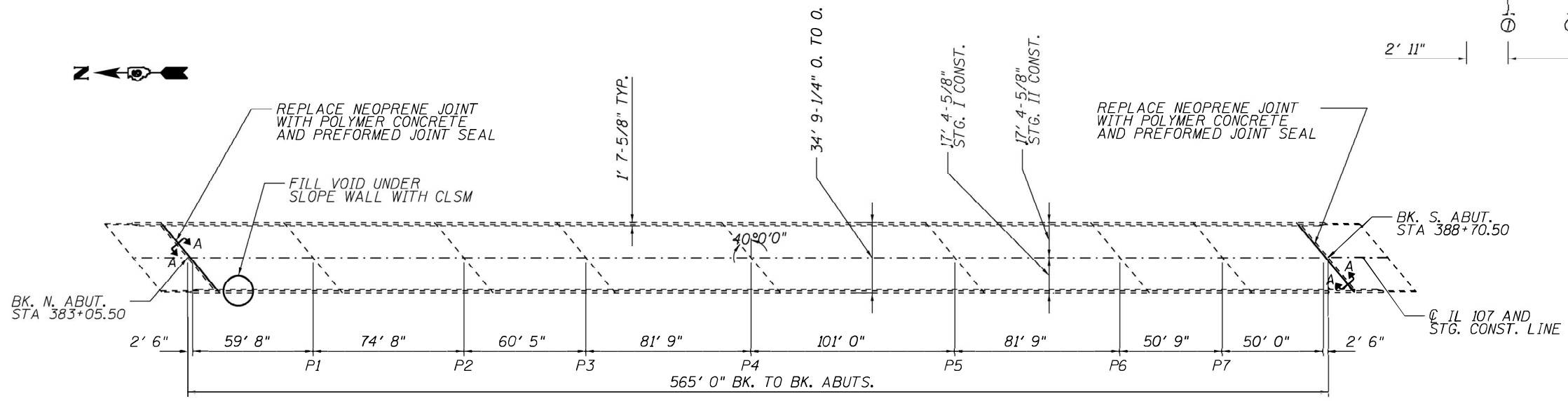

PLAN



Expires 11/30/2022

Jayme F. Schiff

TOTAL BILL OF MATERIAL (005-0002)

ITEM	UNIT	QUANTITY
Deck Slab Repair (Partial)	Sq. Yd.	175
Approach Slab Repair (Partial Depth)	Sq. Yd.	5
Deck Slab Repair (Full Depth, Type I)	Sq. Yd.	5
Deck Slab Repair (Full Depth, Type II)	Sq. Yd.	5
Joint Sealing (Patches)	Foot	2200
Polymer Concrete	Cu. Ft.	16
Preformed Joint Seal 2-1/2"	Foot	96
Concrete Removal	Cu. Yd.	0.1
Controlled Low-Strength Material	Cu. Yd.	5
Protective Coat	Sq. Yd.	190

STRUCTURE GENERAL NOTES:

PRIOR TO POURING THE NEW CONCRETE PATCHES, ALL HEAVY OR LOOSE MILL SCALE AND OTHER LOOSE OR POTENTIALLY DETRIMENTAL FOREIGN MATERIAL SHALL BE REMOVED FROM THE SURFACES IN CONTACT WITH CONCRETE. TIGHTLY ADHERED PAINT MAY REMAIN UNLESS OTHERWISE NOTED. REMOVAL SHALL BE ACCOMPLISHED BY METHODS THAT WILL NOT DAMAGE THE STEEL AND THE COST WILL BE INCLUDED IN CONCRETE REMOVAL.

PLAN DIMENSIONS AND DETAILS RELATIVE TO EXISTING PLANS ARE SUBJECT TO NOMINAL CONSTRUCTION VARIATIONS. THE CONTRACTOR SHALL FIELD VERIFY EXISTING DIMENSIONS AND DETAILS AFFECTING NEW CONSTRUCTION AND MAKE NECESSARY APPROVED ADJUSTMENTS PRIOR TO CONSTRUCTION OR ORDERING OF MATERIALS. SUCH VARIATIONS SHALL NOT BE CAUSE FOR ADDITIONAL COMPENSATION FOR A CHANGE IN THE SCOPE OF WORK, HOWEVER, THE CONTRACTOR WILL BE PAID FOR THE QUANTITY ACTUALLY FURNISHED AT THE UNIT PRICE BID FOR THE WORK.

EXISTING REINFORCEMENT BARS EXTENDING INTO THE REMOVAL AREA SHALL BE CLEANED, STRAIGHTENED, AND INCORPORATED INTO THE NEW CONSTRUCTION. ANY REINFORCEMENT BARS THAT ARE DAMAGED DURING CONCRETE REMOVAL SHALL BE REPLACED WITH AN APPROVED BAR SPLICER OR ANCHORAGE SYSTEM. COST INCLUDED WITH CONCRETE REMOVAL.

MODEL: Default
FILE NAME: S:\addresses\bridgeplans_CAD\72N42_0050002_deck_elevation.dwg
DATE: 3/22/2022

USER NAME = dudleybm	DESIGNED - BRANDON DUDLEY	REVISED -
	DRAWN - BRANDON DUDLEY	REVISED -
PLOT SCALE = 100.0000' / in.	CHECKED -	REVISED -
PLOT DATE = 3/22/2022	DATE - 2/10/2022	REVISED -

**STATE OF ILLINOIS
DEPARTMENT OF TRANSPORTATION**

**BRIDGE PLAN & ELEVATION
SN 005-0002**

SCALE: SHEET 1 OF 3 SHEETS STA. TO STA.

F.A.P. RITE.	SECTION	COUNTY	TOTAL SHEETS	SHEET NO.
554	(18BR)BDR-BJR	BROWN	9	7
			CONTRACT NO. 72N42	
ILLINOIS FED. AID PROJECT				

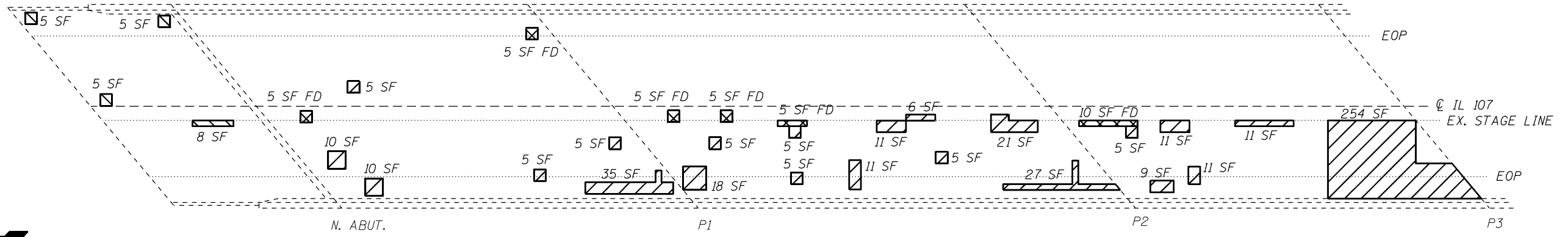

PARTIAL PLAN

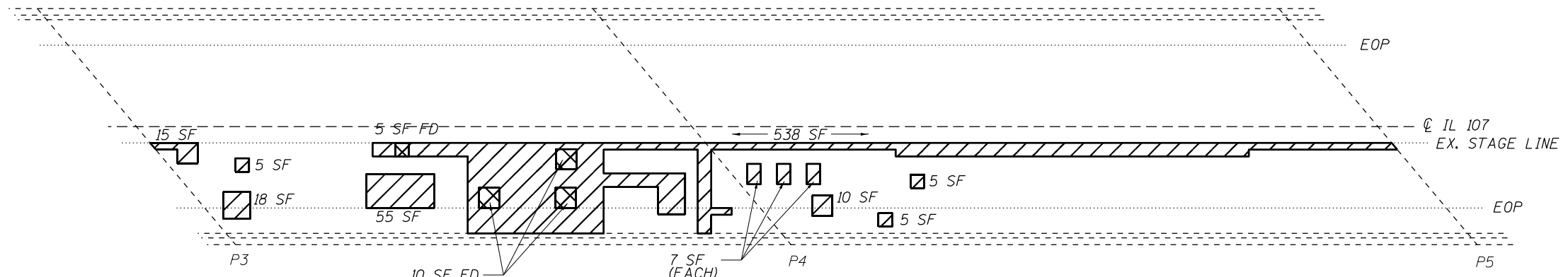

PARTIAL PLAN

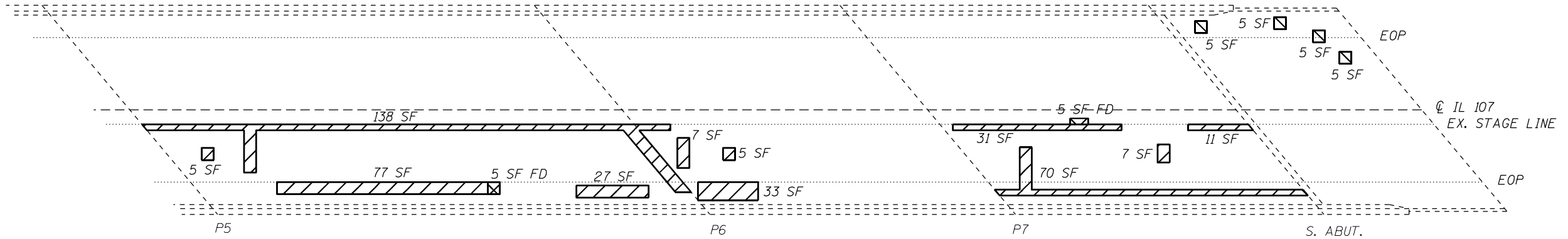

PARTIAL PLAN

NOTES:

IDENTIFIED PATCHING LOCATIONS ARE ESTIMATED FROM A DECK SURVEY PERFORMED ON 4/8/2021. THE PATCHING SURVEY IS INCLUDED FOR INFORMATION ONLY. THE ENGINEER SHALL LAY OUT ACTUAL PATCH LOCATIONS IN THE FIELD.

THE ENGINEER SHALL SHOW ACTUAL LOCATIONS OF DECK REPAIRS ON AS-BUILT PLANS.

FULL DEPTH PATCHING LOCATIONS MAY BE OMITTED IF SOUND CONCRETE IS ENCOUNTERED.

JOINT SEALING (PATCHES) SHALL BE APPLIED IN LOCATIONS AS DIRECTED IN THE SPECIAL PROVISIONS, ALONG THE ENTIRE LENGTH OF THE EXISTING STAGE CONSTRUCTION LINE, AND ALONG THE CONSTRUCTION JOINTS BETWEEN THE ABUTMENT AND APPROACHES.

- APPROACH SLAB REPAIR (PARTIAL DEPTH)
- DECK SLAB REPAIR (PARTIAL)
- DECK SLAB REPAIR (FULL DEPTH)

SLAB REPAIR BILL OF MATERIAL

ITEM	UNIT	QUANTITY
Deck Slab Repair (Partial)	Sq. Yd.	175
Approach Slab Repair (Partial Depth)	Sq. Yd.	5
Deck Slab Repair (Full Depth, Type I)	Sq. Yd.	5
Deck Slab Repair (Full Depth, Type II)	Sq. Yd.	5
Joint Sealing (Patches)	Foot	2200

MODEL: Default
FILE NAME: S:\Address\Bridges\BDR\72N42 - 0050002 deck patching & joint sealing.dgn

USER NAME = dudleybm	DESIGNED -	REVISED -
	DRAWN -	REVISED -
PLOT SCALE = 100,0000' / in.	CHECKED -	REVISED -
PLOT DATE = 3/22/2022	DATE -	REVISED -

STATE OF ILLINOIS
DEPARTMENT OF TRANSPORTATION

SLAB REPAIR PLAN
SN 005-0002

SCALE: SHEET 2 OF 3 SHEETS STA. TO STA.

F.A.P. RTE. 554	SECTION (18BR)BDR-BJR	COUNTY BROWN	TOTAL SHEETS 9	SHEET NO. 8
CONTRACT NO. 72N42				
ILLINOIS FED. AID PROJECT				

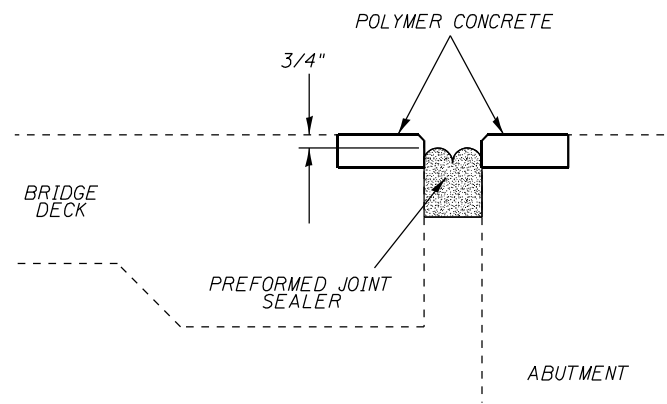

SECTION A-A:
SILICONE JOINT SEALER DETAIL

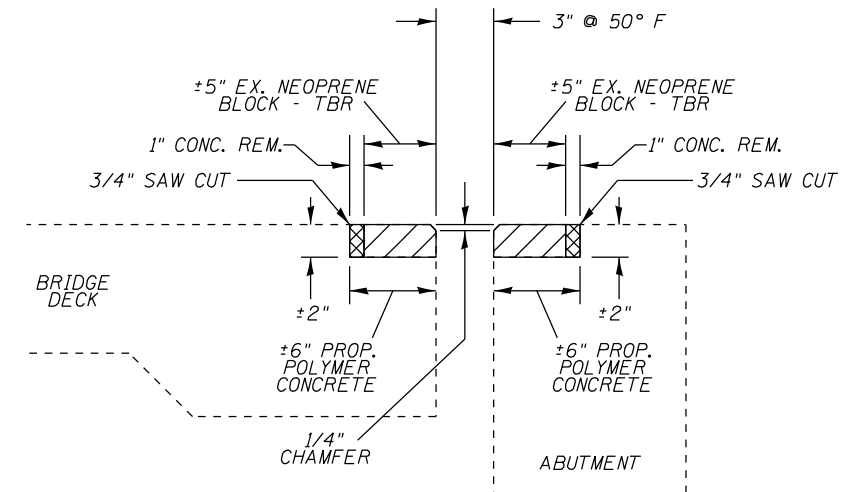

SECTION A-A
PROPOSED POLYMER CONCRETE
CROSS SECTION

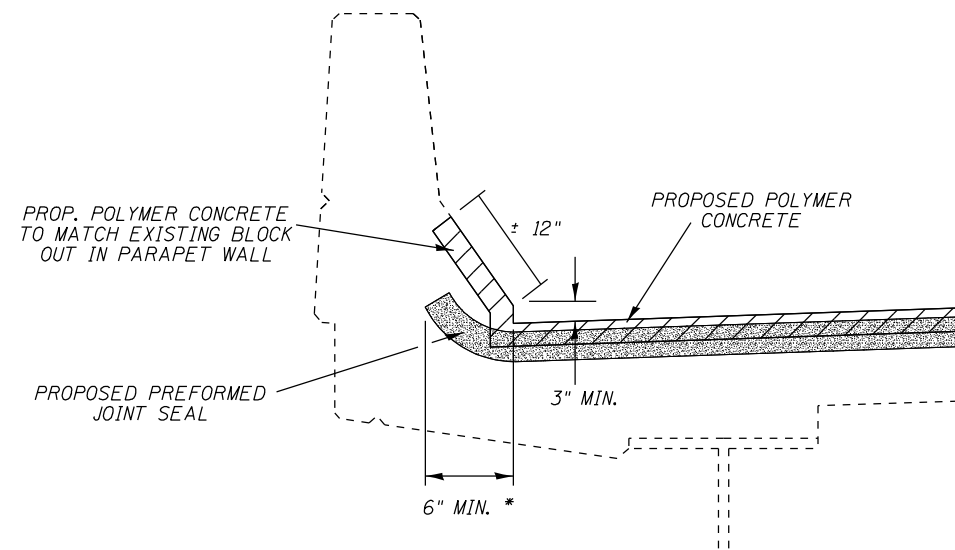

TYPICAL PARAPET CROSS SECTION:
JOINT SEALER END TREATMENT

NOTES:

- 1/4" CHAMFER MAY BE ACHIEVED BY GRINDING AFTER POLYMER CONCRETE HAS CURED.
- REMOVAL OF EXISTING NEOPRENE EXPANSION JOINTS SHALL BE INCLUDED IN THE COST OF CONCRETE REMOVAL.
- ANY STEEL ANCHORING STUDS ENCOUNTERED IN THE NEOPRENE JOINT REMOVAL AREA SHALL BE CUT OFF FLUSH WITH THE EXISTING CONCRETE. COST TO BE INCLUDED IN THE BID PRICE FOR CONCRETE REMOVAL.
- THE PREFORMED PRE-COMPRESSED, SILICONE COATED, SELF-EXPANDING SEALANT SYSTEM SHALL BE USED.

JOINT REPAIR BILL OF MATERIAL

ITEM	UNIT	QUANTITY
Polymer Concrete	Cu. Ft.	16
Preformed Joint Seal 2-1/2"	Foot	96
Concrete Removal	Cu. Yd.	0.1

MODEL: Default
FILE NAME: S:\Addresses\Bridges\BDR\72N42 - 0050002 deck matching & joint repair\sheet.dgn

USER NAME = dudleybm	DESIGNED -	REVISED -
PLOT SCALE = 100,0000' / in.	DRAWN -	REVISED -
PLOT DATE = 3/22/2022	CHECKED -	REVISED -
	DATE -	REVISED -

STATE OF ILLINOIS
DEPARTMENT OF TRANSPORTATION

EXPANSION JOINT REPAIR DETAILS
SN 005-0002

SCALE: SHEET 3 OF 3 SHEETS STA. TO STA.

F.A.P. RTE.	SECTION	COUNTY	TOTAL SHEETS	SHEET NO.
554	(18BR)BDR-BJR	BROWN	9	9
			CONTRACT NO. 72N42	
		ILLINOIS FED. AID PROJECT		