

06-17-2022 LETTING ITEM 141

STATE OF ILLINOIS
DEPARTMENT OF TRANSPORTATION

ROUTE	SECTION	COUNTY	TOTAL SHEETS	SHEET NO.
FAS 889	21-00085-00-RS	GALLATIN	9	1
MAIN STREET (CH 11)				
PROJECT T5RZ(501)			JOB C-99-003-22	

INDEX OF SHEETS

- 1 COVER SHEET
- 2 SUMMARY OF QUANTITIES, TYPICAL SECTIONS
- 3 CONSTRUCTION SCHEDULES
- 4-5 DETAILS
- 6-9 PLAN VIEWS

PLANS FOR PROPOSED

GALLATIN COUNTY

F.A.S. ROUTE 889 (CH 11)
MAIN STREET / RIDGWAY - NEW HAVEN ROAD
SECTION 21-00085-00-RS
PROJECT T5RZ(501)
JOB C-99-003-22

FUNCTIONAL CLASSIFICATION
MAJOR COLLECTOR
ADT (2020): 850

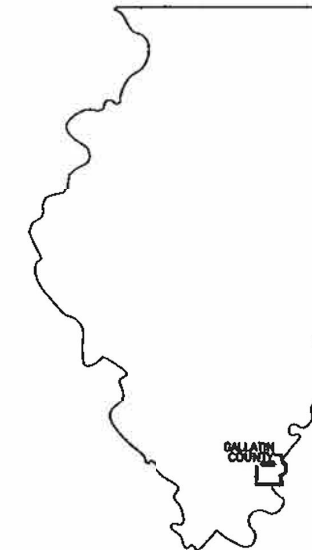

LOCATION OF SECTION INDICATED THUS -

STANDARDS

- 000001-08 STANDARD SYMBOLS, ABBR, PATTERNS
- 001006 DECIMAL OF AN INCH AND FOOT
- 280001-07 TEMPORARY EROSION CONTROL
- 424001-11 PERPENDICULAR CURB RAMPS FOR SIDEWALKS
- 424006-05 DIAGONAL CURB RAMPS FOR SIDEWALKS
- 424011-04 CORNER PARALLEL CURB RAMPS FOR SIDEWALKS
- 424016-05 MID-BLOCK CURB RAMPS FOR SIDEWALKS
- 424021-06 DEPRESSED CORNER FOR SIDEWALKS
- 606001-08 COMB CONC CURB & GUTTER
- 701006-05 TRAFFIC CONTROL
- 701011-04 TRAFFIC CONTROL
- 701201-05 TRAFFIC CONTROL
- 701301-04 TRAFFIC CONTROL
- 701306-04 TRAFFIC CONTROL
- 701311-03 TRAFFIC CONTROL
- 701801-06 TRAFFIC CONTROL
- 701901-08 TRAFFIC CONTROL DEVICES
- 780001-05 TYPICAL PAVEMENT MARKINGS MAILBOX
- BLR 24-2 TURNOUT FOR LOCAL ROADS
- 482001-02 HMA SHOULDER ADJACENT TO FLEXIBLE PAVEMENT

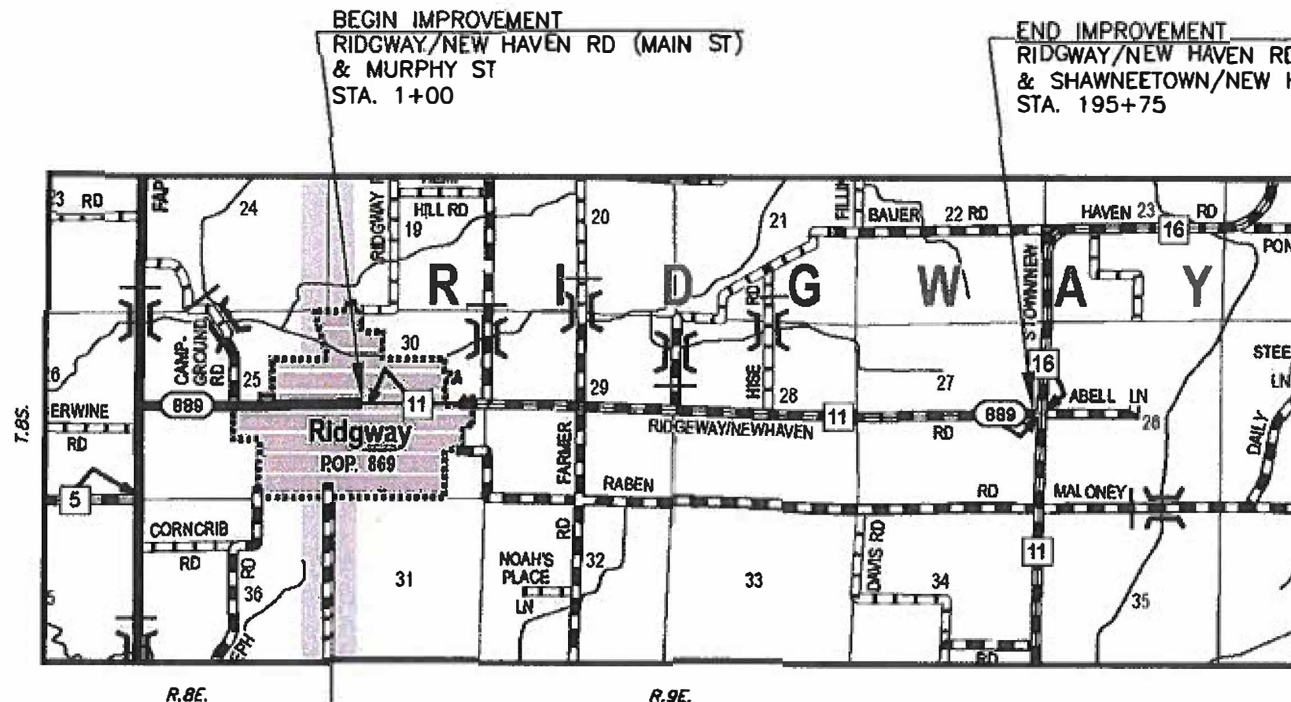

LOCATION MAP
LENGTH OF IMPROVEMENTS = 19,475 FT. = 3.688 MI.

ALL EXISTING UTILITIES AND LOCATIONS TO BE
CONFIRMED BY J.U.L.I.E. 800-892-0123

Jim W. Brown

 Jim W. Brown as President of Brown & Roberts, Inc.
 Illinois Professional Design Firm
 Land Survey & Professional Engineering Corporation
 Number 184-002376
 Expires April 30, 2022
 Date: *March 31, 2022*

GALLATIN COUNTY	
APPROVED	<i>3/31/22</i> <i>Justin Hastie</i> JUSTIN HASTIE, GALLATIN COUNTY ENGINEER
PASSED	<i>4/12/22</i> <i>Rich H. Rao</i> DISTRICT 9 ENGINEER OF LOCAL ROADS & STREETS
RELEASING FOR BID BASED ON LIMITED REVIEW	<i>4/12/22</i> <i>Rich H. Rao PE</i> ASST. DIRECTOR OF HIGHWAYS REGION FIVE ENGINEER

BROWN & ROBERTS, INC.
 CONSULTING ENGINEERS & LAND SURVEYORS
 1 WESTRIDGE ROAD HARRISBURG, IL 62948 (618) 282-8111

BRI JOB NO. 20-054 **CONTRACT NO. 99677**

STREET NAME	PROJECT NO.	JOB NO.	ROUTE	SECTION	COUNTY	TOTAL SHEETS	SHEET NO.
MAIN STREET (CH 11)	T5RZ(501)	C-99-003-22	FAS 889	21-00085-00-RS	GALLATIN	9	2

SUMMARY OF QUANTITIES

ITEM NUMBER	ITEM DESCRIPTION	UNIT	TOTAL QUANTITY
*X4400220	CURB REMOVAL AND REPLACEMENT	FOOT	295
*X6025800	MANHOLES TO BE ADJUSTED WITH NEW TYPE 1 FRAME, CLOSED LID, SPECIAL	EACH	7
*X7010216	TRAFFIC CONTROL AND PROTECTION, (SPECIAL)	L SUM	1
*Z0011500	COLD MILLING EXISTING SURFACE	SQ YD	13,602
20800150	TRENCH BACKFILL	CU YD	220
40600290	BITUMINOUS MATERIALS (TACK COAT)	POUND	6,091
40600370	LONGITUDINAL JOINT SEALANT	FOOT	3,600
40604052	HOT-MIX ASPHALT SURFACE COURSE, IL-9.5, MIX "C", N70	TON	1,601
42400100	PORTLAND CEMENT CONCRETE SIDEWALK 4 INCH	SQ FT	1,575
42400800	DETECTABLE WARNINGS	SQ FT	140
44000600	SIDEWALK REMOVAL	SQ FT	1,460
48203100	HOT-MIX ASPHALT SHOULDERS	TON	2,714
54248510	CONCRETE COLLAR	CU YD	2
55101200	STORM SEWER REMOVAL 24"	FOOT	162
550A0410	STORM SEWERS, CLASS A, TYPE 2 24"	FOOT	162
60255500	MANHOLES TO BE ADJUSTED	EACH	1
60266600	VALVE BOXES TO BE ADJUSTED	EACH	7
67100100	MOBILIZATION	L SUM	1
70300100	SHORT TERM PAVEMENT MARKING	FOOT	400
△ 78001110	PAINT PAVEMENT MARKING - LINE 4"	FOOT	4,094

* SPECIAL PROVISION

△ SPECIALTY ITEMS

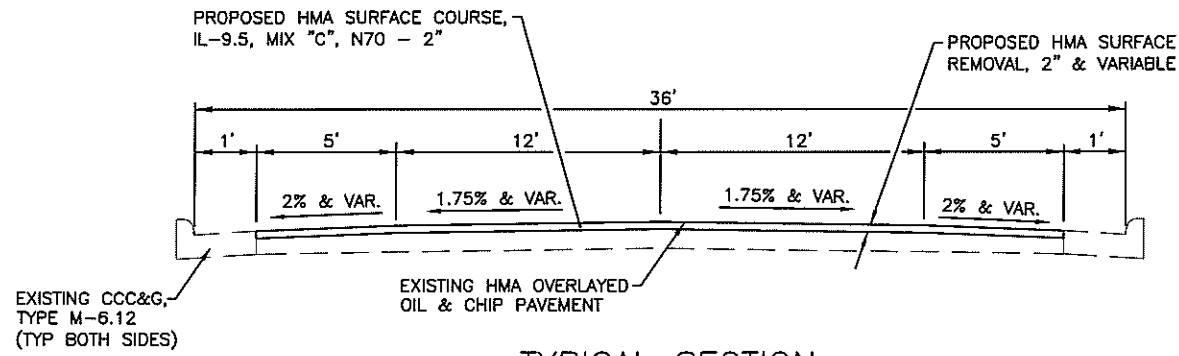

TYPICAL SECTION

STA 1+00 TO STA 14+40
NO SCALE

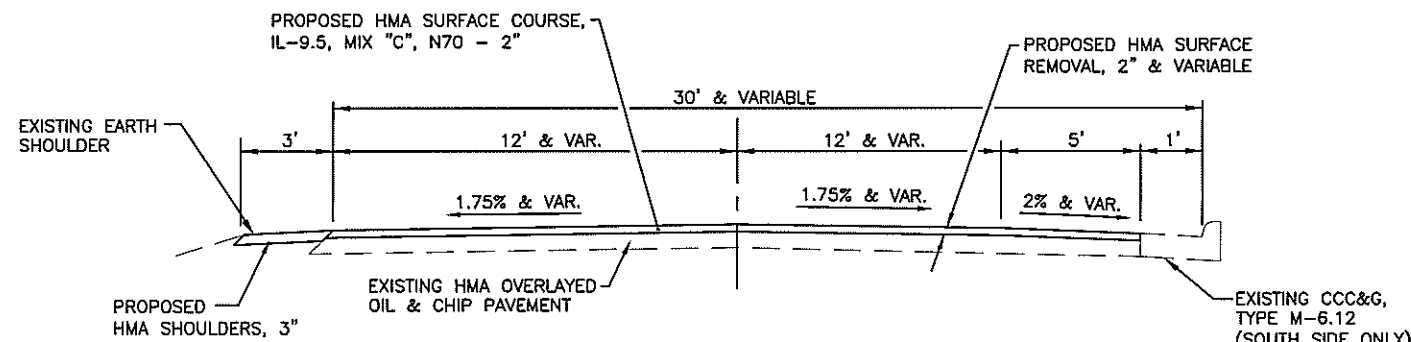

TYPICAL SECTION

STA 14+40 TO STA 27+56
NO SCALE

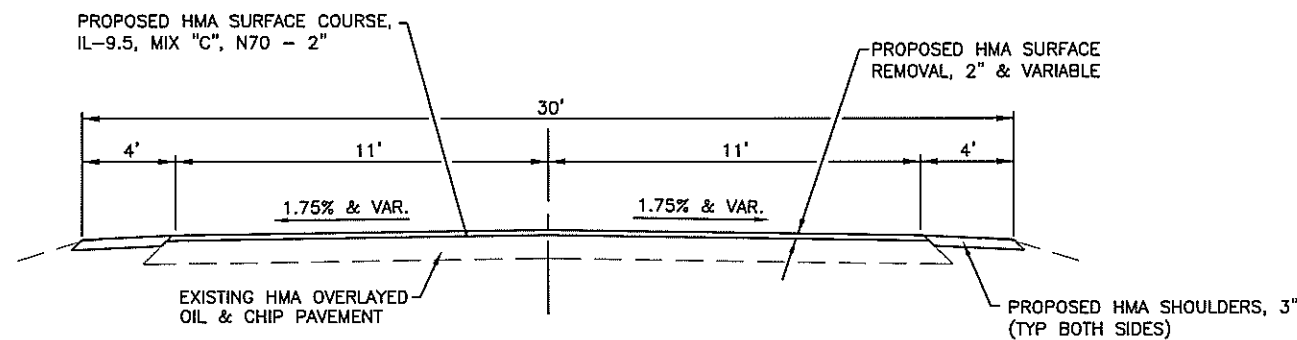

TYPICAL SECTION

STA 27+56 TO STA 37+00
NO SCALE

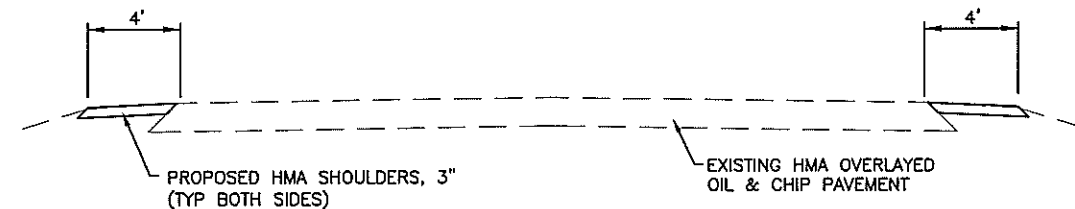

TYPICAL SECTION

STA 37+00 TO STA 195+75
NO SCALE

06 Apr 2022 - 3:08pm - K:\2020\20054\2nd Project\AC_Secnd Project\20054\2nd Project\Typical Sections.dwg: Layout Tab Typical Section & Summary of Quantities

CONTRACT NO. 99677

STREET NAME	PROJECT NO.	JOB NO.	ROUTE	SECTION	COUNTY	TOTAL SHEETS	SHEET NO.
MAIN STREET (CH 11)	T5RZ(501)	C-99-003-22	FAS 889	21-00085-00-RS	GALLATIN	9	3

PAVEMENT SCHEDULE				
LOCATION	HMA SURF CSE, MIX "C", N70 (2" LIFT) (TON)	BITUMINOUS MATERIALS (TACK COAT) 0.05#/SF (POUND)	COLD MILLING EXISTING SURFACE (SQ YD)	HMA SHOULDERS (TON)
STA 1+00 TO STA 14+40 MAINLINE	630	2,379	5,360	
STA 14+40 TO STA 21+15 MAINLINE	274	1,048	2,328	
STA 14+50 TO STA 27+56 SHOULDERS	0	0	0	77
STA 21+15 TO STA 27+56 MAINLINE	252	965	2,144	
STA 27+56 TO STA 37+00 MAINLINE	280	1,070	2,378	148
STA 37+00 TO STA 195+75 MAINLINE	0	0	0	2,489
MURPHY STREET LT	9	33	72	
MURPHY STREET RT	15	59	130	
JARRELL STREET LT	13	50	110	
JARRELL STREET RT	12	45	99	
VALTER STREET LT	12	45	101	
VALTER STREET RT	12	44	98	
KARBER STREET LT	12	44	99	
KARBER STREET RT	13	51	114	
SHERMAN STREET LT	13	51	112	
SHERMAN STREET RT	13	51	112	
WELVER STREET RT	12	47	104	
HARRINGTON STREET RT	9	33	72	
DRONE DRIVE RT	9	35	77	
HERMANN DRIVE RT	11	41	92	
TOTALS	1,601	6,091	13,602	2,714

SIDEWALK SCHEDULE				
LOCATION	SIDEWALK REMOVAL (SQ FT)	PCC SIDEWALK 4 INCH (SQ FT)	CCC&G REMOVAL AND REPLACEMENT (FOOT)	DETECTABLE WARNINGS (SQ FT)
MURPHY STREET (NORTHEAST)	175.0	185.0	30.0	20.0
JARRELL STREET (NORTHWEST)	100.0	100.0	15.0	8.0
JARRELL STREET (SOUTHWEST)	80.0	80.0	10.0	8.0
JARRELL STREET (SOUTHEAST)	100.0	100.0	10.0	8.0
VALTER STREET (NORTHWEST)	115.0	120.0	10.0	8.0
VALTER STREET (SOUTHWEST)	110.0	120.0	10.0	8.0
VALTER STREET (NORTHEAST)	100.0	120.0	10.0	8.0
KARBER STREET (NORTHWEST)	230.0	240.0	25.0	16.0
KARBER STREET (SOUTHWEST)	180.0	200.0	25.0	16.0
KARBER STREET (NORTHEAST)	80.0	100.0	25.0	16.0
KARBER STREET (SOUTHEAST)	130.0	140.0	25.0	16.0
SHERMAN STREET (NORTHWEST)	60.0	70.0	10.0	8.0
STA 15+15 TO STA 16+05 RT			90.0	
TOTALS	1,460	1,575	295	140

NOTE: Quantities for Sidewalk Removal, PCC Sidewalk 4 inch, Curb Removal & Replacement, and Detectable Warnings are approximate and will be as determined in the field by the Engineer.

PAVEMENT MARKING SCHEDULE	
LOCATION	PAINT PAVEMENT MARKING - LINE 4" (FOOT)
STA 1+00 TO STA 37+00 (YELLOW SKIP DASH CENTERLINE)	900
STA 14+50 TO STA 27+56, 12' LT (EDGE WHITE LINE)	1,306
STA 27+56 TO STA 37+00, 11' LT AND 11' RT (EDGE WHITE LINE)	1,888
TOTALS	4,094

MANHOLES SCHEDULE		
LOCATION	MANHOLES TO BE ADJ WITH NEW T1F CL SP (EACH)	MANHOLES TO BE ADJUSTED (EACH)
STA. 4+17.2, 0.9'RT	1	
STA. 8+84.7, 15.3'LT	1	
STA. 12+39.4, 12.1'LT	1	
STA. 13+97.9, 23.9'LT	1	
STA. 14+25, RT		1
STA. 15+85.7, 12.0'LT	1	
STA. 19+22.1, 11.4'LT	1	
STA. 20+85.5, 8.3'LT	1	
TOTALS	7	1

NOTE: See Detail Sheet 5

VALVE BOXES SCHEDULE	
LOCATION	VALVE BOXES TO BE ADJUSTED (EACH)
STA. 1+11.1, 18.8'LT	1
STA. 1+20.3, 15.7'LT	1
STA. 1+39.0, 13.7'LT	1
STA. 4+38.3, 14.7'LT	1
STA. 6+97.7, 17.2'LT	1
STA. 10+72.4, 11.7'LT	1
STA. 20+75.4, 17.7'RT	1
TOTALS	7

06 Apr 2022 - 3:07pm X:\2020\20054\2nd Project\AC Second Project\20054\2nd Project\Layout Tab Construction Schedules 1'

CONTRACT NO. 99677

STREET NAME	PROJECT NO.	JOB NO.	ROUTE	SECTION	COUNTY	TOTAL SHEETS	SHEET NO.
MAIN STREET (CH 11)	T5RZ(501)	C-99-003-22	FAS 889	21-00085-00-RS	GALLATIN	9	4

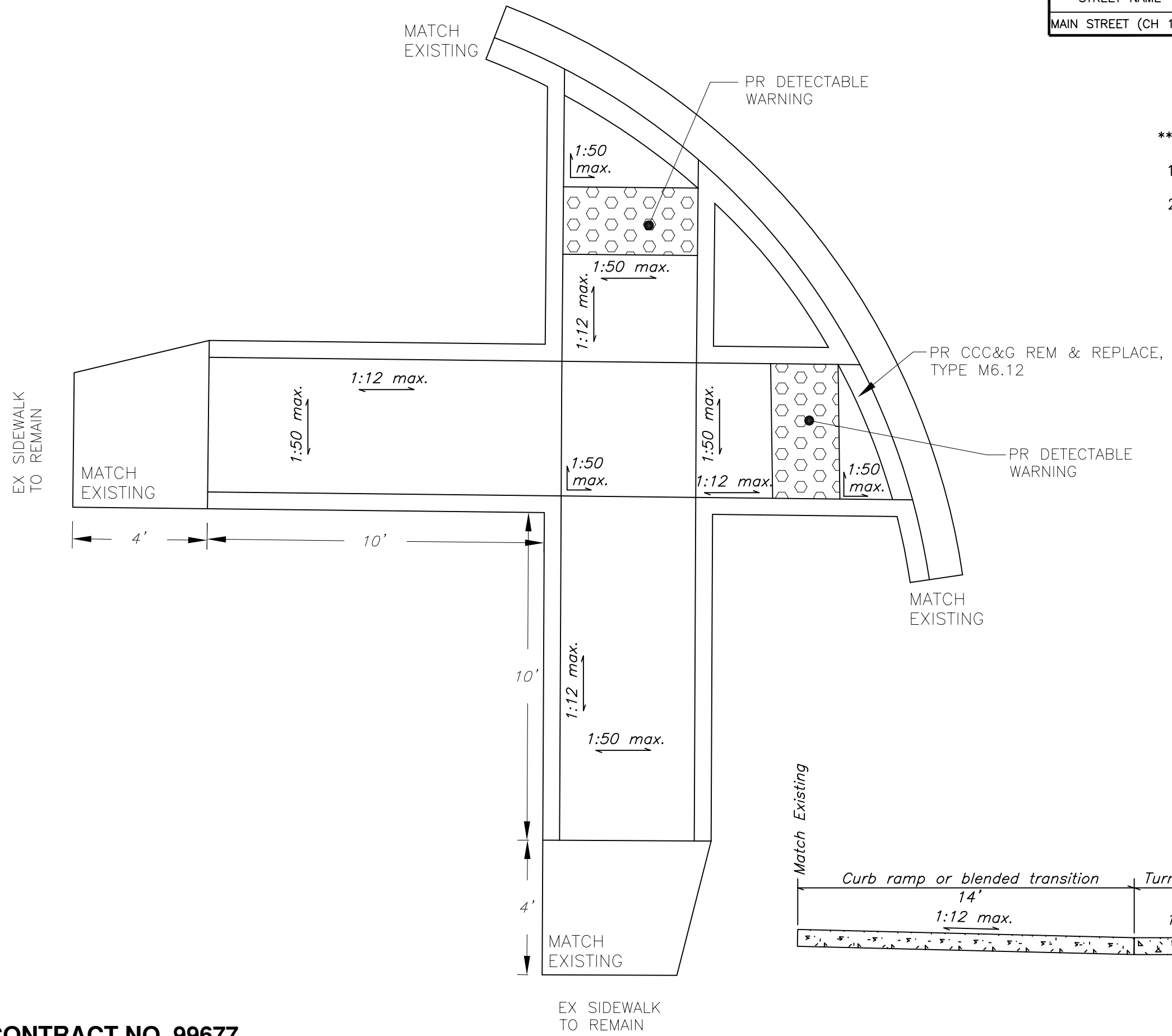

****NOTES****

1. THE LIMITS OF SIDEWALK TO BE REMOVED AND REPLACED WILL BE DETERMINED BY THE ENGINEER.
2. REFER TO HIGHWAY STANDARDS 424001, 424006, 424011, 424016, AND 424021 FOR DETAILS.

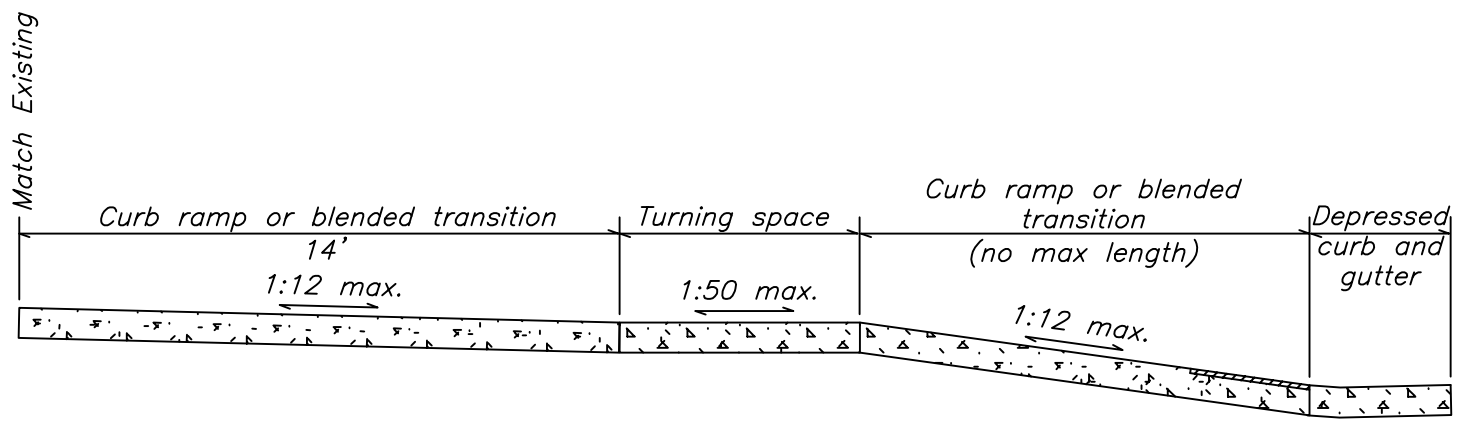

06 Apr 2022 - 3:08pm X:\2020\20054\2nd Project\AC Second Project\20054 Second Project\Typical Sections.dwg: Layout Tab 'Typical Sidewalk Detail'

CONTRACT NO. 99677

EX SIDEWALK TO REMAIN

STREET NAME	PROJECT NO.	JOB NO.	ROUTE	SECTION	COUNTY	TOTAL SHEETS	SHEET NO.
MAIN STREET (CH 11)	T5RZ(501)	C-99-003-22	FAS 889	21-00085-00-RS	GALLATIN	9	5

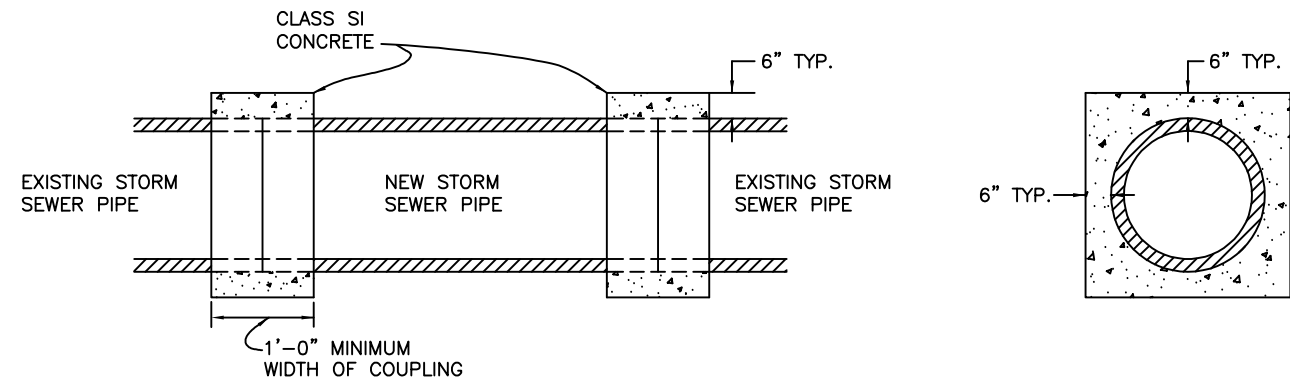

CONCRETE COLLAR DETAIL

NOT TO SCALE

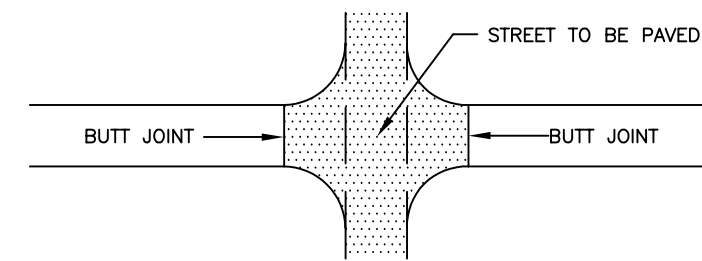

TYPICAL INTERSECTION DETAIL

NO SCALE

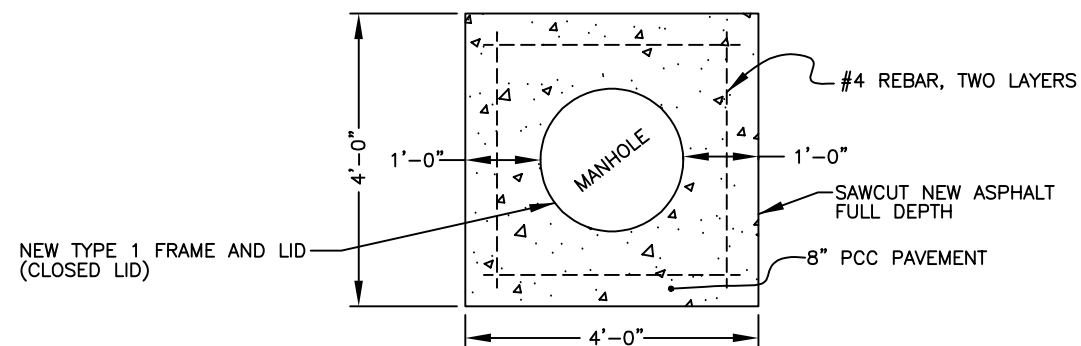

DETAIL - MANHOLE ADJUSTMENT,
NEW TYPE 1 FRAME, CLOSED LID, SPECIAL

NOT TO SCALE

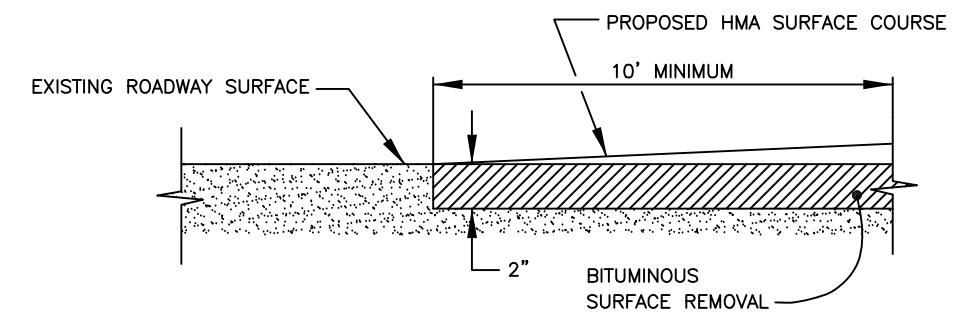

BUTT JOINT DETAIL

NO SCALE

06 Apr 2022 - 3:09pm X:\2020\2005\2nd Project\AC Second Project\2005\2nd Project\Typical Sections.dwg: Layout Tab 'Typical Details'



X:\2020\20054\2nd Project\AC Second Project\20054\2nd Project Plans.dwg: Layout Tab 'Storm Sewer Detail'

06 Apr 2022 - 3:09pm CONTRACT NO. 99677

BROWN & ROBERTS, INC

STREET NAME	PROJECT NO.	JOB NO.	ROUTE	SECTION	COUNTY	TOTAL SHEETS	SHEET NO.
MAIN STREET (CH 11)	T5RZ(501)	C-99-003-22	FAS 889	21-00085-00-RS	GALLATIN	9	6

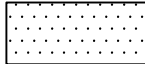
LEGEND

-  AREA OF COLD MILLING AND HMA SURFACE COURSE, IL-9.5 MIX "C", N70
-  EXISTING STORM SEWER TO BE REMOVED AND REPLACED

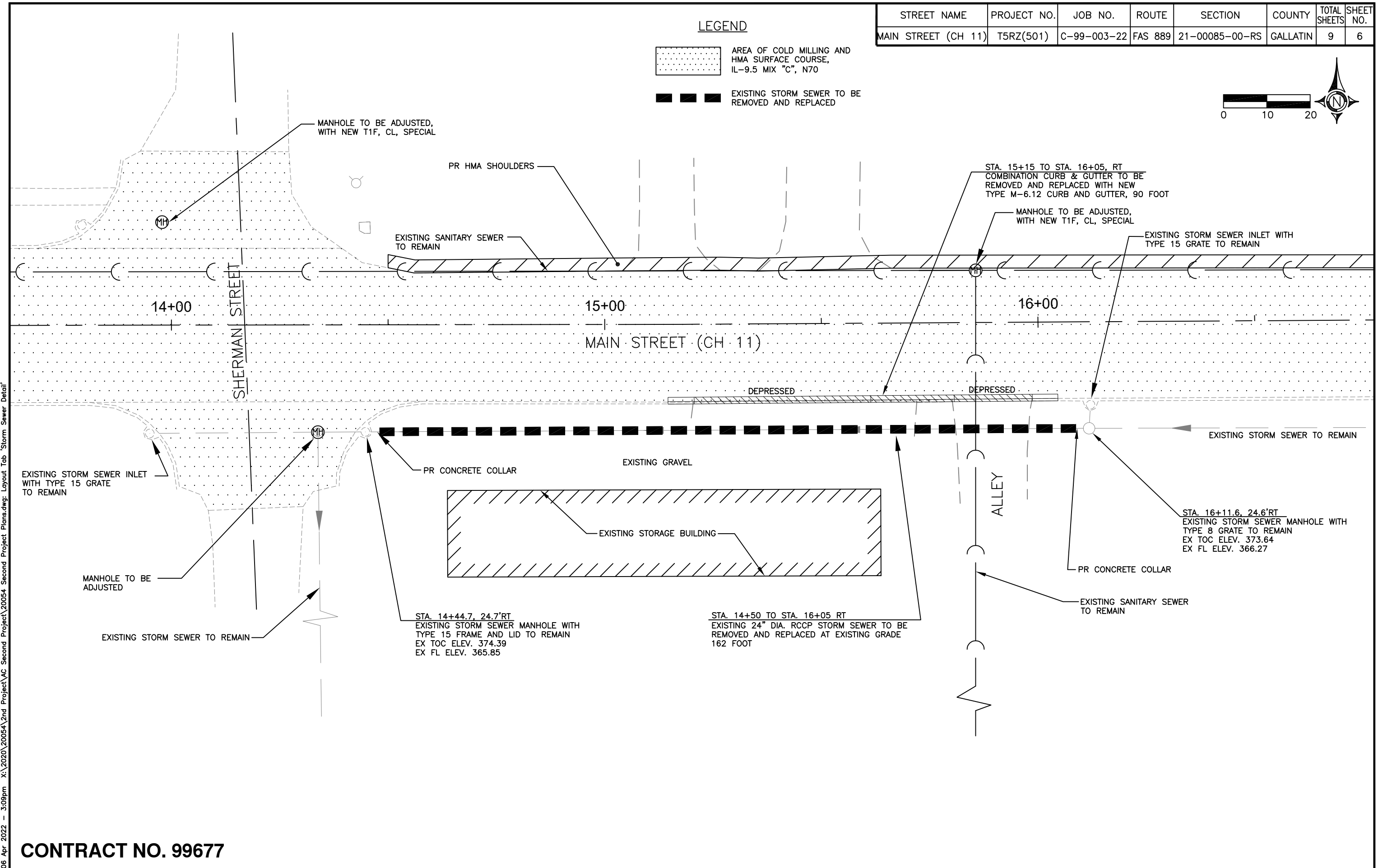
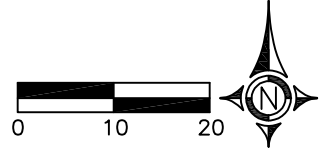

STREET NAME	PROJECT NO.	JOB NO.	ROUTE	SECTION	COUNTY	TOTAL SHEETS	SHEET NO.
MAIN STREET (CH 11)	T5RZ(501)	C-99-003-22	FAS 889	21-00085-00-RS	GALLATIN	9	7

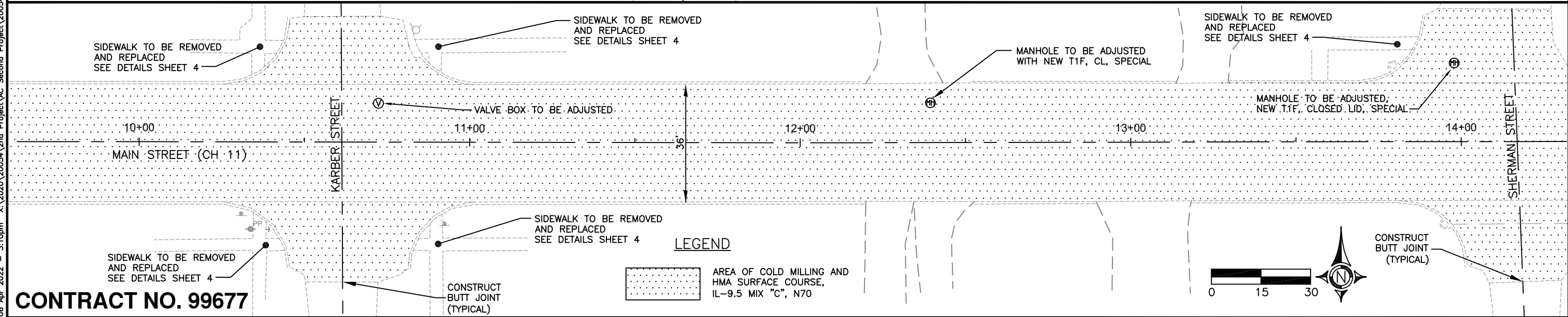
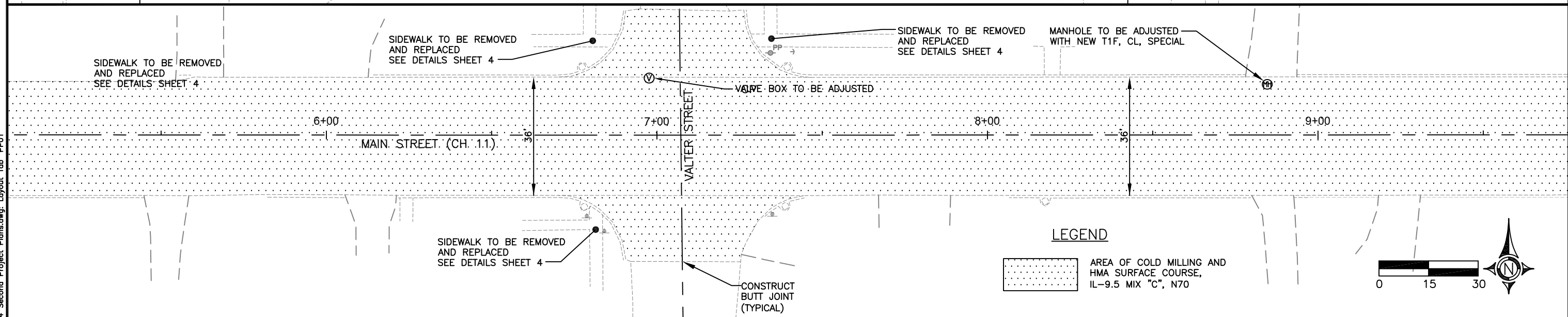
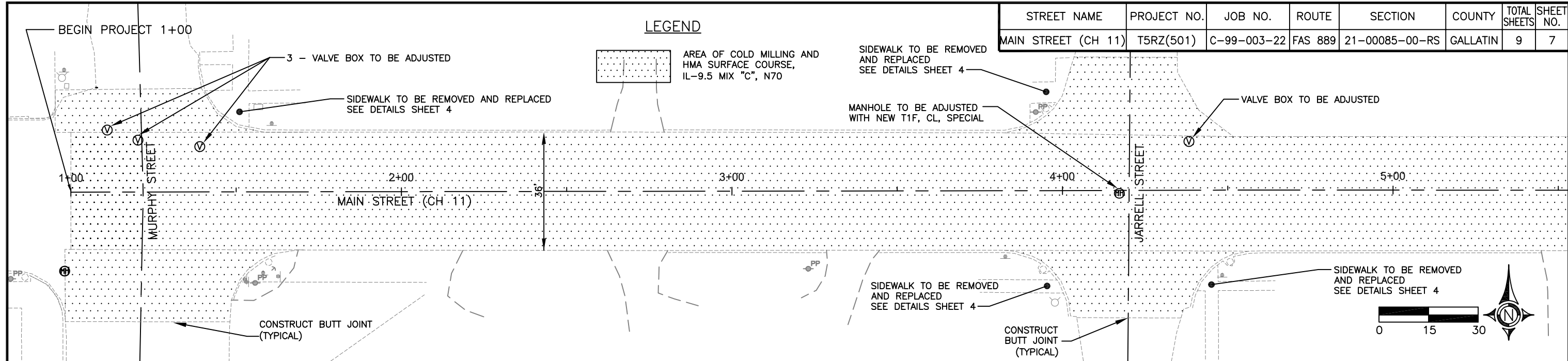

CONTRACT NO. 99677

06 Apr 2022 - 3:10pm X:\2020\20054\2nd Project\AC Second Project\20054 Second Project Plans.dwg: Layout Tab 'PP01'

06 Apr 2022 - 3:10pm X:\2020\20054\2nd Project\AC Second Project\20054 Second Project Plans.dwg: Layout Tab 'PP02'

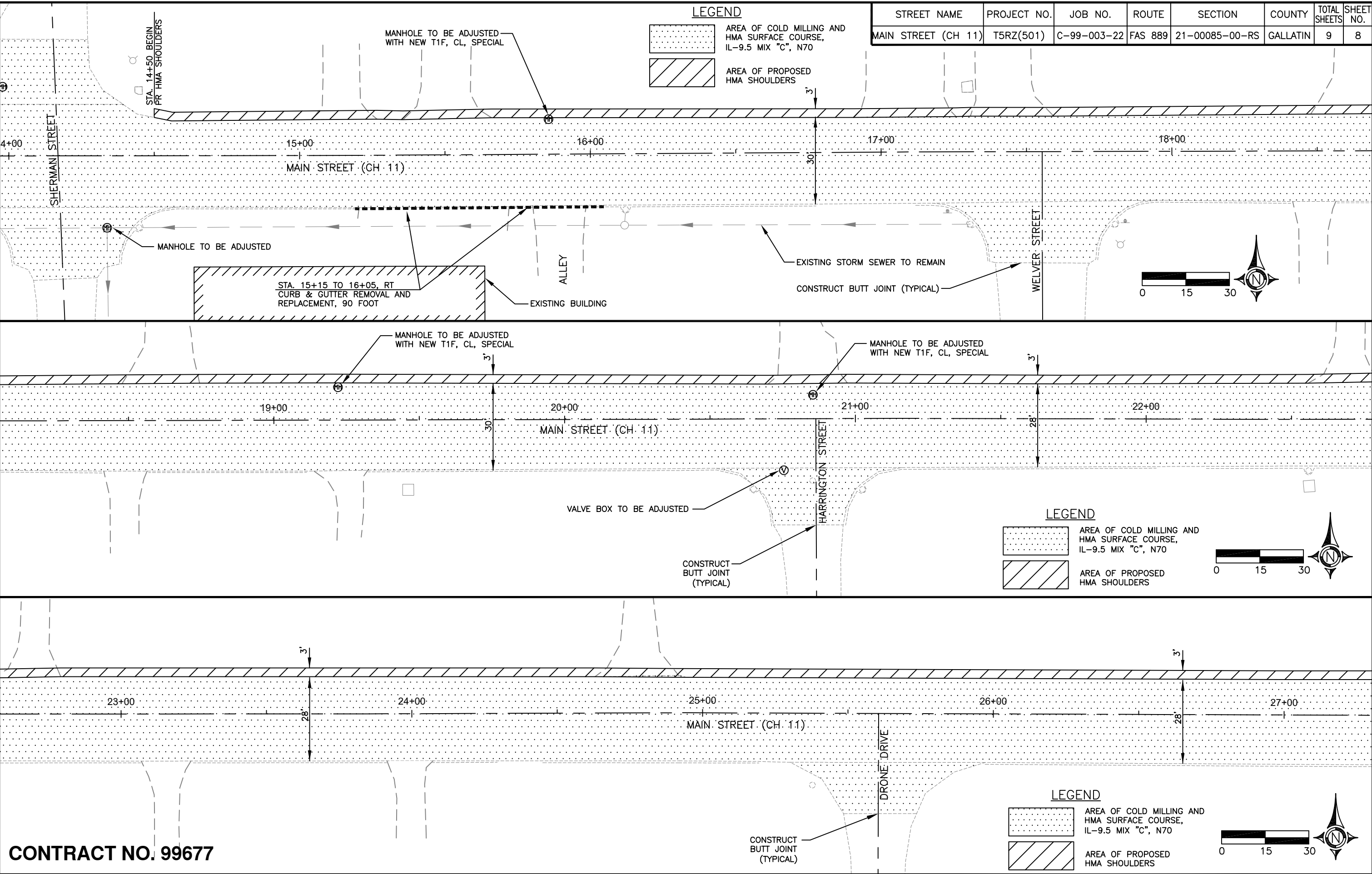

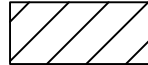

LEGEND

-  AREA OF COLD MILLING AND HMA SURFACE COURSE, IL-9.5 MIX "C", N70
-  AREA OF PROPOSED HMA SHOULDERS

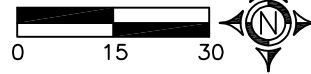
STREET NAME	PROJECT NO.	JOB NO.	ROUTE	SECTION	COUNTY	TOTAL SHEETS	SHEET NO.
MAIN STREET (CH 11)	T5RZ(501)	C-99-003-22	FAS 889	21-00085-00-RS	GALLATIN	9	8



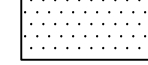

LEGEND

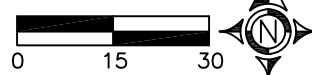
-  AREA OF COLD MILLING AND HMA SURFACE COURSE, IL-9.5 MIX "C", N70
-  AREA OF PROPOSED HMA SHOULDERS

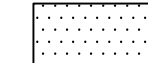

LEGEND

-  AREA OF COLD MILLING AND HMA SURFACE COURSE, IL-9.5 MIX "C", N70
-  AREA OF PROPOSED HMA SHOULDERS

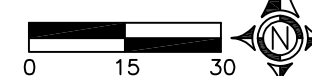

CONTRACT NO. 99677

STREET NAME	PROJECT NO.	JOB NO.	ROUTE	SECTION	COUNTY	TOTAL SHEETS	SHEET NO.
MAIN STREET (CH 11)	T5RZ(501)	C-99-003-22	FAS 889	21-00085-00-RS	GALLATIN	9	9

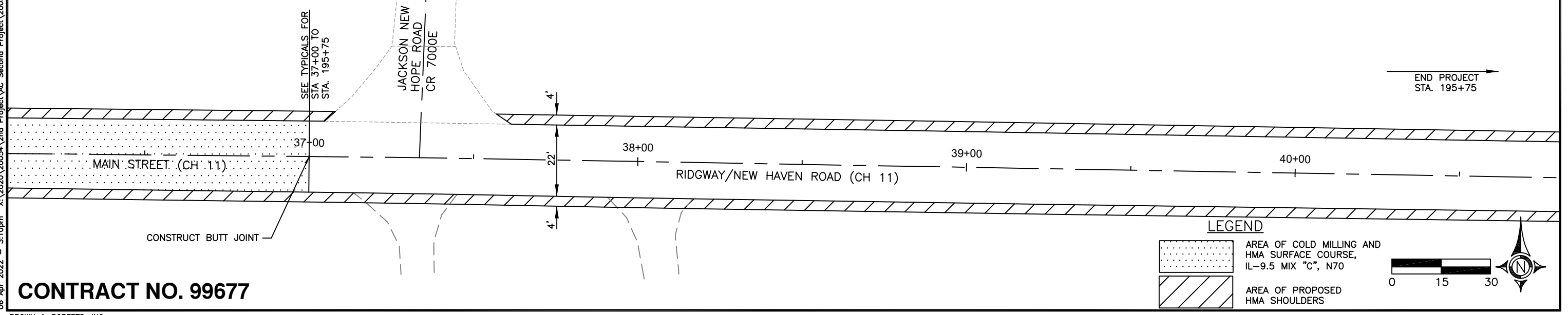
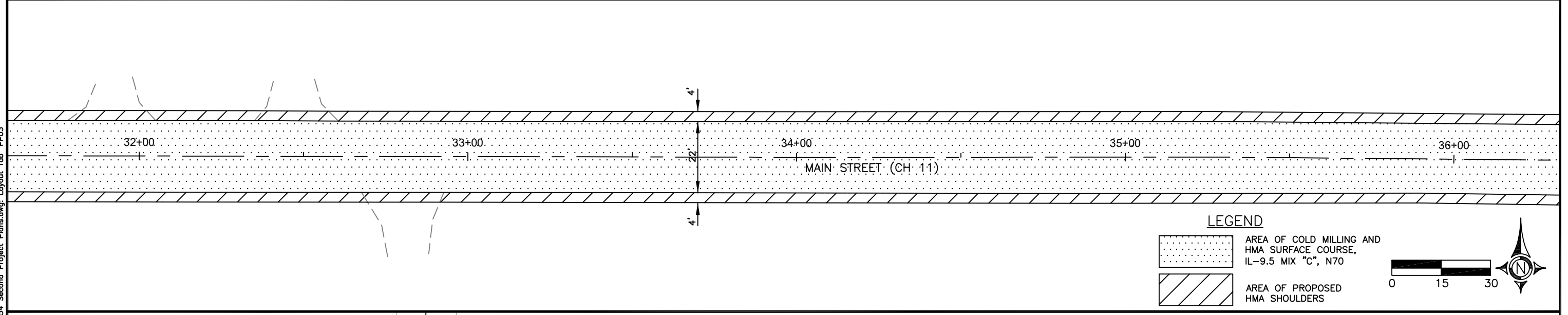
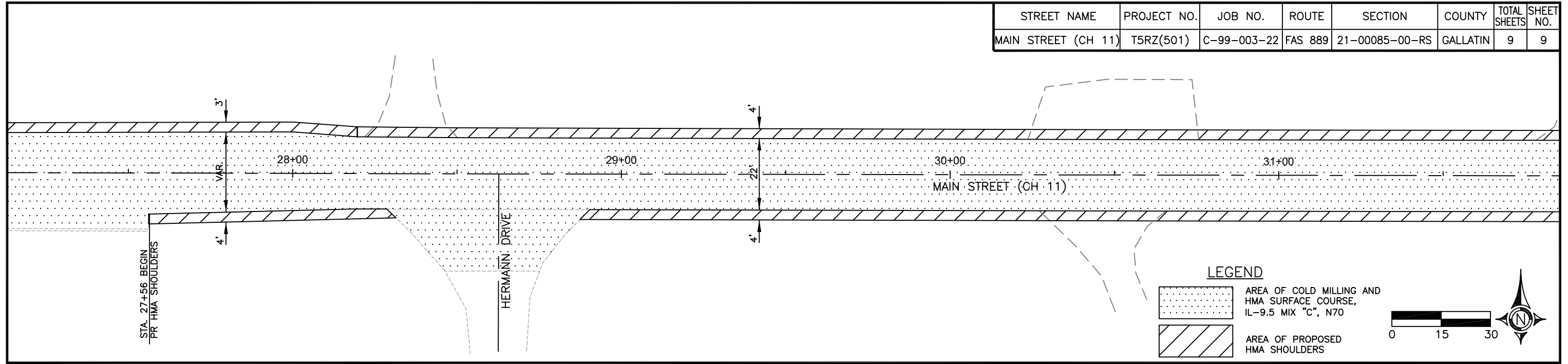

CONTRACT NO. 99677

06 Apr 2022 - 3:10pm X:\2020\20054\2nd Project\AC Second Project\20054 Second Project Plans.dwg: Layout Tab 'PP03'