

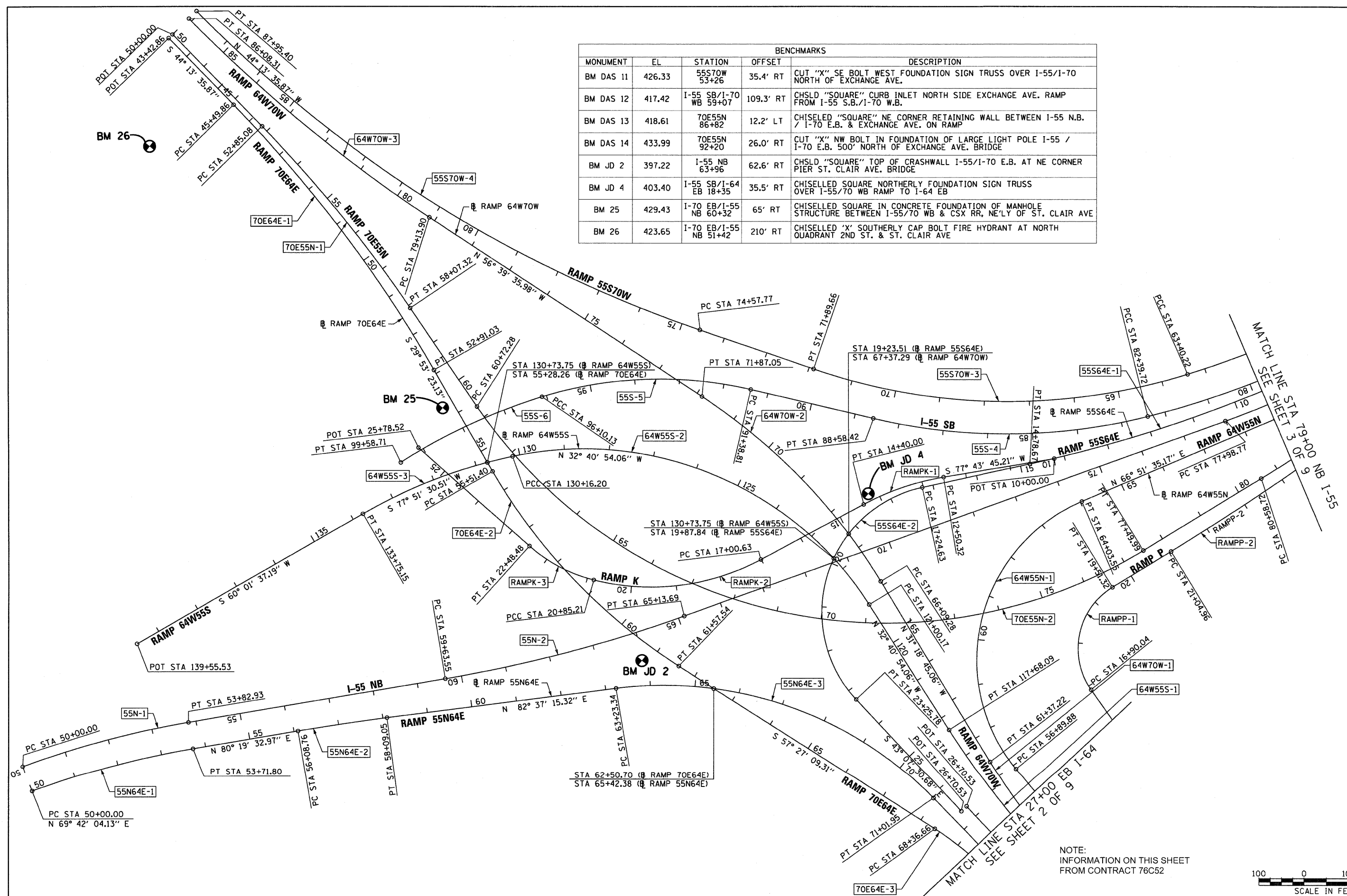

BENCHMARKS				
MONUMENT	EL	STATION	OFFSET	DESCRIPTION
BM DAS 11	426.33	55S70W 53+26	35.4' RT	CUT "X" SE BOLT WEST FOUNDATION SIGN TRUSS OVER I-55/I-70 NORTH OF EXCHANGE AVE.
BM DAS 12	417.42	I-55 SB/I-70 WB 59+07	109.3' RT	CHSLD "SQUARE" CURB INLET NORTH SIDE EXCHANGE AVE. RAMP FROM I-55 S.B./I-70 W.B.
BM DAS 13	418.61	70E55N 86+82	12.2' LT	CHISELED "SQUARE" NE CORNER RETAINING WALL BETWEEN I-55 N.B. / I-70 E.B. & EXCHANGE AVE. ON RAMP
BM DAS 14	433.99	70E55N 92+20	26.0' RT	CUT "X" NW BOLT IN FOUNDATION OF LARGE LIGHT POLE I-55 / I-70 E.B. 500' NORTH OF EXCHANGE AVE. BRIDGE
BM JD 2	397.22	I-55 NB 63+96	62.6' RT	CHSLD "SQUARE" TOP OF CRASHWALL I-55/I-70 E.B. AT NE CORNER PIER ST. CLAIR AVE. BRIDGE
BM JD 4	403.40	I-55 SB/I-64 EB 18+35	35.5' RT	CHISELED SQUARE NORTHERLY FOUNDATION SIGN TRUSS OVER I-55/70 WB RAMP TO I-64 EB
BM 25	429.43	I-70 EB/I-55 NB 60+32	65' RT	CHISELED SQUARE IN CONCRETE FOUNDATION OF MANHOLE STRUCTURE BETWEEN I-55/70 WB & CSX RR, NE'LY OF ST. CLAIR AVE
BM 26	423.65	I-70 EB/I-55 NB 51+42	210' RT	CHISELED "X" SOUTHERLY CAP BOLT FIRE HYDRANT AT NORTH QUADRANT 2ND ST. & ST. CLAIR AVE

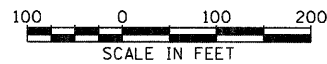

NOTE:  
INFORMATION ON THIS SHEET  
FROM CONTRACT 76C52



FILE NAME = DBTR1-76C52-shr-ATB-B1.dgn

USER NAME = searsb  
PLOT SCALE = 200.0000' / 1" =  
PLOT DATE = 1/24/2012

DESIGNED	OP	REVISED	-
DRAWN	OP	REVISED	-
CHECKED	DBM	REVISED	-
DATE	1-20-12	REVISED	-

**STATE OF ILLINOIS  
DEPARTMENT OF TRANSPORTATION**

**ALIGNMENT, TIES AND BENCHMARKS**

SCALE: 1"=100' SHEET NO. 1 OF 9 SHEETS STA. TO STA.

F.A.I. RTE.	SECTION	COUNTY	TOTAL SHEETS	SHEET NO.
55/70	82-1LS	ST. CLAIR	38	5
CONTRACT NO. 76F37				
FED. ROAD DIST. NO.		ILLINOIS FED. AID PROJECT		