

CONCRETE BARRIER REMOVAL

- (A) - STA 1825+79.77, 52.38' LT
- (B) - STA 1825+99.70, 54.43' LT
- (C) - STA 1831+41.93, 16.90' RT
- (D) - STA 1831+57.78, 41.82' RT
- (E) - STA 1832+19.09, 2.48' LT
- (F) - STA 1832+35.20, 200.43' RT

REMOVAL LEGEND

- [Hatched Box] PAVEMENT REMOVAL
- [Cross-hatched Box] PAVED SHOULDER REMOVAL
- [Dotted Box] APPROACH SLAB REMOVAL
- [Wavy Line Box] LUG SYSTEM REMOVAL
- [Dashed Line] LINEAR REMOVAL
- [Dotted Area] TREE REMOVAL, ACRES
- [X] TREE REMOVAL

THE COMPLETE REMOVAL OF LUG SYSTEM IS INCLUDED IN THE COST OF PAVEMENT REMOVAL. LIMITS SHOWN FOR INFORMATION ONLY. ACTUAL LOCATIONS OF REMOVAL SHALL BE VERIFIED IN THE FIELD.

BOXED ITEMS ARE INCLUDED IN THE COST OF THE CONTRACT.

TREE REMOVAL, ACRES

POINT	STATION	OFFSET	LT/RT
(A)	1832+82.91	124.76'	RT
(B)	1832+75.00	129.02'	RT
(C)	1832+50.00	153.03'	RT
(D)	1832+40.67	133.78'	RT
(E)	1831+79.21	23.64'	RT
(F)	1832+37.71	2.91'	RT

EXISTING

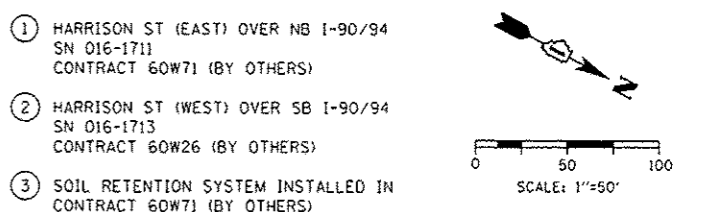
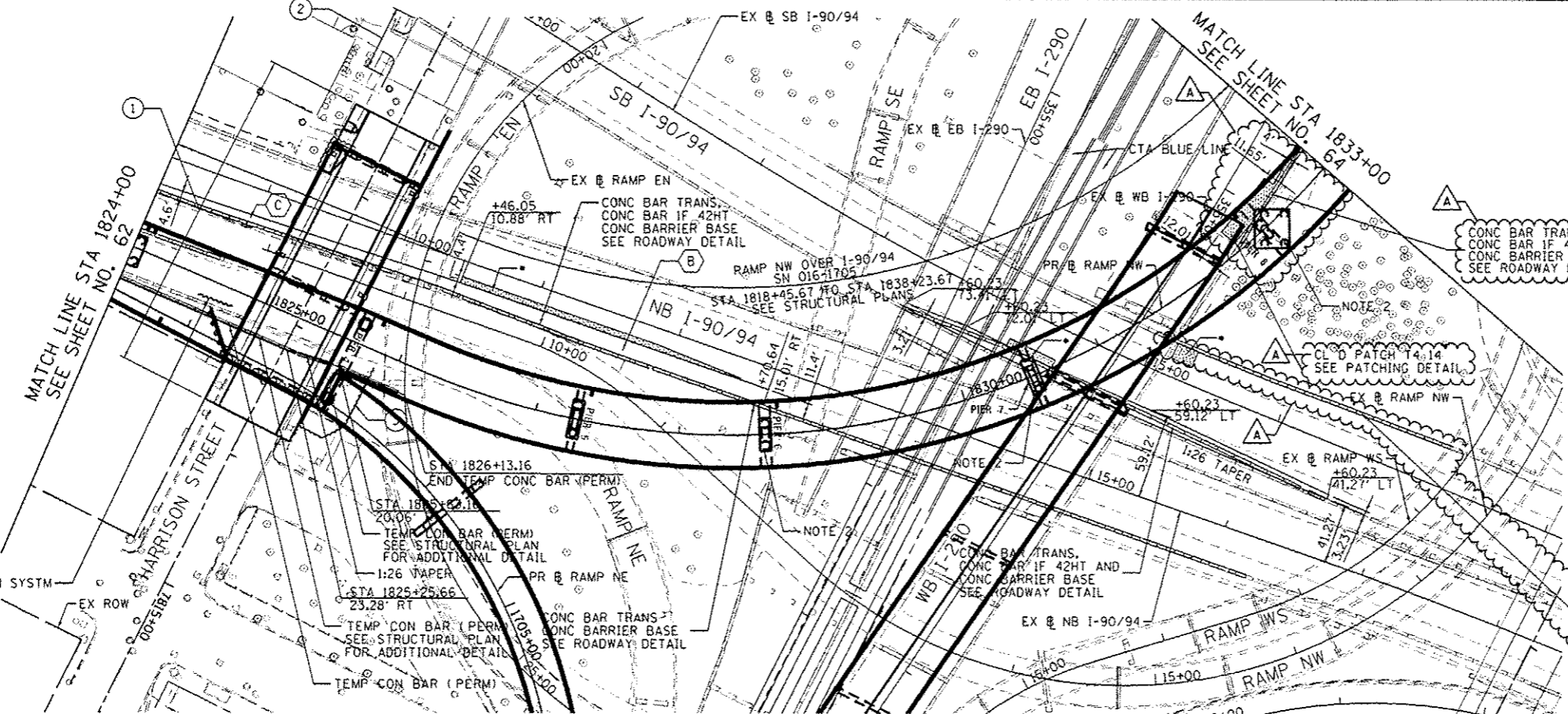

- 1 HARRISON ST (EAST) OVER NB I-90/94
SN 016-I711
CONTRACT 60W71 (BY OTHERS)
- 2 HARRISON ST (WEST) OVER SB I-90/94
SN 016-I713
CONTRACT 60W26 (BY OTHERS)
- 3 SOIL RETENTION SYSTEM INSTALLED IN
CONTRACT 60W71 (BY OTHERS)

NOTE:

- 1. SEE SHTS 66 TO 69 FOR PR ROADWAY PROFILES
- 2. FOR BRACED EXCAVATION, SEE BRACED EXCAVATION LIMIT PLAN AND SPECIAL PROVISION

PROPOSED ROADWAY LEGEND

- (A) TEMPORARY PAVEMENT
SUB GRAN MAT B 4
- (B) PCC PVT 10 1/2 JOINTD
STAB SUBBASE HMA 4
AGG SUBGRADE IMPR 12
- (C) PCC SHOULDERS 10 1/2
SUB GRAN MAT C 4
AGG SUBGRADE IMPR 12
- (D) PCC PVT 10 JOINTED
STAB SUBBASE HMA 4
AGG SUBGRADE IMPR 12
- (E) PCC SHOULDERS 10
SUB GRAN MAT C 4
AGG SUBGRADE IMPR 12

PROPOSED



D:\60W26-SHT-PLAN-04.dgn
 USER NAME: pmsarno
 PLOT SCALE: 1/80.0000 1/4" = 1'-0"
 PLOT DATE: 5/26/2014

DESIGNED - KAM
 DRAWN - NSA/OPS
 CHECKED - KCF
 DATE - 04/28/14

REVISED - 5/27/2014
 REVISED -
 REVISED -
 REVISED -

STATE OF ILLINOIS
 DEPARTMENT OF TRANSPORTATION

EXISTING AND PROPOSED PLAN
 RAMP NW
 SCALE: 1"=50'
 SHEET 4 OF 6 SHEETS
 STA. 1824+00 TO STA. 1833+00

F.A.J. RTE.	SECTION	COUNTY	TOTAL SHEETS	SHEET NO.
90/94/290	2013-010R	COOK	747	63
CONTRACT NO. 60W28				
ILLINOIS FED. AID PROJECT				

FILE PATH: C:\Users\pmsarno\AppData\Local\Temp\1\1824+00\1824+00.dwg
 PROJECT: I:\60W26-SHT-PLAN-04.dgn
 DRAWN: NSA/OPS
 CHECKED: KCF
 DATE: 04/28/14