

NOTE:
UNLESS OTHERWISE NOTED ALL STATIONING AND OFFSET SHOWN ON THIS SHEET REFER TO PROPOSED RAMP NW ALIGNMENT

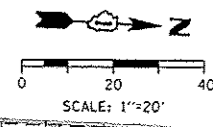

SEE SHEETS 61 AND 62 FOR ADDITIONAL INFORMATION FOR EXISTING AND PROPOSED PLAN - RAMP NW

REMOVAL LEGEND

- PAVEMENT REMOVAL
- PAVED SHOULDER REMOVAL
- APPROACH SLAB REMOVAL
- LINEAR REMOVAL
- TREE REMOVAL, ACRES
- TREE REMOVAL

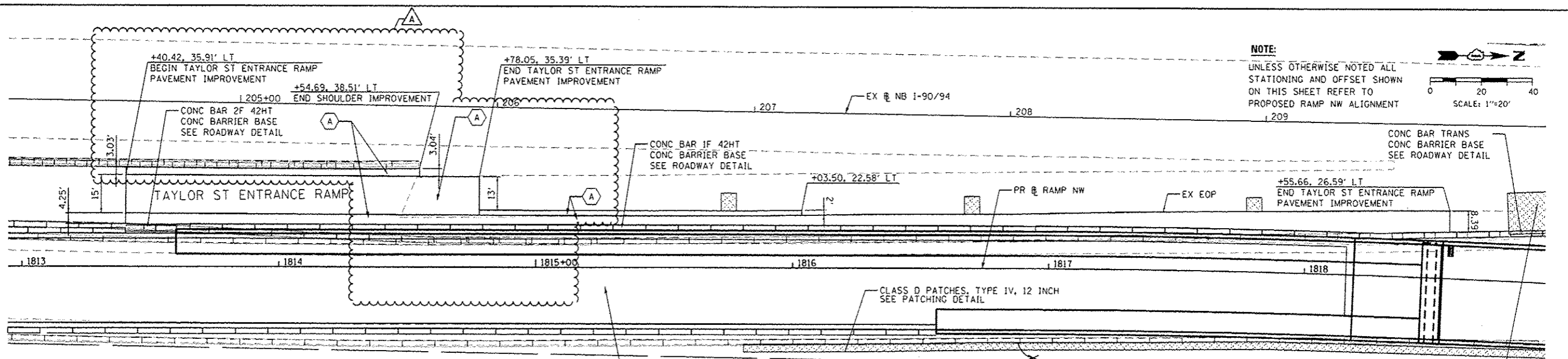

NOTE:
UNLESS OTHERWISE NOTED ALL STATIONING AND OFFSET SHOWN ON THIS SHEET REFER TO PROPOSED RAMP NW ALIGNMENT

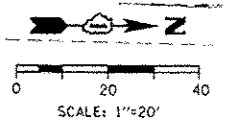

SEE SHEETS 61 AND 62 FOR ADDITIONAL INFORMATION FOR EXISTING AND PROPOSED PLAN - RAMP NW

PROPOSED ROADWAY LEGEND

- TEMPORARY PAVEMENT SUB GRAN MAT B 4
- PCC PVT 10 1/2 JOINTED STAB SUBBASE HMA 4 AGG SUBGRADE IMPR 12
- PCC SHOULDERS 10 1/2 SUB GRAN MAT C 4 AGG SUBGRADE IMPR 12
- PCC PVT 10 JOINTED STAB SUBBASE HMA 4 AGG SUBGRADE IMPR 12
- PCC SHOULDERS 10 SUB GRAN MAT C 4 AGG SUBGRADE IMPR 12
- CL A PATCH T4 13 PATCH REINFORCEMENT TIE BARS 3/4 SAW CUTS SEE PATCHING DETAIL



0160428-SHT-PLAN-BB.dgn	DESIGNED - OPS	REVISED - 5/27/2014
USER NAME - pms@rd	DRAWN - NSA	REVISED -
PLT SCALE - 40,0000' / 1"	CHECKED - KCF	REVISED -
PLT DATE - 5/26/2014	DATE - 04/28/14	REVISED -

STATE OF ILLINOIS
DEPARTMENT OF TRANSPORTATION

ROADWAY PLAN
TAYLOR ENTRANCE RAMP IMPROVEMENT

SCALE: 1"=20' SHEET 1 OF 1 SHEETS STA. TO STA.

P.A.I. RTE.	SECTION	COUNTY	TOTAL SHEETS	SHEET NO.
90/94/290	2013-010R	COOK	747	71
CONTRACT NO. 60W28			ILLINOIS FED. AID PROJECT	