

TRAFFIC CONTROL NOTES

1. PRIMARY DETOUR ROUTE: TAKE RAMP SW TO I-290 WB, EXIT AT ASHLAND AVE, RETURN EASTBOUND ON I-290, USE RAMP ES TO ACCESS EB I-90/94 (SB)
2. SOUTHBOUND ENTRANCE RAMP AT LAKE STREET, RANDOLPH ST, AND MADISON STREET ARE TO BE CLOSED. TRAFFIC IS TO BE DETOURED ALONG HALSTED ST AND DES PLAINES ST
3. EASTBOUND I-290 ENTRANCE RAMP FROM ASHLAND IS TO BE CLOSED.
4. EASTBOUND I-290 EXIT RAMP TO RACINE AVE IS TO BE CLOSED.
5. NORTHBOUND ASHLAND AVE TRAFFIC IS TO BE DETOURED TO LOOMIS ST.
6. WESTBOUND I-290 ENTRANCE RAMP FROM RACINE AVE IS TO BE CLOSED.
7. WESTBOUND ASHLAND AVE EXIT IS TO BE CLOSED TO ALL I-290 TRAFFIC, THIS MOVEMENT WILL ONLY BE OPEN TO DETOURED EB I-90/94 (SB) TRAFFIC.
8. EASTBOUND CONGRESS PARKWAY IS TO BE CLOSED AT ASHLAND AVE.
9. DETOUR SIGNING MUST BE INSTALLED PRIOR TO THE CLOSURE OF EB I-90/94 (SB).
10. ROAD CLOSURE SHALL FOLLOW THE LATEST VERSION OF THE IDOT HIGHWAY STANDARDS AND DISTRICT 1 STANDARD DETAIL TC-08. SEE SUGGESTED STAGES OF CONSTRUCTION AND TRAFFIC CONTROL PLANS FOR ADDITIONAL INFORMATION.
11. PLACEMENT AND SPACING OF SIGNS AND BARRICADES SHALL BE IN ACCORDANCE WITH IDOT DISTRICT 1 STANDARD DETAIL TC-08 AND TC-21.
12. ALL DETOUR SIGNS SHALL HAVE AN ORANGE BACKGROUND WITH BLACK LETTERS.
13. THE CONTRACTOR IS RESPONSIBLE FOR COORDINATION WITH OTHER ROAD WORK IN THE AREA.
14. THE COST OF SUPPLYING, ERECTING AND MAINTAINING BARRICADES, WARNING LIGHTS AND STANDARD SIGNS ALONG ALL DETOUR ROUTES SHALL BE INCLUDED IN THE CONTRACT COST OF TRAFFIC CONTROL AND PROTECTION (SPECIAL).
15. THIS DETOUR CAN ONLY BE USED DURING GIRDER ERECTION. REFER TO THE SPECIAL PROVISIONS "GIRDER ERECTION INFORMATION AND RESTRICTIONS" FOR ADDITIONAL INFORMATION.

LEGEND

- SUGGESTED PRIMARY ROUTE FOR EB I-90/94 (SB)
- SECONDARY CLOSURES AND DETOURS NECESSARY TO FACILITATE PRIMARY DETOUR
- TEMPORARY SIGN
- EXISTING SIGN
- EXISTING POLE
- SIGN BARRICADE TYPE III
- TWO-WAY STREET
- ONE-WAY STREET
- RAMP CLOSURE

DETOUR SIGNS TYPE & SIZE

(ALL SIGN COLORS SHALL BE ACCORDING TO THE LATEST EDITION OF THE MUTCD)

- MI-1 (24"x24")
- EAST M3-2 (24"x12")
- NORTH M3-1 (24"x12")
- DETOUR M4-8 (24"x12")
- END DETOUR M4-8A (24"x18")
- M5-1 (21"x15")
- M6-1 (21"x15")
- M6-2 (21"x15")
- M6-3 (21"x15")
- DETOUR AHEAD W20-2 (48"x48")
- ROAD CONSTRUCTION AHEAD W20-1103-48
- ROAD CLOSED AHEAD W20-3-48

- RAMP CLOSED SEE TC-08 FOR SIGN INFORMATION BLACK LETTERS ON ORANGE BACKGROUND (48"x36")
- ROAD CLOSED R11-2 SEE TC-21 FOR SIGN INFORMATION (48"x30")
- DETOUR M4-9R (30"x24")
- DETOUR M4-9L (30"x24")
- M4-9 (30"x24")
- CUSTOM SPECIAL - LOCAL ROAD BLACK LETTERS ON ORANGE BACKGROUND (30"x18")

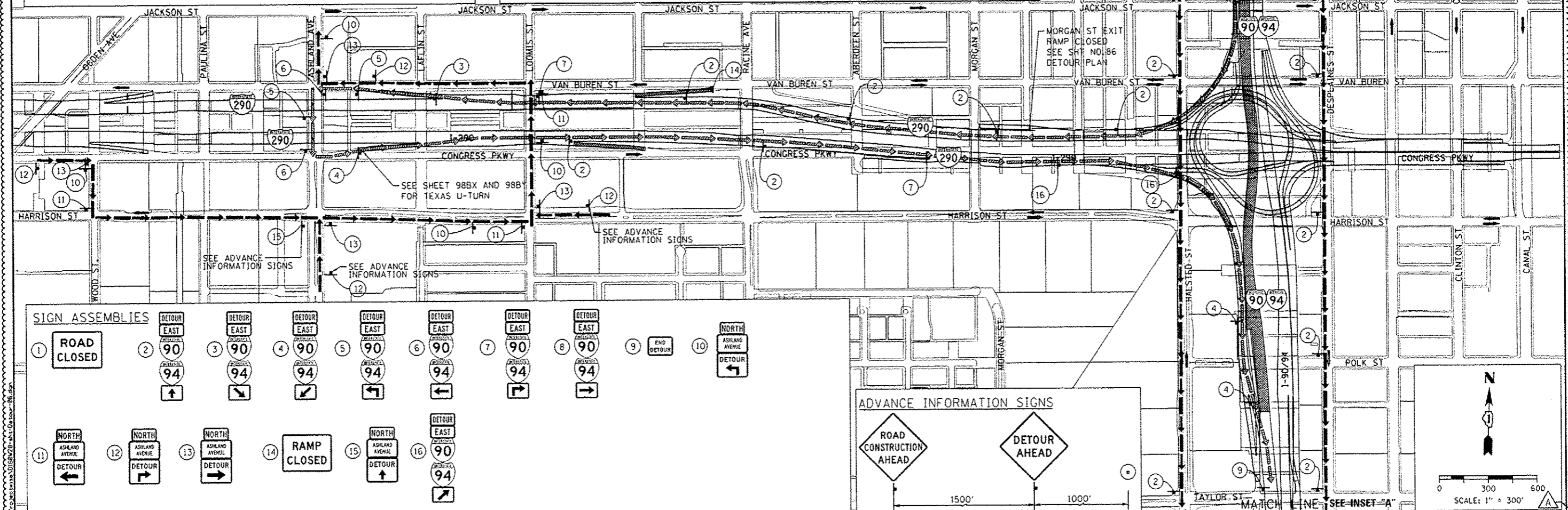

SIGN ASSEMBLIES

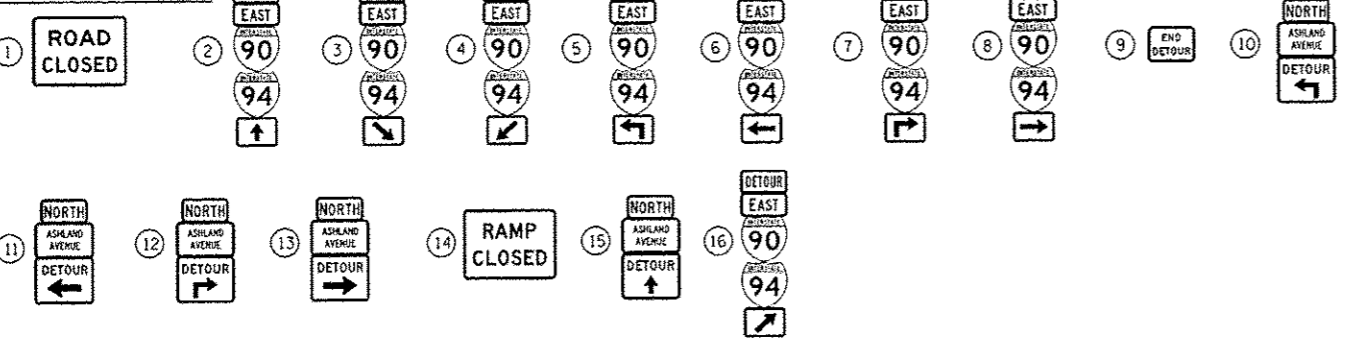

ADVANCE INFORMATION SIGNS

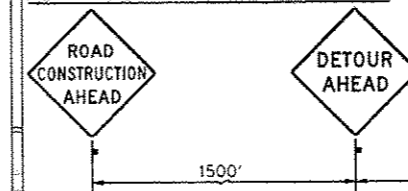

INSET "A" MATCH LINE

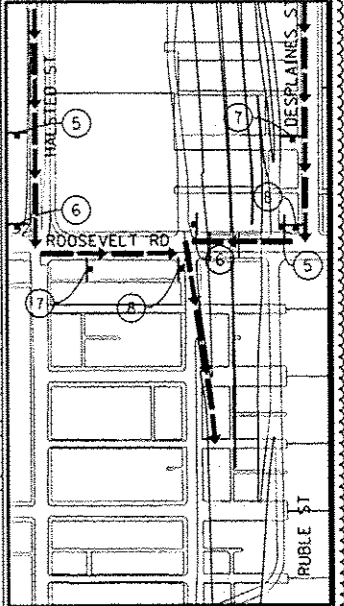

0168W28-sh1-Detour-86.dgn	DESIGNED - AFC	REVISED - 05/27/2014
USER NAME = brosej	DRAWN - AFC	REVISED -
PLOT SCALE = 680.0000 "/>		

STATE OF ILLINOIS
DEPARTMENT OF TRANSPORTATION

DETOUR PLAN
EB I-90/94 (SB)

SCALE: 1" = 300' SHEET 1 OF 1 SHEETS STA. TO STA.

F.A.I. RTE. 90/94/290	SECTION 2013-010R	COUNTY COOK	TOTAL SHEETS 747	SHEET NO. 90A
CONTRACT NO. 60W28			ILLINOIS FED. AID PROJECT	