

**TRAFFIC CONTROL NOTES**

1. PRIMARY DETOUR ROUTE; EXIT AT ROOSEVELT RD. LEFT AT ROOSEVELT RD. UNTIL RIGHT AT ASHLAND AVE. LEFT AT VAN BUREN ST. ENTER TO I-290 (WB).
2. DETOUR SIGNING MUST BE INSTALLED PRIOR TO THE CLOSURE OF TEMPORARY RAMP NW.
3. RAMP CLOSURE SHALL FOLLOW THE LATEST VERSION OF THE IDOT HIGHWAY STANDARDS AND DISTRICT 1 STANDARD DETAIL TC-08. SEE SUGGESTED STAGES OF CONSTRUCTION AND TRAFFIC CONTROL PLANS FOR ADDITIONAL INFORMATION.
4. PLACEMENT AND SPACING OF SIGNS AND BARRICADES SHALL BE IN ACCORDANCE WITH IDOT DISTRICT 1 STANDARD DETAIL TC-08 AND TC-21.
5. ALL DETOUR SIGNS SHALL HAVE AN ORANGE BACKGROUND WITH BLACK LETTERS.
6. THE CONTRACTOR IS RESPONSIBLE FOR COORDINATION WITH OTHER ROAD WORK IN THE AREA.
7. THE COST OF SUPPLYING, ERECTING AND MAINTAINING BARRICADES, WARNING LIGHTS AND STANDARD SIGNS ALONG ALL DETOUR ROUTES SHALL BE INCLUDED IN THE CONTRACT COST OF TRAFFIC CONTROL AND PROTECTION (SPECIAL).
8. THIS DETOUR CAN ONLY BE USED DURING GIRDER ERECTION OF UNIT #3. REFER TO THE SPECIAL PROVISIONS "GIRDER ERECTION INFORMATION AND RESTRICTIONS" FOR ADDITIONAL INFORMATION.

**LEGEND**

- SUGGESTED PRIMARY ROUTE FOR WB I-290
- TEMPORARY SIGN
- EXISTING SIGN
- EXISTING POLE
- SIGN BARRICADE TYPE III
- TWO-WAY STREET
- ONE-WAY STREET
- RAMP CLOSURE

**DETOUR SIGNS TYPE & SIZE**  
(ALL SIGN COLORS SHALL BE ACCORDING TO THE LATEST EDITION OF THE MUTCD)

- M1-1 (30"x24")
- M3-4 (24"x12")
- M4-8 (24"x12")
- M4-8A (24"x18")
- M5-1 (21"x15")
- M6-1 (21"x15")
- M6-2A (21"x15")
- M6-2 (21"x15")
- M6-3 (21"x15")

- W20-2 (48"x48")
- W20-1103-48
- SEE TC-08 FOR SIGN INFORMATION BLACK LETTERS ON ORANGE BACKGROUND (48"x36")

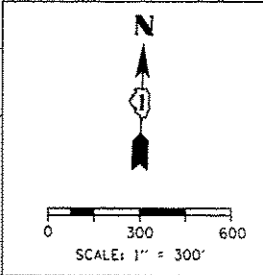
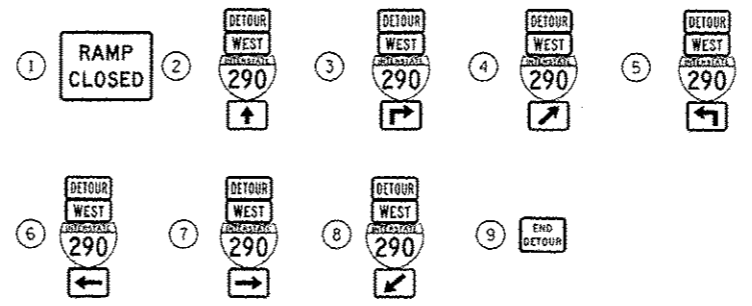
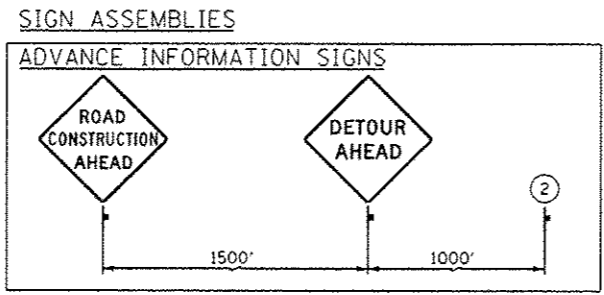

FILE PATH: C:\P\60628\60628.dwg



D168W28-shs-Detour-11.dgn  
 USER NAME: kbrosej  
 PLOT SCALE: 600,0000 1/1 in.  
 PLOT DATE: 5/27/2014

DESIGNED - AFC  
 DRAWN - AFC  
 CHECKED - KCF  
 DATE - 4/28/2014

REVISED - 05/27/2014  
 REVISED -  
 REVISED -  
 REVISED -

STATE OF ILLINOIS  
 DEPARTMENT OF TRANSPORTATION

**DETOUR PLAN**  
**TEMPORARY RAMP NW (GIRDER ERECTION) IF RAMP SW CLOSED**  
 SCALE: 1" = 300' SHEET 1 OF 1 SHEETS STA. TO STA.

F.A.I. RTE.	SECTION	COUNTY	TOTAL SHEETS	SHEET NO.
90/94/290	2013-010R	COOK	747	90F
CONTRACT NO. 60W28			ILLINOIS FED. AID PROJECT	