

OH4 EXISTING OVERHEAD SIGNS TO REMAIN  
SEE CONTRACT 60W26 FOR SIGN DETAIL.

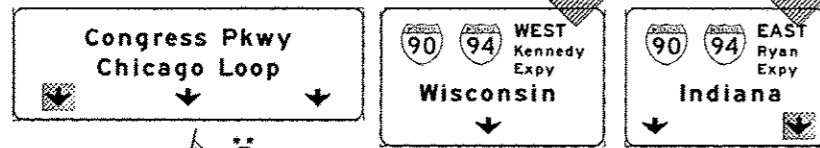

OH5 EXISTING OVERHEAD SIGNS TO REMAIN  
SEE CONTRACT 60W26 FOR SIGN DETAIL.

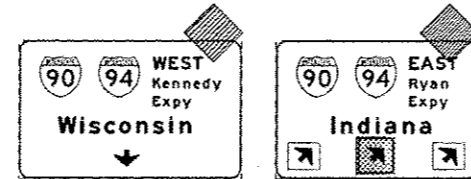

**PROPOSED TEMP PAVEMENT MARKINGS AND TRAFFIC CONTROL DEVICES**

- A TEMP EPOXY PVT MK LINE 4 (SOLID WHITE)
- B TEMP EPOXY PVT MK LINE 4 (SOLID YELLOW)
- C TEMP EPOXY PVT MK LINE 4 (2' DASH 6' SKIP, WHITE)
- D TEMP EPOXY PVT MK LINE 5 (10' DASH 30' SKIP, WHITE)
- E TEMP EPOXY PVT MK LINE 8 (SOLID WHITE)
- F TEMP EPOXY PVT MK LINE 12 (WHITE CHEVRONS @ 45°, 30' SPACING) (TYP)
- G TEMP CONC BARRIER @ 12:1 ON TAPERS UNLESS OTHERWISE NOTED
- H IMP ATTN TEMP FRN TL3
- I TYPE II BARRICADE OR DRUMS WITH STEADY BURN MONODIRECTIONAL LIGHT @ 50' C-C (TYP) ON TAPERS AND RAMP @ 100' C-C (TYP) ON TANGENTS
- J DIRECTIONAL INDICATOR BARRICADE WITH STEADY BURN MONODIRECTIONAL LIGHT @ 50' C-C
- K REL TEMP CONC BARRIER @ 12:1 ON TAPERS UNLESS OTHERWISE NOTED
- L IMP ATTN REL FRN TL3

**LEGEND:**

- WORK ZONE
- TEMPORARY CONCRETE BARRIER
- TEMPORARY IMPACT ATTENUATOR
- TEMPORARY SOIL RETENTION SYSTEM OR BRACED EXCAVATION
- DIRECTION OF TRAFFIC FLOW
- TYPE III BARRICADE
- TYPE II BARRICADE OR DRUMS WITH STEADY BURN MONODIRECTIONAL LIGHT
- DIRECTIONAL INDICATOR BARRICADE WITH STEADY BURN MONODIRECTIONAL SIGN
- ARROW BOARD
- REMOVAL LIMITS
- TEMPORARY PAVEMENT

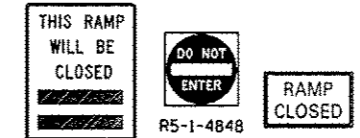
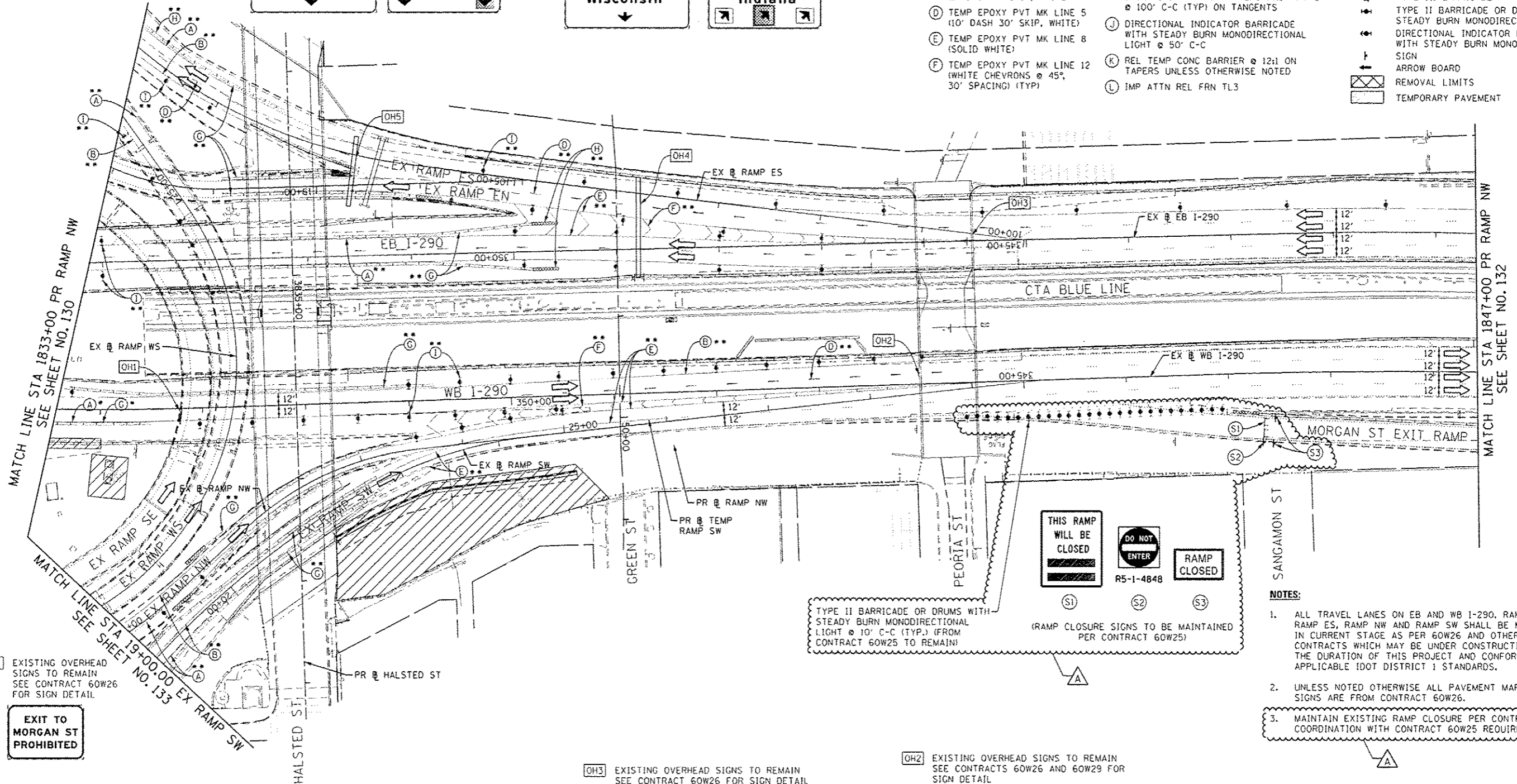

TYPE II BARRICADE OR DRUMS WITH STEADY BURN MONODIRECTIONAL LIGHT @ 10' C-C (TYP.) (FROM CONTRACT 60W25 TO REMAIN)

(RAMP CLOSURE SIGNS TO BE MAINTAINED PER CONTRACT 60W25)

- NOTES:**
- ALL TRAVEL LANES ON EB AND WB I-290, RAMP EN, RAMP ES, RAMP NW AND RAMP SW SHALL BE MAINTAINED IN CURRENT STAGE AS PER 60W26 AND OTHER ADJACENT CONTRACTS WHICH MAY BE UNDER CONSTRUCTION DURING THE DURATION OF THIS PROJECT AND CONFORM TO ALL APPLICABLE IDOT DISTRICT 1 STANDARDS.
  - UNLESS NOTED OTHERWISE ALL PAVEMENT MARKING AND SIGNS ARE FROM CONTRACT 60W26.
  - MAINTAIN EXISTING RAMP CLOSURE PER CONTRACT 60W25. COORDINATION WITH CONTRACT 60W25 REQUIRED.

S1 EXISTING OVERHEAD SIGNS TO REMAIN  
SEE CONTRACT 60W26 FOR SIGN DETAIL.

**EXIT TO MORGAN ST PROHIBITED**

OH3 EXISTING OVERHEAD SIGNS TO REMAIN  
SEE CONTRACT 60W26 FOR SIGN DETAIL.

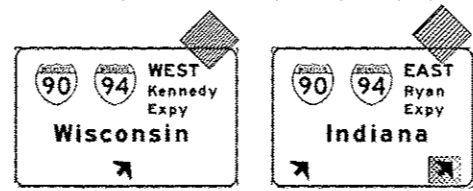

OH2 EXISTING OVERHEAD SIGNS TO REMAIN  
SEE CONTRACTS 60W26 AND 60W29 FOR SIGN DETAIL.

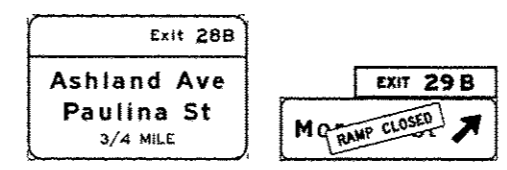

- \* FROM PREVIOUS STAGE TO REMAIN
- \*\* FROM CONTRACT 60W26 TO REMAIN

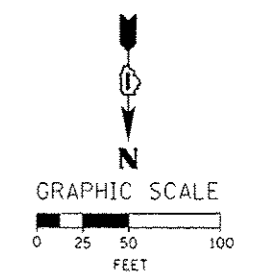

D160W26-shr-Staging2-08	DESIGNED - OPS	REVISED -
USER NAME - patelap2	DRAWN - PHP	REVISED -
PLOT SCALE - 5/8"=1'-0"	CHECKED - KCF	REVISED -
PLOT DATE - 5/25/2014	DATE - 04/28/14	REVISED -

STATE OF ILLINOIS  
DEPARTMENT OF TRANSPORTATION

**SUGGESTED STAGES OF CONSTRUCTION AND TRAFFIC CONTROL PLAN**  
MAINLINE STAGING 2

SCALE: 1" = 50' SHEET 9 OF 14 SHEETS STA. 1833+00 TO STA. 1847+00

F.A.I. RTE.	SECTION	COUNTY	TOTAL SHEETS	SHEET NO.
90/94/290	2013-010R	COOK	747	131
CONTRACT NO. 60W28				
ILLINOIS FED. AID PROJECT				