

**NOTES:**

1. TWO 2" DIAMETER CONDUITS TO BE INSTALLED IN THE BARRIER RAIL OF THE RETAINING WALL.
2. JUNCTION BOX TO BE INSTALLED IN THE BARRIER RAIL OF THE RETAINING WALL.
3. MAINTAIN THE EXISTING IDOT DETECTION SYSTEM (ITS) AFFECTED BY THE NW FLYOVER CONSTRUCTION. THIS WORK SHALL BE INCLUDED IN THE COST OF THE 'MAINTAINING ITS DURING CONSTRUCTION' PAY ITEM. SEE THE 'OPERATION OF EXISTING TRAFFIC SURVEILLANCE/SPEED/COUNT STATIONS' SPECIAL PROVISION FOR MORE DETAILS.
4. TWO CONDUITS IN JUNCTION BOX TO TRANSITION TO HEAVY DUTY HANDHOLE.

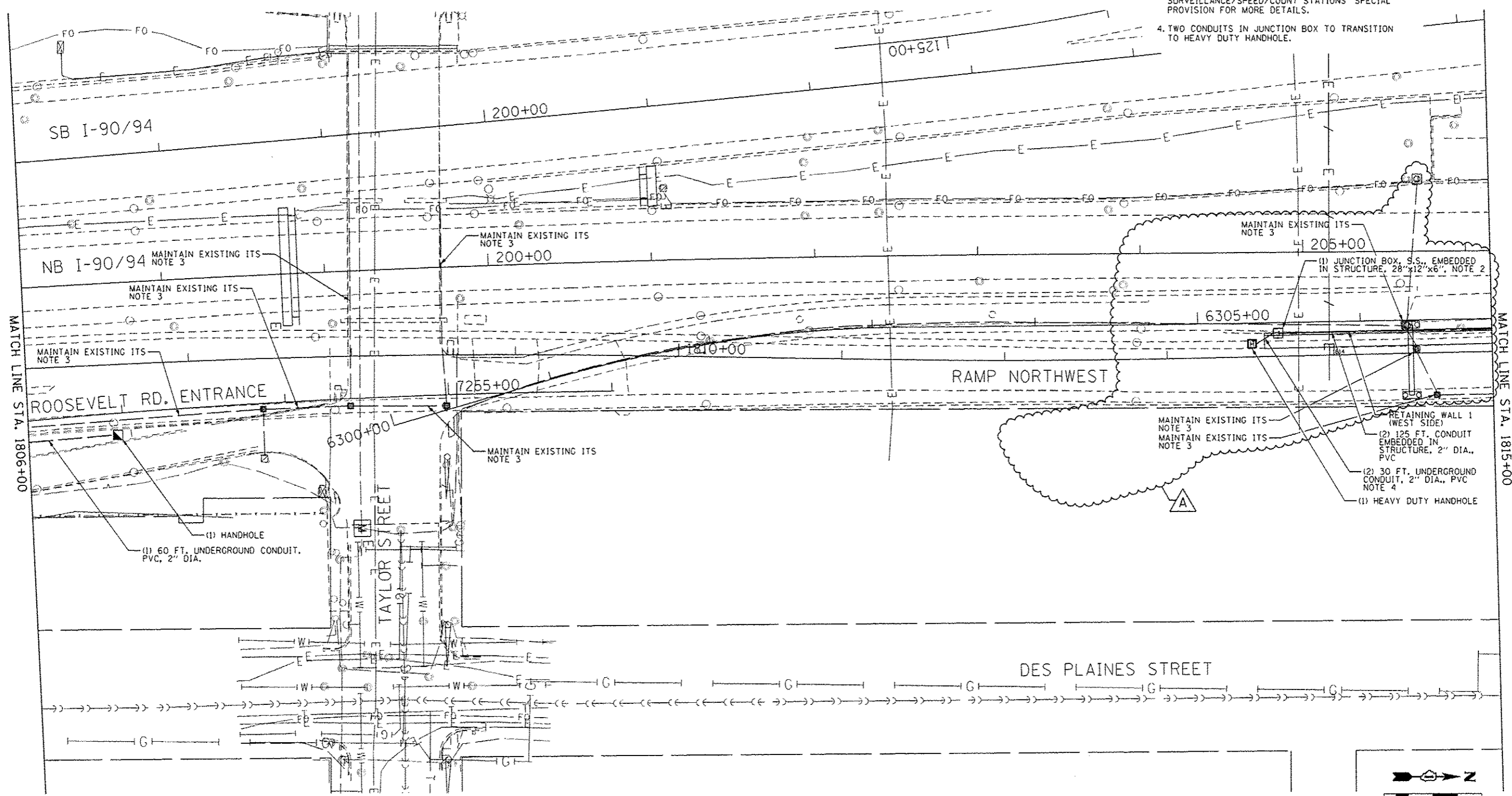

FILE PATH: \\p011288338\p011288338\work\60625908\_Circle\9908\_AmericanTransportation\60625908\_Circle\9908\_Roadway\Sheet\60625908-1-115-03



0160V20-115-03  
 USER NAME: mjg  
 PLOT SCALE: 60.0000' / in.  
 PLOT DATE: 5/21/2014

DESIGNED - GWS	REVISED - 5/27/2014
DRAWN - CAM	REVISED -
CHECKED - JDG	REVISED -
DATE - 04/28/14	REVISED -

STATE OF ILLINOIS  
 DEPARTMENT OF TRANSPORTATION

PROPOSED ITS PLAN  
 RAMP NORTHWEST

SCALE: 1"=30' SHEET 3 OF 9 SHEETS STA. 1806+00 TO STA. 1815+00

F.A.I. RTE.	SECTION	COUNTY	TOTAL SHEETS	SHEET NO.
90/94/290	2013-010R	COOK	747	310
				CONTRACT NO. 60W28
ILLINOIS FED. AID PROJECT				