

PLAN VIEW "1"
N.T.S.

• THE CONCRETE GUTTER, TYPE B SHALL BE CONSTRUCTED BETWEEN THE FACE OF THE BRIDGE PIER AND THE BACK OF THE CONCRETE BARRIER, SINGLE FACE, 42 INCH HEIGHT, 3/4" PREFORMED JOINT FILLER SHALL BE USED AS SHOWN IN DETAIL.

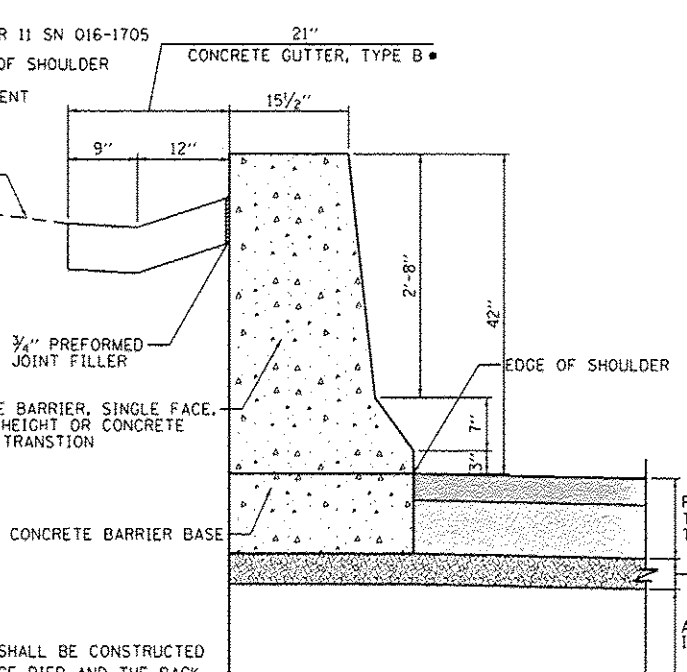

SECTION A-A
SCALE: NONE

CONCRETE BARRIER, SINGLE FACE, 42 INCH HEIGHT WITH CONCRETE GUTTER, TYPE B

CONCRETE BARRIER TRANSITION STA 1303+49.18 TO STA 1303+64.65 (PR @ INTERIM RAMP SW, ALONG FRONT FACE OF WALL) SEE PLAN VIEW "2" AND ELEVATION VIEW

CONCRETE BARRIER, SINGLE FACE, 42 INCH HEIGHT STA 1303+64.65 (PR @ INTERIM RAMP SW) TO STA 1838+08.59 (PR @ RAMP NW) (ALONG FRONT FACE OF WALL) SEE PLAN VIEW "2" AND ELEVATION VIEW

- NOTES:**
1. EXPANSION JOINTS SHOWN ON THIS DRAWING SHALL BE PREFORMED JOINT MATERIAL (BITUMINOUS TYPE) FILLER AND SHALL MEET AASHTO DESIGNATION M-33.
 2. ALL WORK AND MATERIALS DETAILED HEREIN SHALL BE INCLUDED IN THE COST OF THE VARIOUS CONCRETE BARRIER PAY ITEMS UNLESS OTHERWISE NOTED.
 3. PREFORMED JOINT FILLER SHALL BE INCLUDED IN THE COST OF OF CONCRETE BARRIER OR CONCRETE BARRIER TRANSITION.
 4. JOINTS SHALL BE CONSTRUCTED AS SHOWN ON THE PLANS AND IN ACCORDANCE WITH ARTICLE 637.08 OF THE STANDARD SPECIFICATIONS
 5. TWO VERTICAL EPOXY COATED, NO. 8 TIE BARS, 10" LONG, SHALL BE PLACED STAGGERED FRONT TO BACK OF THE BARRIER WALL AT 48" CENTERS ALONG THE CONCRETE BARRIER TRANSITION. TIE BARS SHALL BE INCLUDED IN THE COST OF CONCRETE BARRIER TRANSITION.
 6. HORIZONTAL TIE BARS SHALL BE NO. 6 EPOXY COATED, 24" LONG, 24" C-C AND SHALL BE INCLUDED IN THE COST OF THE BARRIER BASE. HORIZONTAL TIE BARS ARE REQUIRED WHEN PAVEMENT IS PCC.
 7. EXPANSION JOINTS SHALL BE CONSTRUCTED IN BARRIER WALL AT MAXIMUM JOINT SPACING OF 90 FEET AND AS SHOWN ON THE PLANS.
 8. VERTICAL TIE BARS ARE REQUIRED WHEN CONCRETE BARRIER AND CONCRETE BARRIER BASE ARE NOT POURED MONOLITHICALLY.

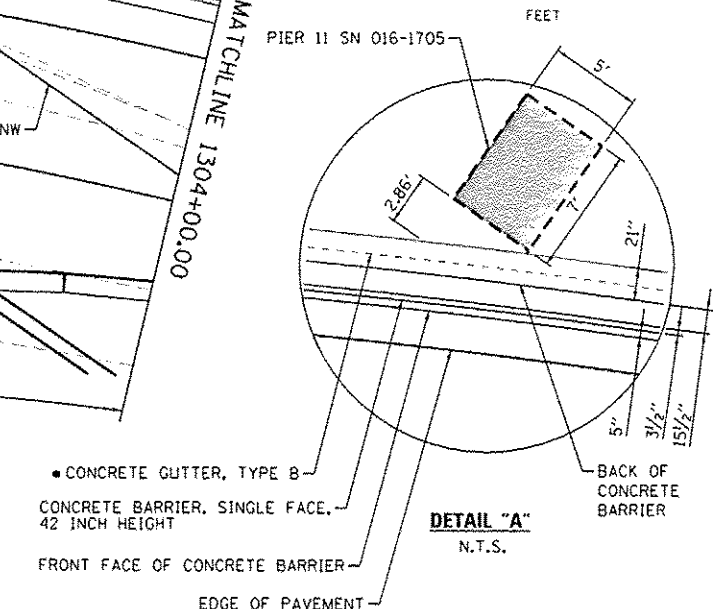

DETAIL "A"
N.T.S.

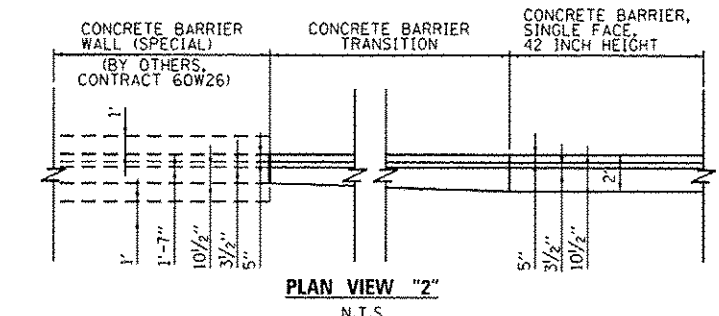

PLAN VIEW "2"
N.T.S.

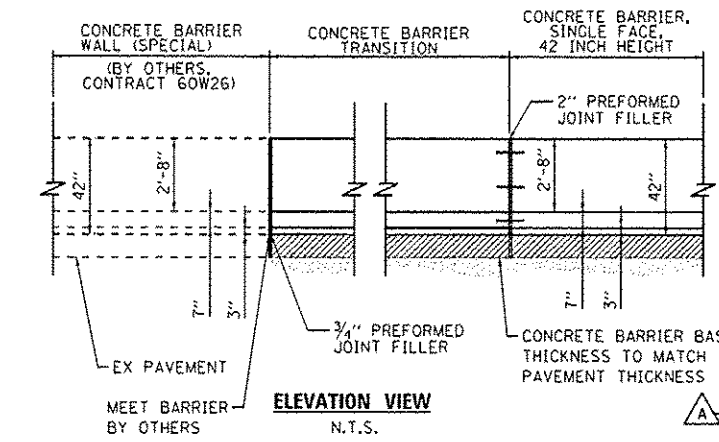

ELEVATION VIEW
N.T.S.



D:\60W26\shd-Detail-08.dgn
USER NAME : alizadeh
PLOT SCALE = 20,0000' / 1"
PLOT DATE : 5/27/2014

DESIGNED - OPS	REVISED - 5/27/2014
DRAWN - OPS	REVISED -
CHECKED - DBM	REVISED -
DATE - 04/28/14	REVISED -

STATE OF ILLINOIS
DEPARTMENT OF TRANSPORTATION

ROADWAY DETAILS - CONCRETE BARRIER AT PIER 11
SCALE: N.T.S. SHEET 1 OF 1 SHEETS STA. TO STA.

F.A.I. RTE. 90/94/290	SECTION 2013-010R	COUNTY COOK	TOTAL SHEETS 747	SHEET NO. 644L
CONTRACT NO. 60W26			ILLINOIS FED. AID PROJECT	