

NOTES:

EXISTING UTILITIES SHOWN ARE FOR LATERAL REFERENCE ONLY. THE CONTRACTOR IS RESPONSIBLE FOR IDENTIFYING ALL EXISTING SEWERS AND UTILITIES PRIOR TO CONSTRUCTION. THE CONTRACTOR SHALL REFER TO THE UTILITY LOCATION PLANS FOR ADDITIONAL UTILITY INFORMATION.

DATE	
BY	
REVISION	
NO.	
DATE	
BY	
REVISION	
NO.	
DATE	
BY	
REVISION	
NO.	

DATE	
BY	
REVISION	
NO.	
DATE	
BY	
REVISION	
NO.	
DATE	
BY	
REVISION	
NO.	

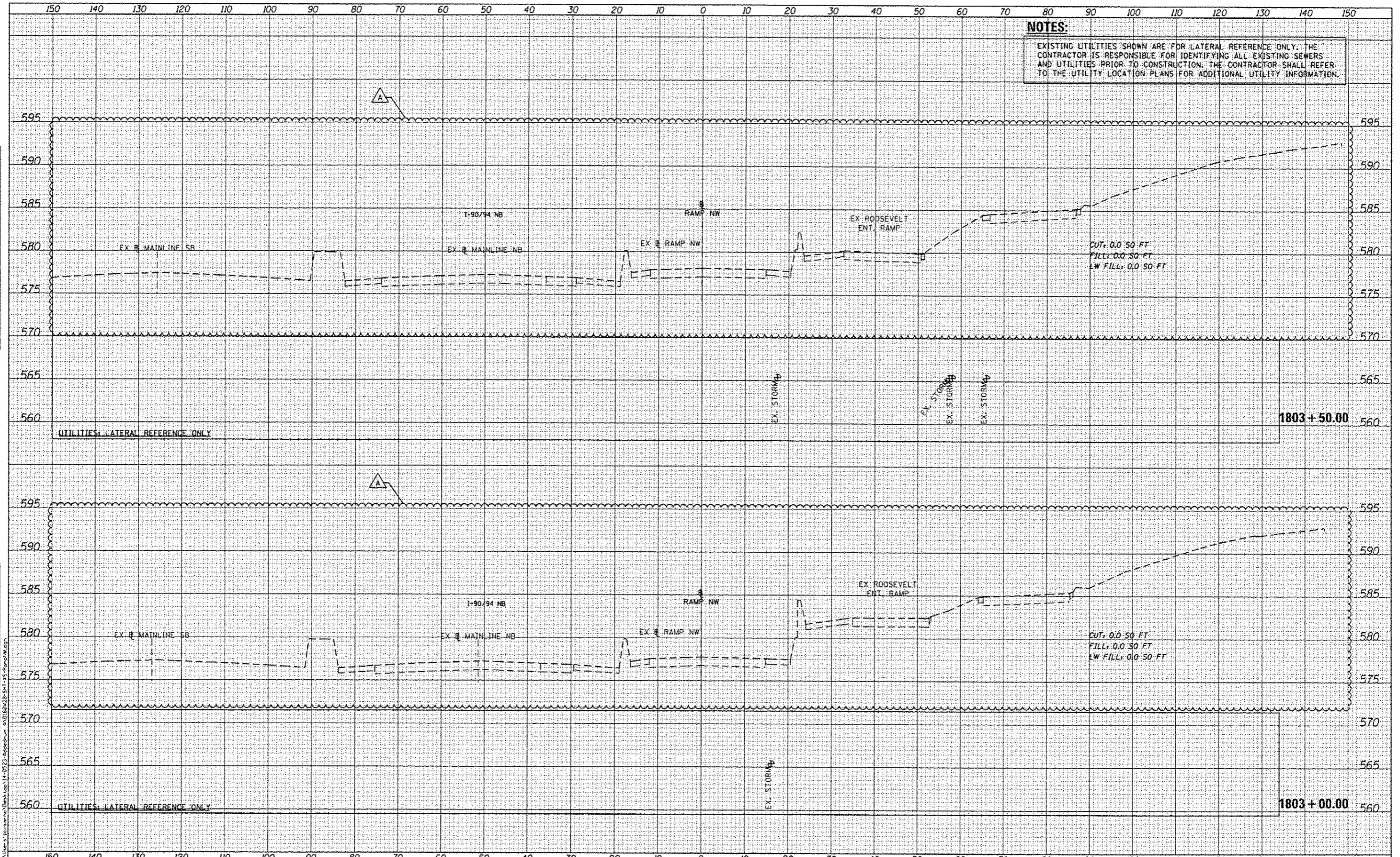

<p>303 EAST WACKER DRIVE, SUITE 1400 CHICAGO, IL 60601-3278 PHONE: (312) 373-1700 FAX: (312) 373-6800</p>	DIEBEN20-SHT-15-RampNW.dgn USER NAME: pmsarng PLOT SCALE: 1/8" = 1'-0" PLOT DATE: 5/23/2014	DESIGNED - KAM DRAWN - KAM CHECKED - KCF DATE - 04/28/14	REVISED - 5/27/2014 REVISED - REVISED - REVISED -	STATE OF ILLINOIS DEPARTMENT OF TRANSPORTATION	CROSS SECTIONS RAMP NW SCALE: 1/8" = 1'-0" SHEET 02 OF 51 SHEETS STA. 1803+00.00 TO STA. 1803+50.00	F.A.I. RTE. 90/94/290 SECTION 2013-010R COUNTY COOK TOTAL SHEETS 747 SHEET NO. 647 CONTRACT NO. 60W28 ILLINOIS FED. AID PROJECT
---	--	---	--	---	---	---