

NOTES:
 EXISTING UTILITIES SHOWN ARE FOR LATERAL REFERENCE ONLY. THE CONTRACTOR IS RESPONSIBLE FOR IDENTIFYING ALL EXISTING SEWERS AND UTILITIES PRIOR TO CONSTRUCTION. THE CONTRACTOR SHALL REFER TO THE UTILITY LOCATION PLANS FOR ADDITIONAL UTILITY INFORMATION.
 SEE GRADING PLAN FOR ADDITIONAL INFIELD GRADING INFORMATION AROUND STRUCTURAL ELEMENTS.

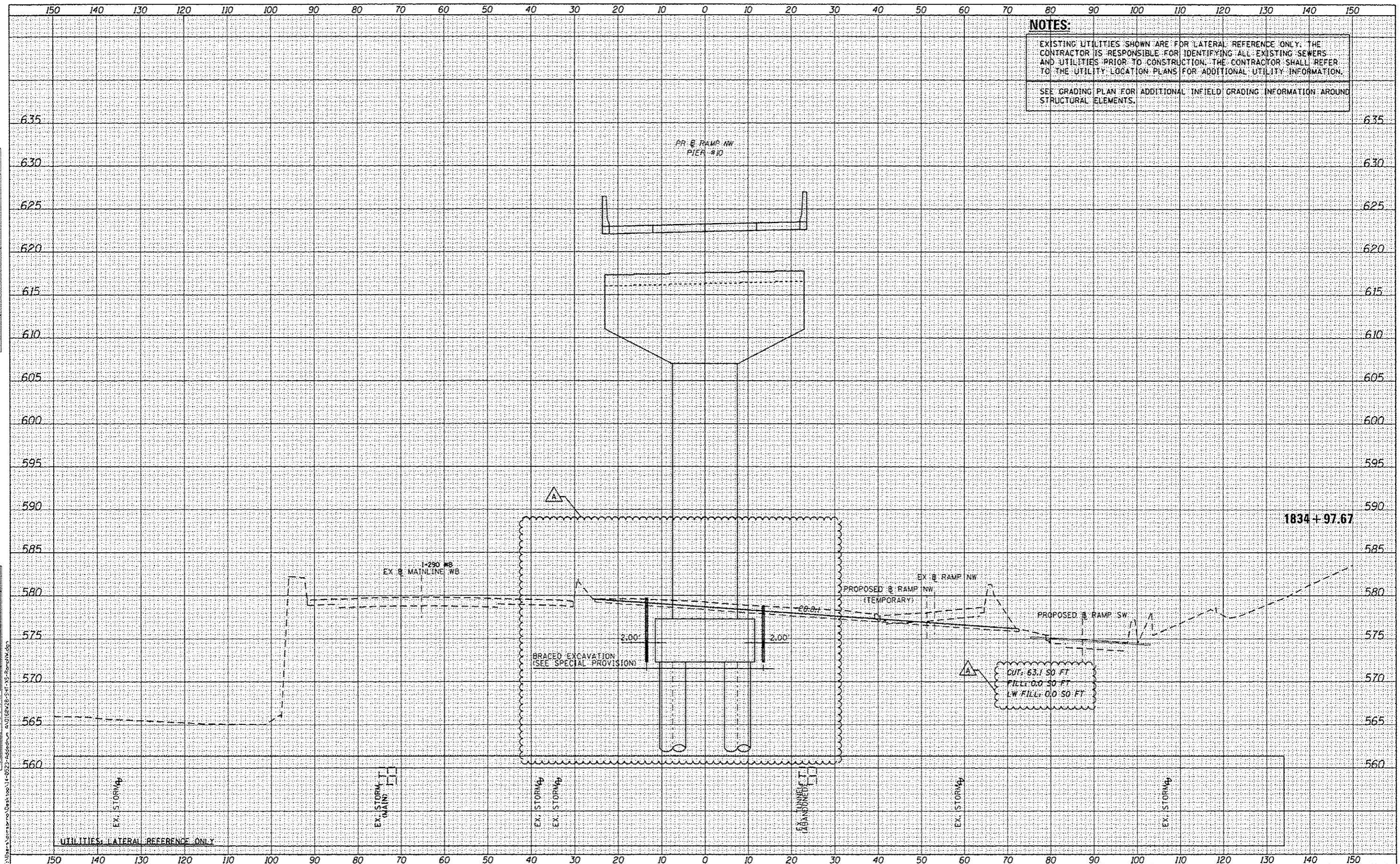

DATE	
BY	
DESIGNED	
DRAWN	
CHECKED	
DATE	

DATE	
BY	
DESIGNED	
DRAWN	
CHECKED	
DATE	

FILE PATH: C:\Users\jgarcia\OneDrive\Documents\2014\0523\1834+97.67\1834+97.67.dwg
 USER: jgarcia
 PLOT DATE: 5/23/2014



DESIGNED -	KAM	REVISION	5/27/2014
DRAWN -	KAM	REVISION	
CHECKED -	KCF	REVISION	
DATE -	04/28/14	REVISION	

**STATE OF ILLINOIS
 DEPARTMENT OF TRANSPORTATION**

**CROSS SECTIONS
 RAMP NW**
 SCALE: 1:5V, 1:10H SHEET 34 OF 51 SHEETS STA. 1834+97.67 TO STA. 1834+97.67

F.A.I. RTE.	SECTION	COUNTY	TOTAL SHEETS	SHEET NO.
90/94/290	2013-010R	COOK	747	675
CONTRACT NO. 60W28			ILLINOIS FED. AID PROJECT	