

DATE	
BY	
DESIGNED	
DRAWN	
CHECKED	
DATE	
FINAL	
DATE	
BY	

DATE	
BY	
DESIGNED	
DRAWN	
CHECKED	
DATE	
ORIGINAL	
DATE	
BY	

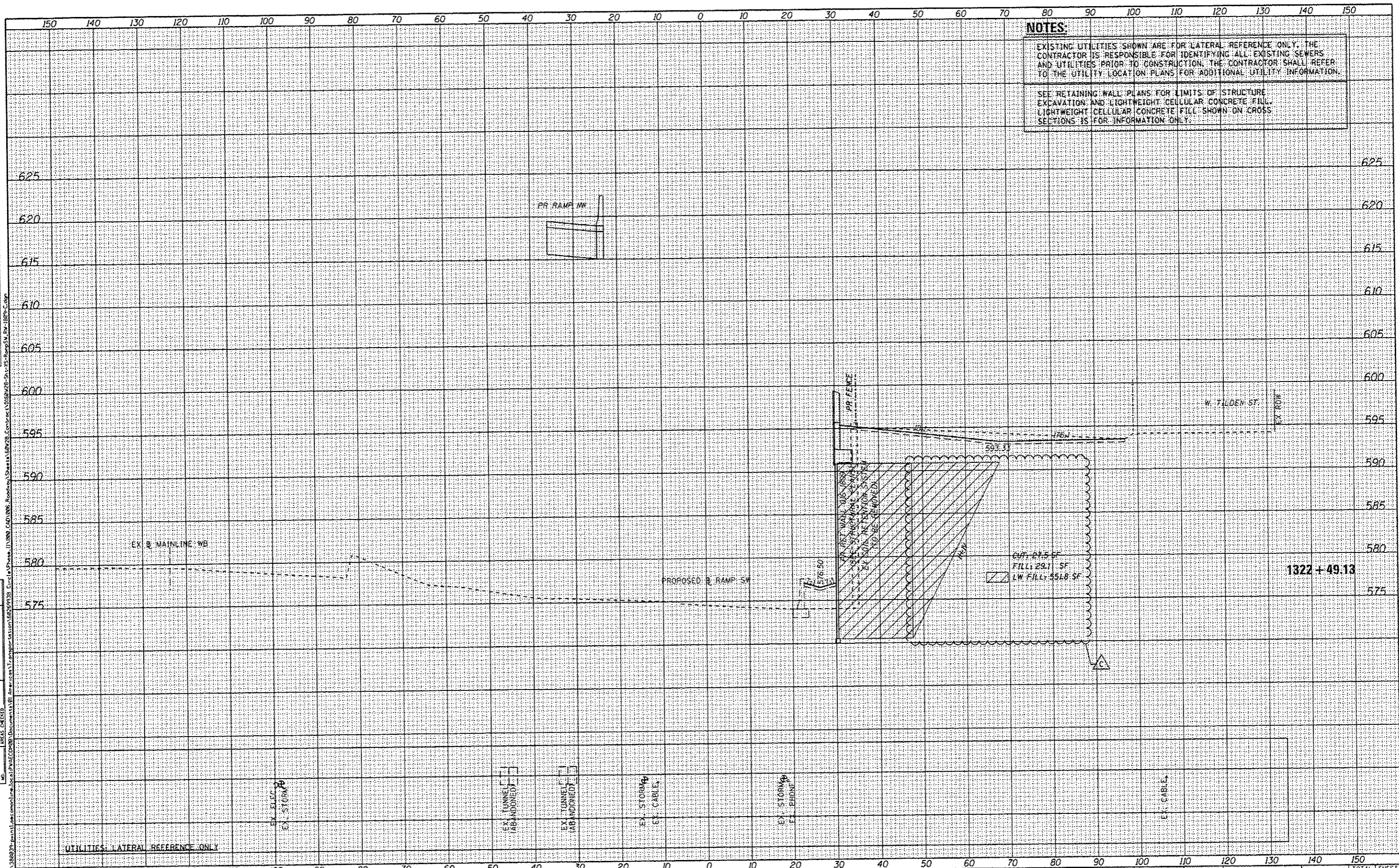

**NOTES:**  
 EXISTING UTILITIES SHOWN ARE FOR LATERAL REFERENCE ONLY. THE CONTRACTOR IS RESPONSIBLE FOR IDENTIFYING ALL EXISTING SEWERS AND UTILITIES PRIOR TO CONSTRUCTION. THE CONTRACTOR SHALL REFER TO THE UTILITY LOCATION PLANS FOR ADDITIONAL UTILITY INFORMATION.  
 SEE RETAINING WALL PLANS FOR LIMITS OF STRUCTURE EXCAVATION AND LIGHTWEIGHT CELLULAR CONCRETE FILL. LIGHTWEIGHT CELLULAR CONCRETE FILL SHOWN ON CROSS SECTIONS IS FOR INFORMATION ONLY.



DESIGNED -	NWM / AJP	REVISION	6/24/2014
DRAWN -	NWM / AJP	REVISION	-
CHECKED -	KAM	REVISION	-
DATE -	6/24/14	REVISION	-

STATE OF ILLINOIS  
 DEPARTMENT OF TRANSPORTATION

CROSS SECTIONS	
RAMP SW & RETAINING WALL 016-1809	
SCALE: 1:5V, 1:10H	SHEET 1 OF 15 SHEETS
STA. 1322+49.13 TO STA. 1322+49.13	

F.A.I. RTE.	SECTION	COUNTY	TOTAL SHEETS	SHEET NO.
90/94/290	2013-010R	COOK	747	732
CONTRACT NO. 60W28			ILLINOIS FED. AID PROJECT	