

STATE OF ILLINOIS

DEPARTMENT OF TRANSPORTATION

F.A.P. & T.E.	SECTION	COUNTY	TOTAL SHEETS	SHEET NO.
704	(57-7)RS-2	MCLEAN	31	1
		ILLINOIS	CONTRACT NO. 70E04	

FOR INDEX OF SHEETS, SEE SHEET NO. 2
FOR SUMMARY OF QUANTITIES, SEE SHEET NO. 4 THROUGH 6

CURRENT TRAFFIC DATA FOR FAP 704		
	LEG "A"	LEG "B"
2019 ADT =	13,100	20,700
P.U. %	94.2	94.8
S.U. %	3.1	3.3
M.U. %	2.7	1.9

LEG "A" is Veterans from 0.1 MI W of Morris Ave to Morris Ave
LEG "B" is Veterans from Morris Ave to 0.3 MI W of US 51 BUS

DESIGN DESIGNATION
N/A

PROPOSED HIGHWAY PLANS

F.A.P. 704 (I-55 BUSN., VETERANS PARKWAY)
SECTION (57-7)RS-2
PROJECT NHPP-Z68L(018)
PAVEMENT PRESERVATION SMART OVERLAY
MCLEAN COUNTY

C-95-070-19

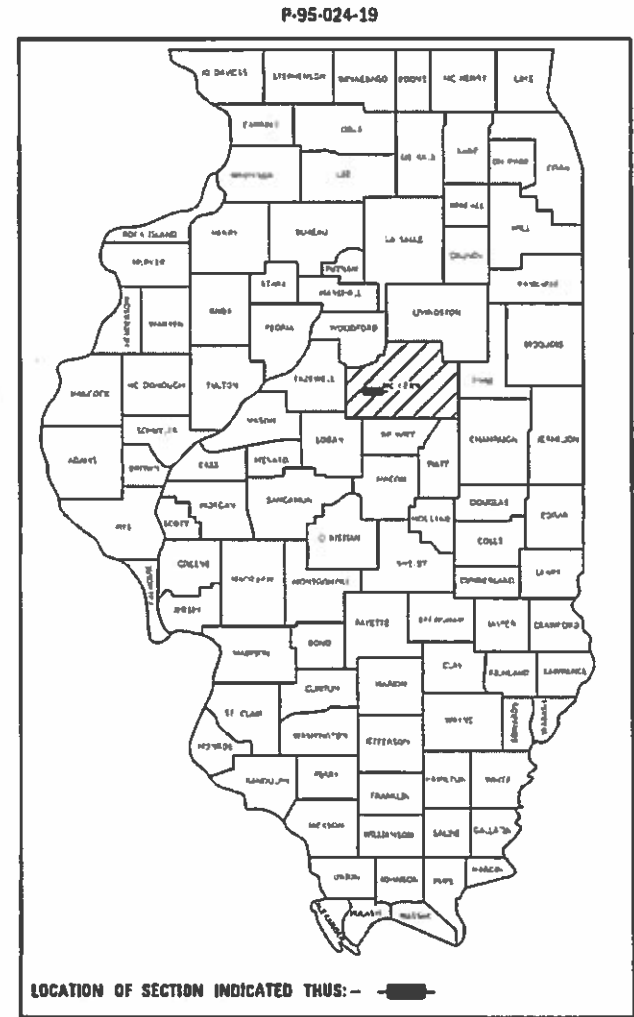

0.1 MI W OF MORRIS AVE TO 0.3 MI W OF US 51 BUS IN BLOOMINGTON

FAP 704 SECTION BEGINS:
STA. 365 + 78.00

STATION EQUATION
STA. 390 + 96.85 BK =
STA. 29 + 93.05 AH

FAP 704 SECTION ENDS:
STA. 32 + 80.00

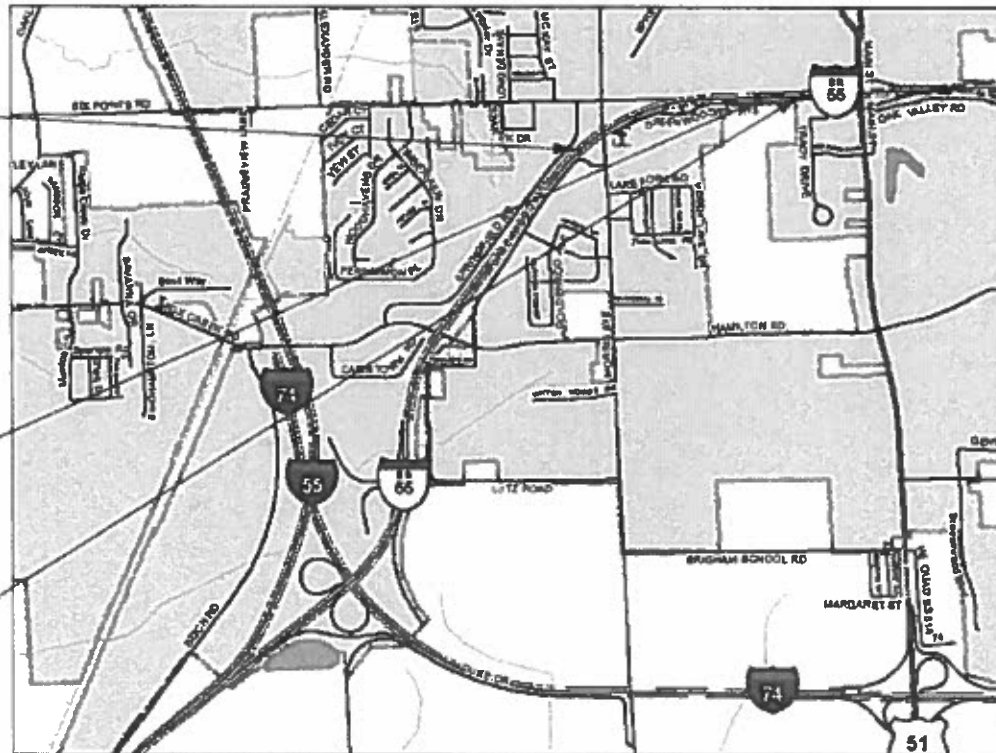

T 23 N

R 2 E



GROSS LENGTH = 2,805.80 FT. = 0.531 MILE
NET LENGTH = 2,805.80 FT. = 0.531 MILE

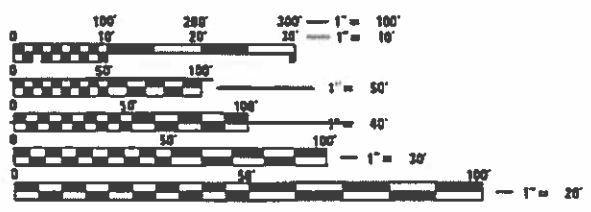

FULL SIZE PLANS HAVE BEEN PREPARED USING STANDARD ENGINEERING SCALES. REDUCED SIZED PLANS WILL NOT CONFORM TO STANDARD SCALES. IN MAKING MEASUREMENTS ON REDUCED PLANS, THE ABOVE SCALES MAY BE USED.

J.U.L.I.E.
JOINT UTILITY LOCATION INFORMATION FOR EXCAVATORS
1-800-892-0123
OR 811 BLOOMINGTON TOWNSHIP

PROJECT ENGINEER: NANCY FASIG
SQUAD LEADER: BRIAN J. HOGAN
DESIGNER: JASON HELANDER
PHONE: (217)-465-4181

CONTRACT NO. 70E04

STATE OF ILLINOIS
DEPARTMENT OF TRANSPORTATION

SUBMITTED 06/03/2019
Kensila A. Barnett, suw REGIONAL ENGINEER

June 14, 2019
Paul P. Chaf, ENGINEER OF DESIGN AND ENVIRONMENT

June 14, 2019
Paul P. Chaf, DIRECTOR OF HIGHWAYS PROJECT IMPLEMENTATION

PRINTED BY THE AUTHORITY OF THE STATE OF ILLINOIS

INDEX OF SHEETS

<u>SHEET NO.</u>	<u>DESCRIPTION</u>
1	COVER SHEET
2	INDEX OF SHEETS
2	LIST OF STANDARDS
3	GENERAL NOTES
4-6	SUMMARY OF QUANTITIES
7-14	TYPICAL CROSS SECTIONS
15-19	SCHEDULES OF QUANTITIES
20-25	PLAN SHEETS FAP 704 (I-55 BUSN)
26-29	DISTRICT DETAIL 7800AAAA PAVEMENT MARKING AND MARKERS (RURAL & URBAN TYPICAL APPLICATIONS)
30	DISTRICT DETAIL 7800BBBB PAVEMENT MARKING (INTERSTATE & MULTI-LANE APPLICATIONS)
31	DISTRICT DETAIL XX442100 PCC PARTIAL DEPTH HOT-MIX ASPHALT PATCHING

LIST OF STANDARDS

<u>STANDARD NO.</u>	<u>DESCRIPTION</u>
000001-07	STANDARD SYMBOLS, ABBREVIATIONS AND PATTERNS
001006	DECIMAL OF AN INCH AND OF A FOOT
442201-03	CLASS C AND D PATCHES
701411-09	LANE CLOSURE, MULTILANE, AT ENTRANCE OR EXIT RAMP, FOR SPEEDS ≥ 45 MPH
701422-10	LANE CLOSURE, MULTILANE, FOR SPEEDS ≥ 45 MPH TO 55 MPH
701426-09	LANE CLOSURE, MULTILANE, INTERMITTENT OR MOVING OPER., FOR SPEEDS ≥ 45 MPH
701701-10	URBAN LANE CLOSURE, MULTILANE INTERSECTION
701901-08	TRAFFIC CONTROL DEVICES
780001-05	TYPICAL PAVEMENT MARKINGS
781001-04	TYPICAL APPLICATIONS RAISED REFLECTIVE PAVEMENT MARKERS
886001-01	DETECTOR LOOP INSTALLATIONS
886006-01	TYPICAL LAYOUTS FOR DETECTION LOOP

MODEL: \$MODELNAME\$
 FILE: \$NAME\$.dwg
 I:\Information\dot\illinois.gov\PWIDOT\Documents\DOT_Offices\District_5\Projects\DS70E04\CADD\data\CAD\sheet\DS70E04-sht-02enote.dgn

USER NAME = hoganbj	DESIGNED -	REVISED -
	DRAWN -	REVISED -
PLOT SCALE = 40.0000 ' / in.	CHECKED -	REVISED -
PLOT DATE = 6/2/2019	DATE -	REVISED -

**STATE OF ILLINOIS
DEPARTMENT OF TRANSPORTATION**

INDEX OF SHEETS & LIST OF STANDARDS

SCALE: N/A SHEET 1 OF 1 SHEETS STA. TO STA.

F.A.P. RTE.	SECTION	COUNTY	TOTAL SHEETS	SHEET NO.
704	(57-7)RS-2	MCLEAN	31	2
CONTRACT NO. 70E04				
ILLINOIS FED. AID PROJECT				

GENERAL NOTES

G.N.-100A
ELECTRONIC FILES AND/OR ELECTRONIC SURVEY INFORMATION INCLUDING CADD FILES WILL NOT BE AVAILABLE TO THE CONTRACTOR.

GN 105.07C
EXISTING STATE-OWNED AND MAINTAINED UNDERGROUND UTILITY FACILITIES EXIST WITHIN THE ROW. THE DEPARTMENT IS NOT A MEMBER OF JULIE AND DOES NOT LOCATE IT'S OWN FACILITIES. THE CONTRACTOR SHALL BE RESPONSIBLE AT THEIR OWN EXPENSE FOR SECURING AN APPROVED LOCATING FIRM TO LOCATE ALL EXISTING IDOT UNDERGROUND FACILITIES PRIOR TO COMMENCING ANY EXCAVATION, PER THE REQUIREMENTS OF ARTICLE 803 OF THE STANDARD SPECIFICATIONS. UTILITY LOCATES MAY ALSO BE REQUIRED OUTSIDE THE PROJECT LIMITS, SUCH AS FOR TRAFFIC CONTROL SIGNING AND OTHER ITEMS. THE CONTRACTOR MAY OBTAIN, ON REQUEST, PLANS OF EXISTING ELECTRICAL FACILITIES FROM THE DEPARTMENT. FOR FURTHER INFORMATION, THE CONTRACTOR MAY CONTACT THE DISTRICT TRAFFIC OPERATIONS ENGINEER, GARY SIMS, AT 217-251-4859.

G.N.-406.10
FOR MULTILANE RESURFACING

WHEN BEGINNING THE RESURFACING WITH NEW MIXTURES FOR LEVELING BINDER, BINDER COURSE, AND SURFACE COURSE MIXTURES, THE WORK WILL BE CONFINED TO THE INSIDE TRAFFIC LANE (PASSING LANE) FIRST. THE WORK WILL REMAIN ON THE INSIDE LANE UNTIL THE MIX HAS BEEN ADJUSTED AND APPROVED BY THE ENGINEER BEFORE ANY RESURFACING IS ALLOWED ON THE OUTSIDE (DRIVING) TRAFFIC LANE(S).

ANY DELAYS OR INCONVENIENCES CAUSED THE CONTRACTOR IN COMPLYING WITH THIS REQUIREMENT WILL BE CONSIDERED INCIDENTAL TO THE VARIOUS HOT-MIX ASPHALT PAY ITEMS, AS SHOWN IN THE CONTRACT, AND NO ADDITIONAL COMPENSATION WILL BE ALLOWED.

G.N. -406H

MIXTURE REQUIREMENTS	CONTRACT 70E04	
Location	BUS 55	BUS 55
Mixture Use	Poly Surface	Class D & Partial Depth Patching
AC/PG	SBS PG 70-22	PG 64-22
Design Air Voids	4.0% @ Ndes=90	4.0% @ Ndes=90
Mix Comp(Gradation)	IL 9.5	IL 19.0
Friction Aggregate	Mix D	N.A.
Mixture Weight	112	112
Quality Management Program	QC/QA	QC/QA
Sublot Size	N.A.	N.A.

G.N.- 442B - PATCHING SCHEDULES
THE PATCHING SCHEDULES INCLUDED IN THE PLANS REPRESENT THE BEST INFORMATION AVAILABLE AT THE TIME OF COMPLETION OF THE PLANS FOR LETTING. VARIATIONS IN LOCATION AND SIZES OF THE FULL-DEPTH AND PARTIAL-DEPTH PATCHES MAY OCCUR.

G.N.- 703A
SHORT TERM PAVEMENT MARKING SHALL BE APPLIED TO THE PAVEMENT AFTER ANY OF THE FOLLOWING: COLD MILLING AND/OR PLACING BITUMINOUS MATERIALS (TACK COAT), LEVELING BINDER (MACHINE METHOD), BINDER AND SURFACE COURSES. SHORT TERM PAVEMENT MARKING PLACED ON THE SURFACE SHALL COINCIDE WITH THE FINAL PAVEMENT STRIPING. SHORT TERM PAVEMENT MARKING PLACED PRIOR TO THE SURFACE SHALL COINCIDE WITH THE EXISTING PAVEMENT MARKINGS. USE 4 FEET PER 40 FEET (OR 10% PER STATION).

G.N.- 781
THE FINAL PAVEMENT MARKINGS SHALL BE IN PLACE PRIOR TO PLACING THE RAISED REFLECTIVE PAVEMENT MARKERS.

G.N.- 886
EXISTING DETECTOR LOOPS IN THE AREAS OF PROPOSED SURFACE REMOVAL SHALL BE REPLACED PER THE EXISTING SIZE AND LOCATION EXCEPT AS NOTED IN THE PLANS. EXISTING DETECTOR LOOPS SHALL BE DISCONNECTED AT THE GULFBOX JUNCTION OR HANDHOLE PRIOR TO COLD MILLING AT THE RESPECTIVE LOCATION. NEW DETECTOR LOOPS SHALL BE CONNECTED TO THE RESPECTIVE AMPLIFIER. IN GENERAL, MULTIPLE ADVANCED DETECTOR LOOPS FOR DILEMMA ZONE PROTECTION LOCATED AT THE SAME STATION SHALL BE GROUPED TOGETHER ON A COMMON AMPLIFIER AND PRESENCE LOOPS SHALL BE GROUPED BY LANE ON A COMMON AMPLIFIER UNLESS OTHERWISE NOTED IN THE PLANS.

EXISTING LOOPS NOT SHOWN TO BE REPLACED SHALL BE DISCONNECTED AT THE DETECTOR AMPLIFIER IN THE CONTROLLER CABINET BEFORE BEING DISCONNECTED AT THE GULFBOX JUNCTION OR HANDHOLE.

WHERE IT IS NECESSARY TO INSTALL MORE THAN ONE LOOP HOMERUN IN A CONDUIT, HOMERUNS SHARING THE SAME CONDUIT SHALL BE ON A COMMON AMPLIFIER.

G.N.- 1004.01
COARSE AGGREGATE GRADATION CA-10 MAY BE USED WHENEVER COARSE AGGREGATE CA-6 IS SPECIFIED IN THE STANDARD SPECIFICATIONS.

NO COMMITMENTS.

MODEL: I:\MODEL\NAMES FILE: N:\names: p:\pub\mcomas.dwg: I:\links: gpc:\P\DOT\Documents\DOT - Offices\District 5\Projects\0570E04\CADD\data\CADD\sheet\0570E04-ht-general.dgn

USER NAME = hoganbj	DESIGNED -	REVISED -	
	DRAWN -	REVISED -	
PLOT SCALE = 40,0000 ' / in.	CHECKED -	REVISED -	
PLOT DATE = 6/2/2019	DATE -	REVISED -	

**STATE OF ILLINOIS
DEPARTMENT OF TRANSPORTATION**

GENERAL NOTES

SCALE: N/A SHEET 1 OF 1 SHEETS STA. TO STA.

F.A.P. RTE.	SECTION	COUNTY	TOTAL SHEETS	SHEET NO.
704	(57-7)RS-2	MCLEAN	31	3
CONTRACT NO. 70E04				
ILLINOIS FED. AID PROJECT				

SUMMARY OF QUANTITIES

LOCATION OF WORK: F.A.P. 704 (I-55 BUS/VETERANS PKWY)
 URBAN MULTILANE
 OTHER PRINCIPAL ARTERIAL
 STA. 365+78.00 TO STA. 32+80.00
 MCLEAN COUNTY
 FUNDING BREAKOUT: NHPP / TDC - 80% FED / 20% FED
 CONSTRUCTION TYPE CODE: 0005

CODE NO.	ITEM	UNIT	TOTAL QUANTITY	
40600290	BITUMINOUS MATERIALS (TACK COAT)	POUND	10,250.0	10,250.0
40600990	TEMPORARY RAMP	SQ YD	400.0	400.0
40603545	POLYMERIZED HOT-MIX ASPHALT SURFACE COURSE, MIX "D", N90	TON	1,550.0	1,550.0
44000155	HOT-MIX ASPHALT SURFACE REMOVAL, 1 1/2"	SQ YD	18,425.0	18,425.0
44201798	CLASS D PATCHES, TYPE I, 13 INCH	SQ YD	5.0	5.0
44201803	CLASS D PATCHES, TYPE II, 13 INCH	SQ YD	45.0	45.0
67100100	MOBILIZATION	L SUM	1.0	1.0
70107025	CHANGEABLE MESSAGE SIGN	CAL DA	52.0	52.0
70300100	SHORT TERM PAVEMENT MARKING	FOOT	3,664.0	3,664.0
70300150	SHORT TERM PAVEMENT MARKING REMOVAL	SQ FT	1,221.0	1,221.0
* 78000100	THERMOPLASTIC PAVEMENT MARKING - LETTERS AND SYMBOLS	SQ FT	234.0	234.0
* 78000200	THERMOPLASTIC PAVEMENT MARKING - LINE 4"	FOOT	11,291.0	11,291.0
* 78000400	THERMOPLASTIC PAVEMENT MARKING - LINE 6"	FOOT	250.0	250.0
* 78000500	THERMOPLASTIC PAVEMENT MARKING - LINE 8"	FOOT	176.0	176.0
* DENOTES SPECIALTY ITEM				

MODEL: I:\MODEL\NAMES
 FILE: Names_Plan\Illumination\Illinois\pwr\Illumination\DOT\Office\Illumination\CADD\DATA\CADD\Sheet\0570E04.rvt-500.dgn

USER NAME = hoganbj	DESIGNED -	REVISED -
	DRAWN -	REVISED -
PLOT SCALE = 40.0000' / in.	CHECKED -	REVISED -
PLOT DATE = 6/2/2019	DATE -	REVISED -

**STATE OF ILLINOIS
DEPARTMENT OF TRANSPORTATION**

SUMMARY OF QUANTITIES

SCALE: N/A SHEET 1 OF 3 SHEETS STA. TO STA.

F.A.P. RTE.	SECTION	COUNTY	TOTAL SHEETS	SHEET NO.
704	(57-7)RS-2	MCLEAN	31	4
CONTRACT NO. 70E04				
ILLINOIS FED. AID PROJECT				

SUMMARY OF QUANTITIES

LOCATION OF WORK: F.A.P. 704 (I-55 BUS/VETERANS PKWY)
 URBAN MULTILANE
 OTHER PRINCIPAL ARTERIAL
 STA. 365+78.00 TO STA. 32+80.00
 MCLEAN COUNTY
 FUNDING BREAKOUT: NHPP / TDC - 80% FED / 20% FED
 CONSTRUCTION TYPE CODE: 0005

CODE NO.	ITEM	UNIT	TOTAL QUANTITY
* 78000600	THERMOPLASTIC PAVEMENT MARKING - LINE 12"	FOOT	291.0
* 78000650	THERMOPLASTIC PAVEMENT MARKING - LINE 24"	FOOT	132.0
* 78004210	PREFORMED PLASTIC PAVEMENT MARKING, TYPE B - INLAID - LINE 4"	FOOT	1,410.0
* 78100100	RAISED REFLECTIVE PAVEMENT MARKER	EACH	162.0
78300200	RAISED REFLECTIVE PAVEMENT MARKER REMOVAL	EACH	162.0
* 88600100	DETECTOR LOOP, TYPE I	FOOT	646.0
X4406100	PARTIAL DEPTH REMOVAL, TYPE I, 10"	SQ YD	115.0
X4406300	PARTIAL DEPTH REMOVAL, TYPE II, 10"	SQ YD	30.0
X4421000	PARTIAL DEPTH PATCHING	TON	85.0
X7010216	TRAFFIC CONTROL AND PROTECTION, (SPECIAL)	L SUM	1.0
* X7830060	GROOVING FOR RECESSED PAVEMENT MARKING, LETTERS AND SYMBOLS	SQ FT	234.0
* X7830070	GROOVING FOR RECESSED PAVEMENT MARKING 5"	FOOT	11,291.0
* X7830074	GROOVING FOR RECESSED PAVEMENT MARKING 7"	FOOT	250.0
* X7830076	GROOVING FOR RECESSED PAVEMENT MARKING 9"	FOOT	176.0

* DENOTES SPECIALTY ITEM

MODEL: I:\MODEL\MHMS
 FILE: MHMS_Plan\Illumination\DOT\Documents\DOT_Offices\Illum\IllumData\CAD\Sheet\0570E04.rvt-500.dgn

USER NAME = hoganbj	DESIGNED -	REVISED -
PLOT SCALE = 40.0000 ' / in.	DRAWN -	REVISED -
PLOT DATE = 6/2/2019	CHECKED -	REVISED -
	DATE -	REVISED -

STATE OF ILLINOIS
DEPARTMENT OF TRANSPORTATION

SCALE: N/A		SHEET 2	OF 3 SHEETS	STA.	TO STA.
------------	--	---------	-------------	------	---------

F.A.P. RTE.	SECTION	COUNTY	TOTAL SHEETS	SHEET NO.
704	(57-7)RS-2	MCLEAN	31	5
CONTRACT NO. 70E04				
ILLINOIS FED. AID PROJECT				

EXISTING TYPICAL CROSS SECTION ①

STATION TO STATION
365+78.00 366+28.00 ②

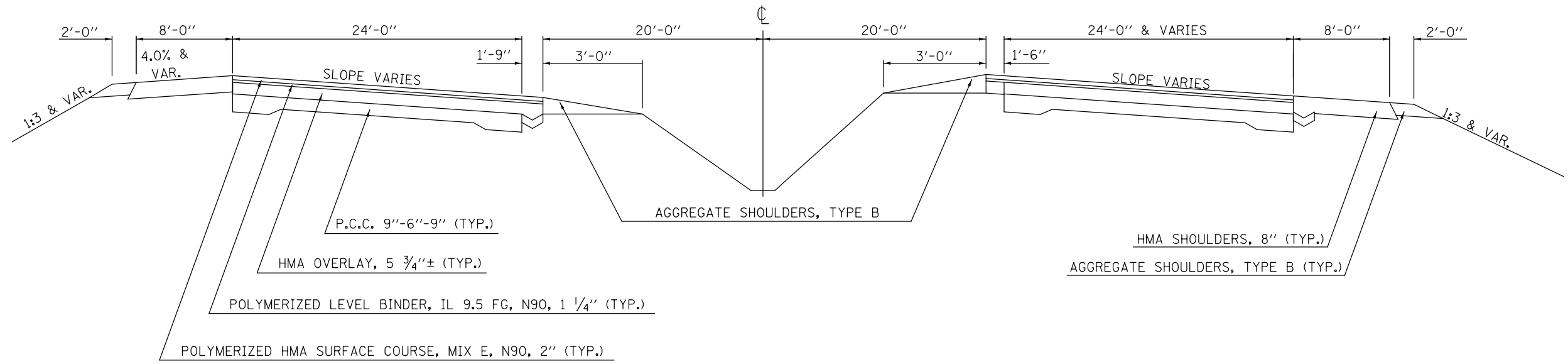

PROPOSED TYPICAL CROSS SECTION ①

STATION TO STATION
365+78.00 366+28.00 ②

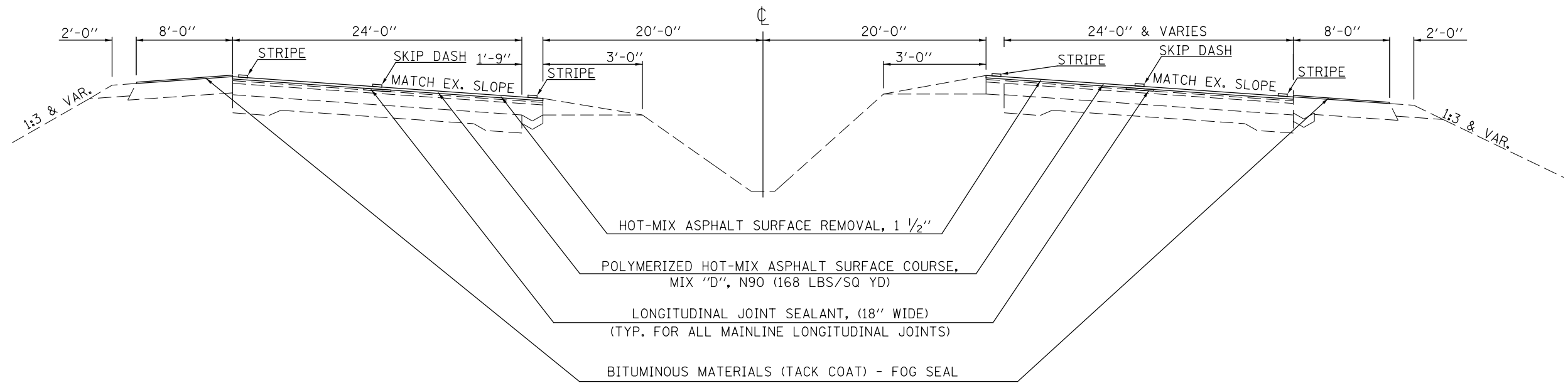

MODEL: \\MODEL\NAME: FILE: \\NAME: P:\pub\mcom\mdata\illinois\pwr\DOT\Documents\DOT_Offices\Drawings\Projects\70E04\CADD\Drawings\CADD\Sheet\0570E04-1b-Typical.dgn

USER NAME = hoganbj	DESIGNED -	REVISED -
	DRAWN -	REVISED -
PLOT SCALE = 40.0000' / in.	CHECKED -	REVISED -
PLOT DATE = 6/2/2019	DATE -	REVISED -

**STATE OF ILLINOIS
DEPARTMENT OF TRANSPORTATION**

TYPICAL CROSS SECTIONS			
SCALE: N/A	SHEET 1	OF 8 SHEETS	STA. TO STA.

F.A.P. RTE.	SECTION	COUNTY	TOTAL SHEETS	SHEET NO.
704	(57-7)RS-2	MCLEAN	31	7
CONTRACT NO. 70E04				
ILLINOIS FED. AID PROJECT				

EXISTING TYPICAL CROSS SECTION ②

STATION ① 366+28.00 TO STATION ③ 373+88.53

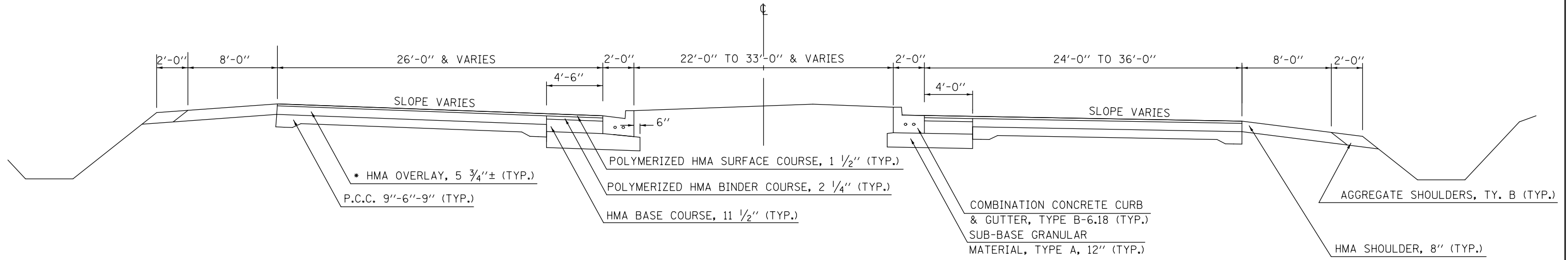

* 5"± HMA OVERLAY SHOWN AT
 STA. 367+00.00 RT TO STA. 373+00.00 RT
 STA. 370+50.00 LT TO STA. 376+97.00 LT

PROPOSED TYPICAL CROSS SECTION ②

STATION ① 366+28.00 TO STATION ③ 373+88.53

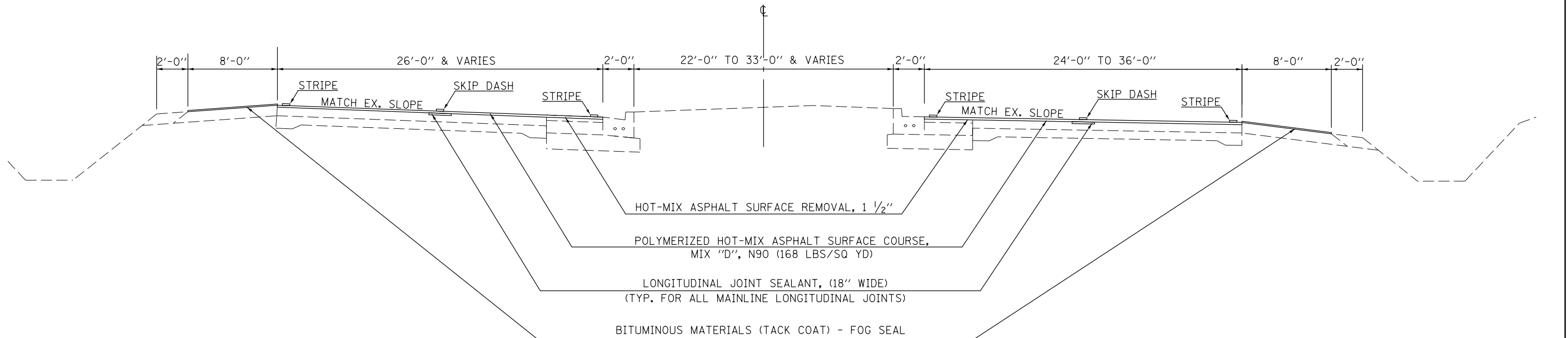

MODEL: \\MODEL\MATF
 FILE: \\matf\p\70E04\70E04\CADD\DATA\CADD\PROJECTS\70E04\70E04-1b-Typical.dgn

USER NAME = hoganbj	DESIGNED -	REVISED -
	DRAWN -	REVISED -
PLOT SCALE = 40.0000 ' / in.	CHECKED -	REVISED -
PLOT DATE = 6/2/2019	DATE -	REVISED -

STATE OF ILLINOIS
 DEPARTMENT OF TRANSPORTATION

TYPICAL CROSS SECTIONS			
SCALE: N/A	SHEET 2	OF 8 SHEETS	STA. TO STA.

F.A.P. RTE.	SECTION	COUNTY	TOTAL SHEETS	SHEET NO.
704	(57-7)RS-2	MCLEAN	31	8
CONTRACT NO. 70E04				
ILLINOIS FED. AID PROJECT				

EXISTING TYPICAL CROSS SECTION 3

STATION ② 373+88.53 TO STATION ④ 375+49.48

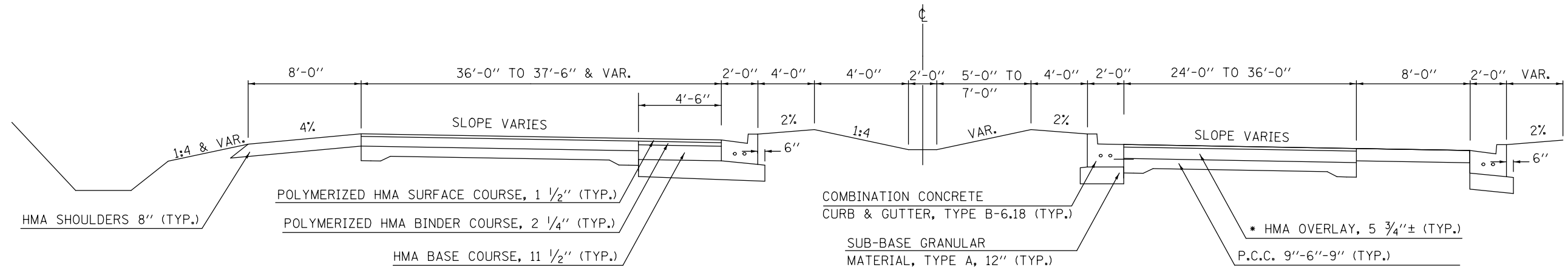

* 5" ± HMA OVERLAY SHOWN AT
 STA. 367+00.00 RT TO STA. 373+00.00 RT
 STA. 370+50.00 LT TO STA. 376+97.00 LT

PROPOSED TYPICAL CROSS SECTION 3

STATION ② 373+88.53 TO STATION ④ 375+49.48

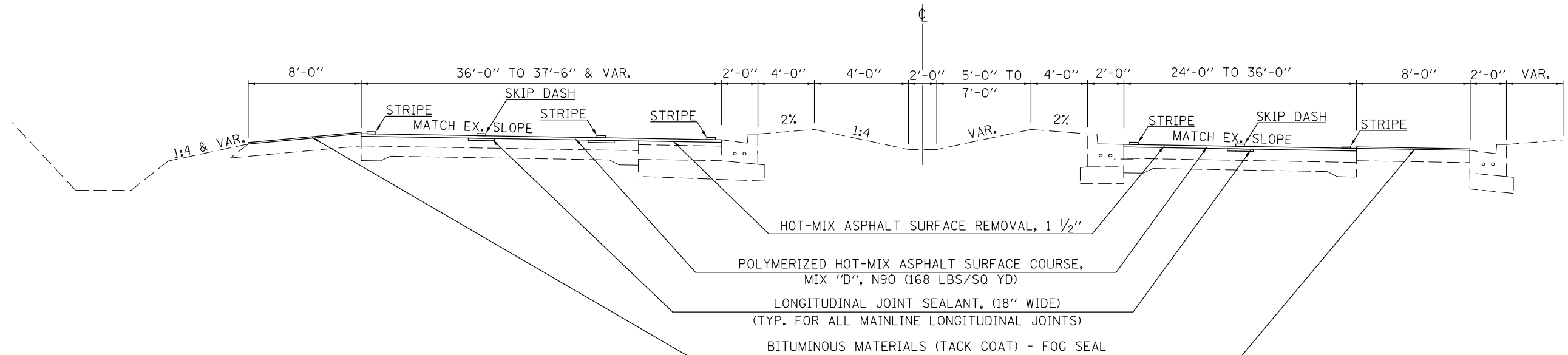

MODEL: \\MODEL\MARIS
 FILE: \\MARIS_Plan\Illinois\p04\70E04\CADD\Drawings\DOT\Office\Drawings\3\Projects\0570E04\CADD\Drawings\0570E04-ht-Typical.dgn

USER NAME = hoganbj	DESIGNED -	REVISED -
	DRAWN -	REVISED -
PLOT SCALE = 40,0000 ' / in.	CHECKED -	REVISED -
PLOT DATE = 6/2/2019	DATE -	REVISED -

STATE OF ILLINOIS
 DEPARTMENT OF TRANSPORTATION

TYPICAL CROSS SECTIONS

SCALE: N/A SHEET 3 OF 8 SHEETS STA. TO STA.

F.A.P. RTE.	SECTION	COUNTY	TOTAL SHEETS	SHEET NO.
704	(57-7)RS-2	MCLEAN	31	9
CONTRACT NO. 70E04				
ILLINOIS FED. AID PROJECT				

EXISTING TYPICAL CROSS SECTION ④

STATION TO STATION
 ③ 375+49.48 TO 381+50.53 ⑤

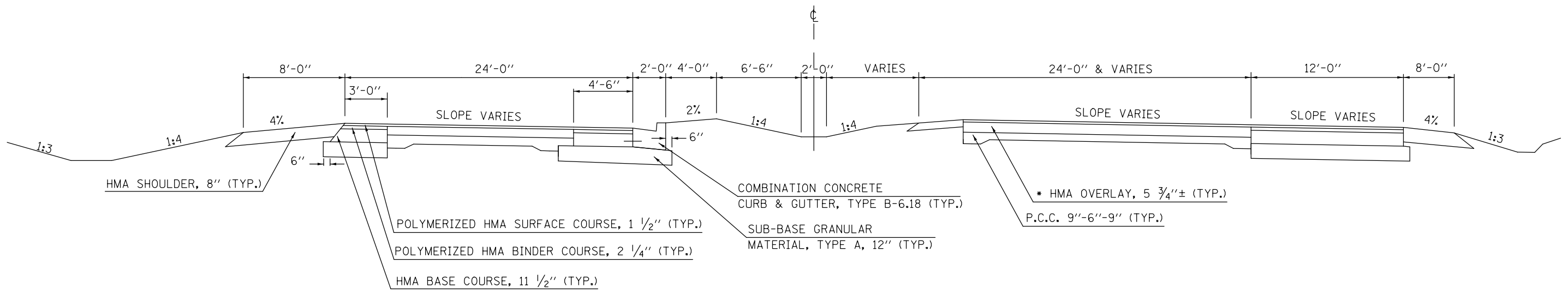

* 5" ± HMA OVERLAY SHOWN AT
 STA. 367+00.00 RT TO STA. 373+00.00 RT
 STA. 370+50.00 LT TO STA. 376+97.00 LT

PROPOSED TYPICAL CROSS SECTION ④

STATION TO STATION
 ③ 375+49.48 TO 381+50.53 ⑤

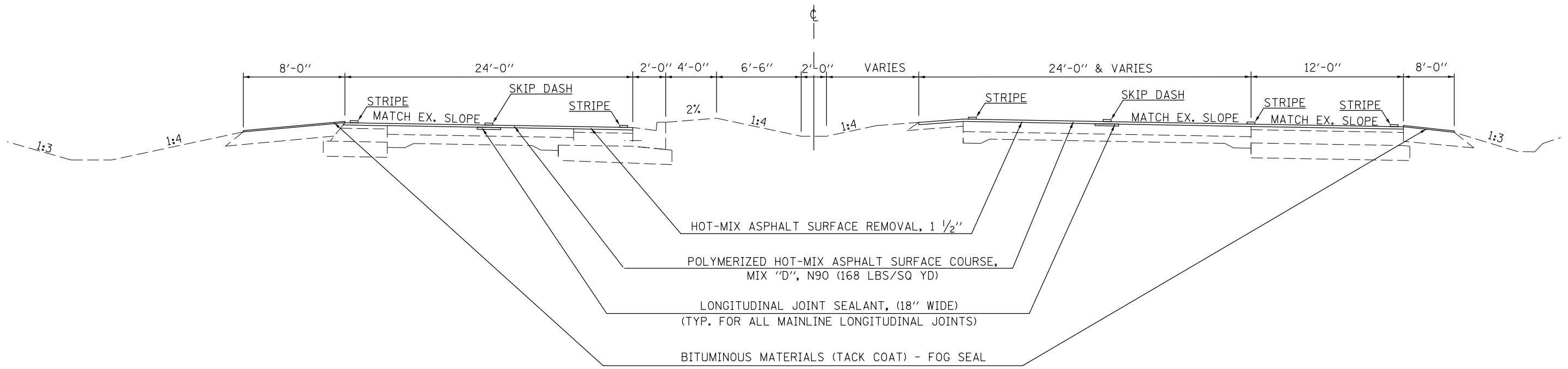

MODEL: s:\MODEL\MARTE
 FILE: MARTE - PLOT\BIM\COMMA\DATA\ILLINOIS\DOT\Office\Bldg\DOT\Projects\70E04\CADD\DATA\CAD\Sheet\0570E04-4b-Typical.dgn

USER NAME = hoganbj	DESIGNED -	REVISED -
PLOT SCALE = 40.0000 ' / in.	DRAWN -	REVISED -
PLOT DATE = 6/2/2019	CHECKED -	REVISED -
	DATE -	REVISED -

**STATE OF ILLINOIS
 DEPARTMENT OF TRANSPORTATION**

TYPICAL CROSS SECTIONS			
SCALE: N/A	SHEET 4	OF 8 SHEETS	STA. TO STA.

F.A.P. RTE.	SECTION	COUNTY	TOTAL SHEETS	SHEET NO.
704	(57-7)RS-2	MCLEAN	31	10
CONTRACT NO. 70E04				
ILLINOIS FED. AID PROJECT				

EXISTING TYPICAL CROSS SECTION 5

STATION TO STATION
 ④ 381+50.53 383+63.79 ⑥

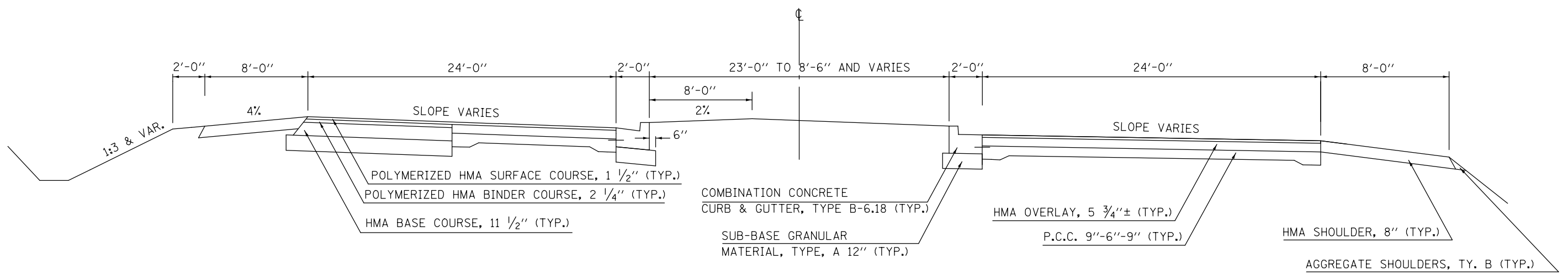

PROPOSED TYPICAL CROSS SECTION 5

STATION TO STATION
 ④ 381+50.53 383+63.79 ⑥

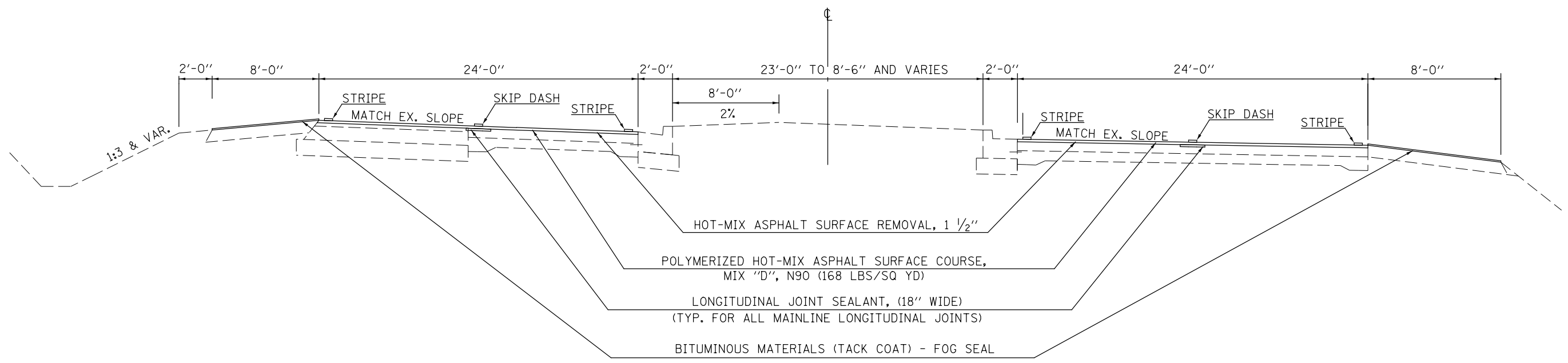

MODEL: \\MODEL\MARTE
 FILE: \\MARTE_Plan\pblm\com\m\dat\illinois\gov\pww\DOT\Documents\DOT_Offices\Illin\570E04\CADD\DATA\CAD\Sheet\570E04-5-1c-Typical.dgn

USER NAME = hoganbj	DESIGNED -	REVISED -
PLOT SCALE = 40,0000 ' / in.	DRAWN -	REVISED -
PLOT DATE = 6/2/2019	CHECKED -	REVISED -
	DATE -	REVISED -

**STATE OF ILLINOIS
 DEPARTMENT OF TRANSPORTATION**

TYPICAL CROSS SECTIONS			
SCALE: N/A	SHEET 5	OF 8 SHEETS	STA. TO STA.

F.A.P. RTE.	SECTION	COUNTY	TOTAL SHEETS	SHEET NO.
704	(57-7)RS-2	MCLEAN	31	11
CONTRACT NO. 70E04				
ILLINOIS FED. AID PROJECT				

EXISTING TYPICAL CROSS SECTION ⑥

STATION ⑤ 383+63.79 TO STATION 388+07.10 ⑦

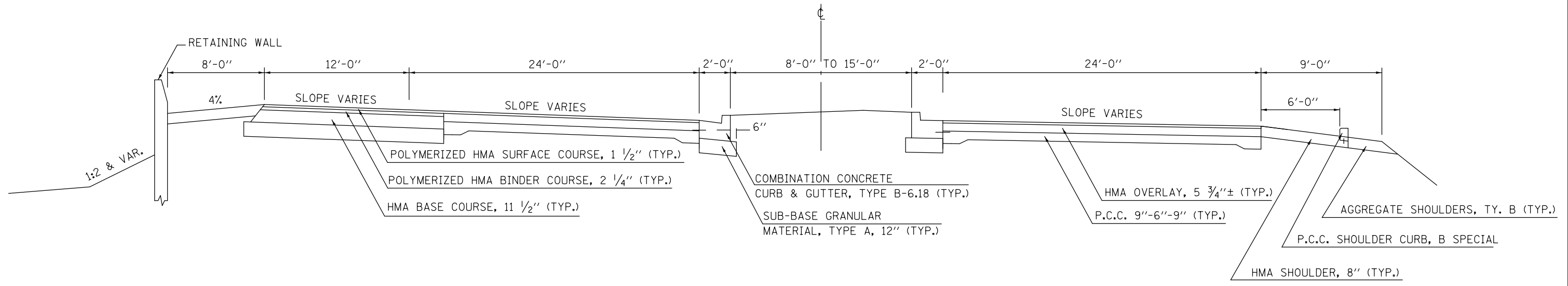

RETAINING WALL STA. 385+28.49 TO STA. 388+30.32

P.C.C. SHOULDER STA. 384+95.68 TO STA. 387+67.99

PROPOSED TYPICAL CROSS SECTION ⑥

STATION ⑤ 383+63.79 TO STATION 388+07.10 ⑦

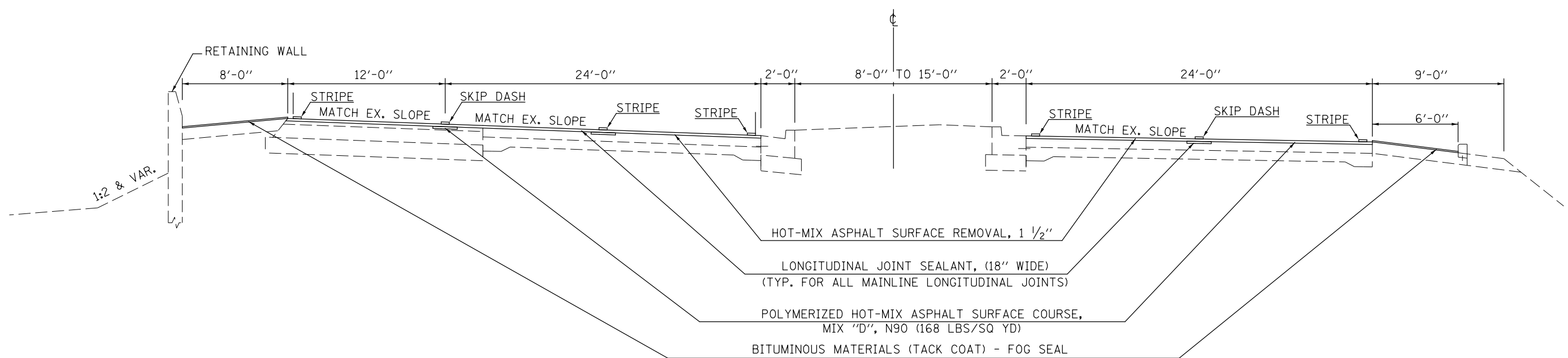

MODEL: I:\MODEL\MHFE FILE: MHFE.dwg PLOT DATE: 6/2/2019

USER NAME = hoganbj	DESIGNED -	REVISED -
PLOT SCALE = 40.0000 ' / in.	DRAWN -	REVISED -
PLOT DATE = 6/2/2019	CHECKED -	REVISED -
	DATE -	REVISED -

**STATE OF ILLINOIS
DEPARTMENT OF TRANSPORTATION**

TYPICAL CROSS SECTIONS			
SCALE: N/A	SHEET 6	OF 8 SHEETS	STA. TO STA.

F.A.P. RTE. 704	SECTION (57-7)RS-2	COUNTY MCLEAN	TOTAL SHEETS 31	SHEET NO. 12
CONTRACT NO. 70E04			ILLINOIS FED. AID PROJECT	

EXISTING TYPICAL CROSS SECTION 7

STATION TO STATION
 ⑥ 388+07.10 390+96.85 BK ⑧
 29+96.20 AH 32+30.00

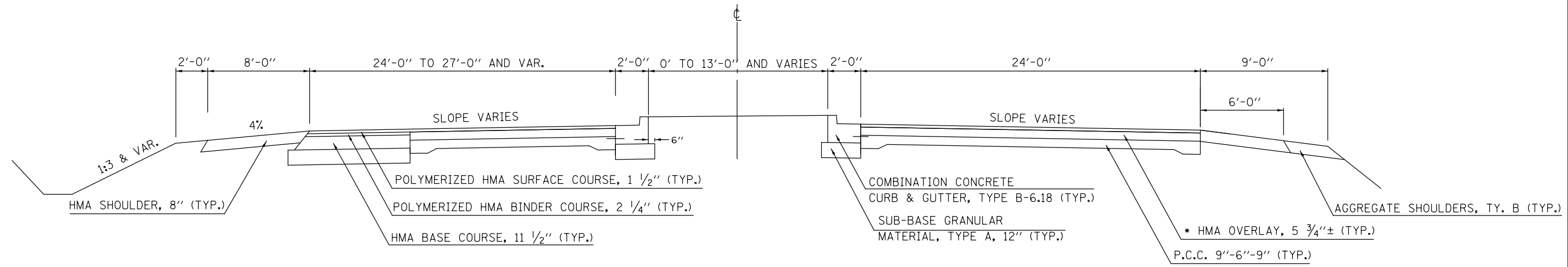

* 5"± HMA OVERLAY SHOWN AT STA. 390+96.85 BK = STA. 29+96.20 AH TO STA. 32+30.00

PROPOSED TYPICAL CROSS SECTION 7

STATION TO STATION
 ⑥ 388+07.10 390+96.85 BK ⑧
 29+93.05 AH 32+30.00

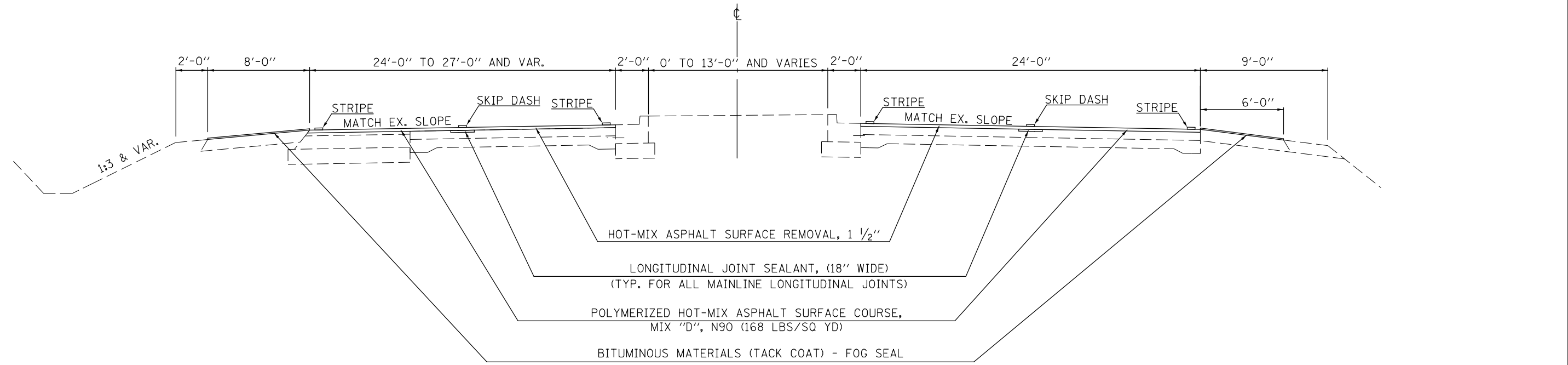

MODEL: \\MODEL\NAME
 FILE: \\NAME: \\path\to\file.dwg
 PROJECT: \\PROJECT\NAME
 OFFICE: \\OFFICE\NAME
 DATE: 6/2/2019

USER NAME = hoganbj	DESIGNED -	REVISED -
PLOT SCALE = 40.0000' / in.	DRAWN -	REVISED -
PLOT DATE = 6/2/2019	CHECKED -	REVISED -
	DATE -	REVISED -

STATE OF ILLINOIS
 DEPARTMENT OF TRANSPORTATION

TYPICAL CROSS SECTIONS
 SCALE: N/A SHEET 7 OF 8 SHEETS STA. TO STA.

F.A.P. RTE.	SECTION	COUNTY	TOTAL SHEETS	SHEET NO.
704	(57-7)RS-2	MCLEAN	31	13
CONTRACT NO. 70E04				
ILLINOIS FED. AID PROJECT				

EXISTING TYPICAL CROSS SECTION 8

⑦ STATION 32+30.00 TO STATION 32+80.00

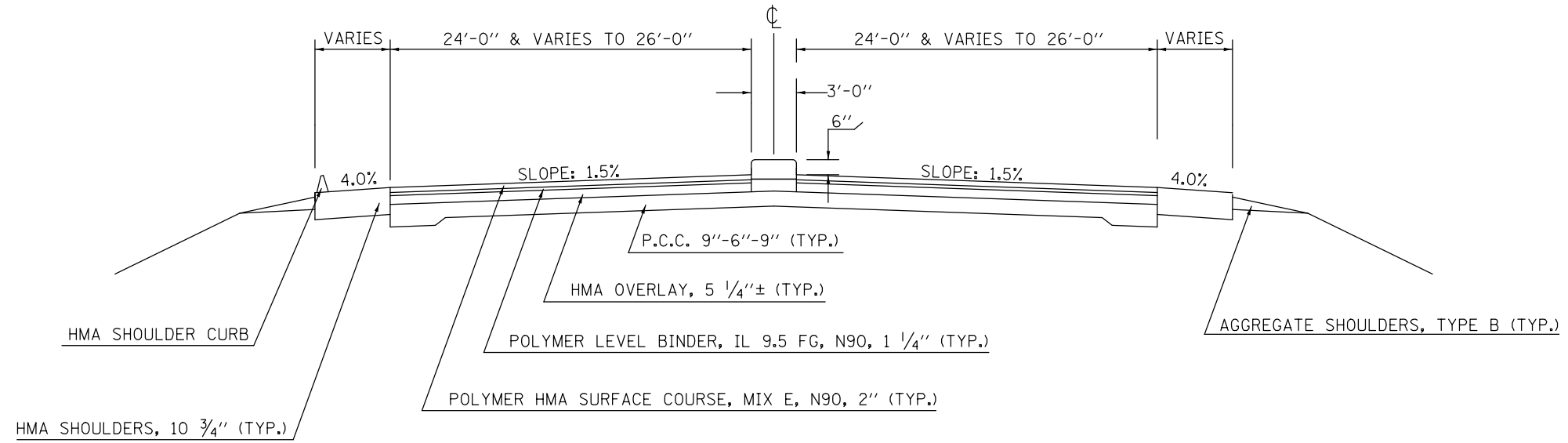

PROPOSED TYPICAL CROSS SECTION 8

⑦ STATION 32+30.00 TO STATION 32+80.00

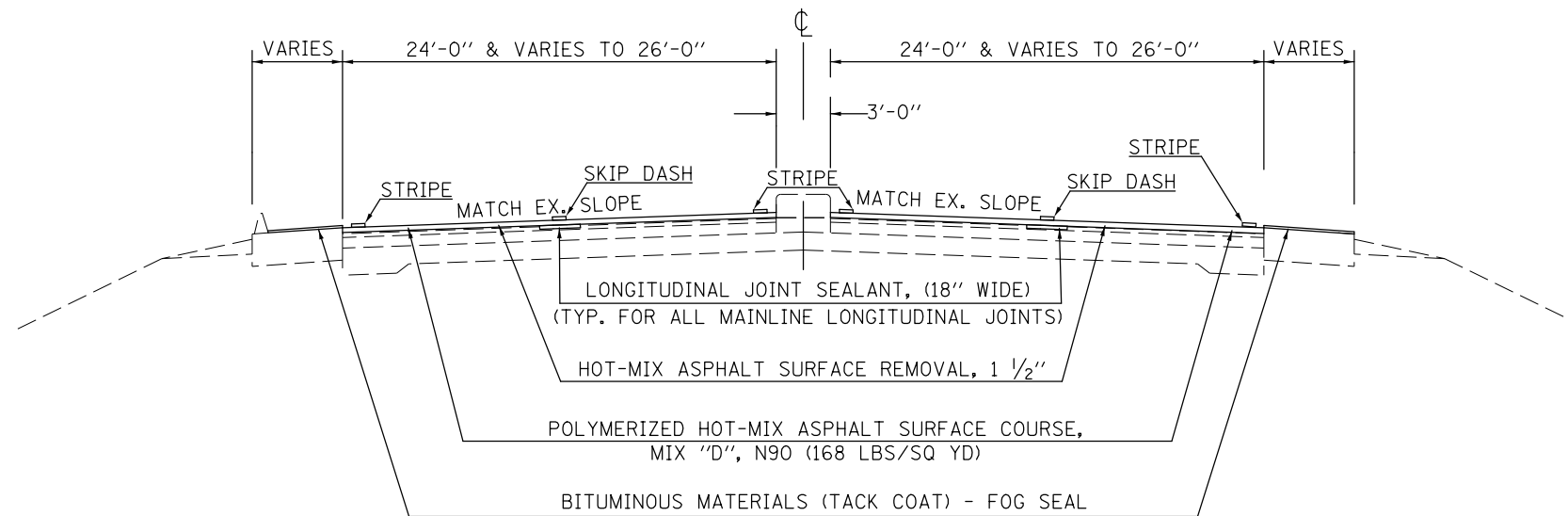

MODEL: \\MODEL\NAME: FILE: \\NAME: P:\pub\mcom\ma\data\illinois\pwr\WIDOT\Documents\DOT_Offices\District 5\Projects\0570E04\CADD\data\CAD\Sheet\0570E04-ht-Typical.dgn

USER NAME = hoganbj	DESIGNED -	REVISED -
	DRAWN -	REVISED -
PLOT SCALE = 40.0000 ' / in.	CHECKED -	REVISED -
PLOT DATE = 6/2/2019	DATE -	REVISED -

STATE OF ILLINOIS
DEPARTMENT OF TRANSPORTATION

TYPICAL CROSS SECTIONS

SCALE: N/A SHEET 8 OF 8 SHEETS STA. TO STA.

F.A.P. RTE.	SECTION	COUNTY	TOTAL SHEETS	SHEET NO.
704	(57-7)RS-2	MCLEAN	31	14
CONTRACT NO. 70E04				
ILLINOIS FED. AID PROJECT				

CHANGEABLE MESSAGE SIGNS

DIRECTION	STREET NAME	CHANGEABLE MESSAGE SIGN 70107025 (CAL DA)
NB	Morris	3.0
SB	Morris	3.0
EB	Veterans	3.0
WB	Veterans	3.0
Extra Days During Construction Operations*		40.0
GRAND TOTAL		52.0

*May be deleted if not needed.

DETECTOR LOOPS

LANE	INTERSECTION	STATION	LENGTH (FEET)	WIDTH (FEET)	LENGTH OF LEAD-IN (FEET)	DETECTOR LOOP, TYPE I 88600100 (FOOT)
EBDL	Morris/Veterans	367+17.5	6	6	15	39.0
EBPL	Morris/Veterans	367+17.5	6	6	28	52.0
EBLTL	Morris/Veterans	370+08.5	10	6	10	42.0
EBLTL	Morris/Veterans	370+27.7	10	6	11	43.0
WBLTL	Morris/Veterans	372+84.4	15	6	6	48.0
WBLTL	Morris/Veterans	373+06.9	15	6	15	57.0
WBDL	Morris/Veterans	376+06.7	6	6	14	38.0
WBPL	Morris/Veterans	376+06.7	6	6	27	51.0
EBDL	Greenwood/Veterans	379+37.6	6	6	23	47.0
EBPL	Greenwood/Veterans	379+37.6	6	6	38	62.0
WBLTL	Greenwood/Veterans	384+56.1	10	6	7	39.0
WBLTL	Greenwood/Veterans	384+82.4	10	6	14	46.0
WBDL	Greenwood/Veterans	386+78.7	6	6	11	35.0
WBPL	Greenwood/Veterans	386+78.7	6	6	23	47.0
GRAND TOTAL						646.0

HMA SUMMARY

LOCATION	STATION	TO	STATION	LENGTH (FOOT)	AVG. WIDTH (FOOT)	AREA* (SQ YD)	HOT MIX ASPHALT SURFACE COURSE THICKNESS (INCH)	BITUMINOUS MATERIALS (TACK COAT)** 40600290 (POUND)	POLYMERIZED HOT- MIX ASPHALT SURFACE COURSE, MIX "D", N90 40603545 (TON)	HOT-MIX ASPHALT SURFACE REMOVAL, 1 1/2" 44000155 (SQ YD)
MAINLINE FAP 704 (I-55 BUS)										
VETERANS PKWY	365+78.00		390+96.85	2,518.85	VAR	18,409.0	1.5	8,284.1	1,546.4	18,409.0
	29+93.05		32+80.00	286.95						
MAINLINE SUBTOTAL								8,284.1	1,546.4	18,409.0
HMA SHOULDERS - FOG SEAL FAP 704 (I-55 BUS)										
EBDS	365+78.00		369+45.63	367.63	VAR	330.4	0.0	148.7	0.0	0.0
EBDS	372+62.04		382+44.78	982.74	VAR	856.3	0.0	385.4	0.0	0.0
EBDS	384+25.41		390+96.85	671.44	VAR	690.2	0.0	310.6	0.0	0.0
	29+93.05		32+80.00	286.95						
WBDS	32+80.00		29+93.05	286.95	VAR	1,153.0	0.0	518.8	0.0	0.0
	390+96.85		380+64.17	1,032.68						
WBDS	381+25.44		373+29.84	795.60	VAR	843.8	0.0	379.7	0.0	0.0
WBDS	370+32.24		365+78.00	454.24	VAR	458.0	0.0	206.1	0.0	0.0
SHOULDER SUBTOTAL								1,949.3	0.0	0.0
GRAND TOTAL								10,233.4	1,546.4	18,409.0
ROUND TO:								10,250.0	1,550.0	18,425.0

*AREAS MEASURED FROM CADD

**PRIME APPLICATION RATE = 0.05 LB/SQ FT FOR MILLED SURFACE & 0.05 LB/SQ FT FOR SHOULDER FOG SEAL

MODEL: I:\MODEL\HMF5
FILE: hmf5_01.dwg
PROJECT: I:\PROJECTS\70E04\CADD\DATA\CAD\HMF5\70E04-01-Schedule.dwg

USER NAME = hoganbj	DESIGNED -	REVISED -
	DRAWN -	REVISED -
PLOT SCALE = 40.0000' / in.	CHECKED -	REVISED -
PLOT DATE = 6/2/2019	DATE -	REVISED -

**STATE OF ILLINOIS
DEPARTMENT OF TRANSPORTATION**

SCHEDULE OF QUANTITIES			
SCALE:	SHEET 1	OF 5 SHEETS	STA. TO STA.

F.A.P. RTE.	SECTION	COUNTY	TOTAL SHEETS	SHEET NO.
704	(57-7)RS-2	MCLEAN	31	15
CONTRACT NO. 70E04				
ILLINOIS FED. AID PROJECT				

PAVEMENT MARKING SCHEDULE

DIRECTION	DESCRIPTION	STATION	TO	STATION	LENGTH	THERMOPLASTIC PAVEMENT MARKING - LINE 4"				PREFORMED PLASTIC PAVEMENT MARKING, TYPE B - INLAID - LINE 4" (WHITE)	THERMOPLASTIC PAVEMENT MARKING - LINE 6" (WHITE)	THERMOPLASTIC PAVEMENT MARKING - LINE 8" (WHITE)	THERMOPLASTIC PAVEMENT MARKING - LINE 12" (WHITE)	THERMOPLASTIC PAVEMENT MARKING - LINE 24" (WHITE)	THERMOPLASTIC PAVEMENT MARKING - LETTERS AND SYMBOLS (WHITE)	
						4" EDGE LINE (YELLOW)	4" EDGE LINE (WHITE)	4" LANE LINE EXTENSIONS (WHITE)	4" TURN LANE LINE SOLID (WHITE)							
						(FOOT)	(FOOT)	(FOOT)	(FOOT)							
						78000200				78004210	78000400	78000500	78000600	78000650	78000100	
						FAP 704 (I-55 BUS)										
EB	EDGE LINE	365+78.00	TO	367+31.84	153.8	153.8	153.8									
EB	LEFT TURN LANE SKIP DASH	367+31.84	TO	368+75.34	143.5	143.5	143.5	47.8								
EB	LEFT TURN LANE SOLID LINE	368+75.34	TO	370+37.71	162.4	162.4	162.4		162.4							
EB	MEDIAN	370+37.71	TO	370+37.71	91.0	91.0										
EB	EDGE LINE	370+37.71	TO	378+54.45	816.7	816.7	816.7			204.2						
EB	RIGHT TURN LANE SKIP DASH	378+54.45	TO	380+26.52	172.1	172.1	172.1	57.4								
EB	RIGHT TURN LANE SOLID LINE	380+26.52	TO	382+44.78	218.3	218.3	218.3		218.3							
EB	MEDIAN	382+44.78	TO	382+68.85	42.0	42.0										
EB	EDGE LINE	382+44.78	TO	390+96.85	852.07	852.1	852.1			213.0						
EB	STATION EQUATION	390+96.85 BK	TO	29+93.05 AH												
EB	EDGE LINE	29+93.20	TO	32+80.00	286.8	286.8	286.8			71.7						
WB	EDGE LINE	365+78.00	TO	372+84.27	706.3	706.3	706.3			176.6						
WB	MEDIAN	370+75.72	TO	372+84.27	20.0	20.0										
WB	LEFT TURN LANE SKIP DASH	372+84.27	TO	375+37.73	253.5	253.5	253.5		253.5							
WB	LEFT TURN LANE SOLID LINE	375+37.73	TO	377+35.25	197.5	197.5	197.5	65.8		49.4						
WB	EDGE LINE	377+35.25	TO	383+53.91	618.7	618.7	618.7			154.7						
WB	MEDIAN	383+41.32	TO	383+53.91	15.0	15.0										
WB	LEFT TURN LANE SKIP DASH	383+53.91	TO	385+58.37	204.5	204.5	204.5		204.5							
WB	LEFT TURN LANE SOLID LINE	385+58.37	TO	387+34.22	175.8	175.8	175.8	58.6		44.0						
WB	EDGE LINE	387+34.22	TO	390+96.85	362.6	362.6	362.6			90.7						
WB	STATION EQUATION	390+96.85 BK	TO	29+93.05 AH												
WB	EDGE LINE	29+93.20	TO	32+80.00	286.8	286.8	286.8			71.7						
MORRIS AVE.	DUAL LEFT TURN LANE EXT.	371+37.33						42.0								
EB	ISLAND	370+01.90	TO	370+42.40	40.5					40.5						
EB	ISLAND	370+53.67	TO	370+63.92	10.3					10.3						
EB	CROSS WALK	370+49.80			85.0					85.0						
EB	ISLAND	371+37.54	TO	371+70.54	33.0					33.0						
EB	ISLAND	382+51.82	TO	382+77.82	26.0					26.0						
WB	CROSS WALK	370+49.80			55.0					55.0						
EB	CROSS WALK W/ 13 BARS	370+49.80			10.0							130.0				
WB	CROSS WALK W/ 10 BARS	370+49.80			10.0							100				
WB	GORE	380+54.80	TO	381+42.8	176.0						176.0	61.0				
EB	STOP BAR	370+38.83			36.0									36.0		
EB	STOP BAR	382+52.74			24.0									24.0		
WB	STOP BAR	372+83.41			36.0									36.0		
WB	STOP BAR	383+54.10			36.0									36.0		
EB LT TRN	3- LEFT ARROW	368+69.89	TO	370+22.91											46.8	
WB LT TRN	4- LEFT ARROW	373+02.11	TO	375+35.24											62.4	
EB RT TRN	4- RIGHT ARROW	380+28.49	TO	382+32.14											62.4	
WB LT TRN	4- LEFT ARROW	383+72.28	TO	385+57.99											62.4	
FAP 704 SUB TOTAL =						5,779.3	5,611.3	271.6	838.6	1,402.8	249.8	176.0	291.0	132.0	234.0	
FAP 704 SUB TOTAL =										12,500.8	1,402.8	249.8	176.0	291.0	132.0	234.0
EDGE LINE OMISSIONS =										1,210.0						
FAP 704 TOTAL =										11,290.8	1,402.8	249.8	176.0	291.0	132.0	234.0
ROUND TO:										11,291.0	1,410.0	250.0	176.0	291.0	132.0	234.0

*AREAS MEASURED FROM CADD

MODEL: I:\MODEL\MAHES FILE: MAHES_PAVEMENT\MAHES_PAVEMENT.dwg; PROJECT: I:\PROJECTS\70E04\DATA\CADD\70E04-PAVEMENT-SCHEDULE.dwg

USER NAME = hoganbj	DESIGNED -	REVISED -
	DRAWN -	REVISED -
PLOT SCALE = 40,0000 ' / in.	CHECKED -	REVISED -
PLOT DATE = 6/2/2019	DATE -	REVISED -

**STATE OF ILLINOIS
DEPARTMENT OF TRANSPORTATION**

SCHEDULE OF QUANTITIES

SCALE: SHEET 4 OF 5 SHEETS STA. TO STA.

F.A.P. RTE.	SECTION	COUNTY	TOTAL SHEETS	SHEET NO.
704	(57-7)RS-2	MCLEAN	31	18
CONTRACT NO. 70E04				
ILLINOIS FED. AID PROJECT				

PAVEMENT GROOVING SCHEDULE

DIRECTION	DESCRIPTION	STATION	TO	STATION	LENGTH	GROOVING FOR RECESSED PAVEMENT MARKING 5"				GROOVING FOR RECESSED PAVEMENT MARKING 7"	GROOVING FOR RECESSED PAVEMENT MARKING 9"	GROOVING FOR RECESSED PAVEMENT MARKING 13"	GROOVING FOR RECESSED PAVEMENT MARKING 25"	GROOVING FOR RECESSED PAVEMENT MARKING, LETTERS AND SYMBOLS
						5" EDGE PASSING LANE	5" EDGE LINE DRIVING LANE	5" LANE LINE EXTENSIONS	5" TURN LANES					
						X7830070				X7830074	X7830076	X7830078	X7830090	X7830060
						(FOOT)	(FOOT)	(FOOT)	(FOOT)	(FOOT)	(FOOT)	(FOOT)	(FOOT)	(SQ FT)
FAP 704 (I-55 BUS)														
EB	EDGE LINE	365+78.00	TO	367+31.84	153.8	153.8	153.8							
EB	LEFT TURN LANE SKIP DASH	367+31.84	TO	368+75.34	143.5	143.5	143.5	47.8						
EB	LEFT TURN LANE SOLID LINE	368+75.34	TO	370+37.71	162.4	162.4	162.4		162.4					
EB	MEDIAN	370+37.71	TO	370+37.71	91.0	91.0								
EB	EDGE LINE	370+37.71	TO	378+54.45	816.7	816.7	816.7							
EB	RIGHT TURN LANE SKIP DASH	378+54.45	TO	380+26.52	172.1	172.1	172.1	57.4						
EB	RIGHT TURN LANE SOLID LINE	380+26.52	TO	382+44.78	218.3	218.3	218.3		218.3					
EB	MEDIAN	382+44.78	TO	382+68.85	42.0	42.0								
EB	EDGE LINE	382+44.78	TO	390+96.85	852.07	852.1	852.1							
EB	STATION EQUATION	390+96.85 BK	TO	29+93.05 AH										
EB	EDGE LINE	29+93.20	TO	32+80.00	286.8	286.8	286.8							
WB	EDGE LINE	365+78.00	TO	372+84.27	706.3	706.3	706.3							
WB	MEDIAN	370+75.72	TO	372+84.27	20.0	20.0								
WB	LEFT TURN LANE SKIP DASH	372+84.27	TO	375+37.73	253.5	253.5	253.5		253.5					
WB	LEFT TURN LANE SOLID LINE	375+37.73	TO	377+35.25	197.5	197.5	197.5	65.8						
WB	EDGE LINE	377+35.25	TO	383+53.91	618.7	618.7	618.7							
WB	MEDIAN	383+41.32	TO	383+53.91	15.0	15.0								
WB	LEFT TURN LANE SKIP DASH	383+53.91	TO	385+58.37	204.5	204.5	204.5		204.5					
WB	LEFT TURN LANE SOLID LINE	385+58.37	TO	387+34.22	175.8	175.8	175.8	58.6						
WB	EDGE LINE	387+34.22	TO	390+96.85	362.6	362.6	362.6							
WB	STATION EQUATION	390+96.85 BK	TO	29+93.05 AH										
WB	EDGE LINE	29+93.20	TO	32+80.00	286.8	286.8	286.8							
MORRIS AVE.	DUAL LEFT TURN LANE EXT.	371+37.33						42.0						
EB	ISLAND	370+01.90	TO	370+42.40	40.5				40.5					
EB	ISLAND	370+53.67	TO	370+63.92	10.3				10.3					
EB	CROSS WALK	370+49.80			85.0				85.0					
EB	ISLAND	371+37.54	TO	371+70.54	33.0				33.0					
EB	ISLAND	382+51.82	TO	382+77.82	26.0				26.0					
WB	CROSS WALK	370+49.80			55.0				55.0					
EB	CROSS WALK W/ 13 BARS	370+49.80			10.0						130.0			
WB	CROSS WALK W/ 10 BARS	370+49.80			10.0						100			
WB	GORE	380+54.80	TO	381+42.8	176.0					176.0	61.0			
EB	STOP BAR	370+38.83			36.0							36.0		
EB	STOP BAR	382+52.74			24.0							24.0		
WB	STOP BAR	372+83.41			36.0							36.0		
WB	STOP BAR	383+54.10			36.0							36.0		
														46.8
EB LT TRN	3- LEFT ARROW	368+69.89	TO	370+22.91										62.4
WB LT TRN	4- LEFT ARROW	373+02.11	TO	375+35.24										62.4
EB RT TRN	4- RIGHT ARROW	380+28.49	TO	382+32.14										62.4
WB LT TRN	4- LEFT ARROW	383+72.28	TO	385+57.99										
FAP 704 SUB TOTAL =						5,779.3	5,611.3	271.6	838.6	249.8	176.0	291.0	132.0	234.0
FAP 704 SUB TOTAL =									12,500.8	249.8	176.0	291.0	132.0	234.0
EDGE LINE OMISSIONS =									1,210.0					
FAP 704 TOTAL =									11,290.8	249.8	176.0	291.0	132.0	234.0
ROUND TO:									11,291.0	250.0	176.0	291.0	132.0	234.0

*AREAS MEASURED FROM CADD

MODEL: I:\MODEL\NAMES FILE: N:\MIS: P:\pub\mcomas.dwg: I:\links\pwp\WIDOT\Documents\DOT - Offices\DIR\ctc 5\Projects\0570E04\CADDData\CAD\References\0570E04-eh-Schedule.dgn

USER NAME = hoganbj	DESIGNED -	REVISED -
	DRAWN -	REVISED -
PLOT SCALE = 40,0000 ' / in.	CHECKED -	REVISED -
PLOT DATE = 6/2/2019	DATE -	REVISED -

STATE OF ILLINOIS
DEPARTMENT OF TRANSPORTATION

SCHEDULE OF QUANTITIES			
SCALE:	SHEET 5	OF 5	SHEETS STA. TO STA.

F.A.P. RTE.	SECTION	COUNTY	TOTAL SHEETS	SHEET NO.
704	(57-7)RS-2	MCLEAN	31	19
CONTRACT NO. 70E04				
ILLINOIS FED. AID PROJECT				

START PROJECT F.A.P. 704
STATION 365+78.00

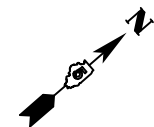

CL F.A.P. 704
(I-55 BUS.)

363

364

365+00

366



CL F.A.P. 704
(I-55 BUS.)

367

MATCHLINE STATION 367+50.00

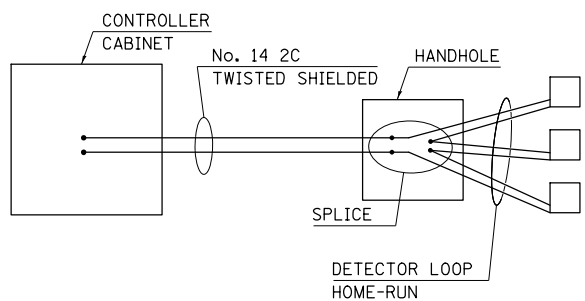
**TYPICAL DETAIL OF
DETECTOR LOOP WIRING**
WIRED IN SERIES WITH SINGLE PAIR CABLE



-  HMA SURFACE REMOVAL, 1 1/2"
-  BITUMINOUS MATERIALS (TACK COAT) - FOG SEAL

MODEL: 4\MODEL\MARF6
FILE: MARF6_Plan.dwg
S:\Projects\0570E04\CADDData\CADD\Sheet\0570E05-Plan.dwg

USER NAME = hoganbj	DESIGNED -	REVISED -
PLOT SCALE = 40,0000' / in.	DRAWN -	REVISED -
PLOT DATE = 6/2/2019	CHECKED -	REVISED -
	DATE -	REVISED -



**STATE OF ILLINOIS
DEPARTMENT OF TRANSPORTATION**

**PLAN SHEETS
F.A.P. 704 (I-55 BUSINESS / VETERANS PARKWAY)**

SCALE: 1" = 20' SHEET 1 OF 6 SHEETS STA. 363+00.00 TO STA. 367+50.00

F.A.P. RTE.	SECTION	COUNTY	TOTAL SHEETS	SHEET NO.
704	(57-7)RS-2	MCLEAN	31	20
			CONTRACT NO. 70E04	
		ILLINOIS FED. AID PROJECT		

MODEL: s:\MODEL\NAME
 FILE: NAME: s:\p\illinois\dot\Documents\DOT_Offices\Illin\DOT\Projects\0570E04\CADD\DATA\CAD\Sheet\0570E05-rt-Plan.dgn

-  HMA SURFACE REMOVAL, 1/2"
-  BITUMINOUS MATERIALS (TACK COAT) - FOG SEAL

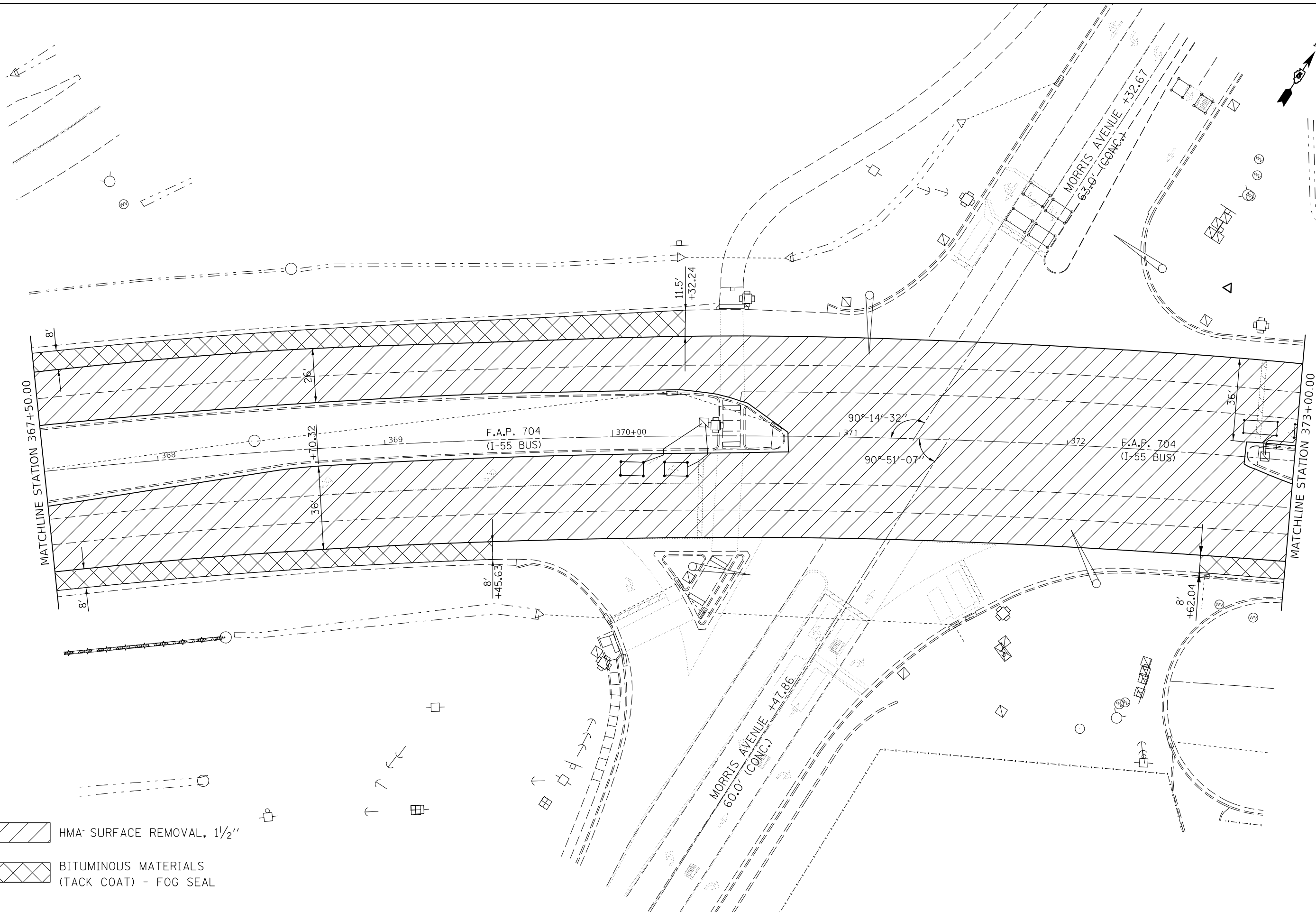

USER NAME = hoganbj	DESIGNED -	REVISED -
DRAWN -	REVISED -	
PLOT SCALE = 40,0000 ' / in.	CHECKED -	REVISED -
PLOT DATE = 6/2/2019	DATE -	REVISED -

**STATE OF ILLINOIS
 DEPARTMENT OF TRANSPORTATION**

PLAN SHEETS			
F.A.P. 704 (I-55 BUSINESS / VETERANS PARKWAY)			
SCALE: 1" = 20'	SHEET 2	OF 6 SHEETS	STA. 367+50.00 TO STA. 373+00.00

F.A.P. RTE. 704	SECTION (57-7)RS-2	COUNTY MCLEAN	TOTAL SHEETS 31	SHEET NO. 21
			CONTRACT NO. 70E04	
ILLINOIS FED. AID PROJECT				

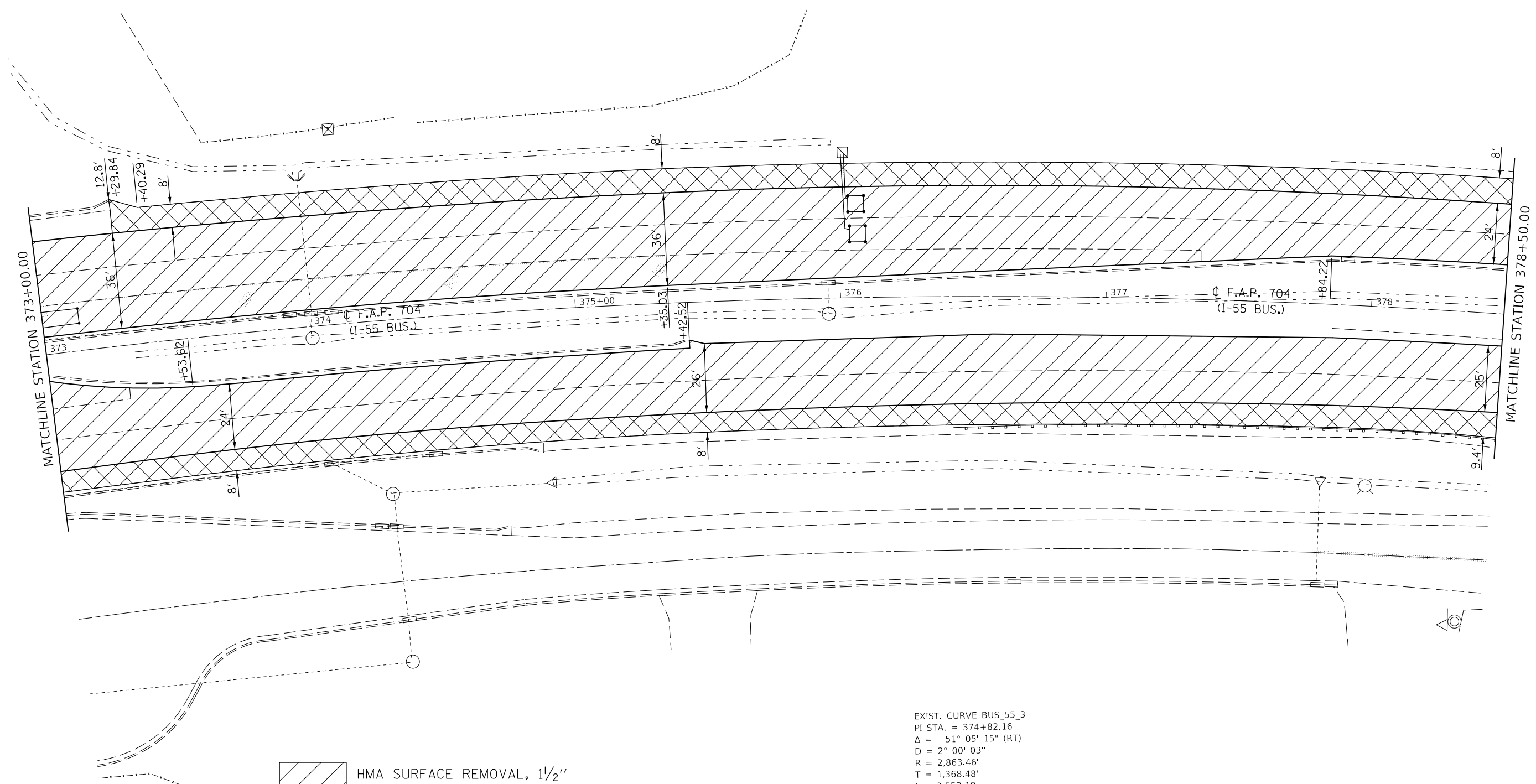

EXIST. CURVE BUS 55_3
 PI STA. = 374+82.16
 $\Delta = 51^\circ 05' 15''$ (RT)
 $D = 2^\circ 00' 03''$
 $R = 2,863.46'$
 $T = 1,368.48'$
 $L = 2,553.18'$
 $E = 310.20'$
 $e = \text{---}$
 $T.R. = \text{---}$
 $S.E. \text{ RUN} = \text{---}$
 $P.C. \text{ STA.} = 361+13.68$
 $P.T. \text{ STA.} = 386+66.86$

MODEL: I:\MODEL\NAME
 FILE: NAME.dwg
 PROJECT: I:\PROJECTS\70E04\CADD\DATA\CADD\PROJECTS\70E04-RT-Plan.dwg

USER NAME = hoganbj	DESIGNED -	REVISED -
PLOT SCALE = 40,0000' / in.	DRAWN -	REVISED -
PLOT DATE = 6/2/2019	CHECKED -	REVISED -
	DATE -	REVISED -

STATE OF ILLINOIS
DEPARTMENT OF TRANSPORTATION

PLAN SHEETS
F.A.P. 704 (I-55 BUSINESS / VETERANS PARKWAY)
 SCALE: 1" = 20' SHEET 3 OF 6 SHEETS STA. 373+00.00 TO STA. 378+50.00

F.A.P. RTE.	SECTION	COUNTY	TOTAL SHEETS	SHEET NO.
704	(57-7)RS-2	MCLEAN	31	22
CONTRACT NO. 70E04				
ILLINOIS FED. AID PROJECT				

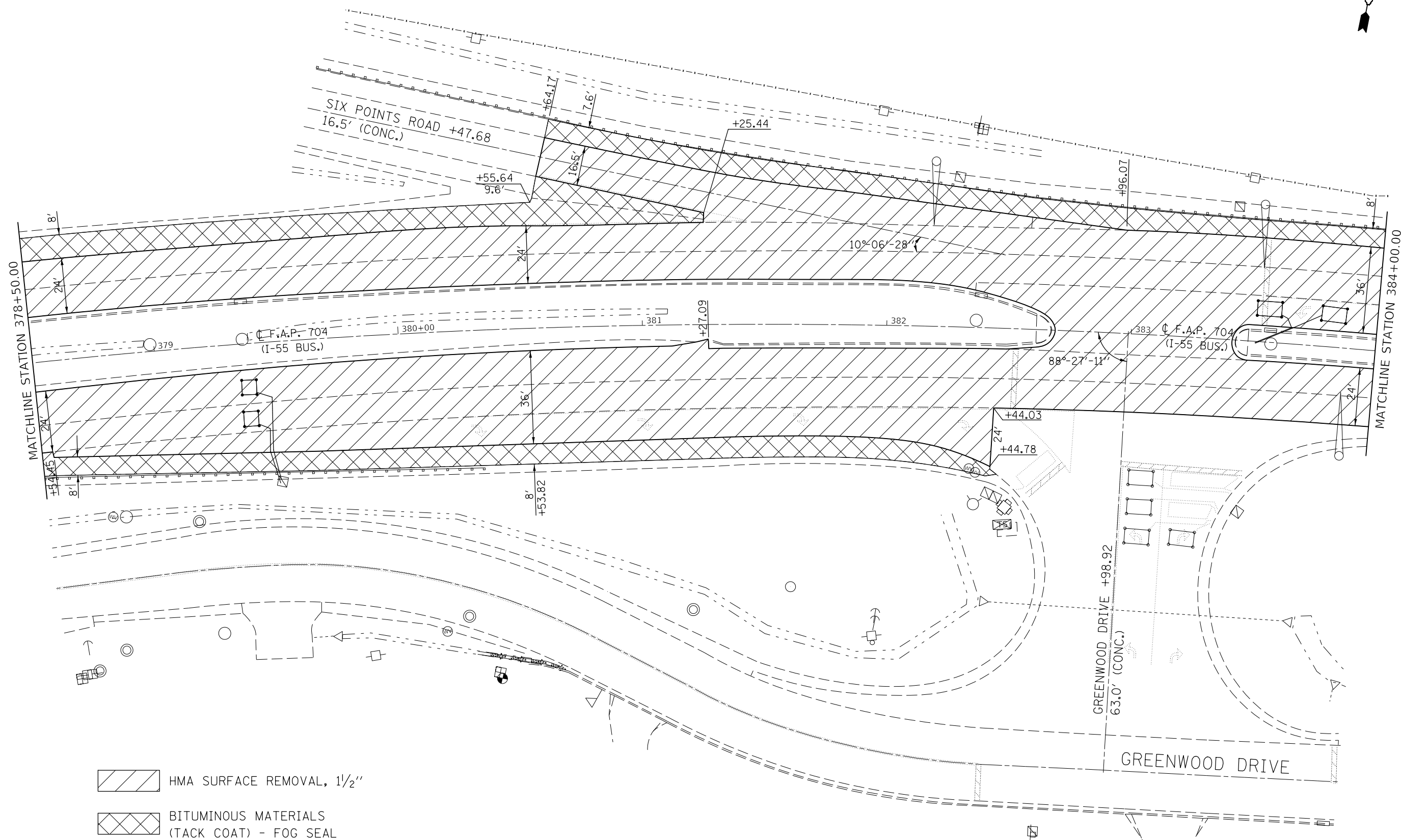

- HMA SURFACE REMOVAL, 1 1/2"
- BITUMINOUS MATERIALS (TACK COAT) - FOG SEAL

MODEL: \\MODEL\NAME
 FILE: \\NAME: \\path\to\document\DOT: Office\Director: S:\projects\0570E04\CADD\DATA\CAD\papers\0570E05-rtr-plan.dgn

USER NAME = hoganbj	DESIGNED -	REVISED -
	DRAWN -	REVISED -
PLOT SCALE = 40.0000 ' / in.	CHECKED -	REVISED -
PLOT DATE = 6/2/2019	DATE -	REVISED -

STATE OF ILLINOIS
DEPARTMENT OF TRANSPORTATION

PLAN SHEETS
F.A.P. 704 (I-55 BUSINESS / VETERANS PARKWAY)
 SCALE: 1" = 20' SHEET 4 OF 6 SHEETS STA. 378+50.00 TO STA. 384+00.00

F.A.P. RTE.	SECTION	COUNTY	TOTAL SHEETS	SHEET NO.
704	(57-7)RS-2	MCLEAN	31	23
CONTRACT NO. 70E04				
ILLINOIS FED. AID PROJECT				

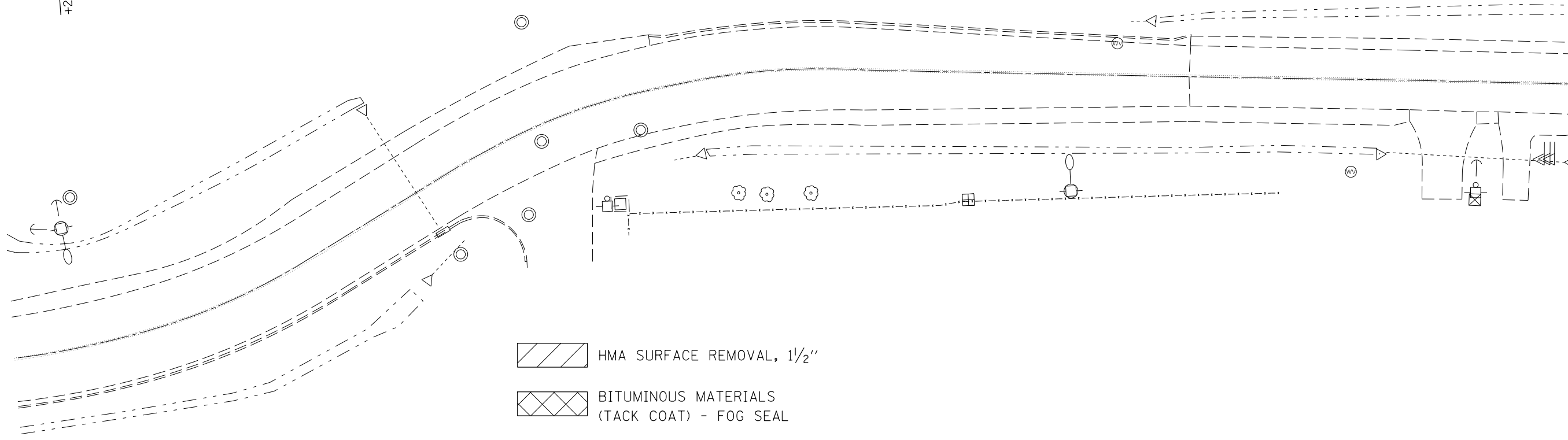
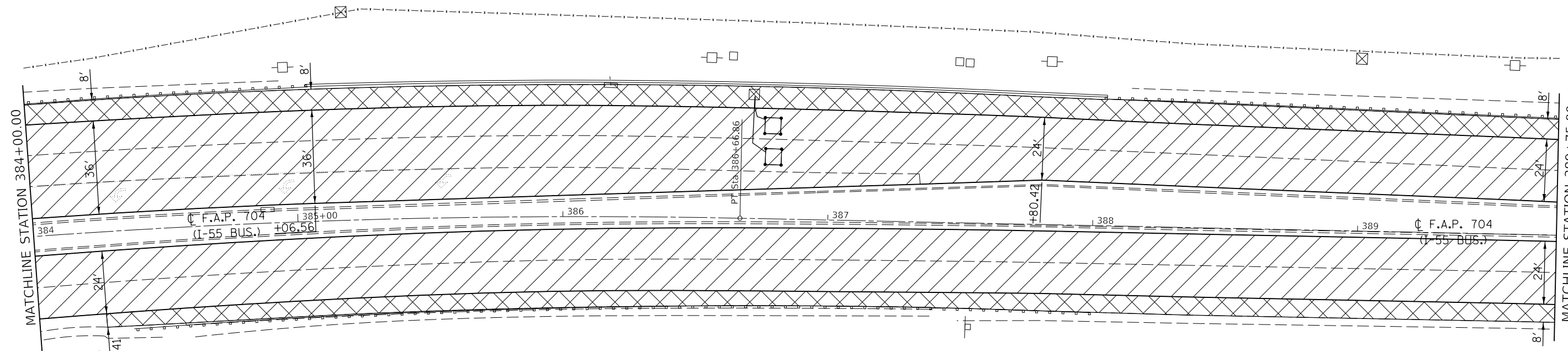

- HMA SURFACE REMOVAL, 1/2"
- BITUMINOUS MATERIALS (TACK COAT) - FOG SEAL

MODEL: \\MODEL\MARF
 FILE: MARF_Plan.dwg
 S:\Projects\0570E04\CADD\Drawings\CADD\Drawings\0570E04-Plan.dwg

USER NAME = hoganbj	DESIGNED -	REVISED -
PLOT SCALE = 40,0000 ' / in.	DRAWN -	REVISED -
PLOT DATE = 6/2/2019	CHECKED -	REVISED -
	DATE -	REVISED -

**STATE OF ILLINOIS
DEPARTMENT OF TRANSPORTATION**

PLAN SHEETS			
F.A.P. 704 (I-55 BUSINESS / VETERANS PARKWAY)			
SCALE: 1" = 20'	SHEET 5	OF 6 SHEETS	STA. 384+00.00 TO STA. 389+75.00

F.A.P. RTE. 704	SECTION (57-7)RS-2	COUNTY MCLEAN	TOTAL SHEETS 31	SHEET NO. 24
ILLINOIS FED. AID PROJECT			CONTRACT NO. 70E04	

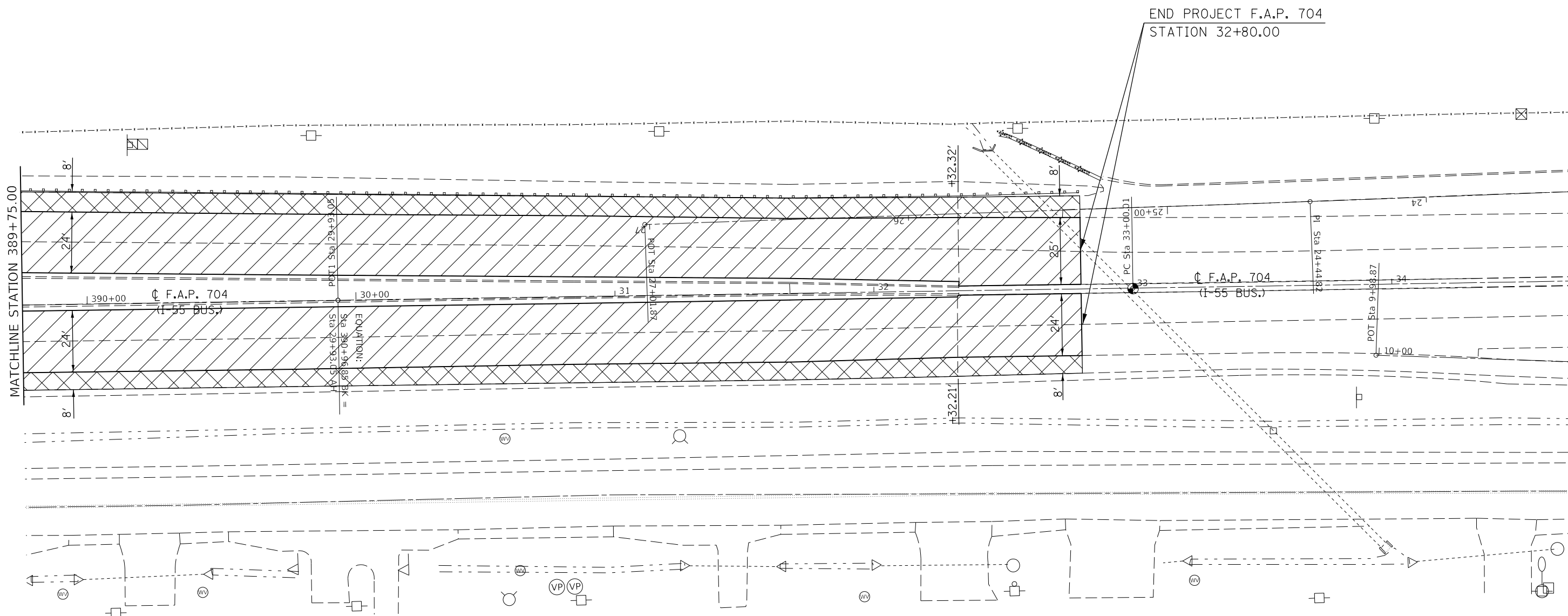
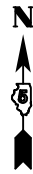

- HMA SURFACE REMOVAL, 1 1/2"
- BITUMINOUS MATERIALS (TACK COAT) - FOG SEAL

MODEL: I:\MODEL\NAME
 FILE: NAME.dwg
 S:\projects\70E04\CADD\Drawings\DOT\Office\Drawings\70E04\Drawings\70E04-Plan.dwg

USER NAME = hoganbj	DESIGNED -	REVISED -
PLOT SCALE = 40.0000 ' / in.	DRAWN -	REVISED -
PLOT DATE = 6/2/2019	CHECKED -	REVISED -
	DATE -	REVISED -

**STATE OF ILLINOIS
DEPARTMENT OF TRANSPORTATION**

PLAN SHEETS	
F.A.P. 704 (I-55 BUSINESS / VETERANS PARKWAY)	
SCALE: 1" = 20'	SHEET 6 OF 6 SHEETS STA. 389+75.00 TO STA. 34+00.00

F.A.P. RTE.	SECTION	COUNTY	TOTAL SHEETS	SHEET NO.
704	(57-7)RS-2	MCLEAN	31	25
CONTRACT NO. 70E04				
ILLINOIS FED. AID PROJECT				

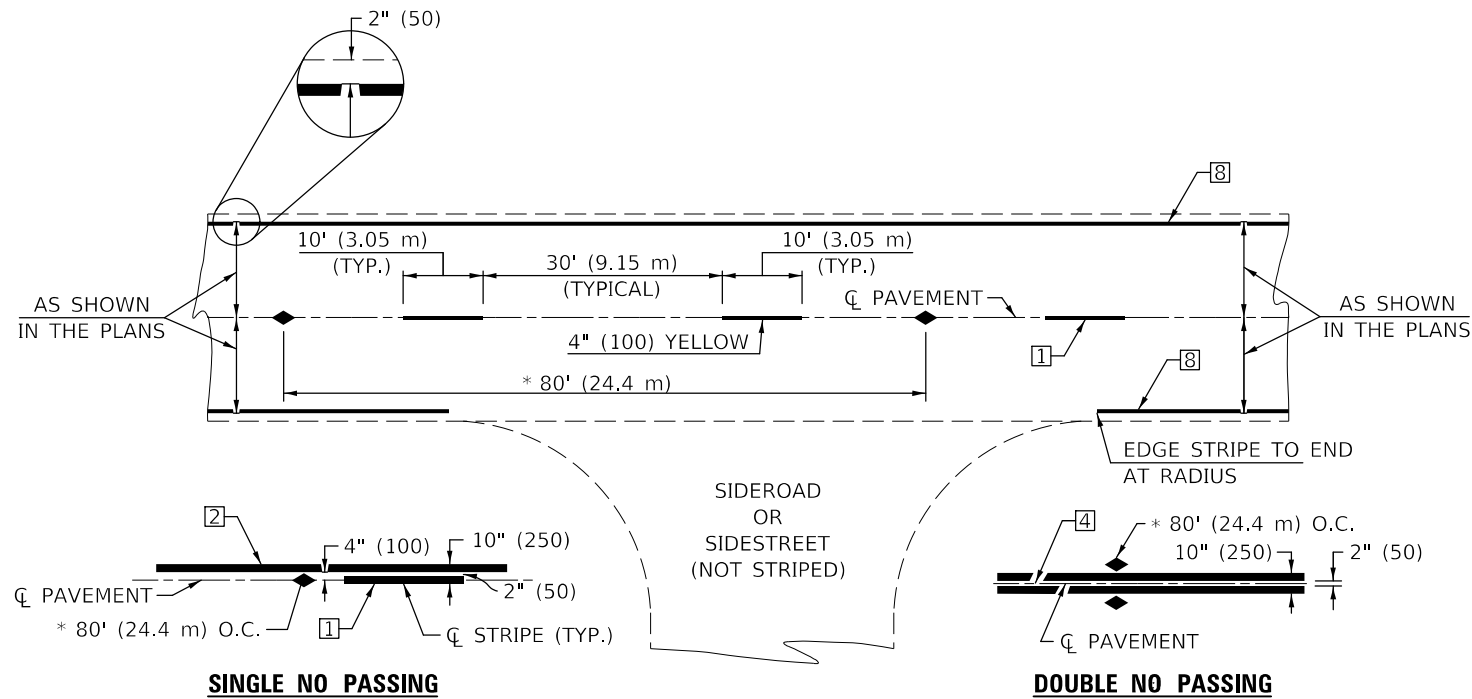

* REDUCE TO 40' (12.2 m) O.C. ON CURVES WITH POSTED OR ADVISORY SPEEDS OF 45 mph (70 km/h) OR LESS.

TWO LANE/TWO WAY

TYPICAL PAVEMENT MARKING LEGEND

- 1 4" (100) SKIP-DASH (YELLOW)
- 2 4" (100) SOLID (YELLOW)
- 3 12" (300) DIAGONAL (YELLOW)
- 4 4" (100) DOUBLE YELLOW (NARROW)
- 5 RESERVED
- 6 RESERVED
- 7 4" (100) SKIP-DASH (WHITE)
- 8 4" (100) SOLID (WHITE)
- 9 12" (300) DIAGONAL (WHITE)
- 10 6" (150) SOLID (WHITE)
- 11 24" (600) STOP BAR (WHITE)
- 12 8" (200) SOLID (WHITE)
- 13 4" (100) LANE LINE EXTENSIONS (WHITE)
- 14 4" (100) PARKING WHITE

TYPICAL PAVEMENT MARKERS LEGEND

- ◆ TWO-WAY AMBER MARKER
- ▶ ONE-WAY AMBER MARKER
- ▷ ONE-WAY CRYSTAL MARKER

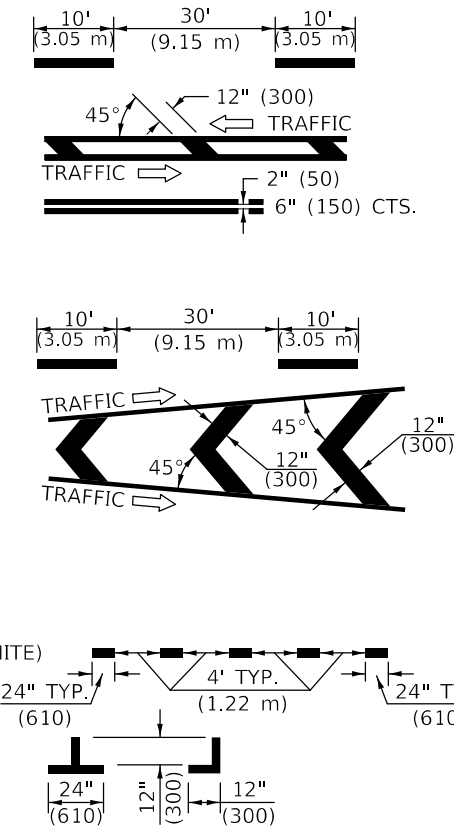

RURAL LEFT TURN

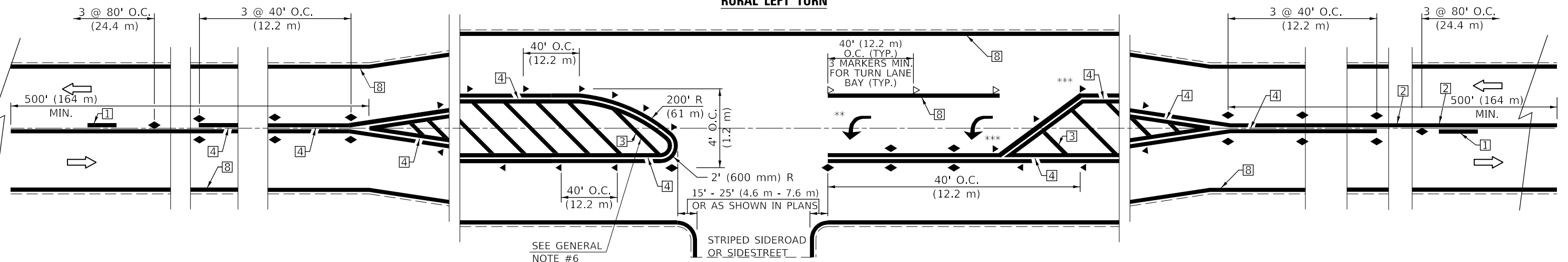

- *** REDUCE SPACING IF NECESSARY TO ASSURE MARKERS AT CORNER POINTS.
- ** TURN ARROWS SHALL BE PLACED AS SHOWN ON SHEET #2.

Note: All dimensions are in INCHES (millimeters) unless otherwise shown.

STATE OF ILLINOIS
DEPARTMENT OF TRANSPORTATION

PAVEMENT MARKING AND MARKERS
(RURAL & URBAN APPLICATIONS)

DISTRICT 5 DETAIL NO. 7800AAAA

USER NAME = hoganbj	DESIGNED -	REVISED - 11/06
	DRAWN -	REVISED - 9/2009 KJT
PLOT SCALE = 40,0000 ' / in.	CHECKED -	REVISED - 04/14 JLA
PLOT DATE = 6/2/2019	DATE -	REVISED - 3/2019 SWN

SCALE: SHEET 1 OF 4 SHEETS STA. TO STA.

F.A.P. RTE.	SECTION	COUNTY	TOTAL SHEETS	SHEET NO.
704	(57-7)RS-2	MCCLEAN	31	26
			CONTRACT NO. 70E04	
ILLINOIS FED. AID PROJECT				

MODEL: I:\MODEL\MAR15...
FILE: MAR15...
PROJECT: I:\PROJECTS\70E04\CADD\DATA\DOT\Office\Detail\5\Projects\70E04\CADD\DATA\DOT\Office\Detail\5\Projects\70E04\p1-detailed.dgn

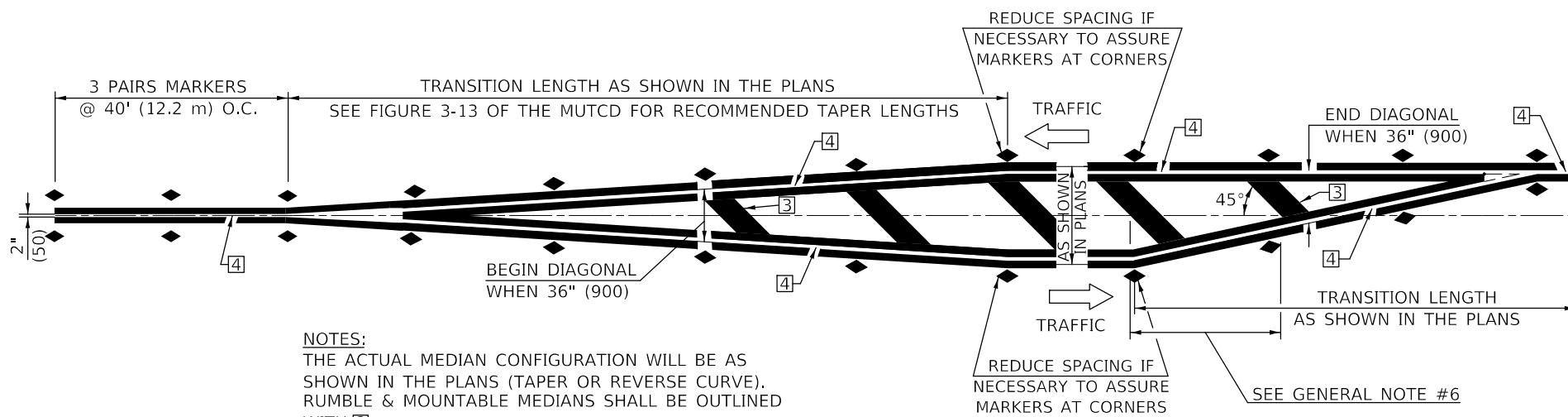

NOTES:
 THE ACTUAL MEDIAN CONFIGURATION WILL BE AS SHOWN IN THE PLANS (TAPER OR REVERSE CURVE). RUMBLE & MOUNTABLE MEDIANS SHALL BE OUTLINED WITH [2].

TYPICAL MEDIAN TRANSITIONS

GENERAL NOTES

1. WHEN MEDIANS ARE PRESENT, PAVEMENT MARKINGS ARE TO BE PLACED ADJACENT TO MEDIANS.
2. SOME OF THE INFORMATION INCLUDED WITH THIS DETAIL MAY NOT BE APPLICABLE TO THIS IMPROVEMENT.
3. PAVEMENT MARKINGS ARE TO BE EXTENDED THROUGH OMISSIONS WHEN APPLICABLE.
4. A STRIPING KEY IS AVAILABLE ELSEWHERE AND SHALL BE SHOWN WHERE THE QUANTITIES ARE LISTED.
5. FINAL PAVEMENT MARKINGS SHALL BE IN PLACE PRIOR TO PLACING ANY RAISED REFLECTIVE PAVEMENT MARKERS.
6. THE FOLLOWING CRITERIA SHALL BE USED FOR SELECTING THE DIAGONAL PAVEMENT MARKING SPACING,
 <30 MPH USE 15' (<50 km/h USE 4.5 m)
 30-45 MPH USE 20' (50-75 km/h USE 6.0 m)
 >45 MPH USE 30' (>75 km/h USE 9.0 m)

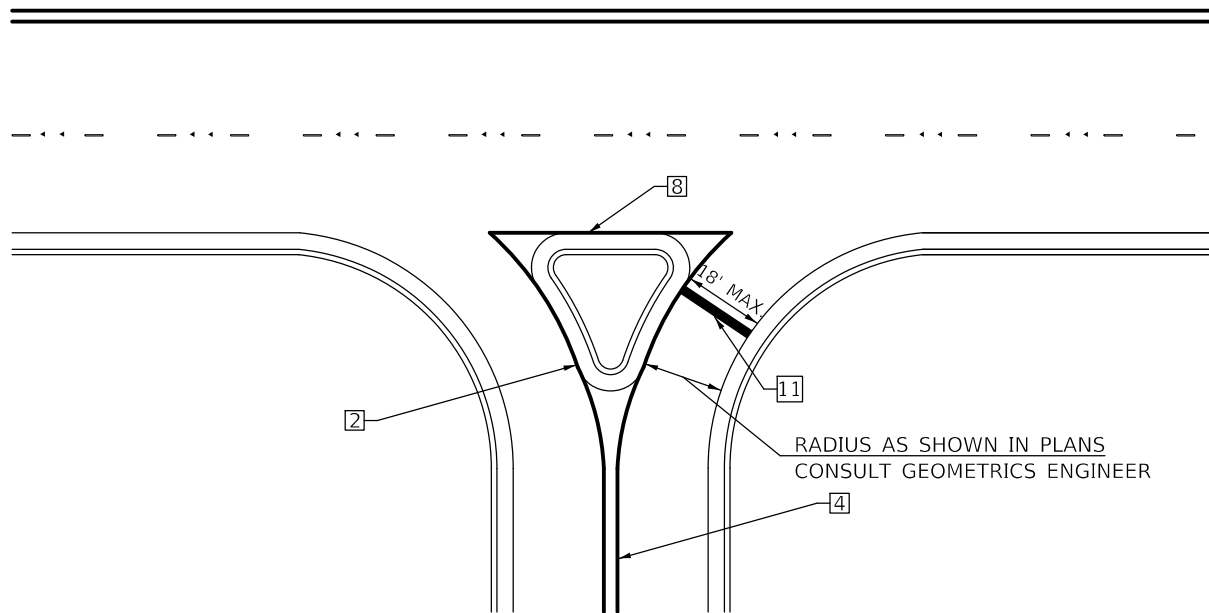

RIGHT IN - RIGHT OUT ACCESS

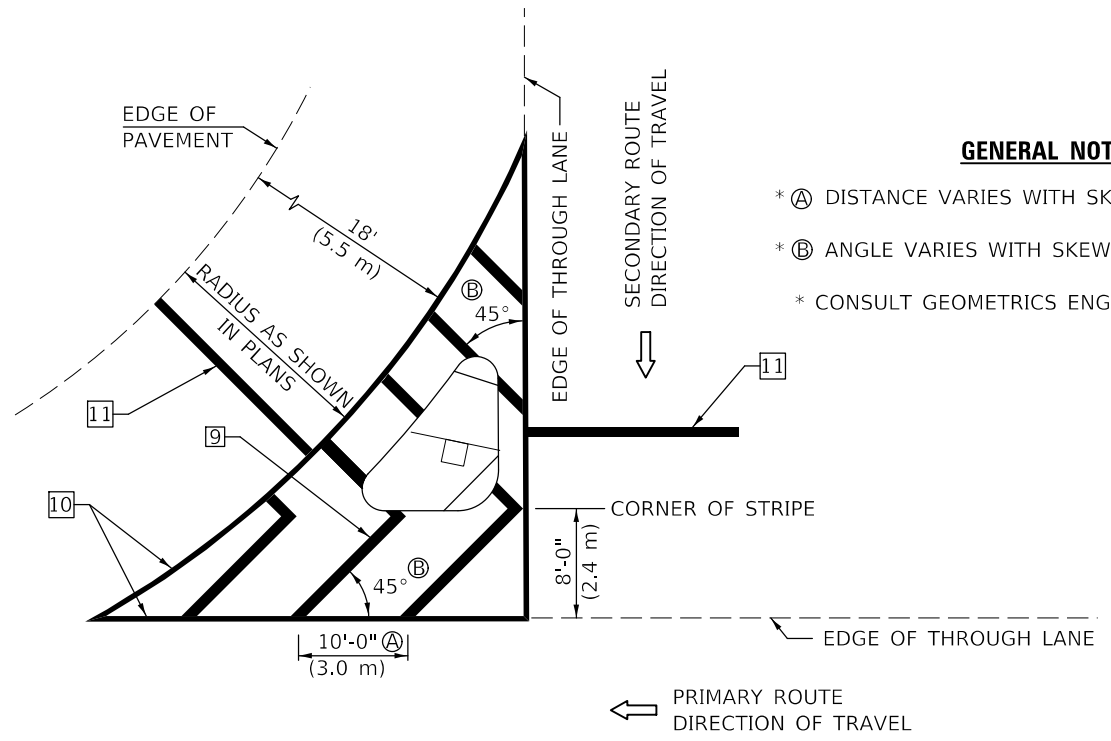

ISLAND

GENERAL NOTES

- * A DISTANCE VARIES WITH SKEW OF INTERSECTION.
- * B ANGLE VARIES WITH SKEW OF INTERSECTION.
- * CONSULT GEOMETRICS ENGINEER

Note: All dimensions are in INCHES (millimeters) unless otherwise shown.

MODEL: s:\MODEL\MAR15...
 FILE: MAR15...
 PROJECT: s:\PROJECTS\0570E04\CADD\DATA\CAD\PROJECTS\0570E04-RT-DETAILED.dgn
 OFFICE: IDOT - OFFICE OF DESIGN
 DATE: 6/2/2019

USER NAME = hoganbj	DESIGNED -	REVISED - 11/06
PLOT SCALE = 40,0000 ' / in.	DRAWN -	REVISED - 9/2009 KJT
PLOT DATE = 6/2/2019	CHECKED -	REVISED - 04/14 JLA
	DATE -	REVISED - 3/2019 SWN

**STATE OF ILLINOIS
 DEPARTMENT OF TRANSPORTATION**

**PAVEMENT MARKING AND MARKERS
 (RURAL & URBAN APPLICATIONS)**

SCALE: SHEET 3 OF 4 SHEETS STA. TO STA.

DISTRICT 5 DETAIL NO. 7800AAAA				
F.A.P. RTE.	SECTION	COUNTY	TOTAL SHEETS	SHEET NO.
704	(57-7)RS-2	MCLEAN	31	28
			CONTRACT NO. 70E04	
ILLINOIS FED. AID PROJECT				

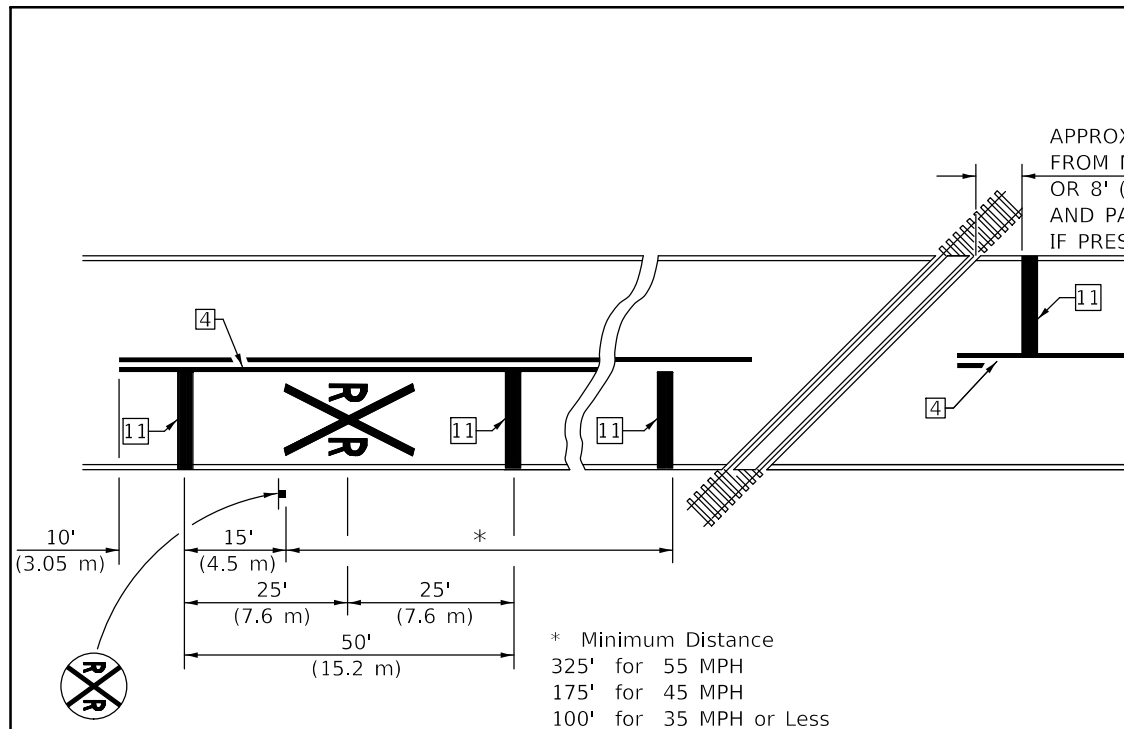

PAVEMENT MARKINGS AT RAILROAD-HIGHWAY GRADE CROSSING

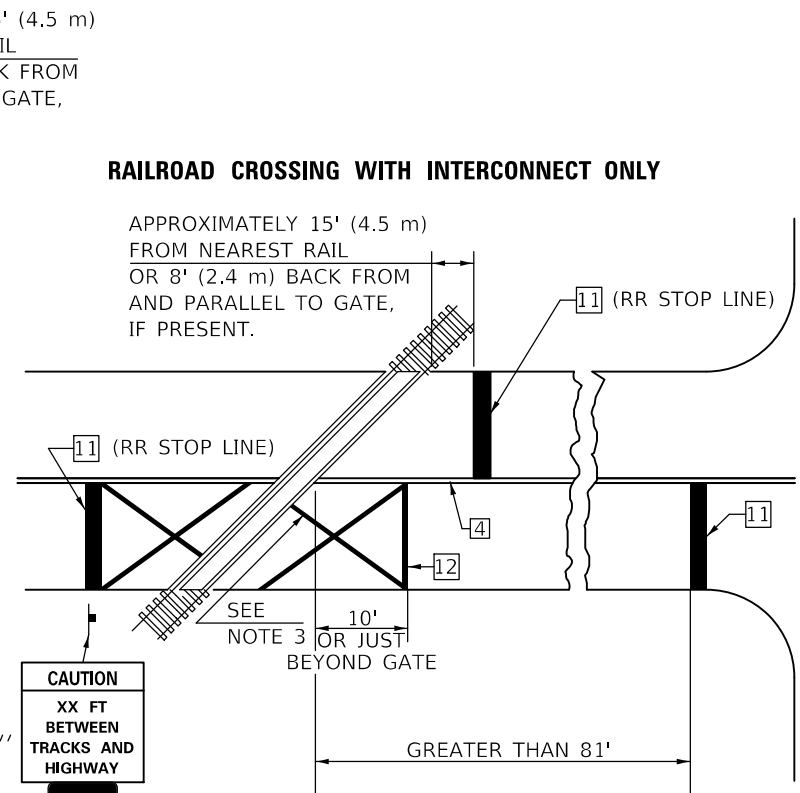

RAILROAD CROSSING WITH INTERCONNECT ONLY

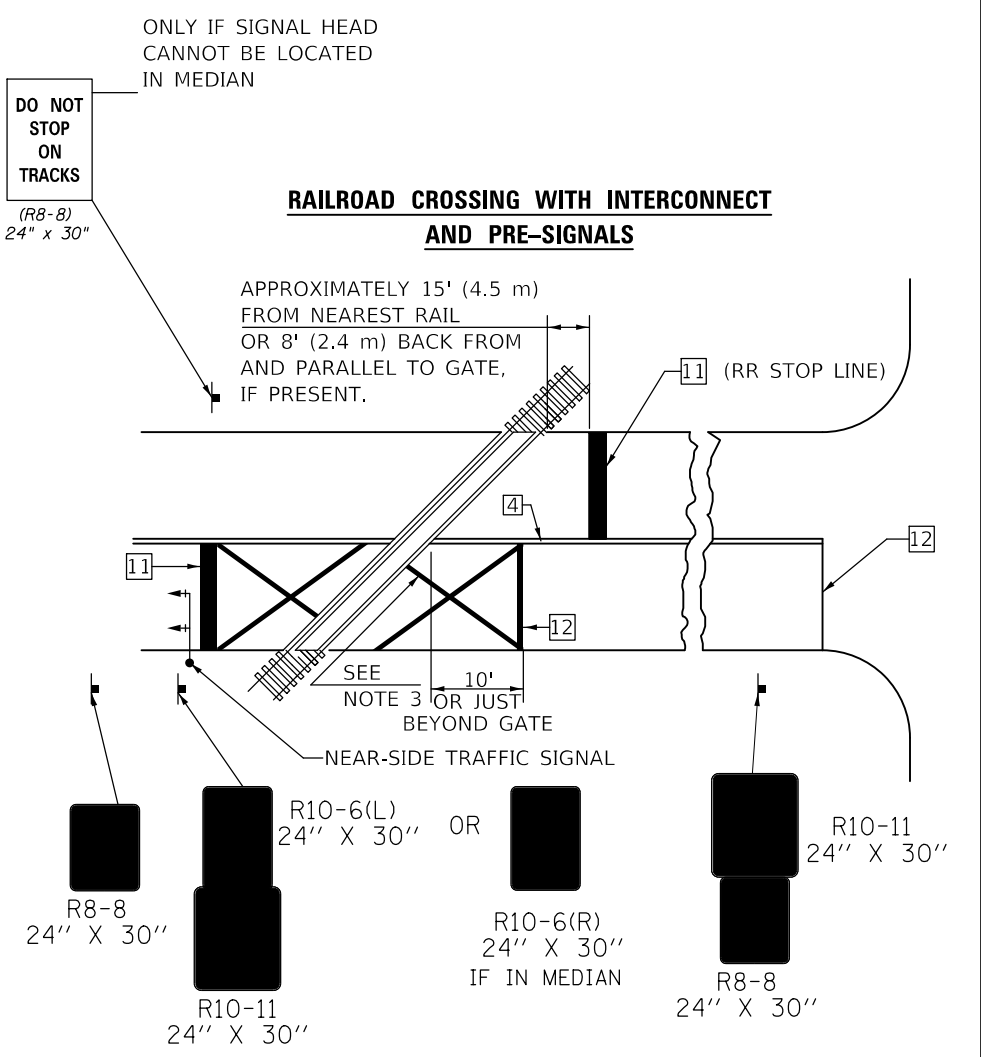

RAILROAD CROSSING WITH INTERCONNECT AND PRE-SIGNALS

GENERAL NOTES

1. SUPPLEMENTAL PAVEMENT MARKINGS TO BE INSTALLED ONLY ON APPROACHES TO INTERSECTIONS CONTROLLED BY TRAFFIC SIGNALS WHICH ARE INTERCONNECTED WITH THE RAILROAD WARNING SIGNALS.
2. EXTEND PAVEMENT MARKINGS TO THE INTERSECTION ONLY WHERE NEAR-SIDE TRAFFIC SIGNALS ARE USED.
3. 6" WHITE PAVEMENT MARKINGS AT 45° TO PAVEMENT, 8' CENTER TO CENTER.
4. XX DISTANCE TO BE SHOWN ON SIGN MEASURED FROM A POINT 6 FEET FROM THE RAIL CLOSEST TO THE INTERSECTION OR FROM THE CLOSEST POINT ALONG THE EXIT GATE IF PRESENT OVER THE ROADWAY WHEN IN THE LOWERED POSITION TO THE STOP BAR OR CROSSWALK, WHICH EVER IS CLOSEST, ROUNDED DOWN TO NEAREST 5 FEET. WHERE THERE IS NO STOP LINE, MEASURE TO POINT WHERE DRIVER HAS A VIEW OF APPROACHING TRAFFIC.
5. THE CLEARANCE SIGN IS ALSO TO BE USED AS AN INTERIM MEASURE AT LOCATIONS WITH INTERCONNECTED INTERSECTION TRAFFIC SIGNALS WHERE IT IS PLANNED TO CHANGE THEM TO NEAR-SIDE SIGNALS AT A FUTURE TIME. IN THIS CASE, THE DISTANCE TO BE SHOWN ON THE SIGN IS MEASURED FROM THE EDGE OF THE STRIPED-OUT AREA INSTEAD OF 6 FEET FROM THE RAIL. THE SIGN IS TO BE REMOVED WHEN THE NEAR-SIDE SIGNALS ARE INSTALLED AND THE PAVEMENT MARKINGS EXTENDED TO THE INTERSECTION.

SUPPLEMENTAL PAVEMENT MARKING TREATMENT FOR RAILROAD-HIGHWAY GRADE CROSSING

ALTERNATE SIGNS



NOTES

THE TRAVERSE SPREAD OF THE "X" MAY VARY ACCORDING TO LANE WIDTH.

ON MULTI-LANE ROADS, THE STOP LINES SHALL EXTEND ACROSS ALL APPROACH LANES AND SEPARATE RXR SYMBOLS SHALL BE PLACED ADJACENT TO EACH OTHER IN EACH LANE.

WHEN THE PAVEMENT MARKING SYMBOL IS USED, A PORTION OF THE SYMBOL SHOULD BE LOCATED DIRECTLY ADJACENT TO THE ADVANCE WARNING SIGN (W10-1) AS PLACED BY TABLE II-1, CONDITION B OF THE MUTCD.

Note: All dimensions are in INCHES (millimeters) unless otherwise shown.

DISTRICT 5 DETAIL NO. 7800AAAA

MODEL: I:\MODEL\MARF... FILE NAME: P:\pub\mcom\ma_data\illinois\poc\p\WIDDOT\Documents\DOT_Offices\Detail\5\Projects\0570E04\CADD\data\CAD\poc\0570E04-rt-detailed.dgn

USER NAME = hoganbj	DESIGNED -	REVISED - 11/06
	DRAWN -	REVISED - 9/2009 KJT
PLOT SCALE = 40,0000 ' / in.	CHECKED -	REVISED - 04/14 JLA
PLOT DATE = 6/2/2019	DATE -	REVISED - 3/2019 SWN

**STATE OF ILLINOIS
DEPARTMENT OF TRANSPORTATION**

**PAVEMENT MARKING AND MARKERS
(RURAL & URBAN APPLICATIONS)**

SCALE: SHEET 4 OF 4 SHEETS STA. TO STA.

F.A.P. RTE.	SECTION	COUNTY	TOTAL SHEETS	SHEET NO.
704	(57-7)RS-2	MCLEAN	31	29
CONTRACT NO. 70E04			ILLINOIS FED. AID PROJECT	

