

STATE OF ILLINOIS
DEPARTMENT OF TRANSPORTATION

F.A.P. RTE	SECTION	COUNTY	TOTAL SHEETS	SHEET NO
820	(27,27-1,37-2)RS-2	COLES	15	1
		ILLINOIS	CONTRACT NO 74718	

FOR INDEX OF SHEETS, SEE SHEET NO. 2

PROPOSED HIGHWAY PLANS

F.A.P. ROUTE 820 (IL 130)
SECTION (27,27-1,37-2)RS-2
PROJECT STP KALA(883)
3P RESURFACING
COLES COUNTY

C-97-081-19

ADT = 2,300 (2017)



PROJECT ENDS
STA 109 + 35

STATION EQUATION
756 + 46(BK) = 100 + 00(AH)

STATION EQUATION
116 + 00(BK) = 608 + 00(AH)

OMISSION
STA 61 + 19 TO
STA 61 + 81

PROJECT BEGINS
STA 9 + 60

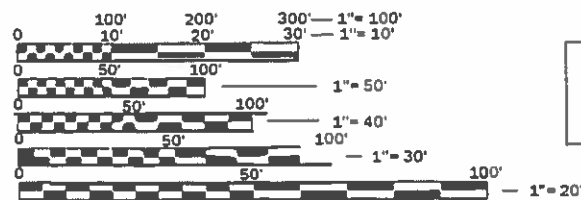
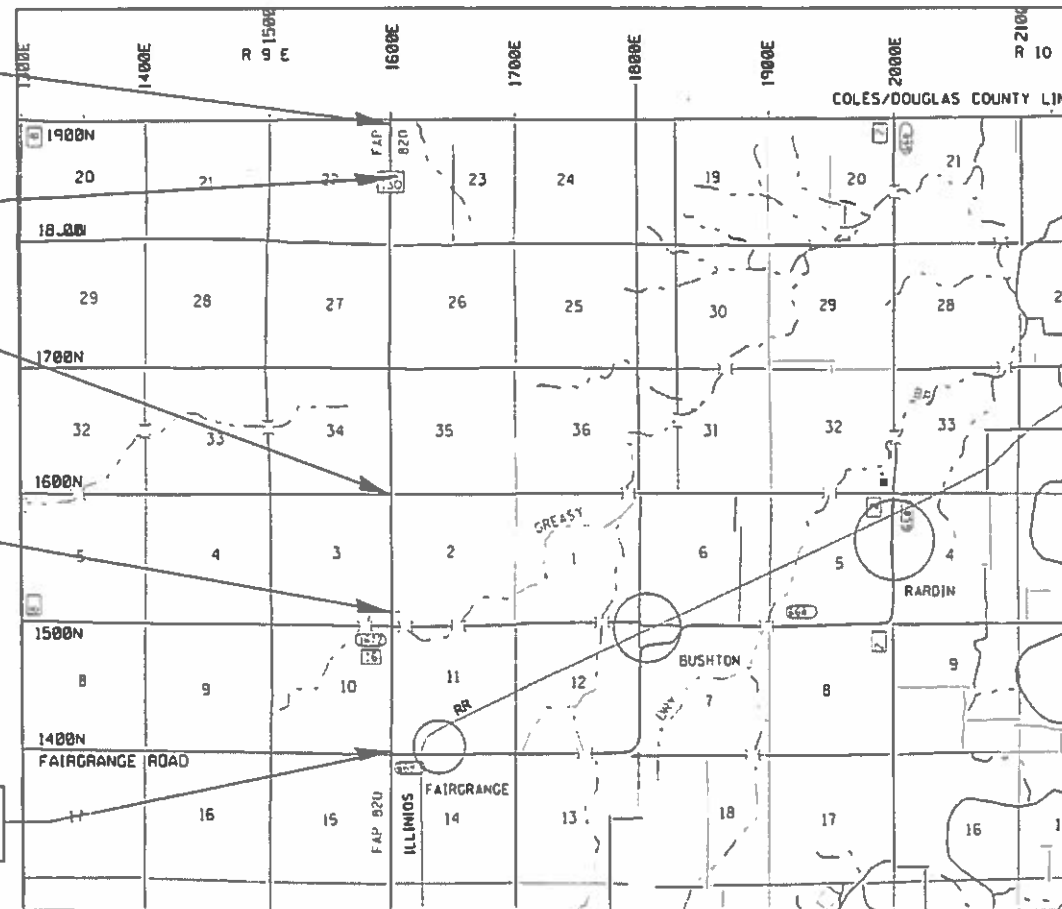

FULL SIZE PLANS HAVE BEEN PREPARED USING STANDARD ENGINEERING SCALES. REDUCED SIZED PLANS WILL NOT CONFORM TO STANDARD SCALES. IN MAKING MEASUREMENTS ON REDUCED PLANS, THE ABOVE SCALES MAY BE USED.

J.U.L.I.E.
JOINT UTILITY LOCATION INFORMATION FOR EXCAVATION
1-800-892-0123
OR 811

PROJECT ENGINEER: BRIAN LEWIS
PROJECT MANAGER: ANDREW DETERS

CONTRACT NO. 74718

GROSS LENGTH = 26,421 FT. = 5.004 MILE
NET LENGTH = 26,359 FT. = 4.992 MILE

STATE OF ILLINOIS
DEPARTMENT OF TRANSPORTATION

SUBMITTED May 31 2019
Jeffrey P. Meyer
REGIONAL ENGINEER

June 14 2019
[Signature]
ENGINEER OF DESIGN AND ENVIRONMENT

June 14 2019
[Signature]
DIRECTOR HIGHWAYS PROJECT IMPLEMENTATION

PRINTED BY THE AUTHORITY
OF THE STATE OF ILLINOIS

GENERAL NOTES

THE PROPOSED PROJECT IS LOCATED ON IL 130 FROM FAIRGRANGE ROAD TO THE COLES/DOUGLAS COUNTY LINE IN COLES COUNTY.

THE WORK INCLUDED IN SECTION (27.27-1.37-2)RS-2 CONSISTS OF PATCHING, HMA SURFACE REMOVAL, HMA RESURFACING, SHOULDER RUMBLE STRIPS, AGGREGATE SHOULDERS, PAINT PAVEMENT MARKING, RAISED REFLECTIVE PAVEMENT MARKERS, PROTECTING OR RESETTING SURVEY MARKERS, SURVEY MARKER VAULTS, AND OTHER NECESSARY WORK TO COMPLETE THE SECTION.

HMA SHOULDERS ARE TO BE PAVED IN CONJUNCTION WITH HMA LEVEL BINDER AND SURFACE COURSES.

MATERIAL FOR AGGREGATE SHOULDERS TYPE B, SHALL BE CRUSHED STONE OR CRUSHED CONCRETE.

MATERIAL FOR AGGREGATE SURFACE COURSE, TYPE B SHALL BE CRUSHED STONE, OR CRUSHED CONCRETE.

SHORT TERM PAVEMENT MARKING APPLIED TO ANY MILLED SURFACE SHALL BE PAINT AND THOSE APPLIED TO THE HMA COURSES SHALL BE TAPE.

QUANTITIES FOR PAINT PAVEMENT MARKING - LINE 4" CONSISTS OF 6,591 FEET OF YELLOW AND 52,318 OF WHITE.

THE FOLLOWING MIXTURE REQUIREMENTS ARE APPLICABLE FOR THIS PROJECT:

APPLICATION	AC/PG	DESIGN AIR VOIDS	MIXTURE COMPOSITION	FRICTION AGGREGATE	QUALITY MANAGEMENT
LEVELING BINDER	PG 64-22	4.0% ϕ Ndesign=70	IL - 9.5FC	N/A	QCP
SURFACE COURSE	PG 64-22	4.0% ϕ Ndesign=70	IL - 9.5	MIXTURE C	PFP
INCIDENTAL SURFACE	PG 64-22	4.0% ϕ Ndesign=70	IL - 9.5	MIXTURE C	QC/OA
CLASS D PATCHING	PG 64-22	4.0% ϕ Ndesign=70	IL - 19.0	N/A	QC/OA

INDEX OF SHEETS

SHEET NO.	ITEM
1	COVER SHEET
2	INDEX OF SHEETS & GENERAL NOTES
3	SUMMARY OF QUANTITIES
4	TYPICAL SECTIONS
5-6	SCHEDULES OF QUANTITIES
7	ENTRANCE SCHEDULE
8	SURVEY TIES
9	PLAN SHEET
10	DETAILS
11-14	PAVEMENT MARKING DETAILS
15	SURVEY MARKER VAULT DETAIL

THE FOLLOWING STANDARDS ARE A PART OF THESE PLANS AND ARE INCLUDED FOLLOWING THE LAST NUMBERED SHEET OF THE PLANS.

- 406201-01 MAILBOX TURNOUT
- 442201-03 CLASS C AND D PATCHES
- 642006 SHOULDER RUMBLE STRIPS, 8 IN.
- 630001-12 STEEL PLATE BEAM GUARDRAIL
- 630106-02 LONG SPAN GUARDRAIL OVER CULVERT
- 701006-05 OFF-ROAD OPERATIONS, 2L, 2W, 15' TO 24' FROM PAVEMENT EDGE
- 701201-05 LANE CLOSURE, 2L, 2W, DAY ONLY, FOR SPEEDS >= 45 MPH
- 701301-04 LANE CLOSURE, 2L, 2W, SHORT TIME OPERATIONS
- 701306-04 LANE CLOSURE, 2L, 2W, SLOW MOVING OPERATIONS DAY ONLY, FOR SPEEDS >= 45 MPH
- 701311-03 LANE CLOSURE, 2L, 2W, MOVING OPERATIONS - DAY ONLY
- 701901-08 TRAFFIC CONTROL DEVICES
- 630301-09 SHOULDER WIDENING FOR TYPE I (SPECIAL) GUARDRAIL TERMINALS
- 782006 GUARDRAIL AND BARRIER WALL REFLECTOR MOUNTING DETAILS

REV. - MS

FILE NAME =	USER NAME = Default	DESIGNED =	REVISED =	STATE OF ILLINOIS DEPARTMENT OF TRANSPORTATION	INDEX OF SHEETS & GENERAL NOTES	F.A.P. RTE.	SECTION	COUNTY	TOTAL SHEETS	SHEET NO.
pw:\p\planroom.ctb	Illinois.gov	DRAWN	REVISED			820	(27.27-1.37-2)RS-2	COLES	15	2
Default	6/13/2019	CHECKED	REVISED			CONTRACT NO. 74718		ILLINOIS FED AID PROJECT		

80% FED
20% STATE

80% FED
20% STATE

SUMMARY OF QUANTITIES			TOTAL QUANTITIES	CONSTRUCTION TYPE CODE		
CODE NO	ITEM	UNIT		0005		
40200800	AGGREGATE SURFACE COURSE, TYPE B	TON	9	9		
40600290	BITUMINOUS MATERIALS (TACK COAT)	POUND	59280	59280		
40600637	LEVELING BINDER (MACHINE METHOD), 1L-9.5FG, N70	TON	8158	8158		
40600990	TEMPORARY RAMP	SO YD	88	88		
40603315	HOT-MIX ASPHALT SURFACE COURSE, MIX "C", N70	TON	9841	9841		
40800050	INCIDENTAL HOT-MIX ASPHALT SURFACING	TON	63	63		
44000155	HOT-MIX ASPHALT SURFACE REMOVAL, 1 1/2"	SO YD	87732	87732		
44201823	CLASS D PATCHES, TYPE I, 15 INCH	SO YD	5	5		
44201827	CLASS D PATCHES, TYPE II, 15 INCH	SO YD	1504	1504		
44201831	CLASS D PATCHES, TYPE III, 15 INCH	SO YD	51	51		
44201833	CLASS D PATCHES, TYPE IV, 15 INCH	SO YD	154	154		
48101200	AGGREGATE SHOULDERS, TYPE B	TON	4305	4305		
64200108	SHOULDER RUMBLE STRIPS, 8 INCH	FOOT	41482	41482		
67000500	ENGINEER'S FIELD OFFICE, TYPE B	CAL MO	6	6		

SUMMARY OF QUANTITIES			TOTAL QUANTITIES	CONSTRUCTION TYPE CODE		
CODE NO	ITEM	UNIT		0005		
* 63000003	STEEL PLATE BEAM GUARDRAIL, TYPE A, 9 FOOT POSTS	FOOT	287.5	287.5		
67100100	MOBILIZATION	LSUM	1	1		
* 63000360	LONG-SPAN GUARDRAIL OVER CULVERT, 18 FT 9 IN SPAN	FOOT	87.5	87.5		
70100450	TRAFFIC CONTROL AND PROTECTION, STANDARD 701201	LSUM	1	1		
63200310	GUARDRAIL REMOVAL	FOOT	375	375		
70100460	TRAFFIC CONTROL AND PROTECTION, STANDARD 701306	LSUM	1	1		
70107025	CHANGEABLE MESSAGE SIGN	CAL DA	28	28		
70300100	SHORT TERM PAVEMENT MARKING	FOOT	7909	7909		
70300150	SHORT TERM PAVEMENT MARKING REMOVAL	SO FT	879	879		
70300220	TEMPORARY PAVEMENT MARKING - LINE 4"	FOOT	58909	58909		
* 78001110	PAINT PAVEMENT MARKING - LINE 4"	FOOT	58909	58909		
* 78100100	RAISED REFLECTIVE PAVEMENT MARKER	EACH	330	330		
* 78200005	GUARDRAIL REFLECTORS, TYPE A	EACH	4	4		
X0326440	SURFACE REMOVAL, VARIABLE DEPTH (SPECIAL)	SO YD	535	535		
* X6330227	VERTICAL ADJUSTMENT OF TRAFFIC BARRIER TERMINAL, TYPE 1	EACH	4	4		
Z0033700	LONGITUDINAL JOINT SEALANT	FOOT	26359	26359		
Z0049799	PROTECTING OR RESETTING SURVEY MARKERS	EACH	4	4		
Z0070202	SURVEY MARKER VAULT	EACH	3	3		

* SPECIALTY ITEM

REV. - MS

MODEL: Default
 FILE: \\niles.pw\pub\barcom.dwg
 ILLINOIS GOV. PW\DOT\Documents\DOT_Offices\District 7\Projects\74718\CADDData\CAD\sheet\74718-ph-500.dgn

USER NAME = steffenmk	DESIGNED -	REVISED -
	DRAWN -	REVISED -
PLOT SCALE = 100.0000' / in.	CHECKED -	REVISED -
PLOT DATE = 5/31/2019	DATE -	REVISED -

STATE OF ILLINOIS
DEPARTMENT OF TRANSPORTATION

SCALE: SHEET OF SHEETS STA. TO STA.

F.A.P. RTE.	SECTION	COUNTY	TOTAL SHEETS	SHEET NO.
820	*	COLES	15	3
CONTRACT NO. 74718				
ILLINOIS FED. AID PROJECT				

*(27.27-1,37-2)RS-2

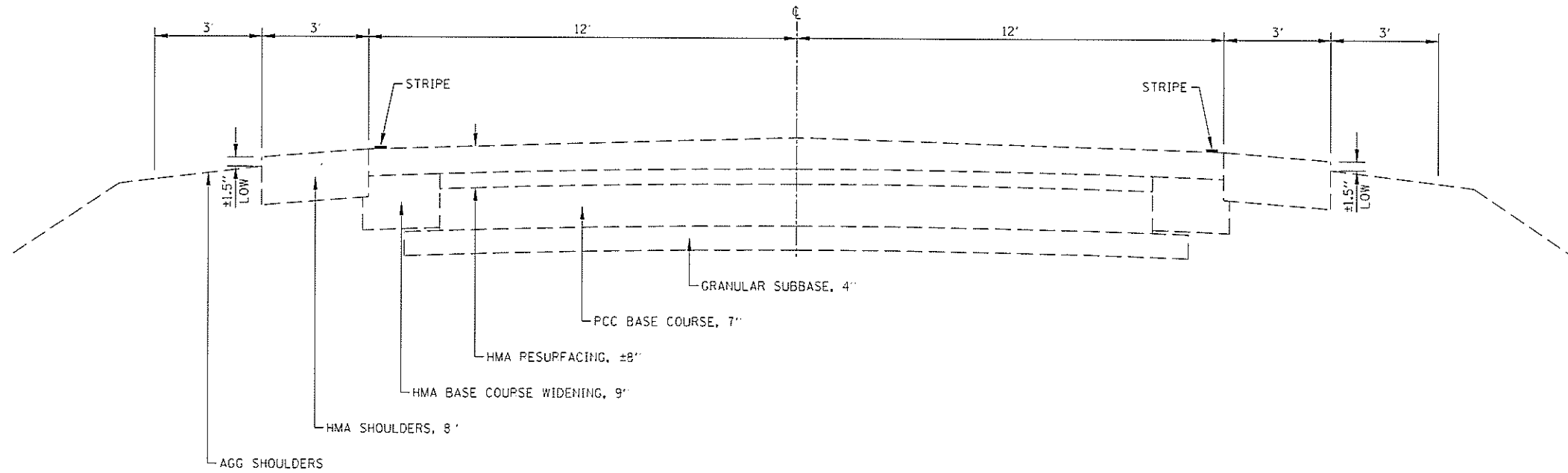

EXISTING
 STA. 9+60 - STA. 61+19
 STA. 61+19 - STA. 61+81 - BRIDGE OMISSION
 STA. 61+81 - STA. 116+00(BK)
 STA. 608+00(AH) - STA. 756+46(BK)
 STA. 100+00(AH) - STA. 109+35

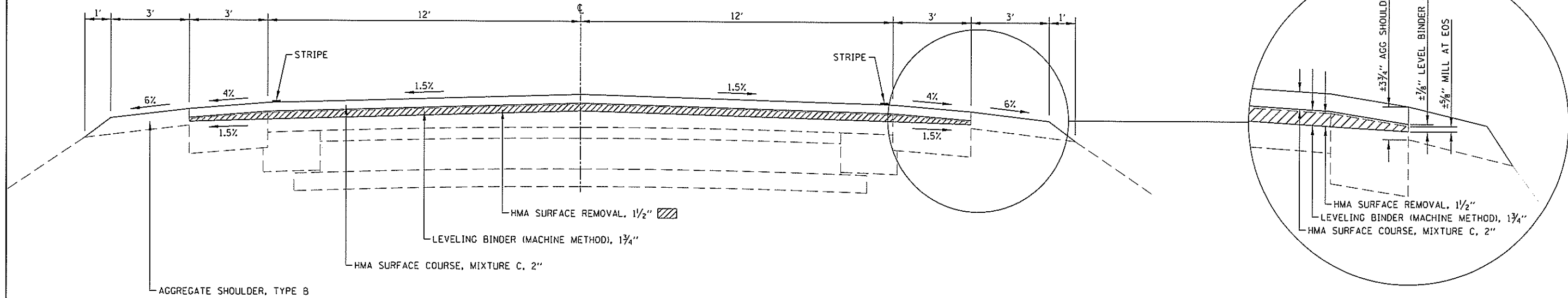

PROPOSED
 STA. 9+60 - STA. 61+19
 STA. 61+19 - STA. 61+81 - BRIDGE OMISSION
 STA. 61+81 - STA. 116+00(BK)
 STA. 608+00(AH) - STA. 756+46(BK)
 STA. 100+00(AH) - STA. 109+35

FILE NAME =	USER NAME = Default	DESIGNED -	REVISED -
pvc\planroom.dcl\illinois.gov\FWIDOT\Documents\DOT	Office\District 7\Projects\74694\CADD\Design\74694-Design	DRAWN -	REVISED -
Default	PLOT SCALE = 4 0000 1/2 in.	CHECKED -	REVISED -
	PLOT DATE = 6/13/2019	DATE -	REVISED -

STATE OF ILLINOIS
 DEPARTMENT OF TRANSPORTATION

TYPICAL SECTIONS

SCALE: SHEET OF SHEETS STA. TO STA.

F.A.P. RTE.	SECTION	COUNTY	TOTAL SHEETS	SHEET NO.
820	(27.27-1.37-2)RS-2	COLES	15	4
CONTRACT NO. 74718				

PAVING SCHEDULE

STATION	TO	STATION	LENGTH	WIDTH	AREA	HOT-MIX ASPHALT SURFACE REMOVAL, 1 1/2"	BITUMINOUS MATERIAL (TACK COAT)	LEVELING BINDER (MACHINE METHOD), IL-9.5FG, N70	LONGITUDINAL JOINT SEALANT	HOT-MIX ASPHALT SURFACE COURSE, MIX "C" N70
			FOOT	FOOT	SO YD	SO YD	POUNDS	TONS	FOOT	TONS
9+60		10+05	45	30	150	117	94	6	45	17
10+05		60+74	5069	30	16897	16897	11405	1576	5069	1892
60+74		61+19	45	30	150	117	94	6	45	17
61+81		62+26	45	30	150	117	94	6	45	17
62+26		116+00	5374	30	17913	17913	12092	1671	5374	2006
608+00		756+46	14846	30	49487	49487	33404	4608	14846	5543
100+00		108+90	890	30	2967	2967	2003	279	890	332
108+90		109+35	45	30	150	117	94	6	45	17
TOTALS			26359		87864	87732	59280	8158	26359	9841

* 0.05 LBS/SO FT ON MILLED SURFACE & 0.025 LBS/SO FT ON LEVEL BINDER SURFACE - RATE CALCS FOR BITUMINOUS MATERIALS (TACK COAT)

SHOULDER SCHEDULE

STATION	TO	STATION	LENGTH	PRA/MBT/ENTRANCE DEDUCT	SHOULDER RUMBLE STRIP, 8 INCH	AGGREGATE SHOULDER, TYPE B
			FOOT	FOOT	FOOT	TON
9+60		61+19	5159	179	8111	842
61+81		116+00	5419	176	8530	885
608+00		756+46	14846	511	23345	2423
100+00		109+35	935	0	1496	155
TOTALS			26359	866	41482	4305

PAVEMENT MARKING SCHEDULE

STATION	TO	STATION	LENGTH	SHORT TERM PAVEMENT MARKING (YELLOW)	SHORT TERM PAVEMENT MARKING REMOVAL	PAINT PAVEMENT MARKING LINE 4" (WHITE)	PAINT PAVEMENT MARKING LINE 4" (YELLOW)	TEMPORARY PAVEMENT MARKING LINE 4" (WHITE)	TEMPORARY PAVEMENT MARKING LINE 4" (YELLOW)	RAISED REFLECTIVE PAVEMENT MARKERS (2 WAY AMBER)
			FOOT	FOOT	SO FT	FOOT	FOOT	FOOT	FOOT	EACH
9+60		61+19	5159	1548	172	10218	1290	10218	1290	64
61+81		116+00	5419	1626	181	10738	1355	10738	1355	68
608+00		756+46	14846	4454	495	29492	3712	29492	3712	186
100+00		109+35	935	281	31	1870	234	1870	234	12
TOTALS			26359	7909	879	52318	6591	52318	6591	330
						58909	58909			

SURVEY MARKER SCHEDULE

STATION	O/S	SURVEY POINT	PROTECTING OR RESETTING SURVEY MARKER	SURVEY MARKER VAULT
			EACH	EACH
115+95	1.8 RT	906	1	1
634+40	2.0 LT	905	1	1
660+75	13 LT	904	1	1
687+20	15.5 RT	903	1	0
TOTALS			4	3

TEMPORARY RAMP SCHEDULE

STATION	TO	STATION	LENGTH	WIDTH	TEMPORARY RAMP
			FOOT	FOOT	SO YD
9+60		9+66.6	6.6	30	22
61+12.4		61+19	6.6	30	22
61+81		61+87.6	6.6	30	22
109+28.4		109+35	6.6	30	22
TOTALS					88

GUARDRAIL SCHEDULE

STATION	TO	STATION	GUARDRAIL REMOVAL	STEEL PLATE BEAM GUARDRAIL, TYPE A, 9 FOOT POST	LONG-SPAN GUARDRAIL OVER CULVERT, 18FT 9IN SPAN	VERTICAL ADJUSTMENT OF TRAFFIC BARRIER TERMINAL, TYPE 1	GUARDRAIL REFLECTORS, TYPE A
			FOOT	FOOT	SO YD	SO YD	POUNDS
SOUTHBOUND							
650+17.15		650+67.15	-	-	-	1	-
650+67.15		651+01.53	34.38	34.38	-	-	1
651+01.53		651+45.28	43.75	-	43.75	-	-
651+45.28		652+54.65	109.38	109.38	-	-	1
652+54.65		653+04.65	-	-	-	1	-
SOUTHBOUND TOTALS			187.5	143.75	43.75	2	2
NORTHBOUND							
649+42.15		649+92.15	-	-	-	1	-
649+92.15		651+01.53	109.38	109.38	-	-	1
651+01.53		651+45.28	43.75	-	43.75	-	-
651+45.28		651+79.65	34.38	34.38	-	-	1
651+79.65		652+29.65	-	-	-	1	-
NORTHBOUND TOTALS			187.5	143.75	43.75	2	2
TOTALS			375	287.5	87.5	4	4

CLASS D PATCHES (SOUTHBOUND LANE)						
STATION	LENGTH (FOOT)	WIDTH (FOOT)	TYPE I, 15 INCH (SQ YD)	TYPE II, 15 INCH (SQ YD)	TYPE III, 15 INCH (SQ YD)	TYPE IV, 15 INCH (SQ YD)
10+00	LT	8.0	12	10.7		
10+78	LT	6.0	12	8.0		
11+26	LT	4.0	12	5.3		
11+80	LT	4.0	12	5.3		
20+60	LT	14.0	12		18.7	
22+64	LT	6.0	12	8.0		
25+78	LT	4.0	12	5.3		
37+21	LT	8.0	12	10.7		
39+78	LT	8.0	12	10.7		
40+51	LT	6.0	12	8.0		
44+29	LT	6.0	12	8.0		
45+65	LT	7.0	12	9.3		
46+66	LT	4.0	12	5.3		
47+84	LT	6.0	12	8.0		
52+94	LT	5.0	12	6.7		
54+38	LT	6.0	12	8.0		
62+60	LT	8.0	12	10.7		
64+06	LT	4.0	12	5.3		
70.98	LT	7.0	12	9.3		
77+20	LT	12.0	12		16.0	
78+38	LT	4.0	12	5.3		
84+64	LT	7.0	12	9.3		
85+04	LT	4.0	12	5.3		
89+30	LT	7.0	12	9.3		
96+16	LT	5.0	12	6.7		
103+61	LT	8.0	12	10.7		
106+74	LT	4.0	12	5.3		
111+47	LT	9.0	12	12.0		
113+54	LT	8.0	12	10.7		
608+11	LT	8.0	12	10.7		
608+19	LT	7.0	6.0	4.7		
610+96	LT	9.0	12	12.0		
614+48	LT	5.0	12	6.7		
616+05	LT	5.0	12	6.7		
617+25	LT	7.0	12	9.3		
619+30	LT	4.0	12	5.3		
620+52	LT	10.0	12	13.3		
622+23	LT	6.0	12	8.0		
623+83	LT	4.0	12	5.3		
625+96	LT	6.0	12	8.0		
626+87	LT	5.0	12	6.7		
628+34	LT	5.0	12	6.7		
630+45	LT	5.0	12	6.7		
632+88	LT	7.0	12	9.3		
634+06	LT	6.0	12	8.0		
635+36	LT	6.0	12	8.0		
638+53	LT	6.0	12	8.0		
640+56	LT	5.0	12	6.7		
646+26	LT	4.0	12	5.3		
649+41	LT	7.0	12	9.3		
651+63	LT	5.0	12	6.7		
653+47	LT	4.0	12	5.3		
658+44	LT	7.0	12	9.3		
COLUMN TOTALS			4.7	398.5	34.7	0.0

CLASS D PATCHES (SOUTHBOUND LANE)						
STATION	LENGTH (FOOT)	WIDTH (FOOT)	TYPE I, 15 INCH (SQ YD)	TYPE II, 15 INCH (SQ YD)	TYPE III, 15 INCH (SQ YD)	TYPE IV, 15 INCH (SQ YD)
661+19	LT	5.0	12	6.7		
663+13	LT	4.0	12	5.3		
665+31	LT	5.0	12	6.7		
668+74	LT	6.0	12	8.0		
670+48	LT	7.0	12	9.3		
672+53	LT	4.0	12	5.3		
674+58	LT	6.0	12	8.0		
675+96	LT	5.0	12	6.7		
680+00	LT	5.0	12	6.7		
680+85	LT	5.0	12	6.7		
683+18	LT	5.0	12	6.7		
686+38	LT	5.0	12	6.7		
688+50	LT	4.0	12	5.3		
691+05	LT	6.0	12	8.0		
692+42	LT	6.0	12	8.0		
693+85	LT	5.0	12	6.7		
695+21	LT	6.0	12	8.0		
697+18	LT	6.0	12	8.0		
698+85	LT	5.0	12	6.7		
700+56	LT	5.0	12	6.7		
702+30	LT	4.0	12	5.3		
703+44	LT	4.0	12	5.3		
704+95	LT	6.0	12	8.0		
707+81	LT	4.0	12	5.3		
709+20	LT	5.0	12	6.7		
710+18	LT	6.0	12	8.0		
712+38	LT	4.0	12	5.3		
714+30	LT	5.0	12	6.7		
715+17	LT	5.0	12	6.7		
716+67	LT	5.0	12	6.7		
720+71	LT	8.0	12	10.7		
722+57	LT	4.0	12	5.3		
723+60	LT	4.0	12	5.3		
725+31	LT	5.0	12	6.7		
729+05	LT	5.0	12	6.7		
731+37	LT	5.0	12	6.7		
733+74	LT	6.0	12	8.0		
735+26	LT	5.0	12	6.7		
737+59	LT	5.0	12	6.7		
742+09	LT	5.0	12	6.7		
743+70	LT	5.0	12	6.7		
745+47	LT	4.0	12	5.3		
746+16	LT	5.0	12	6.7		
747+88	LT	4.0	12	5.3		
750+27	LT	5.0	12	6.7		
752+25	LT	5.0	12	6.7		
754+38	LT	4.0	12	5.3		
755+20	LT	5.0	12	6.7		
101+22	LT	6.0	12	8.0		
103+16	LT	5.0	12	6.7		
104+79	LT	6.0	12	8.0		
105+80	LT	5.0	12	6.7		
COLUMN TOTALS			0.0	352.5	0.0	0.0
SOUTHBOUND TOTALS			4.7	751.0	34.7	0.0

CLASS D PATCHES (NORTHBOUND LANE)						
STATION	LENGTH (FOOT)	WIDTH (FOOT)	TYPE I, 15 INCH (SQ YD)	TYPE II, 15 INCH (SQ YD)	TYPE III, 15 INCH (SQ YD)	TYPE IV, 15 INCH (SQ YD)
10+00	RT	10.0	12	13.3		
10+78	RT	8.0	12	10.7		
11+26	RT	4.0	12	5.3		
11+80	RT	4.0	12	5.3		
20+60	RT	8.0	12	10.7		
21+45	RT	5.0	12	6.7		
22+64	RT	6.0	12	8.0		
25+78	RT	4.0	12	5.3		
37+21	RT	10.0	12	13.3		
39+78	RT	10.0	12	13.3		
40+51	RT	6.0	12	8.0		
44+29	RT	6.0	12	8.0		
45+65	RT	7.0	12	9.3		
46+66	RT	4.0	12	5.3		
47+84	RT	6.0	12	8.0		
52+94	RT	5.0	12	6.7		
54+38	RT	6.0	12	8.0		
62+28	RT	90.0	6.0			60.0
63+08	RT	70.0	12			93.3
64+06	RT	9.0	12	12.0		
70.98	RT	7.0	12	9.3		
73+15	RT	7.0	12	9.3		
77+20	RT	12.0	12		16.0	
77+31	RT	10.0	6.0	6.7		
78+38	RT	5.0	12	6.7		
84+64	RT	7.0	12	9.3		
89+30	RT	7.0	12	9.3		
96+16	RT	5.0	12	6.7		
103+61	RT	6.0	12	8.0		
111+47	RT	7.0	12	9.3		
113+54	RT	6.0	12	8.0		
608+29	RT	7.0	12	9.3		
610+96	RT	11.0	12	14.7		
614+48	RT	5.0	12	6.7		
616+05	RT	5.0	12	6.7		
617+25	RT	6.0	12	8.0		
619+30	RT	5.0	12	6.7		
620+52	RT	7.0	12	9.3		
622+23	RT	5.0	12	6.7		
623+83	RT	5.0	12	6.7		
625+96	RT	6.0	12	8.0		
626+87	RT	5.0	12	6.7		
628+34	RT	5.0	12	6.7		
630+45	RT	5.0	12	6.7		
632+88	RT	5.0	12	6.7		
634+06	RT	6.0	12	8.0		
635+36	RT	6.0	12	8.0		
638+53	RT	6.0	12	8.0		
640+56	RT	5.0	12	6.7		
640+66	RT	15.0	6.0	10.0		
646+26	RT	4.0	12	5.3		
649+41	RT	5.0	12	6.7		
651+63	RT	5.0	12	6.7		
COLUMN TOTALS			0.0	408.8	16.0	153.3

CLASS D PATCHES (NORTHBOUND LANE)						
STATION	LENGTH (FOOT)	WIDTH (FOOT)	TYPE I, 15 INCH (SQ YD)	TYPE II, 15 INCH (SQ YD)	TYPE III, 15 INCH (SQ YD)	TYPE IV, 15 INCH (SQ YD)
651+80	RT	15.0	6.0	10.0		
653+47	RT	4.0	12	5.3		
658+44	RT	7.0	12	9.3		
661+19	RT	5.0	12	6.7		
663+13	RT	4.0	12	5.3		
665+31	RT	5.0	12	6.7		
668+74	RT	6.0	12	8.0		
670+48	RT	5.0	12	6.7		
672+53	RT	4.0	12	5.3		
674+58	RT	5.0	12	6.7		
675+96	RT	5.0	12	6.7		
680+00	RT	5.0	12	6.7		
680+85	RT	5.0	12	6.7		
683+18	RT	5.0	12	6.7		
686+38	RT	4.0	12	5.3		
688+50	RT	4.0	12	5.3		
692+42	RT	5.0	12	6.7		
693+85	RT	5.0	12	6.7		
695+21	RT	5.0	12	6.7		
697+18	RT	6.0	12	8.0		
698+85	RT	5.0	12	6.7		
700+56	RT	5.0	12	6.7		
702+30	RT	4.0	12	5.3		
703+44	RT	4.0	12	5.3		
704+95	RT	5.0	12	6.7		
707+81	RT	4.0	12	5.3		
709+20	RT	5.0	12	6.7		
710+18	RT	5.0	12	6.7		
712+38	RT	4.0	12	5.3		
714+30	RT	5.0	12	6.7		
715+17	RT	4.0	12	5.3		
716+67	RT	5.0	12	6.7		
720+71	RT	5.0	12	6.7		
722+57	RT	4.0	12	5.3		
723+60	RT	4.0	12	5.3		
725+31	RT	4.0	12	5.3		
729+05	RT	5.0	12	6.7		
731+37	RT	4.0	12	5.3		
733+74	RT	4.0	12	5.3		
735+26	RT	5.0	12	6.7		
737+59	RT	5.0	12	6.7		
742+09	RT	5.0	12	6.7		
743+70	RT	4.0	12	5.3		
745+47	RT	5.0	12	6.7		
746+16	RT	5.0	12	6.7		
747+88	RT	4.0	12	5.3		
750+27	RT	5.0	12	6.7		
752+25	RT	5.0	12	6.7		
754+38	RT	4.0	12	5.3		
101+22	RT	7.0	12	9.3		
103+16	RT	6.0	12	8.0		
104+79	RT	6.0	12	8.0		
105+80	RT	5.0	12	6.7		
COLUMN TOTALS			0.0	343.6	0.0	0.0
NORTHBOUND TOTALS			0.0	752.4	16.0	153.3
PROJECT TOTALS			4.7	1503.4	50.7	153.3
ROUNDED PROJECT TOTAL						

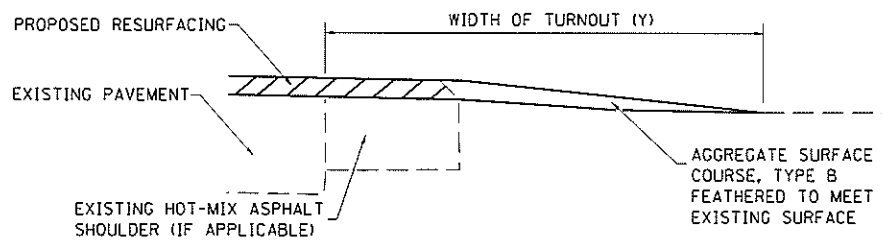
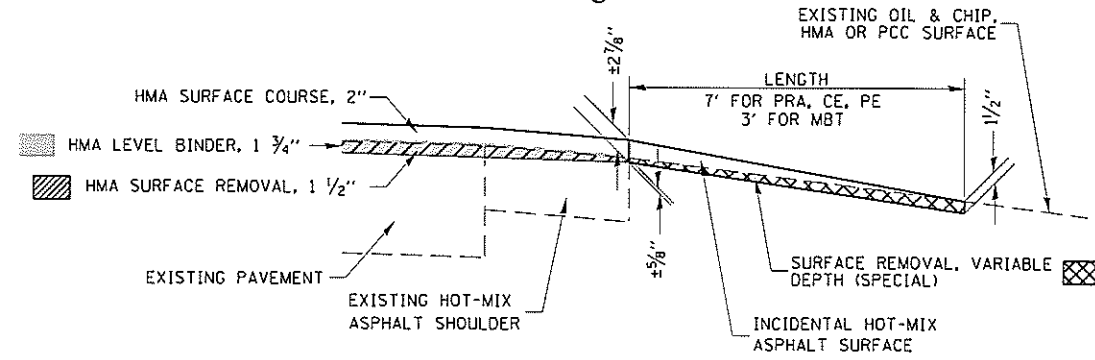
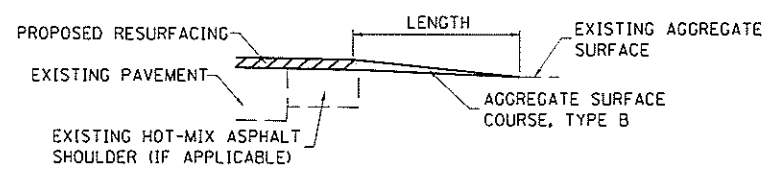
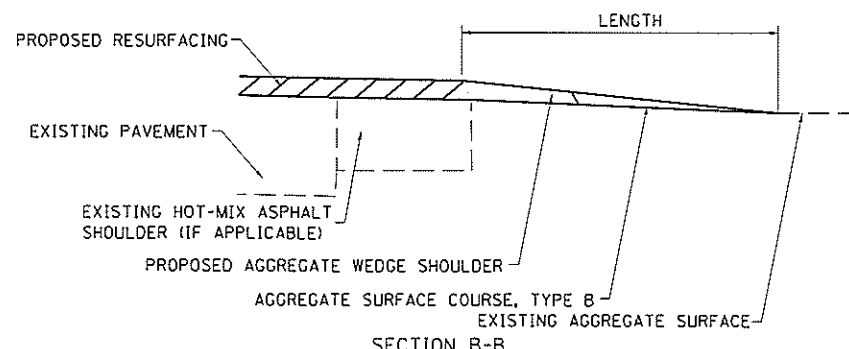
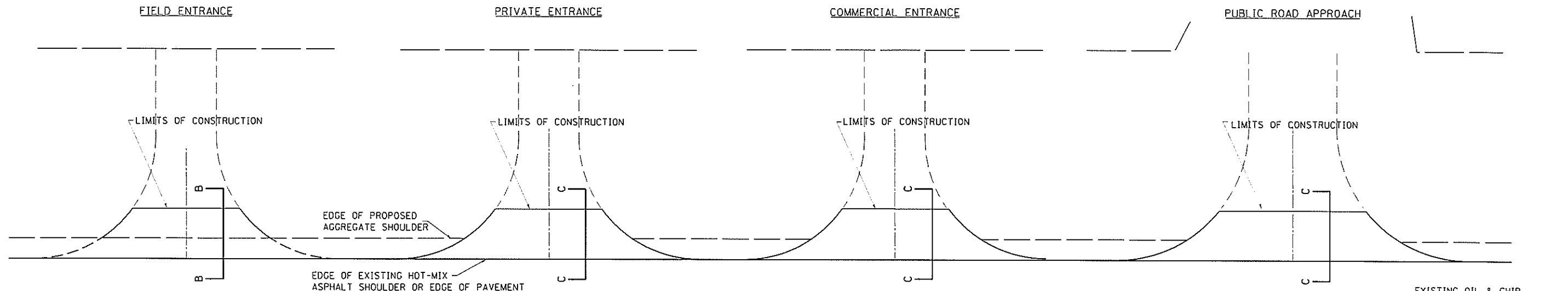

TYPICAL SECTION AT MAILBOX TURNOUT
NOTE: SEE STANDARD 406201 FOR MAILBOX TURNOUT DETAILS

NOTES

LENGTH = 10' UNLESS OTHERWISE NOTED ON PLANS
IF THERE IS NOT EXISTING HOT-MIX ASPHALT SHOULDER THEN THE ENTRANCE TAPER STARTS AT THE EDGE OF EXISTING PAVEMENT.
THE COST OF THE BITUMINOUS MATERIALS (TACK COAT) FOR ENTRANCES AND PUBLIC ROAD APPROACHES SHALL BE INCLUDED IN THE PAY ITEM INCIDENTAL HOT-MIX ASPHALT SURFACING.

SIDE	STATION	TYPE	SURFACE REMOVAL, VARIABLE DEPTH (SPECIAL)		INCIDENTAL HOT-MIX ASPHALT SURFACING	AGGREGATE SURFACE COURSE, TYPE B	
			SO YD	TON		TON	TON
RT	48+16	CE	23	3	0		
PT	60+92	PPA	44	5	0		
LT	60+92	PPA	47	5	0		
LT	87+55	FE	0	0	1		
RT	88+04	FE	0	0	6		
RT	112+05	PE	16	2	0		
RT	114+07	PE	16	2	0		
PT	114+72	PE	15	2	0		
P.T	115+75	PPA	33	4	0		
LT	115+75	PPA	33	4	0		
LT	621+77	FE	0	0	2		
LT	634+28	PE	23	3	0		
LT	635+89	PE	23	3	0		
LT	637+47	PE	19	2	0		
LT	641+12	MBT	10	1	0		
PT	641+14	PE	15	2	0		
PT	660+45	PPA	41	5	0		
LT	660+45	PRA	42	5	0		
RT	696+90	MBT	9	1	0		
LT	697+08	PE	18	2	0		

SIDE	STATION	TYPE	SURFACE REMOVAL, VARIABLE DEPTH (SPECIAL)		INCIDENTAL HOT-MIX ASPHALT SURFACING	AGGREGATE SURFACE COURSE, TYPE B	
			SO YD	TON		TON	TON
RT	697+21	PE	18	2	0		
PT	713+41	PPA	45	5	0		
LT	713+41	PPA	45	5	0		
		TOTAL	535	63	8		

SIDE	STATION	TYPE	SURFACE REMOVAL, VARIABLE DEPTH (SPECIAL)		INCIDENTAL HOT-MIX ASPHALT SURFACING	AGGREGATE SURFACE COURSE, TYPE B	
			SO YD	TON		TON	TON

SIDE	STATION	TYPE	SURFACE REMOVAL, VARIABLE DEPTH (SPECIAL)		INCIDENTAL HOT-MIX ASPHALT SURFACING	AGGREGATE SURFACE COURSE, TYPE B	
			SO YD	TON		TON	TON

FE=FIELD ENTRANCE PRA - PUBLIC ROAD APPROACH
PE=PRIVATE ENTRANCE MBT - MAILBOX TURNOUT
CE=COMMERCIAL ENTRANCE

HOUSE: D:\tbl\...
FILE NAME: ...
PROJECT: ...

USER NAME = Default	DESIGNED - 08-03-99	REVISED - 03-13-07
PLOT SCALE = 100.0073 / in	CHECKED -	REVISED -
PLOT DATE = 6/13/2019	DATE -	REVISED -

STATE OF ILLINOIS
DEPARTMENT OF TRANSPORTATION

RURAL ENTRANCE SCHEDULE AND MAILBOX TURNOUT DETAILS
WITH SHOULDERS

SCALE: _____ SHEET _____ OF _____ SHEETS STA _____ TO STA _____

F.A.P. RTE.	SECTION	COUNTY	TOTAL SHEETS	SHEET NO.
820		COLES	15	7
CONTRACT NO. 74718				

ILLINOIS FED. AID PROJECT

1

903
WEST 1/4 COR. SEC. 26
T14N, R9E OF 3RD P.M.

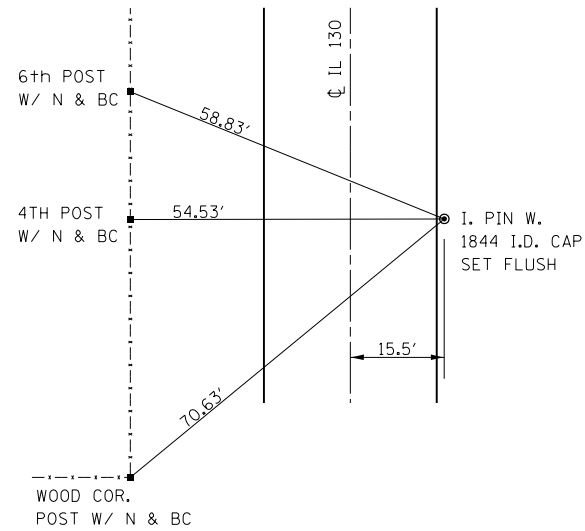

2

904
NW COR. SEC. 35
T14N, R9E OF 3RD P.M.

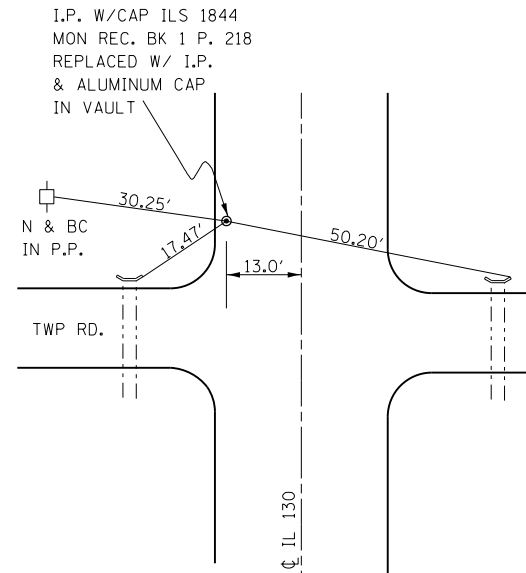

3

905
SW COR. NW 1/4 SEC. 35
T14N, R9E OF 3RD P.M.

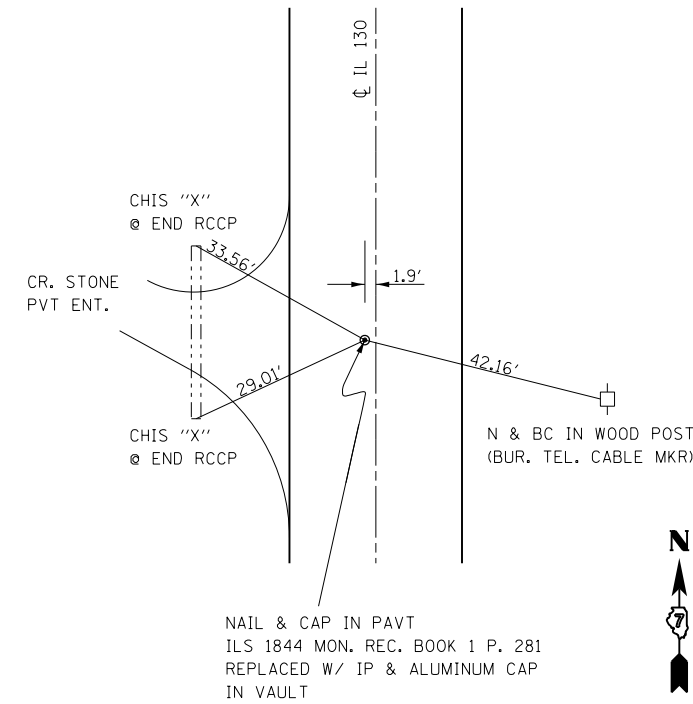

4

906
SW COR. SEC. 35
T14N, R9E OF 3RD P.M.

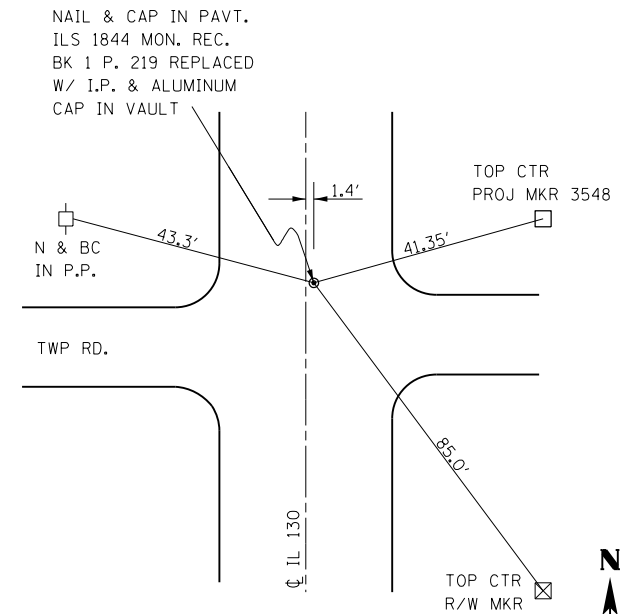

Schedule of Existing Section Corners and Monuments

Station	Off-Set	Description	Point
687+20	15.5' Rt	IP Found W 1/4 Corner 26-14N-9E Buried +/- 8"	903
660+75	13' Lt	IP Found w/Alum. Cap In Vault NW Corner 35-14N-9E	904
634+45	2.0' Lt	IP w/Alum. Cap In Vault SW Corner NW 1/4 35-14N-9E -Could not open	905
115+95	1.8' Rt	IP w/ Alum. Cap In Vault SW Corner 35-14N-9E -Could not open	906

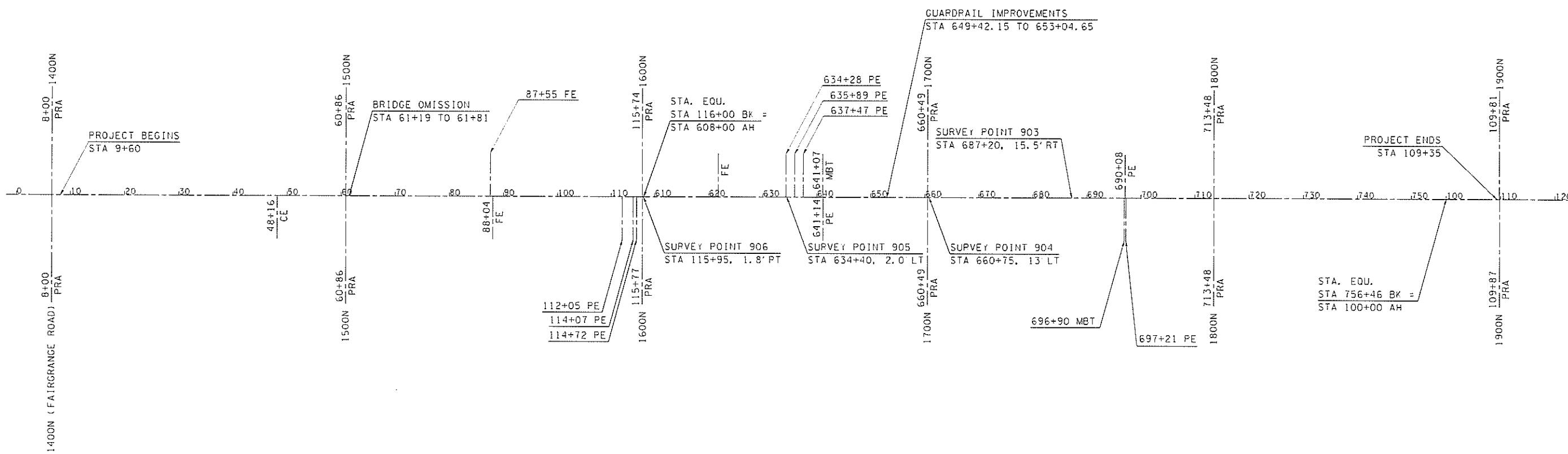

FILE NAME *	USER NAME = Default	DESIGNED - _____	REVISED - _____	STATE OF ILLINOIS DEPARTMENT OF TRANSPORTATION	PLAN SHEET	F.A.P. RTE.	SECTION	COUNTY	TOTAL SHEETS	SHEET NO.
	PLDT SCALE = 100,0000 in.	CHECKED - _____	REVISED - _____			B20	*	COLES	15	9
Default	PLDT DATE = 8-13-2019	DATE - _____	REVISED - _____	SCALE: _____	SHEET _____ OF _____ SHEETS	STA. _____ TO STA. _____	*(27,27-1,37-2)RS-2		CONTRACT NO. 74718	
ILLINOIS FED. AID PROJECT										

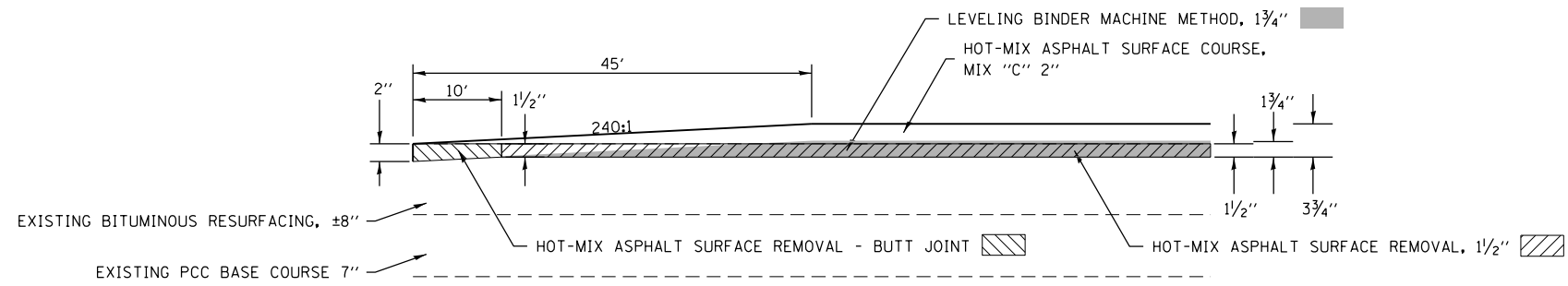

BUTT JOINT DETAIL

STA 9+60 TO STA 9+70
 STA 61+09 TO STA 61+19
 STA 61+81 TO STA 61+91
 STA 109+25 TO STA 109+35

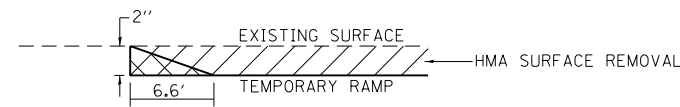

TEMPORARY RAMP

STA 9+60 TO STA 9+66.6
 STA 61+12.4 TO STA 61+19
 STA 61+81 TO STA 61+87.6
 STA 109+28.4 TO STA 109+35

NOT TO SCALE

Note: All dimensions are in INCHES (millimeters) unless otherwise shown.

FILE NAME =	USER NAME = steffenmk	DESIGNED -	REVISED -	STATE OF ILLINOIS DEPARTMENT OF TRANSPORTATION	SCALE:	SHEET	OF	SHEETS	STA.	TO STA.	F.A.P. RTE.	SECTION	COUNTY	TOTAL SHEETS	SHEET NO.	
pw:\planroom.dot.illinois.gov\PIDOT\Documents\IDOT Offices\District 7\Projects\74718\CAD\CADsheets\0774718-sht-details.dgn	DRAWN	REVISIONS	REVISIONS								820	.	COLES	15	10	
Default	PLOT SCALE = 100.0000' / 1in.	CHECKED -	REVISED -								CONTRACT NO. 74718					
	PLOT DATE = 5/31/2019	DATE -	REVISED -								ILLINOIS FED. AID PROJECT					

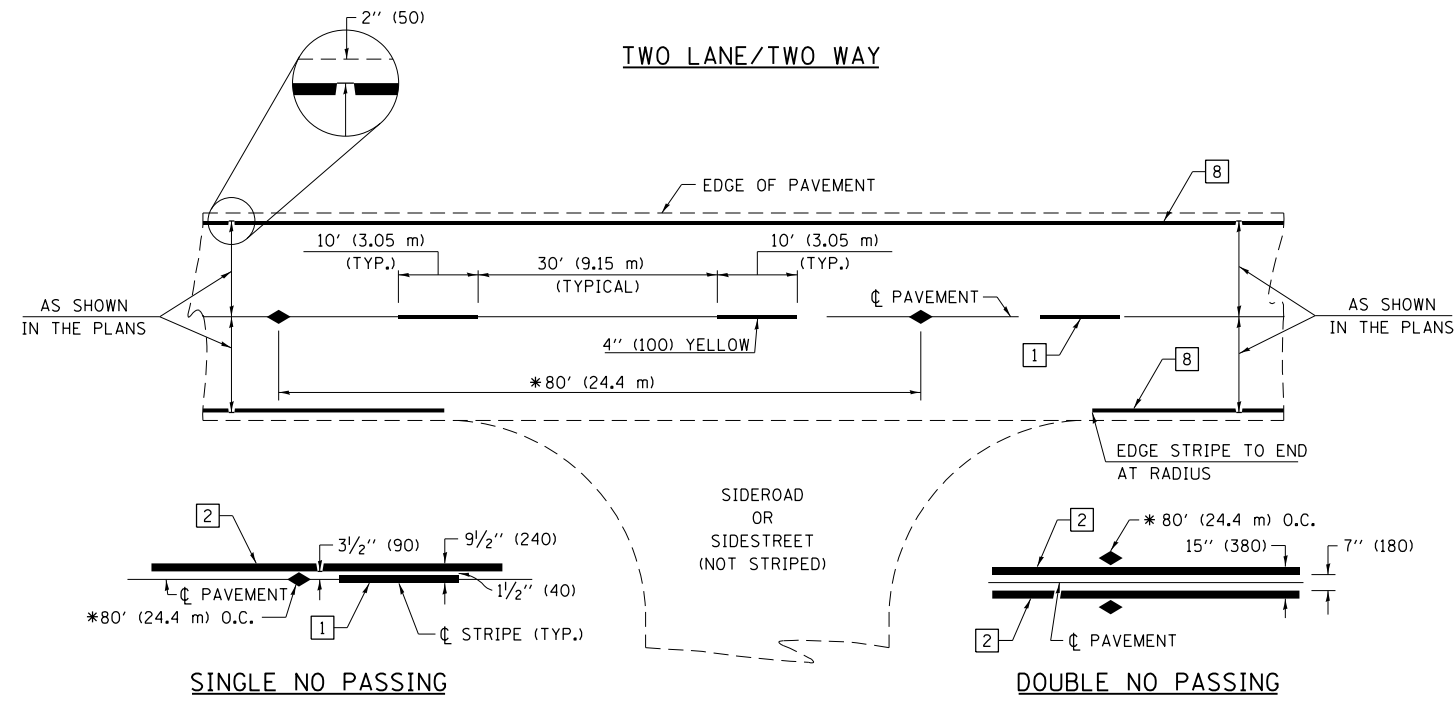

* REDUCE TO 40' (12.2 m) O.C. ON CURVES WITH POSTED OR ADVISORY SPEEDS OF 45 mph (70 km/h) OR LESS.

PAVEMENT MARKING LEGEND

- 1 4" (100) SKIP-DASH (YELLOW)
- 2 4" (100) SOLID (YELLOW)
- 3 12" (300) DIAGONAL (YELLOW)
- 4 4" (100) DOUBLE YELLOW (NARROW)
- 5 12" (300) SOLID WHITE
- 6 RESERVED
- 7 6" (150) SKIP-DASH (WHITE)
- 8 4" (100) SOLID (WHITE)
- 9 12" (300) DIAGONAL (WHITE)
- 10 6" (150) SOLID (WHITE)
- 11 24" (600) STOP BAR (WHITE)
- 12 8" (200) SOLID (WHITE)
- 13 4" (100) PARKING WHITE

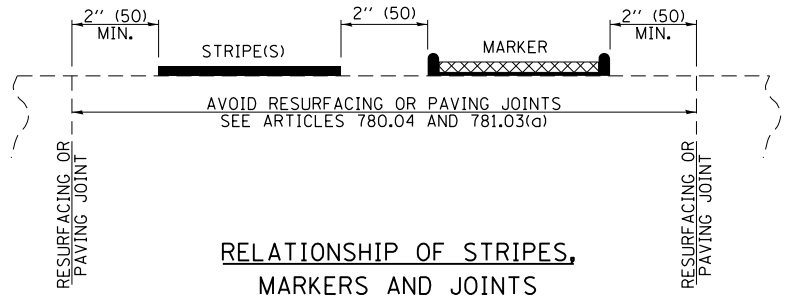

RELATIONSHIP OF STRIPES, MARKERS AND JOINTS

TYPICAL PAVEMENT MARKERS LEGEND

- ◆ TWO-WAY AMBER MARKER
- ▶ ONE-WAY AMBER MARKER
- ▷ ONE-WAY CRYSTAL MARKER

RAISED REFLECTIVE PAVEMENT MARKERS

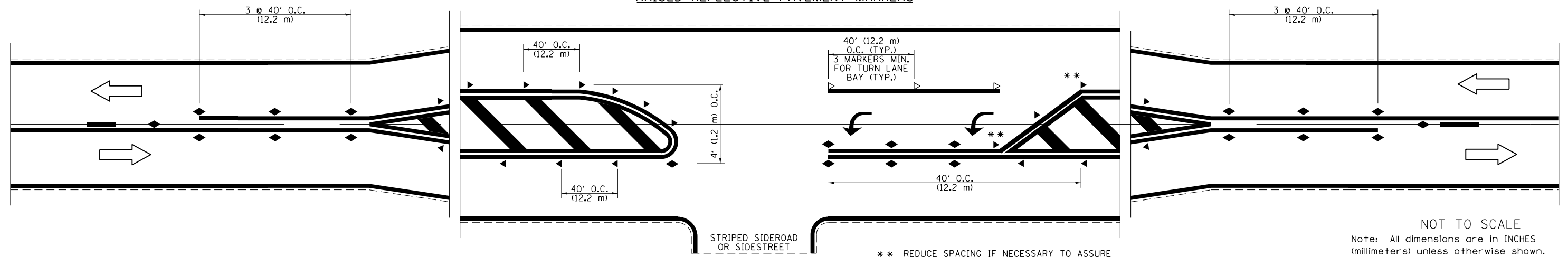

** REDUCE SPACING IF NECESSARY TO ASSURE MARKERS AT CORNER POINTS.

NOT TO SCALE
Note: All dimensions are in INCHES (millimeters) unless otherwise shown.

DISTRICT 7 DETAIL NO. 7800001

FILE NAME =	USER NAME = steffenmk	DESIGNED -	REVISED -	STATE OF ILLINOIS DEPARTMENT OF TRANSPORTATION	PAVEMENT MARKING AND RAISED REFLECTIVE PAVEMENT MARKERS (RURAL & URBAN APPLICATIONS)	F.A.P. RTE.	SECTION	COUNTY	TOTAL SHEETS	SHEET NO.	
pw:\planroom.dot.illinois.gov\PWIDOT\Documents\IDOT Offices\District 7\Projects\74718\CDRAWN\CADsheets\0774718-sht-details.dgn	PLOT SCALE = 100.0000' / in.	CHECKED -	REVISED -			820	.	COLES	15	11	
PLOT DATE = 5/31/2019	DATE -	REVISED -	REVISED -			CONTRACT NO. 74718					
						ILLINOIS FED. AID PROJECT					

*(27,27-1,37-2)RS-2

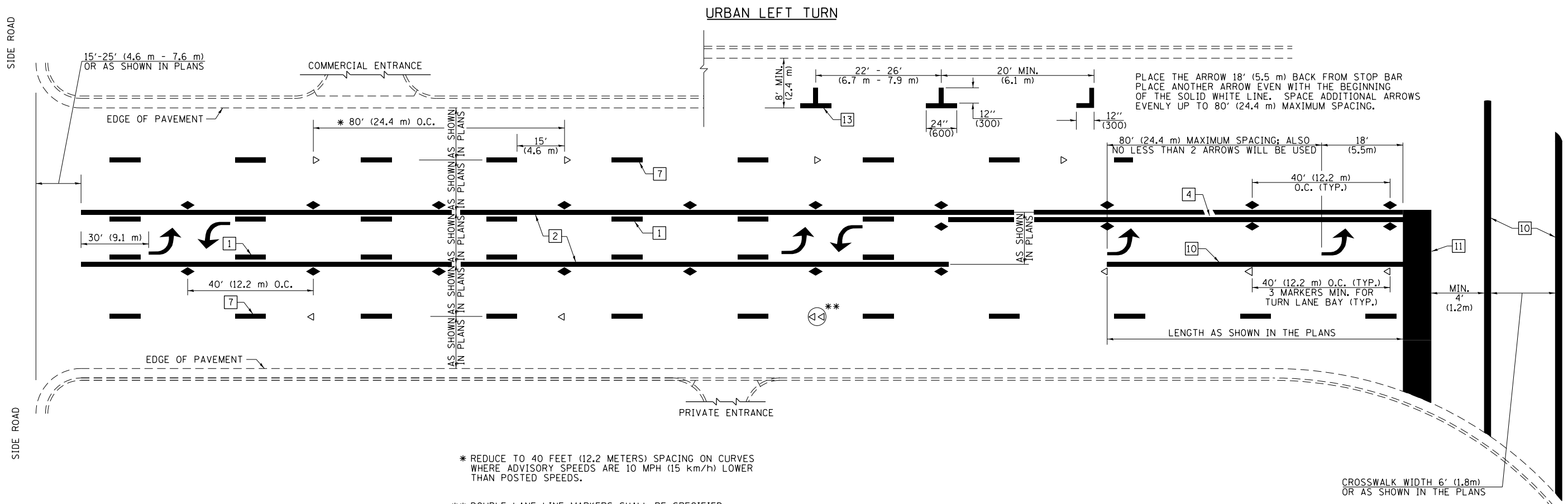

PLACE THE ARROW 18' (5.5 m) BACK FROM STOP BAR
PLACE ANOTHER ARROW EVEN WITH THE BEGINNING
OF THE SOLID WHITE LINE. SPACE ADDITIONAL ARROWS
EVENLY UP TO 80' (24.4 m) MAXIMUM SPACING.

* REDUCE TO 40 FEET (12.2 METERS) SPACING ON CURVES
WHERE ADVISORY SPEEDS ARE 10 MPH (15 km/h) LOWER
THAN POSTED SPEEDS.

** DOUBLE LANE LINE MARKERS SHALL BE SPECIFIED
AND SPACED AS SHOWN IN HIGHWAY STANDARD
781001 FOR MULTI-LANE DIVIDED AND UNDIVIDED
HIGHWAYS.

PAVEMENT MARKING LEGEND

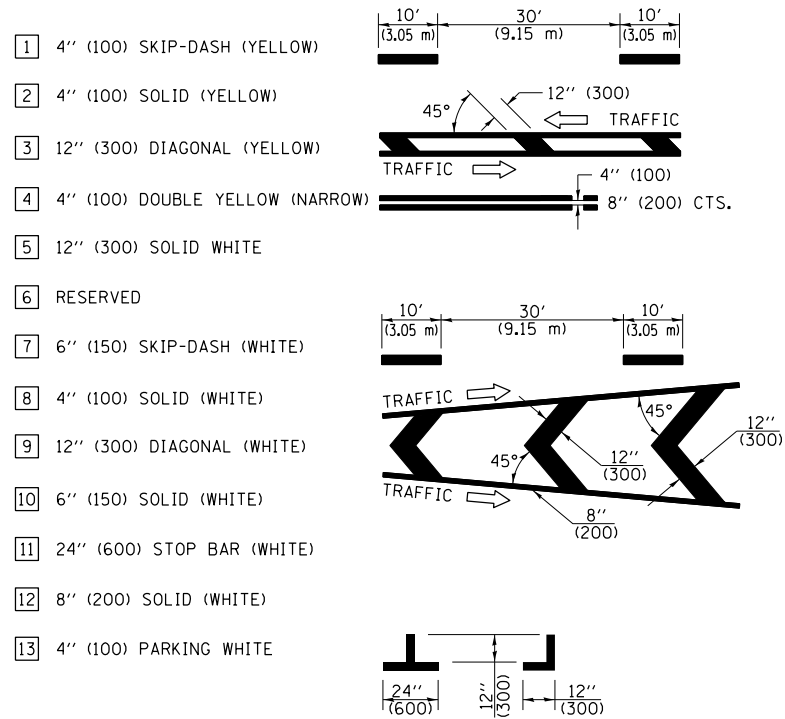

GENERAL NOTES

- TURN ARROW PAIRS SHALL BE PLACED AT 250' (75 m) INTERVALS AND SHALL BE EVENLY SPACED BETWEEN BOTH ENDS OF THE BIDIRECTIONAL LEFT TURN LANE. USE A MINIMUM OF TWO PAIRS PER BLOCK.
- THE SOLID YELLOW PAVEMENT MARKINGS [2] SHOULD GENERALLY START OR END NEAR THE RADIUS POINT OF EACH STREET RETURN EXCEPT WHERE ONE OR BOTH ENDS WOULD INCLUDE STOP BARS.
- THE SKIP-DASH PAVEMENT MARKINGS [1] OR [7] SHOULD BE CENTERED BETWEEN BOTH ENDS OF EACH CITY BLOCK AND SHALL BE PLACED SO THEY LINE UP ACROSS FROM EACH OTHER.
- USE LARGE ARROW SIZE FOR BOTH RURAL AND URBAN LOCATIONS. (SEE LAST PAGE OF SECTION 780x FOR SYMBOLS TABLE)
- LANE LINE EXTENSIONS SHALL BE THE SAME COLOR AND WIDTH AS THE LANE LINE BEING EXTENDED.

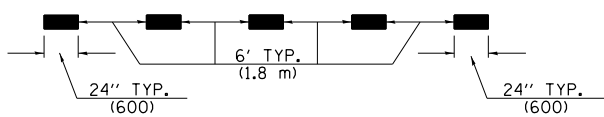

LANE LINE EXTENSIONS

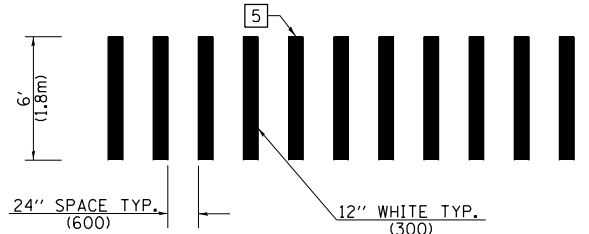

**CROSSWALK DETAIL
(DECATUR CITY LIMITS ONLY)**

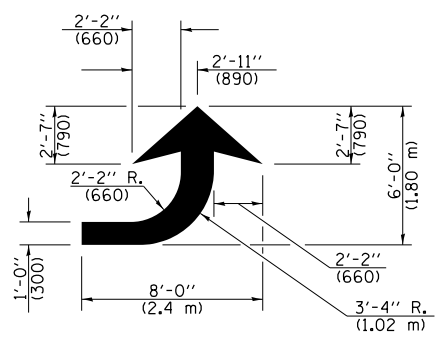

LEFT ARROW

REVERSE FOR RIGHT ARROW
AREA = 15.6 SQ. FT. (1.47 m²)
(WHITE)

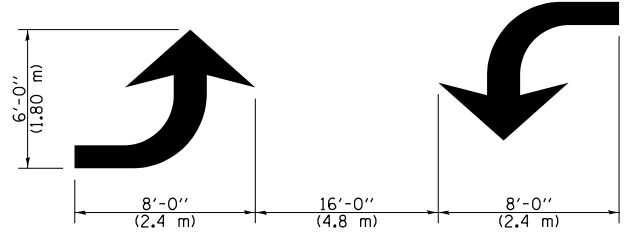

**TYPICAL DOUBLE
TURN ARROWS (WHITE)**

NOT TO SCALE

Note: All dimensions are in INCHES
(millimeters) unless otherwise shown.

DISTRICT 7 DETAIL NO. 78000001

FILE NAME =	USER NAME = steffennk	DESIGNED -	REVISED -	STATE OF ILLINOIS DEPARTMENT OF TRANSPORTATION	PAVEMENT MARKING AND RAISED REFLECTIVE PAVEMENT MARKERS (RURAL & URBAN APPLICATIONS)	F.A.P. RTE.	SECTION	COUNTY	TOTAL SHEETS	SHEET NO.	
pw:\planroom.dot.illinois.gov\PIWIDOT\Documents\IDOT Offices\District 7\Projects\74718\CDRAWN\CADsheets\0774718-sht-details.dgn	BRUNN	REVISOR -	REVISOR -			820	.	COLES	15	12	
		CHECKED -	REVISOR -			CONTRACT NO. 74718					
		DATE -	REVISOR -			ILLINOIS FED. AID PROJECT					

*27,27-1,37-2)RS-2

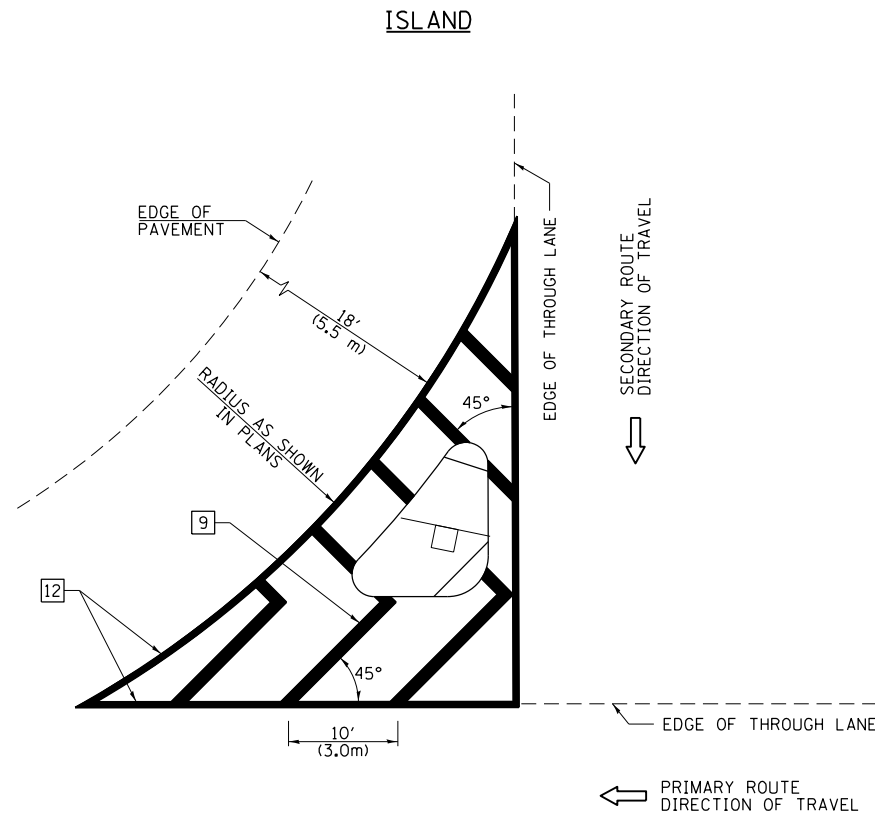

GENERAL NOTES

1. RAISED AND CORRUGATED MEDIANS SHALL BE OUTLINED WITH [2] IF PRESENT.
2. SOME OF THE INFORMATION INCLUDED WITH THIS DETAIL MAY NOT BE APPLICABLE TO THIS IMPROVEMENT.
3. PAVEMENT MARKINGS ARE TO BE EXTENDED THROUGH OMISSIONS WHEN APPLICABLE.
4. FINAL PAVEMENT MARKINGS SHALL BE IN PLACE PRIOR TO PLACING ANY RAISED REFLECTIVE PAVEMENT MARKERS.
5. THE FOLLOWING CRITERIA SHALL BE USED FOR SELECTING THE DIAGONAL PAVEMENT MARKING SPACING:

< 30 MPH (< 50 km/h)	15' (4.5 m)
30-45 MPH (50-75 km/h)	20' (6.0 m)
> 45 MPH (> 75 km/h)	30' (9.0 m)

PAVEMENT MARKING LEGEND

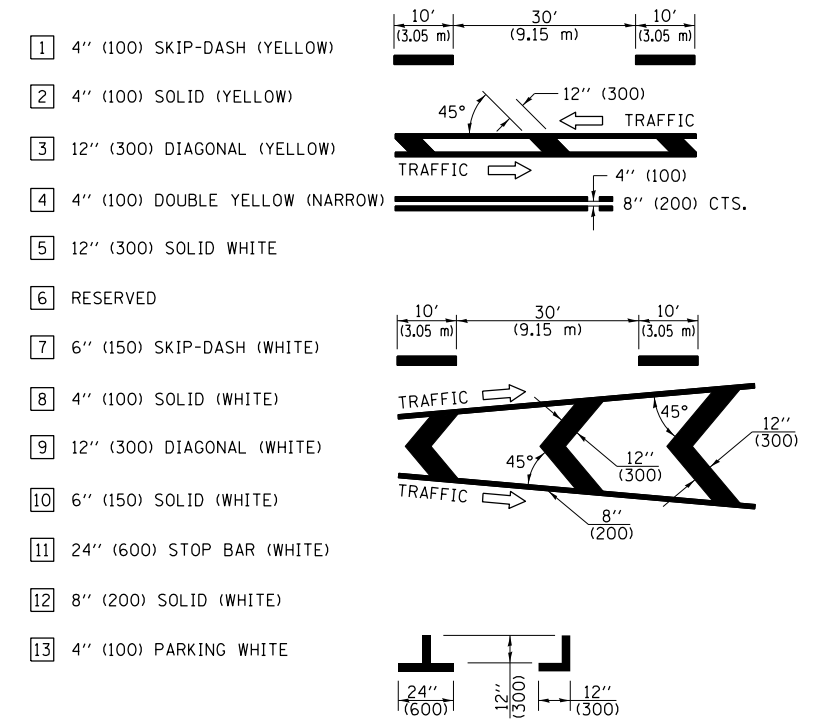

RURAL LEFT TURN STRIPING

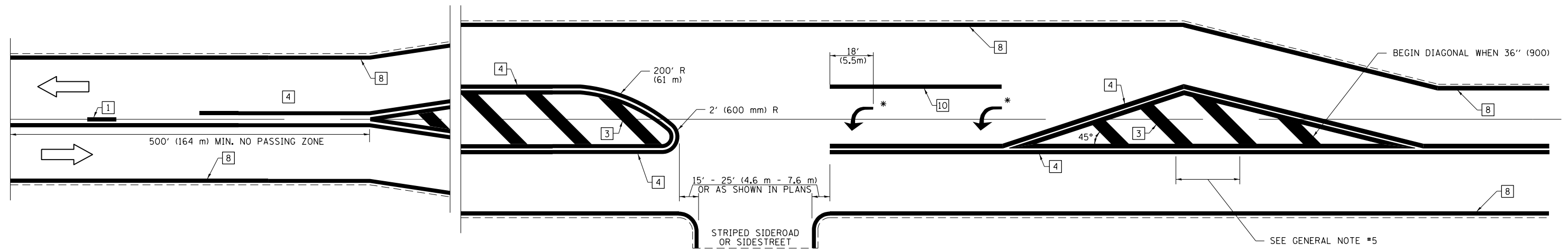

* PLACE AN ARROW 18' (5.5 m) BACK FROM STOP BAR. PLACE ANOTHER ARROW EVEN WITH THE BEGINNING OF THE SOLID WHITE LINE. SPACE ADDITIONAL ARROWS EVENLY UP TO 80' (24.4 m) MAXIMUM SPACING. USE MINIMUM OF 2 ARROWS.

NOT TO SCALE
Note: All dimensions are in INCHES (millimeters) unless otherwise shown.

DISTRICT 7 DETAIL NO. 7800001

FILE NAME =	USER NAME = steffenmk	DESIGNED -	REVISED -	STATE OF ILLINOIS DEPARTMENT OF TRANSPORTATION	PAVEMENT MARKING AND RAISED REFLECTIVE PAVEMENT MARKERS (RURAL & URBAN APPLICATIONS)	F.A.P. RTE.	SECTION	COUNTY	TOTAL SHEETS	SHEET NO.	
pw:\planroom.dot.illinois.gov\PIDOT\Documents\IDOT Offices\District 7\Projects\74718\CDRAW\CADsheets\0774718-sht-details.dgn	PLotted SCALE = 100.0000' / in.	CHECKED -	REVISED -			820	.	COLES	15	13	
	PLOT DATE = 5/31/2019	DATE -	REVISED -			CONTRACT NO. 74718					
						ILLINOIS FED. AID PROJECT					

PAVEMENT MARKINGS AT RAILROAD-HIGHWAY GRADE CROSSING

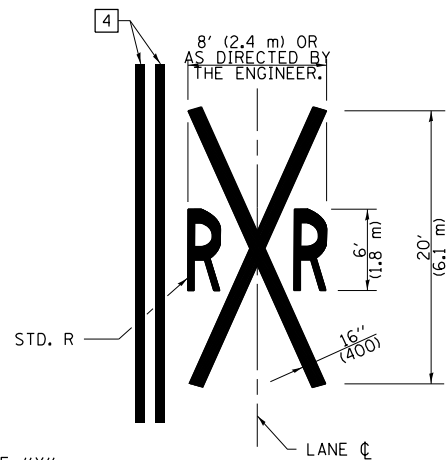
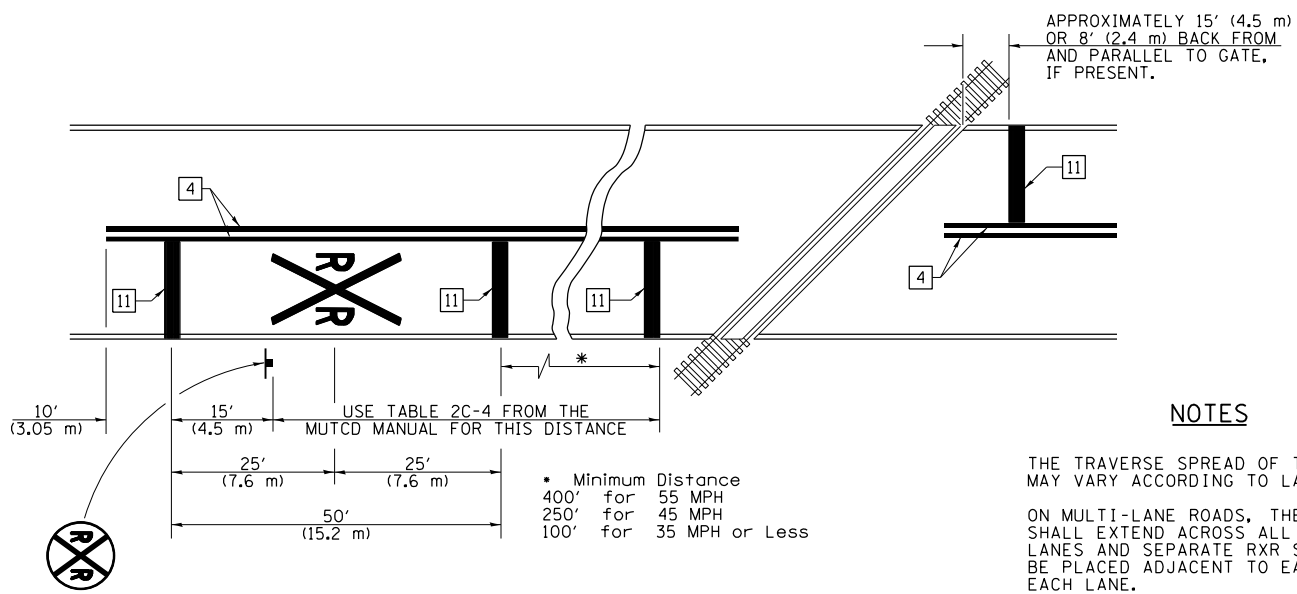

NOTES

THE TRAVERSE SPREAD OF THE "X" MAY VARY ACCORDING TO LANE WIDTH.

ON MULTI-LANE ROADS, THE STOP LINES SHALL EXTEND ACROSS ALL APPROACH LANES AND SEPARATE RXR SYMBOLS SHALL BE PLACED ADJACENT TO EACH OTHER IN EACH LANE.

WHEN THE PAVEMENT MARKING SYMBOL IS USED, A PORTION OF THE SYMBOL SHOULD BE LOCATED DIRECTLY ADJACENT TO THE ADVANCE WARNING SIGN (W10-1) AS PLACED BY TABLE II-1, CONDITION B OF THE MUTCD.

PAVEMENT MARKING LEGEND

- 1 4" (100) SKIP-DASH (YELLOW)
- 2 4" (100) SOLID (YELLOW)
- 3 12" (300) DIAGONAL (YELLOW)
- 4 4" (100) DOUBLE YELLOW (NARROW)
- 5 12" (300) SOLID WHITE
- 6 RESERVED
- 7 6" (150) SKIP-DASH (WHITE)
- 8 4" (100) SOLID (WHITE)
- 9 12" (300) DIAGONAL (WHITE)
- 10 6" (150) SOLID (WHITE)
- 11 24" (600) STOP BAR (WHITE)
- 12 8" (200) SOLID (WHITE)
- 13 4" (100) PARKING WHITE

RAILROAD CROSSING WITH INTERCONNECT ONLY

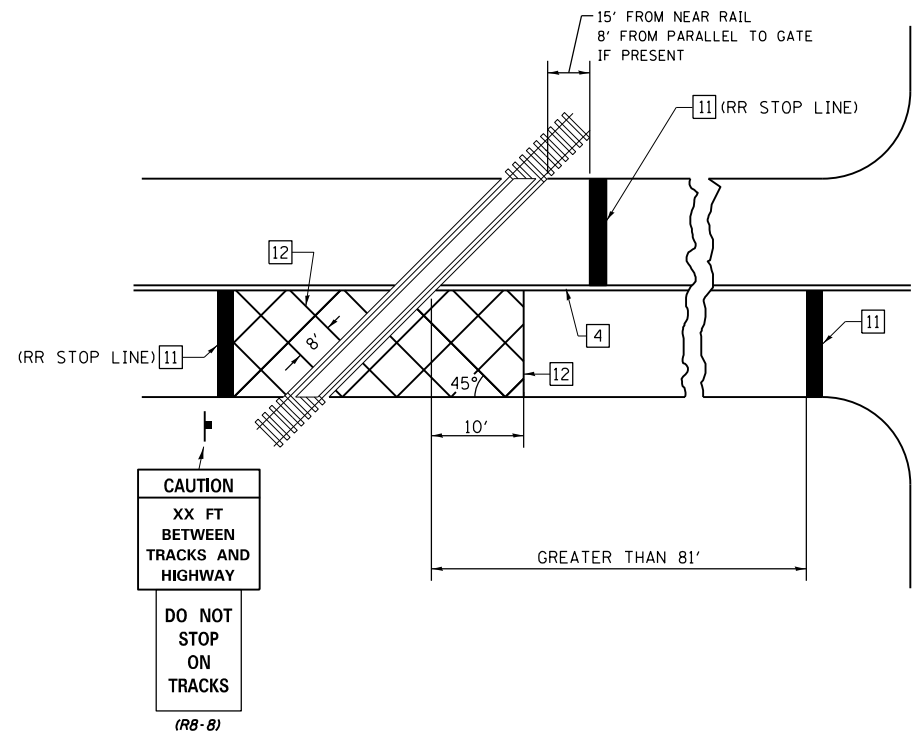

RAILROAD CROSSING WITH INTERCONNECT AND PRE-SIGNALS

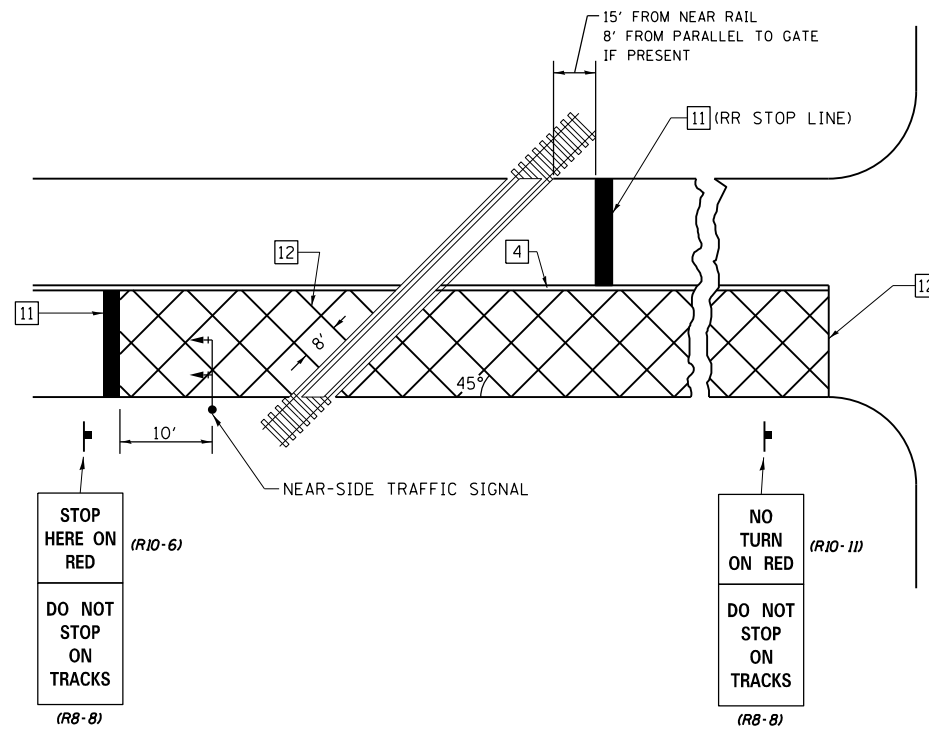

SUPPLEMENTAL PAVEMENT MARKING TREATMENT FOR RAILROAD-HIGHWAY GRADE CROSSING

GENERAL NOTES

- SUPPLEMENTAL PAVEMENT MARKINGS TO BE INSTALLED ONLY ON APPROACHES TO INTERSECTIONS CONTROLLED BY TRAFFIC SIGNALS WHICH ARE INTERCONNECTED WITH THE RAILROAD WARNING SIGNALS.
- EXTEND PAVEMENT MARKINGS TO THE INTERSECTION ONLY WHERE NEAR-SIDE TRAFFIC SIGNALS ARE USED.

NOT TO SCALE

Note: All dimensions are in INCHES (millimeters) unless otherwise shown.

DISTRICT 7 DETAIL NO. 7800001

FILE NAME =	USER NAME = steffenmk	DESIGNED -	REVISED -	STATE OF ILLINOIS DEPARTMENT OF TRANSPORTATION	PAVEMENT MARKING AND RAISED REFLECTIVE PAVEMENT MARKERS (RURAL & URBAN APPLICATIONS)	F.A.P. RTE.	SECTION	COUNTY	TOTAL SHEETS	SHEET NO.	
pw:\planroom.dot.illinois.gov\PIWIDOT\Documents\IDOT Offices\District 7\Projects\74718\CDRAW\CADsheets\0774718-sht-details.dgn		REVISOR -	REVISED -			820	.	COLES	15	14	
		CHECKED -	REVISED -			CONTRACT NO. 74718					
		DATE -	REVISED -			ILLINOIS FED. AID PROJECT					

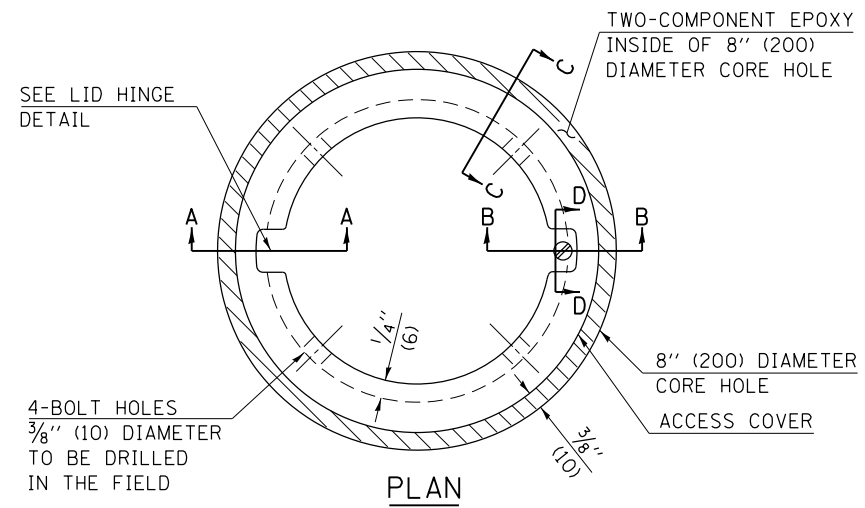

- LEGEND**
- ALUMINUM CASTING
 - 5" (125) OR 6" (150) P.V.C. PIPE
 - TWO-COMPONENT EPOXY
- T = THICKNESS OF PAVEMENT STRUCTURE
- H = THE THICKNESS OF THE SUB-BASE GRANULAR + 1" (25)

BILL OF MATERIAL	
ALUMINUM CASTING OF THE DIMENSIONS AND SPECIFICATIONS SHOWN OR OTHER SUBJECT TO ENGINEER'S APPROVAL OF SHOP DRAWINGS,	
4 EACH - 5/16" X 2" (M8 X 50) BOLTS WITH NUTS, EPOXY,	
5" OR 6" (125 mm OR 150 mm) DIAMETER P.V.C. PIPE, SCHEDULE 40 (WHEN REQUIRED).	

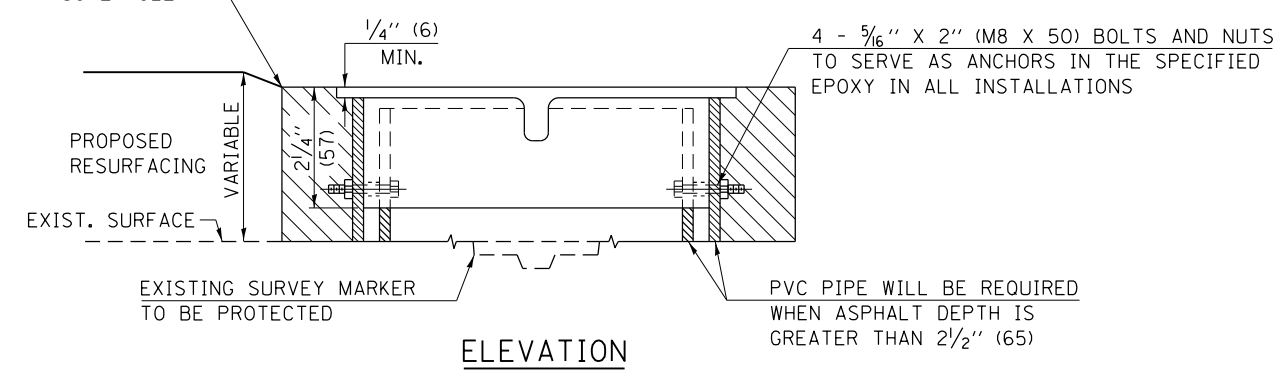
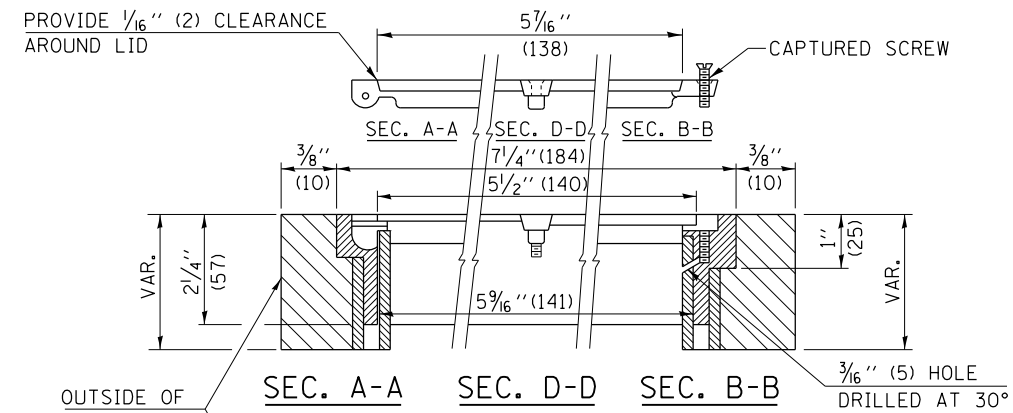
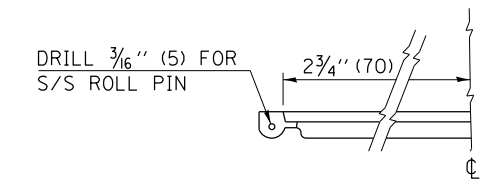
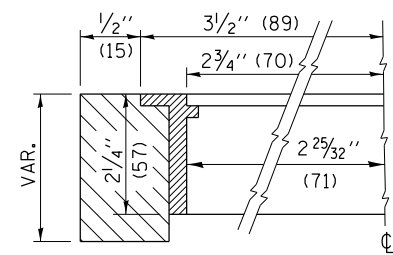

EXISTING SURVEY MARKER

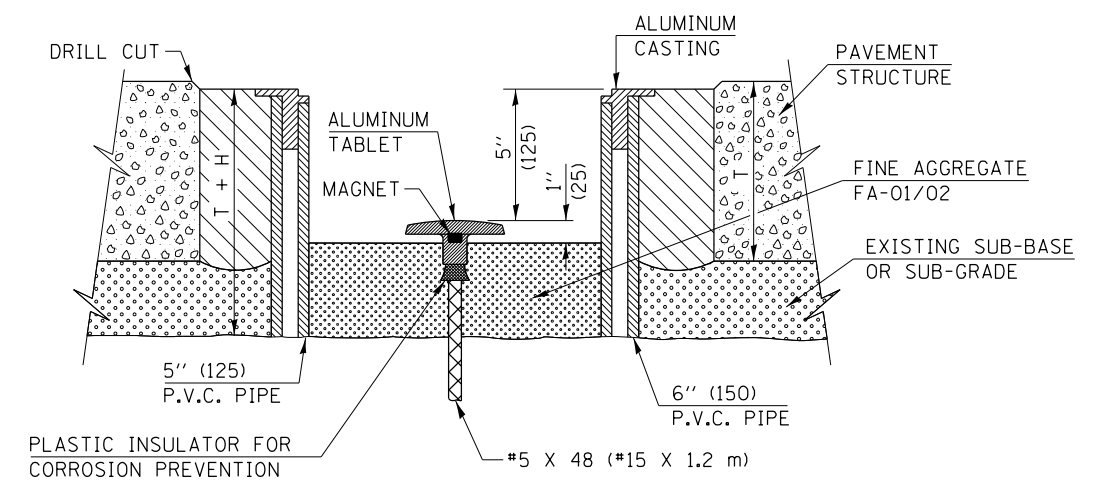

PROPOSED SURVEY MARKER

NOT TO SCALE

Note: All dimensions are in INCHES (millimeters) unless otherwise shown.

FILE NAME =	USER NAME = steffennk	DESIGNED -	REVISED - MAD 6-11
pw:\planroom.dot.illinois.gov\PIDOT\Documents\IDOT Offices\District 7\Projects\74718\CDRAWN\CADsheets\0774718-sht-details.dgn		REVISED -	
	PLOT SCALE = 100.0000' / 1in.	CHECKED -	REVISED -
	PLOT DATE = 5/31/2019	DATE -	REVISED -

STATE OF ILLINOIS
DEPARTMENT OF TRANSPORTATION

SURVEY MARKER VAULT			
SCALE:	SHEET NO.	OF SHEETS	STA. TO STA.

DISTRICT 7 DETAIL NO. Z0070202				
F.A.P. RTE.	SECTION	COUNTY	TOTAL SHEETS	SHEET NO.
820	.	COLES	15	15
FED. ROAD DIST. NO. ILLINOIS FED. AID PROJECT			CONTRACT NO. 74718	

(27,27-1,37-2)RS-2