

STATE OF ILLINOIS
DEPARTMENT OF TRANSPORTATION

F & P RATE	SECTION	COUNTY	TOTAL SHEETS	SHEET NO.
331	(1X-1, 6Z)	RS-4 WILLIAMSON	23	1
ILLINOIS CONTRACT NO. 78692				

PROPOSED HIGHWAY PLANS

FAP 331 (IL 13)
SECTION (1X-1, 6Z) RS-4
PROJECT NHPP-SMN5(910)
HMA RESURFACING (3P)
WILLIAMSON COUNTY

C-99-120-18

FOR INDEX OF SHEETS, SEE SHEET NO. 3

FOR SUMMARY OF QUANTITIES, SEE SHEETS NO. 5-7

TRAFFIC DATA - (2017 ADT)
IL 13 - 16400 WITH 12.8% TRUCKS

TOWNSHIPS
EAST MARION

DESIGN DESIGNATION
17,400(20) OTHER PRINCIPAL ARTERIAL 6.31 (FD-20)

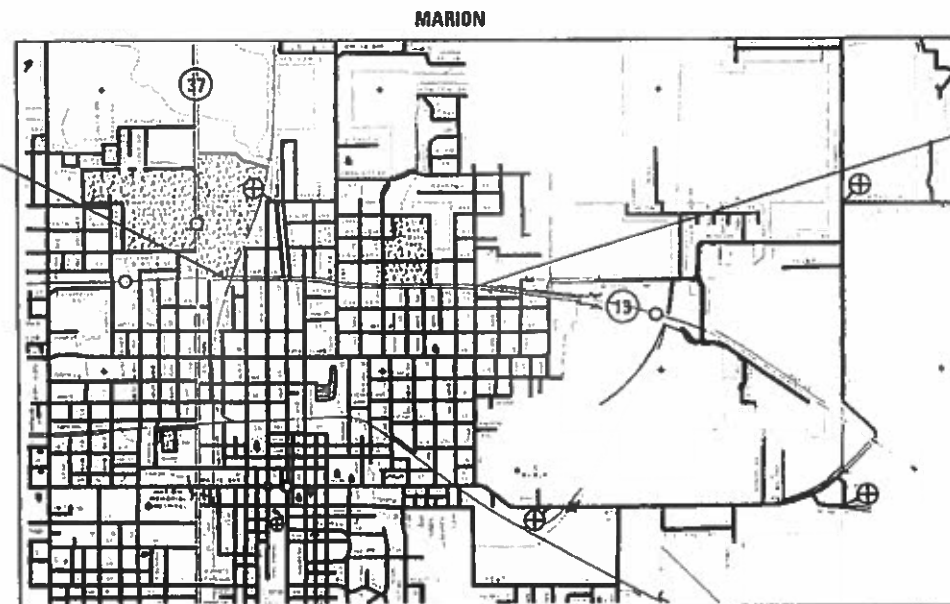
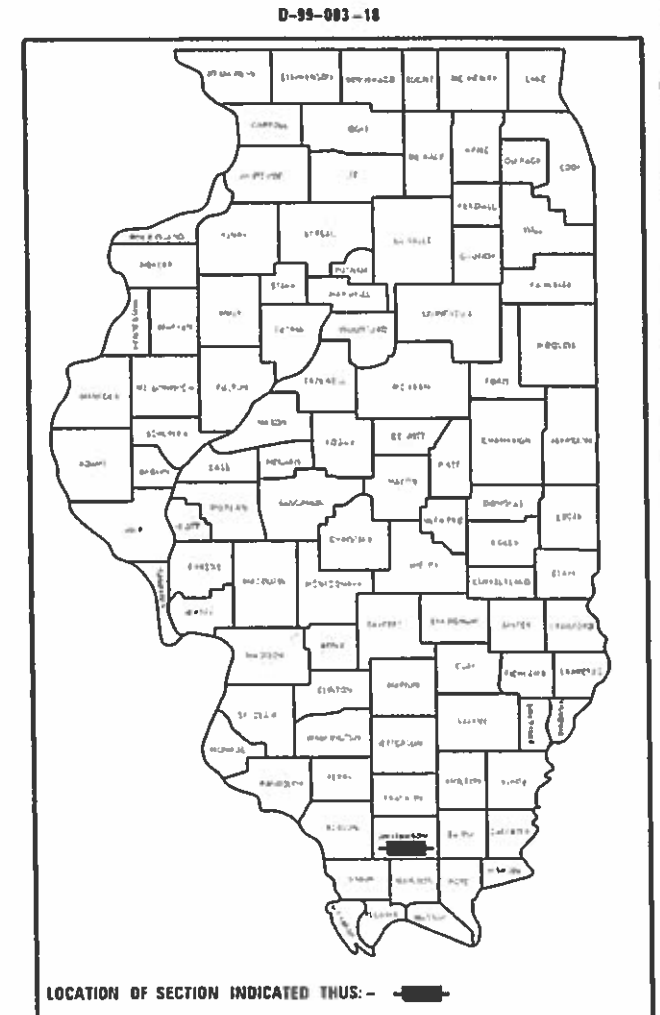

BEGIN PROJECT IL 13
STATION 5+32

END PROJECT IL 13
FAIR ST 49+45

POSTED SPEED : 35 MPH

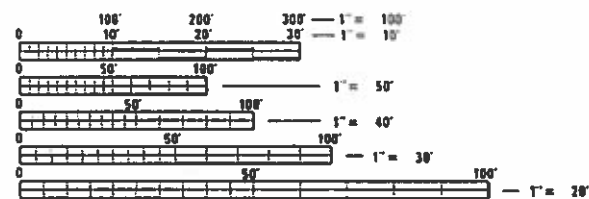

FULL SIZE PLANS HAVE BEEN PREPARED USING STANDARD ENGINEERING SCALES. REDUCED SIZED PLANS WILL NOT CONFORM TO STANDARD SCALES. IN MAKING MEASUREMENTS ON REDUCED PLANS, THE ABOVE SCALES MAY BE USED.

J.U.L.I.E.
JOINT UTILITY LOCATION INFORMATION FOR EXCAVATION
1-800-892-0123
OR 811

PROJECT ENGINEER: SUSAN POE
PROJECT DESIGNER: NATHAN TAYLOR

CONTRACT NO. 78692

GROSS LENGTH = 4,413 FT. = 0.84 MILES
NET LENGTH = 4,413 FT. = 0.84 MILES

STATE OF ILLINOIS
DEPARTMENT OF TRANSPORTATION

SUBMITTED 05-29-2019
[Signature]
REGION FIVE ENGINEER

June 14 2019
[Signature]
ENGINEER OF DESIGN AND ENVIRONMENT

June 14 2019
[Signature]
DIRECTOR OF HIGHWAYS PROJECT IMPLEMENTATION

PRINTED BY THE AUTHORITY
OF THE STATE OF ILLINOIS

MOORE & DEWOLF
FILE NAME: \\msd\users\m...
DRAWN BY: ...
CHECKED BY: ...
DATE: ...

Prepared By: Charles Stein
DISTRICT STUDIES & PLANS ENGINEER

Examined By: _____
DISTRICT LAND ACQUISITION ENGINEER

Examined By: Carrie Nelson
DISTRICT PROGRAM DEVELOPMENT ENGINEER

Examined By: Kevin Kelly
DISTRICT OPERATIONS ENGINEER

Examined By: K.A.P.
DISTRICT PROJECT IMPLEMENTATION ENGINEER

Examined By: Douglas J. Sullivan
DISTRICT CONSTRUCTION ENGINEER

Examined By: [Signature]
DISTRICT MATERIALS ENGINEER

USER NAME = tsj\orn9	DESIGNED - _____	REVISED - _____
LOT SCALE = 100 0000 / r	DRAWN - _____	REVISED - _____
LOT DATE = 5/20/2019	CHECKED - _____	REVISED - _____
	DATE - _____	REVISED - _____

STATE OF ILLINOIS
DEPARTMENT OF TRANSPORTATION

SIGNATURE SHEET

SCALE: _____ SHEET 2 OF 23 SHEETS STA. 5+32 TO STA. 51+15

F A P RTE	SECTION	COUNTY	TOTAL SHEETS	SHEET NO.
331	11X-1, 6Z, IRS-4	WILLIAMSON	23	2

CONTRACT NO. 78692
ILLINOIS FED. AID PROJECT

INDEX OF SHEETS

SHEET NO	DESCRIPTION
1	COVER SHEET
2	SIGNATURE SHEET
3	INDEX OF SHEETS, GENERAL NOTES, AND LIST OF STANDARDS
4	MIX DESIGNS AND MTD CROSSING RESTRICTIONS
5-7	SUMMARY OF QUANTITIES
8	TYPICAL SECTIONS
9-13	SCHEDULE OF QUANTITIES
14-16	HMA SURFACE REMOVAL
17-19	PAVEMENT MARKING
20-21	TRAFFIC SIGNAL DETAILS
22	TEMPORARY HOT-MIX ASPHALT TRANSITIONS
23	ROUGH GROOVED SURFACE AND UNEVEN LANE SIGNS, AND DETECTOR LOOPS

LIST OF STANDARDS

000001-07	STANDARD SYMBOLS, ABBREVIATIONS AND PATTERNS
001006	DECIMAL OF AN INCH AND OF A FOOT
420001-09	PAVEMENT JOINTS
442201-03	CLASS C AND D PATCHES
701101-05	OFF-RD OPERATIONS, MULTILANE, 15' (4.5 m) TO 24" (600mm) FROM PAVEMENT EDGE
701106-02	OFF-RD OPERATIONS, MULTILANE, MORE THAN 15' (4.5 m) AWAY
701427-05	LANE CLOSURE, MULTILANE, INTERMITTENT OR MOVING OPER., FOR SPEEDS < 40 MPH
701602-10	URBAN LANE CLOSURE, MULTILANE, 2W WITH BIDIRECTIONAL LEFT TURN LANE
701701-10	URBAN LANE CLOSURE, MULTILANE INTERSECTION
701901-08	TRAFFIC CONTROL DEVICES
780001-05	TYPICAL PAVEMENT MARKINGS
781001-04	TYPICAL APPLICATIONS RAISED REFLECTIVE PAVEMENT MARKERS
886001-01	DETECTOR LOOP INSTALLATIONS
886006-01	TYPICAL LAYOUTS FOR DETECTION LOOPS

GENERAL NOTES

FACTORS USED FOR ESTIMATING PLAN QUANTITIES ARE AS FOLLOWS AND SHALL NOT BE USED FOR THE BASIS OF FINAL QUANTITIES:

ALL HOT MIX ASPHALT	2.016 TONS/CU.YD.
ALL AGGREGATE	2.05 TONS/CU.YD.

THE QUANTITY OF SHORT TERM PAVEMENT MARKING SHOWN IN THE PLANS IS BASED ON ONE APPLICATION EACH FOR THE HMA SURFACE REMOVAL, SURFACE COURSE, AND BINDER COURSE.

THE CONTRACTOR SHALL STAMP STATIONING IN THE PROPOSED HOT MIX ASPHALT SURFACE AT 300 FT INTERVALS ON ALTERNATING SIDES OF THE PAVEMENT AND AS DIRECTED BY THE ENGINEER. THE STATION SYMBOL STAMPS USED SHALL BE FURNISHED BY THE CONTRACTOR. THEY SHALL BE 5 1/2 IN. TALL, OF A DESIGN APPROVED BY THE ENGINEER, AND SHALL REMAIN THE PROPERTY OF THE CONTRACTOR.

PRIOR TO PLACEMENT OF THE FINAL PAVEMENT MARKINGS THE RESIDENT ENGINEER SHALL CONTACT THE BUREAU OF OPERATIONS AND ARRANGE FOR INSPECTION AND APPROVAL OF THE PAVEMENT MARKING LAYOUT.

AFTER A LIFT OF HOT MIX ASPHALT HAS BEEN PLACED, THE LANE SHALL REMAIN CLOSED TO TRAFFIC UNTIL THE NEW MAT HAS COOLED TO 150 DEGREES FAHRENHEIT.

THE CONTRACTOR SHALL NOTIFY THE ENGINEER OF TRAFFIC OPERATIONS 72 HOURS PRIOR TO THE SHUT- DOWN OR CUTTING OF EXISTING DETECTOR LOOPS.

THE CONTRACTOR SHALL COMPLETE ALL PATCHING PRIOR TO THE HOT MIX ASPHALT SURFACE REMOVAL.

REVISE STANDARD SPECIFICATIONS ARTICLE 107.12, PARAGRAPH 5, LAST SENTENCE TO READ: "ALL OTHER RAILROAD FLAGGER COSTS WILL BE INCURRED BY THE DEPARTMENT ACCORDING TO ARTICLE 109.05".

A CONTRACTOR'S RIGHT-OF-ENTRY PERMIT IS REQUIRED BEFORE ANY WORK CAN COMMENCE ON RAILROAD PROPERTY. THE COST TO OBTAIN THIS PERMIT SHALL BE CONSIDERED INCIDENTAL TO THE PROJECT.

THE FURNISHING AND INSTALLATION OF THE 1 1/4 IN. CONDUIT WITH ITS TRENCHING AND BACKFILL FROM THE LOOP SAWCUT TO THE SPLICE POINT SHALL BE INCLUDED IN THE LOOP INSTALLATION UNLESS SHOWN OTHERWISE ON THE PLANS.

THE LOCATION OF THE DETECTOR LOOPS, AS SHOWN ON THE PLANS, MAY BE ADJUSTED TO FIT FIELD CONDITIONS AS DIRECTED BY THE ENGINEER OF TRAFFIC OPERATIONS.

ALL DETECTOR LOOPS SHALL BE INSTALLED PRIOR TO RESURFACING.

THE 5'X5' DETECTOR LOOPS SHALL BE TYPE I AND EACH DETECTOR LOOP SHALL HAVE 4 TURNS OF LOOP WIRE. THE DETECTOR LOOPS SHALL BE INSTALLED IN ACCORDANCE WITH THE APPLICABLE PORTIONS OF SECTION 886 OF THE STANDARD SPECIFICATIONS FOR TRAFFIC CONTROL ITEMS.

COMMITMENTS: NONE

USER NAME = taylornf		DESIGNED - _____	REVISED - _____	STATE OF ILLINOIS DEPARTMENT OF TRANSPORTATION	INDEX OF SHEETS, LIST OF STANDARDS, AND GENERAL NOTES	F.A.P. RTE	SECTION	COUNTY	TOTAL SHEETS	SHEET NO.
PLOT SCALE = 100 0000' / in.		DRAWN - _____	REVISED - _____			331	(1X-1, 6Z)RS-4	WILLIAMSON	23	3
PLOT DATE = 5/30/2019		CHECKED - _____	REVISED - _____			SCALE _____ SHEET 3 OF 23 SHEETS STA. 5+32 TO STA. 49+45		CONTRACT NO. 78692		
					ILLINOIS FED. AID PROJECT					

MIX DESIGN - SURFACE COURSE

LOCATIONS	HOT-MIX ASPHALT SURFACE COURSE
MIXTURE USE(S):	POLYMERIZED HOT-MIX ASPHALT SURFACE COURSE, MIX D, N90
AB/PG:	SBS PG76-22
ABR % (MAX):	SEE SPECIAL PROVISION
DESIGN AIR VOIDS:	4.0%, 90 GYRATION DESIGN
MIXTURE COMPOSITION (GRADATION MIXTURE)	IL-9.5mm
FRICTION AGGREGATE:	D SURFACE
MIXTURE WEIGHT:	112 LBS/SQ YD/IN
QUALITY MANAGEMENT PROGRAM:	QCP
SUBLOT SIZE:	TBD

MIX DESIGN - LEVELING BINDER

LOCATIONS	HOT-MIX ASPHALT LEVELING BINDER
MIXTURE USE(S):	POLYMERIZED HOT-MIX ASPHALT LEVELING BINDER, N90 FINE GRADED
AB/PG:	SBS PG76-22
ABR % (MAX):	SEE SPECIAL PROVISION
DESIGN AIR VOIDS:	4.0%, 90 GYRATION DESIGN
MIXTURE COMPOSITION (GRADATION MIXTURE)	IL-9.5mm FINE GRADED
FRICTION AGGREGATE:	NONE
MIXTURE WEIGHT:	112 LBS/SQ YD/IN
QUALITY MANAGEMENT PROGRAM:	QC/QA
SUBLOT SIZE:	NA

MTD CROSSING RESTRICTIONS TABLE

SN & CENTERLINE STATION ROUTE (FAP 331 IL 13)	STRUCTURE SIZE	MTD CROSSING RESTRICTIONS
SN 100-7131 (STA. 16+16)	12 FT W X 6.5 FT H	NO MTD ALLOWED
SN 100-7132 (STA. 36+72)	9FT W X 5 FT H	NO MTD ALLOWED

MODEL: D:\hull
 FILE NAME: p:\p\planroom\ebi_illinois_gov\p\DOT\Document\DOT_Offices\District_9\Pages\331\B\331R5-4\MTD_Crossing_Restrictions\DOT_331_Index.dgn

SUMMARY OF QUANTITIES

COUNTY:	WILLIAMSON CO
ROUTE:	IL 13
FUNDING:	80% FED / 20% STATE
LOCATION:	URBAN
	ROADWAY
	0005

CODE NUMBER	ITEM DESCRIPTION	UNIT	TOTAL QUANTITY	
40600290	BITUMINOUS MATERIALS (TACK COAT)	POUND	18,216	
40600847	POLYMERIZED LEVELING BINDER (MACHINE METHOD), IL-9.5FG, N90	TON	1,135	
40600990	TEMPORARY RAMP	SQ YD	929	
40603545	POLYMERIZED HOT-MIX ASPHALT SURFACE COURSE, MIX "D", N90	TON	2,267	
44000158	HOT-MIX ASPHALT SURFACE REMOVAL, 2 1/4"	SQ YD	26,986	
44201415	CLASS C PATCHES, TYPE II, 15 INCH	SQ YD	256	
44201419	CLASS C PATCHES, TYPE III, 15 INCH	SQ YD	20	
67000400	ENGINEER'S FIELD OFFICE, TYPE A	CAL MO	3	
67100100	MOBILIZATION	L SUM	1	
70102632	TRAFFIC CONTROL AND PROTECTION, STANDARD 701602	L SUM	1	
70102635	TRAFFIC CONTROL AND PROTECTION, STANDARD 701701	L SUM	1	
70107025	CHANGEABLE MESSAGE SIGN	CAL DA	56	

MDFL Per-User
 FILE NAME: c:\p1\m101\Documents\MIDOT_01\c3\1\28692\CAD\Drawings\CDISect\11878692_SNA_Cr_Sig_Index.dwg

USER NAME = taylornd	DESIGNED - _____	REVISED - _____	
	DRAWN - _____	REVISED - _____	
PLOT SCALE = 100.0000' / in.	CHECKED - _____	REVISED - _____	
PLOT DATE = 5/30/2019	DATE - _____	REVISED - _____	

STATE OF ILLINOIS
DEPARTMENT OF TRANSPORTATION

SUMMARY OF QUANTITIES

SCALE: _____ SHEET 5 OF 23 SHEETS STA. 5+32 TO STA. 49+45

F.A.P. RTE.	SECTION	COUNTY	TOTAL SHEETS	SHEET NO.
331	(1X-1, 6Z)R5-4	WILLIAMSON	23	5
CONTRACT NO. 78692				
ILLINOIS FED. AID PROJECT				

SUMMARY OF QUANTITIES - CONT

COUNTY:	WILLIAMSON CO
ROUTE:	IL 13
FUNDING:	80% FED / 20% STATE
LOCATION:	URBAN
	ROADWAY
	0005

CODE NUMBER	ITEM DESCRIPTION	UNIT	TOTAL QUANTITY	
70200100	NIGHTTIME WORK ZONE LIGHTING	L SUM	1	
70300100	SHORT TERM PAVEMENT MARKING	FOOT	31344	
70300150	SHORT TERM PAVEMENT MARKING REMOVAL	SQ FT	10448	
70300210	TEMPORARY PAVEMENT MARKING LETTERS AND SYMBOLS	SQ FT	501	
70300220	TEMPORARY PAVEMENT MARKING - LINE 4"	FOOT	13184	
70300260	TEMPORARY PAVEMENT MARKING - LINE 12"	FOOT	140	
70300280	TEMPORARY PAVEMENT MARKING - LINE 24"	FOOT	211	
* 78009000	MODIFIED URETHANE PAVEMENT MARKING - LETTERS AND SYMBOLS	SQ FT	501	
* 78009004	MODIFIED URETHANE PAVEMENT MARKING - LINE 4"	FOOT	13184	
* 78009012	MODIFIED URETHANE PAVEMENT MARKING - LINE 12"	FOOT	140	
* 78009024	MODIFIED URETHANE PAVEMENT MARKING - LINE 24"	FOOT	211	
* 78100100	RAISED REFLECTIVE PAVEMENT MARKER	EACH	353	

* SPECIALTY ITEM

MODIFI: D:\envt\...
 FILE NAME: ...
 ...

SUMMARY OF QUANTITIES - CONT

COUNTY:	WILLIAMSON CO
ROUTE:	IL 13
FUNDING:	80% FED / 20% STATE
LOCATION:	URBAN
	ROADWAY
	0005

CODE NUMBER	ITEM DESCRIPTION	UNIT	TOTAL QUANTITY	
78300200	RAISED REFLECTIVE PAVEMENT MARKER REMOVAL	EACH	353	
* 88600100	DETECTOR LOOP, TYPE I	FOOT	613	
X0327979	PAVEMENT MARKING REMOVAL - GRINDING	SQ FT	161	
X7030005	TEMPORARY PAVEMENT MARKING REMOVAL	SQ FT	5,458	
Z0033700	LONGITUDINAL JOINT SEALANT	FOOT	17,355	
Z0034105	MATERIAL TRANSFER DEVICE	TON	3,402	
Z0048665	RAILROAD PROTECTIVE LIABILITY INSURANCE	L SUM	1	

* SPECIALTY ITEM

MOORE:\dcs\aut FILE NAME: pw\p\p\sum001.dwg 5/30/2019 11:00 AM

FAP 331
IL 13

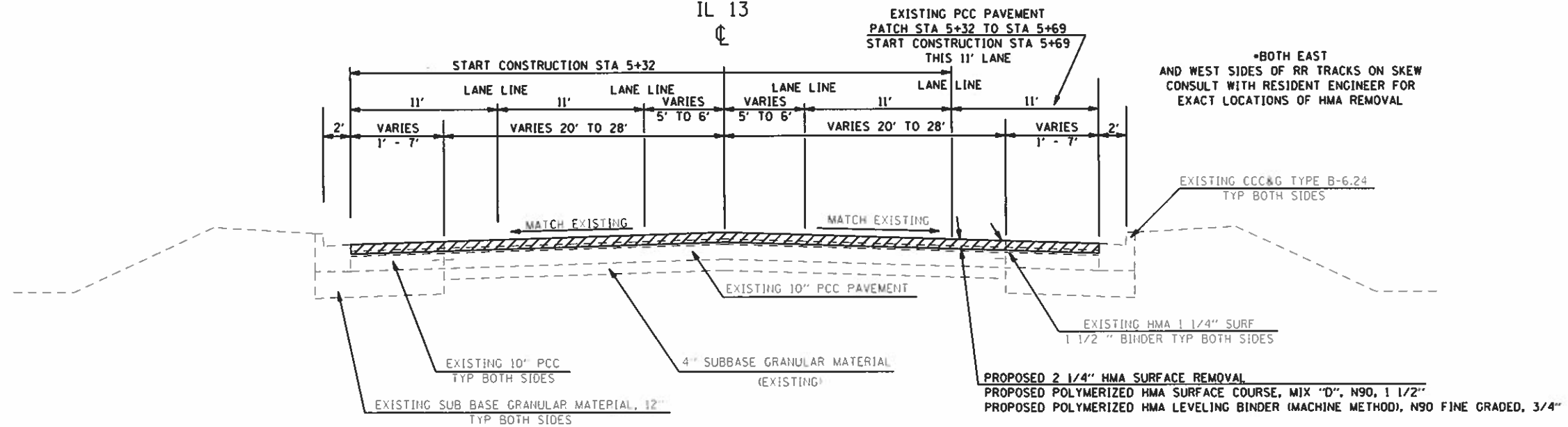

TO BE USED

STA 5+32 TO STA 47+18

LONGITUDINAL JOINT SEALANT (Z0033700) - SHALL BE APPLIED UNDER THE SURFACE COURSE UNDER EACH LANE LINE

FAP 331
IL 13

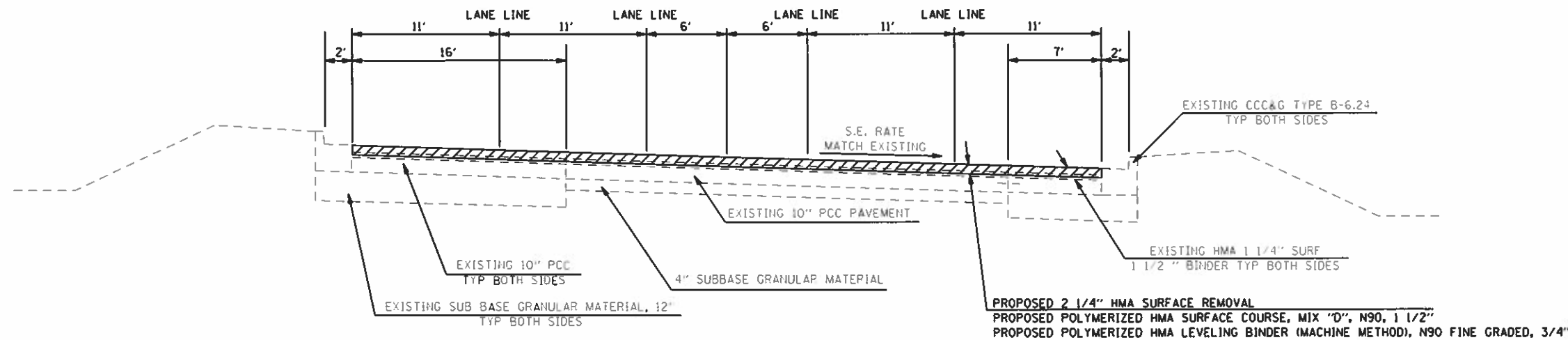

TO BE USED

STA 47+18 TO STA 48+90

LONGITUDINAL JOINT SEALANT (Z0033700) - SHALL BE APPLIED UNDER THE SURFACE COURSE UNDER EACH LANE LINE

MODFL: Del-built
 FILE NAME: \\p01room01\illinois.gov\PI\PID\DOT\Documents\DOT - Office\3378692\CA\Drawings\1978692_S&R_TYP_S&R_Elements.dgn

USER NAME = taylord	DESIGNED -
PLOT SCALE = 100.0000 / in.	DRAWN -
PLOT DATE = 5/30/2019	CHECKED -
	DATE -

REVISED -
REVISED -
REVISED -
REVISED -

STATE OF ILLINOIS
DEPARTMENT OF TRANSPORTATION

TYPICAL SECTIONS 5+32 TO 48+90
ILLINOIS ROUTE 13

SCALE N.T.S. SHEET 8 OF 23 SHEETS STA. 5+32 TO STA. 48+90

F.A.P. RTE	SECTION	COUNTY	TOTAL SHEETS	SHEET NO.
331	(1X-1, 62)RS-4	WILLIAMSON	23	8
CONTRACT NO. 78692			ILLINOIS FED. AID PROJECT	

IL 13 (F.A.P. 331) MAINLINE RESURFACING SCHEDULE

LOCATION STATION TO STATION				LENGTH	ROADWAY WIDTH	SHOULDER WIDTH	HMA SUR. REMOV.	HOT-MIX ASP. SUR. CSE., MIX D N 90	HOT MIX ASPHALT BINDER COURSE, N90 FINE GRADED	BIT. MAT. (TACK COAT)	TEMPORARY RAMPS
				FOR INFORMATIONAL PURPOSE ONLY			(2 1/4")	(1 1/2")	(3/4")		
				(FT)	(FT)	(FT)	(SQ YD)	(TON)	(TON)	(LBS)	(SQ YD)
MAINLINE: STA.5+32 TO STA 48+90											
	5+32	TO	5+32.00		43						36
	5+68	TO	5+68.00		11						9
	5+32	TO	5+85.00	53	43	0	253	22	11	171	
RT	5+68	TO	5+80.00	12	12	0	16	1	1	11	
LT	5+85	TO	6+01.00	16	21.5	0	38	3	2	26	
RT	5+80	TO	5+84.00	4	6	0	3	0	0	2	
	5+80	TO	6+01.00		60				0		25
	5+92.70	TO	6+13.20	21	28	0	64	5	3	43	
	5+92.70	TO	6+13.20		60						25
	6+13.00	TO	48+90.00	4,277	56	0	26,612	2,236	1,118	17,963	
LT	7+98.00	TO	8+72.00	74	Monroe St N Side						31
RT	8+10.00	TO	8+74.00	64	Monroe St S Side						27
LT	10+20.00	TO	10+51.00	31	Alley Entrance						13
RT	10+22.00	TO	10+51.00	29	Alley Entrance						12
LT	11+95.00	TO	12+77.00	82	Van Buren St N Side						34
RT	11+95.00	TO	12+77.00	82	Van Buren St S Side						34
LT	14+82.00	TO	15+61.00	79	Market St N Side						33
RT	15+17.00	TO	16+21.00	104	Market St S Side						43
LT	16+09.00	TO	16+87.00	78	Courtney St N Side						33
LT	18+57.00	TO	19+07.00	50	Madison St N Side						21
RT	18+78.00	TO	19+37.00	59	Madison St S Side						25
LT	20+43.00	TO	21+08.00	65	Glendale St N Side						27
LT	24+07.00	TO	25+34.00	127	State St N Side						53
RT	24+52.00	TO	25+58.00	106	State St S Side						44
LT	26+86.00	TO	27+30.00	44	N Alley Entrance						18
RT	26+88.00	TO	27+29.00	41	S Alley Entrance ROC						17
SUBTOTAL							26,986	2,267	1,135	18,216	560

MODIFIED: D:\proj\...
 FILE NAME: Williamson.dwg

IL 13 (F.A.P. 331) MAINLINE RESURFACING SCHEDULE (CONT.)

LOCATION STATION TO STATION				LENGTH	ROADWAY WIDTH	SHOULDER WIDTH	HMA SUR. REMOV.	HOT-MIX ASP. SUR. CSE., MIX D N 90	HOT MIX ASPHALT BINDER COURSE, N90 FINE GRADED	BIT. MAT. (TACK COAT)	TEMPORARY RAMPS	
							FOR INFORMATIONAL PURPOSE ONLY				(2 1/4")	(1 1/2")
				(FT)	(FT)	(FT)		(SQ YD)	(TON)	(TON)	(LBS)	(SQ YD)
MAINLINE: STA.28+76 TO STA 48+90												
LT	28+76.00	TO	29+61.00	85	Logan St N Side							35
RT	28+79.00	TO	29+54.00	75	Logan St S Side							31
LT	31+03.00	TO	31+33.00	30	N Alley Entrance							13
LT	32+94.00	TO	33+68.00	74	Garfield St N Side							31
RT	32+99.00	TO	33+70.00	71	Garfield St S Side							30
RT	37+14.00	TO	37+90.00	76	Washington St S Side							32
RT	40+08.00	TO	40+80.00	72	Whitman Dr S Side							30
LT	41+28.00	TO	42+10.00	82	Otis St N Side							34
RT	43+00.00	TO	43+65.00	65	Otis St S Side							27
RT	45+75.00	TO	46+55.00	80	McLaren St S Side							33
LT	45+83.00	TO	46+47.00	64	McLaren St N Side							27
	48+90.00	TO	48+90.00	56	Fair St Intersection							47
SUBTOTAL							0	0	0	0	369	
TOTAL							26,986	2,266	1,135	18,216	929	

TEMPORARY RAMPS FOR SIDEROADS DETAIL

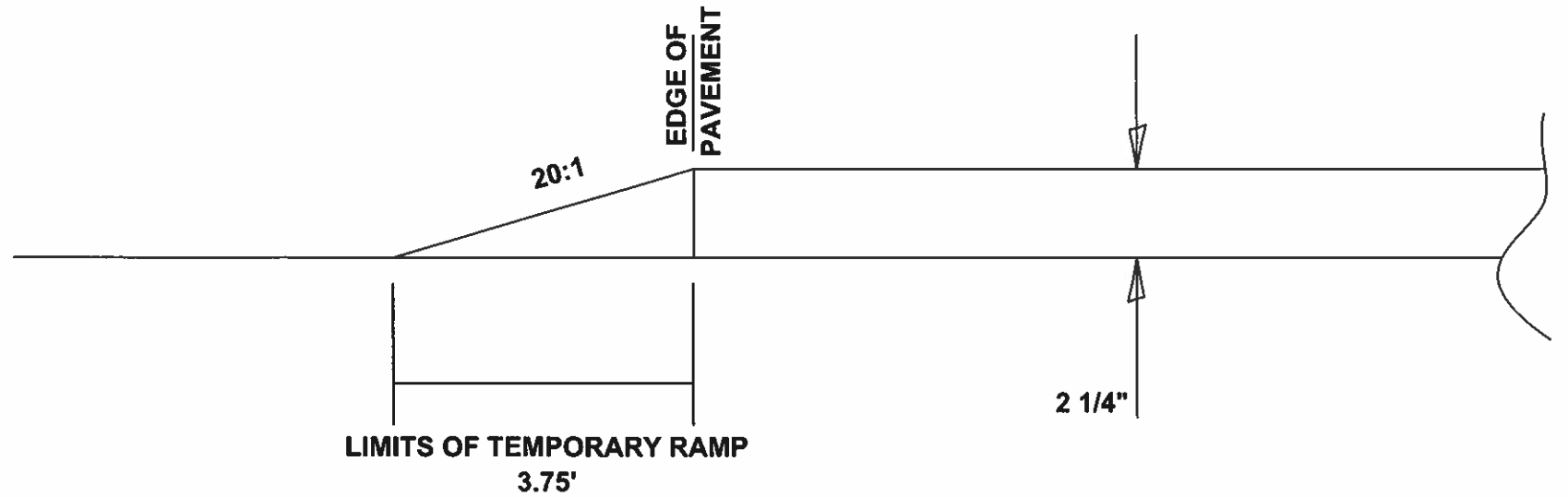

MODFL Default
 FILE NAME: \\p001\Documents\IBD01 - Office\Distrel - 9/19/2019\1318692\CADD\Main\CAD\sheet\1318692_Shb_Typ_Sch_Tes_CognateElements.dgn
 Plot Room for Illinois.gov\p001\Documents\IBD01 - Office\Distrel - 9/19/2019\1318692\CADD\Main\CAD\sheet\1318692_Shb_Typ_Sch_Tes_CognateElements.dgn

PAVEMENT MARKING SCHEDULE - CONT.

LOCATION STATION TO STATION	STATION LT/RT	LENGTH	MODIFIED URETHANE PAVEMENT MARKING							LETTERS AND SYMBOLS SQ FT	REMARKS	
			LINE 4"			LINE 12"		LINE 24"				
			YELLOW		SKIP DASH FOOT	WHITE		WHITE FOOT	YELLOW FOOT			WHITE FOOT
			DBL SOLID FOOT	SOLID FOOT		SOLID FOOT	SKIP DASH FOOT					
ILLINOIS 13												
27+43 TO 47+34	LT	1991		1991	498							BIDIRECTIONAL LEFT TURN LANE
27+43 TO 47+34	RT	1991		1991	498							BIDIRECTIONAL LEFT TURN LANE
29+98 TO 29+98		0									17.6	TWO WAY LEFT TURN ARROWS
32+25 TO 32+25		0									17.6	TWO WAY LEFT TURN ARROWS
34+22 TO 34+22		0									17.6	TWO WAY LEFT TURN ARROWS
36+72 TO 36+72		0									17.6	TWO WAY LEFT TURN ARROWS
39+03 TO 39+03		0									17.6	TWO WAY LEFT TURN ARROWS
41+04 TO 41+04		0									17.6	TWO WAY LEFT TURN ARROWS
43+31 TO 43+31		0									17.6	TWO WAY LEFT TURN ARROWS
45+55 TO 45+55		0									17.6	TWO WAY LEFT TURN ARROWS
46+89 TO 46+89		0									17.6	TWO WAY LEFT TURN ARROWS
47+34 TO 49+30	LT	196	392									LEFT TURN LANE EB DBL YELLOW
48+30 TO 49+46	RT	116				116						LEFT TURN LANE EB SOLID WHITE
48+46 TO 48+46		0									11.8	ONLY
48+72 TO 48+72		0									8.8	LEFT TURN ARROW
49+29 TO 49+29		0									13	EB LEFT TURN LANE STOP BAR
49+45 TO 49+45	RT	0									32	EB LANES STOP BAR
SUBTOTAL			392	3982	996	116	0	0	0	45	179	
TOTAL					5485					45	179	
TOTAL					13184			140		211	501	

MODEL: D:\c:\p\...
 FILE NAME: ...
 PLOT DATE: 5/30/2019

DETECTOR LOOP SCHEDULE

LOCATION STATION TO STATION	EOP TO LOOP	BETWEEN LOOPS	LOOP AMOUNT	DETECTOR LOOP, TYPE I	REMARKS
	FOR INFORMATION USE ONLY				
	FOOT	FOOT	FOOT	FOOT	
IL 13 EASTBOUND LANES					
22+44	7	16	40	63	2 - 5'x5'
23+53	37	0	20	57	1 - 5'x5'
24+25	32	7	96	135	2 - 6'x18' LT TURN LANE
IL 13 WESTBOUND LANES					
25+67.	33	7	96	136	2 - 6'x18' LT TURN LANE
26+32.	26	0	20	46	1 - 5'x5'
27+38.	7	15	40	62	2 - 5'x5'
IL 13 EASTBOUND LANES					
47+36.	8	14	40	62	2 - 5'x5'
48+38.	32	0	20	52	1 - 5'x5'
TOTAL				613	

MODFL: Det/Loop
 FILE NAME: dwg:\p1\11111111.dwg
 PROJECT: 11111111

MDIF: D:\chairs
 FILE NAME: p:\hwy\proj\1010\DeYoung\1010.DWG
 USER: jay/brnd

LEGEND

	2 1/4"	HMA SURFACE REMOVAL
	1 1/2"	POLYMERIZED HMA SURFACE COURSE
	3/4"	POLYMERIZED HMA LEVELING BINDER

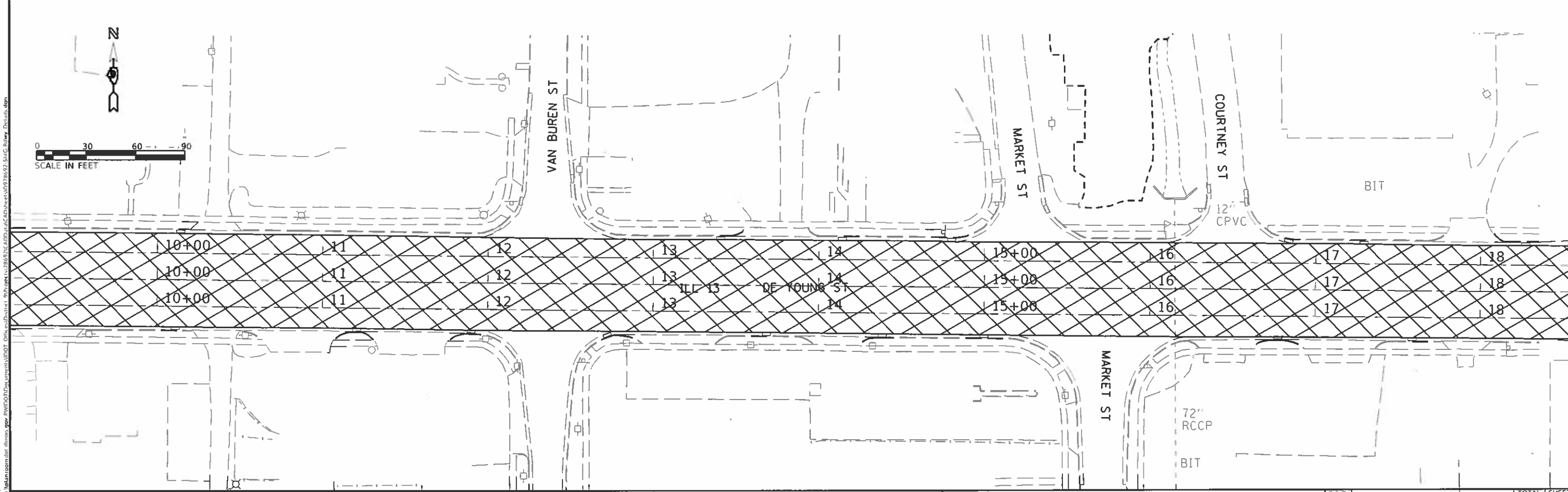
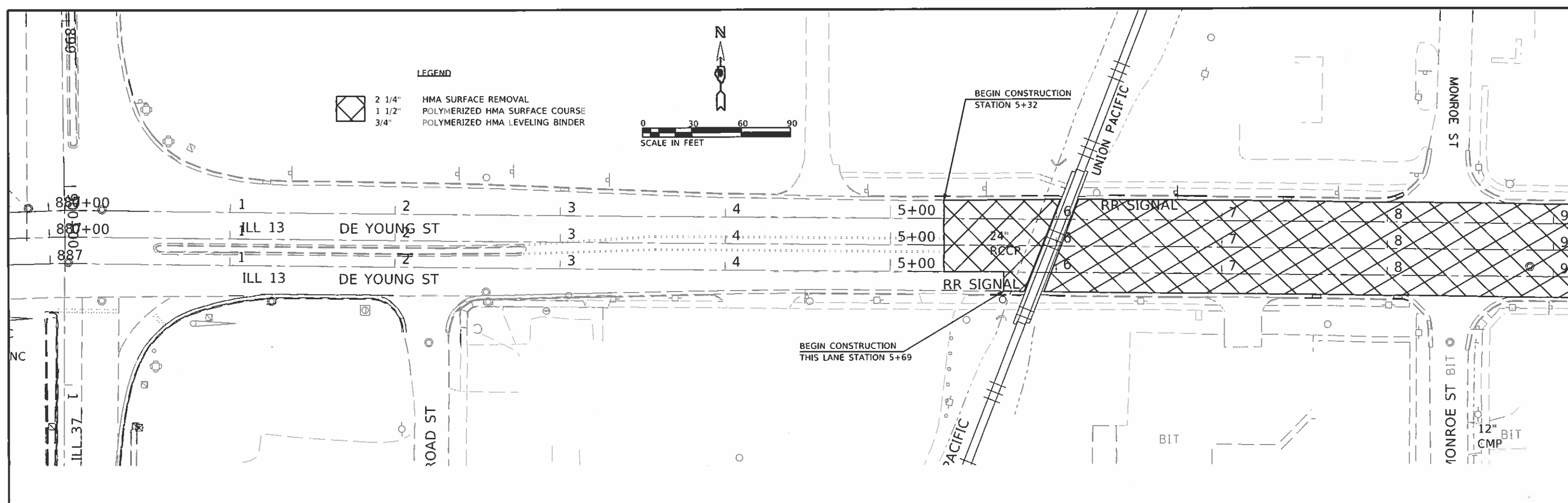

USER NAME = jay/brnd	DESIGNED - _____	REVISED - _____	STATE OF ILLINOIS DEPARTMENT OF TRANSPORTATION		HMA SURFACE REMOVAL STATION 5+32 TO 18+36				F.P. RTE	SECTION	COUNTY	TOTAL SHEETS	SHEET NO.
PLOT SCALE = 60 0000 ' / in	DRAWN - _____	REVISED - _____	SCALE: 1" = 30' SHEET 14 OF 23 SHEETS STA. 5+32 TO STA. 18+36		331	(1X-1, 6Z)RS-4	WILLIAMSON	23	14				
PLOT DATE = 5/30/2019	CHECKED - _____	REVISED - _____			CONTRACT NO. 78692				ILLINOIS FED. AID PROJECT				

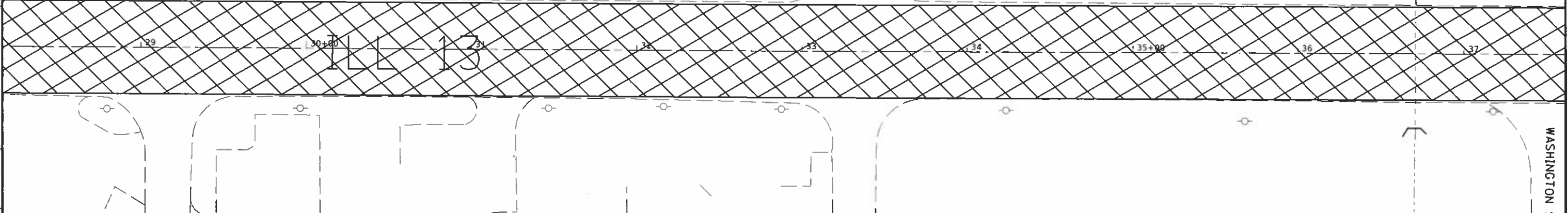
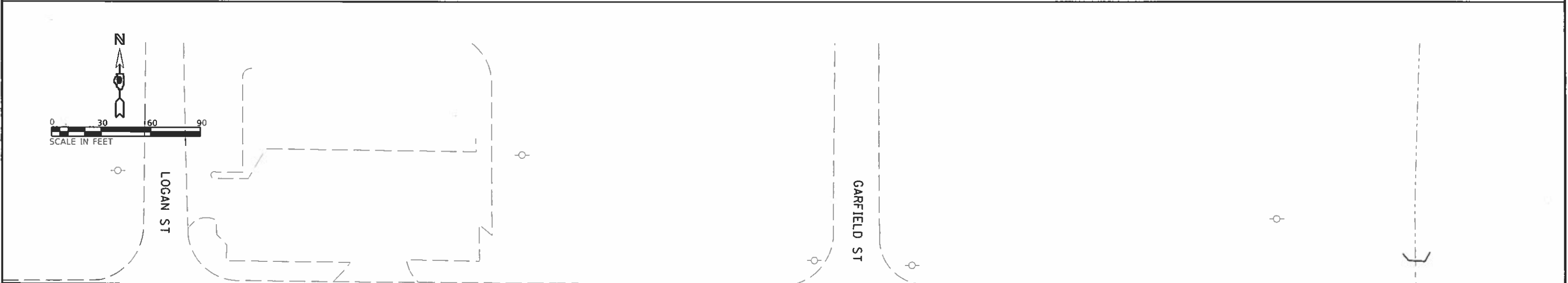
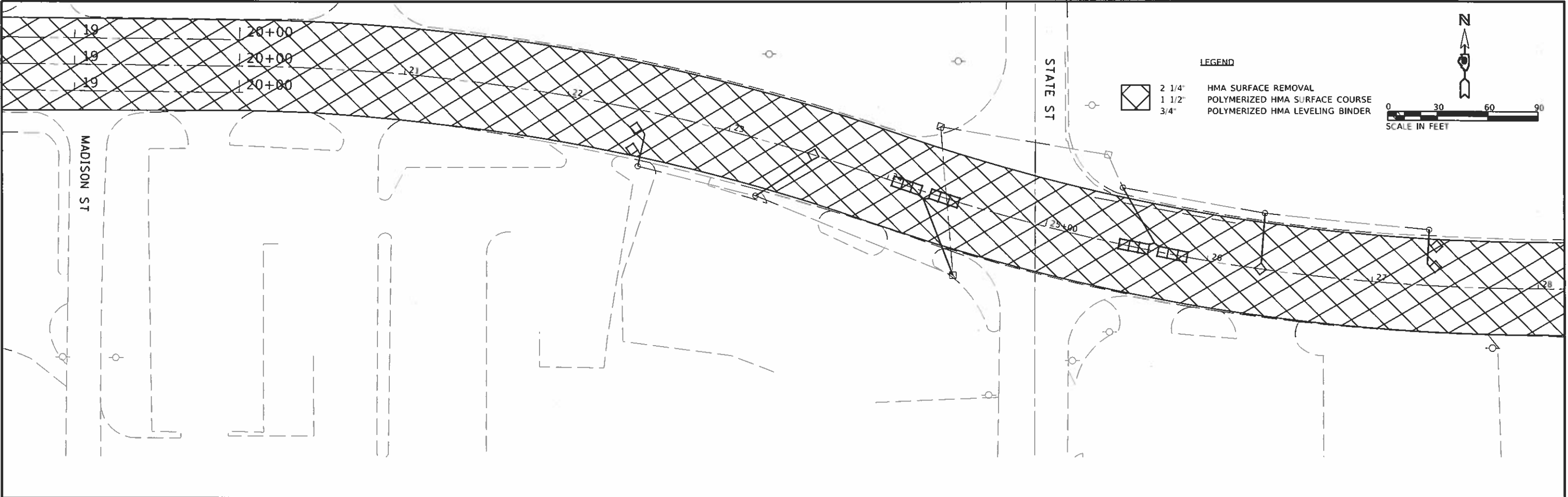

MOJRA - Detail
 FILE NAME: \\p1001\Documents\DOT - Offices\District 5\Project\18692\CAD\plan\CAD\sheet\18692_Sht15.dwg
 User: taylornd

USER NAME = taylornd	DESIGNED -	REVISED -
PLOT SCALE = 60 0000' / in	DRAWN -	REVISED -
PLOT DATE = 5/30/2019	CHECKED -	REVISED -
	DATE -	REVISED -

DESIGNED -	REVISED -
DRAWN -	REVISED -
CHECKED -	REVISED -
DATE -	REVISED -

STATE OF ILLINOIS
DEPARTMENT OF TRANSPORTATION

HMA SURFACE REMOVAL
STATION 18+36 TO 37+61

SCALE: 1" = 30' SHEET 15 OF 23 SHEETS STA. 18+36 TO STA. 37+61

F.A.P. RTE	SECTION	COUNTY	TOTAL SHEETS	SHEET NO.
331	(1X-1, 62)RS 4	WILLIAMSON	23	15
CONTRACT NO. 78692				
ILLINOIS FED. AID PROJECT				



LEGEND



2 1/4" HMA SURFACE REMOVAL
 1 1/2" POLYMERIZED HMA SURFACE COURSE
 3/4" POLYMERIZED HMA LEVELING BINDER

OTIS ST

MCLAREN ST

38 39 40+00 41 42 43 44 45+00 46

WHITMAN ST

OTIS ST



FAIR ST

48 49 50+00 51 52 53 54 55+00 56

EXISTING CONCRETE
 PAVEMENT EDGE STA 48+90
 END HMA SURFACE REMOVAL

MODEL: Delbur
 FILE NAME: \\p:\m\room\g01_illinois_gov\HWIDOT\Documents\DOT_Offices\10\101\1 9\Project\118692\CADD\AutoCAD\Drawings\0978692-5116-Roadway-Details.dwg

USER NAME = 18y10418
PLOT SCALE = 60.0000' / in
PLOT DATE = 5/30/2019

DESIGNED -
DRAWN -
CHECKED -
DATE -

REVISED -
REVISED -
REVISED -
REVISED -

**STATE OF ILLINOIS
 DEPARTMENT OF TRANSPORTATION**

**HMA SURFACE REMOVAL
 STATION 37+61 TO 48+90**

SCALE: 1" = 30' SHEET 16 OF 23 SHEETS STA. 37+61 TO STA. 48+90

F.A.P. RTE	SECTION	COUNTY	TOTAL SHEETS	SHEET NO.
331	(1X-1, 62)RS-4	WILLIAMSON	23	16
				CONTRACT NO. 78692
ILLINOIS FED. AID PROJECT				

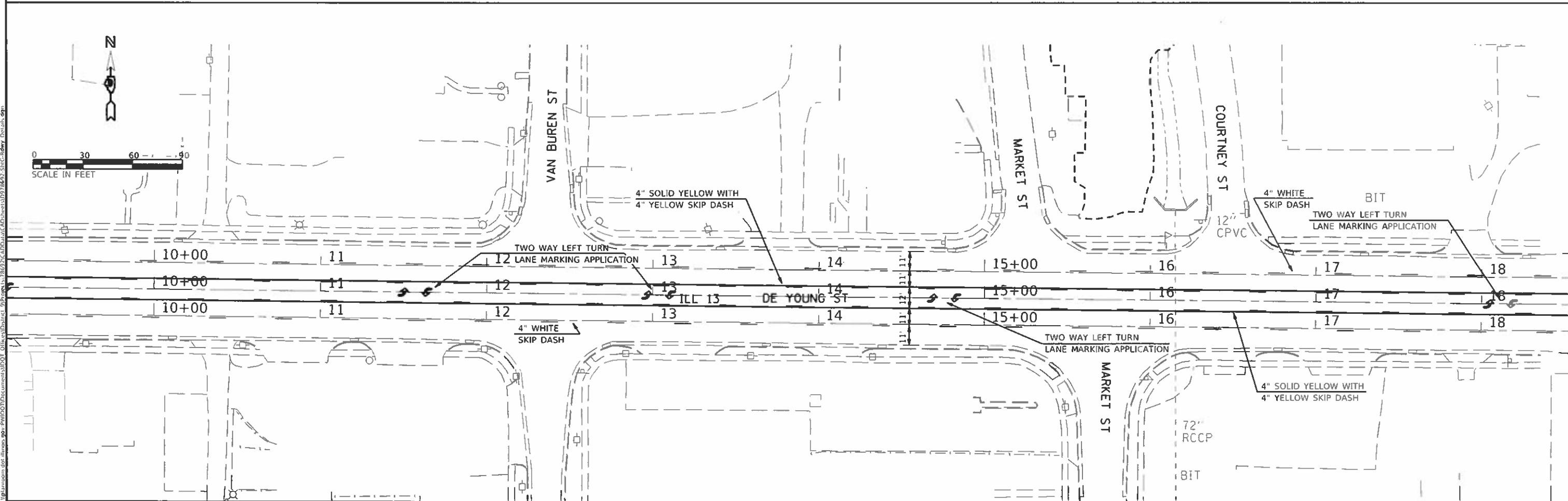
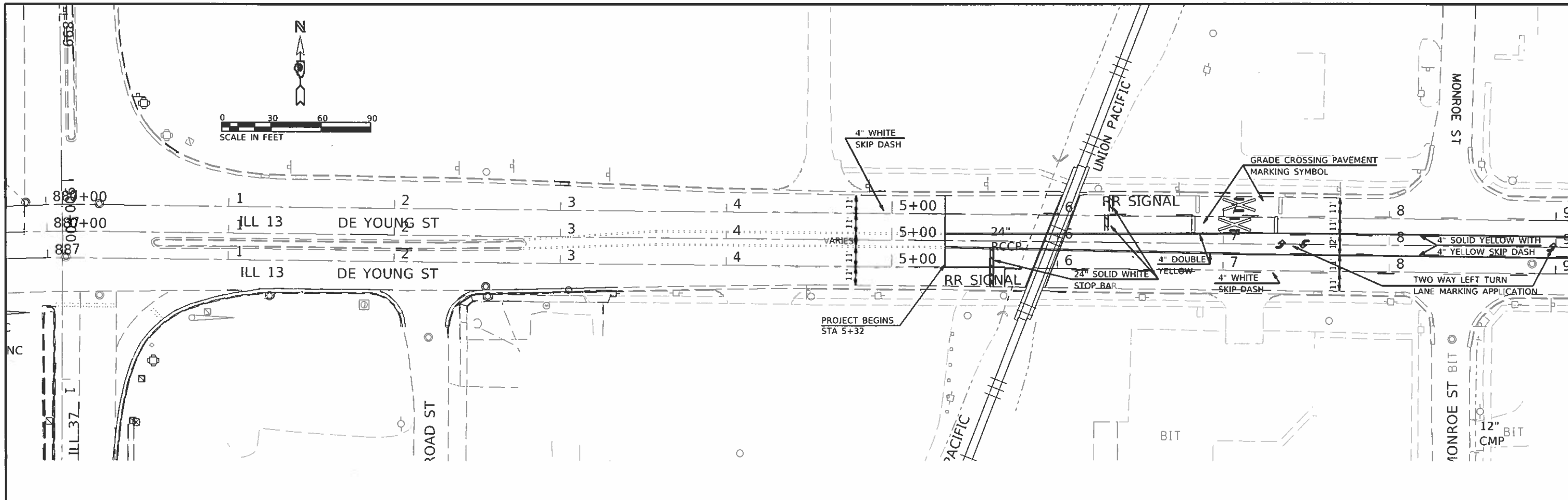

MODIFIED: Default
 FILE NAME: p:\pavedocuments\1001_0111\1001_0111.dwg
 PLOT DATE: 5/31/2019

USER NAME = taylornd	DESIGNED -	REVISED -
PLOT SCALE = 60 0000' / in	DRAWN -	REVISED -
PLOT DATE = 5/31/2019	CHECKED -	REVISED -
	DATE -	REVISED -

STATE OF ILLINOIS
DEPARTMENT OF TRANSPORTATION

PAVEMENT MARKING STATION 5+32 TO 18+36			
SCALE: 1" = 30'	SHEET 17	OF 23 SHEETS	STA. 5+32 TO STA. 18+36

F.A.P. RTE.	SECTION	COUNTY	TOTAL SHEETS	SHEET NO.
331	(1X-1, 62)RS-4	WILLIAMSON	23	17
CONTRACT NO. 78692				
ILLINOIS FED. AID PROJECT				

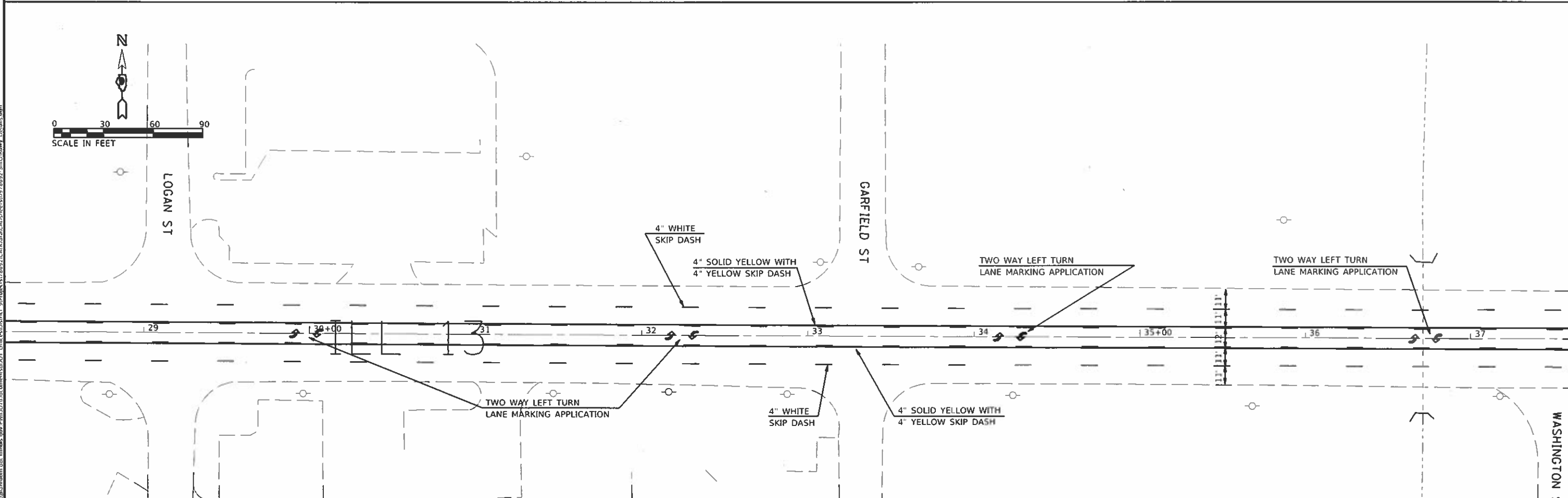
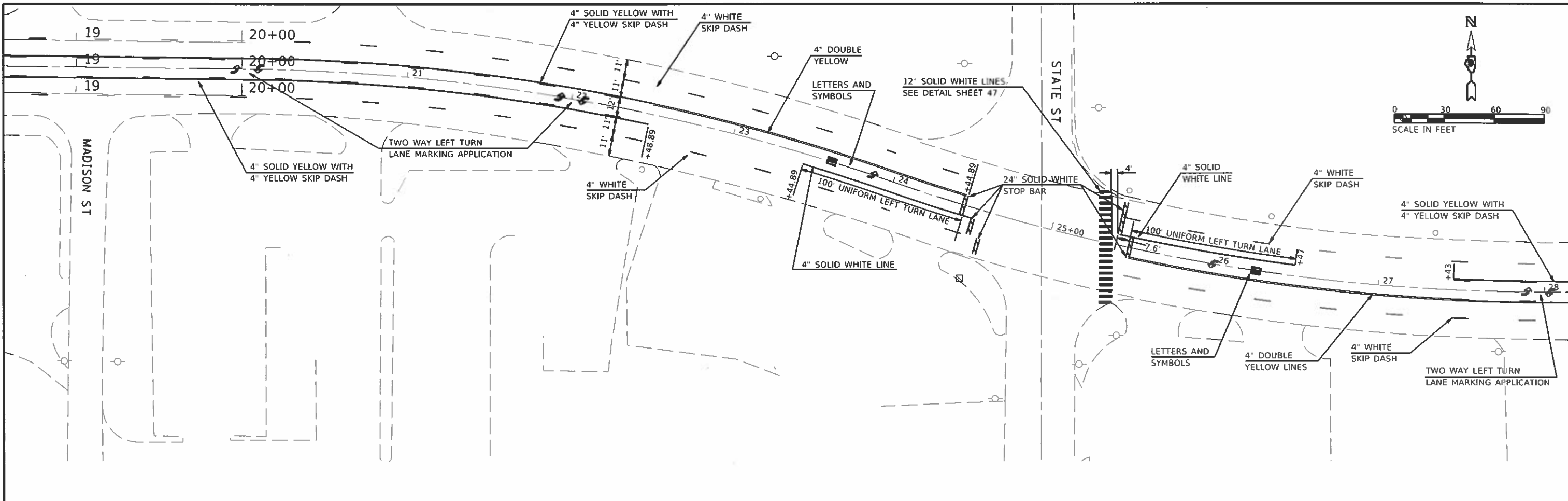

MODEL Detail
 FILE NAME: g:\p1\hanncom\dot\illinois\pav\p1\03\1\Documents\DOT - Office\DOT\18692\CAD\Drawings\18692_S11\Stationing_Details.dwg

USER NAME = saylord
PLOT SCALE = 60 0000' / in
PLOT DATE = 5/30/2019

DESIGNED -	REVISED -
DRAWN -	REVISED -
CHECKED -	REVISED -
DATE -	REVISED -

STATE OF ILLINOIS
DEPARTMENT OF TRANSPORTATION

PAVEMENT MARKING
STATION 18+36 TO 37+61

SCALE: 1" = 30' SHEET 18 OF 23 SHEETS STA. 18+36 TO STA. 37+61

F&E RTE.	SECTION	COUNTY	TOTAL SHEETS	SHEET NO.
331	(1X-1, 6Z)RS-4	WILLIAMSON	23	18
CONTRACT NO. 78692				
ILLINOIS FED. AID PROJECT				

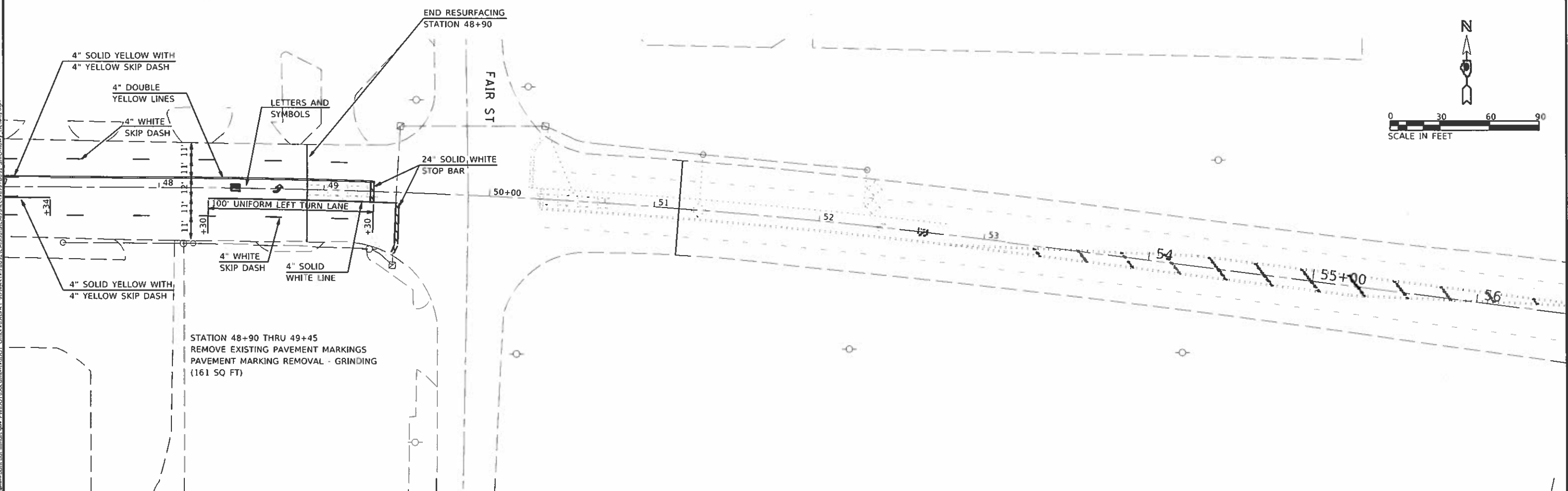
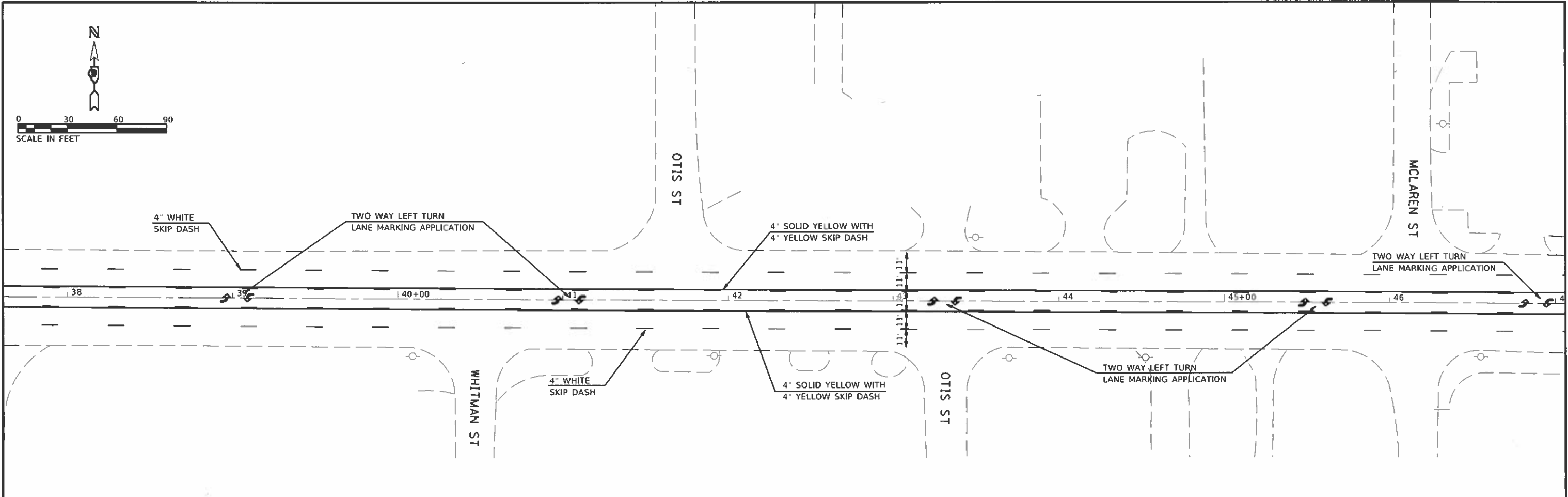

STATION 48+90 THRU 49+45
 REMOVE EXISTING PAVEMENT MARKINGS
 PAVEMENT MARKING REMOVAL - GRINDING
 (161 SQ FT)

USER NAME = lrp/brnd	DESIGNED -	REVISED -
PLOT SCALE = 6"=100'	DRAWN -	REVISED -
PLOT DATE = 5/3/2019	CHECKED -	REVISED -
	DATE -	REVISED -

**STATE OF ILLINOIS
 DEPARTMENT OF TRANSPORTATION**

PAVEMENT MARKING	
STATION 37+61 TO 49+45	
SCALE 1" = 30'	SHEET 19 OF 23 SHEETS
STA 37+61	TO STA. 49+45

F.A.P. RTE	SECTION	COUNTY	TOTAL SHEETS	SHEET NO.
331	(1X-1, 6Z)RS-4	WILLIAMSON	23	19
CONTRACT NO. 78692				
ILLINOIS FED. AID PROJECT				

MODIFIED BY: lrp/brnd
 FILE NAME: \\s:\mclaren\gis\mclaren\DOT_Offices\l\brnd\18692\CADD\mclaren\DOT_78692_S111_C.dwg

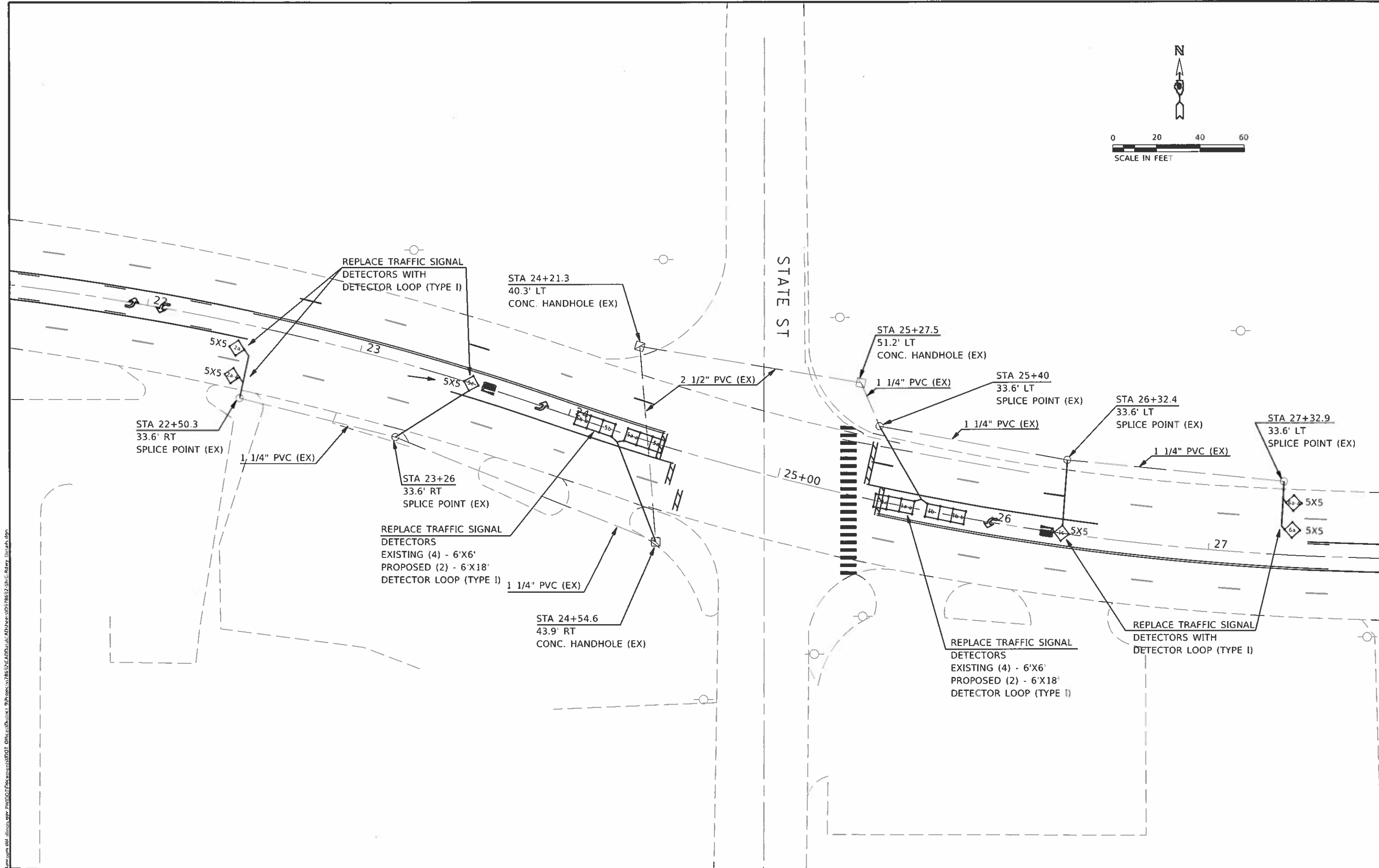
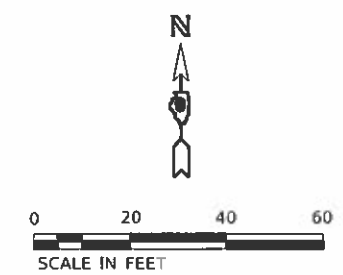

MODIFIED: 5/30/2019
 FILE NAME: \\p1001\proj\78692\dwg\13andstate\13andstate.dwg
 USER: taylorid
 PLOT DATE: 5/30/2019

USER NAME = taylorid	DESIGNED - _____	REVISED - _____
DRAWN - _____	REVISED - _____	
CHECKED - _____	REVISED - _____	
DATE - _____	REVISED - _____	

STATE OF ILLINOIS
DEPARTMENT OF TRANSPORTATION

TRAFFIC SIGNAL DETAILS
ILLINOIS 13 AND STATE STREET
 SCALE: 1" = 20' SHEET 20 OF 23 SHEETS STA. _____ TO STA. _____

F.A.P. RTE.	SECTION	COUNTY	TOTAL SHEETS	SHEET NO.
331	(1X-1, 6Z)RS-4	WILLIAMSON	23	20
CONTRACT NO. 78692				
ILLINOIS FED. AID PROJECT				

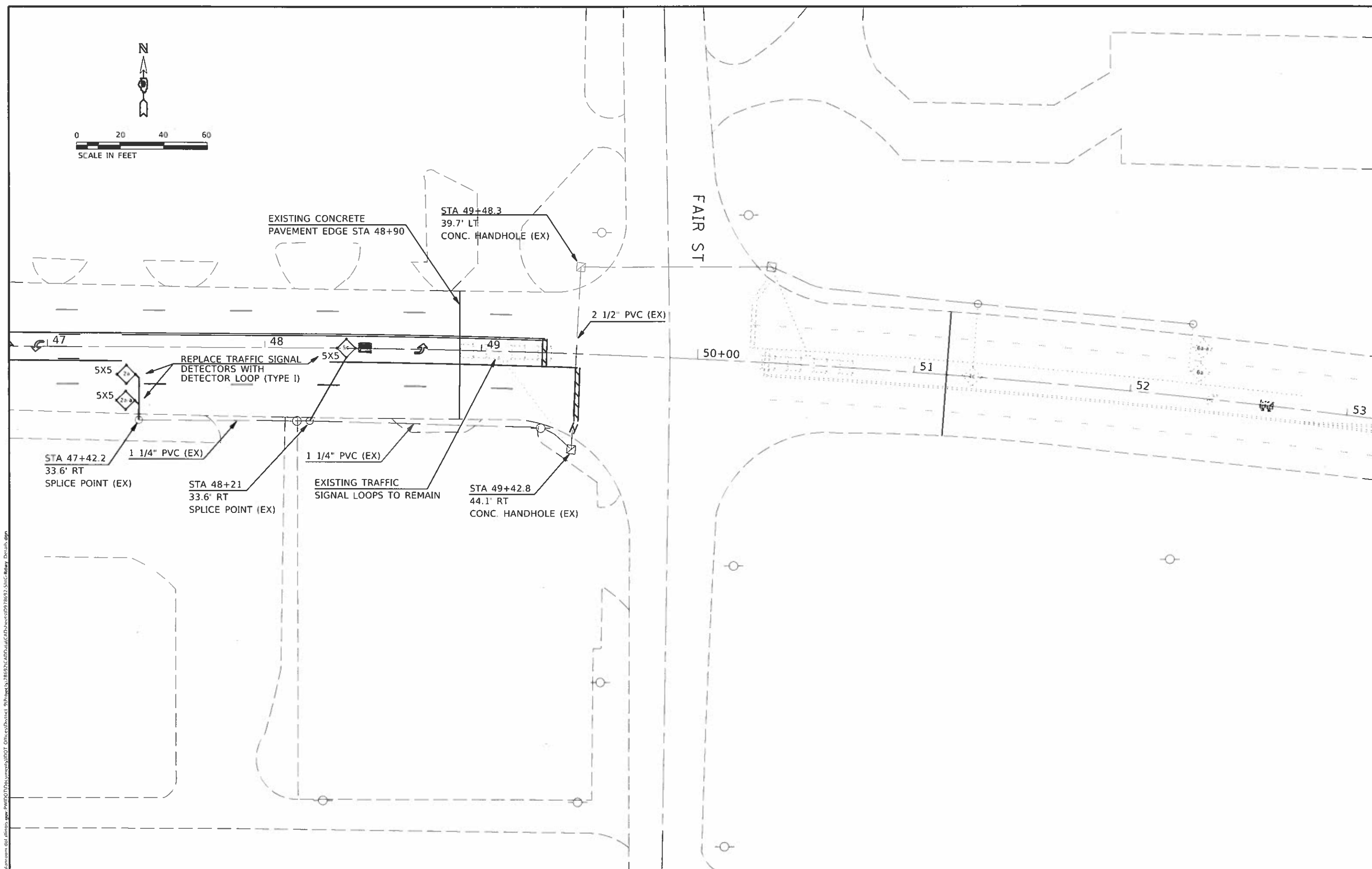

MODIFI: The built
 FILE NAME: p:\planningroom\gdl\illinois\pwr\AWP\DOT\Documents\DOT\Office\District\9\Project\1318692\CAD\CAD\Sheet\0918692_S11C_Signals_Details.dwg

USER NAME = 13ylord	DESIGNED - _____	REVISED - _____
PLOT SCALE = 10.0000 1/2 in	DRAWN - _____	REVISED - _____
PLOT DATE = 5/30/2019	CHECKED - _____	REVISED - _____
	DATE - _____	REVISED - _____

STATE OF ILLINOIS
DEPARTMENT OF TRANSPORTATION

TRAFFIC SIGNAL DETAILS
ILLINOIS 13 AND FAIR STREET

SCALE: 1" = 20' SHEET 21 OF 23 SHEETS STA. _____ TO STA. _____

F.A.P. RTE	SECTION	COUNTY	TOTAL SHEETS	SHEET NO.
331	(1X-1, 6Z)RS-4	WILLIAMSON	23	21
CONTRACT NO. 78692				
ILLINOIS FED. AID PROJECT				

TEMPORARY HOT-MIX ASPHALT TRANSITIONS

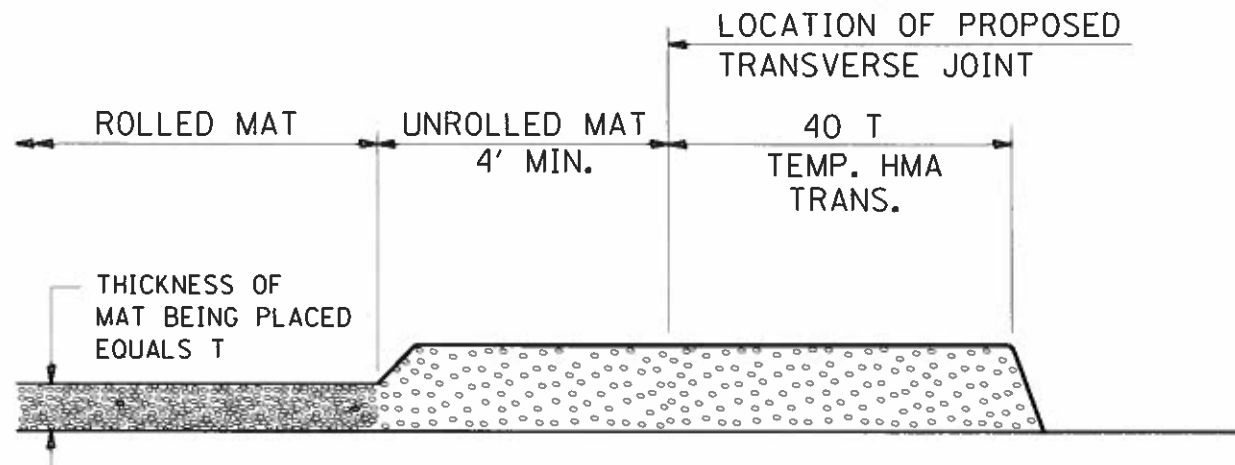

STEP I

1. PLACE HOT-MIX ASPHALT MAT, LENGTH 40 TIMES THE THICKNESS OF THE MAT BEING PLACED PAST THE PROPOSED TRANSVERSE JOINT LOCATION USING NORMAL OPERATING PROCEDURES.
2. EXTREME CARE SHOULD BE TAKEN TO MAINTAIN ENOUGH MATERIAL IN FRONT OF THE SCREED TO MAINTAIN REQUIRED PAVING DEPTH.

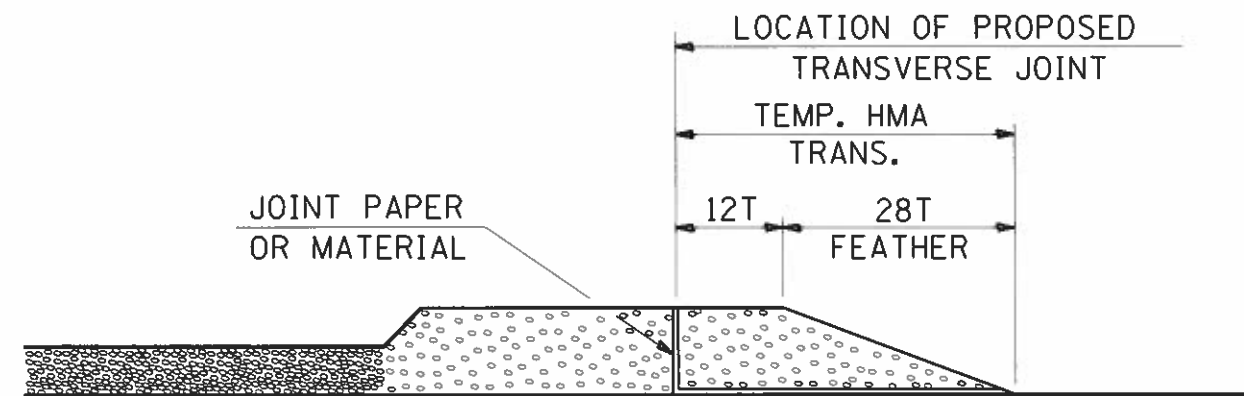

STEP III

1. JOINT PAPER OR OTHER PRESELECTED JOINT MATERIAL IS THEN PLACED IN THE CLEARED AREA AND THE EXCESS ASPHALT USED TO HAND FORM A TRANSITION TO THE DIMENSIONS SHOWN ABOVE.
2. NOTE THAT IN CONSTRUCTING THE TRANSITION, THE MAT DEPTH IS CONTINUED AS PART OF THE TRANSITION BEFORE FORMING THE FEATHER.

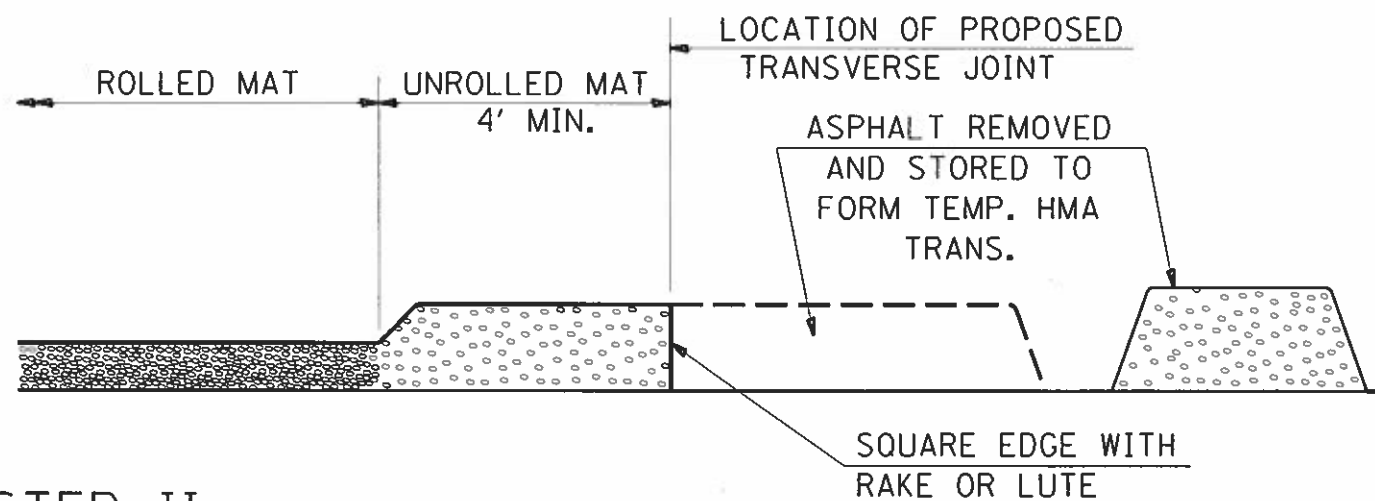

STEP II

1. MOVE THE PAVER OUT OF THE WAY AND REMOVE THE ASPHALT FROM THE AREA OF THE PROPOSED TEMPORARY HOT-MIX ASPHALT TRANSITION.
2. SQUARE UP THE END OF THE MAT WITH A RAKE OR LUTE.
3. NOTE THAT THE MAT WITHIN 4' OF THE END OF JOINT IS NOT TO BE ROLLED AT THIS TIME.

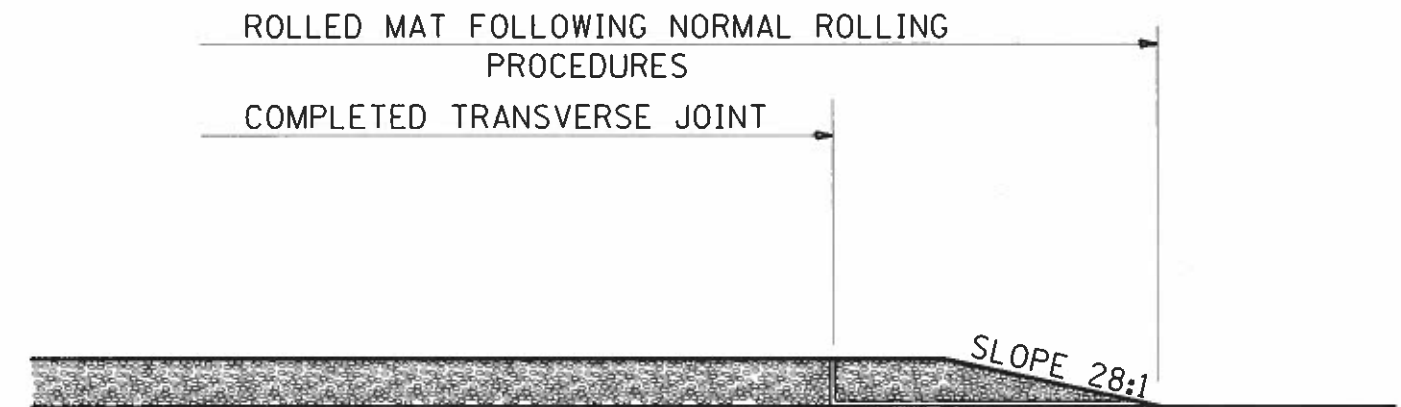

STEP IV

1. COMPLETE TEMPORARY TRANSITION BY ROLLING.
2. TO RESUME PAVING, AT THE JOINT, REMOVE TEMPORARY TRANSITION AND DISPOSE OF THE MATERIAL ACCORDING TO ART. 202.03 OF THE STD. SPECS. (COST INCLUDED IN THE CONTRACT).
3. CONSTRUCTING THE TEMPORARY TRANSITIONS WILL NOT BE PAID FOR SEPARATELY IN ACCORDANCE WITH ARTICLE 406.14 OF THE STANDARD SPECIFICATIONS.

STD. 9-26

REVISIONS	
REDRAWN	2-15-89
REVISED	8-16-94
REVISED	01-09-07
RESIZED	05-8-08
REVISED	05-16-13

MODEL: D:\cadd\pav\pav.dwg
 FILE NAME: pav.dwg
 PLOT DATE: 5/30/2019
 USER: jay
 PLOT SCALE: 100.0000
 PLOT DATE: 5/30/2019

USER NAME = jay	DESIGNED -	REVISED -
PLOT SCALE = 100.0000	DRAWN -	REVISED -
PLOT DATE = 5/30/2019	CHECKED -	REVISED -
	DATE -	REVISED -

STATE OF ILLINOIS
DEPARTMENT OF TRANSPORTATION

PAVEMENT DETAILS

SCALE: N.T.S. SHEET 22 OF 23 SHEETS STA. 5+32 TO STA. 48+90

F.A.P. RATE	SECTION	COUNTY	TOTAL SHEETS	SHEET NO.
331	(1X-1, 6Z)RS-4	WILLIAMSON	23	22
CONTRACT NO. 78692				
ILLINOIS FED. AID PROJECT				

ILLINOIS STANDARD

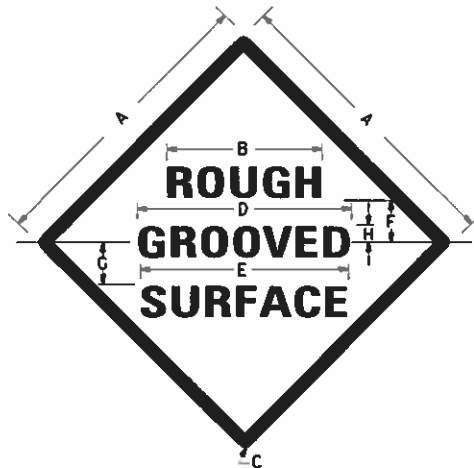

COLORS:

LEGEND AND BORDER- BLACK NON-REFLECTORIZED
BACKGROUND- ORANGE REFLECTORIZED

SIGN SIZE	DIMENSIONS							
	A	B	C	D	E	F	G	H
48X48	48.0	24.1	3.0	34.0	33.0	6.0	13.0	3.5

SIGN SIZE	SERIES LINES			MAR-GIN	BOR-DER	BLANK STD.
	1	2	3			
48X48	7C	7C	7C	0.8	1.2	B4-48D

ALL DIMENSIONS IN INCHES

NOTES:

PRIOR TO ALLOWING TRAFFIC ON ANY PORTION OF THE ROADWAY THAT HAS BEEN COLDMILLED, THE CONTRACTOR SHALL HAVE ERECTED "ROUGH GROOVED SURFACE" SIGNS THAT CONFORM TO THE ABOVE DETAILS. A MINIMUM OF ONE SIGN AT EACH END OF THE IMPROVEMENT WILL BE REQUIRED. THE CONTRACTOR SHALL MAINTAIN THE "ROUGH GROOVED SURFACE" SIGNS UNTIL THE COLDMILLED SURFACE IS COVERED WITH LEVELING BINDER OR SURFACE COURSE.

IF AT ANY TIME THE SIGNS ARE IN PLACE BUT NOT APPLICABLE, THEY SHALL BE TURNED FROM THE VIEW OF MOTORISTS OR COVERED AS DIRECTED BY THE ENGINEER.

THE COST OF FURNISHING, ERECTING, MAINTAINING, AND REMOVING THE REQUIRED SIGNS SHALL BE INCLUDED IN THE CONTRACT.

REVISIONS

REDRAWN	2-15-89
REVISED	4-6-93
REVISED	3-27-08
REVIEWED	5-17-13

STD. 9-39

UNEVEN LANES SIGN

W8-11 (48" x 48")

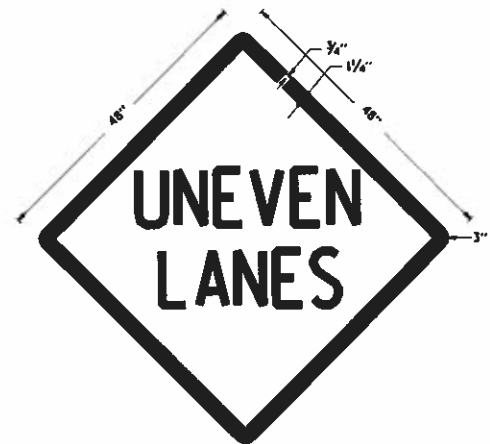

COLORS:

LEGEND AND BORDER - BLACK NON-REFLECTORIZED
BACKGROUND - ORANGE REFLECTORIZED

NOTE: PRIOR TO ALLOWING TRAFFIC ON ANY PORTION OF THE ROADWAY THAT HAS BEEN COLDMILLED OR BEFORE RESURFACING OPERATIONS BEGIN, THE CONTRACTOR SHALL HAVE ERECTED "UNEVEN PAVEMENT" SIGNS THAT CONFORM TO THE ABOVE DETAILS. A MINIMUM OF ONE SIGN AT EACH END OF THE IMPROVEMENT WILL BE REQUIRED. THE CONTRACTOR SHALL MAINTAIN THE "UNEVEN PAVEMENT" SIGNS UNTIL THE RESURFACING OPERATIONS ARE COMPLETED.

IF AT ANY TIME THE SIGNS ARE IN PLACE BUT NOT APPLICABLE, THEY SHALL BE TURNED FROM THE VIEW OF MOTORISTS OR COVERED AS DIRECTED BY THE ENGINEER.

THE COST OF FURNISHING, ERECTING, MAINTAINING, AND REMOVING THE REQUIRED SIGNS SHALL BE INCLUDED IN THE CONTRACT.

REVISIONS

DRAWN	12-15-89
REVISED	4-06-93
REDESIGNED	7-23-04
REVISED	5-08-08
REVIEWED	5-17-13

STD. 9-41

DETAIL OF DETECTOR LOOPS

NOTES

1. THE DETECTOR LOOPS SHALL BE TYPE 1. EACH DETECTOR LOOP SHALL HAVE 3 TURNS OF LOOP WIRE AND BE INSTALLED IN ACCORDANCE WITH THE APPLICABLE PORTIONS OF SECTION 886 OF THE STANDARD SPECIFICATIONS FOR TRAFFIC CONTROL ITEMS.
2. BEGINNING LEAD WIRES SHALL BE CONNECTED TO THE BLACK LEAD AND THE ENDING LEAD WIRES SHALL BE CONNECTED TO THE WHITE LEAD OF THE TWIN TWISTED FEED CABLES AT THE SPLICE POINT.
3. WHERE THE LOOPS ARE INSTALLED PRIOR TO RESURFACING, THE LOOP CORNERS SHALL BE DIAGONALLY CUT.

LOOP LEGEND

- () CLOCKWISE ROTATION FOR LOOP WIRES
- S INDICATES SPLICE POINT FOR DETECTOR LOOP LEAD
- INDICATES 2" CORE-DRILL

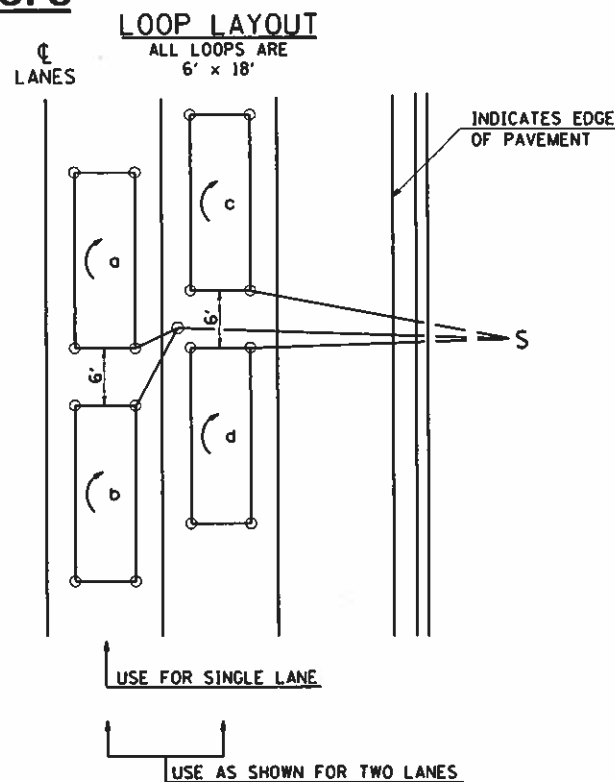

DETAIL 6' x 18' DETECTOR LOOPS

REVISIONS

REDRAWN	5-13-02
REVISED	10-27-05
REVISED	3-26-08
REDRAWN	3-16-11
REVISED	4-12-13

STD. 9-22

SHORT TERM PAVEMENT MARKING DETAIL

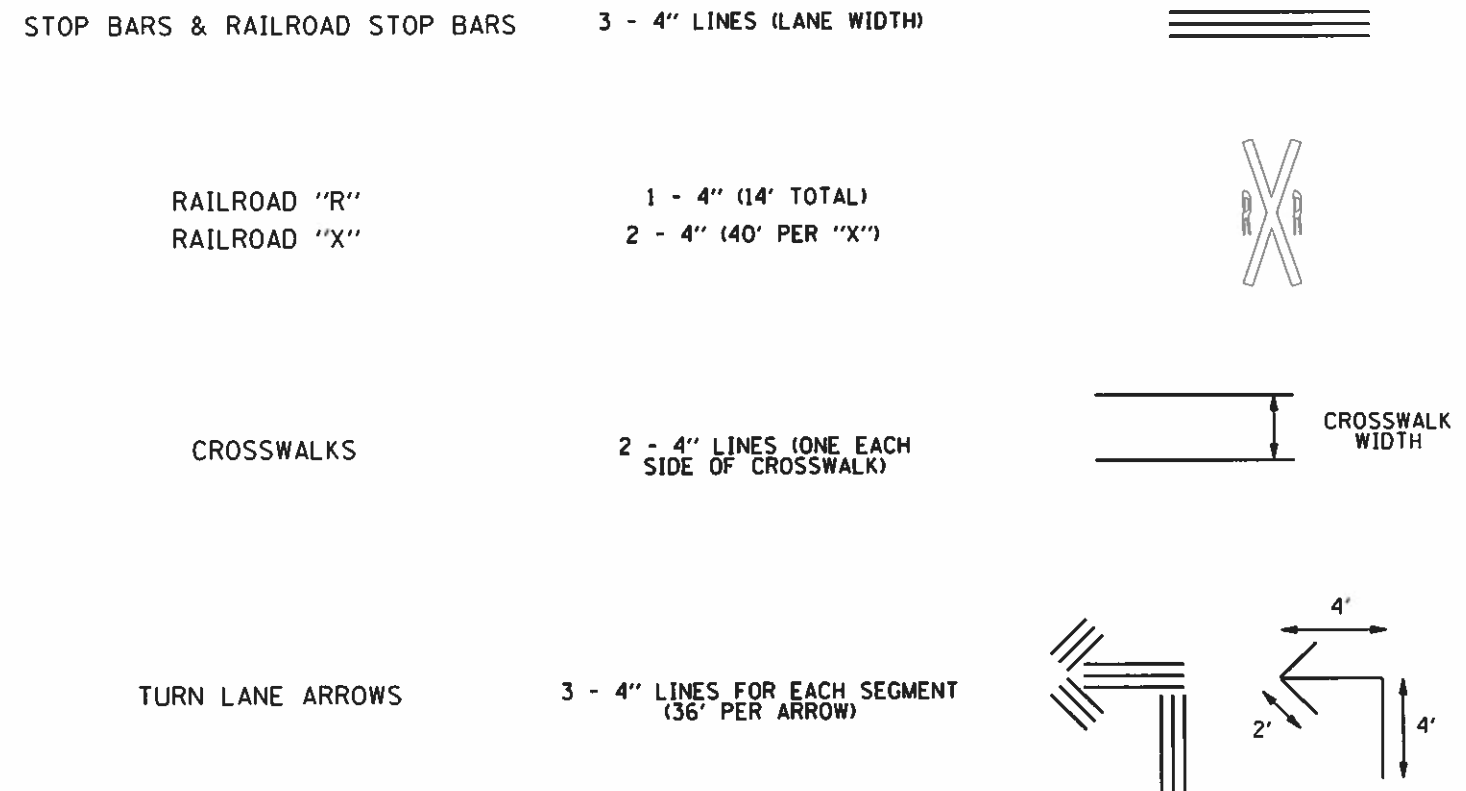

TURN LANE ARROWS

3 - 4" LINES FOR EACH SEGMENT (36' PER ARROW)

USER NAME = taylornd	DESIGNED -	REVISED -
PLOT SCALE = 100.0000 / in	DRAWN -	REVISED -
PLOT DATE = 5/30/2019	CHECKED -	REVISED -
	DATE -	REVISED -

STATE OF ILLINOIS
DEPARTMENT OF TRANSPORTATION

PAVEMENT DETAILS

SCALE: N.T.S. SHEET 23 OF 23 SHEETS STA. 5+32 TO STA. 51+15

F.A.P. RTE.	SECTION	COUNTY	TOTAL SHEETS	SHEET NO.
331	(1X-1, 6Z)RS-4	WILLIAMSON	23	23
CONTRACT NO. 78692				

ILLINOIS FED. AID PROJECT