

STATE OF ILLINOIS
DEPARTMENT OF TRANSPORTATION

F.A.P. RTE.	SECTION	COUNTY	TOTAL SHEETS	SHEET NO.
42	(15,14,13,13-1)RS-6	JACKSON	33	1
		ILLINOIS	CONTRACT NO. 78705	

082

FOR INDEX OF SHEETS, SEE SHEET NO. 3

FOR SUMMARY OF QUANTITIES, SEE SHEET NO. 5-8

PROPOSED HIGHWAY PLANS

F.A.P. 42 ROUTE (IL 13 /127)
SECTION (15,14,13,13-1)RS-6
PROJECT NHPP-VEDW(944)
PATCHING & RESURFACING
JACKSON COUNTY

TRAFFIC DATA

ADT = 4,690 (2019), 5,730 (2039)
7% TRUCKS

TOWNSHIPS

VERGENNES
SOMERSET

DESIGN DESIGNATION : N/A

COORDINATE SYSTEM : ILLINOIS EAST
POSTED SPEED : 50,55 MPH

J.U.L.I.E.
JOINT UTILITY LOCATION INFORMATION FOR EXCAVATION
1-800-892-0123
OR 811

PROJECT ENGINEER: VALERIE ROLLA
PROJECT DESIGNER ROBERT HANDY

CONTRACT NO. 78705

C-99-023-19

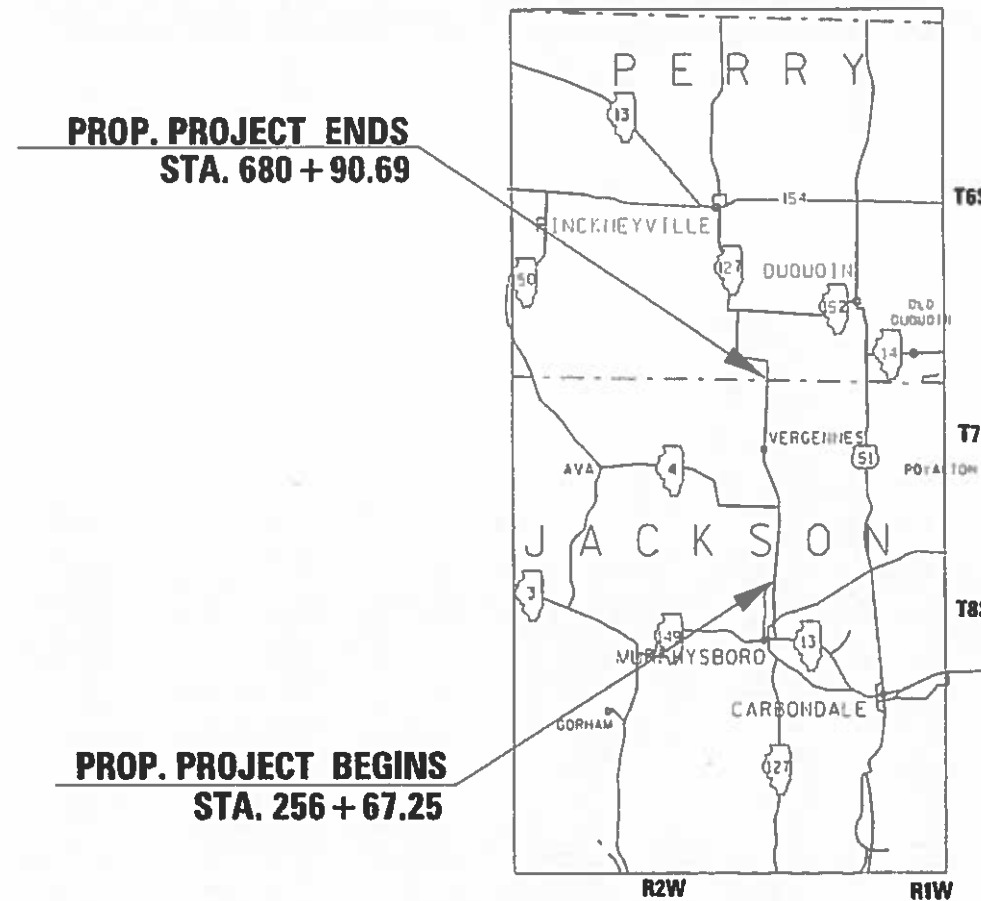

GROSS LENGTH = 42,138.85 FT. = 7.98 MILES
NET LENGTH = 42,138.85 FT. = 7.98 MILES

D-99-010-19



LOCATION OF SECTION INDICATED THUS: - [shaded box] -

STATE OF ILLINOIS
DEPARTMENT OF TRANSPORTATION

SUBMITTED 05-13-2019
[Signature]
REGION FIVE ENGINEER

June 14 2019
[Signature]
ENGINEER OF DESIGN AND ENVIRONMENT

June 14 2019
[Signature]
DIRECTOR OF HIGHWAYS PROJECT IMPLEMENTATION

PRINTED BY THE AUTHORITY
OF THE STATE OF ILLINOIS

Prepared By: Charles Stein
DISTRICT STUDIES & PLANS ENGINEER

Examined By: Nancy Lee
DISTRICT LAND ACQUISITION ENGINEER

Examined By: A. M.
DISTRICT PROGRAM DEVELOPMENT ENGINEER

Examined By: Keel Kelly
DISTRICT OPERATIONS ENGINEER

Examined By: K. Q.
DISTRICT PROJECT IMPLEMENTATION ENGINEER

Examined By: Douglas J. Tuszik
DISTRICT CONSTRUCTION ENGINEER

Examined By: [Signature]
DISTRICT MATERIALS ENGINEER

FILE NAME *	USER NAME = handyc	DESIGNED -	REVISED -
pvc\planroom\dtd_illinois.gov\PWIDOT\Documents\DOT Offices\District 9\Projects\78705\CADData\CADsheets\78705-Sheet		DRAWN -	REVISED -
	PLOT SCALE = 100.0000' / in.	CHECKED -	REVISED -
Default	PLOT DATE = 5/7/2019	DATE -	REVISED -

**STATE OF ILLINOIS
DEPARTMENT OF TRANSPORTATION**

SIGNATURE SHEET

SCALE: SHEET OF SHEETS STA. TO STA.

F.A.P. RTE.	SECTION	COUNTY	TOTAL SHEETS	SHEET NO.
42	(15.14.13.13-1)RS-6	JACKSON	33	2
CONTRACT NO. 78705				
ILLINOIS FED. AID PROJECT				

SHEET NO DESCRIPTION

1	COVER SHEET
2	SIGNATURE SHEET
3	INDEX OF SHEETS, STANDARDS, STATION EQUATIONS, MIXTURE DESIGN
4	GENERAL NOTES, COMMITMENTS, MTD
5-8	SUMMARY OF QUANTITIES
9-11	TYPICAL SECTIONS: IL 13 / 127
12	IL 13 / 127 MAINLINE RESURFACING SCHEDULE
13	IL 13 / 127 SHOULDER PAVING / RUMBLE STRIPS SCHEDULE
14	ENTRANCE SCHEDULE
15	SIDEROAD SCHEDULE
16-19	PAVEMENT MARKING SCHEDULE
20-23	PATCHING SCHEDULE
24	PAVEMENT DELINEATION SCHEDULE CURB RAMPS SCHEDULE
25	PAVEMENT MARKING DETAIL: INTERSECTION OF IL 13 / 127 & TRUAX TRAER RD
26	REMOVAL AT BRYDEN STREET
27	REMOVAL AT CHERRY STREET
28	PROFILE AT BRYDEN STREET PROFILE AT CHERRY AVE
29	PLAN AT BRYDEN STREET
30	PLAN AT CHERRY STREET
31	UNEVEN LANE SIGN DETAIL ROUGH GROOVED SURFACE SIGNS CENTERLINE RUMBLE STRIP DETAIL
32	OVERLAY: SIDEROAD AND ENTRANCE DETAIL
33	BUTT JOINT DETAIL & HMA TRANSITION DETAIL

HMA MIXTURE TABLE

Locations	Class D Patching
Mixture Use(s):	Hot-Mix Asphalt Binder Course, N70, IL-19.0
AC/PG:	PG64-22
ABR % (Max):	See Special Provision
Design Air Voids:	4.0 %, 70 Gyration Design
Mixture (Gradation)	IL-19.0mm
Friction Aggregate:	None
Mixture Weight:	112 lbs/Sq Yd/in
Quality Management	QCQA
Program:	
Sublot Size:	NA

HMA MIXTURE TABLE

Locations	Hot-Mix Asphalt Surface Course
Mixture Use(s):	Hot-Mix Asphalt Surface Course, Mix D, N70
AC/PG:	PG64-22
ABR % (Max):	See Special Provision
Design Air Voids:	4.0 %, 70 Gyration Design
Mixture (Gradation)	IL-9.5mm
Friction Aggregate:	D Surface
Mixture Weight:	112 lbs/Sq Yd/in
Quality Management	PPF
Sublot Size:	TBD

Locations	Hot-Mix Asphalt Leveling Binder
Mixture Use(s):	Hot-Mix Asphalt Leveling Binder, N70, Fine Graded
AC/PG:	PG64-22
ABR % (Max):	See Special Provision
Design Air Voids:	4.0 %, 70 Gyration Design
Mixture (Gradation)	IL-9.5mm Fine Graded
Friction Aggregate:	None
Mixture Weight:	112 lbs/Sq Yd/in
Quality Management	QCP
Sublot Size:	TBD

Locations	Hot-Mix Asphalt Shoulders
Mixture Use(s):	Hot-Mix Asphalt Surface Course, N30, IL-9.5L
AC/PG:	PG64-22
ABR % (Max):	See Special Provision
Design Air Voids:	4.0 %, 30 Gyration Design
Mixture (Gradation)	IL-9.5L
Friction Aggregate:	None
Mixture Weight:	112 lbs/Sq Yd/in
Quality Management	QCQA
Program:	
Sublot Size:	NA

HIGHWAY STANDARDS

000001-07	701201-05
424001-11	701301-04
442201-03	701306-04
482011-03	701311-03
606001-07	701701-10
642006	701901-08
701006-05	780001-05
701011-04	781001-04
	701801-06

STATION EQUATIONS

STA 475+30.80 BK = STA 478+15.39 AH

REV. - MS

MODEL: Default
FILE: MainE_Pxl\planroom.dwg
PROJECT: 78705\CADD\DATA\CADD\Sheets\78705-Sheets.dgn

USER NAME = handyc	DESIGNED -	REVISED -
	DRAWN -	REVISED -
PLOT SCALE = 100.0000 ' / in.	CHECKED -	REVISED -
PLOT DATE = 5/13/2019	DATE -	REVISED -

**STATE OF ILLINOIS
DEPARTMENT OF TRANSPORTATION**

**INDEX OF SHEETS, MIXTURE DESIGN
STANDARDS, STATION EQUATIONS**

SCALE: SHEET OF SHEETS STA. TO STA.

F.A.P. RTE.	SECTION	COUNTY	TOTAL SHEETS	SHEET NO.
42	(15,14,13,13-1)RS-6	JACKSON	33	3
CONTRACT NO. 78705			ILLINOIS FED. AID PROJECT	

GENERAL NOTES

FACTORS USED FOR ESTIMATING PLAN QUANTITIES ARE AS FOLLOWS AND SHALL NOT BE USED FOR THE BASIS OF FINAL QUANTITIES:

ALL HOT MIX ASPHALT 2.016 TONS/CU. YD.

ALL AGGREGATE 2.05 TONS/CU. YD.

THE ALGEBRAIC DIFFERENCE BETWEEN THE PAVEMENT AND SHOULDER SLOPES SHALL NOT EXCEED 8%. THE SHOULDER ON THE OUTSIDE OF SUPERELEVATED CURVES SHALL BE FLATTENED ACCORDINGLY.

THE QUANTITY OF SHORT TERM PAVEMENT MARKING SHOWN IN THE PLANS IS BASED ON ONE APPLICATION EACH FOR THE HMA SURFACE REMOVAL, BINDER COURSE, AND SURFACE COURSE.

THE CONTRACTOR SHALL STAMP STATIONING IN THE PROPOSED HOT MIX ASPHALT SURFACE AT 300 FT INTERVALS ON ALTERNATING SIDES OF THE PAVEMENT AND AS DIRECTED BY THE ENGINEER. THE STATION SYMBOL STAMPS USED SHALL BE FURNISHED BY THE CONTRACTOR. THEY SHALL BE 5 1/2 IN. TALL, OF A DESIGN APPROVED BY THE ENGINEER, AND SHALL REMAIN THE PROPERTY OF THE CONTRACTOR.

HMA RESURFACING SHALL BE PLACED IN A SEQUENCE THAT WILL MINIMIZE THE TIME THE CENTERLINE EDGE IS EXPOSED TO TRAFFIC. WHEN AT THE END OF A DAY'S OPERATION THE EXPOSED CENTERLINE EDGE IS GREATER THAN 2,000 FT, THE CONTRACTOR SHALL BE REQUIRED TO PAVE IN THE ADJACENT LANE ON THE FOLLOWING WORK DAY. PRIOR TO WINTER SHUTDOWN, RESURFACING ON ADJACENT LANES IS TO BE BROUGHT UP TO THE SAME ELEVATION.

PRIOR TO PLACEMENT OF THE FINAL PAVEMENT MARKINGS THE RESIDENT ENGINEER SHALL CONTACT THE BUREAU OF OPERATIONS AND ARRANGE FOR INSPECTION AND APPROVAL OF THE PAVEMENT MARKING LAYOUT.

AFTER A LIFT OF HOT MIX ASPHALT HAS BEEN PLACED, THE LANE SHALL REMAIN CLOSED TO TRAFFIC UNTIL THE NEW MAT HAS COOLED TO 150 DEGREES FAHRENHEIT.

THE CONTRACTOR SHALL COMPLETE ALL PATCHING PRIOR TO THE HOT MIX ASPHALT SURFACE REMOVAL.

TWO APPLICATIONS OF TEMPORARY EROSION CONTROL SEEDING HAVE BEEN INCLUDED. THE ACTUAL QUANTITY LOCATIONS, AND APPLICATIONS SHALL BE DIRECTED BY THE ENGINEER. THE APPLICATION RATE SHALL BE AS PER ARTICLE 280.04 (F)

FORMS SHALL BE MADE OF METAL ONLY, EXCEPT THAT WOOD FORMS MAY BE USED ON SHORT RADIUS CURVES

HMA SURFACE IN THE EXISTING GUTTER FLAGS SHALL BE REMOVED AND INCLUDED IN THE COST OF COMBINATION CURB AND GUTTER REMOVAL

THE RADIUS MEASUREMENTS FOUND ON THE PLAN SHEETS ARE TAKEN FROM THE FLOW LINE OF THE PROPOSED GUTTER

COMMITMENTS: NONE

MTD CROSSING RESTRICTIONS TABLE

SN & CENTERLINE STATION ROUTE (FAP 42)	EXISTING FILL HEIGHT OVER BOX CULVERT	THICKNESS OF EXISTING PAVEMENT OVER BOX CULVERT	MTD CROSSING RESTRICTIONS
	FOOT	FOOT	
CULVERTS			
SN 039-7074 (STA. 380+84)	2.50	1.33	EMPTIED
SN 039-2022 (STA. 425+20)	2.00	1.33	EMPTIED
SN 039-7042 (STA. 485+79)	8.10	1.33	EMPTIED
SN 039-7043 (STA. 545+67)	3.80	1.33	EMPTIED
SN 039-7044 (STA. 574+98)	4.60	1.33	EMPTIED
SN 039-7045 (STA. 590+96)	3.50	1.33	EMPTIED
SN 039-7046 (STA. 620+37)	2.30	1.33	EMPTIED

MODEL: Default
 FILE: \\nrcs-pix\pub\room\dat\links\gov\PIWDOT\Documents\DOT_Offices\District_9\Projects\78705\CADD\DATA\CAD\Sheets\78705-Sheets.dgn

USER NAME = handyc	DESIGNED -	REVISED -
	DRAWN -	REVISED -
PLOT SCALE = 100.0000 ' / in.	CHECKED -	REVISED -
PLOT DATE = 5/13/2019	DATE -	REVISED -

**STATE OF ILLINOIS
DEPARTMENT OF TRANSPORTATION**

GENERAL NOTES & MTD

SCALE: SHEET OF SHEETS STA. TO STA.

F.A.P. RTE.	SECTION	COUNTY	TOTAL SHEETS	SHEET NO.
42	(15,14,13,13-1)RS-6	JACKSON	33	4
CONTRACT NO. 78705				
ILLINOIS			FED. AID PROJECT	

SUMMARY OF QUANTITIES

COUNTY:	JACKSON
ROUTE:	IL 13/127
FUNDING:	80% FED / 20% STATE
LOCATION:	RURAL
	ROADWAY
	0005

CODE NUMBER	ITEM DESCRIPTION	UNIT	QUANTITY
25000200	SEEDING, CLASS 2	ACRE	0.02
25000350	SEEDING, CLASS 7	ACRE	0.02
25000400	NITROGEN FERTILIZER NUTRIENT	POUND	1
25000500	PHOSPHORUS FERTILIZER NUTRIENT	POUND	1
25000600	POTASSIUM FERTILIZER NUTRIENT	POUND	1
25000700	AGRICULTURAL GROUND LIMESTONE	TON	0.04
25100115	MULCH, METHOD 2	ACRE	0.02
28000250	TEMPORARY EROSION CONTROL SEEDING	POUND	1
40600290	BITUMINOUS MATERIALS (TACK COAT)	POUND	95,337
40600637	LEVELING BINDER (MACHINE METHOD), IL-9.5FG, N70	TON	4,792
40600982	HOT-MIX ASPHALT SURFACE REMOVAL - BUTT JOINT	SQ YD	1,569
40600990	TEMPORARY RAMP	SQ YD	16
40603340	HOT-MIX ASPHALT SURFACE COURSE, MIX "D", N70	TON	9,628

MODEL: Default
 FILE: h:\mfc_2019\pub\harcourt\dot\Documents\DOT_Offices\13127.ctb 9:Project\78705\CADD\Drawings\CAD\Sheet\78705-Sheets.dgn

USER NAME = handycr PLOT SCALE = 100.0000 ' / in. PLOT DATE = 5/13/2019	DESIGNED - DRAWN - CHECKED - DATE -	REVISED - REVISED - REVISED - REVISED -	STATE OF ILLINOIS DEPARTMENT OF TRANSPORTATION	SUMMARY OF QUANTITIES	SCALE:	SHEET OF SHEETS STA. TO STA.	F.A.P. RTE. SECTION COUNTY TOTAL SHEETS SHEET NO. 42 (15,14,13,13-1)RS-6 JACKSON 33 5 CONTRACT NO. 78705	ILLINOIS FED. AID PROJECT
---	--	--	---	------------------------------	--------	------------------------------	--	---------------------------

SUMMARY OF QUANTITIES - CONT

COUNTY:	JACKSON
ROUTE:	IL 13/127
FUNDING:	80% FED / 20% STATE
LOCATION:	RURAL
	ROADWAY
	0005

CODE NUMBER	ITEM DESCRIPTION	UNIT	QUANTITY
40800050	INCIDENTAL HOT-MIX ASPHALT SURFACING	TON	165
42400200	PORTLAND CEMENT CONCRETE SIDEWALK 5 INCH	SQ FT	191
42400800	DETECTABLE WARNINGS	SQ FT	25
44000152	HOT-MIX ASPHALT SURFACE REMOVAL, 3/4"	SQ YD	108,966
44000158	HOT-MIX ASPHALT SURFACE REMOVAL, 2 1/4"	SQ YD	8,134
44000500	COMBINATION CURB AND GUTTER REMOVAL	FOOT	35
44000600	SIDEWALK REMOVAL	SQ FT	137
44201835	CLASS D PATCHES, TYPE I, 16 INCH	SQ YD	8
44201839	CLASS D PATCHES, TYPE II, 16 INCH	SQ YD	2,992
44201843	CLASS D PATCHES, TYPE III, 16 INCH	SQ YD	578
44201845	CLASS D PATCHES, TYPE IV, 16 INCH	SQ YD	294
44213204	TIE BARS 3/4"	EACH	10
48102100	AGGREGATE WEDGE SHOULDER, TYPE B	TON	1,466

MODEL: Default
 FILE: \\hpc1\pub\hpc\room\dat\illinois.gov\p\WIDOT\Documents\IDOT_Offices\District_9\Projects\78705\CADD\Drawings\CAD\Sheet\78705-Sheets.dgn

USER NAME = handyc	DESIGNED -	REVISED -	STATE OF ILLINOIS DEPARTMENT OF TRANSPORTATION	SUMMARY OF QUANTITIES	F.A.P. RTE.	SECTION	COUNTY	TOTAL SHEETS	SHEET NO.	
PLOT SCALE = 100,0000 ' / in.	CHECKED -	REVISED -			42	(15,14,13,13-1)RS-6	JACKSON	33	6	
PLOT DATE = 5/13/2019	DATE -	REVISED -			CONTRACT NO. 78705					
					SCALE:	SHEET OF SHEETS	STA. TO STA.	ILLINOIS FED. AID PROJECT		

SUMMARY OF QUANTITIES - CONT

COUNTY:	JACKSON
ROUTE:	IL 13/127
FUNDING:	80% FED / 20% STATE
LOCATION:	RURAL
	ROADWAY
	0005

CODE NUMBER	ITEM DESCRIPTION	UNIT	QUANTITY
48203100	HOT-MIX ASPHALT SHOULDERS	TON	3,426
60605000	COMBINATION CONCRETE CURB AND GUTTER, TYPE B-6.24	FOOT	35
64200108	SHOULDER RUMBLE STRIPS, 8 INCH	FOOT	87,768
67100100	MOBILIZATION	L SUM	1
70100450	TRAFFIC CONTROL AND PROTECTION, STANDARD 701201	L SUM	1
70100460	TRAFFIC CONTROL AND PROTECTION, STANDARD 701306	L SUM	1
70102635	TRAFFIC CONTROL AND PROTECTION, STANDARD 701701	L SUM	1
70102640	TRAFFIC CONTROL AND PROTECTION, STANDARD 701801	L SUM	2
70300100	SHORT TERM PAVEMENT MARKING	FOOT	17,967
70300150	SHORT TERM PAVEMENT MARKING REMOVAL	SQ FT	12,887
70300210	TEMPORARY PAVEMENT MARKING LETTERS AND SYMBOLS	SQ FT	74
70300220	TEMPORARY PAVEMENT MARKING - LINE 4"	FOOT	108,506
70300260	TEMPORARY PAVEMENT MARKING - LINE 12"	FOOT	240

MODEL: Default
 FILE: h:\mhc\p\pub\harcam\dat\illinois\p\p\DOT\Documents\DOT_Offices\Default_9\Project\78705\CADD\DATA\CAD\Sheet\78705_Sheets.dgn

SUMMARY OF QUANTITIES - CONT

COUNTY:	JACKSON
ROUTE:	IL 13/127
FUNDING:	80% FED / 20% STATE
LOCATION:	RURAL
	ROADWAY
	0005

CODE NUMBER	ITEM DESCRIPTION	UNIT	QUANTITY
70300280	TEMPORARY PAVEMENT MARKING - LINE 24"	FOOT	50
* 78000100	THERMOPLASTIC PAVEMENT MARKING - LETTERS AND SYMBOLS	SQ FT	74
* 78000200	THERMOPLASTIC PAVEMENT MARKING - LINE 4"	FOOT	108,506
* 78000600	THERMOPLASTIC PAVEMENT MARKING - LINE 12"	FOOT	240
* 78000650	THERMOPLASTIC PAVEMENT MARKING - LINE 24"	FOOT	50
* 78100100	RAISED REFLECTIVE PAVEMENT MARKER	EACH	420
78300200	RAISED REFLECTIVE PAVEMENT MARKER REMOVAL	EACH	420
X7030005	TEMPORARY PAVEMENT MARKING REMOVAL	SQ FT	37,014
Z0033700	LONGITUDINAL JOINT SEALANT	FOOT	42,145
Z0034105	MATERIAL TRANSFER DEVICE	TON	14,420

* SPECIALTY ITEM

MODEL: Default
 FILE: Model: P:\pub\harcourt\dot\Documents\DOT_Offices\District 9\Projects\78705\CADD\Drawings\78705-Sheets.dgn

USER NAME = handycr PLOT SCALE = 100,0000 ' / in. PLOT DATE = 5/13/2019	DESIGNED - DRAWN - CHECKED - DATE -	REVISED - REVISED - REVISED - REVISED -	STATE OF ILLINOIS DEPARTMENT OF TRANSPORTATION	SUMMARY OF QUANTITIES	F.A.P. RTE. 42 SECTION (15,14,13,13-1)RS-6 COUNTY JACKSON TOTAL SHEETS 33 SHEET NO. 8 CONTRACT NO. 78705	SCALE: SHEET OF SHEETS STA. TO STA. ILLINOIS FED. AID PROJECT
---	--	--	---	------------------------------	---	---

TYPICAL SECTION

N.T.S

IL-13/127
FAP 42

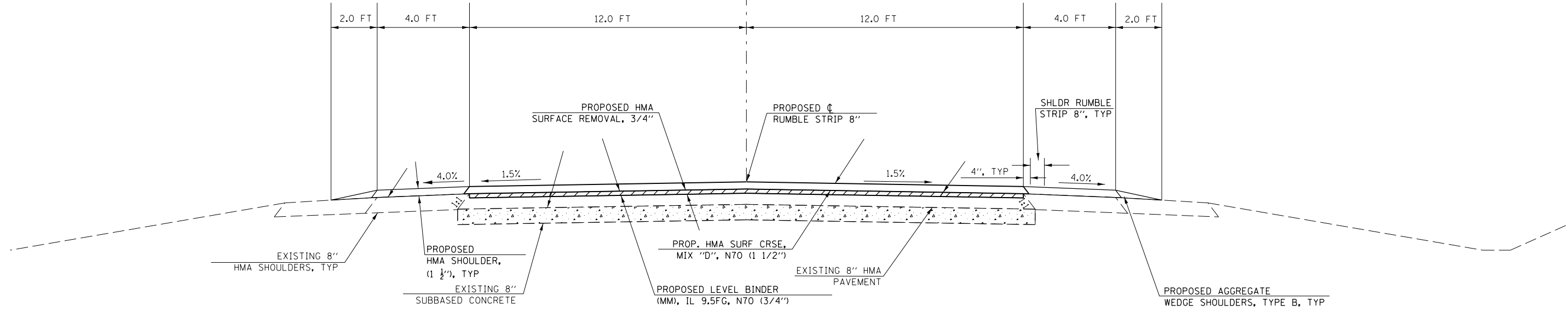

TO BE USED:
STA. 256+67.25 TO STA. 336+52.44

TYPICAL SECTION

N.T.S

IL-13/127
FAP 42

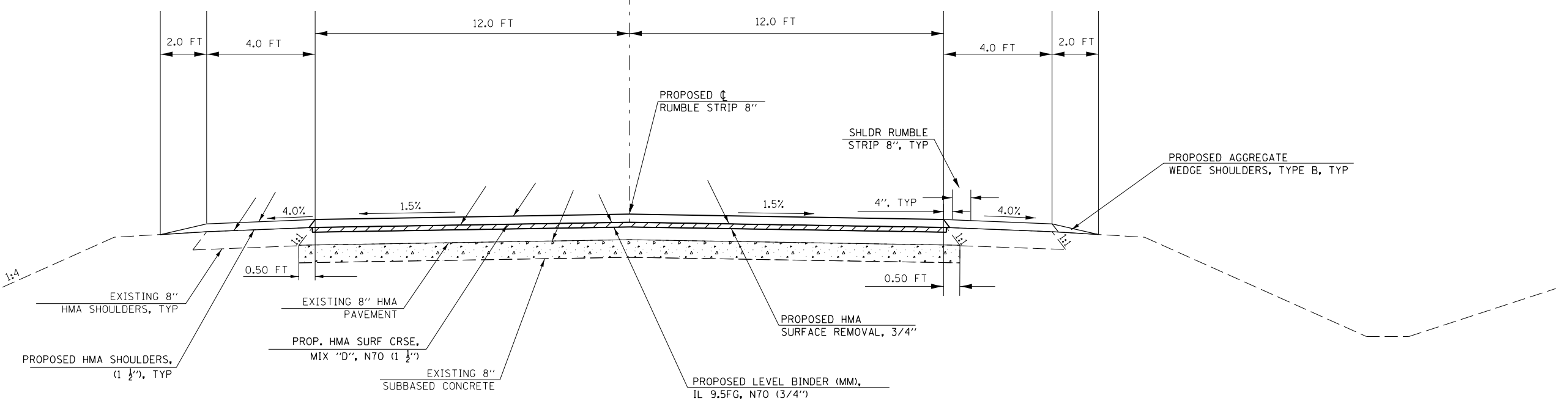

TO BE USED:
STA. 349+50.00 TO STA. 424+85.01
STA. 425+44.06 TO STA. 441+61.50
STA. 480+98.59 TO STA. 488+94.84
STA. 507+33.53 TO STA. 680+90.69

MODEL: Default
FILE: Mainline_TypicalSections\DOT-Office\Drawings\9\Projects\78705\CADD\Drawings\78705-Sheets.dgn

USER NAME = handyc	DESIGNED -	REVISED -
PLOT SCALE = 100.0000' / in.	DRAWN -	REVISED -
PLOT DATE = 5/13/2019	CHECKED -	REVISED -
	DATE -	REVISED -

**STATE OF ILLINOIS
DEPARTMENT OF TRANSPORTATION**

MAINLINE TYPICAL SECTIONS

SCALE: SHEET OF SHEETS STA. TO STA.

F.A.P. RTE.	SECTION	COUNTY	TOTAL SHEETS	SHEET NO.
42	(15,14,13,13-1)RS-6	JACKSON	33	9
CONTRACT NO. 78705				
ILLINOIS FED. AID PROJECT				

TYPICAL SECTION

N.T.S

IL-13/127
FAP 42

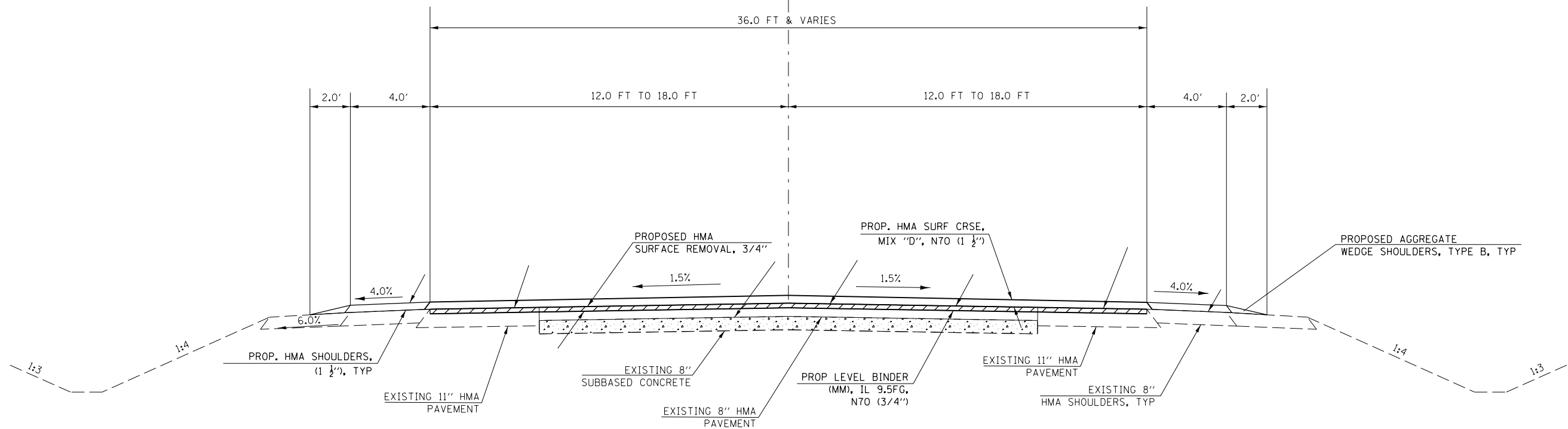

TO BE USED:

STA. 336+52.44 to STA 349+50.00

TRANSITION PVMT: 24' TO 36' PVMT- 336+52.44 TO 339+52.44
TRANSITION PVMT: 36' TO 24' PVMT- 346+29.56 TO 349+50.00

IL-13/127
FAP 42

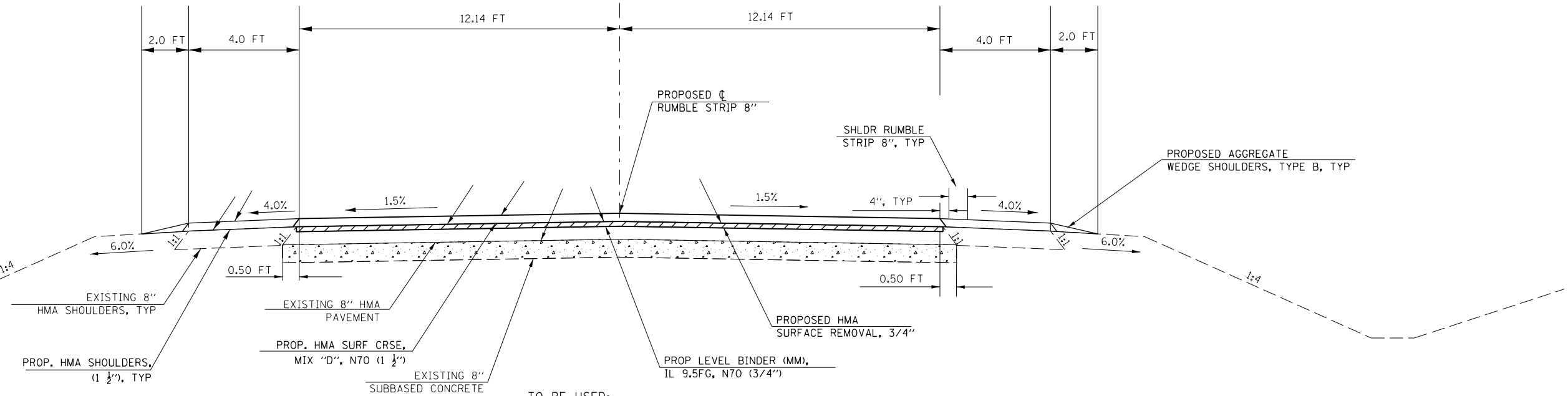

TO BE USED:

STA. 441+61.50 TO STA. 475+30.80
STA. EQ: 475+30.80BK = 478+15.39AH
STA. 478+15.39 TO STA. 480+98.59

MODEL: Default
FILE: h:\mhc\p\pub\harcam\dat\illind\gov\p\pub\harcam\dot\Office\Drawtct_9\Project\78705\CADD\Drawtct_9\78705-Sheets.dgn

USER NAME = handyc	DESIGNED -	REVISED -
PLOT SCALE = 100.0000' / in.	DRAWN -	REVISED -
PLOT DATE = 5/13/2019	CHECKED -	REVISED -
	DATE -	REVISED -

**STATE OF ILLINOIS
DEPARTMENT OF TRANSPORTATION**

MAINLINE TYPICAL SECTIONS

SCALE: SHEET OF SHEETS STA. TO STA.

F.A.P. RTE.	SECTION	COUNTY	TOTAL SHEETS	SHEET NO.
42	(15,14,13,13-1)RS-6	JACKSON	33	10
CONTRACT NO. 78705				
ILLINOIS FED. AID PROJECT				

TYPICAL SECTION

N.T.S

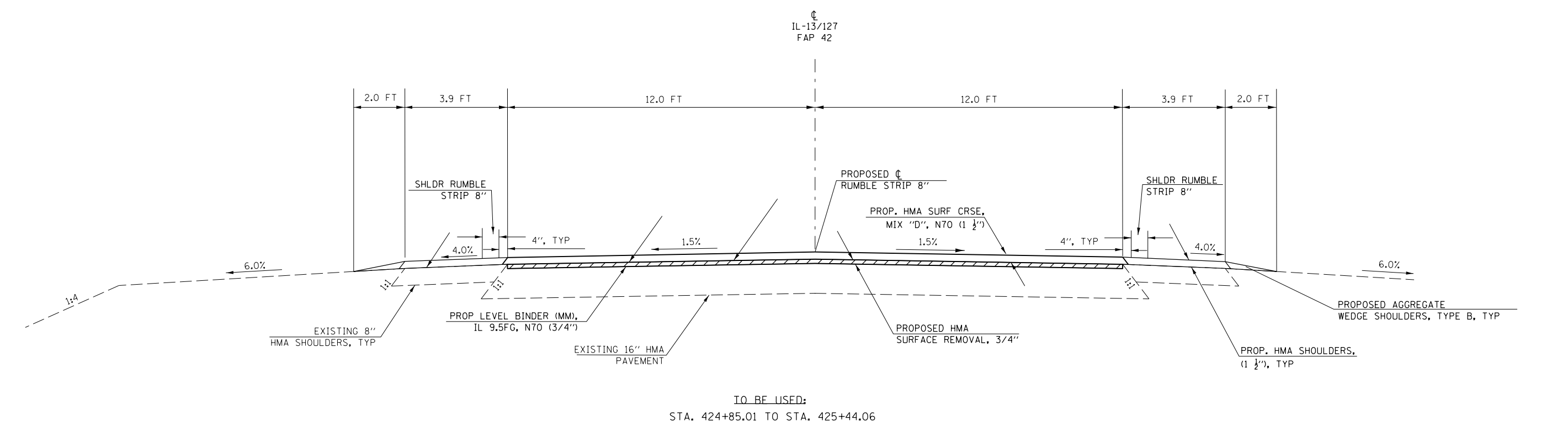
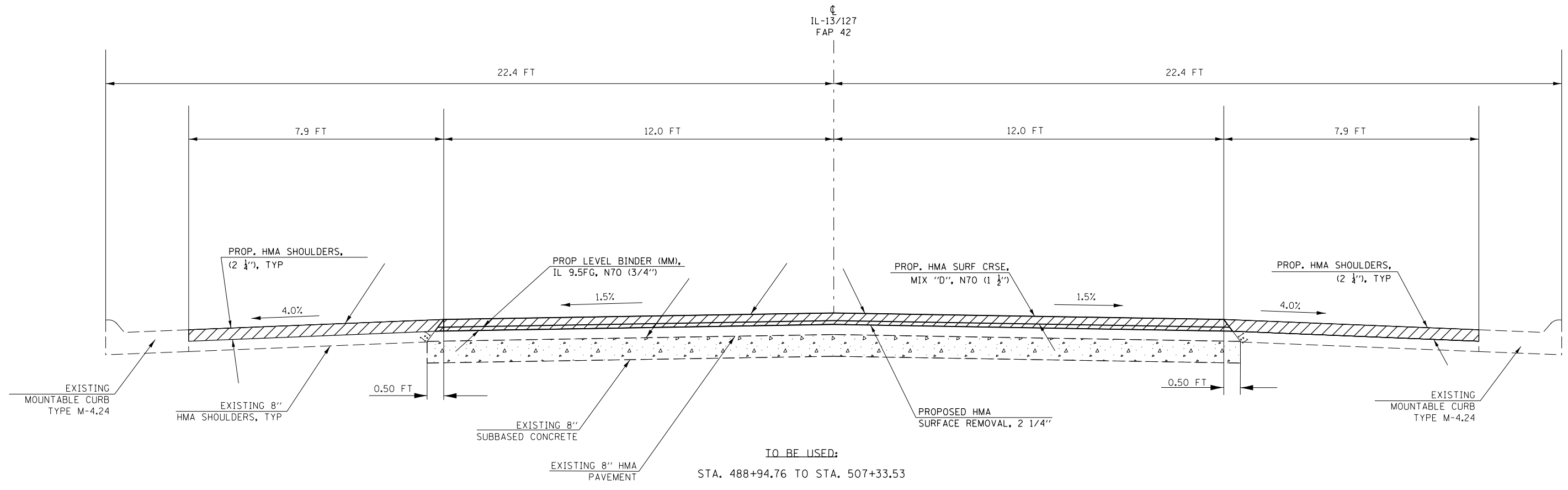

MODEL: Default
FILE: h:\mhc\p\suplanroom\dat\illinois\p\p\WIDOT\Documents\DOT_Offices\Illinet\9\Project\78705\CADD\Drawings\78705-Sheets.dgn

USER NAME = handyc	DESIGNED -	REVISED -
PLOT SCALE = 100.0000' / in.	DRAWN -	REVISED -
PLOT DATE = 5/13/2019	CHECKED -	REVISED -
	DATE -	REVISED -

**STATE OF ILLINOIS
DEPARTMENT OF TRANSPORTATION**

MAINLINE TYPICAL SECTIONS			
SCALE:	SHEET	OF SHEETS	STA. TO STA.

F.A.P. RTE.	SECTION	COUNTY	TOTAL SHEETS	SHEET NO.
42	(15,14,13,13-1)RS-6	JACKSON	33	11
CONTRACT NO. 78705				
ILLINOIS FED. AID PROJECT				

MAINLINE RESURFACING SCHEDULE

LOCATION STATION TO STATION JACKSON COUNTY	LENGTH		ROADWAY WIDTH	HOT-MIX ASP. SURF. REMOV. - BUTT JT. ***	TEMP RAMP	HMA SUR. REMOVAL, 3/4"	HMA SUR. REMOVAL, 2 1/4" * *	HOT-MIX ASP. SUR. CSE., MIX D, N 70 (1 1/2")	LEVELING BINDER (MM) N70 (3/4")	BIT. MAT. (TACK COAT) *	LONG JOINT SEALANT ****	SHLDR RUMBLE STRIPS 8" *****	NOTES		
	FOR INFORMATIONAL PURPOSE ONLY														
	(FT)	(FT)	(SQ YD)	(SQ YD)	(SQ YD)	(SQ YD)	(TON)	(TON)	(LBS)	(FT)	(FT)				
MAINLINE: STA. 256+67.25 TO STA. 680+90.69															
	256+67.25	TO	336+52.44												
LT	256+67.25	TO	336+52.44	7,986	12.0	20	4	10,648		900	448	7,188	7,986	1,997	
RT	256+67.25	TO	336+52.44	7,986	12.0	20	4	10,648		900	448	7,188			
	336+52.44	TO	349+50.00												
LT	336+52.44	TO	339+52.44	300	15.0			500		43	21	338	300		12FT TO 18FT PVMT TRANSITION
RT	336+52.44	TO	339+52.44	300	15.0			500		43	21	338			12FT TO 18FT PVMT TRANSITION
LT	339+52.44	TO	346+29.56	678	18.0	187		1,356		115	57	916	678		BUTT JOINT ALONG IL 4 INTERSECTION
RT	339+52.44	TO	346+29.56	678	18.0			1,356		115	57	916			
LT	346+29.56	TO	349+50.00	321	15.0			535		46	23	362	321		18FT TO 12FT PVMT TRANSITION
RT	346+29.56	TO	349+50.00	321	15.0			535		46	23	362			18FT TO 12FT PVMT TRANSITION
	349+50.00	TO	475+30.80												
LT	349+50.00	TO	441+61.50	9,212	12.0			12,283		1,038	516	8,291	9,212	2,303	
RT	349+50.00	TO	441+61.50	9,212	12.0			12,283		1,038	516	8,291			
LT	441+61.50	TO	475+30.80	3,370	12.2			4,569		386	192	3,084	3,370	843	
RT	441+61.50	TO	475+30.80	3,370	12.2			4,569		386	192	3,084			
STA. EQ. 475+30.80 BK = STA. 478+15.39 AH															
	478+15.39	TO	488+94.76												
LT	478+15.39	TO	480+98.59	284	12.2			385		33	17	260	284	71	
RT	478+15.39	TO	480+98.59	284	12.2			385		33	17	260			
LT	480+98.59	TO	488+94.76	797	12.0			1,063		90	45	718	797	200	
RT	480+98.59	TO	488+94.76	797	12.0			1,063		90	45	718			
	488+94.73	TO	507+33.53												VILLAGE OF VERGENNES
LT	488+94.76	TO	507+33.53	1,839	12.0			2,452	208	104	1,656	1,839			CONCRETE CURB AND GUTTER
RT	488+94.76	TO	507+33.53	1,839	12.0			2,452	208	104	1,656				CONCRETE CURB AND GUTTER
	507+33.53	TO	680+90.69												
LT	507+33.53	TO	680+90.69	17,358	12.0	20	4	23,144		1,955	973	15,623	17,358	4,340	
RT	507+33.53	TO	680+90.69	17,358	12.0	20	4	23,144		1,955	973	15,623			
TOTALS						267	16	108,966	4,904	9,628	4,792	76,872	42,145	9,754	

- * ADDITIONAL QUANTITIES, SEE SHOULDER PAVING/RUMBLE STRIPS, ENTRANCE & SIDE ROAD SCHEDULES
- ** ADDITIONAL QUANTITIES, SEE SHOULDER PAVING/RUMBLE STRIPS SCHEDULE
- *** ADDITIONAL QUANTITIES, SEE SHOULDER PAVING/RUMBLE STRIPS & SIDE ROAD SCHEDULES
- **** LJS LOCATED @ CENTERLINE JOINT
- ***** ADDITIONAL QUANTITIES, SEE SHOULDER PAVING/RUMBLE STRIPS SCHEDULE & CENTERLINE RUMBLE STRIPS PAID FOR AS SHOULDER RUMBLE STRIPS, 8 INCH

MODEL: Default
FILE: Mainline_PavingRumbleStrips.dwg
Project: 78705-CA00DataCAD: 78705-Sheets.dwg
Office: IDOT
Documents: IDOT
Path: \\lanroom.dia.illinois.gov\PIWDOT\Documents\IDOT

USER NAME = handycr	DESIGNED -	REVISED -	STATE OF ILLINOIS DEPARTMENT OF TRANSPORTATION	MAINLINE RESURFACING SCHEDULE	F.A.P. RTE.	SECTION	COUNTY	TOTAL SHEETS	SHEET NO.	
PLOT SCALE = 100,0000' / in.	DRAWN -	REVISED -			42	(15,14,13,13-1)RS-6	JACKSON	33	12	
PLOT DATE = 5/13/2019	CHECKED -	REVISED -			CONTRACT NO. 78705					
	DATE -	REVISED -			SCALE:	SHEET	OF	SHEETS	STA.	TO

ILLINOIS FED. AID PROJECT

SHOULDER PAVING/RUMBLE STRIPS SCHEDULE

LOCATION STATION TO STATION JACKSON COUNTY			LENGTH	PAVE SHOULDER WIDTH	AGGERGATE SHOULDER WIDTH	HOT-MIX ASP. SURF. REMOV. - BUTT JT. ***	HMA SUR. REMOVAL 2 1/4" **	AGG WEDGE SHLDER, TYPE B ****	SHOULDER RUMBLE STRIPS 8" **	HMA SHLDER	BIT. MATERIALS (TACK COAT) *	NOTES
			FOR INFORMATIONAL PURPOSE ONLY			(SQ. YD.)	(SQ. YD.)	(TON)	(FT)	(TON)	(POUNDS)	
			(FT)	(FT)	(FT)	(SQ. YD.)	(SQ. YD.)	(TON)	(FT)	(TON)	(POUNDS)	
MAINLINE: STA. 256+67.25 TO STA. 678+11.61												
	256+67.25	TO	336+52.44									
LT	256+67.25	TO	336+52.44	7,986	4.0	2.0	7.0		143	7,986	299	1,598
RT	256+67.25	TO	336+52.44	7,986	4.0	2.0	7.0		143	7,986	299	1,598
	336+52.44	TO	349+50.00									
LT	336+52.44	TO	339+52.44	300	4.0	2.0			6		12	60
RT	336+52.44	TO	339+52.44	300	4.0	2.0			6		12	60
LT	339+52.44	TO	346+29.59	678	4.0	2.0			13		26	136
RT	339+52.44	TO	346+29.59	678	4.0	2.0			13		26	136
LT	346+29.59	TO	349+50.00	321	4.0	2.0			6		12	65
RT	346+29.59	TO	349+50.00	321	4.0	2.0			6		12	65
	349+50.00	TO	475+30.80									
LT	349+50.00	TO	424+85.01	7,536	4.0	2.0			135	7,536	282	1,508
RT	349+50.00	TO	424+85.01	7,536	4.0	2.0			135	7,536	282	1,508
LT	424+85.01	TO	425+44.06	60	3.9	2.0			2	60	3	12
RT	424+85.01	TO	425+44.06	60	3.9	2.0			2	60	3	12
LT	425+44.06	TO	475+30.80	4,987	4.0	2.0			89	4,987	187	998
RT	425+44.06	TO	475+30.80	4,987	4.0	2.0			89	4,987	187	998
STA. EQ. 475+30.80 BK = STA. 478+15.39 AH												
	478+15.39	TO	488+94.76									
LT	478+15.39	TO	488+94.76	1,080	4.0	2.0			20	1,080	41	216
RT	478+15.39	TO	488+94.76	1,080	4.0	2.0			20	1,080	41	216
	488+94.73	TO	507+33.53									
LT	488+94.76	TO	507+33.53	1,839	7.9			1,615		202		727
RT	488+94.76	TO	507+33.53	1,839	7.9			1,615		202		727
	507+33.53	TO	680+90.69									
LT	507+33.53	TO	680+90.69	17,358	4.0	2.0	7.0		309	17,358	649	3,472
RT	507+33.53	TO	680+90.69	17,358	4.0	2.0	7.0		309	17,358	649	3,472
TOTALS							28	3,230	1,446	78,014	3,426	17,584

- * ADDITIONAL QUANTITIES, SEE MAINLINE RESURFACING, ENTRANCE & SIDE ROAD SCHEDULES
- ** ADDITIONAL QUANTITIES, SEE MAINLINE RESURFACING SCHEDULES
- *** ADDITIONAL QUANTITIES, SEE MAINLINE RESURFACING & SIDEROAD SCHEDULES
- **** ADDITIONAL QUANTITIES, SEE ENTRANCE SCHEDULES

MODEL: Default
 FILE: \\pbl\lanroom\dta\illinois.gov\PIWDOT\Documents\DOT_Offices\District 9\Projects\78705\CADD\Drawings\DOT_78705_Sheets.dgn

USER NAME = handyc	DESIGNED -	REVISED -
	DRAWN -	REVISED -
PLOT SCALE = 100,0000' / in.	CHECKED -	REVISED -
PLOT DATE = 5/13/2019	DATE -	REVISED -

**STATE OF ILLINOIS
DEPARTMENT OF TRANSPORTATION**

SHOULDER RESURFACING SCHEDULE

SCALE: SHEET OF SHEETS STA. TO STA.

F.A.P. RTE.	SECTION	COUNTY	TOTAL SHEETS	SHEET NO.
42	(15,14,13,13-1)RS-6	JACKSON	33	13
CONTRACT NO. 78705				
		ILLINOIS FED. AID PROJECT		

ENTRANCE SCHEDULE

LOCATION: FAP 42 (IL 13 / 127)	ENTRANCE TYPE	EXIST. SURFACE	WIDTH AT 4' OFFSET	WIDTH AT 8' OFFSET	ROADWAY AREA	INCIDENTAL HMA SURFACING (1 1/2") **	AGGREGATE WEDGE SHOULDER, TYPE B ****	BIT. MAT. (TACK COAT) *		
		FOR INFORMATIONAL PURPOSES ONLY						TON	TON	POUND
		TYPE	FT	FT	SQ YD	TON	TON	POUND		
ENTRANCES										
257+63 LT	PE	HMA	37	29	15	1		7		
264+75 LT	PE	HMA	31	25	13	1		6		
271+85 LT	PE	AGG	32	27	14		1			
272+60 LT	PE	AGG	24	21	10		1			
280+15 LT	PE	HMA	26	21	11	1		5		
293+78 LT	PE	AGG	20	16	8		1			
294+78 RT	CE	HMA	138	118	57	4		26		
301+17 RT	CE	AGG	93	72	37		3			
313+30 RT	CE	PCC	83	69	34	2		16		
334+22 RT	PE	AGG	25	21	11		1			
371+84 LT	PE	AGG	70	60	29		2			
410+00 LT	PE	HMA	33	27	14	1		7		
430+68 RT	PE	GRASS	37	30	15					
432+82 RT	PE	HMA	28	21	11	1		5		
441+56 LT	PE	HMA	38	31	16	1		8		
449+34 LT	PE	HMA	54	46	23	2		11		
464+40 LT	PE	HMA	44	35	18	2		9		
474+35 LT	PE	HMA	35	31	15	1		7		
479+30 LT	PE	AGG	60	50	25					
479+30 RT	PE	HMA	33	27	14	1		7		
497+58 LT	CE	HMA	82	57	31	2		14		
498+76 LT	CE	HMA	73	54	29	2		14		
508+64 LT	PE	HMA	71	68	31	2		14		
510+85 LT	PE	AGG	50	30	18					
513+01 LT	PE	HMA	52	43	22	2		10		
522+80 LT	PE	GRASS	44	38	19					
540+39 LT	PE	GRASS	44	33	18					
549+00 LT	PE	HMA	27	22	11	1		5		
552+41 LT	CE	HMA	44	38	19	2		9		
552+41 RT	PE	AGG	44	36	18		2			
560+60 LT	PE	HMA	34	31	15	1		7		
561+93 LT	PE	HMA	33	29	14	1		7		
564+00 RT	PE	GRASS	73	68	32					
569+73 LT	PE	AGG	23	18	10					
577+26 RT	PE	AGG	29	23	12		1			
578+50 RT	PE	AGG	42	38	18		2			
581+67 LT	PE	HMA	38	34	16	1		8		
583+24 RT	PE	HMA	25	20	10	1		5		
583+88 RT	PE	HMA	26	21	11	1		5		
584+39 LT	CE	AGG	45	40	19		2			
599+85 RT	PE	HMA	37	32	16	1		8		
600+84 LT	PE	HMA	30	26	13	1		6		
600+84 RT	CE	AGG	39	30	16		1			
604+56 RT	PE	HMA	36	30	15	1		7		
650+56 RT	PE	HMA	27	22	11	1		5		
650+65 RT	PE	HMA	27	21	11	1		5		
665+15 LT	PE	HMA	51	41	21	2		10		
658+10 RT	PE	HMA	66	57	28	2		13		
666+32 RT	PE	HMA	28	20	11	1		5		
667+20 RT	PE	HMA	27	18	10	1		5		
677+50 LT	CE	AGG	98	95	43		3			
ENTRANCE TOTALS						45	20	276		

* ADDITIONAL QUANTITIES,SEE MAINLINE RESURFACING, SHOULDER & SIDE ROAD SCHEDULES

** ADDITIONAL QUANTITIES, SEE SIDEROAD SCHEDULE

**** ADDITIONAL QUANTITIES, SEE SHOULDER PAVING/RUMBLE STRIPS SCHEDULE

MODEL: Default
FILE: Model: 20190508.dwg
PROJECT: 78705-CAADDataCAD: 20190508.dwg
PROJECT: 78705-CAADDataCAD: 20190508.dwg
PROJECT: 78705-CAADDataCAD: 20190508.dwg

USER NAME = handyc	DESIGNED -	REVISED -
	DRAWN -	REVISED -
PLOT SCALE = 100.0000' / in.	CHECKED -	REVISED -
PLOT DATE = 5/13/2019	DATE -	REVISED -

**STATE OF ILLINOIS
DEPARTMENT OF TRANSPORTATION**

ENTRANCE RESURFACING SCHEDULE

SCALE: SHEET OF SHEETS STA. TO STA.

F.A.P. RTE.	SECTION	COUNTY	TOTAL SHEETS	SHEET NO.
42	(15,14,13,13-1)RS-6	JACKSON	33	14
CONTRACT NO. 78705				
ILLINOIS FED. AID PROJECT				

SIDE ROAD SCHEDULE

LOCATION			EXIST. SURFACE	EP WIDTH	WIDTH AT 15' OFFSET	ROADWAY AREA	HMA SURFACE REMOVAL -BUTT JOINT	INCIDENTAL HMA SURFACING ** (1 1/2")	BIT. MAT. (TACK COAT) *	NOTES	
											FOR INFORMATIONAL PURPOSE ONLY
				(FT)	(FT)	(SQ YD)	(SQ YD)	(TON)	(LBS)		
FAP 42 (IL. 13/127)											
RT.	266+41	FINNY RD	HMA	66	35	85	85	8	38		
RT.	307+27	FINNY RD	HMA	107	63	142	142	12	64		
LT.	321+03	DEER CREEK	HMA	72	43	96	32	9	44		
RT.	343+00	TRUAX TRAER RD	HMA	207	107	262	262	22	118		
RT.	370+77	PARRISH RD	HMA	61	36	81	81	7	37		
RT.	400+58	BETHEL RD	HMA	74	32	89	89	8	40		
LT.	400+86	GALE RD	HMA	57	26	70	70	6	32		
LT.	519+39	BEAUCOUP RD	HMA	80	38	99	99	9	45		
RT.	519+39	ELKVILLE RD	HMA	122	50	144	144	13	65		
LT.	574+00	DAVIS RD	HMA	49	23	60	60	6	27		
RT.	574+00	TOW RD	HMA	50	24	62	62	6	28		
LT.	628+50	DOWEL RD	HMA	61	26	73	73	7	33		
RT.	628+50	DOWEL RD	HMA	62	28	75	75	7	34		
SIDE ROAD TOTALS								1,274	120	605	

- * ADDITIONAL QUANTITIES,SEE MAINLINE RESURFACING, SHOULDER PAVING/RUMBLE STRIPS & ENTRANCE ROAD SCHEDULES
- ** ADDITIONAL QUANTITIES, SEE ENTRANCE SCHEDULE

MODEL: Default
 FILE: Mainline_PlanUploadRoom.dwg
 I:\Projects\78705\CADDData\CAD\Sheets\78705-Sheets.dwg

PAVEMENT MARKING SCHEDULE

LOCATION STATION TO STATION	LENGTH (INFO. ONLY)	THERMOPLASTIC PVT MARK LINE										TEMPORARY MARKING REMOVAL	NOTES
		WHITE 4"		YELLOW 4"						YELLOW 12"			
		SOILD EDGE PMVT LT & RT PVMT	TURN LANES	LEFT SKIP DASH	LEFT SOLID LINE	CL SKIP DASH	RIGHT SKIP DASH	RIGHT SOLID LINE	DOUBLE LINE	DIAGONAL LINE			
FAP 42 (IL 13/127)		FOOT	FOOT	FOOT	FOOT	FOOT	FOOT	FOOT	FOOT	FOOT	SQ FT		
STA 256+67.25 TO STA 264+93.42	826	1,652			826		207					896	
STA 264+93.42 TO STA 266+78.96	186	306								371		226	FINNY RD-65FT
STA 266+78.96 TO STA 272+30.00	551	1,102			138				551			598	
STA 272+30.00 TO STA 274+00.00	170	340				43						128	
STA 274+00.00 TO STA 279+63.24	563	1,126				563		141				611	
STA 279+63.24 TO STA 336+58.80	5,696	11,214					1,424					4,213	FINNY RD-105FT / DEER CREEK RD-72FT
STA 336+58.80 TO STA 349+50.00	1,291	2,364	220							4,018	240	2,615	TRAUX TRAER RD -INTERSECTION-218FT
STA 349+50.00 TO STA 397+81.89	4,832	9,602					1,208					3,604	PARRISH RD-62FT
STA 397+81.89 TO STA 403+52.89	571	1,102			143				571			606	GALE RD-18FT / BETHEL RD-22FT
STA 403+52.89 TO STA 409+07.00	554	1,108					139					416	
STA 409+07.00 TO STA 414+45.00	538	1,076				538		135				583	
STA 414+45.00 TO STA 422+98.84	854	1,708					214					641	
STA 422+98.84 TO STA 428+15.00	516	1,032			130				516			560	
STA 428+15.00 TO STA 433+24.00	509	1,018					128					382	
STA 433+24.00 TO STA 439+17.00	593	1,186				593		149				643	
STA 439+17.00 TO STA 475+30.80	3,614	7,228					904					2,711	
STA EQ. 475+30.80 BK = 478+15.39 AH													
SUB TOTALS		43,165	220	411	2,520	4,060	632	1,638	4,389	240		19,433	

MODEL: Default
 FILE: h:\mhc\pav\pub\haronom.dwg
 PROJECT: 78705\CAD\DATA\CAD\haronom.dwg
 OFFICE: J:\DOT\Documents\DOT - Office\J\haronom.dwg
 PLOT DATE: 5/13/2019

USER NAME = handyc	DESIGNED -	REVISED -
	DRAWN -	REVISED -
PLOT SCALE = 100,0000' / in.	CHECKED -	REVISED -
PLOT DATE = 5/13/2019	DATE -	REVISED -

**STATE OF ILLINOIS
DEPARTMENT OF TRANSPORTATION**

PAVEMENT MARKING SCHEDULE	
SCALE:	SHEET OF SHEETS STA. TO STA.

F.A.P. RTE.	SECTION	COUNTY	TOTAL SHEETS	SHEET NO.
42	(15,14,13,13-1)RS-6	JACKSON	33	16
			CONTRACT NO. 78705	
		ILLINOIS FED. AID PROJECT		

PAVEMENT MARKING SCHEDULE CONT.

LOCATION STATION TO STATION	LENGTH (INFO. ONLY)	THERMOPLASTIC PVT MARK LINE										TEMPORARY MARKING REMOVAL *	NOTES	
		WHITE 4"		YELLOW 4"						YELLOW 12"				
		SOILD EDGE PMVT LT & RT PVMT	TURN LANES	LEFT SKIP DASH	LEFT SOLID LINE	CL SKIP DASH	RIGHT SKIP DASH	RIGHT SOLID LINE	DOUBLE LINE	DIAGONAL LINE				
FAP 42 (IL 13/127)	FOOT	FOOT	FOOT	FOOT	FOOT	FOOT	FOOT	FOOT	FOOT	FOOT	SQ FT			
STA EQ. 475+30.80 BK = 478+15.39 AH														
STA	475+30.80	TO STA	488+94.76	1,364	2,673				341				1,005	SUBTRACT 55FT FOR WHITE SOLID LINE CURB AND GUTTER
STA	488+94.76	TO STA	507+33.53	1,839				460					154	
STA	507+33.53	TO STA	517+50.64	1,017	2,034			255					764	
STA	517+50.64	TO STA	527+41.17	991	1,901		248				991		1,047	BEAUCOUP 28FT / ELKVILLE 52FT
STA	527+41.17	TO STA	533+66.00	625	1,250							1,250	834	
STA	533+66.00	TO STA	540+30.00	664	1,328			664	166				720	
STA	540+30.00	TO STA	573+00.00	3,270	6,540			818					2,453	
STA	573+00.00	TO STA	579+21.33	621	1,143		156				621		640	DAVIS RD 50FT / TOW RD 50FT
STA	579+21.33	TO STA	582+80.00	359	717			90					270	
STA	582+80.00	TO STA	589+45.00	665	1,330			665	167				721	
STA	589+45.00	TO STA	592+25.60	281	561			71					211	
STA	592+25.60	TO STA	599+79.24	754	1,507		189				754		817	
STA	599+79.24	TO STA	603+40.00	361	722			91					271	
STA	603+40.00	TO STA	609+81.02	641	1,282			641	161				695	
STA	609+81.02	TO STA	624+20.79	1,440	2,880			360					1,080	
STA	624+20.79	TO STA	634+91.60	1,071	2,018		268				1,071		1,119	DOWELL RD INTERSECTION-124FT
STA	634+91.60	TO STA	636+66.15	175	349							349	233	
STA	636+66.15	TO STA	647+29.18	1,063	2,126			1,063	266				1,152	
STA	647+29.18	TO STA	657+54.39	1,025	2,050			257					770	
STA	657+54.39	TO STA	665+37.60	783	1,566		196				783		849	
STA	665+37.60	TO STA	668+76.82	339	626			85					238	BIGHAM RD-52FT
STA	668+76.82	TO STA	675+15.38	639	1,277			639	160				692	
STA	675+15.38	TO STA	680+90.69	575	1,151			144					432	
SUB TOTALS					37,031		1,057	3,672	2,972	920	4,220	1,599	17,167	
TOTALS					80,196	220	28,090						36,600	

* ADDITIONAL QUANTITES, SHEET 18

MODEL: Default
 FILE: h:\mhc\pav\pavmark.dwg
 PROJECT: 78705\CADD\DATA\CAD\Sheet18-29-2019-Sheets.dwg
 OFFICE: J:\DOT\Documents\DOT - Office\J\78705\CADD\DATA\CAD\Sheet18-29-2019-Sheets.dwg

USER NAME = handyc	DESIGNED -	REVISED -
	DRAWN -	REVISED -
PLOT SCALE = 100.0000' / in.	CHECKED -	REVISED -
PLOT DATE = 5/13/2019	DATE -	REVISED -

**STATE OF ILLINOIS
DEPARTMENT OF TRANSPORTATION**

PAVEMENT MARKING SCHEDULE CONT.

SCALE: SHEET OF SHEETS STA. TO STA.

F.A.P. RTE.	SECTION	COUNTY	TOTAL SHEETS	SHEET NO.
42	(15,14,13,13-1)RS-6	JACKSON	33	17
CONTRACT NO. 78705				
ILLINOIS FED. AID PROJECT				

PAVEMENT MARKING SCHEDULE

LOCATION STATION TO STATION				LENGTH (INFO. ONLY)	THERMO PLASTIC L & S		SHORT TERM PVT MRK LINE 4"			SHORT TERM PAVEMENT MARKING REMOVAL	TEMPORARY MARKING REMOVAL *	NOTES
					WHITE		YELLOW	WHITE				
					24" STOP BAR	LETTERS AND SYMBOLS	CL SKIP DASH	EDGE DIAGONAL	INTERSECTION TURN LANES			
FAP 42 (IL 13/127)				FOOT	FOOT	SQ FT	FOOT	FOOT	FOOT	SQ FT	SQ FT	
STA	256+67.25	TO STA	264+93.42	826			260	208		260		
STA	264+93.42	TO STA	266+78.96	186			56	45		56		
STA	266+78.96	TO STA	272+30.00	551			166	132		166		SUBTRACT RT EDGE FOR INTERSECTION
STA	272+30.00	TO STA	274+00.00	170								
STA	274+00.00	TO STA	279+63.24	563			169	135		305		
STA	279+63.24	TO STA	336+58.80	5,696			1,709	1,367		1,709		
STA	336+58.80	TO STA	349+50.00	1,291	50	74	388	310	44	432	414	TRAUX TRAER RD-INTERSECTION
STA	349+50.00	TO STA	397+81.89	4,832			1,450	1,160		1,450		
STA	397+81.89	TO STA	403+52.89	571			172	137		172		
STA	403+52.89	TO STA	409+07.00	554			167	133		167		
STA	409+07.00	TO STA	414+45.00	538			162	129		162		
STA	414+45.00	TO STA	422+98.84	854			257	205		257		
STA	422+98.84	TO STA	428+15.00	516			155	124		155		
STA	428+15.00	TO STA	433+24.00	509			153	122		153		
STA	433+24.00	TO STA	439+17.00	593			178	142		178		
STA	439+17.00	TO STA	475+30.80	3,614			1,085	867		1,085		
STA EQ. 475+30.80 BK = 478+15.39 AH												
SUB TOTALS							6,527	5,216	44	6,707	414	
TOTALS					50	74						

* ADDITIONAL QUANTITIES, SEE SHEET 17

MODEL: Default
 FILE: h:\mfc_2019\pub\haronom.dwg
 PROJECT: 78705\CADD\Drawings\DOT - Offices\Drawings\78705-Sheets.dwg

USER NAME = handyrc	DESIGNED -	REVISED -
	DRAWN -	REVISED -
PLOT SCALE = 100,0000 ' / in.	CHECKED -	REVISED -
PLOT DATE = 5/13/2019	DATE -	REVISED -

**STATE OF ILLINOIS
DEPARTMENT OF TRANSPORTATION**

PAVEMENT MARKING SCHEDULE CONT.

SCALE: SHEET OF SHEETS STA. TO STA.

F.A.P. RTE.	SECTION	COUNTY	TOTAL SHEETS	SHEET NO.
42	(15,14,13,13-1)RS-6	JACKSON	33	18
CONTRACT NO. 78705			ILLINOIS FED. AID PROJECT	

PAVEMENT MARKING SCHEDULE CONT.

LOCATION STATION TO STATION	LENGTH (INFO. ONLY)	THERMO PLASTIC L & S		SHORT TERM PVT MRK LINE 4"			SHORT TERM PAVEMENT MARKING REMOVAL	TEMPORARY MARKING REMOVAL	NOTES	
		WHITE		YELLOW	WHITE					
		24" STOP BAR	LETTERS AND SYMBOLS	CL SKIP DASH	EDGE DIAGONAL	INTERSECTION TURN LANES				
FAP 42 (IL 13/127)	FOOT	FOOT	SQ FT	FOOT		FOOT	SQ FT	SQ FT		
STA EQ. 475+30.80 BK = 478+15.39 AH										
STA 475+30.80	TO STA 488+94.76	1,364			410			410		SUB 55FT FOR WHITE SOLID LINE CURB AND GUTTER
STA 488+94.76	TO STA 507+33.53	1,839			552			552		
STA 507+33.53	TO STA 517+50.64	1,017			306			306		
STA 517+50.64	TO STA 527+41.17	991			298			298		
STA 527+41.17	TO STA 533+66.00	625			188			188		
STA 533+66.00	TO STA 540+30.00	664			200			200		
STA 540+30.00	TO STA 573+00.00	3,270			981			981		
STA 573+00.00	TO STA 579+21.33	621			187			187		
STA 579+21.33	TO STA 582+80.00	359			108			108		
STA 582+80.00	TO STA 589+45.00	665			200			200		
STA 589+45.00	TO STA 592+25.60	281			85			85		
STA 592+25.60	TO STA 599+79.24	754			227			227		
STA 599+79.24	TO STA 603+40.00	361			109			109		
STA 603+40.00	TO STA 609+81.02	641			193			193		
STA 609+81.02	TO STA 624+20.79	1,440			432			432		
STA 624+20.79	TO STA 634+91.60	1,071			322			322		
STA 634+91.60	TO STA 636+66.15	175			53			53		
STA 636+66.15	TO STA 647+29.18	1,063			319			319		
STA 647+29.18	TO STA 657+54.39	1,025			308			308		
STA 657+54.39	TO STA 665+37.60	783			235			235		
STA 665+37.60	TO STA 668+76.82	339			102			102		
STA 668+76.82	TO STA 675+15.38	639			192			192		
STA 675+15.38	TO STA 680+90.69	575			173			173		
SUB TOTALS					6,180			6,180		
TOTALS						17,967		12,887		

MODEL: Default
 FILE: h:\mhc\pav\pub\haronom.dwg
 PROJECT: 78705\CADD\DATA\CAD\haronom.dwg
 OFFICE: J:\DOT\Documents\DOT - Office\J\haronom.dwg
 SHEET: 78705-Sheets.dwg

USER NAME = handycr	DESIGNED -	REVISED -
	DRAWN -	REVISED -
PLOT SCALE = 100.0000' / in.	CHECKED -	REVISED -
PLOT DATE = 5/13/2019	DATE -	REVISED -

**STATE OF ILLINOIS
DEPARTMENT OF TRANSPORTATION**

PAVEMENT MARKING SCHEDULE CONT.

SCALE: SHEET OF SHEETS STA. TO STA.

F.A.P. RTE.	SECTION	COUNTY	TOTAL SHEETS	SHEET NO.
42	(15,14,13,13-1)RS-6	JACKSON	33	19
CONTRACT NO. 78705				
ILLINOIS FED. AID PROJECT				

PATCHING SURVEY IL-13 /127 MAIN LINE

MILE	WIDTH	LENGTH	AREA	CLASS D TY I	CLASS D TY II	CLASS D TY III	CLASS D TY IV
	FT	FT	SQYD	SQYD	SQYD	SQYD	SQYD
1.3	12.0	8.0	10.7		10.7		
1.3	12.0	6.0	8.0		8.0		
1.4	12.0	6.0	8.0		8.0		
1.4	12.0	8.0	10.7		10.7		
1.4	12.0	6.0	8.0		8.0		
1.4	12.0	6.0	8.0		8.0		
1.4	12.0	10.0	13.3		13.3		
1.4	12.0	6.0	8.0		8.0		
1.4	12.0	6.0	8.0		8.0		
1.4	12.0	6.0	8.0		8.0		
1.4	12.0	6.0	8.0		8.0		
1.4	12.0	8.0	10.7		10.7		
1.5	12.0	8.0	10.7		10.7		
1.5	12.0	8.0	10.7		10.7		
1.5	12.0	6.0	8.0		8.0		
1.5	12.0	6.0	8.0		8.0		
1.5	12.0	20.0	26.7				26.7
1.5	12.0	8.0	10.7		10.7		
1.5	12.0	6.0	8.0		8.0		
1.5	12.0	6.0	8.0		8.0		
1.5	12.0	6.0	8.0		8.0		
1.5	12.0	6.0	8.0		8.0		
1.5	12.0	6.0	8.0		8.0		
1.5	12.0	6.0	8.0		8.0		
1.5	12.0	6.0	8.0		8.0		
1.5	12.0	6.0	8.0		8.0		
1.5	12.0	8.0	10.7		10.7		
1.5	12.0	8.0	10.7		10.7		
1.6	12.0	8.0	10.7		10.7		
1.6	12.0	6.0	8.0		8.0		
1.6	12.0	8.0	10.7		10.7		
1.6	12.0	8.0	10.7		10.7		
1.6	12.0	8.0	10.7		10.7		
1.6	12.0	8.0	10.7		10.7		
1.6	12.0	4.0	5.3		5.3		
1.6	6.0	6.0	4.0	4.0			
1.6	12.0	6.0	8.0		8.0		
1.6	12.0	6.0	8.0		8.0		
1.7	12.0	6.0	8.0		8.0		
1.7	12.0	6.0	8.0		8.0		
1.7	12.0	6.0	8.0		8.0		
1.7	12.0	6.0	8.0		8.0		
1.7	12.0	6.0	8.0		8.0		
1.8	12.0	6.0	8.0		8.0		
1.8	12.0	6.0	8.0		8.0		
1.9	12.0	6.0	8.0		8.0		
1.9	12.0	10.0	13.3		13.3		
1.9	12.0	6.0	8.0		8.0		
1.9	12.0	4.0	5.3		5.3		
1.9	12.0	6.0	8.0		8.0		
SUB TOTALS			454.7	4.0	424.3	0.0	26.7

PATCHING SURVEY IL-13 /127 MAIN LINE

MILE	WIDTH	LENGTH	AREA	CLASS D TY I	CLASS D TY II	CLASS D TY III	CLASS D TY IV
	FT	FT	SQYD	SQYD	SQYD	SQYD	SQYD
1.9	12.0	4.0	5.3		5.3		
1.9	12.0	6.0	8.0		8.0		
1.9	12.0	8.0	10.7		10.7		
1.9	12.0	6.0	8.0		8.0		
2.0	12.0	12.0	16.0			16.0	
2.0	12.0	16.0	21.3			21.3	
2.0	12.0	8.0	10.7		10.7		
2.0	12.0	6.0	8.0		8.0		
2.0	12.0	20.0	26.7				26.7
2.0	12.0	12.0	16.0			16.0	
2.0	12.0	8.0	10.7		10.7		
2.0	12.0	4.0	5.3		5.3		
2.0	12.0	10.0	13.3		13.3		
2.0	12.0	8.0	10.7		10.7		
2.0	12.0	4.0	5.3		5.3		
2.0	6.0	6.0	4.0	4.0			
2.1	12.0	4.0	5.3		5.3		
2.1	12.0	4.0	5.3		5.3		
2.1	12.0	6.0	8.0		8.0		
2.1	12.0	6.0	8.0		8.0		
2.2	12.0	8.0	10.7		10.7		
2.2	12.0	6.0	8.0		8.0		
2.2	12.0	4.0	5.3		5.3		
2.2	12.0	4.0	5.3		5.3		
2.2	12.0	4.0	5.3		5.3		
2.2	12.0	4.0	5.3		5.3		
2.2	12.0	16.0	21.3			21.3	
2.2	12.0	16.0	21.3			21.3	
2.3	12.0	6.0	8.0		8.0		
2.3	12.0	6.0	8.0		8.0		
2.3	12.0	6.0	8.0		8.0		
2.3	12.0	6.0	8.0		8.0		
2.3	12.0	4.0	5.3		5.3		
2.3	12.0	4.0	5.3		5.3		
2.3	12.0	4.0	5.3		5.3		
2.3	12.0	4.0	5.3		5.3		
2.3	12.0	4.0	5.3		5.3		
2.3	12.0	4.0	5.3		5.3		
2.3	12.0	4.0	5.3		5.3		
2.3	12.0	4.0	5.3		5.3		
2.3	12.0	10.0	13.3		13.3		
2.3	12.0	8.0	10.7		10.7		
2.4	12.0	6.0	8.0		8.0		
2.4	12.0	6.0	8.0		8.0		
2.4	12.0	6.0	8.0		8.0		
SUB TOTALS			454.7	4.0	327.6	95.9	26.7

Milepost Marker 0.0 Starts at Grange Hall Rd.

MODEL: Default
FILE: \\s:\p\pub\baronm.d\at\illinois\p\WIDOT\Documents\DOT_Offices\Illinet\9\Projects\78705\CADD\DATA\CAD\Sheet\78705-Sheets.dgn

USER NAME = handyc	DESIGNED -	REVISED -
PLOT SCALE = 100.0000' / in.	DRAWN -	REVISED -
PLOT DATE = 5/13/2019	CHECKED -	REVISED -
	DATE -	REVISED -

**STATE OF ILLINOIS
DEPARTMENT OF TRANSPORTATION**

PATCHING SCHEDULE

SCALE: SHEET OF SHEETS STA. TO STA.

F.A.P. RTE.	SECTION	COUNTY	TOTAL SHEETS	SHEET NO.
42	(15,14,13,13-1)RS-6	JACKSON	33	20
			CONTRACT NO. 78705	
		ILLINOIS FED. AID PROJECT		

PATCHING SURVEY IL-13 /127 MAIN LINE

MILE	WIDTH	LENGTH	AREA	CLASS D TY I	CLASS D TY II	CLASS D TY III	CLASS D TY IV
	FT	FT	SQYD	SQYD	SQYD	SQYD	SQYD
2.4	12.0	6.0	8.0		8.0		
2.4	12.0	8.0	10.7		10.7		
2.4	12.0	6.0	8.0		8.0		
2.4	12.0	6.0	8.0		8.0		
2.4	12.0	6.0	8.0		8.0		
2.4	12.0	6.0	8.0		8.0		
2.4	12.0	16.0	21.3			21.3	
2.5	12.0	6.0	8.0		8.0		
2.5	12.0	6.0	8.0		8.0		
2.5	12.0	10.0	13.3		13.3		
2.5	12.0	4.0	5.3		5.3		
2.5	12.0	4.0	5.3		5.3		
2.5	12.0	4.0	5.3		5.3		
2.5	12.0	6.0	8.0		8.0		
2.5	12.0	4.0	5.3		5.3		
2.5	12.0	4.0	5.3		5.3		
2.5	12.0	8.0	10.7		10.7		
2.5	12.0	8.0	10.7		10.7		
2.5	12.0	4.0	5.3		5.3		
2.5	12.0	4.0	5.3		5.3		
2.5	12.0	4.0	5.3		5.3		
2.6	12.0	6.0	8.0		8.0		
2.6	12.0	6.0	8.0		8.0		
2.6	12.0	6.0	8.0		8.0		
2.6	12.0	8.0	10.7		10.7		
2.6	12.0	6.0	8.0		8.0		
2.6	12.0	15.0	20.0			20.0	
2.6	12.0	6.0	8.0		8.0		
2.6	12.0	4.0	5.3		5.3		
2.6	12.0	6.0	8.0		8.0		
2.6	12.0	4.0	5.3		5.3		
2.6	12.0	4.0	5.3		5.3		
2.6	12.0	6.0	8.0		8.0		
2.7	12.0	4.0	5.3		5.3		
2.7	12.0	4.0	5.3		5.3		
2.7	12.0	6.0	8.0		8.0		
2.7	12.0	6.0	8.0		8.0		
2.7	12.0	6.0	8.0		8.0		
2.7	12.0	8.0	10.7		10.7		
2.7	12.0	6.0	8.0		8.0		
2.7	12.0	4.0	5.3		5.3		
2.7	12.0	4.0	5.3		5.3		
2.8	12.0	4.0	5.3		5.3		
2.8	12.0	4.0	5.3		5.3		
2.8	12.0	8.0	10.7		10.7		
2.8	12.0	6.0	8.0		8.0		
2.8	12.0	15.0	20.0			20.0	
2.8	12.0	4.0	5.3		5.3		
2.8	12.0	8.0	10.7		10.7		
SUB TOTALS			413.3	0.0	351.6	61.3	0.0

Milepost Marker 0.0 Starts at Grange Hall Rd.

PATCHING SURVEY IL-13 /127 MAIN LINE

MILE	WIDTH	LENGTH	AREA	CLASS D TY I	CLASS D TY II	CLASS D TY III	CLASS D TY IV
	FT	FT	SQYD	SQYD	SQYD	SQYD	SQYD
2.8	12.0	6.0	8.0		8.0		
2.8	12.0	4.0	5.3		5.3		
2.8	12.0	6.0	8.0		8.0		
2.8	12.0	6.0	8.0		8.0		
2.8	12.0	4.0	5.3		5.3		
2.8	12.0	4.0	5.3		5.3		
2.8	12.0	4.0	5.3		5.3		
2.8	12.0	4.0	5.3		5.3		
2.8	12.0	4.0	5.3		5.3		
2.9	12.0	8.0	10.7		10.7		
2.9	12.0	15.0	20.0			20.0	
2.9	12.0	6.0	8.0		8.0		
2.9	12.0	6.0	8.0		8.0		
2.9	12.0	6.0	8.0		8.0		
3.0	12.0	8.0	10.7		10.7		
3.0	12.0	8.0	10.7		10.7		
3.0	12.0	6.0	8.0		8.0		
3.0	12.0	6.0	8.0		8.0		
3.1	12.0	6.0	8.0		8.0		
3.1	12.0	6.0	8.0		8.0		
3.1	12.0	4.0	5.3		5.3		
3.1	12.0	4.0	5.3		5.3		
3.1	12.0	6.0	8.0		8.0		
3.1	12.0	6.0	8.0		8.0		
3.1	12.0	6.0	8.0		8.0		
3.1	12.0	4.0	5.3		5.3		
3.2	12.0	12.0	16.0			16.0	
3.2	12.0	12.0	16.0			16.0	
3.3	12.0	20.0	26.7				26.7
3.3	12.0	10.0	13.3		13.3		
3.3	12.0	8.0	10.7		10.7		
3.3	12.0	4.0	5.3		5.3		
3.3	12.0	4.0	5.3		5.3		
3.4	12.0	6.0	8.0		8.0		
3.4	12.0	6.0	8.0		8.0		
3.5	12.0	4.0	5.3		5.3		
3.5	12.0	6.0	8.0		8.0		
3.5	12.0	20.0	26.7				26.7
3.5	12.0	15.0	20.0			20.0	
3.5	12.0	4.0	5.3		5.3		
3.5	12.0	4.0	5.3		5.3		
3.6	12.0	6.0	8.0		8.0		
3.6	12.0	8.0	10.7		10.7		
3.7	12.0	12.0	16.0			16.0	
3.7	12.0	12.0	16.0			16.0	
3.7	12.0	6.0	8.0		8.0		
3.7	12.0	6.0	8.0		8.0		
3.9	12.0	25.0	33.3				33.3
3.9	12.0	12.0	16.0			16.0	
3.9	12.0	6.0	8.0		8.0		
SUB TOTALS			508.0	0.0	301.0	120.0	86.7

MODEL: Default
 FILE: \\hp1bancom.dal.lillinc.gov\PROJECTS\DOT\Office\13127\13127-CAD\CAD\CAD\13127-127-Sheets.dgn

USER NAME = handyc	DESIGNED -	REVISED -
PLOT SCALE = 100,0000' / in.	DRAWN -	REVISED -
PLOT DATE = 5/13/2019	CHECKED -	REVISED -
	DATE -	REVISED -

**STATE OF ILLINOIS
DEPARTMENT OF TRANSPORTATION**

PATCHING SCHEDULE CONT.

SCALE: SHEET OF SHEETS STA. TO STA.

F.A.P. RTE.	SECTION	COUNTY	TOTAL SHEETS	SHEET NO.
42	(15,14,13,13-1)RS-6	JACKSON	33	21
CONTRACT NO. 78705				
ILLINOIS FED. AID PROJECT				

PATCHING SURVEY IL-13 /127 MAIN LINE

MILE	WIDTH	LENGTH	AREA	CLASS D TY I	CLASS D TY II	CLASS D TY III	CLASS D TY IV
	FT	FT	SQYD	SQYD	SQYD	SQYD	SQYD
3.9	12.0	15.0	20.0			20.0	
4.0	12.0	12.0	16.0			16.0	
4.0	12.0	8.0	10.7		10.7		
4.1	12.0	8.0	10.7		10.7		
4.1	12.0	8.0	10.7		10.7		
4.1	12.0	10.0	13.3		13.3		
4.1	12.0	10.0	13.3		13.3		
4.1	12.0	6.0	8.0		8.0		
4.1	12.0	6.0	8.0		8.0		
4.1	12.0	6.0	8.0		8.0		
4.2	12.0	6.0	8.0		8.0		
4.2	12.0	6.0	8.0		8.0		
4.2	12.0	6.0	8.0		8.0		
4.2	12.0	6.0	8.0		8.0		
4.2	12.0	12.0	16.0			16.0	
4.2	12.0	4.0	5.3		5.3		
4.3	12.0	8.0	10.7		10.7		
4.3	12.0	10.0	13.3		13.3		
4.3	12.0	25.0	33.3				33.3
4.3	12.0	15.0	20.0			20.0	
4.3	12.0	6.0	8.0		8.0		
4.3	12.0	8.0	10.7		10.7		
4.5	12.0	12.0	16.0			16.0	
4.5	12.0	12.0	16.0			16.0	
4.5	12.0	6.0	8.0		8.0		
4.5	12.0	6.0	8.0		8.0		
4.5	12.0	6.0	8.0		8.0		
4.5	12.0	6.0	8.0		8.0		
4.5	12.0	8.0	10.7		10.7		
4.6	12.0	8.0	10.7		10.7		
4.6	12.0	6.0	8.0		8.0		
4.6	12.0	4.0	5.3		5.3		
4.7	12.0	8.0	10.7		10.7		
4.7	12.0	12.0	16.0			16.0	
4.7	12.0	6.0	8.0		8.0		
4.7	12.0	6.0	8.0		8.0		
4.7	12.0	12.0	16.0			16.0	
4.7	12.0	6.0	8.0		8.0		
4.8	12.0	10.0	13.3		13.3		
4.8	12.0	10.0	13.3		13.3		
4.8	12.0	8.0	10.7		10.7		
4.8	12.0	6.0	8.0		8.0		
4.8	12.0	12.0	16.0			16.0	
4.8	12.0	8.0	10.7		10.7		
4.8	12.0	6.0	8.0		8.0		
4.8	12.0	6.0	8.0		8.0		
4.8	12.0	6.0	8.0		8.0		
4.8	12.0	6.0	8.0		8.0		
4.9	12.0	8.0	10.7		10.7		
4.9	12.0	6.0	8.0		8.0		
SUB TOTALS			556.0	0.0	370.8	152.0	33.3

PATCHING SURVEY I-13 /127 MAIN LINE

MILE	WIDTH	LENGTH	AREA	CLASS D TY I	CLASS D TY II	CLASS D TY III	CLASS D TY IV
	FT	FT	SQYD	SQYD	SQYD	SQYD	SQYD
4.9	12.0	6.0	8.0		8.0		
4.9	12.0	6.0	8.0		8.0		
4.9	12.0	4.0	5.3		5.3		
4.9	12.0	4.0	5.3		5.3		
4.9	12.0	4.0	5.3		5.3		
4.9	12.0	4.0	5.3		5.3		
4.9	12.0	6.0	8.0		8.0		
4.9	12.0	6.0	8.0		8.0		
5.0	12.0	6.0	8.0		8.0		
5.0	12.0	6.0	8.0		8.0		
5.1	12.0	6.0	8.0		8.0		
5.1	12.0	8.0	10.7		10.7		
5.1	12.0	4.0	5.3		5.3		
5.1	12.0	4.0	5.3		5.3		
5.1	12.0	8.0	10.7		10.7		
5.1	12.0	8.0	10.7		10.7		
5.3	12.0	6.0	8.0		8.0		
5.3	12.0	4.0	5.3		5.3		
5.3	12.0	4.0	5.3		5.3		
5.3	12.0	4.0	5.3		5.3		
5.4	12.0	4.0	5.3		5.3		
5.4	12.0	4.0	5.3		5.3		
5.4	12.0	8.0	10.7		10.7		
5.4	12.0	8.0	10.7		10.7		
5.4	12.0	6.0	8.0		8.0		
5.4	12.0	6.0	8.0		8.0		
5.5	12.0	8.0	10.7		10.7		
5.5	12.0	8.0	10.7		10.7		
5.5	12.0	10.0	13.3		13.3		
5.5	12.0	10.0	13.3		13.3		
5.5	12.0	12.0	16.0			16.0	
5.5	12.0	12.0	16.0			16.0	
5.5	12.0	4.0	5.3		5.3		
5.5	12.0	4.0	5.3		5.3		
5.5	12.0	4.0	5.3		5.3		
5.5	12.0	4.0	5.3		5.3		
5.6	12.0	8.0	10.7		10.7		
5.6	12.0	6.0	8.0		8.0		
5.7	12.0	6.0	8.0		8.0		
5.7	12.0	6.0	8.0		8.0		
5.7	12.0	10.0	13.3		13.3		
5.7	12.0	10.0	13.3		13.3		
5.7	12.0	12.0	16.0			16.0	
5.7	12.0	6.0	8.0		8.0		
5.9	12.0	8.0	10.7		10.7		
5.9	12.0	8.0	10.7		10.7		
6.0	12.0	6.0	8.0		8.0		
6.0	12.0	6.0	8.0		8.0		
6.1	12.0	8.0	10.7		10.7		
6.1	12.0	6.0	8.0		8.0		
SUB TOTALS			434.7	0.0	386.4	48.0	0.0

Milepost Marker 0.0 Starts at Grange Hall Rd.

MODEL: Default
FILE: Model: PatchingArea.mxd
PROJECT: 78705\CADDData\CADDsheets\78705-Sheets.dgn

USER NAME = handycr	DESIGNED -	REVISED -
PLOT SCALE = 100,0000' / in.	DRAWN -	REVISED -
PLOT DATE = 5/13/2019	CHECKED -	REVISED -
	DATE -	REVISED -

**STATE OF ILLINOIS
DEPARTMENT OF TRANSPORTATION**

PATCHING SCHEDULE CONT

SCALE: SHEET OF SHEETS STA. TO STA.

F.A.P. RTE.	SECTION	COUNTY	TOTAL SHEETS	SHEET NO.
42	(15,14,13,13-1)RS-6	JACKSON	33	22
CONTRACT NO. 78705				
ILLINOIS FED. AID PROJECT				

PATCHING SURVEY I-13 /127 MAIN LINE

MILE	WIDTH	LENGTH	AREA	CLASS D TY I	CLASS D TY II	CLASS D TY III	CLASS D TY IV
	FT	FT	SQYD	SQYD	SQYD	SQYD	SQYD
6.1	12.0	12.0	16.0			16.0	
6.1	12.0	8.0	10.7		10.7		
6.1	12.0	4.0	5.3		5.3		
6.1	12.0	4.0	5.3		5.3		
6.3	12.0	12.0	16.0			16.0	
6.3	12.0	8.0	10.7		10.7		
6.4	12.0	8.0	10.7		10.7		
6.4	12.0	4.0	5.3		5.3		
6.5	12.0	10.0	13.3		13.3		
6.5	12.0	8.0	10.7		10.7		
6.6	12.0	8.0	10.7		10.7		
6.7	12.0	6.0	8.0		8.0		
6.7	12.0	12.0	16.0			16.0	
6.7	12.0	4.0	5.3		5.3		
6.7	12.0	4.0	5.3		5.3		
6.7	12.0	4.0	5.3		5.3		
6.7	12.0	4.0	5.3		5.3		
6.8	12.0	8.0	10.7		10.7		
6.8	12.0	8.0	10.7		10.7		
6.9	12.0	8.0	10.7		10.7		
6.9	12.0	6.0	8.0		8.0		
6.9	12.0	10.0	13.3		13.3		
6.9	12.0	10.0	13.3		13.3		
7.0	12.0	20.0	26.7				26.7
7.0	12.0	20.0	26.7				26.7
7.0	12.0	4.0	5.3		5.3		
7.0	12.0	4.0	5.3		5.3		
7.0	12.0	6.0	8.0		8.0		
7.0	12.0	6.0	8.0		8.0		
7.2	12.0	15.0	20.0			20.0	
7.2	12.0	12.0	16.0			16.0	
7.2	12.0	6.0	8.0		8.0		
7.2	12.0	4.0	5.3		5.3		
7.3	12.0	12.0	16.0			16.0	
7.3	12.0	10.0	13.3		13.3		
7.4	12.0	8.0	10.7		10.7		
7.4	12.0	10.0	13.3		13.3		
7.5	12.0	8.0	10.7		10.7		
7.5	12.0	8.0	10.7		10.7		
7.6	12.0	10.0	13.3		13.3		
7.6	12.0	10.0	13.3		13.3		
7.6	12.0	10.0	13.3		13.3		
7.6	12.0	10.0	13.3		13.3		
7.7	12.0	8.0	10.7		10.7		
7.7	12.0	8.0	10.7		10.7		
7.7	12.0	8.0	10.7		10.7		
7.7	12.0	4.0	5.3		5.3		
7.7	12.0	6.0	8.0		8.0		
7.7	12.0	6.0	8.0		8.0		
7.9	12.0	4.0	5.3		5.3		
SUB TOTALS			542.7	0.0	389.1	100.0	53.4

Milepost Marker 0.0 Starts at Grange Hall Rd.

PATCHING SURVEY I-13 /127 MAIN LINE

MILE	WIDTH	LENGTH	AREA	CLASS D TY I	CLASS D TY II	CLASS D TY III	CLASS D TY IV
	FT	FT	SQYD	SQYD	SQYD	SQYD	SQYD
7.9	12.0	4.0	5.3		5.3		
7.9	12.0	8.0	10.7		10.7		
7.9	12.0	6.0	8.0		8.0		
7.9	12.0	8.0	10.7		10.7		
7.9	12.0	6.0	8.0		8.0		
8.0	12.0	4.0	5.3		5.3		
8.0	12.0	4.0	5.3		5.3		
8.1	12.0	8.0	10.7		10.7		
8.1	12.0	10.0	13.3		13.3		
8.1	12.0	8.0	10.7		10.7		
8.1	12.0	8.0	10.7		10.7		
8.1	12.0	4.0	5.3		5.3		
8.1	12.0	4.0	5.3		5.3		
8.1	12.0	4.0	5.3		5.3		
8.1	12.0	4.0	5.3		5.3		
8.2	12.0	10.0	13.3		13.3		
8.2	12.0	8.0	10.7		10.7		
8.2	12.0	4.0	5.3		5.3		
8.2	12.0	8.0	10.7		10.7		
8.2	12.0	6.0	8.0		8.0		
8.4	12.0	6.0	8.0		8.0		
8.4	12.0	6.0	8.0		8.0		
8.5	12.0	8.0	10.7		10.7		
8.6	12.0	8.0	10.7		10.7		
8.6	12.0	8.0	10.7		10.7		
8.6	12.0	6.0	8.0		8.0		
8.6	12.0	6.0	8.0		8.0		
8.7	12.0	8.0	10.7		10.7		
8.7	12.0	8.0	10.7		10.7		
8.8	12.0	8.0	10.7		10.7		
8.8	12.0	8.0	10.7		10.7		
8.8	12.0	6.0	8.0		8.0		
8.8	12.0	6.0	8.0		8.0		
8.9	12.0	6.0	8.0		8.0		
8.9	12.0	6.0	8.0		8.0		
9.0	12.0	8.0	10.7		10.7		
9.0	12.0	8.0	10.7		10.7		
9.0	12.0	8.0	10.7		10.7		
9.0	12.0	8.0	10.7		10.7		
9.0	12.0	6.0	8.0		8.0		
9.0	12.0	10.0	13.3		13.3		
9.1	12.0	20.0	26.7				26.7
9.2	12.0	30.0	40.0				40.0
9.2	12.0	8.0	10.7		10.7		
9.2	12.0	4.0	5.3		5.3		
9.2	12.0	8.0	10.7		10.7		
9.2	12.0	8.0	10.7		10.7		
9.2	12.0	8.0	10.7		10.7		
9.2	12.0	8.0	10.7		10.7		
9.2	12.0	6.0	8.0		8.0		
SUB TOTALS			506.7	0.0	440.3	0.0	66.7
TOTALS			3872	9	2993	579	295

MODEL: Default
FILE: \\mchc-pub\pub\lanscom\data\illinois\pwr\DOT\Documents\DOT_Offices\Illin\dot - 9\Projects\78705\CADD\DATA\CAD\chests\78705-Sheets.dgn

USER NAME = handycr	DESIGNED -	REVISED -
PLOT SCALE = 100,0000 ' / in.	DRAWN -	REVISED -
PLOT DATE = 5/13/2019	CHECKED -	REVISED -
	DATE -	REVISED -

STATE OF ILLINOIS
DEPARTMENT OF TRANSPORTATION

PATCHING SCHEDULE CONT

SCALE: SHEET OF SHEETS STA. TO STA.

F.A.P RTE.	SECTION	COUNTY	TOTAL SHEETS	SHEET NO.
42	(15,14,13,13-1)RS-6	JACKSON	33	23
CONTRACT NO. 78705				
ILLINOIS FED. AID PROJECT				

RPM SCHEDULE

LOCATION STATION TO STATION				LENGTH (INFORMATION ONLY)	RAISED REFLECTIVE PVMT MARKERS ONE-WAY AMBER	RAISED REFLECTIVE PVMT MARKERS TWO-WAY AMBER	RAISED REFLECTIVE PVMT MARKERS ONE-WAY CRYSTAL	RAISED REFLECTIVE PAVEMENT MARKER REMOVAL	NOTES
MAINLINE				FEET	EACH	EACH	EACH	EACH	
STA	256+67.25	TO STA	336+58.80	7,992		100		100	
STA	336+58.80	TO STA	349+50.00	1,291	46	11	6	63	TRAUX TRAER RD INTERSECTION
STA	349+50.00	TO STA	475+30.80	12,581		100		100	
STA EQ. 475+30.80 BK = 478+15.39 AH									
STA	478+15.39	TO STA	680+90.69	20,275		157		157	
SUB TOTALS				42,139	46	368	6		
TOTAL						420		420	

CURB RAMPS SCHEDULE

LOCATION	COMBINATION CURB AND GUTTER REMOVAL	DETECTABLE WARNINGS	COMBINATION CURB & GUTTER TYPE B-6.24	SIDEWALK REMOVAL	TIE BARS 3/4"	PORT CEMENT CONC SIDEWALK 5"	SEEDING, CLASS 2	NITROGEN FERTILIZER	PHOSPHORUS FERTILIZER	POTASIAM FERTILIZER	AG GROUND LIMESTONE	MULCH, METHOD 2	SEEDING, CLASS 7	TEMP EROSION CONTROL SEEDING
	FOOT	SQ FT	FOOT	SQ FT	EACH	SQ FT	ACRE	POUND	POUND	POUND	TON	ACRE	ACRE	POUND
BRYDEN ST NW QUAD	15	10.0	15	74.2	4	105.6	0.01	0.5	0.5	0.5	0.02	0.01	0.01	0.5
CHERRY AVE NW QUAD	20	14.4	20	62.4	6	85.2	0.01	0.5	0.5	0.5	0.02	0.01	0.01	0.5
TOTAL	35	25	35	137	10	191	0.02	1	1	1	0.04	0.02	0.02	1

MODEL: Default
 FILE: h:\mhc\p\pub\haronom.dwg
 PROJECT: 78705\CADD\DATA\CAD\hchests\78705-Sheets.dgn
 OFFICE: IDOT

USER NAME = handyc	DESIGNED -	REVISED -
	DRAWN -	REVISED -
PLOT SCALE = 100,0000' / in.	CHECKED -	REVISED -
PLOT DATE = 5/13/2019	DATE -	REVISED -

**STATE OF ILLINOIS
DEPARTMENT OF TRANSPORTATION**

**PATCHING SCHEDULE CONT
PAVEMENT DELINEATION & CURB RAMP SCHEDULE**

SCALE: SHEET OF SHEETS STA. TO STA.

F.A.P RTE.	SECTION	COUNTY	TOTAL SHEETS	SHEET NO.
42	(15,14,13,13-1)RS-6	JACKSON	33	24
CONTRACT NO. 78705				
ILLINOIS FED. AID PROJECT				

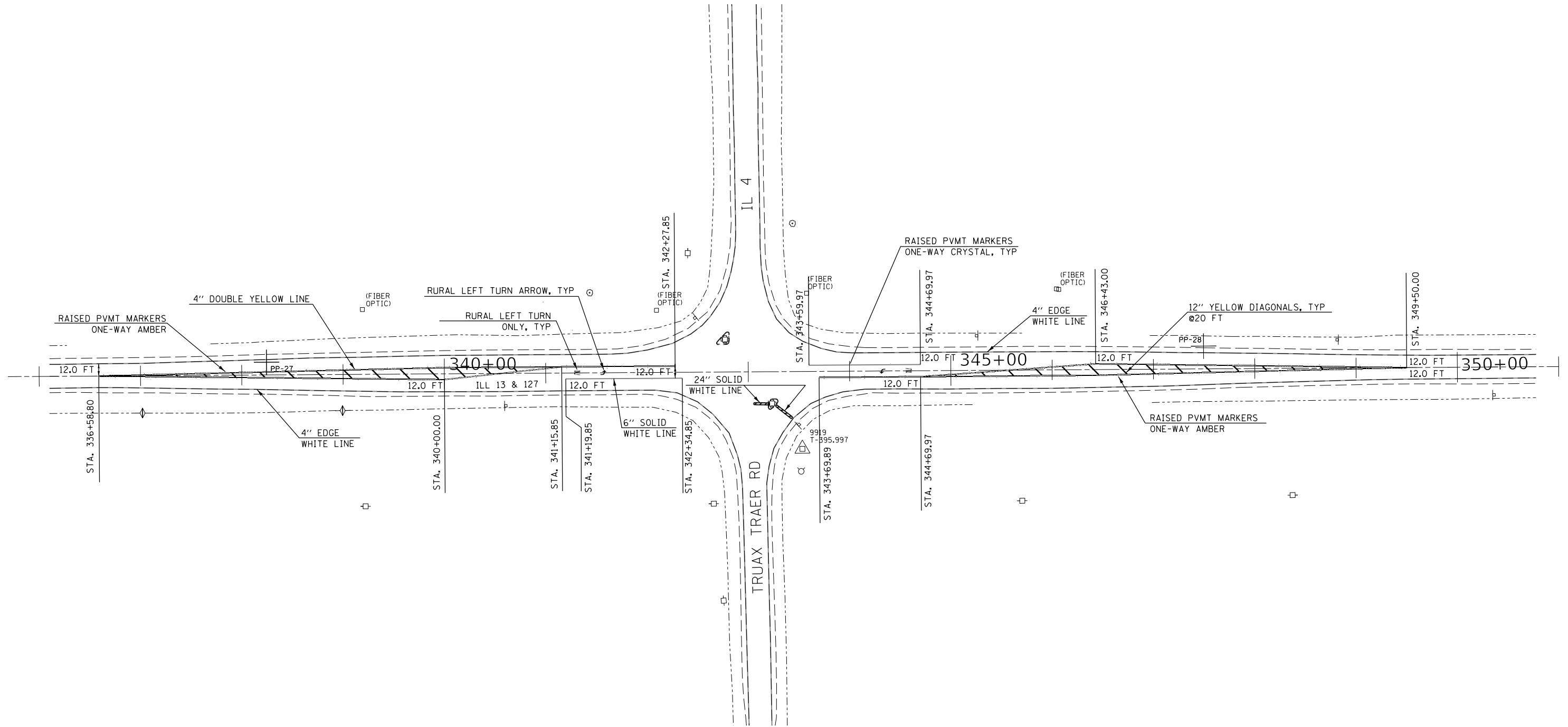

MODEL: Default
 FILE: \\blm\c:\pub\lhamon\dat\illinois\pwr\pww\DOT\Documents\DOT_Offices\Illin\ct 9\Projects\78705\CADD\DATA\CAD\Sheets\78705-Sheets.dgn

USER NAME = handycr	DESIGNED -	REVISED -
	DRAWN -	REVISED -
PLOT SCALE = 100.0000' / in.	CHECKED -	REVISED -
PLOT DATE = 5/13/2019	DATE -	REVISED -

STATE OF ILLINOIS
DEPARTMENT OF TRANSPORTATION

PAVEMENT MARKING DETAIL: INTERSECTION OF
IL13127 & TRUAX TRAER RD

SCALE: SHEET OF SHEETS STA. 336+00 TO STA. 351+00

F.A.P. RTE.	SECTION	COUNTY	TOTAL SHEETS	SHEET NO.
42	(15,14,13,13-1)RS-6	JACKSON	33	25
CONTRACT NO. 78705			ILLINOIS FED. AID PROJECT	

MODEL: Default
 FILE: h:\mhc\p\suplansroom.dwg\illinois.gov\PI\DOT\Documents\DOT_Offices\District_9\Projects\78705\CADD\data\CAD\sheets\78705-Sheets.dgn

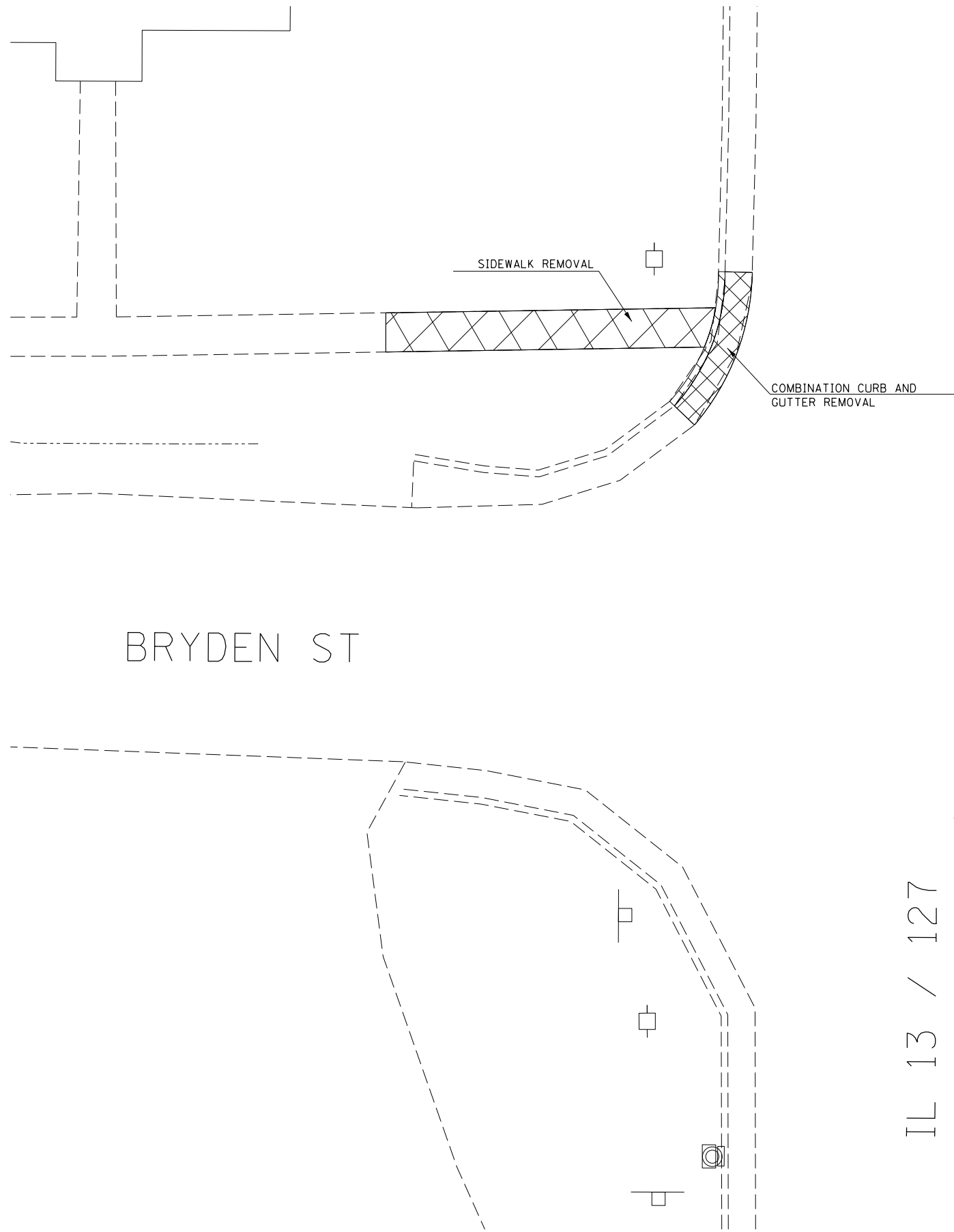

505+00

IL 13 / 127

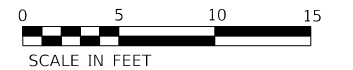
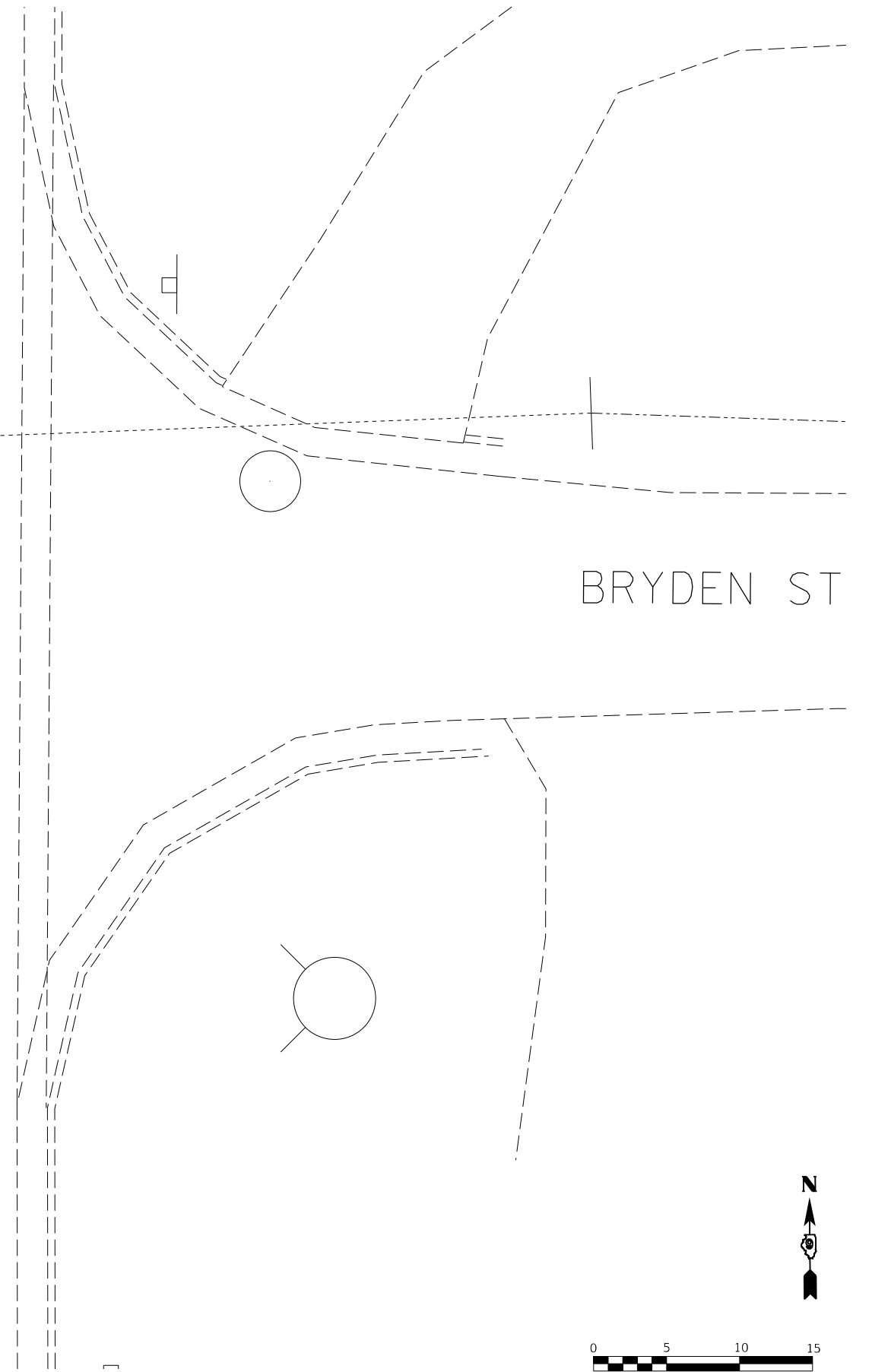

USER NAME = handycr	DESIGNED -	REVISED -
	DRAWN -	REVISED -
PLOT SCALE = 10.0000 ' / in.	CHECKED -	REVISED -
PLOT DATE = 5/13/2019	DATE -	REVISED -

STATE OF ILLINOIS
 DEPARTMENT OF TRANSPORTATION

SIDEWALK REMOVAL
 AT BRYDEN ROAD

SCALE: SHEET OF SHEETS STA. TO STA.

F.A.P. RTE.	SECTION	COUNTY	TOTAL SHEETS	SHEET NO.
42	(15,14,13,13-1)RS-6	JACKSON	33	26
ILLINOIS FED. AID PROJECT			CONTRACT NO. 78705	

MODEL: Default
 FILE: h:\mhc\p\suplanroom\dat\illinois.gov\PI\DOT\Documents\DOT_Offices\District 9\Projects\78705\CADD\DATA\CAD\Sheets\78705_Sheets.dgn

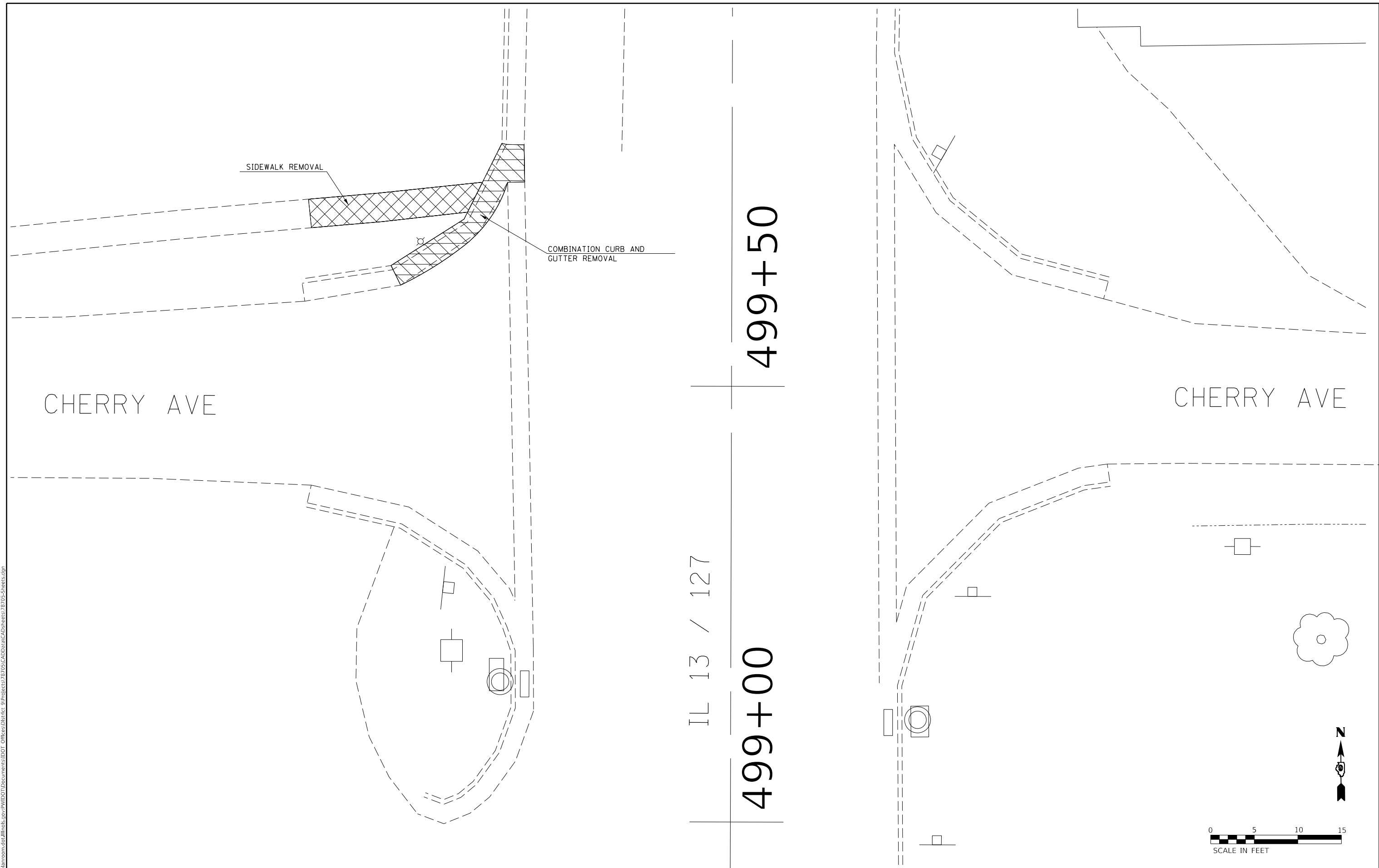

USER NAME = handyc	DESIGNED -	REVISED -
PLOT SCALE = 10.0000 ' / in.	DRAWN -	REVISED -
PLOT DATE = 5/13/2019	CHECKED -	REVISED -
	DATE -	REVISED -

**STATE OF ILLINOIS
 DEPARTMENT OF TRANSPORTATION**

**SIDEWALK REMOVAL
 AT CHERRY AVE**

SCALE: SHEET OF SHEETS STA. TO STA.

F.A.P. RTE.	SECTION	COUNTY	TOTAL SHEETS	SHEET NO.
42	(15,14,13,13-1)RS-6	JACKSON	33	27
CONTRACT NO. 78705				
ILLINOIS FED. AID PROJECT				

IL 13 /127 & BRYDEN ST. N.W. QUADRANT (SE RUNNING E&W)

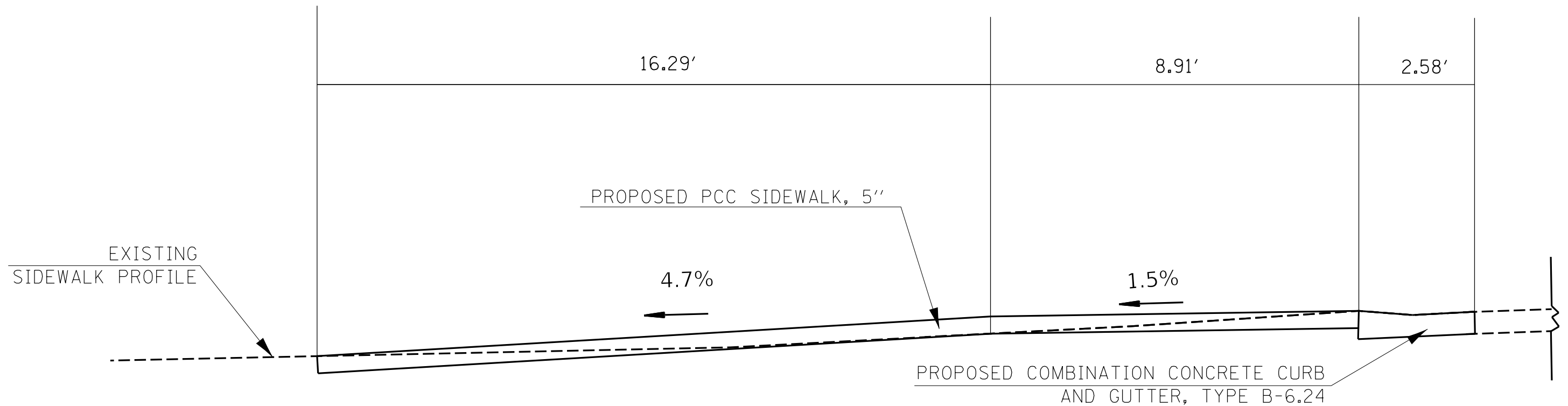

IL 13 /127 & CHERRY AVE N.W. QUADRANT (SE RUNNING E&W)

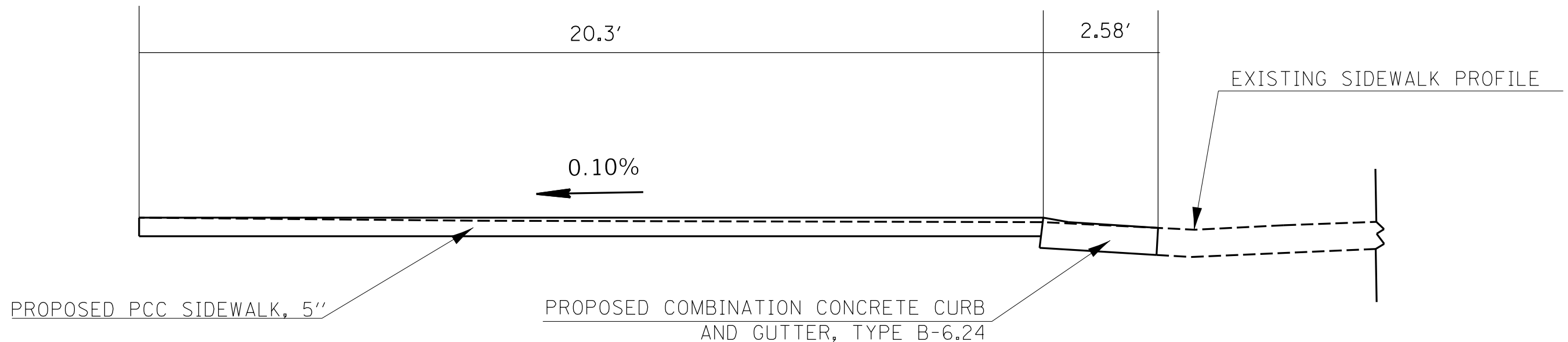

MODEL: Default
 FILE: h:\mhc\p\suplanroom\dat\illinois\p\w\DOT\Documents\DOT_Offices\District 9\Projects\78705\CADD\Drawings\78705-Sheets.dgn

USER NAME = handyc	DESIGNED -	REVISED -
PLOT SCALE = 10.0000' / in.	DRAWN -	REVISED -
PLOT DATE = 5/13/2019	CHECKED -	REVISED -
	DATE -	REVISED -

STATE OF ILLINOIS
DEPARTMENT OF TRANSPORTATION

SIDEWALK PROFILE AT BRYDEN STREET
SIDEWALK PROFILE AT CHERRY AVE

SCALE: SHEET OF SHEETS STA. TO STA.

F.A.P. RTE.	SECTION	COUNTY	TOTAL SHEETS	SHEET NO.
42	(15,14,13,13-1)RS-6	JACKSON	33	28
CONTRACT NO. 78705				
ILLINOIS FED. AID PROJECT				

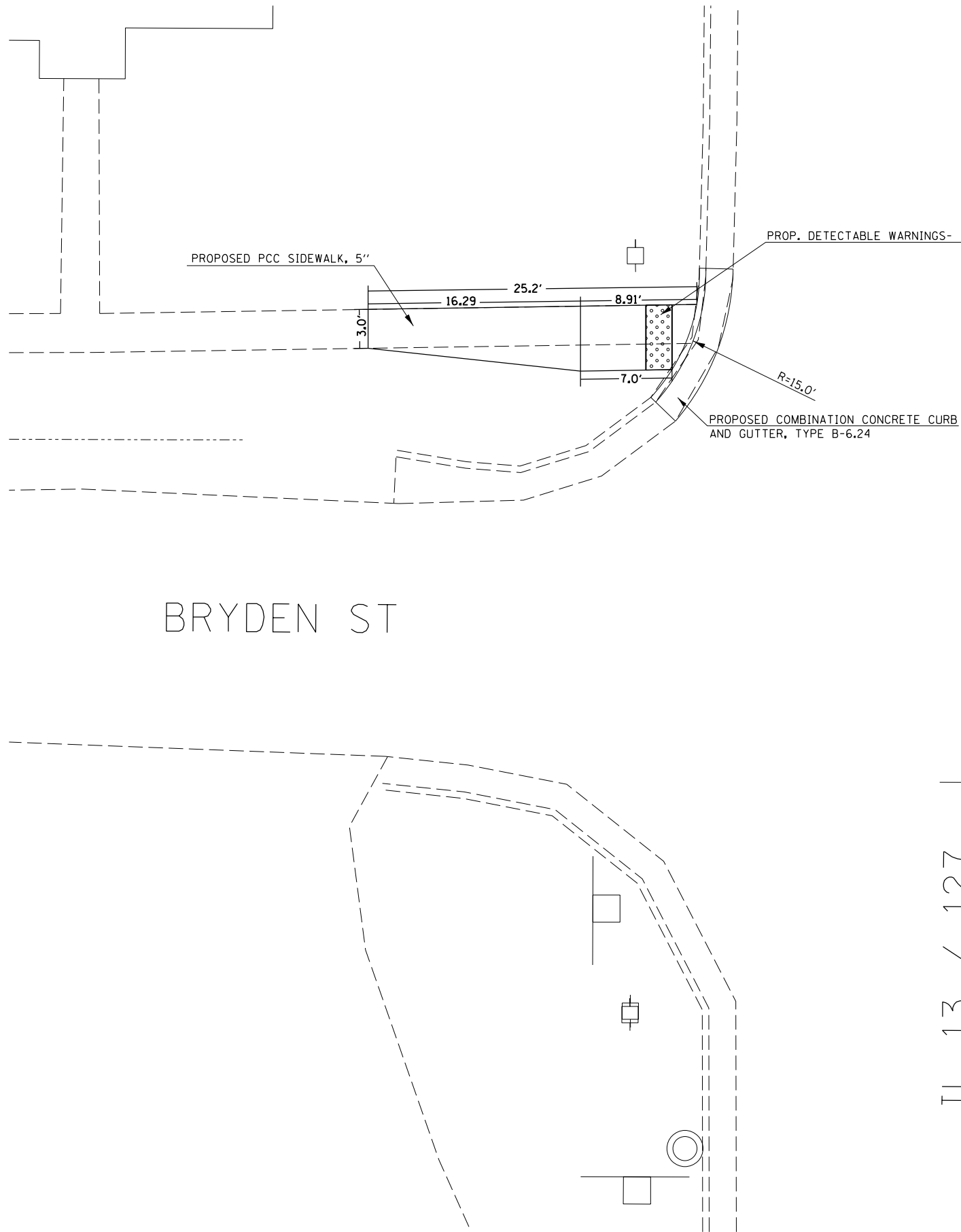

505+00

IL 13 / 127

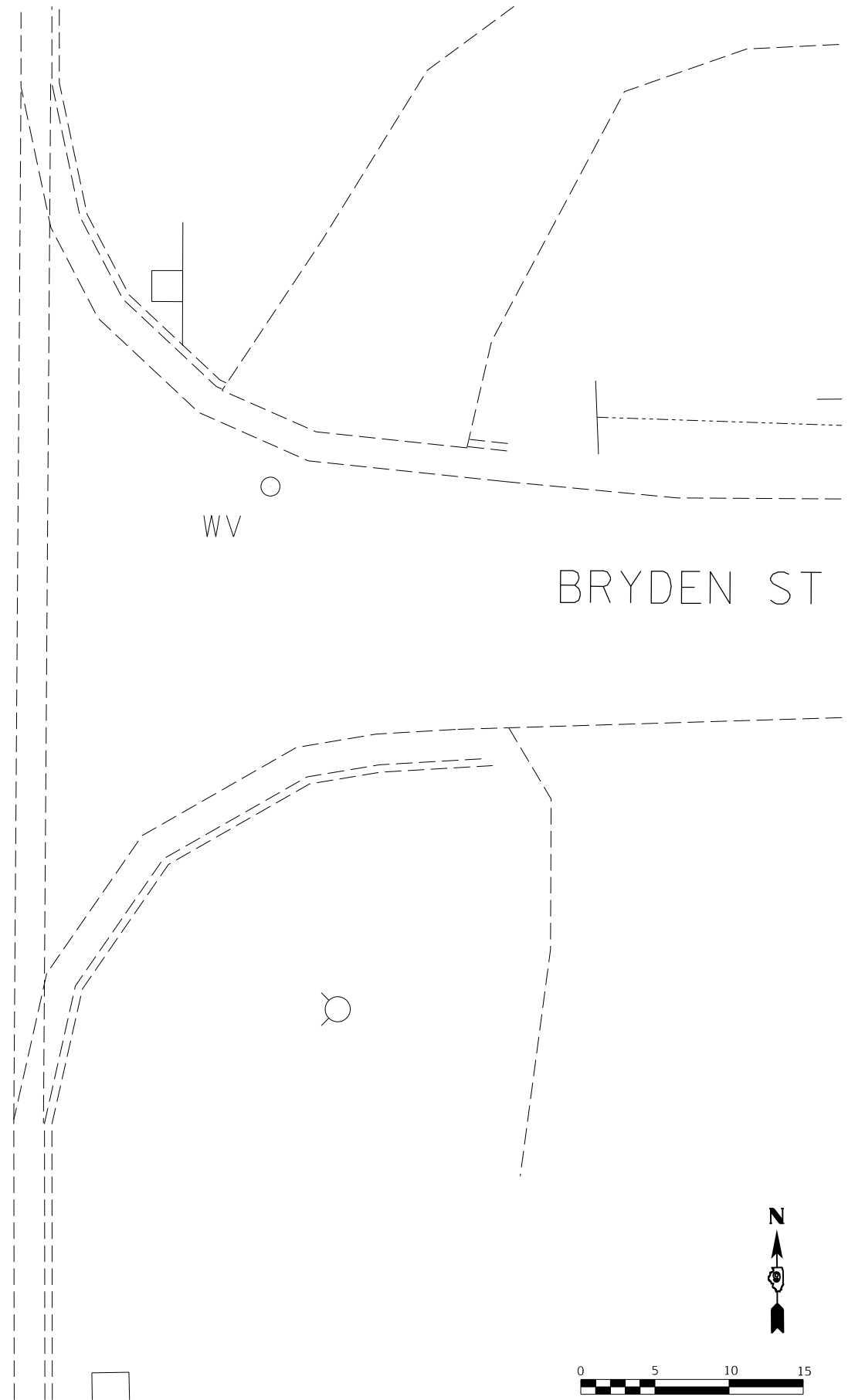

MODEL: Default
FILE: h:\mhc\p\pub\harcam\dat\illinois\p\w\dot\Documents\DOT_Offices\District_9\Projects\78705\CADD\BrydenSt\78705-Sheets.dgn

USER NAME = handycr	DESIGNED -	REVISED -
PLOT SCALE = 10.0000 ' / in.	DRAWN -	REVISED -
PLOT DATE = 5/13/2019	CHECKED -	REVISED -
	DATE -	REVISED -

STATE OF ILLINOIS
DEPARTMENT OF TRANSPORTATION

SIDEWALK PLAN AT BRYDEN STREET				
SCALE:	SHEET	OF	SHEETS	STA. TO STA.

F.A.P. RTE.	SECTION	COUNTY	TOTAL SHEETS	SHEET NO.
42	(15,14,13,13-1)RS-6	JACKSON	33	29
CONTRACT NO. 78705				
ILLINOIS FED. AID PROJECT				

MODEL: Default
 FILE: h:\m11c_2019\pub\planroom.dwg
 PROJECT: 178705\CADD\DATA\CAD\Sheet178705-Sheets.dgn

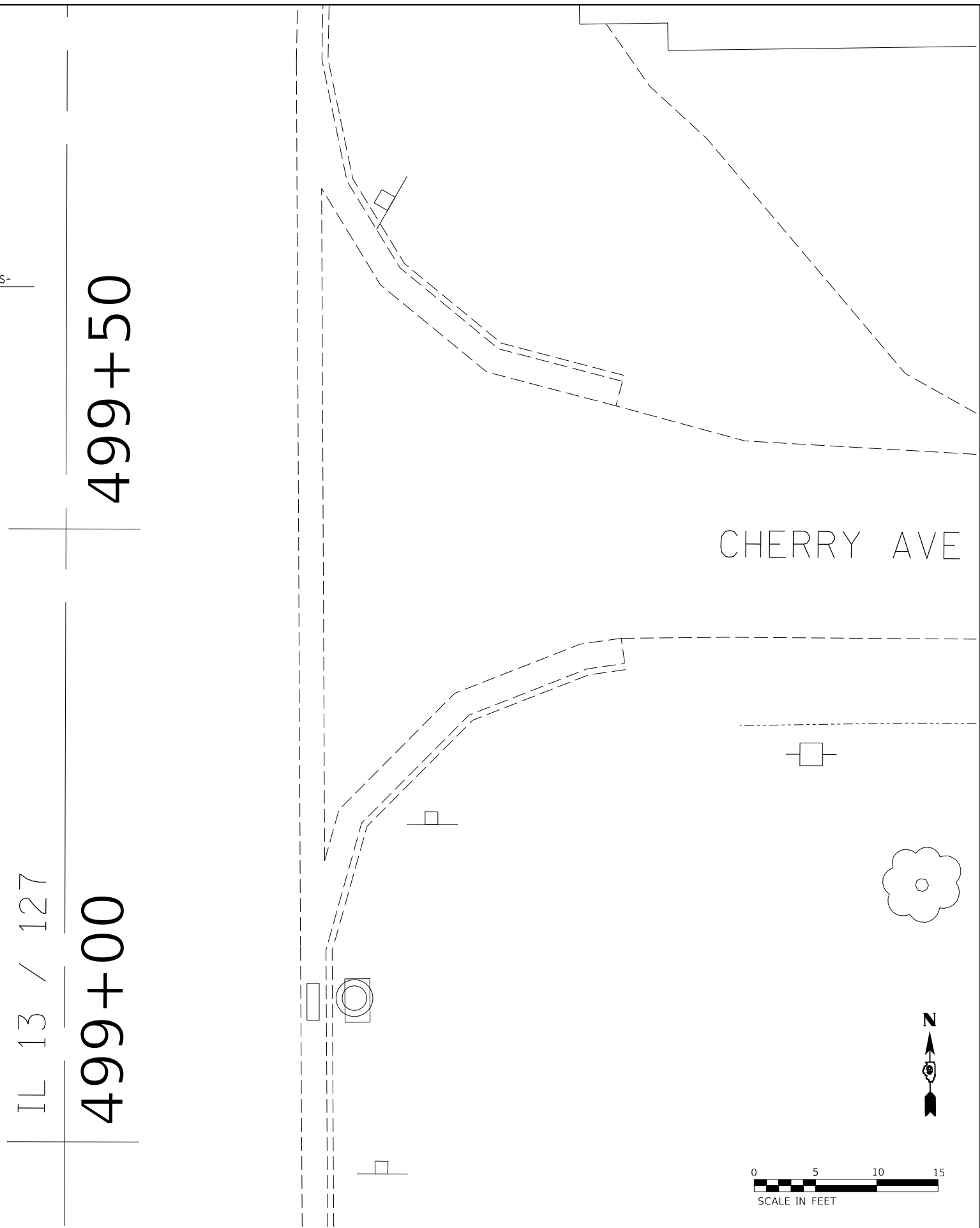
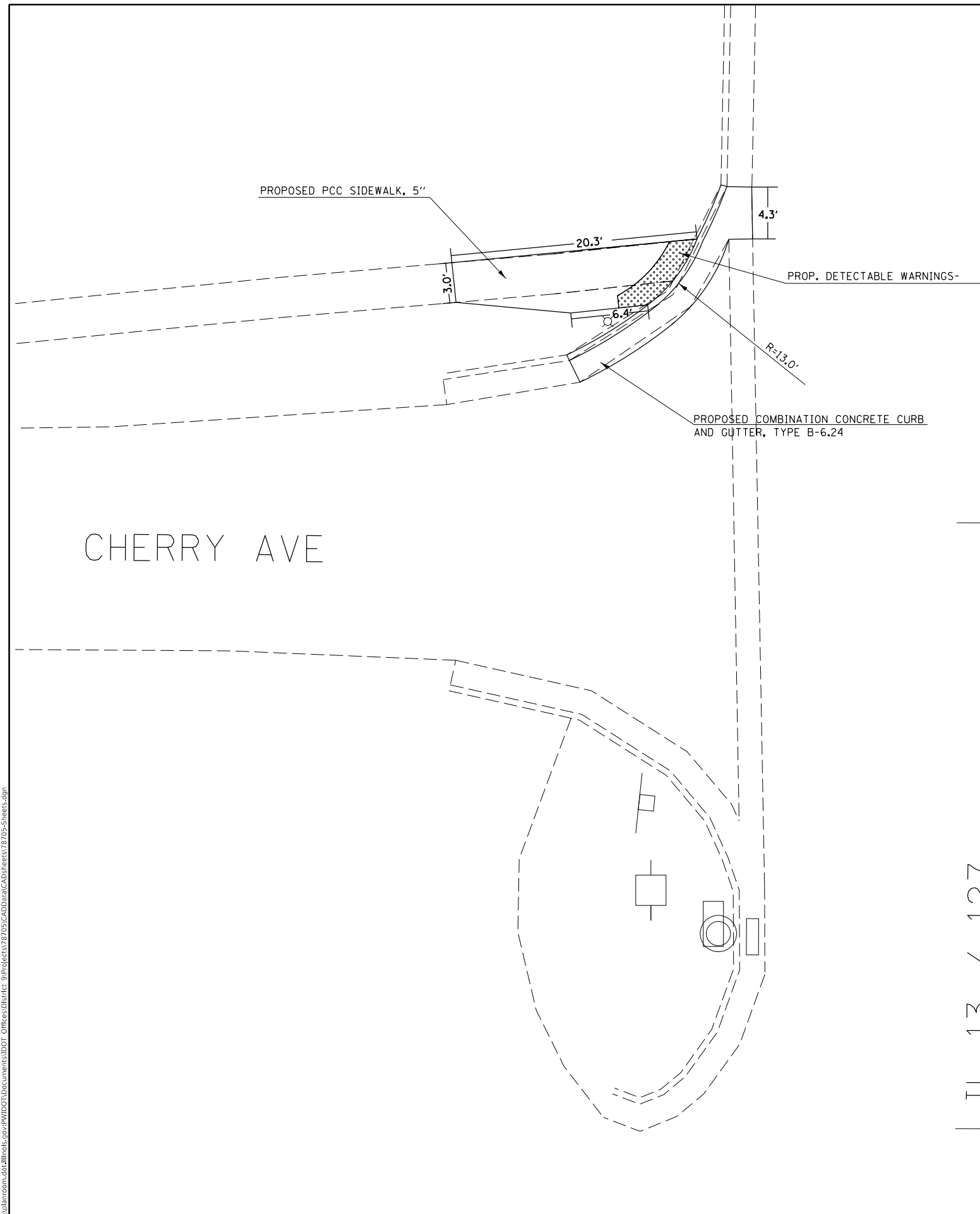

499+50

IL 13 / 127
 499+00

CHERRY AVE

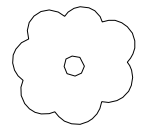

USER NAME = handyc	DESIGNED -	REVISED -
PLOT SCALE = 10.0000 ' / in.	DRAWN -	REVISED -
PLOT DATE = 5/13/2019	CHECKED -	REVISED -
	DATE -	REVISED -

**STATE OF ILLINOIS
 DEPARTMENT OF TRANSPORTATION**

**SIDEWALK PLAN
 AT CHERRY AVE**

SCALE: SHEET OF SHEETS STA. TO STA.

F.A.P. RTE.	SECTION	COUNTY	TOTAL SHEETS	SHEET NO.
42	(15,14,13,13-1)RS-6	JACKSON	33	30
CONTRACT NO. 78705				
ILLINOIS FED. AID PROJECT				

ILLINOIS STANDARD

W8-1106

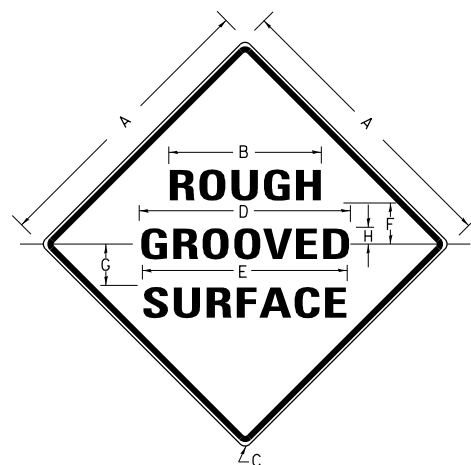

COLORS:

LEGEND AND BORDER- BLACK NON-REFLECTORIZED
BACKGROUND- ORANGE REFLECTORIZED

SIGN SIZE	DIMENSIONS							
	A	B	C	D	E	F	G	H
48X48	48.0	24.1	3.0	34.0	33.0	6.0	13.0	3.5

SIGN SIZE	SERIES LINES			MAR-GIN	BOR-DER	BLANK STD.
	1	2	3			
48X48	7C	7C	7C	0.8	1.2	B4-48D

ALL DIMENSIONS IN INCHES

NOTES:

PRIOR TO ALLOWING TRAFFIC ON ANY PORTION OF THE ROADWAY THAT HAS BEEN COLDMILLED, THE CONTRACTOR SHALL HAVE ERECTED "ROUGH GROOVED SURFACE" SIGNS THAT CONFORM TO THE ABOVE DETAILS. A MINIMUM OF ONE SIGN AT EACH END OF THE IMPROVEMENT WILL BE REQUIRED. THE CONTRACTOR SHALL MAINTAIN THE "ROUGH GROOVED SURFACE" SIGNS UNTIL THE COLDMILLED SURFACE IS COVERED WITH LEVELING BINDER OR SURFACE COURSE.

IF AT ANY TIME THE SIGNS ARE IN PLACE BUT NOT APPLICABLE, THEY SHALL BE TURNED FROM THE VIEW OF MOTORISTS OR COVERED AS DIRECTED BY THE ENGINEER.

THE COST OF FURNISHING, ERECTING, MAINTAINING, AND REMOVING THE REQUIRED SIGNS SHALL BE INCLUDED IN THE CONTRACT.

REVISIONS

REDRAWN	2-15-89
REVISED	4-6-93
REVISED	3-27-08
REVISED	

STD. 9-39

UNEVEN LANES SIGN

W8-11 (48" x 48")

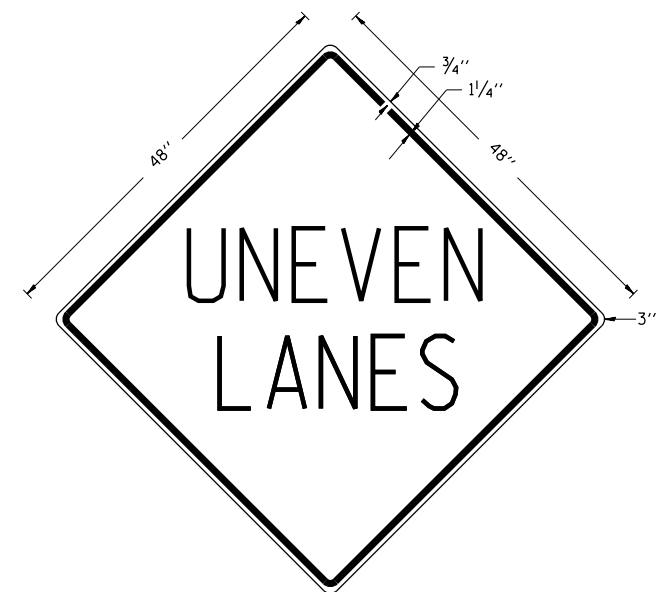

COLORS:

LEGEND AND BORDER - BLACK NON-REFLECTORIZED
BACKGROUND - ORANGE REFLECTORIZED

NOTE: PRIOR TO ALLOWING TRAFFIC ON ANY PORTION OF THE ROADWAY THAT HAS BEEN COLDMILLED OR BEFORE RESURFACING OPERATIONS BEGIN, THE CONTRACTOR SHALL HAVE ERECTED "UNEVEN PAVEMENT" SIGNS THAT CONFORM TO THE ABOVE DETAILS. A MINIMUM OF ONE SIGN AT EACH END OF THE IMPROVEMENT WILL BE REQUIRED. THE CONTRACTOR SHALL MAINTAIN THE "UNEVEN PAVEMENT" SIGNS UNTIL THE RESURFACING OPERATIONS ARE COMPLETED.

IF AT ANY TIME THE SIGNS ARE IN PLACE BUT NOT APPLICABLE, THEY SHALL BE TURNED FROM THE VIEW OF MOTORISTS OR COVERED AS DIRECTED BY THE ENGINEER.

THE COST OF FURNISHING, ERECTING, MAINTAINING, AND REMOVING THE REQUIRED SIGNS SHALL BE INCLUDED IN THE CONTRACT.

REVISIONS

DRAWN	2-15-89
REVISED	4-06-93
RESIGNED	
RESIZED	

STD. 9-41

CENTERLINE RUMBLE STRIP DETAIL

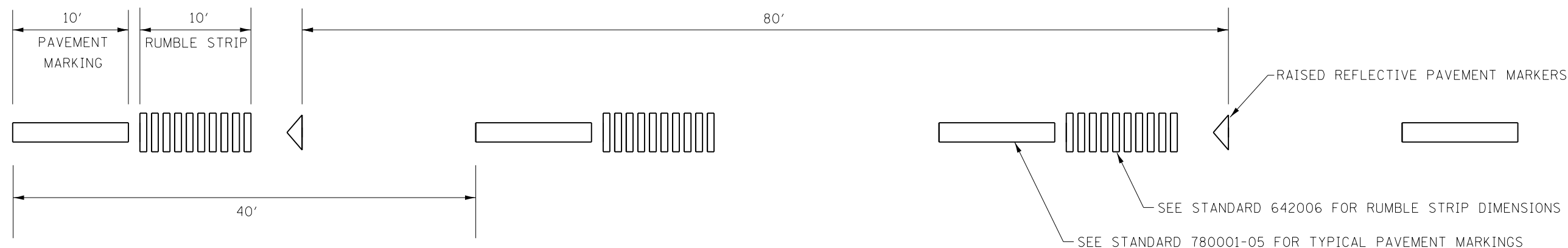

NOTE
PAY AS A SHOULDER RUMBLE STRIPS, 8 INCH

MODEL: Default
FILE: h:\m\c\p\pub\h\m\room\dat\illinois\gov\p\illinois\dot\Documents\DOT_Offices\Illinet\9\Projects\78705\CADD\Drawings\78705-Sheets.dgn

USER NAME = handyc	DESIGNED -	REVISED -
	DRAWN -	REVISED -
PLOT SCALE = 100.0000' / in.	CHECKED -	REVISED -
PLOT DATE = 5/13/2019	DATE -	REVISED -

STATE OF ILLINOIS
DEPARTMENT OF TRANSPORTATION

ROUGH GROOVED SURFACE, UNEVEN LANES SIGN,
AND CENTERLINE RUMBLE STRIP DETAIL

SCALE: SHEET OF SHEETS STA. TO STA.

F.A.P. RTE.	SECTION	COUNTY	TOTAL SHEETS	SHEET NO.
42	(15,14,13,13-1)RS-6	JACKSON	33	31
CONTRACT NO. 78705				
ILLINOIS FED. AID PROJECT				

SIDEROAD AND ENTRANCE DETAILS

HMA, PCC, OR OIL & CHIP PRIVATE OR COMMERCIAL ENTRANCE

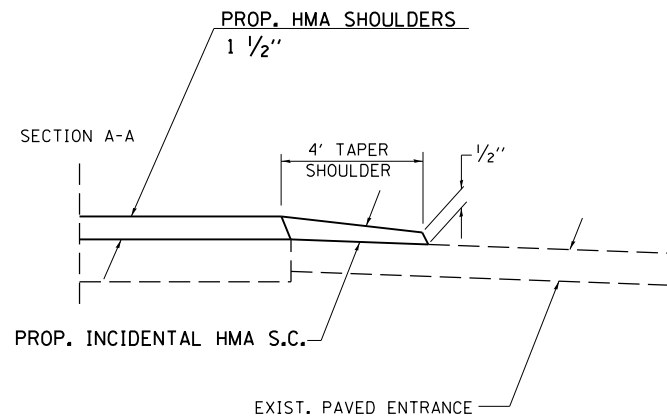

HMA, PCC, OR OIL & CHIP PRIVATE OR COMMERCIAL ENTRANCE (HMA SHLD.)

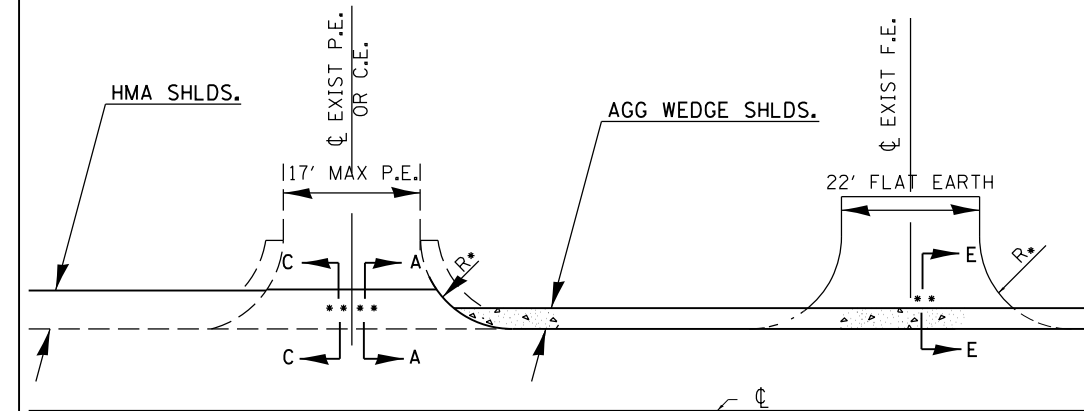
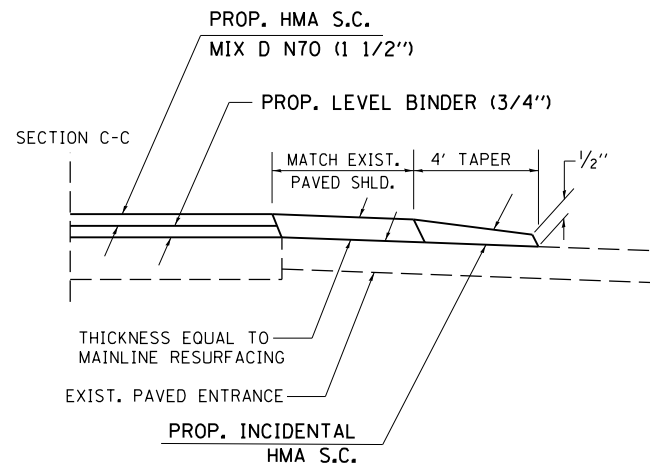

EX. OIL & CHIP SIDEROAD

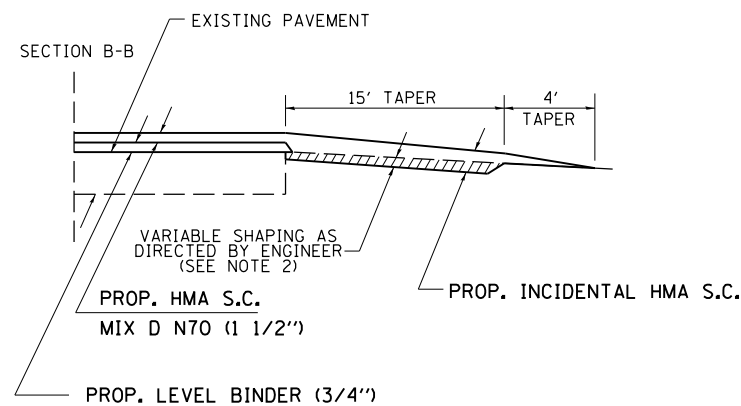

AGG. OR EARTH FIELD ENTRANCE

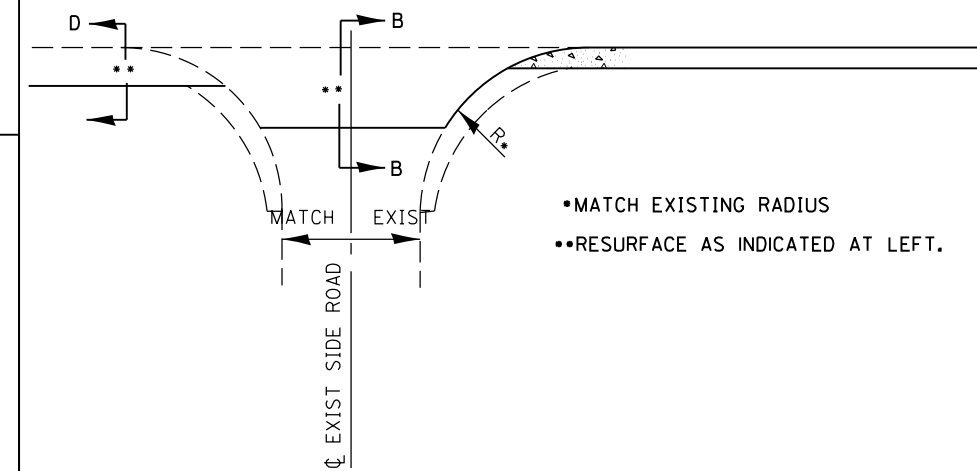
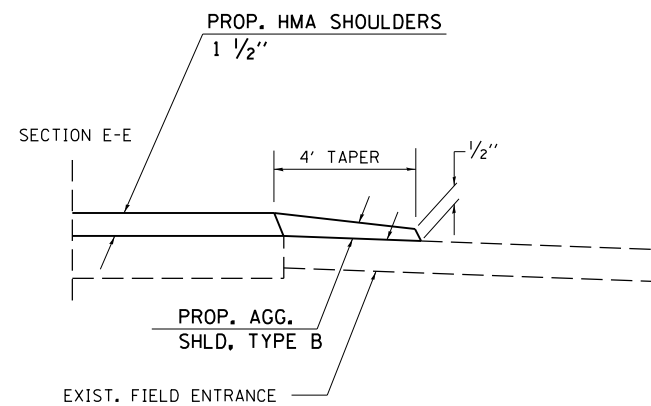

ENTRANCE SCHEDULE

TYPE	NUMBER OF ENTRANCES
P.E.	38
C.E.	9

NOTES

- IF EXISTING SUBBASE IS INADEQUATE, AS DETERMINED BY THE ENGINEER, THE SIDE ROADS SHALL BE CORED OUT AND AGGREGATE SUBBASE, TYPE B SHALL BE PLACED FOR BASE. THE COST OF CORING OUT THE SIDE ROAD AND ANY AGGREGATE BASE COURSE SHALL BE PAID FOR AS SPECIFIED IN ART. 109.04 OF THE STANDARD SPECIFICATIONS FOR ROAD AND BRIDGE CONSTRUCTION. IF EXISTING SUBBASE IS DETERMINED TO BE ADEQUATE, THE PREPARATION OF THE BASE SHALL BE CONSTRUCTED ACCORDING TO ARTICLE 406.09.
- VARIABLE SHAPING IS INCLUDED IN THE COST OF INCIDENTAL HOT-MIX ASPHALT SURFACE.

MODEL: Default
FILE: h:\mhc\p\pub\haronom.dwg
PROJECT: 78705\DOT\Documents\DOT - Office\Drawings\9\Project\78705\CAAD\Drawings\78705-Sheets.dwg

USER NAME = handyc	DESIGNED -	REVISED -
	DRAWN -	REVISED -
PLOT SCALE = 100,0000' / in.	CHECKED -	REVISED -
PLOT DATE = 5/13/2019	DATE -	REVISED -

STATE OF ILLINOIS
DEPARTMENT OF TRANSPORTATION

OVERLAY: SIDEROAD AND ENTRANCE

SCALE: SHEET OF 33 SHEETS STA. TO STA.

F.A.P. RTE.	SECTION	COUNTY	TOTAL SHEETS	SHEET NO.
42	(15,14,13,13-1)RS-6	JACKSON	33	32
				CONTRACT NO. 78705
				ILLINOIS FED. AID PROJECT

DETAIL FOR BUTT JOINT

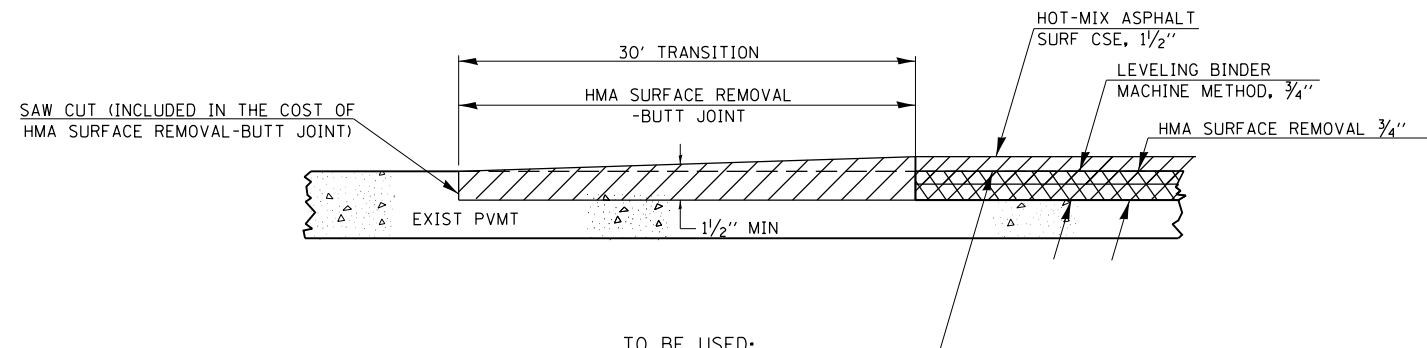

TO BE USED:
 STA. 256.67.25
 STA. 680+90.69

STANDARD: 9-118

REVISIONS	
DRAWN	03-09-17
REVISED	
REVISED	
REVISED	

DETAIL FOR HMA TRANSITION

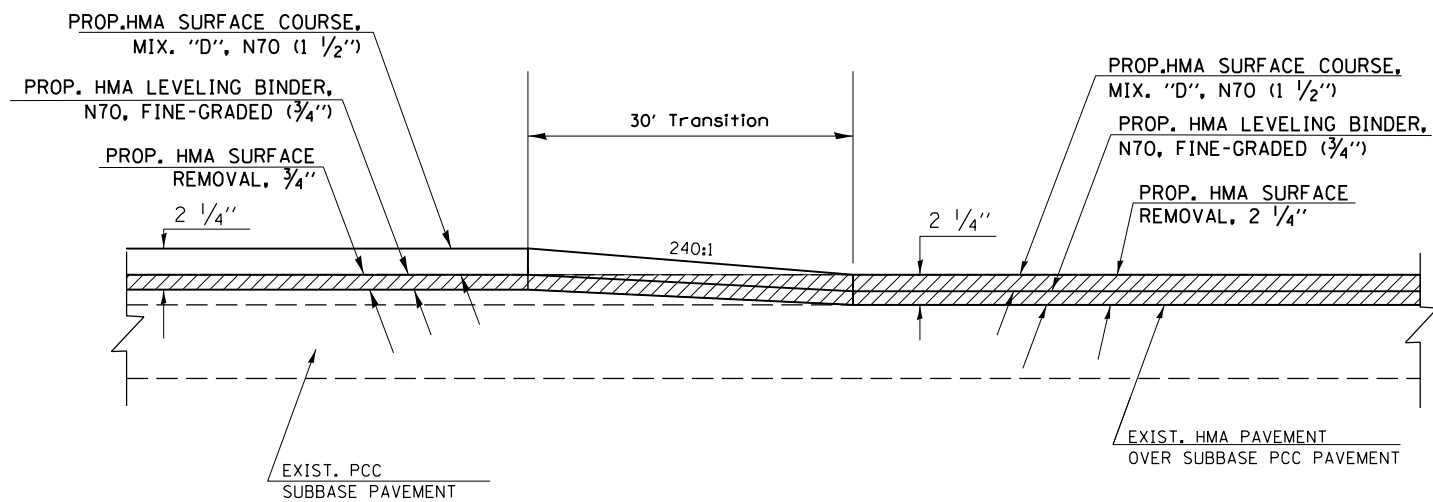

TO BE USED:
 STA. 488+64.76 TO STA. 488+94.76

DETAIL FOR BUTT JOINT AT INTERSECTION OF IL 13/127 & IL 4

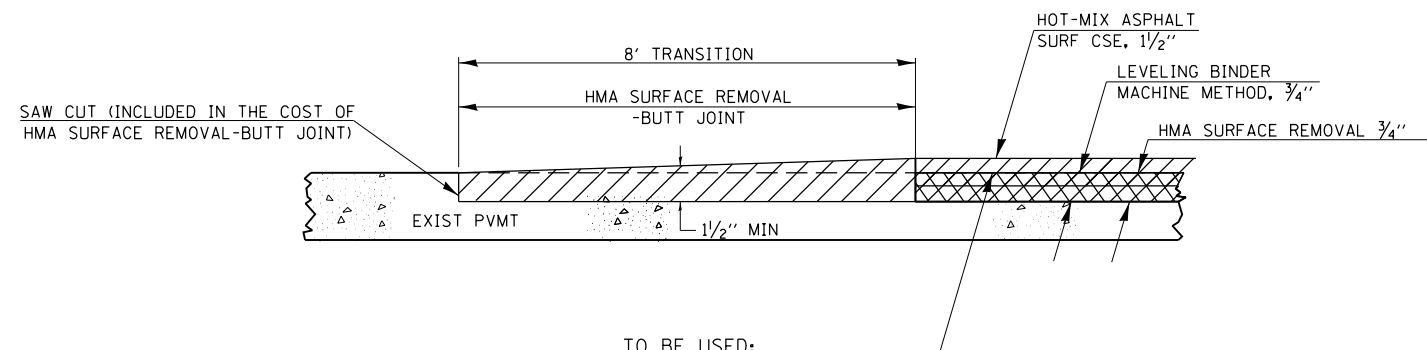

TO BE USED:
 STA. 343+00

STANDARD: 9-118

REVISIONS	
DRAWN	03-09-17
REVISED	
REVISED	
REVISED	

DETAIL FOR HMA TRANSITION

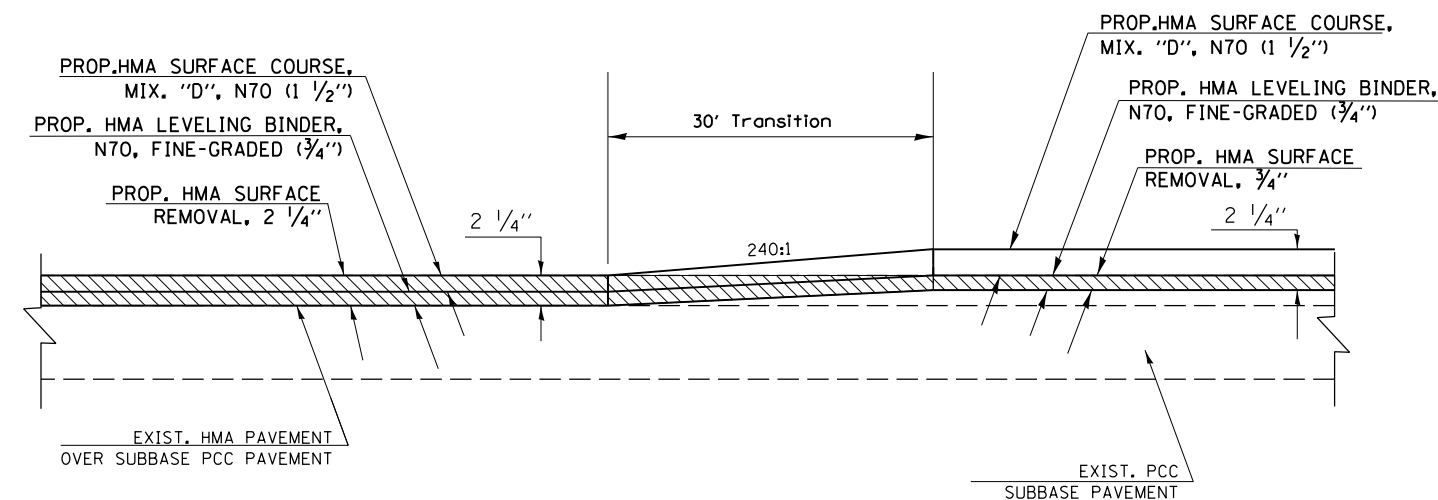

TO BE USED:
 STA. 507+33.53 TO STA. 507+63.53

STATE OF ILLINOIS
 DEPARTMENT OF TRANSPORTATION

BUTT JOINT & HMA TRANSITION DETAIL

SCALE: SHEET OF SHEETS STA. TO STA.

F.A.P. RTE.	SECTION	COUNTY	TOTAL SHEETS	SHEET NO.
42	(15,14,13,13-1)RS-6	JACKSON	33	33
CONTRACT NO. 78705				
ILLINOIS FED. AID PROJECT				

MODEL: Default
 FILE: h:\mhc\p\pub\haronom.dwg
 PROJECT: 78705\CADD\DATA\CAD\haronom.dwg
 SHEETS: 78705-Sheets.dwg