

STATE OF ILLINOIS
DEPARTMENT OF TRANSPORTATION

F.A.P. RTE.	SECTION	COUNTY	TOTAL SHEETS	SHEET NO.
	CM2023-1	**	18	1

* 322 & 322 FRONTAGE RD
** DEWITT & MCLEAN

D-95-024-22



FOR INDEX OF SHEETS, SEE SHEET NO. 2
FOR SUMMARY OF QUANTITIES, SEE SHEET NO 3-4

CURRENT TRAFFIC DATA

FAP 322 (US 51) & FAP 322 FRONTAGE RD (QUEST DR)

	ADT (2022)	PV %	SU %	MU %
LEG "A"	= 9,050	83.1	4.7	12.2
LEG "B"	= 1,300	85.4	7.7	6.9

TRAFFIC DATA LOCATIONS

LEG "A" = US 51 AT DEWITT / MCLEAN COUNTY LINE
LEG "B" = QUEST DRIVE

FUNCTIONAL CLASSIFICATION

LEG "A" = FREEWAY / EXPRESSWAY
LEG "B" = LOCAL

PROPOSED HIGHWAY PLANS

FAP ROUTE 322 (US 51) &
FAP ROUTE 322 FRONTAGE RD (QUEST DRIVE)
SECTION CM2023-1
STANDARD OVERLAY
DEWITT & MCLEAN COUNTIES

C-95-043-22

MEDIAN TURNAROUND AT MCLEAN /DEWITT COUNTY LINE
SOUTH OF HEYWORTH & AT QUEST DRIVE FRONTAGE ROAD
SOUTH OF BLOOMINGTON

DESIGN DESIGNATION
NA

TOWNSHIPS: BLOOMINGTON, WAPELLA

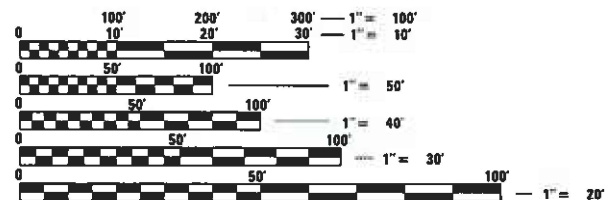

FULL SIZE PLANS HAVE BEEN PREPARED USING STANDARD ENGINEERING SCALES. REDUCED SIZED PLANS WILL NOT CONFORM TO STANDARD SCALES. IN MAKING MEASUREMENTS ON REDUCED PLANS, THE ABOVE SCALES MAY BE USED.

J.U.L.I.E.
JOINT UTILITY LOCATION INFORMATION FOR EXCAVATORS
1-800-892-0123
OR 811

PROJECT ENGINEER: JASON STULTS
SQUAD LEADER: GREG EAGLIN
DESIGNER: STEVE WOOD
(217)465-4181
CONTRACT NO. 70F89

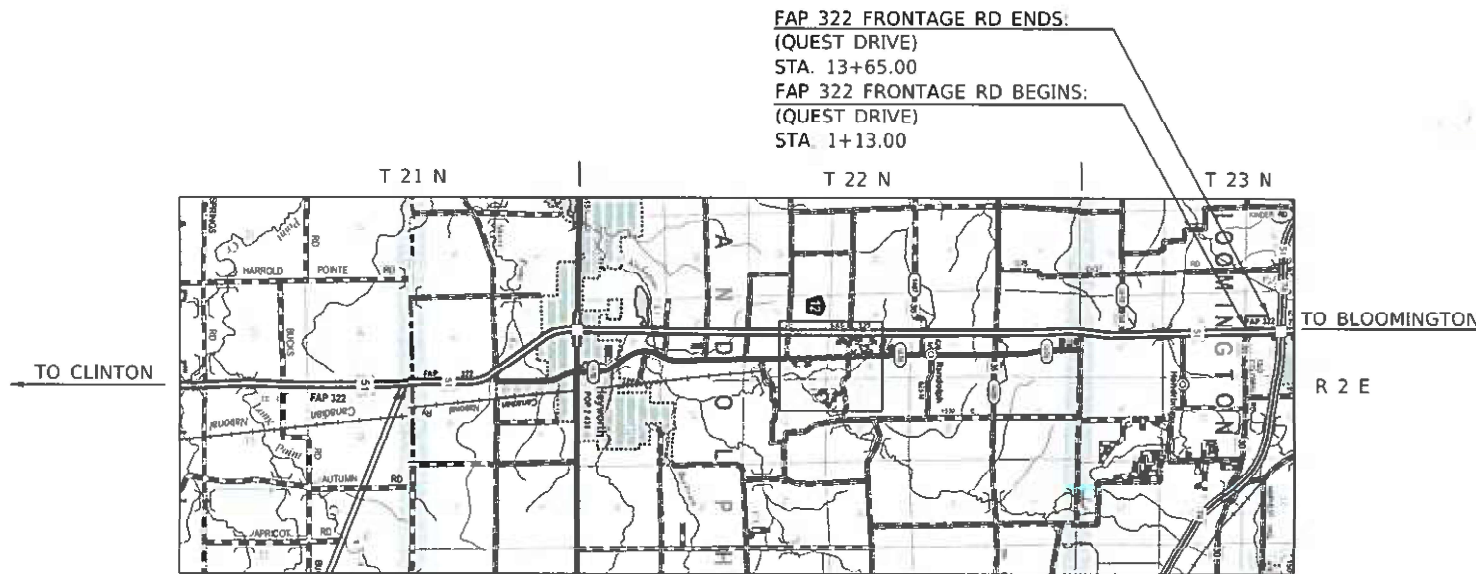

FAP 322 FRONTAGE RD ENDS:
(QUEST DRIVE)
STA. 13+65.00
FAP 322 FRONTAGE RD BEGINS:
(QUEST DRIVE)
STA. 1+13.00

FAP 322 (US 51) BEGINS:
(MEDIAN TURNAROUND)
STA. 1544+64.00

FAP 322 (US 51) ENDS:
(MEDIAN TURNAROUND)
STA. 1547+00.00

DEWITT COUNTY
MCLEAN COUNTY

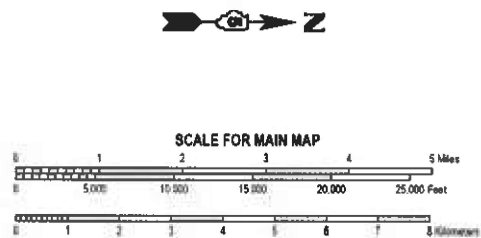

GROSS LENGTH = 1488.0 FT. = 0.282 MILE
NET LENGTH = 1488.0 FT. = 0.282 MILE

STATE OF ILLINOIS
DEPARTMENT OF TRANSPORTATION

SUBMITTED 4/18 2022
Kensil A. Barnett
REGIONAL ENGINEER

June 10, 2022
Steve A. Etkin
ENGINEER OF DESIGN AND ENVIRONMENT

June 10, 2022
Stephen M. Smith
DIRECTOR OF HIGHWAYS PROJECT IMPLEMENTATION

PRINTED BY THE AUTHORITY
OF THE STATE OF ILLINOIS

INDEX OF SHEETS

<u>SHEET NO.</u>	<u>DESCRIPTION</u>
1	COVER SHEET
2	INDEX OF SHEETS
2	LIST OF HIGHWAY STANDARDS
2	GENERAL NOTES
3 - 4	SUMMARY OF QUANTITIES
5 - 6	EXISTING AND PROPOSED TYPICAL CROSS SECTIONS
7 - 8	SCHEDULE OF QUANTITIES
9 - 10	PLAN SHEETS (QUEST DRIVE)
10 - 12	PLAN SHEETS (US 51 MEDIAN TURNAROUND)
13 - 14	DETAIL FOR PRIVATE COMMERCIAL ENTRANCES (NONCOMMERCIAL AND COMMERCIAL RURAL)
15 - 18	DETAIL FOR PAVEMENT MARKING AND MARKINGS (RURAL & URBAN TYPICAL APPLICATIONS)

LIST OF HIGHWAY STANDARDS

<u>STANDARD NO.</u>	<u>NAME OF STANDARD</u>
000001-08	STANDARD SYMBOLS, ABBREVIATIONS AND PATTERNS
001006	DECIMAL OF AN INCH AND OF A FOOT
701006-05	OFF-RD OPERATIONS, 2L, 2W, 15' TO 24" FROM PAVEMENT EDGE
701101-05	OFF-RD OPERATIONS, MULTILANE, 15' TO 24" FROM PAVEMENT EDGE
701301-04	LANE CLOSURE, 2L, 2W, SHORT TIME OPERATIONS
701311-03	LANE CLOSURE 2L, 2W MOVING OPERATIONS-DAY ONLY
701400-11	APPROACH TO LANE CLOSURE, FREEWAY/EXPRESSWAY
701401-13	LANE CLOSURE, FREEWAY/EXPRESSWAY
701501-06	URBAN LANE CLOSURE, 2L, 2W, UNDIVIDED
701901-08	TRAFFIC CONTROL DEVICES
780001-05	TYPICAL PAVEMENT MARKINGS

GENERAL NOTES

G.N.-100A
ELECTRONIC FILES AND/OR ELECTRONIC SURVEY INFORMATION INCLUDING CADD FILES WILL NOT BE AVAILABLE TO THE CONTRACTOR.

G.N. - 406H
THE FOLLOWING MIXTURE REQUIREMENTS ARE APPLICABLE FOR THIS PROJECT:

LOCATION	QUEST DRIVE	QUEST DRIVE
MIXTURE USE	SURFACE & INCIDENTAL	VOID REPAIR
AC/PG	PG 64-22	PG 64-22
DESIGN AIR VOIDS	4.0% @ Ndes=50	4.0% @ Ndes=50
MIX COMP(GRADATION)	IL 9.5	IL 9.5 FG
FRICTION AGGREGATE	MIX "C"	N.A.
MIXTURE WEIGHT	112	112
QUALITY MANAGEMENT PROGRAM	QC/QA	QC/QA
SUBLOT SIZE	N.A.	N.A.
MATERIAL TRANSFER DEVICE (REQUIRED) ?	NO	NO

LOCATION	US 51 MEDIAN TURNAROUND	US 51 MEDIAN TURNAROUND
MIXTURE USE	SURFACE (TOP 1-1/2")	BINDER (BELOW TOP 1-1/2")
AC/PG	PG 64-22	PG 64-22
DESIGN AIR VOIDS	4.0% @ Ndes=50	4.0% @ Ndes=50
MIX COMP(GRADATION)	IL 9.5	IL 19.0
FRICTION AGGREGATE	MIX "C"	N.A.
MIXTURE WEIGHT	112	112
QUALITY MANAGEMENT PROGRAM	QC/QA	QC/QA
SUBLOT SIZE	N.A.	N.A.
MATERIAL TRANSFER DEVICE (REQUIRED) ?	NO	NO

G.N. 406S
PROJECT POSTED SPEED LIMITS

THE FOLLOWING TABLE IS A LISTING OF POSTED SPEED LIMITS WITHIN THE PROJECT LIMITS. THE ENGINEER SHALL FIELD VERIFY THESE LIMITS:

LOCATION	STATION	TO	STATION	POSTED SPEED LIMIT (MPH)
QUEST DRIVE	1+13.00		13+65.00	30
US 51	1544+64.00		1547+00.00	65

G.N.-703A
SHORT TERM PAVEMENT MARKING SHALL BE APPLIED TO THE PAVEMENT AFTER ANY OF THE FOLLOWING: PAVEMENT MARKING REMOVAL, COLD MILLING AND/OR PLACING BITUMINOUS MATERIALS (TACK COAT), AND BINDER & SURFACE COURSES. SHORT TERM PAVEMENT MARKING PLACED ON THE SURFACE, SHALL COINCIDE WITH THE FINAL PAVEMENT STRIPING. SHORT TERM PAVEMENT MARKING PLACED PRIOR TO THE SURFACE SHALL COINCIDE WITH THE EXISTING PAVEMENT MARKINGS. USE 4 FEET PER 40 FEET (OR 10% PER STATION).

COMMITMENTS

THERE ARE NO COMMITMENTS FOR THIS CONTRACT

**STATE OF ILLINOIS
DEPARTMENT OF TRANSPORTATION**

**INDEX OF SHEETS, LIST OF HIGHWAY STANDARDS,
GENERAL NOTES**

SCALE: SHEET 1 OF 1 SHEETS STA. TO STA.

F.A.P. RTE.	SECTION	COUNTY	TOTAL SHEETS	SHEET NO.
*	CM2023-1	**	18	2
CONTRACT NO. 70F89				
ILLINOIS FED. AID PROJECT				

* 322 & 322 FRONTAGE RD
** DEWITT & MCLEAN

SUMMARY OF QUANTITIES

LOCATION OF WORK:	FAP 322 (US 51) RURAL 4 LANE	FAP 322 FRONTAGE ROAD (QUEST DRIVE) URBAN 2 LANE
COUNTY:	DEWITT	MCLEAN
FUNDING BREAKOUT:	STA. 1544+64.00 TO STA. 1547+00.00	STA. 1+13.00 TO STA. 13+65.00
CONSTRUCTION CODE:	0005	0005

CODE NO	ITEM	UNIT	TOTAL QUANTITY	QUANTITY	QUANTITY
35800100	PREPARATION OF BASE	SQ YD	261.0	0.0	261.0
35800200	AGGREGATE BASE REPAIR	TON	14.0	0.0	14.0
40600275	BITUMINOUS MATERIALS (PRIME COAT)	POUND	216.0	216.0	0.0
40600290	BITUMINOUS MATERIALS (TACK COAT)	POUND	2,456.0	339.0	2,117.0
40600370	LONGITUDINAL JOINT SEALANT	FOOT	1,252.0	0.0	1,252.0
40600900	HOT-MIX ASPHALT BINDER COURSE (HAND METHOD), N50	TON	17.0	0.0	17.0
40600990	TEMPORARY RAMP	SQ YD	14.0	0.0	14.0
40604050	HOT-MIX ASPHALT SURFACE COURSE, 1L-9.5, MIX "C", N50	TON	378.0	0.0	378.0
40800029	BITUMINOUS MATERIALS (TACK COAT)	POUND	354.0	0.0	354.0
40800050	INCIDENTAL HOT-MIX ASPHALT SURFACING	TON	67.0	0.0	67.0
44000155	HOT-MIX ASPHALT SURFACE REMOVAL, 1 1/2"	SQ YD	4,649.0	154.0	4,495.0
44000165	HOT-MIX ASPHALT SURFACE REMOVAL, 4"	SQ YD	304.0	304.0	0.0

* SPECIALTY ITEM

MODEL: I:\MODEL\MMF5
FILE: MMF5_Plan\Subcontract\beefay.com\PIV\DOT\Documents\DOT Office\Dir\dir: S:\Project\10570889\CADD\Drawn\CAD\Sheet\10570889\sh-SQ.dgn

* 322 & 322 FRONTAGE RD
** DEWITT & MCLEAN

USER NAME = eaglinga	DESIGNED -	REVISED -	STATE OF ILLINOIS DEPARTMENT OF TRANSPORTATION	SUMMARY OF QUANTITIES			F.A.P. RTE.	SECTION	COUNTY	TOTAL SHEETS	SHEET NO.
PLOT SCALE = 40,0000 * / in.	CHECKED -	REVISED -		SCALE:	SHEET 1	OF 2	SHEETS	STA.	TO STA.	**	18
PLOT DATE = 4/18/2022	DATE -	REVISED -					CONTRACT NO. 70F89			ILLINOIS FED. AID PROJECT	

SUMMARY OF QUANTITIES

LOCATION OF WORK:	FAP 322 (US 51) RURAL 4 LANE	FAP 322 FRONTAGE ROAD (QUEST DRIVE) URBAN 2 LANE
COUNTY:	DEWITT	MCLEAN
FUNDING BREAKOUT:	100% STATE	100% STATE
CONSTRUCTION CODE:	0005	0005

CODE NO	ITEM	UNIT	TOTAL QUANTITY	QUANTITY	QUANTITY
44004250	PAVED SHOULDER REMOVAL	SQ YD	96.0	96.0	0.0
48102100	AGGREGATE WEDGE SHOULDER, TYPE B	TON	47.0	9.0	38.0
48203100	HOT-MIX ASPHALT SHOULDERS	TON	130.0	130.0	0.0
67100100	MOBILIZATION	L SUM	1.0	0.3	0.7
70100205	TRAFFIC CONTROL AND PROTECTION, STANDARD 701401	EACH	2.0	2.0	0.0
70102620	TRAFFIC CONTROL AND PROTECTION, STANDARD 701501	L SUM	1.0	0.0	1.0
70300100	SHORT TERM PAVEMENT MARKING	FOOT	232.0	0.0	232.0
70300150	SHORT TERM PAVEMENT MARKING REMOVAL	SQ FT	38.0	0.0	38.0
* 78001110	PAINT PAVEMENT MARKING LINE 4"	FOOT	2,968.0	0.0	2,968.0
X4400196	HOT-MIX ASPHALT SURFACE REMOVAL, SPECIAL	SQ YD	732.0	0.0	732.0
Z0038119	PORTLAND CEMENT CONCRETE SURFACE REMOVAL 1 1/2"	SQ YD	54.0	0.0	54.0

* SPECIALTY ITEM

MODEL: I:\MODEL\MAME FILE NAME: p:\pub\cpx\beefay.com\FW\DOT\Documents\DOT Office\Dir\dir: S:\Project\10570889\CADD\Drawn\CAD\Sheet\10570889-shs-SQ.dgn

* 322 & 322 FRONTAGE RD
** DEWITT & MCLEAN

USER NAME = eaglinga	DESIGNED -	REVISED -	STATE OF ILLINOIS DEPARTMENT OF TRANSPORTATION	SUMMARY OF QUANTITIES				F.A.P. RTE.	SECTION	COUNTY	TOTAL SHEETS	SHEET NO.
PLOT SCALE = 40,0000 * / in.	CHECKED -	REVISED -		SCALE:	SHEET 2	OF 2	SHEETS	STA.	TO STA.	**	18	4
PLOT DATE = 4/18/2022	DATE -	REVISED -						CONTRACT NO. 70F89				
								ILLINOIS FED. AID PROJECT				

(A) EXISTING TYPICAL CROSS SECTION

STATION TO STATION
1+13.00 13+65.00

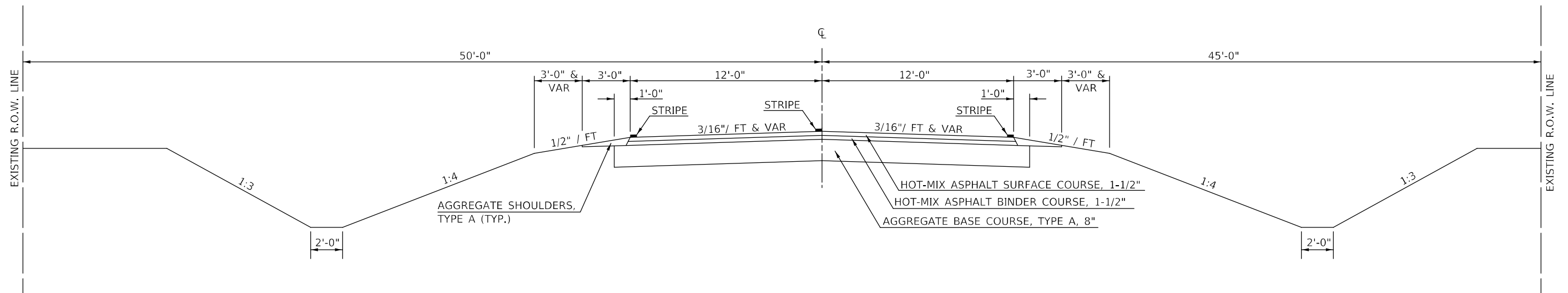

(1) PROPOSED TYPICAL CROSS SECTION

STATION TO STATION
1+13.00 13+65.00

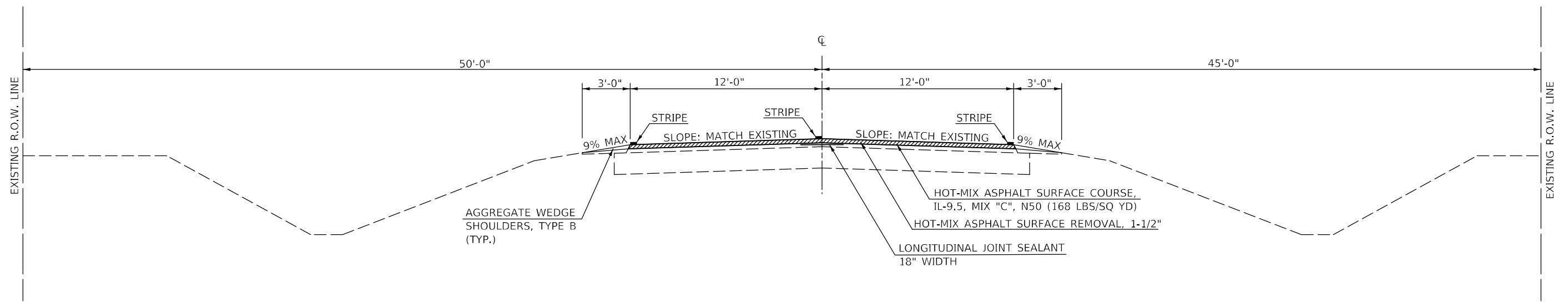

HOT-MIX ASPHALT SURFACE REMOVAL, 1-1/2"

MODEL: \\MODEL\MAME
FILE: \\MAILS_P\public\paw_bentley.com\P\DOT\Documents\DOT_Offices\Dir\Dir: S\Project\10570889\CADD\Drawn\CAD\Sheet\10570889.dgn

USER NAME = eaglinga	DESIGNED -	REVISED -
	DRAWN -	REVISED -
PLOT SCALE = 40,0000 * / in.	CHECKED -	REVISED -
PLOT DATE = 4/18/2022	DATE -	REVISED -

**STATE OF ILLINOIS
DEPARTMENT OF TRANSPORTATION**

**TYPICAL CROSS SECTIONS
FAP 322 FRONTAGE RD (QUEST DRIVE)**

SCALE: SHEET 1 OF 2 SHEETS STA. TO STA.

F.A.P. RTE.	SECTION	COUNTY	TOTAL SHEETS	SHEET NO.
*	CM2023-1	**	18	5
CONTRACT NO. 70F89				
ILLINOIS FED. AID PROJECT				

* 322 & 322 FRONTAGE RD
** DEWITT & MCLEAN

(B) EXISTING TYPICAL CROSS SECTION

STATION TO STATION
 RT. 1544+64.00 TO 1545+88.00
 LT. 1544+64.00 TO 1547+00.00

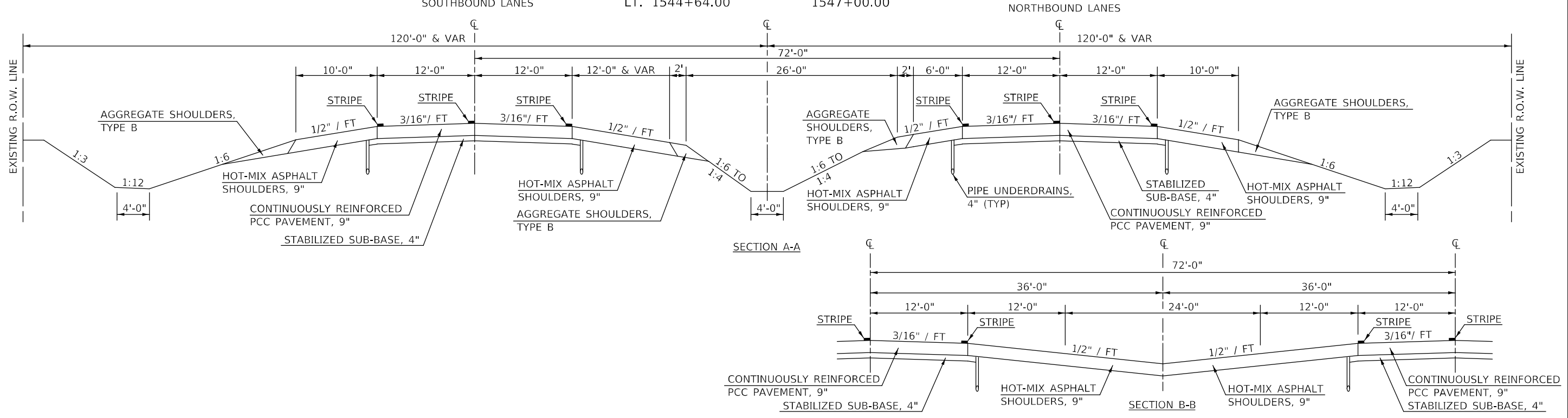

(2) PROPOSED TYPICAL CROSS SECTION

STATION TO STATION
 RT. 1544+64.00 TO 1545+88.00
 LT. 1544+64.00 TO 1547+00.00

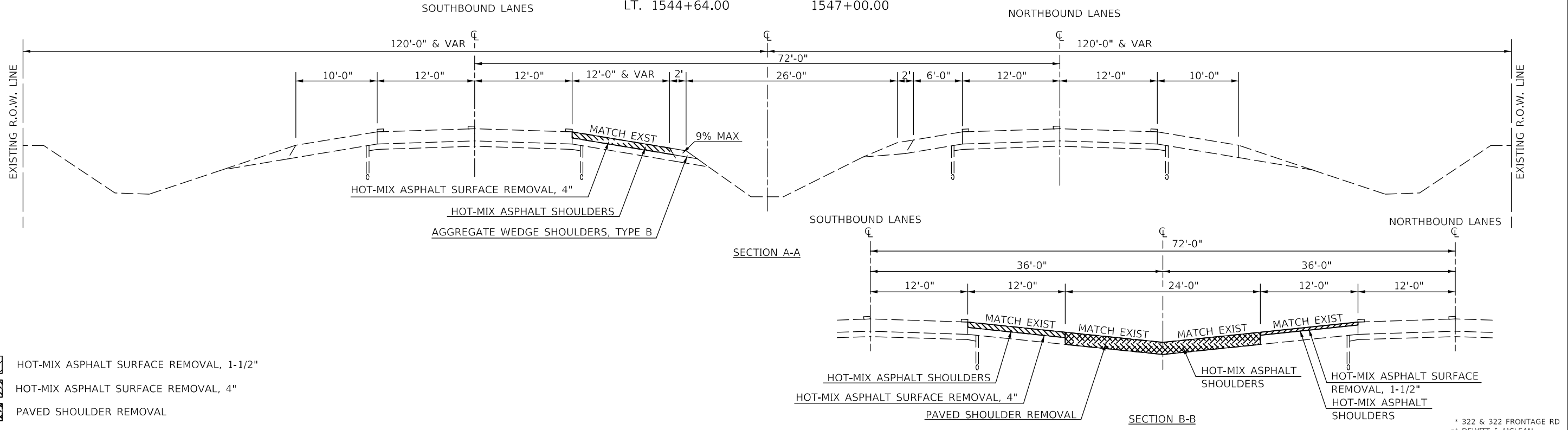

- HOT-MIX ASPHALT SURFACE REMOVAL, 1-1/2"
- HOT-MIX ASPHALT SURFACE REMOVAL, 4"
- PAVED SHOULDER REMOVAL

USER NAME = eaglinga	DESIGNED -	REVISED -
PLOT SCALE = 40,0000' / in.	DRAWN -	REVISED -
PLOT DATE = 4/18/2022	CHECKED -	REVISED -
	DATE -	REVISED -

STATE OF ILLINOIS
 DEPARTMENT OF TRANSPORTATION

TYPICAL CROSS SECTIONS			F.A.P. RTE.		SECTION	COUNTY	TOTAL SHEETS	SHEET NO.	
FAP 322 (US 51 MEDIAN TURNAROUND)			CM2023-1						**
SCALE: SHEET 2 OF 2 SHEETS		STA. TO STA.		CONTRACT NO. 70F89					
ILLINOIS							FED. AID PROJECT		

MODEL: \\MODEL\MAME... FILE NAME: \\... PROJECT: \\... CADD: \\... SHEET: 70F89-02-1

SCHEDULE OF QUANTITIES

HOT-MIX ASPHALT SCHEDULE

LOCATION	STATION	TO	STATION	LENGTH (FT)	AVERAGE WIDTH (FT)	AREA (SQ YD)	HMA SURFACE THICKNESS (INCHES)	44000155 HMA SURFACE REMOVAL, 1-1/2" (SQ YD)	40600290 BITUMINOUS MATERIAL TACK COAT (POUND)	40600370 LONGITUDINAL JOINT SEALANT (FOOT)	40604050 HOT-MIX ASPHALT IL 9.5 MIX "C", N50 (TON)
RT. QUEST DRIVE	URBAN	1+13.00	2+05.00	92.00	12.00	122.67	1.5	122.67	55.20		10.30
RT. QUEST DRIVE	URBAN	2+05.00	4+40.00	235.00	17.00	443.89	1.5	443.89	199.75		37.29
RT. QUEST DRIVE	URBAN	4+40.00	5+80.00	140.00	14.00	217.78	1.5	217.78	98.00		18.29
RT. QUEST DRIVE	URBAN	5+80.00	12+20.00	640.00	12.00	853.33	1.5	853.33	384.00		71.68
RT. QUEST DRIVE	URBAN	12+20.00	13+65.00	145.00	38.00	612.22	1.5	612.22	275.50		51.43
LT. QUEST DRIVE	URBAN	1+13.00	2+05.00	92.00	12.00	122.67	1.5	122.67	55.20		10.30
LT. QUEST DRIVE	URBAN	2+05.00	4+40.00	235.00	18.00	470.00	1.5	470.00	211.50		39.48
LT. QUEST DRIVE	URBAN	4+40.00	5+80.00	140.00	12.00	186.67	1.5	186.67	84.00		15.68
LT. QUEST DRIVE	URBAN	5+80.00	12+20.00	640.00	12.00	853.33	1.5	853.33	384.00		71.68
LT. QUEST DRIVE	URBAN	12+20.00	13+65.00	145.00	38.00	612.22	1.5	612.22	275.50		51.43
C.L. QUEST DRIVE	URBAN	1+13.00	13+65.00	1252.00	1.50				93.90	1252.00	
URBAN TOTAL =								4494.78	2116.55	1252.00	377.56
USE =								4495.00	2117.00	1252.00	378.00
								SQ YD	POUND	FOOT	TON

NOTE:
SEE SHEET 8 FOR ADDITIONAL QUANTITIES ON PAY ITEMS 44000155 AND 40600290.

70300100 SHORT TERM PAVEMENT MARKING

70300150 SHORT TERM PAVEMENT MARKING REMOVAL

LOCATION	STATION	TO	STATION	70300100 QUANTITY (FT)	APPLY AFTER	COLOR	70300150 QUANTITY (SQ FT)	
C.L. QUEST DRIVE	SKIP-DASH	URBAN	1+13.00	12+20.00	232.00	MILLING & HMA SURFACE	YELLOW	38.67
				URBAN TOTAL =	232.00		URBAN TOTAL =	38.67
				USE =	232.00		USE =	38.00
					FT			SQ FT

NOTE:
SHORT TERM PAVEMENT MARKINGS WILL BE REMOVED FROM THE FINAL SURFACE ONLY.

VOID REPAIR SCHEDULE FOR MAINLINE PAVEMENT

LOCATION	STATION	TO	STATION	AREA (SQ YD)	AVERAGE THICKNESS (INCHES)	35800100 PREPARATION OF BASE (SQ YD)	40600900 HOT-MIX ASPHALT BINDER COURSE HAND METHOD, N50 (TON)
RT. QUEST DRIVE	URBAN	1+13.00	13+65.00	88.00	1.5	88.00	7.39
LT. QUEST DRIVE	URBAN	1+13.00	13+65.00	114.00	1.5	114.00	9.58
URBAN TOTAL =						202.00	16.97
USE =						202.00	17.00
						SQ YD	TON

NOTES:
THERE ARE SECTIONS IN THE MAINLINE PAVEMENT THAT ARE IN POOR CONDITION. THE INTENT IS TO PREPARE THE BASE AND FILL THE VOIDS PER THE DIRECTION OF THE ENGINEER. THIS WORK CAN BE COMPLETED EITHER PRIOR TO THE MILLING OPERATIONS AND/OR AFTER THE MILLING OPERATIONS ARE COMPLETE AND PRIOR TO THE PLACEMENT OF THE SURFACE COURSE.
SEE SHEET 8 FOR ADDITIONAL QUANTITIES ON PAY ITEM 35800100.

40600990 TEMPORARY RAMP

LOCATION	STATION	TO	STATION	DROP (INCH)	LENGTH (FT)	WIDTH (FT)	QUANTITY (SQ YD)	CONSTRUCT AFTER:
RT. QUEST DRIVE	URBAN	1+13.00	1+18.00	1.50	5.00	12.00	6.67	MILLING
LT. QUEST DRIVE	URBAN	1+13.00	1+18.00	1.50	5.00	12.00	6.67	MILLING
URBAN TOTAL =							13.33	
USE =							14.00	
							SQ YD	

48102100 AGGREGATE WEDGE SHOULDERS, TYPE B

LOCATION	STATION	TO	STATION	LENGTH (FT)	WIDTH (FT)	AVE. DEPTH (INCHES)	48102100 QUANTITY (TON)
RT. QUEST DRIVE	URBAN	1+13.00	3+41.00	228.00	3.00	1.25	4.75
RT. QUEST DRIVE	URBAN	3+80.00	4+25.00	45.00	3.00	1.25	0.94
RT. QUEST DRIVE	URBAN	4+80.00	5+48.00	68.00	3.00	1.25	1.42
RT. QUEST DRIVE	URBAN	6+06.00	8+20.00	214.00	3.00	1.25	4.46
RT. QUEST DRIVE	URBAN	8+66.00	9+44.00	78.00	3.00	1.25	1.63
RT. QUEST DRIVE	URBAN	9+87.00	12+29.00	242.00	3.00	1.25	5.04
QUEST DRIVE	URBAN	CULDESAC	CULDESAC	126.00	3.00	1.25	2.63
LT. QUEST DRIVE	URBAN	1+13.00	2+10.00	97.00	3.00	1.25	2.02
LT. QUEST DRIVE	URBAN	2+27.00	3+16.00	89.00	3.00	1.25	1.85
LT. QUEST DRIVE	URBAN	3+64.00	3+96.00	32.00	3.00	1.25	0.67
LT. QUEST DRIVE	URBAN	4+67.00	5+39.00	72.00	3.00	1.25	1.50
LT. QUEST DRIVE	URBAN	6+17.00	7+14.00	97.00	3.00	1.25	2.02
LT. QUEST DRIVE	URBAN	8+69.00	12+66.00	397.00	3.00	1.25	8.27
LT. US 51	RURAL	1544+64.00	1545+10.00	46.00	2.00	2.50	1.28
LT. US 51	RURAL	1545+40.00	1547+00.00	160.00	2.00	2.50	4.44
RT. US 51	RURAL	1544+64.00	1545+10.00	46.00	2.00	2.50	1.28
RT. US 51	RURAL	1545+40.00	1545+88.00	48.00	2.00	2.50	1.33
URBAN TOTAL =							37.19
USE =							38.00
RURAL TOTAL =							8.33
USE =							9.00
GRAND TOTAL =							47.00
							TON

MODEL: \\MODEL\MNMF... FILE: \\MAILS... PROJECT: D:\PROJECTS\DOT OFFICES\DOT\Documents\DOT OFFICES\DOT\DOT OFFICES\DOT OFFICES\DOT OFFICES\DOT OFFICES\Schedule.dwg

USER NAME = eaglinga	DESIGNED -	REVISED -
	DRAWN -	REVISED -
PLOT SCALE = 40,0000 */ in.	CHECKED -	REVISED -
PLOT DATE = 4/18/2022	DATE -	REVISED -

**STATE OF ILLINOIS
DEPARTMENT OF TRANSPORTATION**

SCHEDULE OF QUANTITIES	
SCALE:	SHEET 1 OF 2 SHEETS STA. TO STA.

F.A.P. RTE.	SECTION	COUNTY	TOTAL SHEETS	SHEET NO.
	CM2023-1	**	18	7
CONTRACT NO. 70F89				
ILLINOIS FED. AID PROJECT				

* 322 & 322 FRONTAGE RD
** DEWITT & MCLEAN

SCHEDULE OF QUANTITIES

INCIDENTAL HOT-MIX ASPHALT SCHEDULE

STATION	DESCRIPTION			EXISTING AREA (SQ YD)	THICKNESS (INCHES)	X4400196	Z0038119	35800100	35800200	40800029	40800050	COMMENTS	
						HMA SURFACE REMOVAL, SPECIAL (SQ YD)	P.C.C. SURFACE REMOVAL 1-1/2" (SQ YD)	PREPARATION OF BASE (SQ YD)	AGGREGATE BASE REPAIR (TON)	BITUMINOUS MATERIALS TACK COAT (POUND)	INCIDENTAL HMA SURFACING (TON)		
LT.	2+24.00	16'	P.E.	URBAN	28.00	1.50	28.00				12.60	2.35	10 FT FROM EOP
LT.	3+41.00	25'	C.E.	URBAN									NO WORK
RT.	3+62.00	25'	C.E.	URBAN	54.00	1.50		54.00			24.30	4.54	14 FT FROM EOP
LT.	4+40.00	25'	C.E.	URBAN									NO WORK
RT.	4+55.00	35'	C.E.	URBAN	150.00	1.50	150.00		25.00	3.0	67.50	12.60	33 FT FROM EOP
LT.	5+80.00	35'	C.E.	URBAN	90.00	1.50	90.00				40.50	7.56	10 FT FROM EOP
RT.	5+80.00	35'	C.E.	URBAN	164.00	1.50	164.00		34.00	11.0	73.80	13.78	33 FT FROM EOP
LT.	7+46.00	20'	C.E.	URBAN	70.00	1.50	70.00				31.50	5.88	10 FT FROM EOP
LT.	8+36.00	36'	C.E.	URBAN	98.00	1.50	98.00				44.10	8.23	10 FT FROM EOP
RT.	8+40.00	35'	C.E.	URBAN	51.00	1.50	51.00				22.95	4.28	10 FT FROM EOP
RT.	9+65.00	32'	C.E.	URBAN	47.00	1.50	47.00				21.15	3.95	10 FT FROM EOP
RT.	12+48.50	14'	C.E.	URBAN	34.00	1.50	34.00				15.30	2.86	12 FT FROM EOP
RT.	12+76.00	30'	C.E.	URBAN									NO WORK
LT.	12+87.00	35'	C.E.	URBAN									NO WORK
RT.	13+54.00	42'	C.E.	URBAN									NO WORK
URBAN TOTAL =							732.00	54.00	59.00	14.00	353.70	66.02	
USE =							732.00	54.00	59.00	14.00	354.00	67.00	
							SQ YD	SQ YD	SQ YD	TON	POUND	TON	

NOTE:
SEE SHEET 7 FOR ADDITIONAL QUANTITIES ON PAY ITEM 35800100.

MEDIAN TURNAROUND SCHEDULE

LOCATION	STATION	TO	STATION	LENGTH (Ft)	AVERAGE WIDTH (Ft)	AREA (SQ YD)	HMA THICKNESS (INCHES)	44000155	44000165	44004250	40600275	40600290	48203100	
								HMA SURFACE REMOVAL, 1-1/2" (SQ YD)	HMA SURFACE REMOVAL, 4" (SEE NOTE) (SQ YD)	PAVED SHOULDER REMOVAL (SQ YD)	BITUMINOUS MATERIAL PRIME COAT (POUND)	BITUMINOUS MATERIAL TACK COAT (POUND)	HOT-MIX ASPHALT SHOULDERS (TON)	
N.B.	US 51	RURAL	1544+64.00	1545+52.00	88.00	12.00	117.33	1.5	117.33			52.80	9.86	
N.B.	US 51	RURAL	1545+52.00	1545+88.00	36.00	9.00	36.00	1.5	36.00			16.20	3.02	
S.B.	US 51	RURAL	1544+64.00	1544+98.00	34.00	9.00	34.00	4.0		34.00		22.95	7.62	
S.B.	US 51	RURAL	1544+98.00	1547+00.00	202.00	12.00	269.33	4.0		269.33		181.80	60.33	
C.L.	US 51	RURAL	1544+98.00	1545+52.00	54.00	24.00	96.00	9.0			96.00	216.00	64.80	48.38
RURAL TOTAL =								153.33	303.33	96.00	216.00	338.55	129.21	
USE =								154.00	304.00	96.00	216.00	339.00	130.00	
								SQ YD	SQ YD	SQ YD	POUND	POUND	TON	

NOTES:
THE INTENT AT THE LOCATIONS SHOWN IS TO MILL 4" BELOW THE ELEVATION OF THE EXISTING EDGE OF PAVEMENT.
SEE SHEET 7 FOR ADDITIONAL QUANTITIES ON PAY ITEMS 44000155 AND 40600290.

78001110 PAINT PAVEMENT MARKING - LINE 4"

LOCATION	STATION	TO	STATION	78001110	COLOR		
				QUANTITY (FT)			
CL	QUEST DRIVE	DOUBLE YELLOW	URBAN	1+13.00	3+80.00	534.00	YELLOW
CL	QUEST DRIVE	SKIP DASH	URBAN	3+80.00	12+20.00	220.00	YELLOW
RT.	QUEST DRIVE	EOP	URBAN	1+13.00	12+20.00	1107.00	WHITE
LT.	QUEST DRIVE	EOP	URBAN	1+13.00	12+20.00	1107.00	WHITE
URBAN TOTAL =						2968.00	
USE =						2968.00	
						FT	

MODEL: I:\MODEL\MHFS
 FILE: MHFS_Plan\Subcontract\bea\cay.com\PIV\DOT\Documents\DOT_Offices\Dir\dir_5\Project\10570889\CADD\Drawn\CAD\Sheet\10570889\sh-Schedule.dgn

USER NAME = eaglinga	DESIGNED -	REVISED -
DRAWN -	REVISED -	
PLOT SCALE = 40,0000 */ in.	CHECKED -	REVISED -
PLOT DATE = 4/18/2022	DATE -	REVISED -

**STATE OF ILLINOIS
DEPARTMENT OF TRANSPORTATION**

SCHEDULE OF QUANTITIES			
SCALE:	SHEET 2 OF 2 SHEETS	STA.	TO STA.

F.A.P. RTE.	SECTION	COUNTY	TOTAL SHEETS	SHEET NO.
*	CM2023-1	**	18	8
CONTRACT NO. 70F89				
ILLINOIS			FED. AID PROJECT	

* 322 & 322 FRONTAGE RD
** DEWITT & MCLEAN

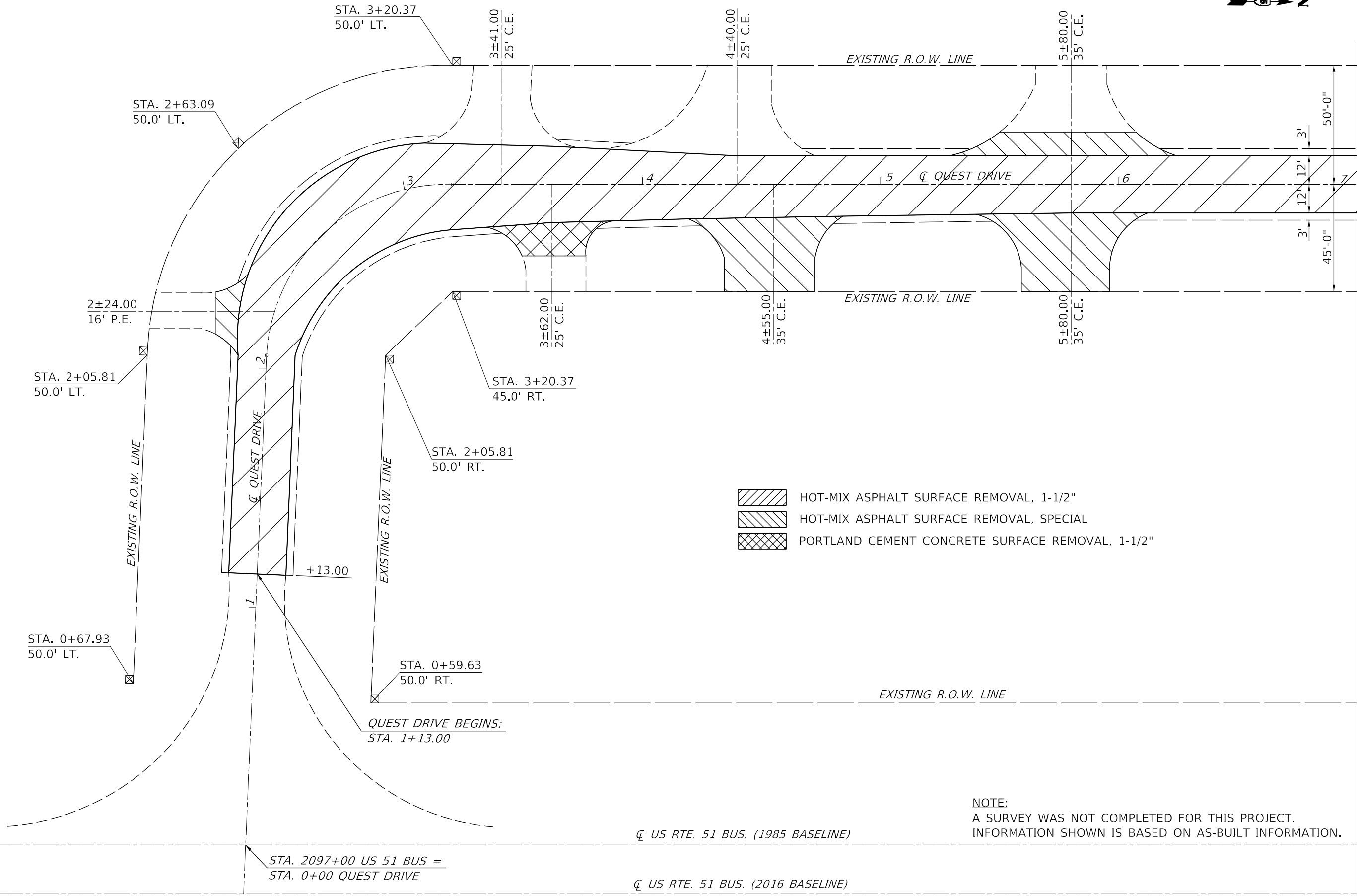

- HOT-MIX ASPHALT SURFACE REMOVAL, 1-1/2"
- HOT-MIX ASPHALT SURFACE REMOVAL, SPECIAL
- PORTLAND CEMENT CONCRETE SURFACE REMOVAL, 1-1/2"

NOTE:
A SURVEY WAS NOT COMPLETED FOR THIS PROJECT.
INFORMATION SHOWN IS BASED ON AS-BUILT INFORMATION.

MODEL: \\MODEL\MAME
 FILE NAME: \\PUB\c:\paw\beefy.com\PIV\DOT\Documents\DOT\Office\Dir\dr. S\Project\0570889\CADD\data\Quest\0570889-act\Quest.dgn
 PROJECT: 0570889\CADD\data\Quest\0570889-act\Quest.dgn

USER NAME = eaglinga	DESIGNED -	REVISED -
DRAWN -	REVISOR -	
PLOT SCALE = 40,0000 * / in.	CHECKED -	REVISOR -
PLOT DATE = 4/18/2022	DATE -	REVISOR -

**STATE OF ILLINOIS
DEPARTMENT OF TRANSPORTATION**

PLAN SHEETS	
QUEST DRIVE	
SCALE:	SHEET 1 OF 2 SHEETS STA. TO STA.

F.A.P. RTE.	SECTION	COUNTY	TOTAL SHEETS	SHEET NO.
*	CM2023-1	**	18	9
CONTRACT NO. 70F89				
ILLINOIS FED. AID PROJECT				

* 322 & 322 FRONTAGE RD
** DEWITT & MCLEAN

MATCH LINE STA. 7+00



NOTE:
A SURVEY WAS NOT COMPLETED FOR THIS PROJECT.
INFORMATION SHOWN IS BASED ON AS-BUILT INFORMATION.

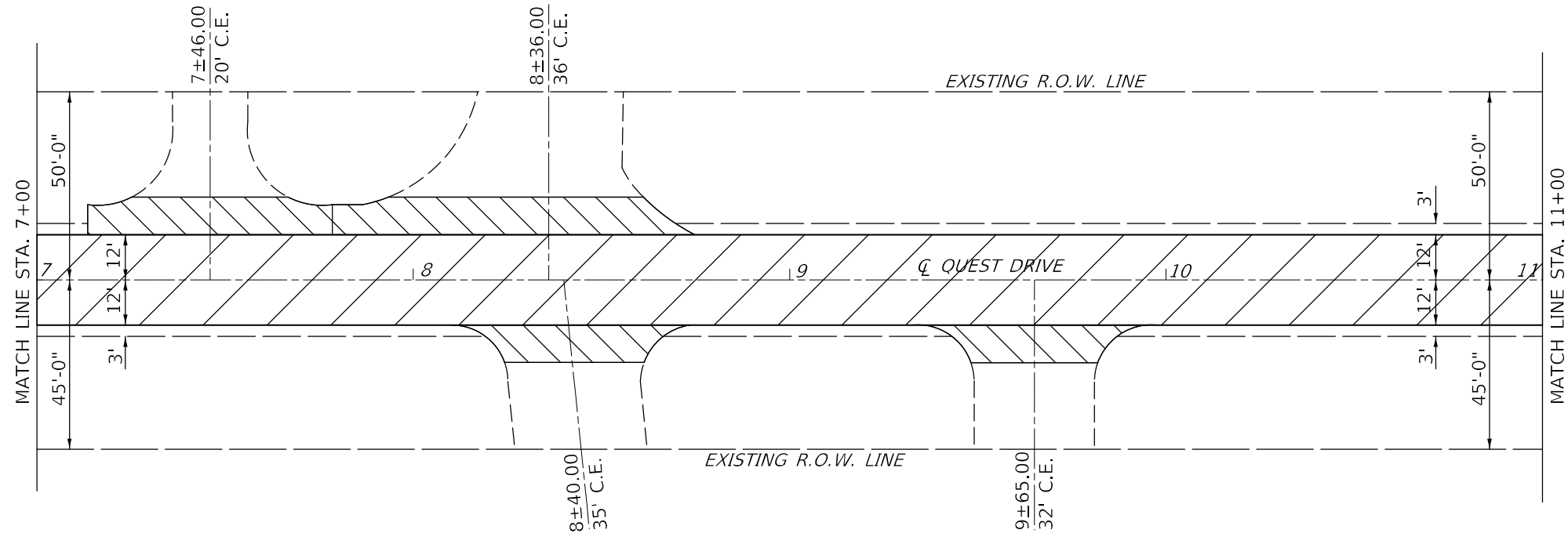

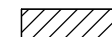
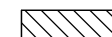

 HOT-MIX ASPHALT SURFACE REMOVAL, 1-1/2"
 HOT-MIX ASPHALT SURFACE REMOVAL, SPECIAL

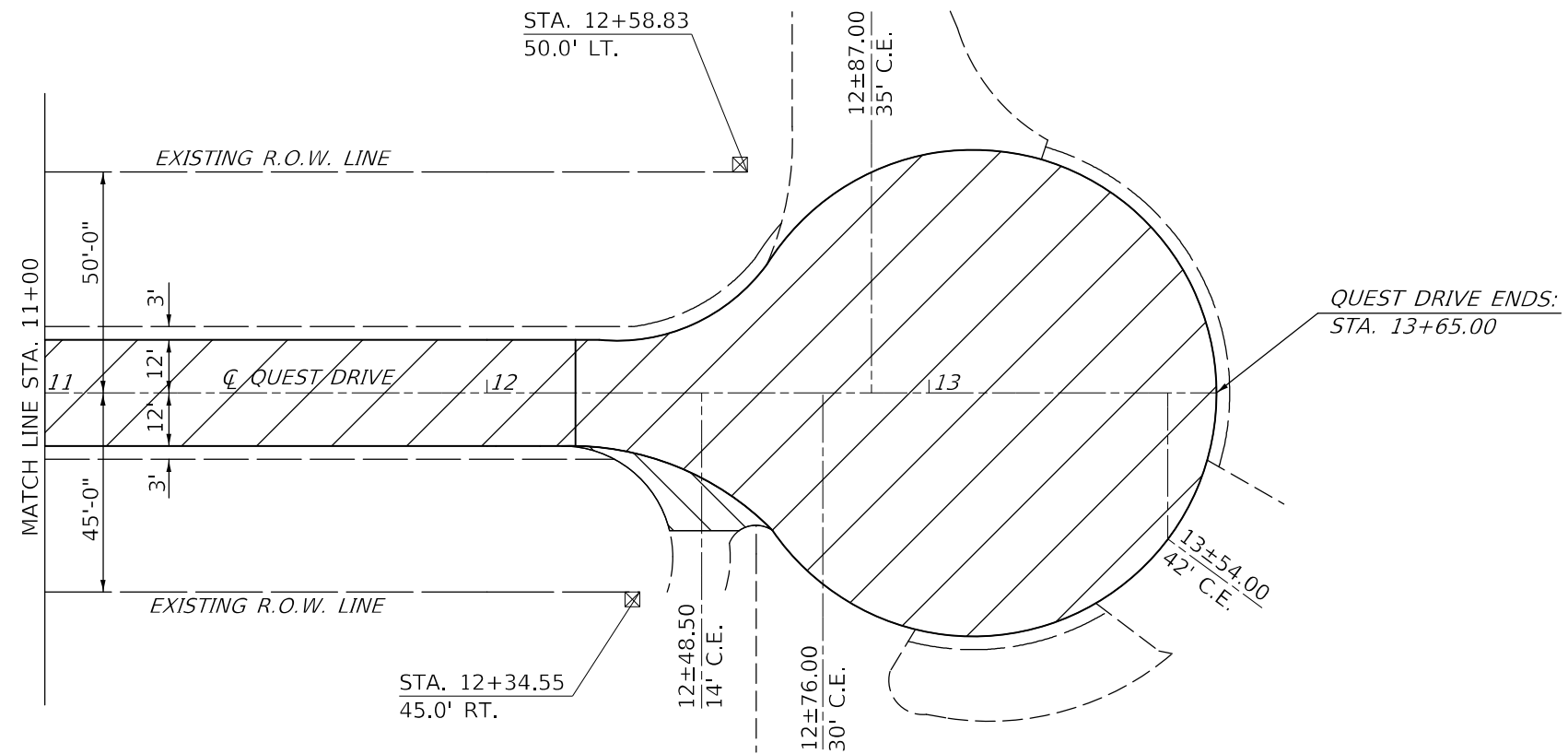

NOTE:
A SURVEY WAS NOT COMPLETED FOR THIS PROJECT.
INFORMATION SHOWN IS BASED ON AS-BUILT INFORMATION.



 HOT-MIX ASPHALT SURFACE REMOVAL, 1-1/2"
 HOT-MIX ASPHALT SURFACE REMOVAL, SPECIAL

MODEL: I:\MODEL\MAME FILE NAME: p:\pub\c-pw-bee\p\com\p\p\DOT\Documents\DOT Office\Drawings\Project\0570689\CADD\Drawings\0570689-31c-Design.dgn

USER NAME = eaglinga	DESIGNED -	REVISED -
	DRAWN -	REVISED -
PLOT SCALE = 40,0000 * / in.	CHECKED -	REVISED -
PLOT DATE = 4/18/2022	DATE -	REVISED -

**STATE OF ILLINOIS
DEPARTMENT OF TRANSPORTATION**

**PLAN SHEETS
QUEST DRIVE**

SCALE: SHEET 2 OF 2 SHEETS STA. TO STA.

F.A.P. RTE.	SECTION	COUNTY	TOTAL SHEETS	SHEET NO.
*	CM2023-1	**	18	10
CONTRACT NO. 70F89			ILLINOIS FED. AID PROJECT	

* 322 & 322 FRONTAGE RD
** DEWITT & MCLEAN

NOTE:
A SURVEY WAS NOT COMPLETED FOR THIS PROJECT.
INFORMATION SHOWN IS BASED ON AS-BUILT INFORMATION.

NW 1/4 SEC. 16, T.21N, R.2E., 3P.M.

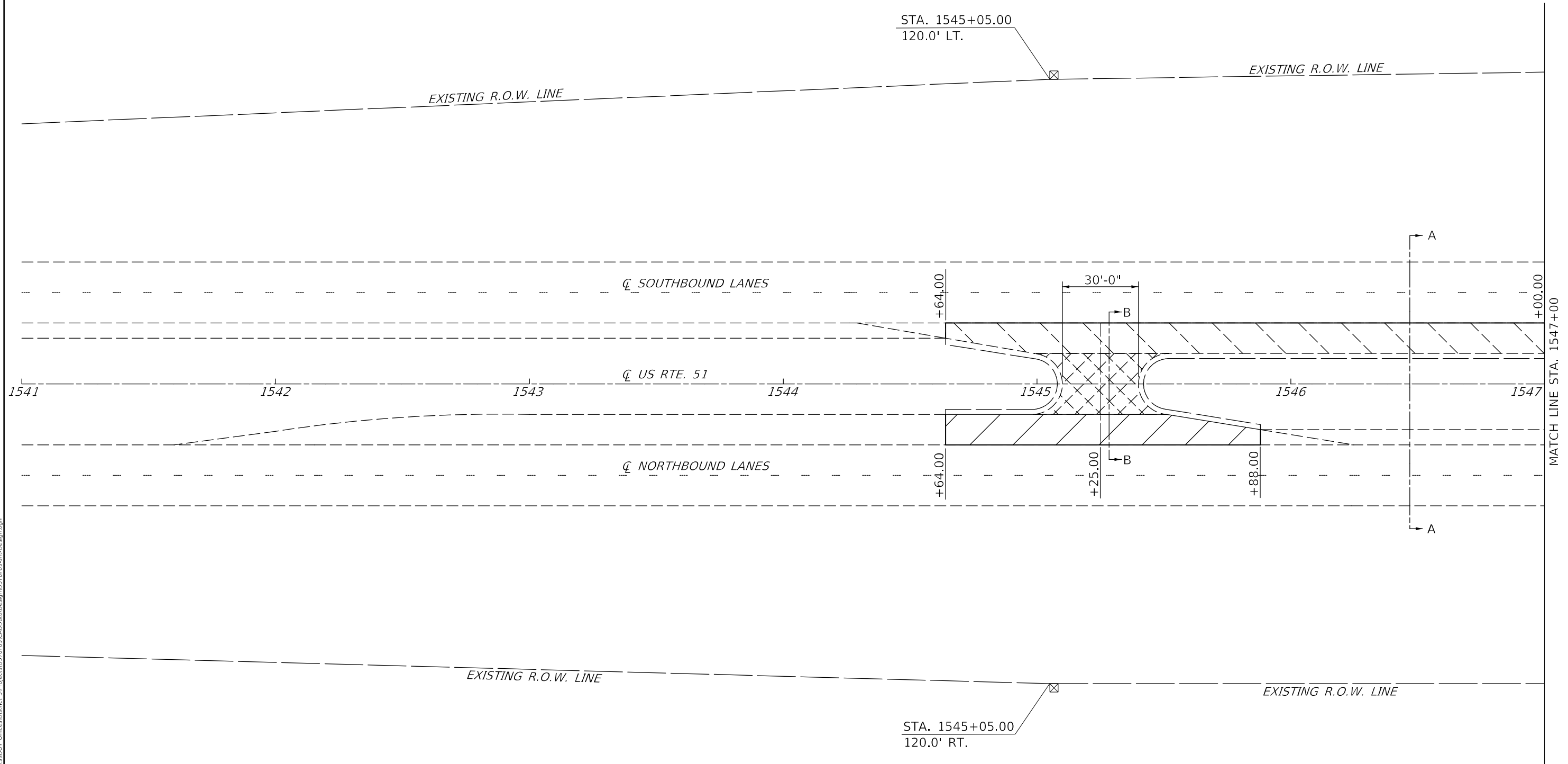

- HOT-MIX ASPHALT SURFACE REMOVAL, 1-1/2"
- HOT-MIX ASPHALT SURFACE REMOVAL, 4"
- PAVED SHOULDER REMOVAL

NW 1/4 SEC. 15, T.21N, R.2E., 3P.M.

MODEL: I:\MODELS\MXFS... FILE: 304161... PROJECT: I:\DOT\Documents\DOT Office\Dir\Dir... S:\Project\10570889\CADD\data\Drawings\10570889-31c-Design.dgn

USER NAME = eaglinga	DESIGNED -	REVISED -
	DRAWN -	REVISED -
PLOT SCALE = 40,0000 * / in.	CHECKED -	REVISED -
PLOT DATE = 4/18/2022	DATE -	REVISED -

**STATE OF ILLINOIS
DEPARTMENT OF TRANSPORTATION**

PLAN SHEETS			
US 51 MEDIAN TURNAROUND			
SCALE:	SHEET 1	OF 2 SHEETS	STA. TO STA.

F.A.P. RTE.	SECTION	COUNTY	TOTAL SHEETS	SHEET NO.
*	CM2023-1	**	18	11
CONTRACT NO. 70F89				
ILLINOIS FED. AID PROJECT				

* 322 & 322 FRONTAGE RD
** DEWITT & MCLEAN

NOTE:
 A SURVEY WAS NOT COMPLETED FOR THIS PROJECT.
 INFORMATION SHOWN IS BASED ON AS-BUILT INFORMATION.

NW 1/4 SEC. 16, T.21N, R.2E., 3P.M.

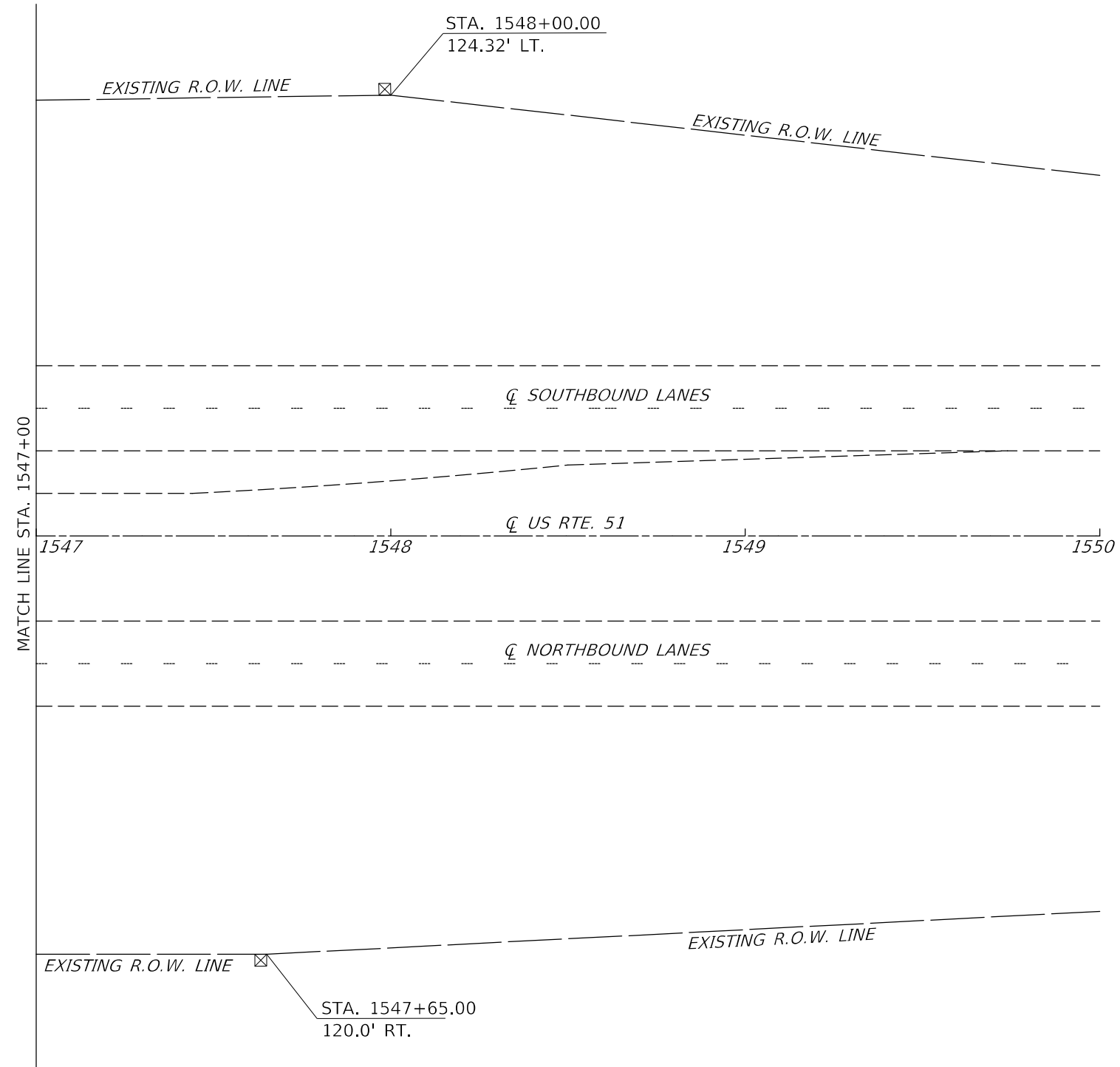

NW 1/4 SEC. 15, T.21N, R.2E., 3P.M.

MODEL: I:\MODEL\MAME
 FILE: MAME: p:\u\luc\paw\beadley.com\PIV\DOT\Documents\DOT Office\Dir\dir: S:\Project\0570689\CADD\data\Drawn\0570689-att-Design.dgn

* 322 & 322 FRONTAGE RD
 ** DEWITT & MCLEAN

USER NAME = eaglinga	DESIGNED -	REVISED -
	DRAWN -	REVISED -
PLOT SCALE = 40,0000 * / in.	CHECKED -	REVISED -
PLOT DATE = 4/18/2022	DATE -	REVISED -

**STATE OF ILLINOIS
 DEPARTMENT OF TRANSPORTATION**

**PLAN SHEETS
 US 51 MEDIAN TURNAROUND**

SCALE: SHEET 2 OF 2 SHEETS STA. TO STA.

F.A.P. RTE.	SECTION	COUNTY	TOTAL SHEETS	SHEET NO.
*	CM2023-1	**	18	12
CONTRACT NO. 70F89			ILLINOIS FED. AID PROJECT	

PROJECTS WITHOUT RECONSTRUCTION

S.M.A.R.T. IMPROVEMENTS (POLICY RESURFACING; BDE 53-4.03; 1½") * USE ON CONTRACT 70F89 *

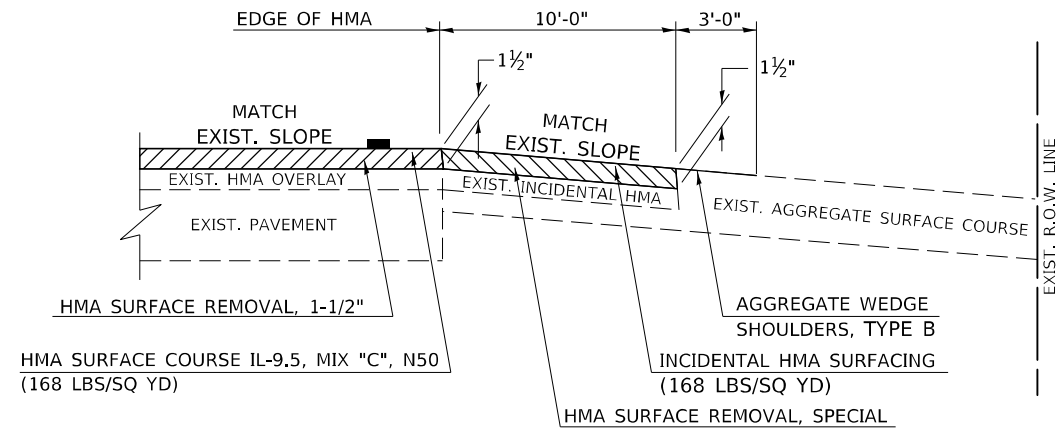

EXISTING AGGREGATE ENTRANCE

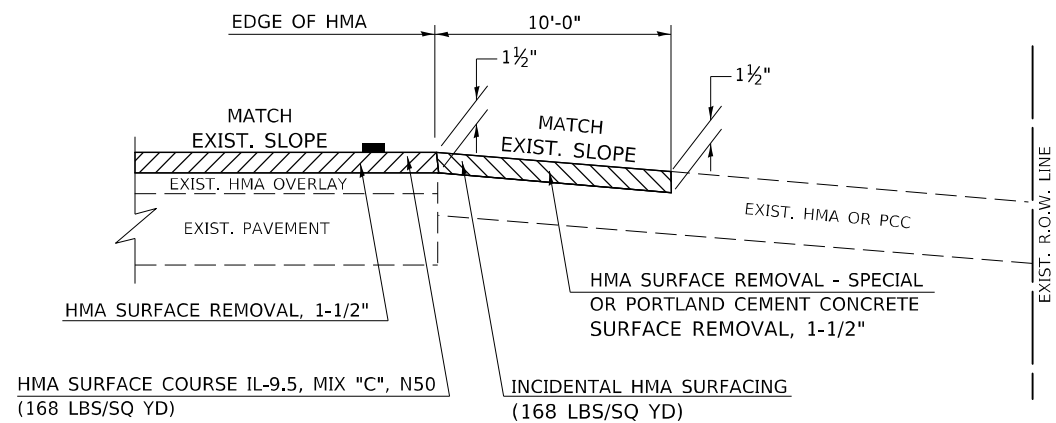

EXISTING HMA OR PCC ENTRANCE

"3P" OR "3R" IMPROVEMENTS (POLICY RESURFACING; BDE 53-4.02; 2¼" OR 2½" ON BARE CONCRETE) * DO NOT USE ON CONTRACT 70F89 *

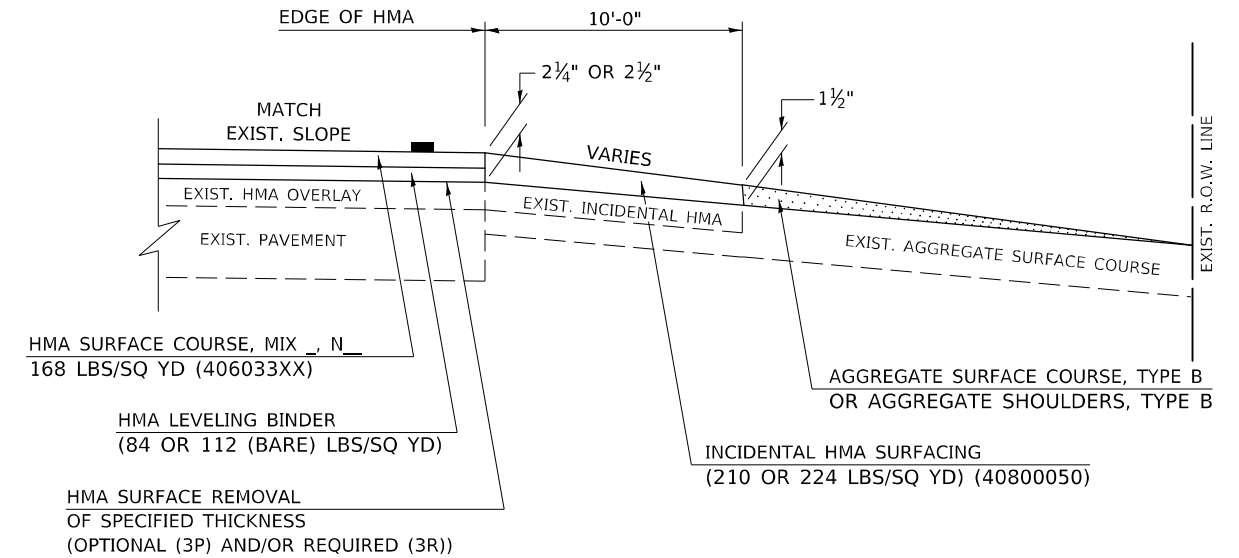

EXISTING AGGREGATE ENTRANCE

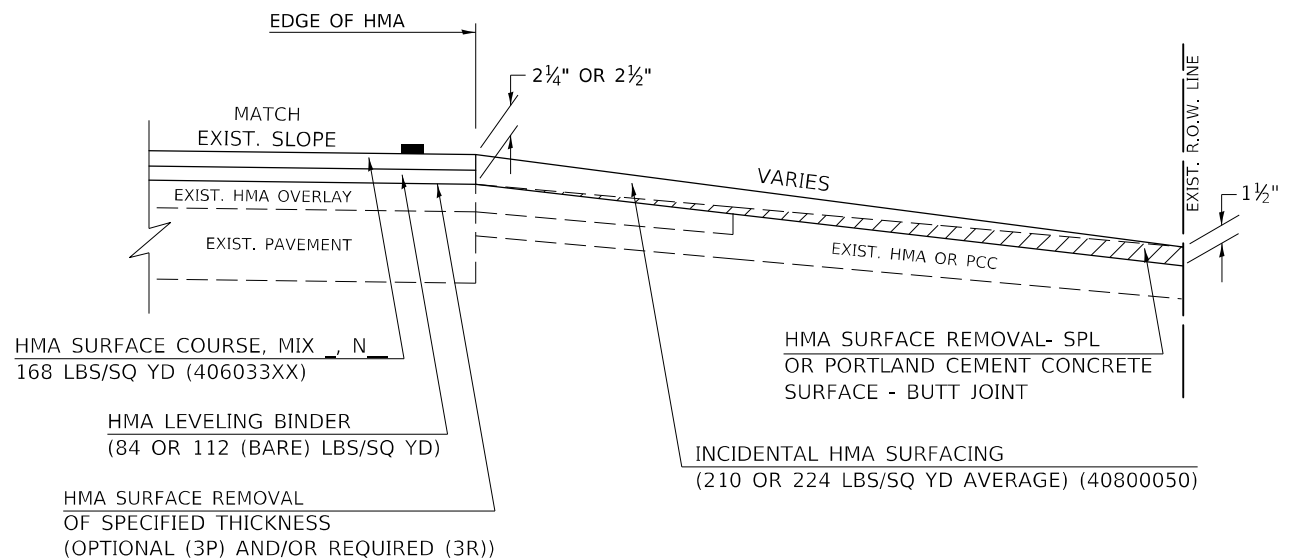

EXISTING HMA OR PCC ENTRANCE

Note: All dimensions are in INCHES (millimeters) unless otherwise shown.

MODEL: I:\MODEL\MHMF... FILE: 30416... PROJECT: 10570F89\CADD\DATA\CAD\Sheet10570F89-ent-Details.dwg

USER NAME = eaglinga	DESIGNED -	REVISED - 09/07 KAG
	DRAWN -	REVISED - 05/08 KJT
PLOT SCALE = 40,0000 * / in.	CHECKED -	REVISED - 04/10 KJT
PLOT DATE = 4/18/2022	DATE -	REVISED - 3/6/17 SWN

STATE OF ILLINOIS
DEPARTMENT OF TRANSPORTATION

PRIVATE COMMERCIAL ENTRANCES (NONCOMMERCIAL AND COMMERCIAL RURAL)			
SCALE:	SHEET 1	OF 2 SHEETS	STA. TO STA.

DISTRICT 5 DETAIL NO. 4080050C				
F.A.P. RTE.	SECTION	COUNTY	TOTAL SHEETS	SHEET NO.
*	CM2023-1	**	18	13
CONTRACT NO. 70F89				
ILLINOIS FED. AID PROJECT				

* 322 & 322 FRONTAGE RD
** DEWITT & MCLEAN

PROJECTS WITH RECONSTRUCTION

(3R IMPROVEMENTS)
* DO NOT USE ON CONTRACT 70F89 *

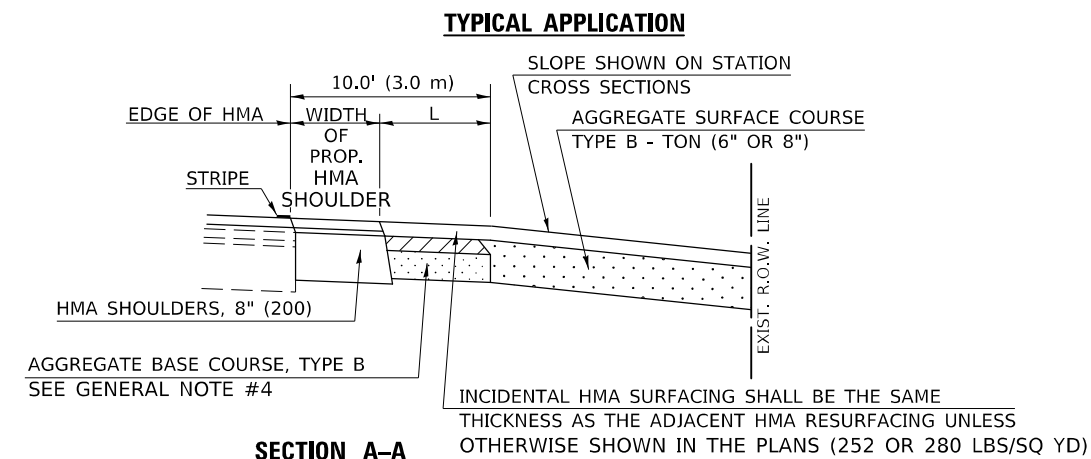
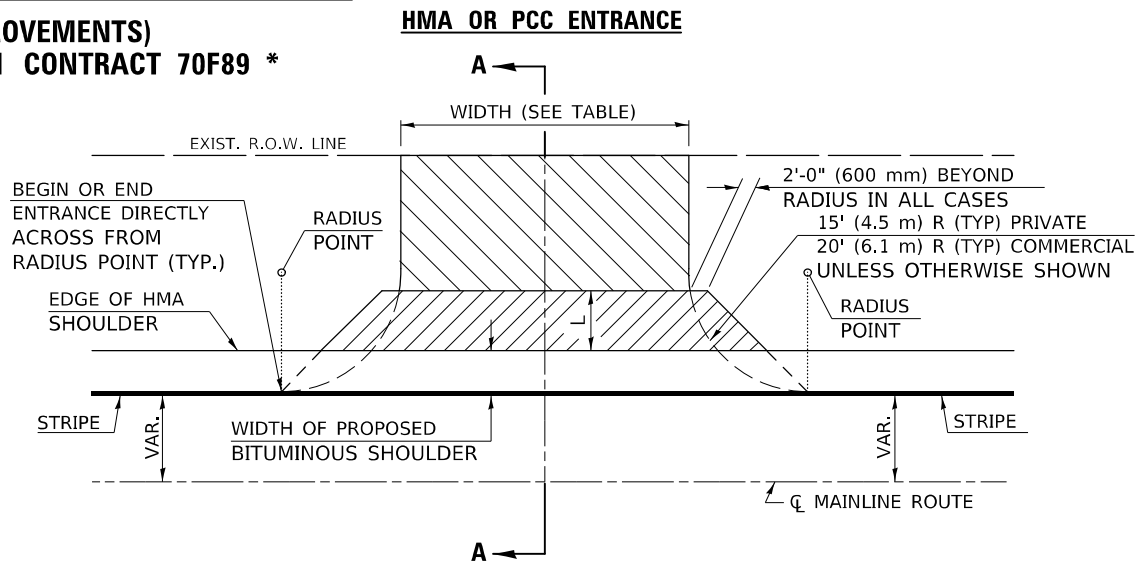
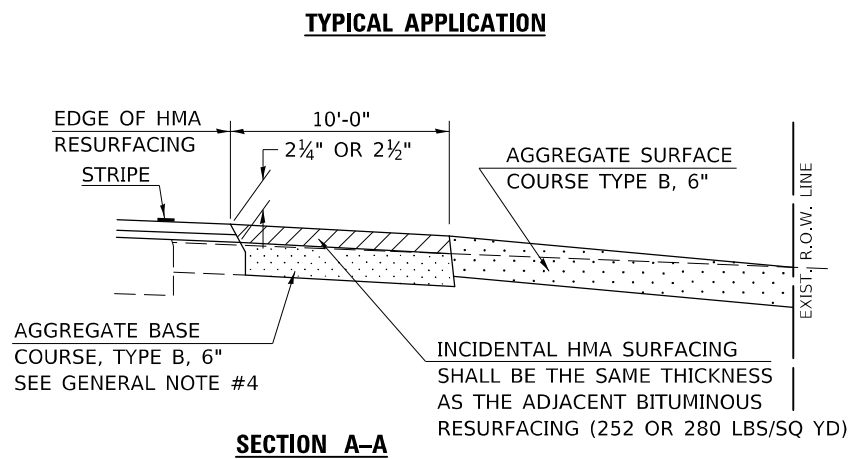
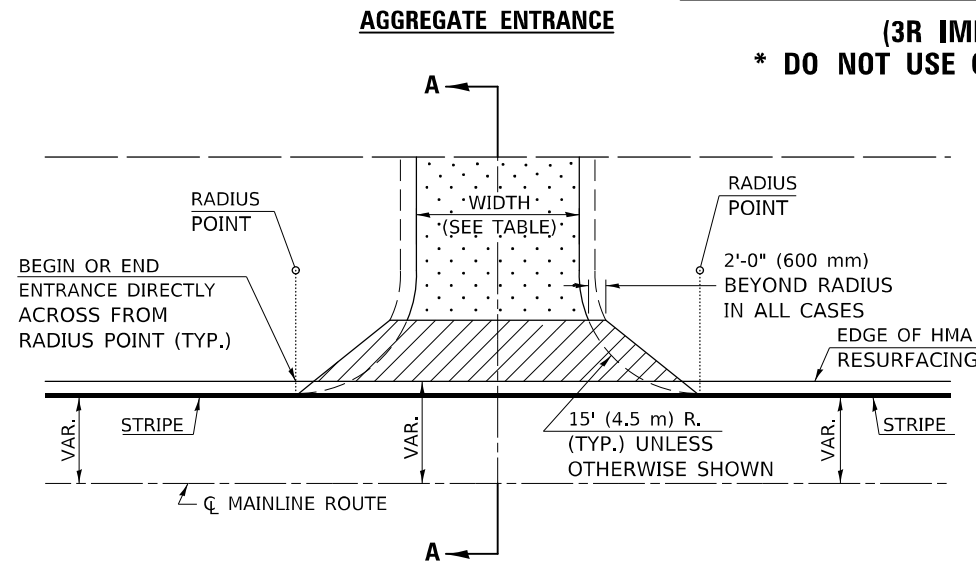

GENERAL NOTES

1. THE EXISTING SURFACE SHALL BE PREPARED IN ACCORDANCE WITH SECTION 408 OF THE STANDARD SPECIFICATIONS.
2. ANY NECESSARY WORK BEHIND THE HMA SHOULDER OR THE INCIDENTAL HMA SURFACING SHALL BE AS SHOWN IN THE PLANS AND/OR AS DIRECTED BY THE ENGINEER.
3. EARTH EXCAVATION REQUIRED FOR THE CONSTRUCTION OF THE AGGREGATE SURFACE COURSE SHALL BE INCLUDED IN THE COST OF AGGREGATE SURFACE COURSE.
4. AGGREGATE BASE COURSE, TYPE B, 6" (150 mm) MIN. SHALL BE USED WHERE IN THE OPINION OF THE ENGINEER THERE IS NOT SUFFICIENT BASE MATERIAL FOR THE PROPOSED ENTRANCES. THIS MATERIAL SHALL GENERALLY BE USED TO WIDEN ANY EXISTING RETURN OR TO CONSTRUCT NEW ENTRANCES WHERE NONE NOW EXISTS.
5. THE AGGREGATE BASE COURSE SHALL BE CONSTRUCTED 12" (300 mm) WIDER THAN THE SURFACE DIMENSIONS AS SHOWN ABOVE.
6. EXISTING FIELD ENTRANCES OF AGGREGATE OR EARTH WITH NO HMA APRON SHALL NOT RECEIVE A NEW HMA APRON WITHOUT PROPER APPROVAL THROUGH THE BUREAU OF OPERATIONS "POLICY ON PERMITS FOR ACCESS DRIVEWAYS TO STATE HIGHWAYS".

TO ASSURE APPROPRIATE ACCESS POLICIES ARE FOLLOWED ALL NEW ACCESS SHALL BE APPLIED FOR THROUGH THE BUREAU OF OPERATIONS PERMIT APPLICATION PROCESS. PLAN PREPARATION MEMORANDUMS 40-09 ALONG WITH DISTRICT PROJECT IMPLEMENTATION MEMO 104/01 DISCUSS THIS PROCEDURE.

Note: All dimensions are in INCHES (millimeters) unless otherwise shown.

RURAL ENTRANCE DESIGN STANDARDS (PPM 40-09)															
DESIGN ELEMENT	NEW CONSTRUCTION & 3R with CONSTRUCTION						3R w/out RECONSTRUCTION, 3P, SMART & CM								
	NONCOMMERCIAL			FIELD W/FARM IMPLEMENTS			COMMERCIAL			NONCOMMERCIAL			COMMERCIAL		
	min.	des.	max.	min.	max.	min.	des.	max.	min.	des.	max.	min.	des.	max.	
SURFACE WIDTH (FT)	12	16	24	24	30	1 LANE, 1 WAY			1 LANE, 1 WAY			1 LANE, 1 WAY			
						14	16	24							
RADIUS (FT)	15	25	40	30		2 LANE, 2 WAY			2 LANE, 2 WAY			2 LANE, 2 WAY			
						24	30	35							
SHOULDER WIDTH (FT)	2	2		2		1	3		resurface existing configuration; existing aggregate or earth entrances shall have the continuation of aggregate shoulders placed behind them						
SHOULDER SLOPE (%)	2	4	6	4		2	4	6							
ENTRANCE GRADE (%)	0	2 to 5	10 or 12	2 to 5	10 or 12	0	2 to 5	8 or 10							
SIDE SLOPE (FT)	1:10	1:6	1:4	1:6	1:4	1:10	1:6	1:4							
SURFACE TYPE															
INCIDENTAL HMA SURFACING (INCH)		2		2		3 or 4			taper from hma resurfacing thickness (2 1/2", 2 1/4" or 1 1/2") to 1 1/2" to minimize aggregate shoulder						
AGGREGATE SURFACE COURSE, TYPE B (INCH)		6		6		8			if applicable, use items: Preparation of Base & Aggregate Base Repair; see PPM 30-02						
PCC DRIVEWAY PAVEMENT (INCH)		6						6 or 8							

* 322 & 322 FRONTAGE RD
** DEWITT & MCLEAN

DISTRICT 5 DETAIL NO. 40800050C

USER NAME = eaglinga	DESIGNED -	REVISED - 09/07 KAG
	DRAWN -	REVISED - 05/08 KJT
PLOT SCALE = 40,0000 * / in.	CHECKED -	REVISED - 04/10 KJT
PLOT DATE = 4/18/2022	DATE -	REVISED - 3/6/17 SWN

STATE OF ILLINOIS
DEPARTMENT OF TRANSPORTATION

PRIVATE COMMERCIAL ENTRANCES
(NONCOMMERCIAL AND COMMERCIAL RURAL)

SCALE: SHEET 2 OF 2 SHEETS STA. TO STA.

F.A.P. RTE.	SECTION	COUNTY	TOTAL SHEETS	SHEET NO.
*	CM2023-1	**	18	14
CONTRACT NO. 70F89				
ILLINOIS FED. AID PROJECT				

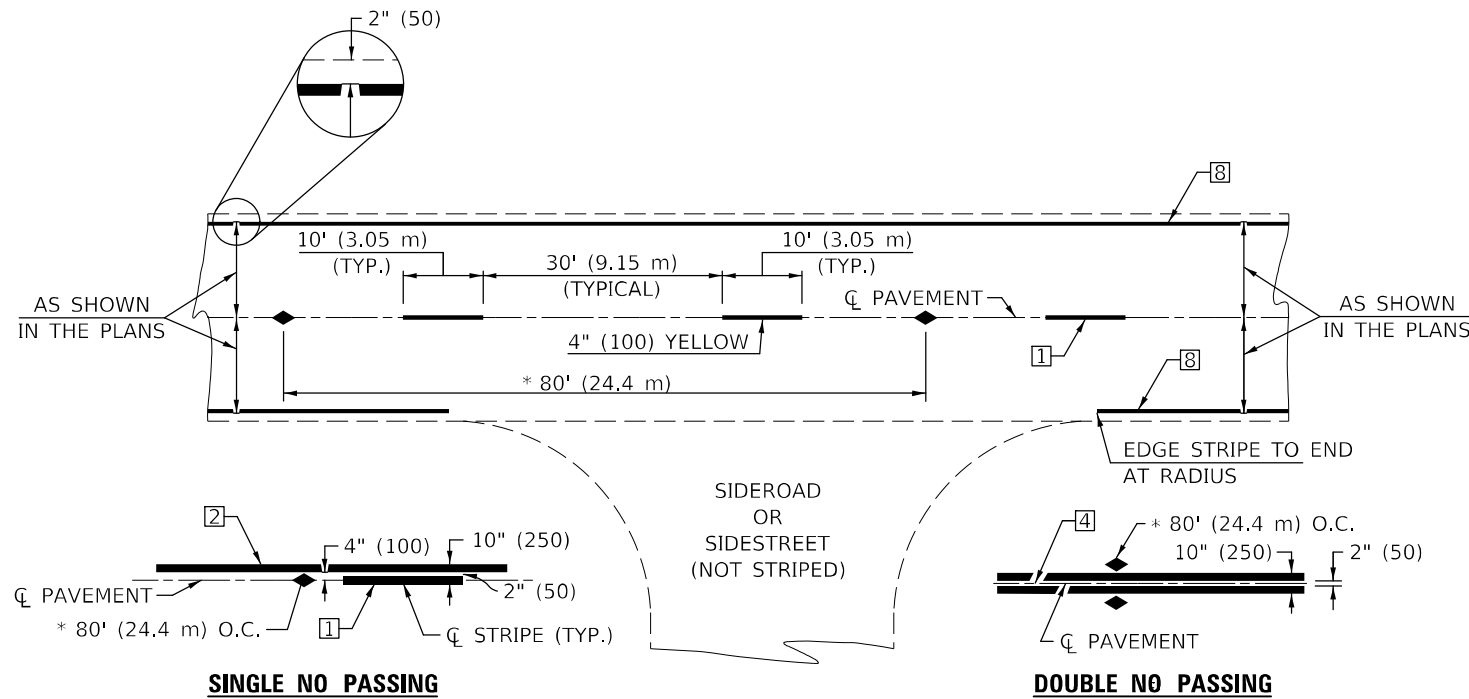

* REDUCE TO 40' (12.2 m) O.C. ON CURVES WITH POSTED OR ADVISORY SPEEDS OF 45 mph (70 km/h) OR LESS.

TWO LANE/TWO WAY

TYPICAL PAVEMENT MARKING LEGEND

- 1 4" (100) SKIP-DASH (YELLOW)
- 2 4" (100) SOLID (YELLOW)
- 3 12" (300) DIAGONAL (YELLOW)
- 4 4" (100) DOUBLE YELLOW (NARROW)
- 5 RESERVED
- 6 RESERVED
- 7 4" (100) SKIP-DASH (WHITE)
- 8 4" (100) SOLID (WHITE)
- 9 12" (300) DIAGONAL (WHITE)
- 10 6" (150) SOLID (WHITE)
- 11 24" (600) STOP BAR (WHITE)
- 12 8" (200) SOLID (WHITE)
- 13 4" (100) LANE LINE EXTENSIONS (WHITE)
- 14 4" (100) PARKING WHITE

TYPICAL PAVEMENT MARKERS LEGEND

- ◆ TWO-WAY AMBER MARKER
- ▶ ONE-WAY AMBER MARKER
- ▷ ONE-WAY CRYSTAL MARKER

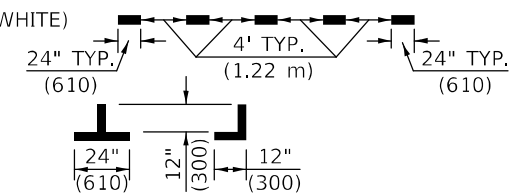
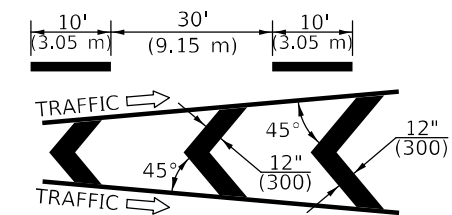
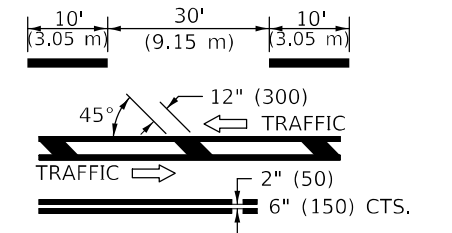

RURAL LEFT TURN

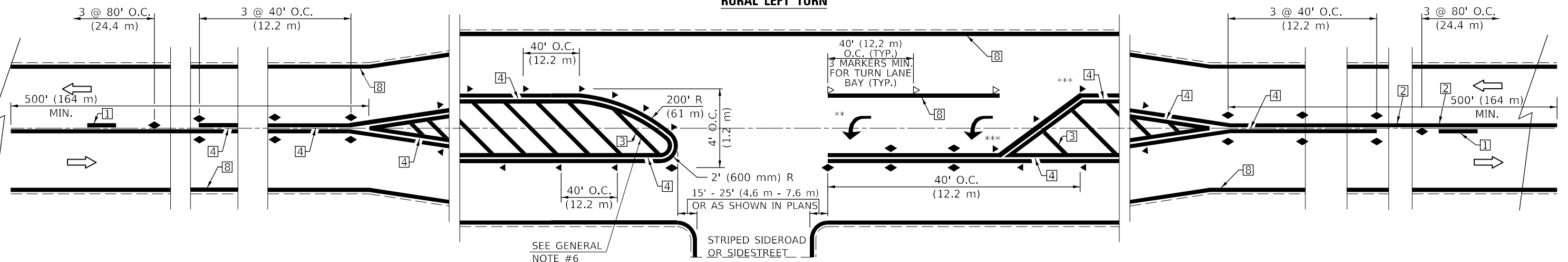

*** REDUCE SPACING IF NECESSARY TO ASSURE MARKERS AT CORNER POINTS.
 ** TURN ARROWS SHALL BE PLACED AS SHOWN ON SHEET #2.

Note: All dimensions are in INCHES (millimeters) unless otherwise shown.

MODEL: I:\MODEL MARKS FILE: MARKS_PAVEMENT.dwg, com: P:\VINDOT\Documents\DOT Office\Drawings\Project\0570889\0570889-Details.dwg

USER NAME = eaglinga	DESIGNED -	REVISD - 11/06
	DRAWN -	REVISD - 9/2009 KJT
PLOT SCALE = 40,0000 */ in.	CHECKED -	REVISD - 04/14 JLA
PLOT DATE = 4/18/2022	DATE -	REVISD - 3/2019 SWN

**STATE OF ILLINOIS
DEPARTMENT OF TRANSPORTATION**

**PAVEMENT MARKING AND MARKERS
(RURAL & URBAN APPLICATIONS)**

SCALE: SHEET 1 OF 4 SHEETS STA. TO STA.

DISTRICT 5 DETAIL NO. 7800AAAA

F.A.P. RTE.	SECTION	COUNTY	TOTAL SHEETS	SHEET NO.
*	CM2023-1	**	18	15
CONTRACT NO. 70F89				
ILLINOIS FED. AID PROJECT				

* 322 & 322 FRONTAGE RD
 ** DEWITT & MCLEAN

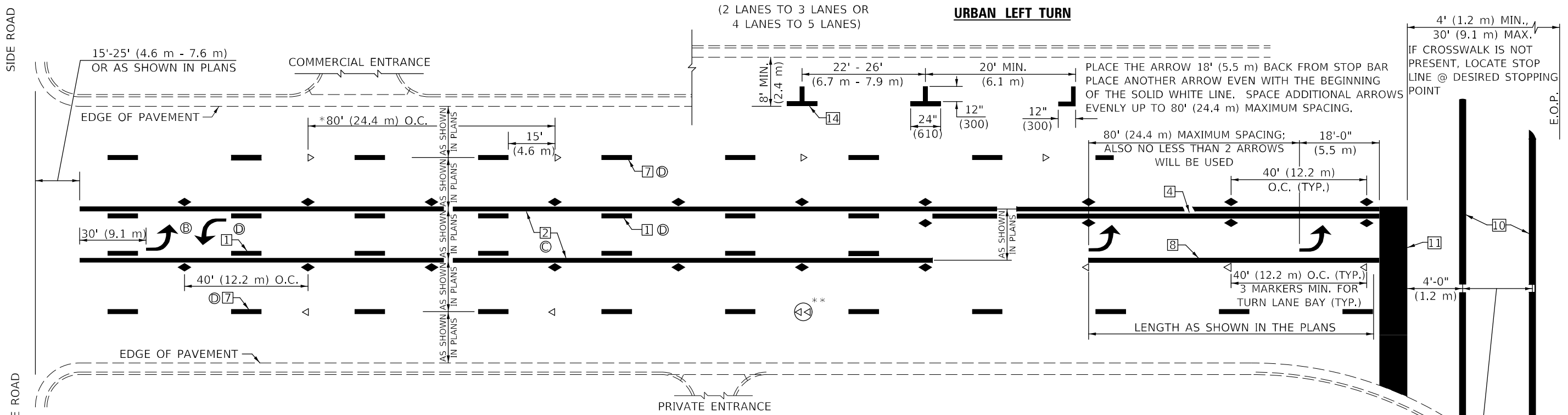

* REDUCE TO 40 FEET (12.2 METERS) ON CENTER ON CURVES WHERE ADVISORY SPEEDS ARE 10 MPH (15 km/h) LOWER THAN POSTED SPEEDS.

** DOUBLE LANE LINE MARKERS SHALL BE SPECIFIED AND SPACED AS SHOWN IN HIGHWAY STANDARD 781001 FOR MULTI-LANE DIVIDED AND UNDIVIDED HIGHWAYS.

GENERAL NOTES:

- (B) TURN ARROW PAIRS SHALL BE PLACED AT 250' (75 m) INTERVALS AND SHALL BE EVENLY SPACED BETWEEN BOTH ENDS OF THE BIDIRECTIONAL LEFT TURN LANE.
- (C) THE SOLID YELLOW PAVEMENT MARKINGS [2] SHOULD GENERALLY START OR END NEAR THE RADIUS POINT OF EACH STREET RETURN EXCEPT WHERE ONE OR BOTH ENDS WOULD INCLUDE STOP BARS.
- (D) THE SKIP-DASH PAVEMENT MARKINGS [1] OR [7] SHOULD BE CENTERED BETWEEN BOTH ENDS OF EACH CITY BLOCK AND SHALL BE PLACED SO THEY LINE UP ACROSS FROM EACH OTHER. SEE EXAMPLE ON SHEET 2 OF 3.
- (E) USE LARGE ARROW SIZE FOR BOTH RURAL AND URBAN LOCATIONS. (SEE LAST PAGE OF SECTION 780x FOR SYMBOLS TABLE)

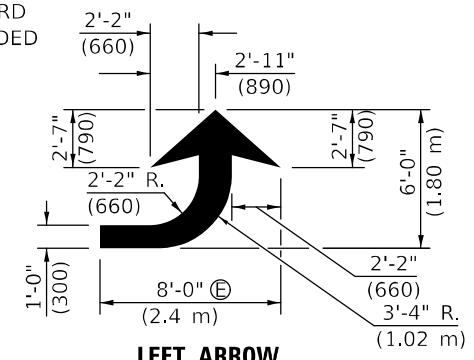

LEFT ARROW

REVERSE FOR RIGHT ARROW
 AREA = 15.6 SQ. FT. (1.47 m²)
 (WHITE)

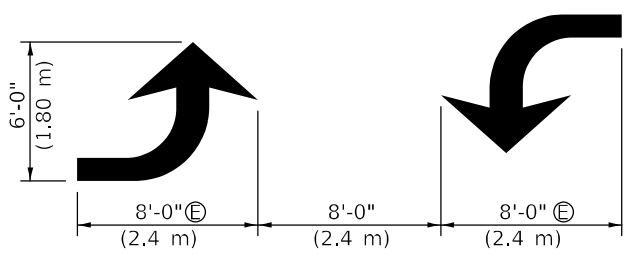

TYPICAL DOUBLE TURN ARROWS (WHITE)

BLOOMINGTON-NORMAL CITY LIMITS ONLY

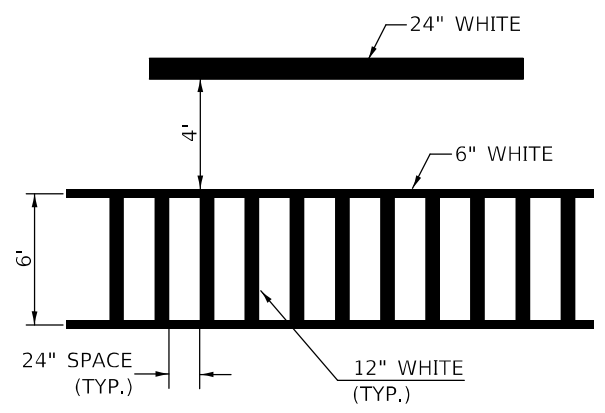

TYPICAL SPACING FOR CROSSWALKS & STOP BARS

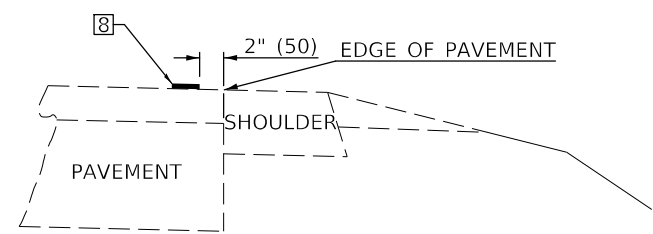

RELATIONSHIP OF EDGE LINE TO EDGE OF PAVEMENT
 (SAFETY SHOULDER OR PAVED SURFACE)
 SEE ARTICLE 780.04

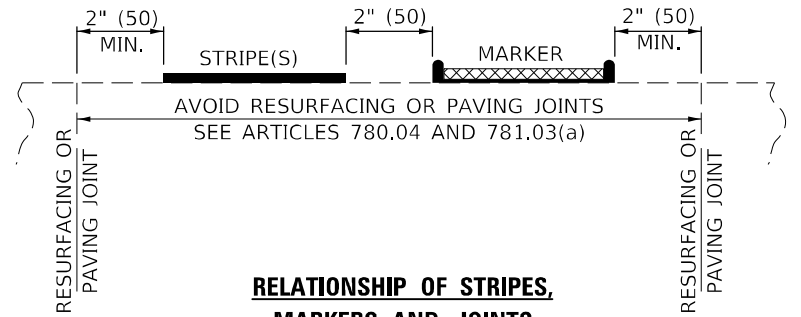

RELATIONSHIP OF STRIPES, MARKERS AND JOINTS

Note: All dimensions are in INCHES (millimeters) unless otherwise shown.

MODEL: I:\MODEL\MARKS FILE: MARKS_PAVEMENT.dwg DATE: 4/18/2022

USER NAME = eaglinga	DESIGNED -	REVISD - 11/06
	DRAWN -	REVISD - 9/2009 KJT
PLOT SCALE = 40,0000 */ in.	CHECKED -	REVISD - 04/14 JLA
PLOT DATE = 4/18/2022	DATE -	REVISD - 3/2019 SWN

**STATE OF ILLINOIS
 DEPARTMENT OF TRANSPORTATION**

**PAVEMENT MARKING AND MARKERS
 (RURAL & URBAN APPLICATIONS)**

SCALE: SHEET 2 OF 4 SHEETS STA. TO STA.

DISTRICT 5 DETAIL NO. 7800AAAA				
F.A.P. RTE.	SECTION	COUNTY	TOTAL SHEETS	SHEET NO.
*	CM2023-1	**	18	16
CONTRACT NO. 70F89				
ILLINOIS FED. AID PROJECT				

* 322 & 322 FRONTAGE RD
 ** DEWITT & MCLEAN

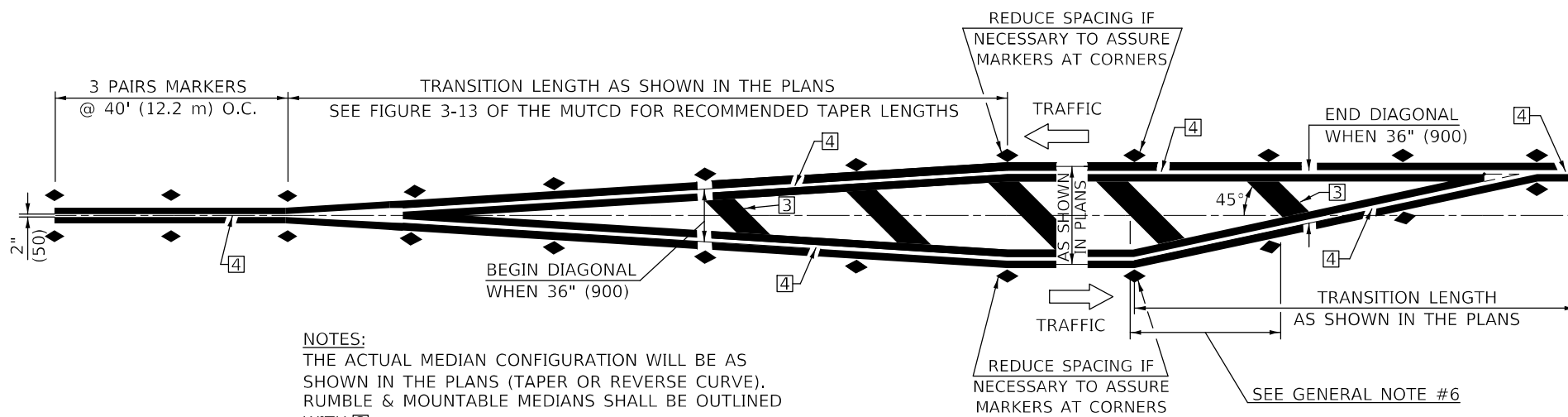

NOTES:
 THE ACTUAL MEDIAN CONFIGURATION WILL BE AS SHOWN IN THE PLANS (TAPER OR REVERSE CURVE). RUMBLE & MOUNTABLE MEDIANS SHALL BE OUTLINED WITH [2].

TYPICAL MEDIAN TRANSITIONS

GENERAL NOTES

1. WHEN MEDIANS ARE PRESENT, PAVEMENT MARKINGS ARE TO BE PLACED ADJACENT TO MEDIANS.
2. SOME OF THE INFORMATION INCLUDED WITH THIS DETAIL MAY NOT BE APPLICABLE TO THIS IMPROVEMENT.
3. PAVEMENT MARKINGS ARE TO BE EXTENDED THROUGH OMISSIONS WHEN APPLICABLE.
4. A STRIPING KEY IS AVAILABLE ELSEWHERE AND SHALL BE SHOWN WHERE THE QUANTITIES ARE LISTED.
5. FINAL PAVEMENT MARKINGS SHALL BE IN PLACE PRIOR TO PLACING ANY RAISED REFLECTIVE PAVEMENT MARKERS.
6. THE FOLLOWING CRITERIA SHALL BE USED FOR SELECTING THE DIAGONAL PAVEMENT MARKING SPACING,
 <30 MPH USE 15' (<50 km/h USE 4.5 m)
 30-45 MPH USE 20' (50-75 km/h USE 6.0 m)
 >45 MPH USE 30' (>75 km/h USE 9.0 m)

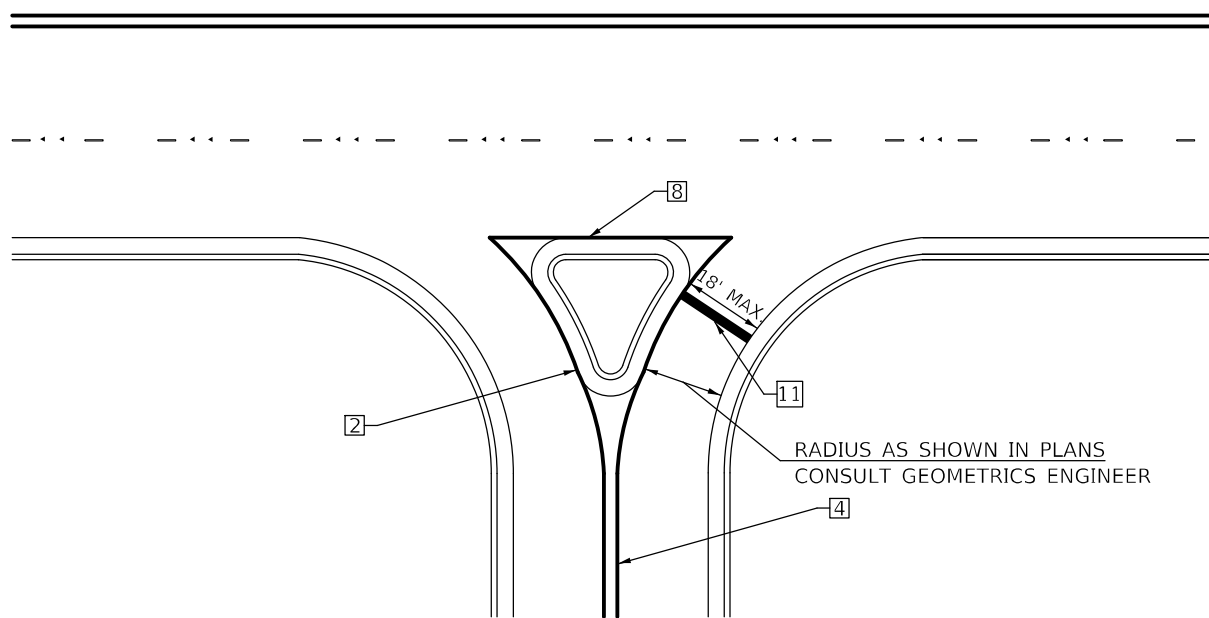

RIGHT IN - RIGHT OUT ACCESS

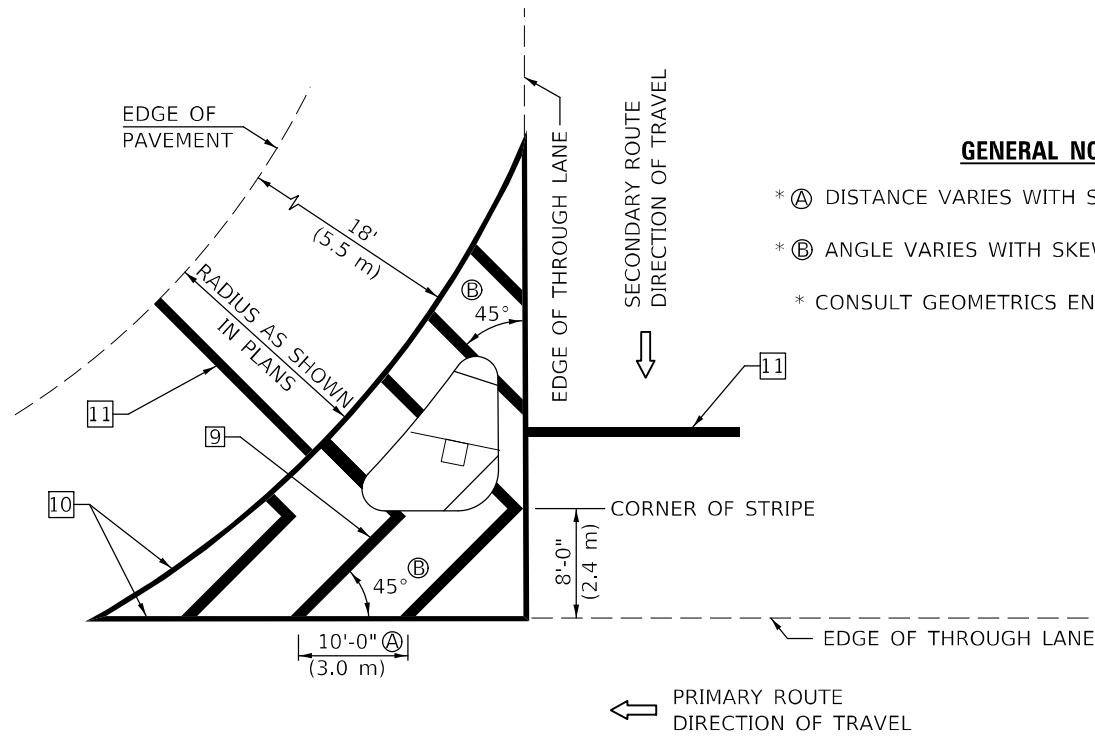

ISLAND

GENERAL NOTES

- * A DISTANCE VARIES WITH SKEW OF INTERSECTION.
- * B ANGLE VARIES WITH SKEW OF INTERSECTION.
- * CONSULT GEOMETRICS ENGINEER

Note: All dimensions are in INCHES (millimeters) unless otherwise shown.

MODEL: I:\MODEL MARKS
 FILE: 3041616.dwg
 PROJECT: I:\PROJECTS\2018\2018041616\2018041616.dwg
 PROJECT: I:\PROJECTS\2018\2018041616\2018041616.dwg

USER NAME = eaglinga	DESIGNED -	REVISD - 11/06
	DRAWN -	REVISD - 9/2009 KJT
PLOT SCALE = 40,0000 * / in.	CHECKED -	REVISD - 04/14 JLA
PLOT DATE = 4/18/2022	DATE -	REVISD - 3/2019 SWN

**STATE OF ILLINOIS
 DEPARTMENT OF TRANSPORTATION**

**PAVEMENT MARKING AND MARKERS
 (RURAL & URBAN APPLICATIONS)**

SCALE: SHEET 3 OF 4 SHEETS STA. TO STA.

DISTRICT 5 DETAIL NO. 7800AAAA				
F.A.P. RTE.	SECTION	COUNTY	TOTAL SHEETS	SHEET NO.
*	CM2023-1	**	18	17
CONTRACT NO. 70F89				
ILLINOIS FED. AID PROJECT				

* 322 & 322 FRONTAGE RD
 ** DEWITT & MCLEAN

DESIGNER NOTE: SEE TABLE 2C-4 OF THE MUTCD FOR ADDITIONAL INFORMATION

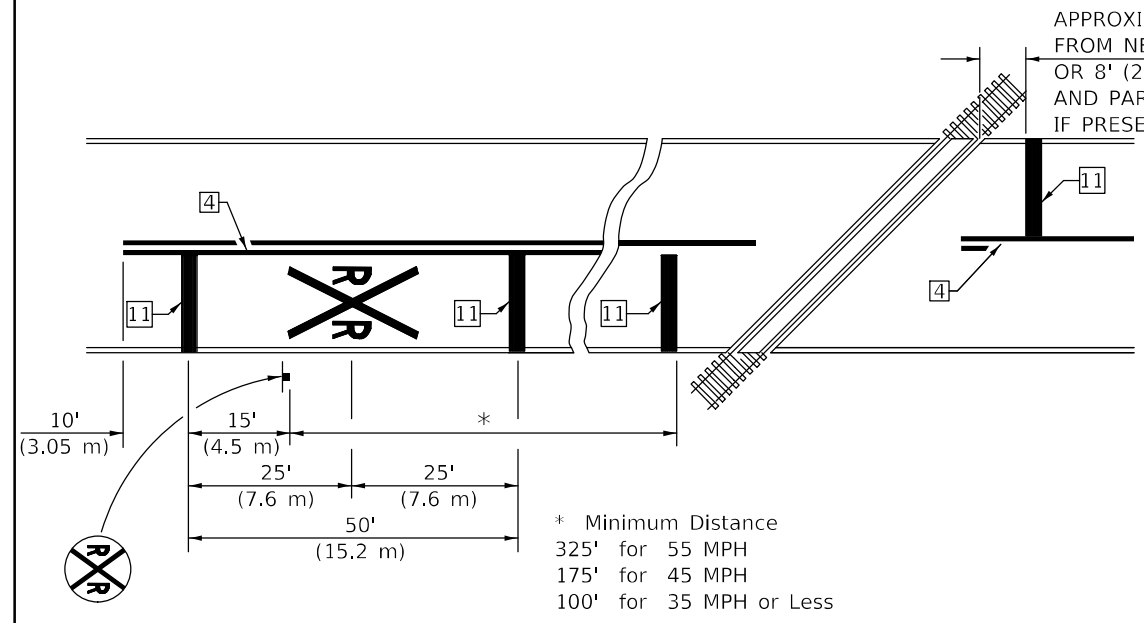

PAVEMENT MARKINGS AT RAILROAD-HIGHWAY GRADE CROSSING

RAILROAD CROSSING WITH INTERCONNECT ONLY

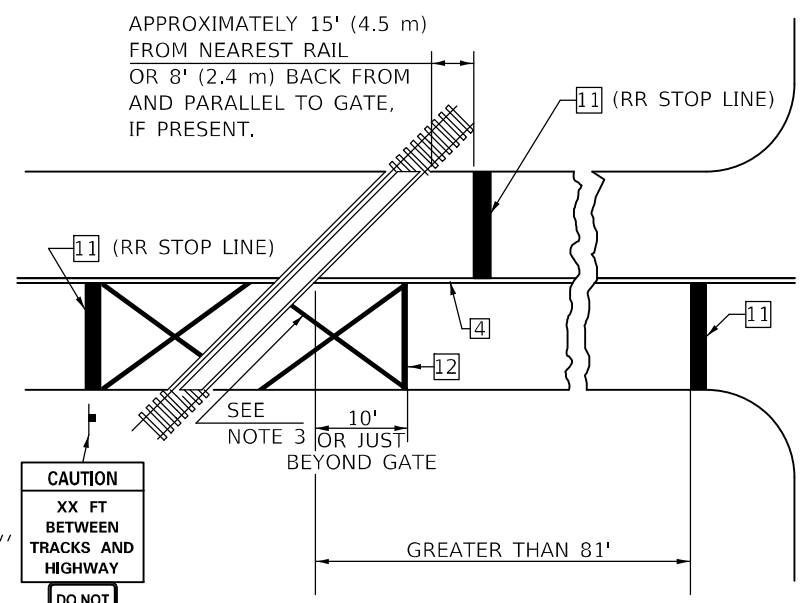

W10-I100
30" X 36"
DO NOT STOP ON TRACKS
R8-8
24" X 30"

ONLY IF SIGNAL HEAD CANNOT BE LOCATED IN MEDIAN

RAILROAD CROSSING WITH INTERCONNECT AND PRE-SIGNALS

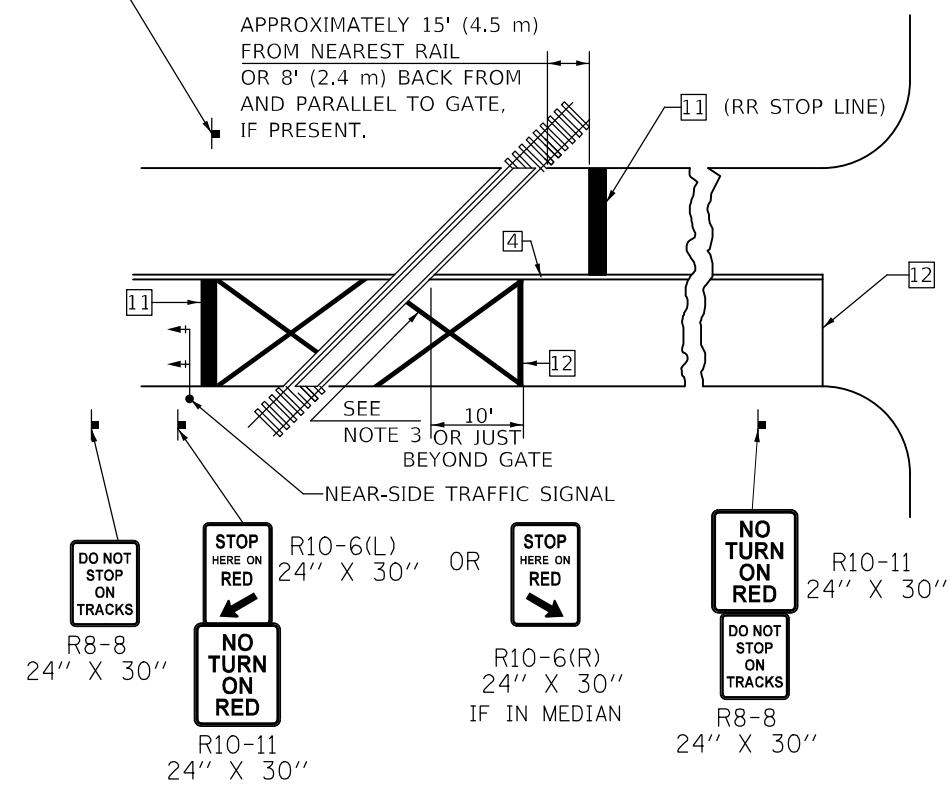

DO NOT STOP ON TRACKS
R8-8
24" X 30"
STOP HERE ON RED
R10-6(L)
24" X 30" OR
R10-6(R)
24" X 30"
IF IN MEDIAN
NO TURN ON RED
R10-11
24" X 30"
DO NOT STOP ON TRACKS
R8-8
24" X 30"

GENERAL NOTES

- SUPPLEMENTAL PAVEMENT MARKINGS TO BE INSTALLED ONLY ON APPROACHES TO INTERSECTIONS CONTROLLED BY TRAFFIC SIGNALS WHICH ARE INTERCONNECTED WITH THE RAILROAD WARNING SIGNALS.
- EXTEND PAVEMENT MARKINGS TO THE INTERSECTION ONLY WHERE NEAR-SIDE TRAFFIC SIGNALS ARE USED.
- 6" WHITE PAVEMENT MARKINGS AT 45° TO PAVEMENT, 8' CENTER TO CENTER.
- XX DISTANCE TO BE SHOWN ON SIGN MEASURED FROM A POINT 6 FEET FROM THE RAIL CLOSEST TO THE INTERSECTION OR FROM THE CLOSEST POINT ALONG THE EXIT GATE IF PRESENT OVER THE ROADWAY WHEN IN THE LOWERED POSITION TO THE STOP BAR OR CROSSWALK, WHICH EVER IS CLOSEST, ROUNDED DOWN TO NEAREST 5 FEET. WHERE THERE IS NO STOP LINE, MEASURE TO POINT WHERE DRIVER HAS A VIEW OF APPROACHING TRAFFIC.
- THE CLEARANCE SIGN IS ALSO TO BE USED AS AN INTERIM MEASURE AT LOCATIONS WITH INTERCONNECTED INTERSECTION TRAFFIC SIGNALS WHERE IT IS PLANNED TO CHANGE THEM TO NEAR-SIDE SIGNALS AT A FUTURE TIME. IN THIS CASE, THE DISTANCE TO BE SHOWN ON THE SIGN IS MEASURED FROM THE EDGE OF THE STRIPED-OUT AREA INSTEAD OF 6 FEET FROM THE RAIL. THE SIGN IS TO BE REMOVED WHEN THE NEAR-SIDE SIGNALS ARE INSTALLED AND THE PAVEMENT MARKINGS EXTENDED TO THE INTERSECTION.

SUPPLEMENTAL PAVEMENT MARKING TREATMENT FOR RAILROAD-HIGHWAY GRADE CROSSING

ALTERNATE SIGNS

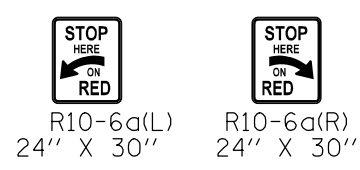

NOTES

- THE TRAVERSE SPREAD OF THE "X" MAY VARY ACCORDING TO LANE WIDTH.
- ON MULTI-LANE ROADS, THE STOP LINES SHALL EXTEND ACROSS ALL APPROACH LANES AND SEPARATE RXR SYMBOLS SHALL BE PLACED ADJACENT TO EACH OTHER IN EACH LANE.
- WHEN THE PAVEMENT MARKING SYMBOL IS USED, A PORTION OF THE SYMBOL SHOULD BE LOCATED DIRECTLY ADJACENT TO THE ADVANCE WARNING SIGN (W10-1) AS PLACED BY TABLE II-1, CONDITION B OF THE MUTCD.

Note: All dimensions are in INCHES (millimeters) unless otherwise shown.

* 322 & 322 FRONTAGE RD
** DEWITT & MCLEAN

MODEL: I:\MODEL\MARKS FILE: MARKS_PAVEMENT.dwg DATE: 4/18/2022 PROJECT: D:\Projects\1057089\CAD\Drawings\CAD\Sheet\1057089-sh-Details.dwg

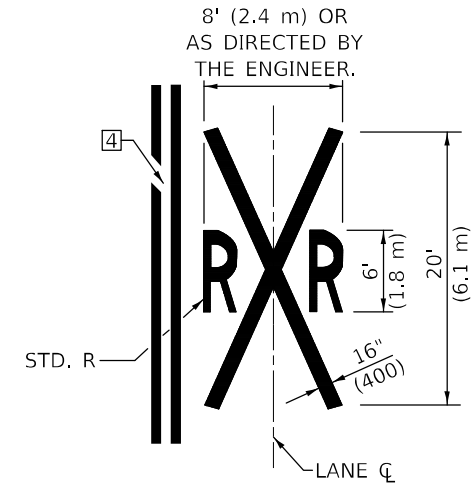

USER NAME = eaglinga	DESIGNED -	REVISED - 11/06
	DRAWN -	REVISED - 9/2009 KJT
PLOT SCALE = 40,0000 */ in.	CHECKED -	REVISED - 04/14 JLA
PLOT DATE = 4/18/2022	DATE -	REVISED - 3/2019 SWN

**STATE OF ILLINOIS
DEPARTMENT OF TRANSPORTATION**

**PAVEMENT MARKING AND MARKERS
(RURAL & URBAN APPLICATIONS)**

SCALE: SHEET 4 OF 4 SHEETS STA. TO STA.

DISTRICT 5 DETAIL NO. 7800AAAA				
F.A.P. RTE.	SECTION	COUNTY	TOTAL SHEETS	SHEET NO.
*	CM2023-1	**	18	18
CONTRACT NO. 70F89				
ILLINOIS FED. AID PROJECT				