

07-29-2016 LETTING ITEM 094

STATE OF ILLINOIS
DEPARTMENT OF TRANSPORTATION

F.A. RTE.	SECTION	COUNTY	TOTAL SHEETS	SHEET NO.
--	15-00127-00-DR	LAKE	12	1
FED. ROAD DIST. NO. 1	ILLINOIS FEDERAL AID PROJECT			

CONTRACT NO. 61D01

PLAN FOR PROPOSED FEDERAL AID HIGHWAY

ROBERT McCLORY BIKE PATH
DRAINAGE IMPROVEMENTS
MULBERRY PLACE TO LAKE COOK ROAD

SECTION NO. 15-00127-00-DR
PROJECT NO. TE-01D1(050)

CITY OF HIGHLAND PARK
LAKE COUNTY

R12E

JOB NO. C-91-311-16

3RD P.M.

FOR INDEX OF SHEETS, SEE SHEET NO. 2

FOR LIST OF IDOT HIGHWAY STANDARDS, SEE SHEET NO. 2

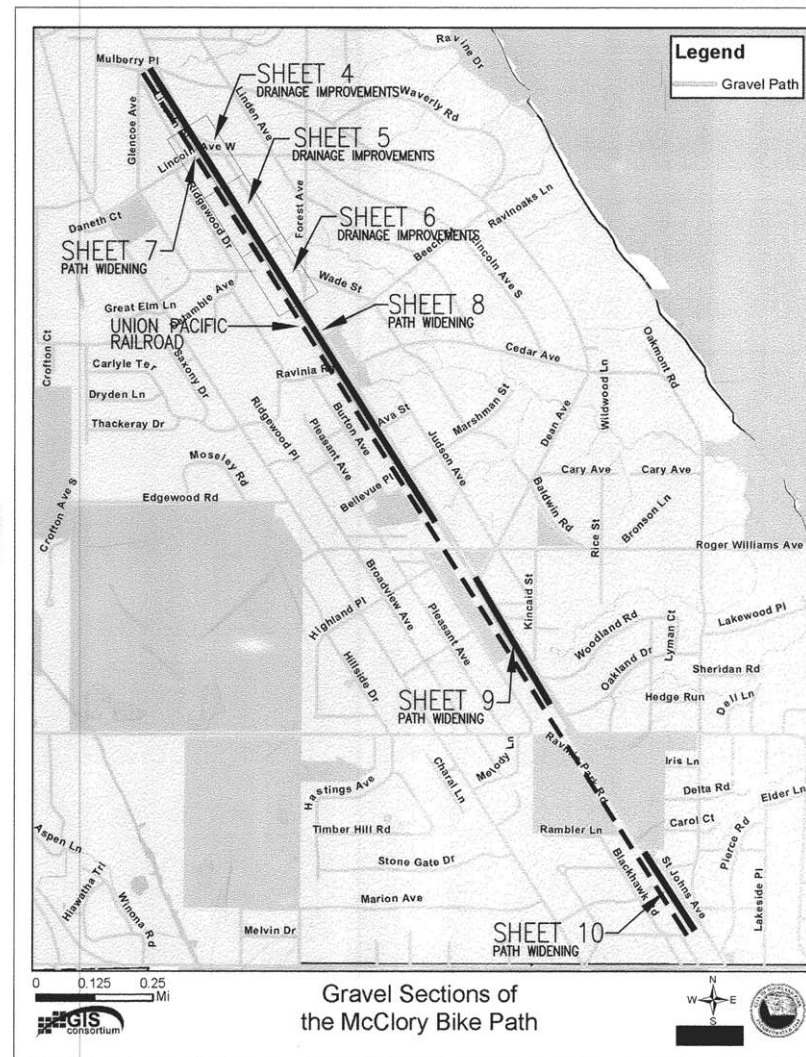

T43N

T43N

MORAINÉ TOWNSHIP

TOWNSHIP 43 NORTH

LOCATION MAP

GROSS/NET LENGTH 1,500 L.F. = (0.28 MILES)

J.U.L.I.E.

FOR UNDERGROUND UTILITY LOCATION
CALL J.U.L.I.E. TOLL FREE
PHONE NO.: 811

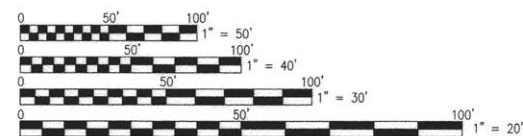

FULL SIZE PLANS HAVE BEEN PREPARED USING STANDARD ENGINEERING SCALES.
REDUCED SIZED PLANS WILL NOT CONFORM TO STANDARD SCALES. IN MAKING
MEASUREMENTS ON REDUCED PLANS, THE ABOVE SCALES MAY BE USED.

PROGRAM AND OFFICE ENGINEER: CHARLES F. RIDDLE, P.E. (847) 705-4406, SCHAUMBURG, IL

CONTRACT NO. 61D01

STATE OF ILLINOIS
DEPARTMENT OF TRANSPORTATION
DIVISION OF HIGHWAYS

Approved May 2 20 16
K. Ramoth Kew
CITY OF HIGHLAND PARK DIRECTOR OF PUBLIC WORKS

Passed May 19 20 16
CHRISTOPHER HOLT
DISTRICT #1 ENGINEER OF LOCAL ROADS AND STREETS

Releasing for Bid
Based on Limited
Review May 19 20 16
John Forthman
REGIONAL ENGINEER

PRINTED BY THE AUTHORITY
OF THE STATE OF ILLINOIS

PLANS PREPARED BY: DOLAND ENGINEERING, LLC.
PROFESSIONAL DESIGN FIRM NO. 184-006022











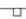

J. Doland
JASON R. DOLAND, P.E., P.L.S.
ILLINOIS REGISTERED PROFESSIONAL ENGINEER
NO. 062055693 (LICENSE EXPIRES 11-30-17)

INDEX OF SHEETS

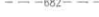
1	COVER SHEET
2	GENERAL NOTES
3	SUMMARY OF QUANTITIES
4	MAINTENANCE OF BICYCLE TRAFFIC (BIKE PATH DETOUR PLAN)
5-7	DRAINAGE IMPROVEMENT PLANS
8-11	BIKE PATH WIDENING PLANS
12	CONSTRUCTION DETAILS

LEGEND

	EXISTING CATCH BASIN
	EXISTING YARD DRAIN
	EXISTING SIGN
	EXISTING UTILITY POLE
	EXISTING POST
	EXISTING TREE
	EXISTING BRUSH LINE
	EXISTING CONTOUR
	EXISTING SPOT ELEVATION
	EXISTING FENCE
	EXISTING STORM SEWER

IDOT HIGHWAY STANDARDS

000001-06	STANDARD SYMBOLS, ABBREVIATIONS AND PATTERNS
604001-04	FRAME AND LIDS TYPE 1
701006-05	OFF-RD OPERATIONS, 2L, 2W, 15' (4-5m) TO 24" (600mm) FROM PAVEMENT EDGE
701011-04	OFF-ROAD MOVING OPERATIONS, 2L, 2W, DAY ONLY
701301-04	LANE CLOSURE, 2L, 2W, SHORT TIME OPERATIONS
701311-03	LANE CLOSURE, 2L, 2W, MOVING OPERATIONS - DAY ONLY
701501-06	URBAN LANE CLOSURE, 2L, 2W, UNDIVIDED
701701-10	URBAN LANE CLOSURE, MULTILANE INTERSECTION
701801-06	SIDEWALK, CORNER OR CROSSWALK CLOSURE
701901-05	TRAFFIC CONTROL DEVICES

GENERAL NOTES

GENERAL NOTES:
BEFORE STARTING ANY EXCAVATION, THE CONTRACTOR SHALL CALL "JULIE" AT 811 FOR FIELD LOCATIONS OF BURIED UTILITY FACILITIES. (48 HOURS NOTIFICATION IS REQUIRED).

SPECIFICATIONS:
ALL CONSTRUCTION SHALL BE DONE IN ACCORDANCE WITH THE "STANDARD SPECIFICATIONS FOR ROAD AND BRIDGE CONSTRUCTION", ADOPTED APRIL 1, 2016. THE MANUAL ON UNIFORM TRAFFIC CONTROL DEVICES FOR STREET AND HIGHWAYS, LATEST EDITION, THE DETAILS INCLUDED IN THE PLANS, AND THE SPECIAL PROVISIONS INCLUDED IN THE CONTRACT DOCUMENTS.

STANDARDS:
ANY REFERENCE TO "STANDARDS" THROUGHOUT THE PLANS OR SPECIAL PROVISIONS SHALL BE INTERPRETED TO BE THE LATEST STANDARD OF IDOT AS LISTED ON THIS SHEET.

COORDINATION:
THE CONTRACTOR SHALL NOTIFY THE CITY OF HIGHLAND PARK AT LEAST 48 HOURS IN ADVANCE OF BEGINNING WORK, AND SHALL COORDINATE ALL CONSTRUCTION OPERATIONS WITH THE ENGINEER.

PUBLIC OR PRIVATE UTILITIES:
THE LOCATIONS OF PUBLIC OR PRIVATE UTILITIES SHOWN ON THE PLANS ARE APPROXIMATE, AND THE DISTRICT DOES NOT GUARANTEE THEIR ACCURACY. THE CONTRACTOR SHALL BE REQUIRED TO ASCERTAIN THE EXACT LOCATIONS OF SUCH UTILITIES AND EXERCISE CARE DURING CONSTRUCTION OPERATIONS SO AS NOT TO DAMAGE THEM, IN ACCORDANCE WITH THE SPECIAL PROVISIONS AND ARTICLE 107.20 OF THE "STANDARD SPECIFICATIONS". THE CONTRACTOR SHALL BE RESPONSIBLE FOR CONTACTING THE UTILITY OWNERS SO THAT THEIR FACILITIES MAY BE ADJUSTED OR RELOCATED, IF NECESSARY, PRIOR TO THE START OF CONSTRUCTION OPERATIONS UNLESS OTHERWISE NOTED IN THE PLANS. ALL RELOCATION WORK ON EXISTING PRIVATE UTILITIES WILL BE DONE BY THE OWNER OF THAT UTILITY.

THE CONTRACTOR SHALL BE RESPONSIBLE FOR ANY DAMAGE OR DESTRUCTION OF PUBLIC OR PRIVATE PROPERTY, AND SHALL RESTORE SUCH PROPERTY AT HIS/HER EXPENSE.

SURVEY AND MONUMENTS:
ALL ELEVATIONS IN THE PLANS ARE BASED UPON THE NORTH AMERICAN VERTICAL DATUM OF 1988 (NAVD88)

DISPOSAL OF MATERIALS:
THERE WILL BE NO SPECIAL WASTE REMOVAL NECESSARY TO CONSTRUCT THIS PROJECT.

EXISTING DRAINAGE STRUCTURES:
DURING CONSTRUCTION OPERATIONS, WHENEVER ANY LOOSE MATERIAL IS DEPOSITED IN THE FLOW LINE OF DRAINAGE STRUCTURES, SUCH THAT THE NATURAL FLOW OF WATER IS OBSTRUCTED, IT SHALL BE REMOVED BY THE CONTRACTOR AT THE CLOSE OF EACH WORKING DAY. AT THE CONCLUSION OF CONSTRUCTION OPERATIONS, ALL DRAINAGE STRUCTURES SHALL BE FREE FROM DIRT AND DEBRIS. THE WORK SPECIFIED ABOVE WILL NOT BE PAID FOR SEPARATELY, BUT SHALL BE CONSIDERED AS INCLUDED IN THE COST OF THE CONTRACT PAY ITEM FOR EARTH EXCAVATION.

WHEN EXISTING DRAINAGE FACILITIES ARE DISTURBED, THE CONTRACTOR SHALL PROVIDE AND MAINTAIN TEMPORARY OUTLETS AND CONNECTIONS FOR ALL PRIVATE OR PUBLIC DRAINS, SEWERS OR CATCH BASINS. CONTRACTOR SHALL PROVIDE FACILITIES TO TAKE IN ALL STORM WATER WHICH WILL BE RECEIVED BY THESE DRAINS AND SEWERS, AND DISCHARGE SAME. CONTRACTOR SHALL PROVIDE AND MAINTAIN AN EFFICIENT PUMPING PLANT, IF NECESSARY, AND A TEMPORARY OUTLET, AND BE PREPARED AT ALL TIMES TO DISPOSE OF THE WATER RECEIVED FROM THESE TEMPORARY CONNECTIONS UNTIL SUCH TIME AS THE PERMANENT CONNECTIONS WITH SEWERS ARE BUILT AND IN SERVICE. THIS WORK WILL NOT BE PAID FOR DIRECTLY, BUT SHALL BE CONSIDERED INCLUDED IN THE CONTRACT PAY ITEM FOR EARTH EXCAVATION. BEFORE ORDERING PIPE CULVERTS, THE CONTRACTOR SHALL CONTACT THE ENGINEER AS TO THE EXACT LENGTH AND QUANTITY REQUIRED.

UNSUITABLE MATERIAL:
BEFORE REMOVAL OF ANY UNSUITABLE MATERIAL, THE CONTRACTOR SHALL TREAT THE SUBGRADE AS PER ARTICLE 301.03 OF THE "STANDARD SPECIFICATIONS" TO THE SATISFACTION OF THE ENGINEER. UNSUITABLE MATERIAL SHALL NOT BE USED AS EMBANKMENT OR FILL UNDER THE PROPOSED TRAIL AS SHOWN ON THE TYPICAL CROSS SECTIONS.

STOCKPILES:
STOCKPILES OF TOPSOIL AND OTHER MATERIALS SHALL NOT BE LOCATED WITH A SPECIAL MANAGEMENT AREA. APPROVAL OF THE LOCATION MUST BE OBTAINED FROM THE ENGINEER PRIOR TO PLACEMENT. IF A STOCKPILE IS TO REMAIN IN PLACE FOR MORE THAN THREE DAYS, EROSION CONTROL MEASURES SHALL BE PROVIDED. STOCKPILES TO REMAIN IN PLACE FOR 30 DAYS OR MORE SHALL RECEIVE TEMPORARY SEEDING.

TREE TRIMMING:
ALL BRANCHES THAT ARE LESS THAN 12 FEET ABOVE THE SURFACE OF THE TRAIL SHALL BE REMOVED BY THE CONTRACTOR. THE CONTRACTOR SHALL PERFORM THE WORK IN ACCORDANCE WITH ANSI STANDARD A300-2001 (PART 1) FOR TREE, SHRUB AND OTHER WOODY PLANT MAINTENANCE AND ANSI Z133.1-1994 FOR TREE CARE OPERATIONS PRUNING, TRIMMING, REPAIRING, MAINTAINING AND REMOVING TREES AND CUTTING BRUSH. THIS WORK SHALL BE NOT BE PAID FOR SEPARATELY, BUT SHALL BE INCLUDED IN THE COST OF MOBILIZATION.

ACCESS TO PROPERTY:
THE CONTRACTOR SHALL MAINTAIN ACCESS TO ABUTTING PROPERTY DURING CONSTRUCTION OF THIS PROJECT, EXCEPT FOR PERIODS OF SHORT DURATION AS APPROVED BY THE ENGINEER.

SAW CUTTING:
THE LIMITS OF REMOVAL OF ALL CONCRETE OR BITUMINOUS PAVEMENTS, CURBING OR SIDEWALKS SHALL BE SAWCUT IN ACCORDANCE WITH SECTION 440 OF THE "STANDARD SPECIFICATIONS" AND AT THE DIRECTION OF THE ENGINEER. THE SAW CUTTING OF BITUMINOUS PAVEMENT, DRIVEWAYS, CURBS OR SIDEWALK SHALL BE INCLUDED IN THE COST OF THE ITEM BEING REMOVED.

RESTORATION:
GRASS AREAS DISTURBED DURING CONSTRUCTION SHALL BE RESTORED WITH SIX INCHES OF TOPSOIL AND SOD.

SEDIMENTATION AND EROSION CONTROL NOTES:
A) SOIL DISTURBANCE SHALL BE CONDUCTED IN SUCH A MANNER AS TO MINIMIZE EROSION. SOIL STABILIZATION MEASURES SHALL CONSIDER THE TIME OF YEAR, SITE CONDITIONS AND THE USE OF TEMPORARY OR PERMANENT MEASURES.
B) SOIL EROSION AND SEDIMENT CONTROL FEATURES SHALL BE CONSTRUCTED PRIOR TO THE COMMENCEMENT OF UPLAND DISTURBANCE.
C) TEMPORARY SOIL STABILIZATION SHALL BE APPLIED TO DISTURBED AREAS WITH 14 CALENDAR DAYS OF THE END OF ACTIVE HYDROLOGIC DISTURBANCE. PERMANENT STABILIZATION SHALL BE DONE WITHIN 14 DAYS AFTER COMPLETION OF FINAL GRADING.
D) ALL STORM SEWER FACILITIES THAT ARE OR WILL BE FUNCTIONING DURING CONSTRUCTION SHALL BE PROTECTED, FILTERED, OR OTHERWISE TREATED TO REMOVE SEDIMENT.
E) ALL TEMPORARY EROSION AND SEDIMENT CONTROL MEASURES SHALL BE REMOVED WITHIN 30 DAYS OF FINAL SITE STABILIZATION OR AFTER THE TEMPORARY MEASURES ARE NO LONGER NEEDED. TRAPPED SEDIMENT AND OTHER DISTURBED SOIL AREAS SHALL BE PERMANENTLY STABILIZED.
F) ALL TEMPORARY AND PERMANENT EROSION CONTROL MEASURES SHALL BE MAINTAINED AND REPAIRED AS NEEDED. THE CONTRACTOR SHALL BE RESPONSIBLE FOR INSPECTION AND REPAIR DURING CONSTRUCTION.
G) THE EROSION CONTROL MEASURES INDICATED ON THE PLANS OR AS DIRECTED BY THE ENGINEER ARE THE MINIMUM REQUIREMENTS. ADDITIONAL MEASURES MAY BE REQUIRED, AS DIRECTED BY THE ENGINEER.
H) THE CONTRACTOR SHALL INSTALL ALL EROSION CONTROL PRIOR TO THE START OF ANY EARTHWORK.
I) IF A STOCKPILE IS TO REMAIN IN PLACE FOR MORE THAN THREE DAYS, EROSION CONTROL MEASURES SHALL BE PROVIDED BY THE CONTRACTOR.
J) EROSION CONTROL MEASURES SHALL COMPLY WITH THE MINIMUM REQUIREMENTS OF THE LAKE COUNTY STORMWATER AND FLOODPLAIN ORDINANCE SPECIFICATIONS AT ALL TIMES.

ALL WORK PERFORMED UNDER THIS IMPROVEMENT SHALL BE GUARANTEED TO THE LOCAL AUTHORITY BY THE CONTRACTOR AND HIS SURETY FOR A PERIOD OF 18 MONTHS AFTER FINAL PAYMENT HAS BEEN MADE, TO ENSURE WORK AND MATERIALS BE COMPLETE AND FREE OF ALL DEFECTS IN WORKMANSHIP AND MATERIALS, OF WHATEVER NATURE.

DOLAND ENGINEERING, LLC
2010 REVISED - 1400 SPRINGFIELD - 1400 PLUMBING
351 EAST COLFAX STREET, SUITE C
PALATKA, ILLINOIS 60067
(815) 991-0088 (815) 991-5427 FAX
www.dolandengineering.com

USER NAME:	DESIGNED:	REVISED:
	DRAWN:	REVISED:
PLOT SCALE: 1" = 20'	CHECKED:	REVISED:
PLOT DATE:	DATE:	REVISED:

STATE OF ILLINOIS
DEPARTMENT OF TRANSPORTATION

GENERAL NOTES

SCALE: N/A	SHEET NO. 2 OF 12 SHEETS	STA.	STA.	
F.A. RTE.	SECTION	COUNTY	TOTAL SHEETS	SHEET NO.
--	15-00127-00-DR	LAKE	12	2
FED. ROAD DIST. NO. --		ILLINOIS FEDERAL AID PROJECT		CONTRACT NO. 61001

SUMMARY OF QUANTITIES

SPECIAL PROVISION	CODE NO.	ITEM DESCRIPTION	UNIT	TOTAL ESTIMATED QUANTITY
	20101100	TREE TRUNK PROTECTION	EACH	12
	20101200	TREE ROOT PRUNING	EACH	6
	20200500	EARTH EXCAVATION (WIDENING)	CU YD	100
	20800150	TRENCH BACKFILL	CU YD	130
	21101615	TOPSOIL FURNISH AND PLACE, 4"	SQ YD	1,000
	25200100	SODDING	SQ YD	1,000
	25200200	SUPPLEMENTAL WATERING	UNIT	20
	28000400	PERIMETER EROSION BARRIER	FOOT	200
	28100101	STONE RIP RAP, CLASS A1	SQ YD	30
	42400200	PORTLAND CEMENT CONCRETE SIDEWALK, 5"	SQ FT	150
	44000600	SIDEWALK REMOVAL	SQ FT	150
	54213657	PRECAST REINFORCED CONCRETE FLARED END SECTIONS 12"	EACH	1

SPECIAL PROVISION	CODE NO.	ITEM DESCRIPTION	UNIT	TOTAL ESTIMATED QUANTITY
	550B2510	STORM SEWERS, RUBBER GASKET, CLASS B, TYPE 2, 10"	FOOT	137
	550B2520	STORM SEWERS, RUBBER GASKET, CLASS B, TYPE 2, 12"	FOOT	343
*	55200200	STORM SEWERS JACKED IN PLACE 12"	FOOT	1,145
	60108106	PIPE UNDERDRAINS	FOOT	320
	60218300	MANHOLES, TYPE A, 4'-DIAMETER, TYPE 1 FRAME, OPEN LID	EACH	9
	60218400	MANHOLES, TYPE A, 4'-DIAMETER, TYPE 1 FRAME, CLOSED LID	EACH	1
	60234200	INLETS, TYPE A, TYPE 1 FRAME, OPEN LID	EACH	7
	67100100	MOBILIZATION	L SUM	1
	70102620	TRAFFIC CONTROL AND PROTECTION, STANDARD 701501	L SUM	1
	70102635	TRAFFIC CONTROL AND PROTECTION, STANDARD 701701	L SUM	1
*	X0323389	STORM SEWER CONNECTION	EACH	1
*	XX008873	AGGREGATE SURFACE COURSE (SPECIAL)	TON	350
*	Z0013798	CONSTRUCTION LAYOUT	L SUM	1

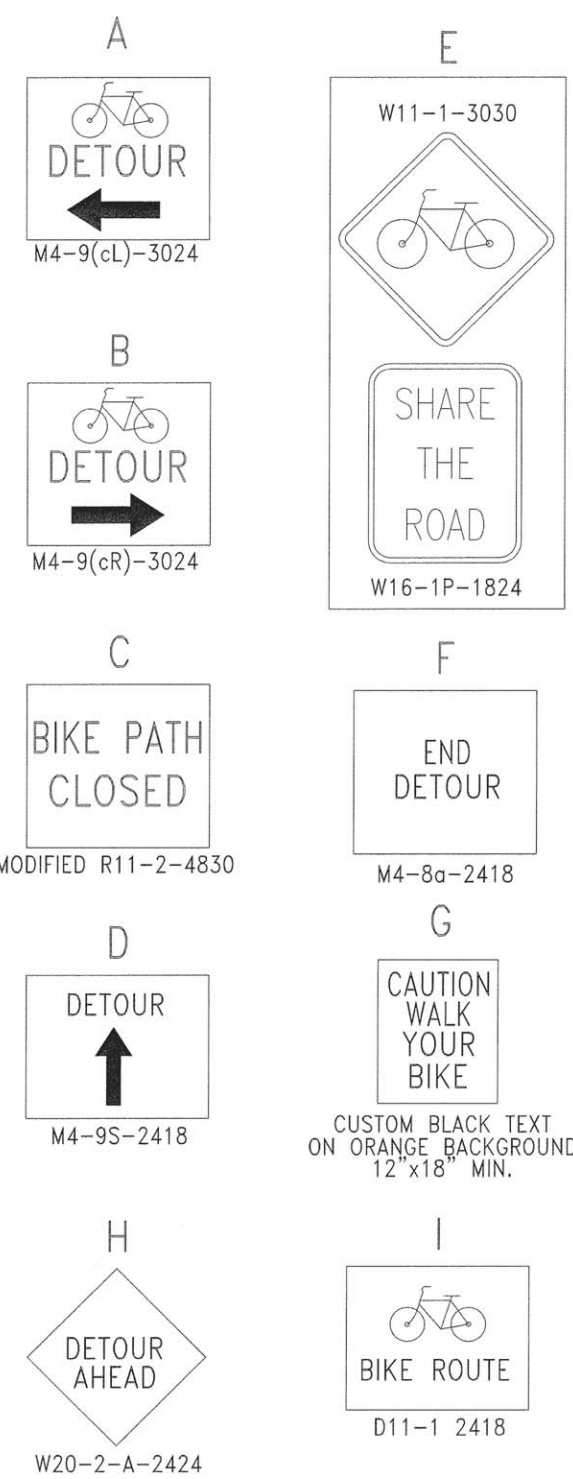
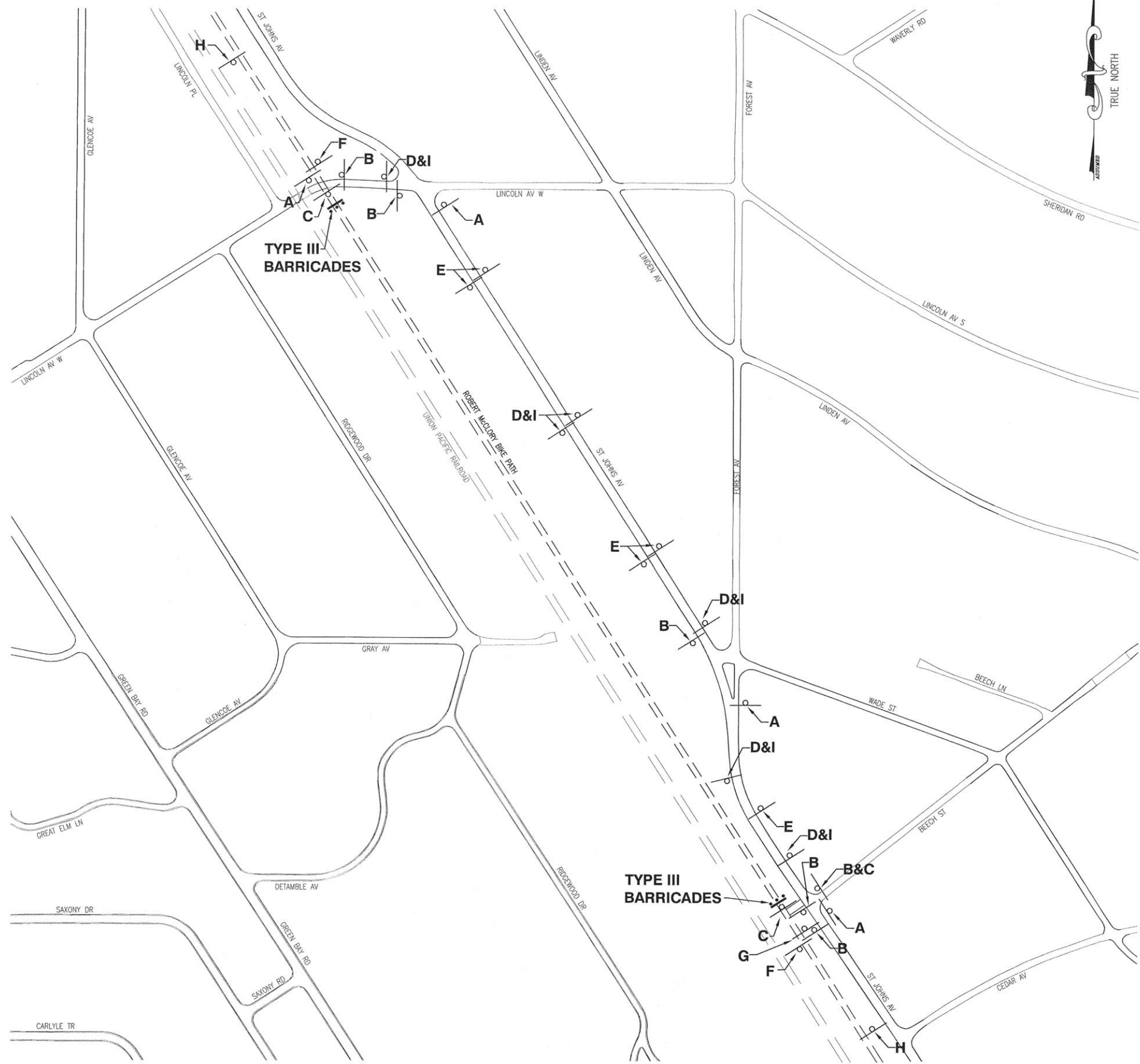

NOTES:
 1) SIGNAGE FOR DETOUR IS TEMPORARY MEASURE WHEN THE PATH MUST BE CLOSED FOR CONTRACTOR WORK. DETOUR SIGNS TO BE INSTALLED ON SINGLE POLE, WITH 7' MIN. HEIGHT TO BOTTOM SIGN. SIGN SHALL BE PLACED A MINIMUM OF 2' FROM BACK OF CURB. ALL SIGNAGE TO MEET MUTCD STANDARDS AND SIGNAGE STANDARD SIZES AND SPECIFICATIONS. DETOUR SIGNAGE TO BE REMOVED TO ALLOW PEDESTRIAN AND BICYCLE USE AS SOON AS WORK SITE SAFETY ALLOWS.
 2) CONTRACTOR SHALL MEET THESE DETOUR AND TRAFFIC CONTROL MEASURES AND REQUIREMENTS AS A MINIMUM AND IS RESPONSIBLE FOR ANY ADDITIONAL TRAFFIC CONTROL MEASURES THAT BECOME NECESSARY DURING CONSTRUCTION.
 3) CONTRACTOR IS RESPONSIBLE FOR PROTECTING THE PUBLIC WITHIN THE WORK AREA AND MAINTAINING SITE CLEANLINESS AT ALL TIMES.
 4) MOUNT SIGN D UNDER SIGN I
 5) SIGNS A,B,C,D,F,G&H ARE TO BE BLACK TEXT/SYMBOL ON ORANGE BACKGROUND.

DOLAND
 ENGINEERING, LLC
 CIVIL ENGINEERING - LAND SURVEYING - LAND PLANNING
 334 EAST VOLPARK STREET, SUITE C
 PALM BEACH, FLORIDA 33408
 (561) 851-5288 (561) 954-3427 FAX
 WWW.DOLANDENGINEERING.COM

USER NAME:	DESIGNED:	REVISED:
DRAWN:	REVISIONS:	
CHECKED:	REVISIONS:	
DATE:	REVISIONS:	

STATE OF ILLINOIS
 DEPARTMENT OF TRANSPORTATION

MAINTENANCE OF BICYCLE TRAFFIC
 (BIKE PATH DETOUR PLAN)

SCALE: N/A SHEET NO. 4 OF 12 SHEETS STA. STA.

F.A. RTE.	SECTION	COUNTY	TOTAL SHEETS	SHEET NO.
---	15-00127-00-DR	LAKE	12	4
FED. ROAD DIST. NO. -	ILLINOIS FEDERAL AID PROJECT			

CONTRACT No. 6101

ST. JOHNS AVENUE

LINCOLN AVE WEST

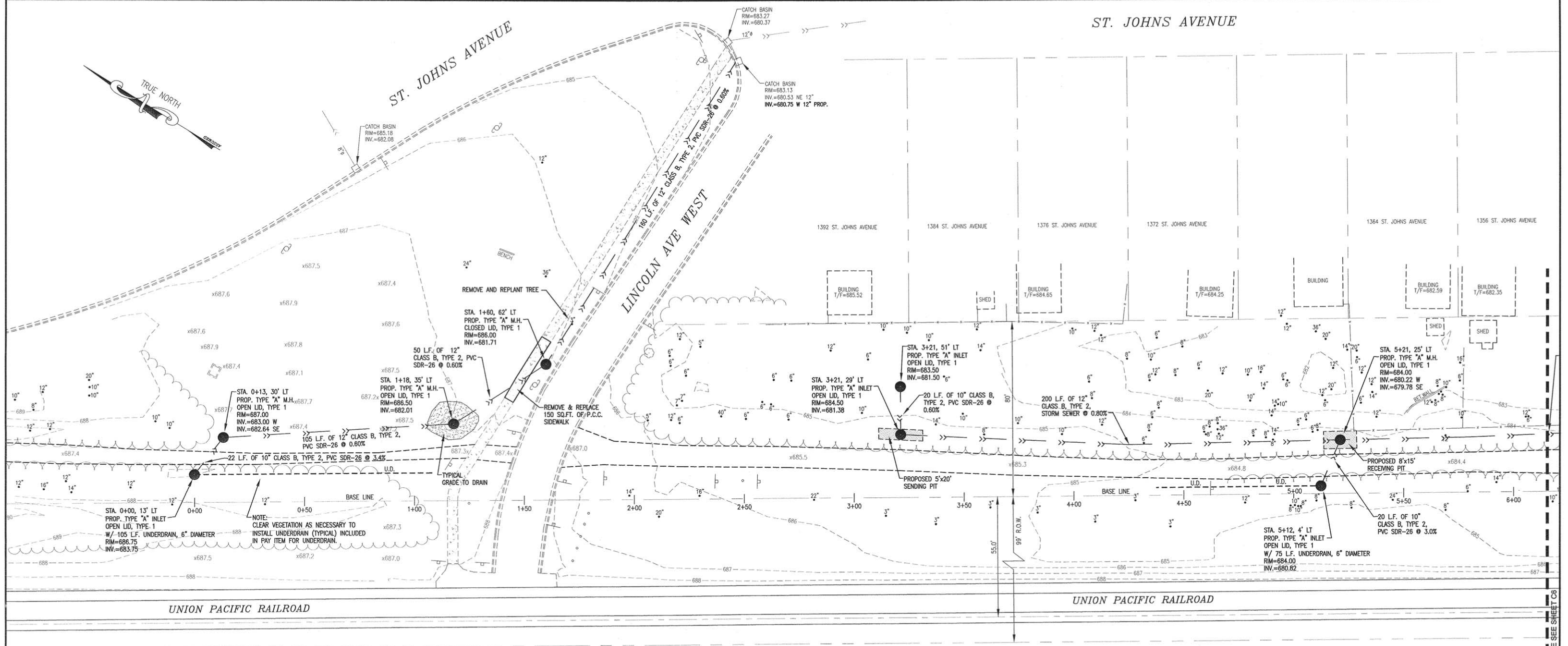
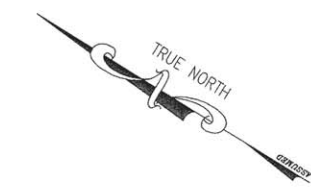

UNION PACIFIC RAILROAD

UNION PACIFIC RAILROAD

- NOTES:
- 1) ANY CLEARING AND GRUBBING WORK NECESSARY FOR EXCAVATING THE PROPOSED SENDING AND RECEIVING PITS SHALL BE INCLUDED IN THE COST OF 12" STORM SEWER, JACKED IN PLACE.
 - 2) CONTRACTOR SHALL PROTECT THE EXISTING GRAVEL BIKE PATH FROM CONSTRUCTION DAMAGE AND FOREIGN MATERIALS, WHICH SHALL BE REPAIRED AND/OR MATERIAL(S) REMOVED PRIOR TO FINAL GRADING, SHAPING AND RESTORATION OF THE BIKE PATH.

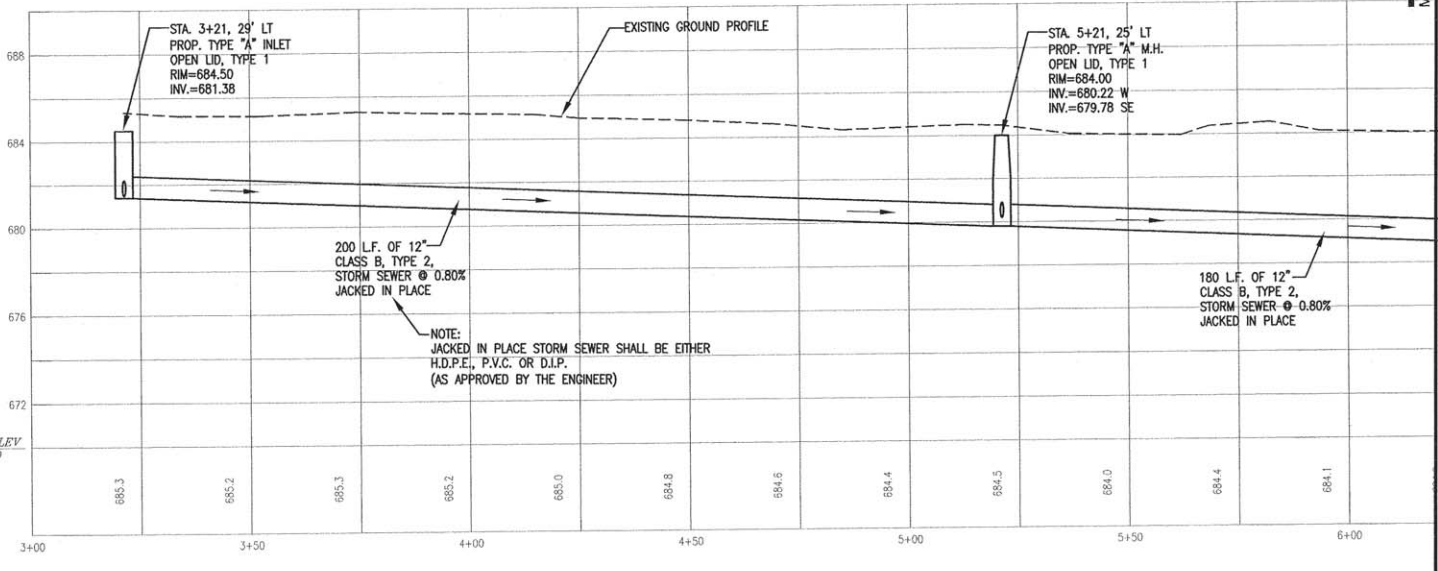
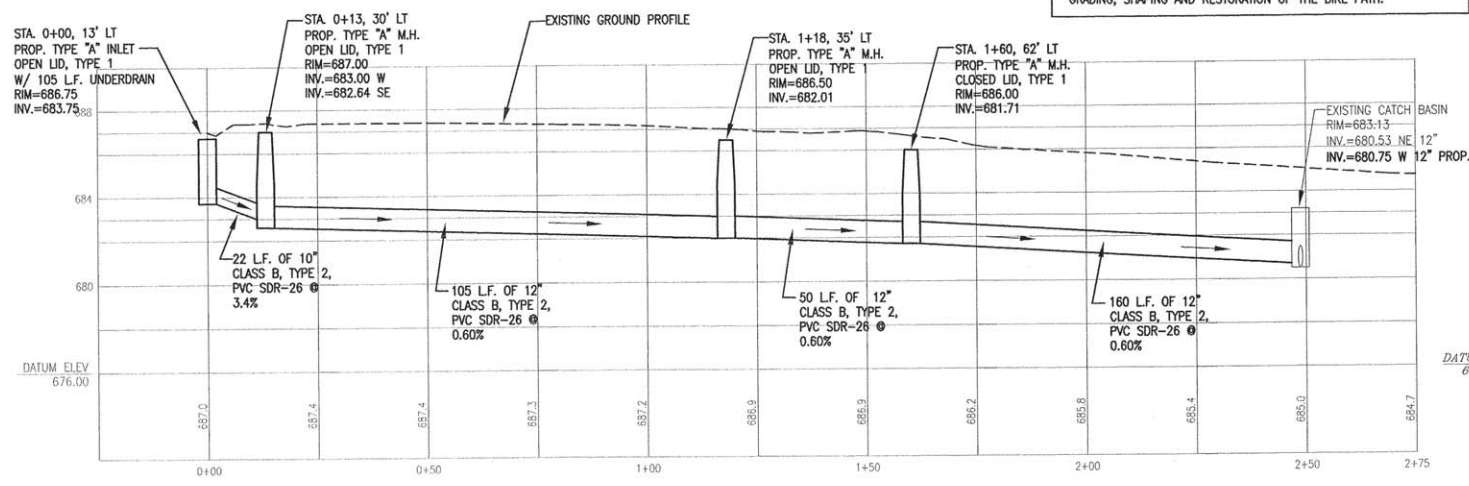

HOLAND ENGINEERING, LLC
 3015 EAST OGDEN STREET, SUITE C
 PALM SPRING, ILLINOIS 60057
 (815) 381-4200 (815) 381-4147 FAX
 www.hollandengineering.com

USER NAME:	DESIGNED:	REVISED:
PLOT SCALE: 1" = 20'	DRAWN:	REVISED:
PLOT DATE:	CHECKED:	REVISED:
	DATE:	REVISED:

STATE OF ILLINOIS
 DEPARTMENT OF TRANSPORTATION

DRAINAGE IMPROVEMENTS

SCALE: N/A SHEET NO. 5 OF 12 SHEETS STA. STA.

F.A. RTE.	SECTION	COUNTY	TOTAL SHEETS	SHEET NO.
--	15-00127-00-DR	LAKE	12	5
FED. ROAD DIST. NO. --	ILLINOIS FEDERAL AID PROJECT		CONTRACT No. 61001	

MATCH LINE SEE SHEET C5

ST. JOHNS AVENUE

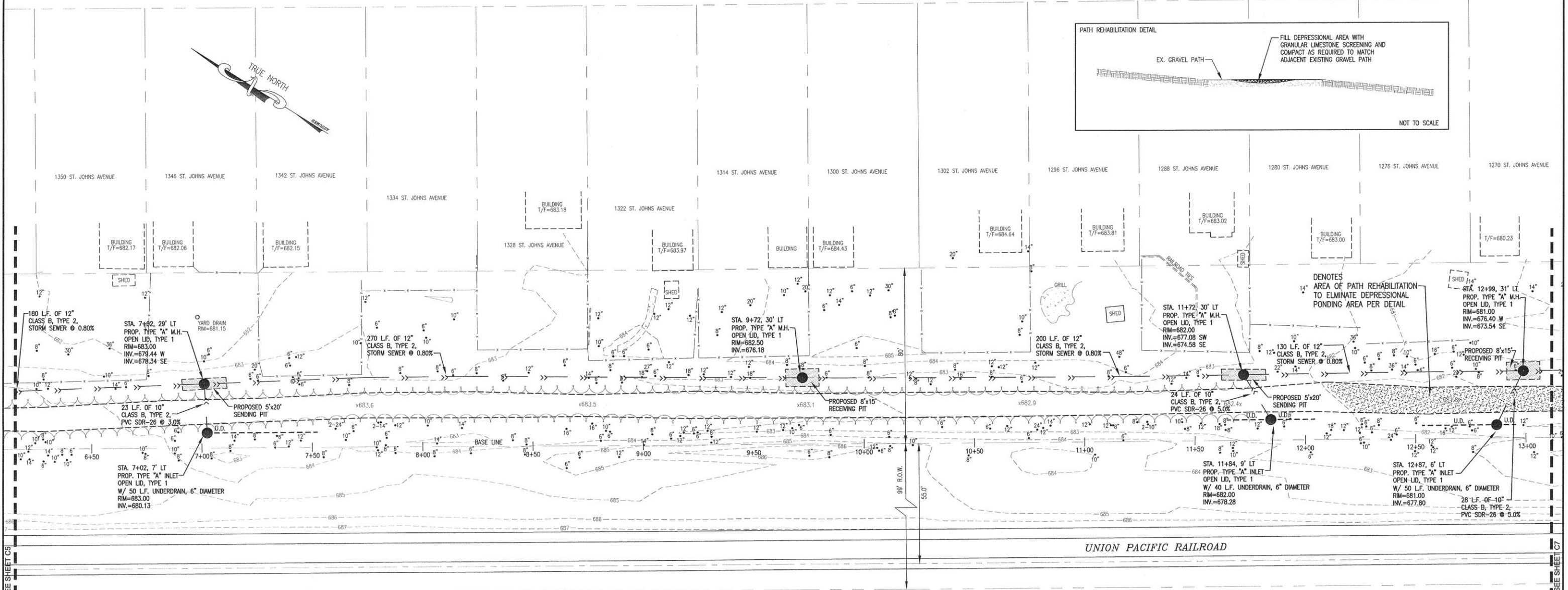
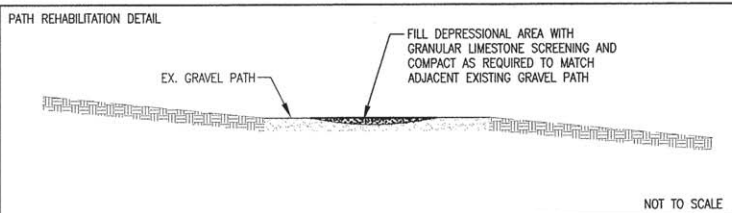
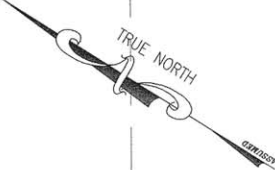

MATCH LINE SEE SHEET 05

MATCH LINE SEE SHEET 07

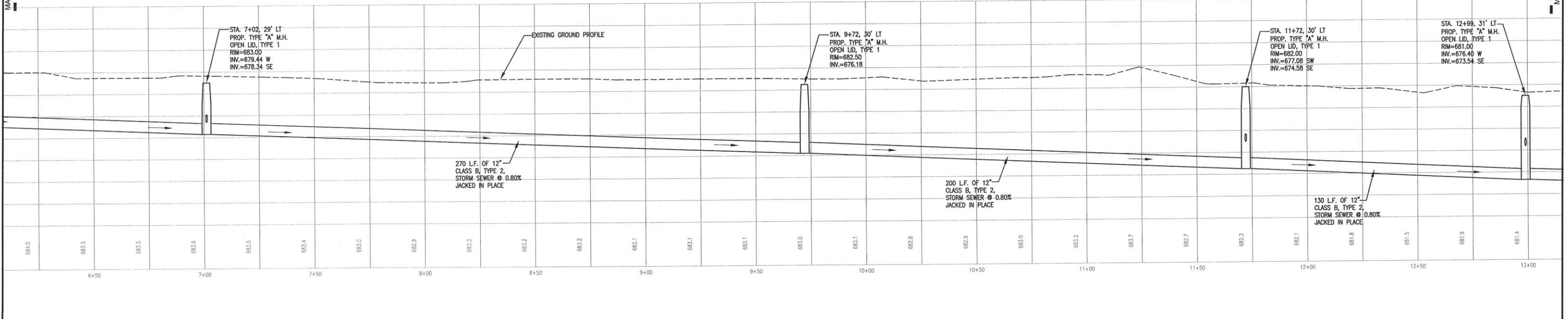

DOLAND ENGINEERING, LLC
 1001 EAST COOK STREET, SUITE C
 PALATKA, ILLINOIS 60067
 (815) 381-5000 (815) 381-5427 FAX
 www.dolandengineering.com

USER NAME:	DESIGNED:	REVISED:
PLOT SCALE: 1" = 20'	DRAWN:	REVISED:
PLOT DATE:	CHECKED:	REVISED:
	DATE:	REVISED:

**STATE OF ILLINOIS
 DEPARTMENT OF TRANSPORTATION**

DRAINAGE IMPROVEMENTS

SCALE: N/A SHEET NO. 6 OF 12 SHEETS STA. STA.

F.A. RTE.	SECTION	COUNTY	TOTAL SHEETS	SHEET NO.
--	15-00127-00-DR	LAKE	12	6
FED. ROAD DIST. NO. --		ILLINOIS FEDERAL AID PROJECT		CONTRACT No. 61D01

ST. JOHNS AVENUE

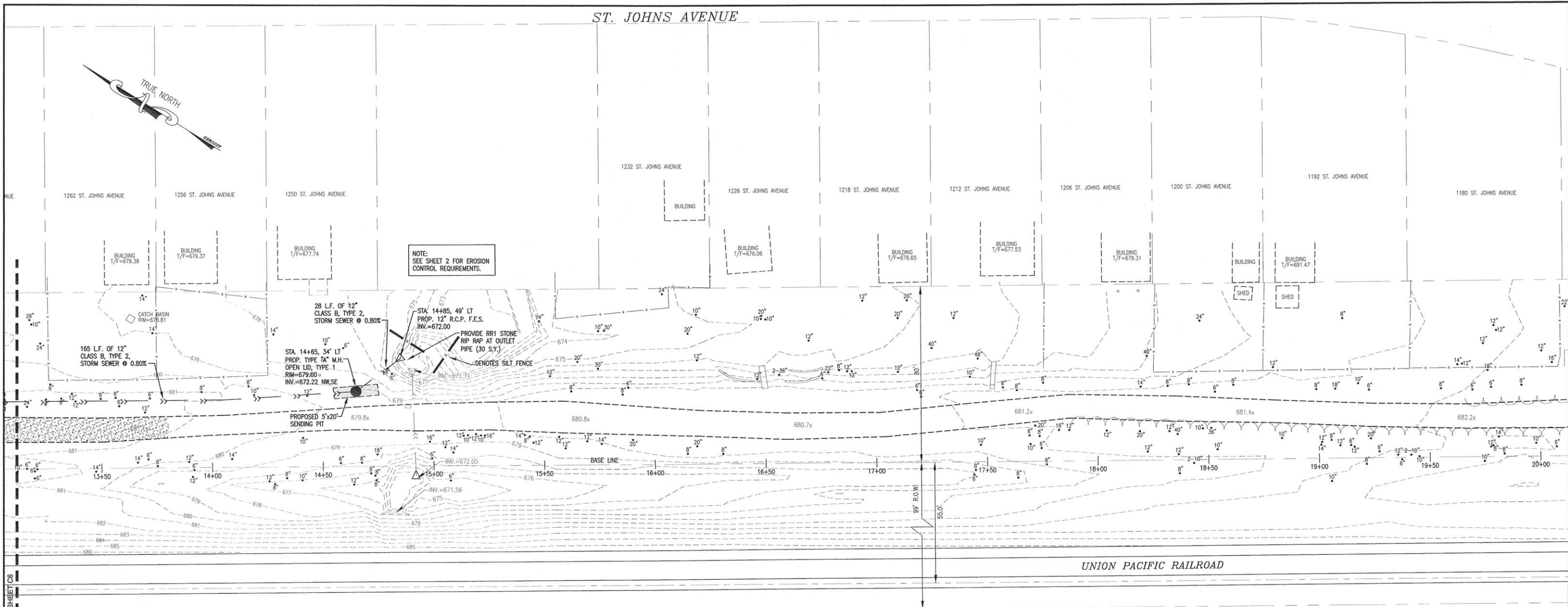

NOTE:
SEE SHEET 2 FOR EROSION
CONTROL REQUIREMENTS.

MATCH LINE SEE SHEET C6

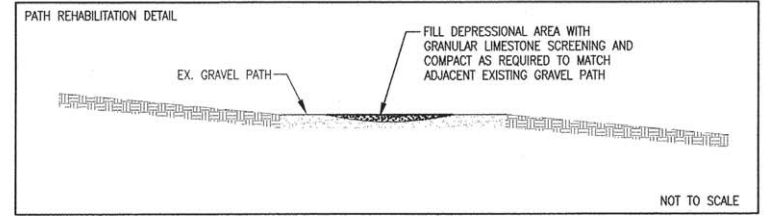
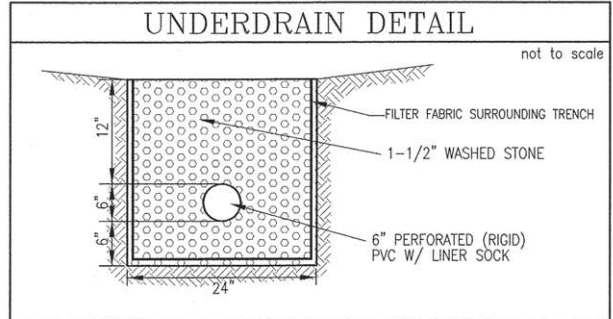
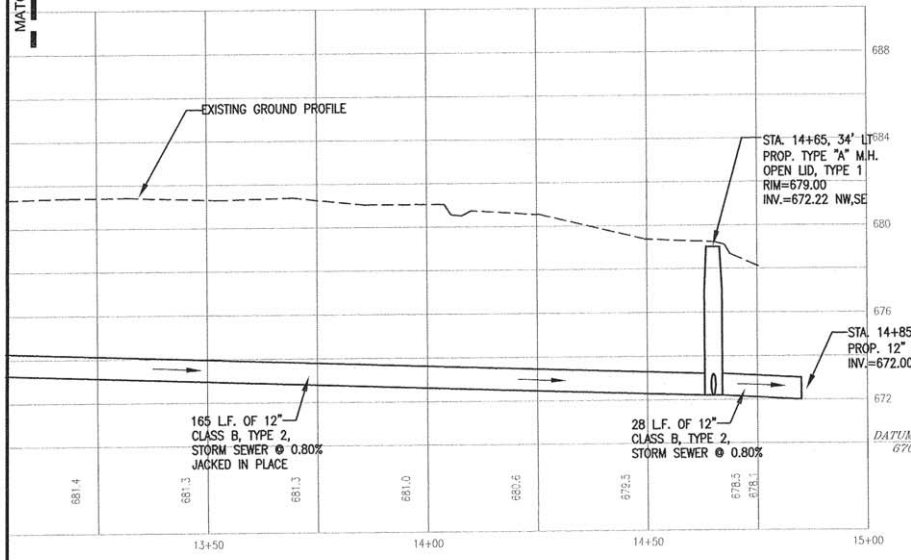

DOLAND
ENGINEERING, LLC
300 EAST COLMAR STREET, SUITE C
PALATKA, ILLINOIS 60067
(815) 391-0088 (815) 391-3127 FAX
www.dolandengineering.com

USER NAME:	DESIGNED:	REVISED:
PLOT SCALE: 1" = 20'	DRAWN:	REVISED:
PLOT DATE:	CHECKED:	REVISED:
	DATE:	REVISED:

STATE OF ILLINOIS
DEPARTMENT OF TRANSPORTATION

DRAINAGE IMPROVEMENTS

SCALE: N/A SHEET NO. 7 OF 12 SHEETS STA. STA.

F.A. RTE.	SECTION	COUNTY	TOTAL SHEETS	SHEET NO.
--	15-00127-00-DR	LAKE	12	7
FED. ROAD DIST. NO. --		ILLINOIS FEDERAL AID PROJECT		
CONTRACT No. 61001				

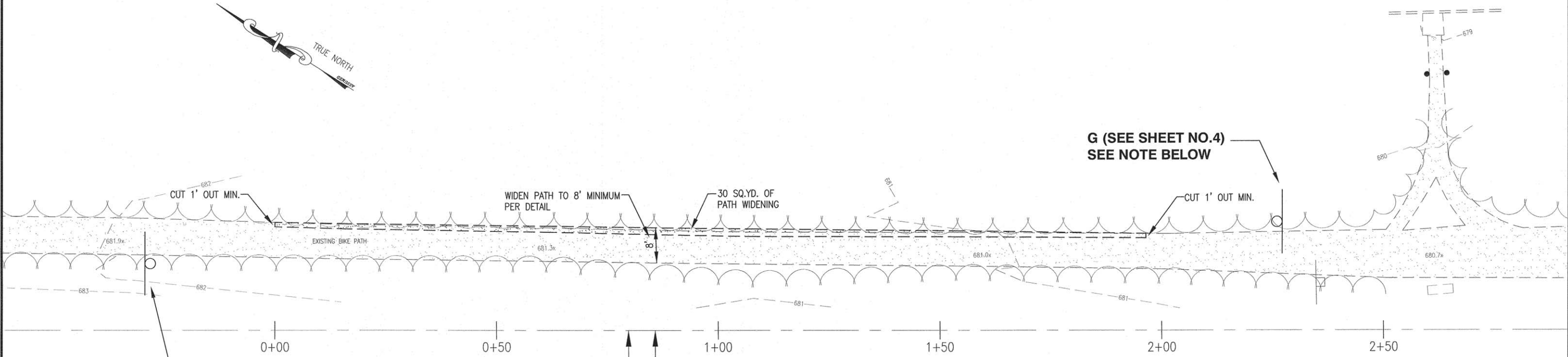
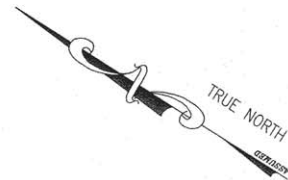

G (SEE SHEET NO.4)
SEE NOTE BELOW

G (SEE SHEET NO.4)

NOTE:
CONTRACTOR SHALL PROVIDE ONE (1) FLAGGER
AT EACH WALK YOUR BIKE "G" SIGN LOCATION,
WHEN WORKING BETWEEN "G" SIGNS

UNION PACIFIC RAILROAD

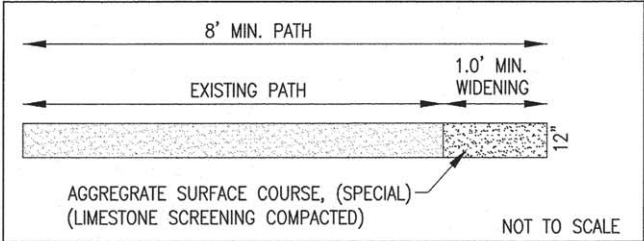

99' R.O.W.

55.0'

44.0'

USER NAME:	DESIGNED:	REVISED:
PLOT SCALE: 1" = 10'	DRAWN:	REVISED:
PLOT DATE:	CHECKED:	REVISED:
	DATE:	REVISED:

F.A. RTE.	SECTION	COUNTY	TOTAL SHEETS	SHEET NO.
--	15-00127-00-DR	LAKE	12	9
FED. ROAD DIST. NO. --		ILLINOIS FEDERAL AID PROJECT	CONTRACT NO. 61001	

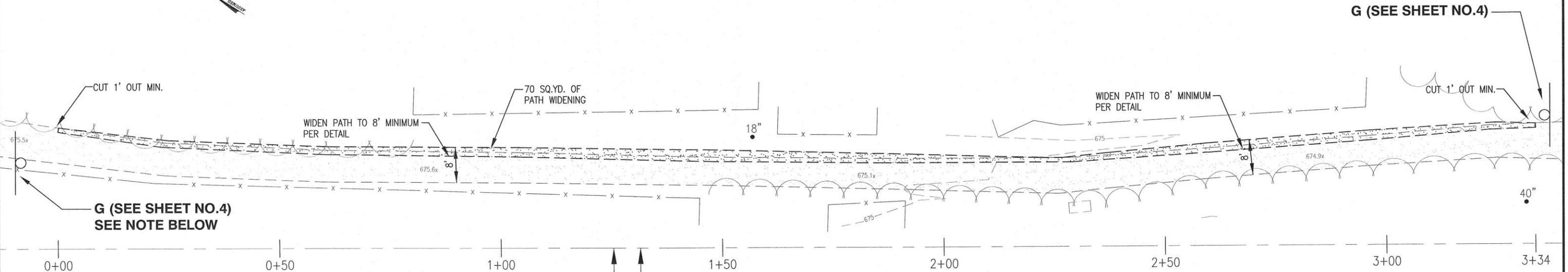
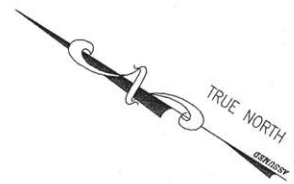

NOTE:
 CONTRACTOR SHALL PROVIDE ONE (1) FLAGGER
 AT EACH WALK YOUR BIKE "G" SIGN LOCATION,
 WHEN WORKING BETWEEN "G" SIGNS

UNION PACIFIC RAILROAD

99' R.O.W.

44.0'

55.0'

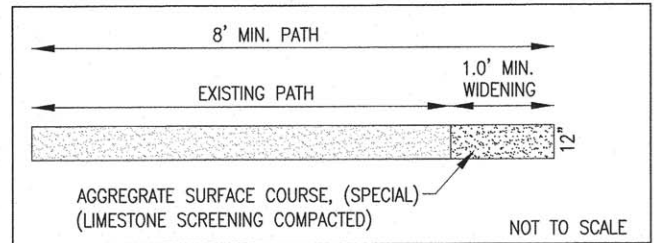

USER NAME:	DESIGNED:	REVISED:
PLOT SCALE: 1" = 10'	DRAWN:	REVISED:
PLOT DATE:	CHECKED:	REVISED:
	DATE:	REVISED:

F.A. RTE.	SECTION	COUNTY	TOTAL SHEETS	SHEET NO.
--	15-00127-00-DR	LAKE	12	10
FED. ROAD DIST. NO. --	ILLINOIS	FEDERAL AID PROJECT	CONTRACT NO. 61001	

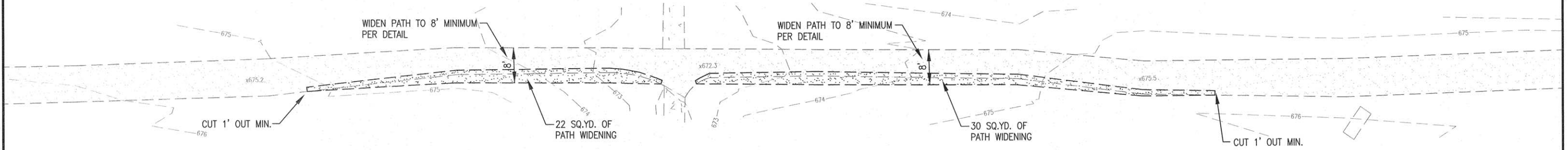
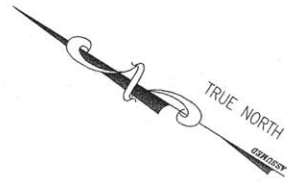

0+00 0+50 1+00 1+50 2+00 2+50

55.0'
99' R.O.W.
44.0'

UNION PACIFIC RAILROAD

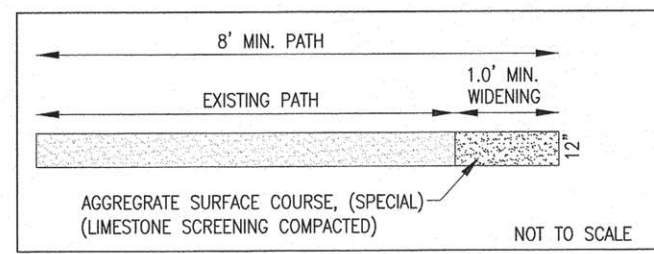

USER NAME:	DESIGNED:	REVISED:
PLOT SCALE: 1" = 10'	DRAWN:	REVISED:
PLOT DATE:	CHECKED:	REVISED:
	DATE:	REVISED:

F.A. RTE.	SECTION	COUNTY	TOTAL SHEETS	SHEET NO.
--	15-00127-00-DR	LAKE	12	11
FED. ROAD DIST. NO. -	ILLINOIS FEDERAL AID PROJECT		CONTRACT NO. 61001	

