

LEGEND

EXISTING	PROPOSED

LEGEND

EXISTING	PROPOSED
W	WATER LINE
IRRW	IRRIGATION WATER LINE
G	GAS LINE
U OF 1 G	U OF 1 GAS LINE
OHE	OVERHEAD ELECTRIC
UGE	UNDERGROUND ELECTRIC
OHT	OVERHEAD TELEPHONE
UGT	UNDERGROUND TELEPHONE
UGT(FO)	UNDERGROUND TELEPHONE (FIBER OPTIC)
CATV	CABLE TELEVISION
COM	COMMUNICATION LINE
FO	FIBER OPTIC LINE
STM	STEAM LINE
CWR	CHILLED WATER RETURN
CWS	CHILLED WATER SUPPLY
AIR	COMPRESSED AIR
FM	FORCE MAIN
SS	SANITARY SEWER
SS	STORM SEWER
SS	STORM SEWER WATER MAIN QUALITY
UD	PIPE UNDERDRAIN

ILLINOIS HIGHWAY STANDARD DRAWINGS

STANDARD NO.	DESCRIPTION
000001-06	STANDARDS SYMBOLS, ABBREVIATIONS AND PATTERNS
280001-07	TEMPORARY EROSION CONTROL SYSTEMS
420001-08	PAVEMENT JOINTS
420101-05	24' JOINTED PCC PAVEMENT
420106-05	36' JOINTED PCC PAVEMENT
420111-03	PCC PAVEMENT ROUNDOUTS
424001-08	PERPENDICULAR CURB RAMPS FOR SIDEWALKS
424011-02	CORNER PARALLEL CURB RAMPS FOR SIDEWALKS
424016-02	MID-BLOCK CURB RAMPS FOR SIDEWALKS
424021-03	DEPRESSED CORNER FOR SIDEWALKS
424026-01	ENTRANCE/ALLEY PEDESTRIAN CROSSINGS
424031-01	MEDIAN PEDESTRIAN CROSSINGS
442101-07	CLASS B PATCHES
601001-05	PIPE UNDERDRAINS
602301-04	INLET, TYPE A
602306-03	INLET, TYPE B
602401-03	MANHOLE, TYPE A
602406-07	MANHOLE, TYPE A, 6' DIAMETER
602411-05	MANHOLE, TYPE A, 7' DIAMETER
602601-04	PRECAST REINFORCED CONCRETE FLAT SLAB TOP
604001-04	FRAME AND LIDS, TYPE 1
604006-05	FRAME AND GRATE, TYPE 3
604011-05	FRAME AND GRATE, TYPE 3V
604036-03	GRATE, TYPE B
604051-04	FRAME AND GRATE, TYPE 11
606001-06	CONCRETE CURB TYPE B AND COMBINATION CONCRETE CURB AND GUTTER
606301-04	PC CONCRETE ISLANDS AND MEDIANS
668001-01	U.S. GEOLOGICAL SURVEY AND NATIONAL GEODETIC SURVEY BENCHMARKS RESETTING METHOD
701006-05	OFF-ROAD OPERATIONS, 2L, 2W, 15' TO 24" FROM PAVEMENT EDGE
701301-04	LANE CLOSURE, 2L, 2W, SHORT TIME OPERATIONS
701311-03	LANE CLOSURE, 2L, 2W, MOVING OPERATIONS - DAY ONLY
701501-06	URBAN LANE CLOSURE, 2L, 2W, UNDIVIDED
701502-06	URBAN LANE CLOSURE, 2L, 2W, WITH BIDIRECTIONAL LEFT TURN LANE
701602-07	URBAN LANE CLOSURE, MULTILANE, 2W WITH BIDIRECTIONAL LEFT TURN LANE
701611-01	URBAN HALF ROAD CLOSURE, MULTILANE, 2W WITH MOUNTABLE MEDIAN
701701-10	URBAN LANE CLOSURE, MULTILANE INTERSECTION
701801-06	SIDEWALK, CORNER OR CROSSWALK CLOSURE
701901-05	TRAFFIC CONTROL DEVICES
720001-01	SIGN PANEL MOUNTING DETAILS
720006-04	SIGN PANEL ERECTION DETAILS
720011-01	METAL POSTS FOR SIGNS, MARKERS AND DELINEATORS
729001-01	APPLICATIONS OF TYPES A AND B METAL POSTS (FOR SIGNS & MARKERS)
780001-05	TYPICAL PAVEMENT MARKINGS
814001-03	HANDHOLES
814006-02	DOUBLE HANDHOLES
8360021-02	LIGHT POLE FOUNDATIONS
857001-01	STANDARD PHASE DESIGNATION DIAGRAMS AND PHASE SEQUENCES
862001-01	UNINTERRUPTABLE POWER SUPPLY (UPS)
873001-02	TRAFFIC SIGNAL GROUNDING AND BONDING
877011-07	STEEL COMBINATION MAST ARM ASSEMBLY AND POLE 16' THROUGH 55'
878001-10	CONCRETE FOUNDATION DETAILS
880006-01	TRAFFIC SIGNAL MOUNTING DETAILS

DISTRICT 5 STANDARD DRAWINGS

STANDARD NO.	DESCRIPTION
70200000	TRAFFIC CONTROL & PROTECTION DEVICES (ROAD & SIDE ROAD CLOSURES)
70200100	DISABLED PARKING
7800AAAA	PAVEMENT MARKING AND MARKERS (RURAL & URBAN APPLICATIONS)

DISTRICT 5 GENERAL NOTES

- 100 ENGLISH UNITS OF MEASUREMENT SHALL GOVERN OVER AND SUPERSEDE ANY METRIC UNITS SHOWN IN THIS CONTRACT, WHERE INCLUDED. METRIC UNITS ARE FOR INFORMATION ONLY.
- 202 GRADING SHALL BE DONE BY HAND AROUND LIGHT POLES, UTILITY POLES, SIGN POSTS, SHRUBS, TREES OR OTHER NATURAL OR MAN-MADE OBJECTS WHERE SHALLOW FILLS OR CUTS ARE ADJACENT TO THE ITEMS. IT IS THE INTENT THAT THE LIMITS OF CONSTRUCTION BE SUCH AS TO PRESERVE IN THE ORIGINAL STATE AS MUCH AREA OF TEMPORARY EASEMENTS AS POSSIBLE. THE DECISION AS TO ITEMS TO REMAIN IN PLACE SHALL BE AS DIRECTED BY THE ENGINEER.
- THIS WORK WILL NOT BE PAID FOR SEPARATELY, BUT SHALL BE CONSIDERED INCLUDED IN THE CONTRACT UNIT PRICE PER CUBIC YARD FOR EARTH EXCAVATION AND NO ADDITIONAL COMPENSATION WILL BE ALLOWED.
- 406 THE QUANTITIES INCLUDED IN THE PLANS FOR HOT-MIX ASPHALT RESURFACING ARE INTENDED TO GIVE THE COVERAGE SHOWN ON THE TYPICAL CROSS SECTIONS. IT IS NOT INTENDED TO INCREASE THE THICKNESS OF THE HOT-MIX ASPHALT MIXTURE IN ORDER TO USE ALL OF THE QUANTITIES INCLUDED IN THE CONTRACT.

406H

BITUMINOUS MIXTURE REQUIREMENTS				
THE FOLLOWING MIXTURE REQUIREMENTS ARE APPLICABLE FOR THIS PROJECT:				
LOCATIONS	GREEN STREET/ LINCOLN AVENUE	GREEN STREET	GREEN STREET/ LINCOLN AVENUE	VARIOUS
MIXTURE USE(S):	LEVEL BINDER	BINDER COURSE	SURFACE COURSE	INCIDENTAL HOT-MIX ASPHALT
PG:	SBS-PG 70-22	SBS-PG 70-22	SBS-PG 70-22	PG 64-22
DESIGN AIR VOIDS:	4.0% @ NDESIGN=70	4.0% @ NDESIGN=70	4.0% @ NDESIGN=70	4.0% @ NDESIGN=50
MIXTURE COMPOSITION: (GRADATION MIXTURE)	IL 9.5 FG	IL 19.0	IL 9.5	IL 9.5
FRICTION AGGREGATE:	N/A	N/A	MIXTURE D	MIXTURE C
MIXTURE WEIGHT:	112 LB/SO YD/IN	112 LB/SO YD/IN	112 LB/SO YD/IN	112 LB/SO YD/IN
QUALITY MANAGEMENT PROGRAM:	OC/OA	OC/OA	OC/OA	OC/OA
SUBLOT SIZE:	N/A	N/A	N/A	N/A

MINIMUM MIXTURE REQUIREMENT NOTES

THE MIXTURE REQUIREMENTS SET FORTH IN THE TABLE ABOVE ARE MINIMUM MIXTURE REQUIREMENTS. THE CONTRACTOR MAY SUBSTITUTE HIGHER FRICTION AGGREGATE HMA MIXTURES FOR A LOWER FRICTION AGGREGATE HMA MIXTURE AT THE CONTRACT UNIT PRICE FOR THE LOWER FRICTION AGGREGATE HMA MIXTURE. THE CONTRACTOR MAY SUBSTITUTE HIGHER DESIGN AIR VOIDS HMA MIXTURES FOR A LOWER DESIGN AIR VOIDS HMA MIXTURE AT THE CONTRACT UNIT PRICE OF THE LOWER DESIGN AIR VOIDS HMA MIXTURE.

- 440C THE MACHINE USED FOR HOT-MIX ASPHALT SURFACE REMOVAL ON THE THROUGH TRAFFIC LANES ON THIS JOB SHALL BE CAPABLE OF REMOVING A LAYER OF BITUMINOUS MATERIAL AT LEAST 10 FT. IN WIDTH AND 1 1/2 INCHES IN DEPTH IN A SINGLE PASS.
- 442B THE PATCHING SCHEDULES INCLUDED IN THE PLANS REPRESENT THE BEST INFORMATION AVAILABLE AT THE TIME OF COMPLETION OF THE PLANS FOR LETTING. VARIATIONS IN LOCATION AND SIZES OF BOTH FULL-DEPTH AND PARTIAL-DEPTH PATCHES MAY OCCUR.

COMMITMENTS

- A. THE PRELIMINARY SITE INVESTIGATIONS (PSI) WILL BE COMPLETED BEFORE THE PROJECT IS INCLUDED ON A LETTING. PSI REPORT IS AVAILABLE FROM THE CITY OF CHAMPAIGN.
- B. SPECIAL CONDITIONS FOR ACCESS TO PROPERTIES DURING CONSTRUCTION WILL BE INCLUDED IN THE CONSTRUCTION DOCUMENTS. PROVISIONS WILL BE INCLUDED TO REQUIRE COMMUNICATIONS WITH PROPERTY OWNERS THROUGHOUT THE CONSTRUCTION PROCESS. MAIL DELIVERY IS DONE BY CARRIER AND PEDESTRIAN ACCESS WILL BE MAINTAINED THROUGHOUT THE PROJECT.
- C. FINAL CHAMPAIGN-URBANA MASS TRANSIT DISTRICT (CUMTD) ROUTE DETOURS WILL BE DETERMINED BEFORE THE PROJECT IS INCLUDED ON A LETTING.
- D. THE TEMPORARY EASEMENTS FOR 809 W. GREEN STREET AND 810 W. GREEN STREET ARE AVAILABLE FROM APRIL 1, 2017 TO MARCH 31, 2018 AND ONCE WORK BEGINS ON EACH PROPERTY IT MUST BE COMPLETED 120 DAYS THEREAFTER.

© Copyright Hanson Professional Services Inc. 2016
HANSON
 Hanson Professional Services Inc.

LAYOUT	11/24/15
DRAWN	2/4/16
REVIEWED	3/22/16
DESIGNED	RLA
CHECKED	RLA
DATE	3/23/2016

FILE NAME = Z:\Plans\Sheets\Project\1\1-snt-gennote02.dgn
 PLOT DATE = 7/18/2016 3:49:45 PM

DESIGNED	- RLA	REVISED	7/18/2016
DRAWN	- RLA	REVISED	-
CHECKED	- MGD	REVISED	-
DATE	- 3/23/2016	REVISED	-

STATE OF ILLINOIS
 DEPARTMENT OF TRANSPORTATION

**PROJECT 1 - GREEN STREET
 HIGHWAY STANDARDS AND LEGEND**

F.A.J. RTE.	SECTION	COUNTY	TOTAL SHEETS	SHEET NO.
7126	15-00304-01-PV	CHAMPAIGN	239	3
MCORE PROJECT 1			CONTRACT NO. 91539	
JOB NO. C-95-305-16 ILLINOIS FED. AID PROJECT FIG-5181057				

SCALE: N/A SHEET NO. OF SHEETS STA. TO STA.

SUMMARY OF QUANTITIES

ITEM NUMBER	ITEM	CONSTRUCTION CODE	UNIT	TOTAL QUANTITY	0004	0021	0021	0031	0043	0043
					ROADWAY QUANTITY	SIGNAL QUANTITY	LIGHTING QUANTITY	LANDSCAPING QUANTITY	SANITARY QUANTITY	WATER MAIN QUANTITY
X7830060	GROOVING FOR RECESSED PAVEMENT MARKING, LETTERS AND SYMBOLS		SQ FT	428	428					
X7830070	GROOVING FOR RECESSED PAVEMENT MARKING 5"		FOOT	8,259	8,259					
X7830074	GROOVING FOR RECESSED PAVEMENT MARKING 7"		FOOT	3,276	3,276					
X7830078	GROOVING FOR RECESSED PAVEMENT MARKING 13"		FOOT	1,932	1,932					
X7830090	GROOVING FOR RECESSED PAVEMENT MARKING 25"		FOOT	487	487					
X8040102	ELECTRIC SERVICE INSTALLATION, SPECIAL		EACH	4			4			
X8130110	JUNCTION BOX (SPECIAL)		EACH	78			78			
X8130125	REMOVE EXISTING JUNCTION BOX		EACH	8			8			
X8140115	HANDHOLE TO BE ADJUSTED		EACH	10	10					
X8211225	LUMINAIRE, LED, HORIZONTAL MOUNT, SPECIAL		EACH	21			21			
X8211285	LUMINAIRE, LED, HORIZONTAL MOUNT, 285 WATT		EACH	5		5				
X8250505	LIGHTING CONTROLLER, SPECIAL		EACH	1			1			
X8360120	LIGHT POLE FOUNDATION, SPECIAL		EACH	22			22			
X8800101	PEDESTRIAN PUSH-BUTTON, SPECIAL		EACH	10		10				
XX000300	CONCRETE STEPS		SQ FT	56	56					
XX001249	ORNAMENTAL FENCE		FOOT	327				327		
XX001683	INFORMATION KIOSK		EACH	4	4					
XX002090	STAIR SIDE RAILING		FOOT	192	192					
XX003000	CLASS SI CONCRETE STEPS		CU YD	4	4					
XX003303	CONCRETE LIGHT POLE		EACH	8			8			
XX004960	SANITARY SEWER BYPASS PUMPING		LSUM	1					1	
XX005106	PVC CASING PIPE, 18"		FOOT	68						68
XX005476	DUCTILE IRON WATER MAIN 12" RESTRAINED JOINT TYPE		FOOT	1,478						1,478
XX005478	DUCTILE IRON WATER MAIN 6" RESTRAINED JOINT TYPE		FOOT	116						116
XX005770	STRUCTURE TO BE ABANDONED		EACH	5	5					
XX005967	TOPSOIL (PLANTING MIXTURE)		CU YD	26.5				26.5		
XX006496	PORTLAND CEMENT CONCRETE SIDEWALK AND CURB WALL		CU YD	12	12					
XX006570	TREES (SPECIAL)		EACH	13				13		
XX006739	CONCRETE PAVERS, TYPE A		SQ FT	1,000				1,000		
XX006740	CONCRETE PAVERS, TYPE B		SQ FT	203				203		
XX006821	CONCRETE TRUCK WASHOUT		LSUM	1	1					
XX007325	REMOVE EXISTING TRAFFIC SIGNAL POST		EACH	2	2					
XX007797	LUMINAIRE (SPECIAL)		EACH	8			8			
XX008068	LUMINAIRE INSTALLATION, TYPE 1		EACH	15			15			
XX008069	LUMINAIRE INSTALLATION, TYPE 2		EACH	8			8			
XX008263	PORTLAND CEMENT CONCRETE PLATFORM (SPECIAL)		SQ FT	8,606	8,606					
XX008639	SHRUBS (SPECIAL)		EACH	373				373		
XX008839	WATER MAIN TO BE ABANDONED		LSUM	1						1
Z0003855	BICYCLE RACKS		EACH	33				33		
Z0004002	BOLLARDS		EACH	7	7					
Z0007480	TEMPORARY SIDEWALK		SQ FT	400	400					

* SPECIALTY ITEM



LAYOUT	BAB	11/24/15
DRAWN	RLA	2/17/16
REVIEWED	MGD	3/22/16

FILE NAME = Z:\Plans\Sheets\Project1\P1-sht-soq06.dgn
 PLOT DATE = 7/18/2016 4:10:18 PM

DESIGNED - BAB	REVISED - 7/18/2016
DRAWN - RLA	REVISED -
CHECKED - MGD	REVISED -
DATE - 3/23/2016	REVISED -

STATE OF ILLINOIS
DEPARTMENT OF TRANSPORTATION

PROJECT 1 - GREEN STREET SUMMARY OF QUANTITIES

SCALE: N/A SHEET NO. OF SHEETS STA. TO STA.

F.A.J. RTE.	SECTION	COUNTY	TOTAL SHEETS	SHEET NO.
7126	15-00304-01-PV	CHAMPAIGN	239	9
MCORE PROJECT 1 CONTRACT NO. 91539				
JOB NO. C-95-305-16 ILLINOIS FED. AID PROJECT TIC-5181057				

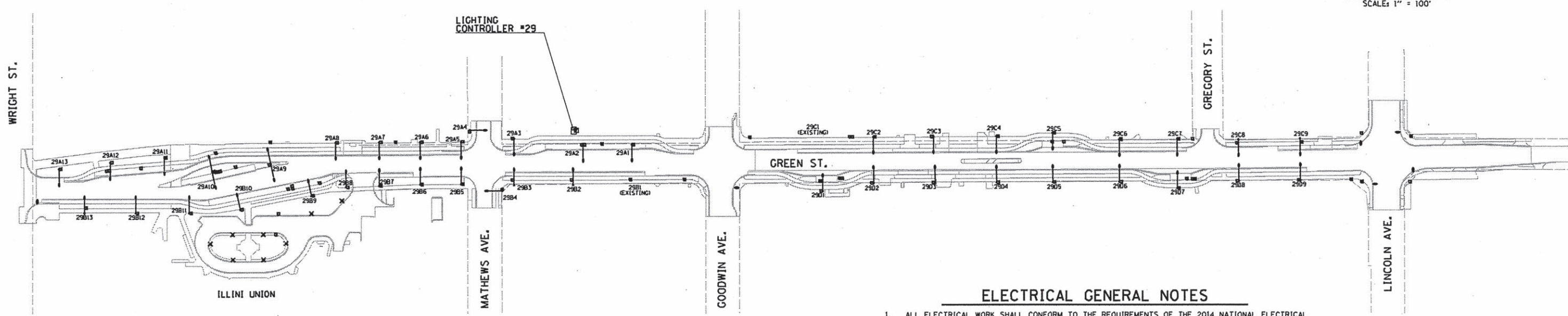
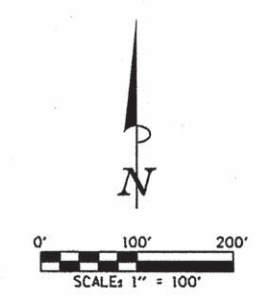

ELECTRICAL GENERAL NOTES

1. ALL ELECTRICAL WORK SHALL CONFORM TO THE REQUIREMENTS OF THE 2014 NATIONAL ELECTRICAL CODE, THE IDOT "STANDARD SPECIFICATIONS FOR ROAD AND BRIDGE CONSTRUCTION", AND ALL APPLICABLE LOCAL ORDINANCES.
2. THE CONTRACTOR SHALL FURNISH ALL MATERIALS FOR A COMPLETE AND WORKABLE SYSTEM.
3. THE CONTRACTOR SHALL BE RESPONSIBLE FOR OBTAINING ALL REQUIRED PERMITS AND FOR PROVIDING ALL SUPERVISION, LABOR, MATERIAL AND TOOLS FOR THE PROJECT. CONTRACTOR SHALL OBTAIN CITY OF URBANA ELECTRICIAN LICENSE PRIOR TO START OF WORK. CONTRACTOR SHALL COORDINATE INSPECTION OF WORK WITH THE CITY OF URBANA.
4. ALL LOCATIONS AND DIMENSIONS SHOWN ARE APPROXIMATE. THE CONTRACTOR SHALL FIELD VERIFY ALL EQUIPMENT LOCATIONS AND EQUIPMENT DIMENSIONS.
5. ALL CONDUITS WITH WIRING SHALL BE PROVIDED WITH AN INSULATED COPPER GROUNDING CONDUCTOR SIZED AS NOTED ON PLANS AND IN ACCORDANCE WITH THE 2014 NATIONAL ELECTRICAL CODE.
6. ALL GROUNDING CONDUCTORS SHALL BE BONDED TOGETHER IN ALL HANDHOLES AND JUNCTION BOXES. (SEE DETAILS)
7. ALL SERVICE LATERAL CONDUITS SHALL BE SCHEDULE 40 PVC EXCEPT ALL ELBOWS AND VERTICAL RISERS SHALL BE RIGID GALVANIZED STEEL. ALL ELBOWS SHALL BE LONG RADIUS TYPE. CONTRACTOR SHALL VERIFY AND COMPLY WITH ALL UNIVERSITY OF ILLINOIS AND PRAIRIELAND ENERGY REQUIREMENTS FOR THE SERVICE INSTALLATIONS.
8. CONDUIT ROUTING SHOWN IS SCHEMATIC ONLY. CONTRACTOR SHALL COORDINATE EXACT ROUTING AND INSTALLATION WITH ALL OTHER SITE WORK BEING PERFORMED. COORDINATE ALL POLE LOCATIONS WITH ENGINEER IN THE FIELD.
9. PROVIDE PULLSTRING IN ALL CONDUITS, INCLUDING THOSE CONDUITS WITH CONDUCTORS INSTALLED. THE PULL STRING SHALL BE INCLUDED IN THE COST OF THE CONDUITS AND NO ADDITIONAL COMPENSATION WILL BE ALLOWED.
10. THE CONTRACTOR SHALL TAG ALL ELECTRICAL CONDUCTORS (PHASE CONDUCTORS, NEUTRALS, AND GROUNDS) WITH PERMANENT TAGS. EACH CONDUCTOR SHALL BE TAGGED IN ALL CONCRETE HANDHOLES, JUNCTION BOXES, AND POLE HANDHOLES. THE TAG SHALL INDICATE THE LIGHTING CONTROLLER AND CIRCUIT NUMBER FROM WHICH THE CONDUCTORS ORIGINATE.
11. ALL CONDUITS SHALL BE 30" BELOW FINAL GRADE UNLESS OTHERWISE DIRECTED BY THE ENGINEER. CONTRACTOR IS RESPONSIBLE FOR REPAIR TO ALL UNDERGROUND UTILITIES DAMAGED DURING INSTALLATION OF ROADWAY LIGHTING AND FEEDER SYSTEMS.
12. SERVICE GROUND RODS SHALL BE 3/4" DIAMETER x 10'-0" LONG COPPER CLAD STEEL. GROUND RODS AT POLES SHALL BE 3/4" DIAMETER x 10'-0" LONG. GROUNDING ELECTRODE CONDUCTORS SHALL BE #4 SOLID COPPER AND SHALL BE CONNECTED WITH HYDRAULIC CRIMP TYPE CONNECTIONS TO GROUNDING ELECTRODE. GROUND ROD SHALL BE INSTALLED AT LIGHTING CONTROLLER, HANDHOLES AND JUNCTION BOXES.
13. POLE WIRING WILL NOT BE PAID FOR SEPARATELY BUT SHALL BE INCLUDED WITH THE LUMINAIRE PER ARTICLE 821.03 OF THE STANDARD SPECIFICATIONS.
14. WHERE EXISTING CONDUCTORS ARE TO BE ABANDONED IN PLACE, THE CONDUCTORS SHALL BE DISCONNECTED AND ISOLATED FROM EXISTING CONDUCTORS WHICH ARE TO REMAIN ENERGIZED.
15. THE CONTRACTOR SHALL USE CARE IN CONSTRUCTING THE LIGHT POLES THAT ARE NEAR TRENCH EXCAVATIONS FOR STORM SEWERS AND OTHER UTILITIES. THE CONTROLLED LOW-STRENGTH MATERIAL SHALL BE BLOCKED OUT AT THE CONCRETE FOUNDATION LOCATIONS TO ALLOW FOR THEIR LATER CONSTRUCTION AS DIRECTED BY THE ENGINEER.
16. THE EXISTING LIGHTING UNITS (LUMINAIRES AND POLES) THAT ARE NOTED TO BE SALVAGED SHALL REMAIN THE PROPERTY OF THE CITY OF URBANA, AND SHALL BE MOVED TO AND STORED AT A LOCATION DESIGNATED BY THE ENGINEER FOR PICK UP BY THE CITY'S FORCES.
17. CONDUITS ARE INDICATED AS TRENCHED OR AUGERED FOR INFORMATION PURPOSES. ALL CONDUIT WILL BE PAID AT THE CONTRACT UNIT PRICE PER FOOT FOR UNDERGROUND CONDUIT OF THE TYPE AND SIZE SPECIFIED.
18. JUNCTION BOXES SHALL INCLUDE THE INTENDED USE CAST INTO THE COVER. SEE SPECIAL PROVISIONS.

BILL OF MATERIALS

CODE NUMBER	ITEM	UNIT	TOTAL QUANTITY
81028350	UNDERGROUND CONDUIT, PVC, 2" D.I.A.	FOOT	10038
81028400	UNDERGROUND CONDUIT, PVC, 5" D.I.A.	FOOT	9
81400700	HANDHOLE, PORTLAND CEMENT CONCRETE	EACH	1
81500120	GULFBOX JUNCTION, COMPOSITE CONCRETE	EACH	1
81702110	ELECTRIC CABLE IN CONDUIT, 600V (XLP-TYPE USE) 1/C NO. 10	FOOT	155
81702120	ELECTRIC CABLE IN CONDUIT, 600V (XLP-TYPE USE) 1/C NO. 8	FOOT	3786
81702130	ELECTRIC CABLE IN CONDUIT, 600V (XLP-TYPE USE) 1/C NO. 6	FOOT	1861
81702140	ELECTRIC CABLE IN CONDUIT, 600V (XLP-TYPE USE) 1/C NO. 4	FOOT	20208
81702155	ELECTRIC CABLE IN CONDUIT, 600V (XLP-TYPE USE) 1/C NO. 1	FOOT	2070
83000400	LIGHT POLE, ALUMINUM, 30 FT. M.H., 10 FT. DAVIT ARM	EACH	39
83600200	LIGHT POLE FOUNDATION, 24" DIAMETER	FOOT	168
84200500	REMOVAL OF LIGHTING UNIT, SALVAGE	EACH	1
84200600	REMOVAL OF LIGHTING UNIT, NO SALVAGE	EACH	27
84200804	REMOVAL OF POLE FOUNDATION	EACH	30
84400105	RELOCATE EXISTING LIGHTING UNIT	EACH	5
84500110	REMOVAL OF LIGHTING CONTROLLER	EACH	1
84500120	REMOVAL OF ELECTRIC SERVICE INSTALLATION	EACH	1
X0327739	MISCELLANEOUS ELECTRICAL WORK	LSUM	1
X1400092	LIGHT POLE, ALUMINUM, 30 FT. M.H., 10 FT. DAVIT ARM - TWIN	EACH	2
X1700001	DRILL EXISTING MANHOLE, HEAVY DUTY HANDHOLE, OR MEDIUM WALL JUNCTION BOX	EACH	8
X6050040	REMOVING MANHOLES, SPECIAL	EACH	1
X8040102	ELECTRIC SERVICE INSTALLATION, SPECIAL	EACH	4
X8130110	JUNCTION BOX (SPECIAL)	EACH	78
X8130125	REMOVE EXISTING JUNCTION BOX	EACH	8
X8211125	LUMINAIRE, LED, HORIZONTAL MOUNT, SPECIAL	EACH	21
X8250505	LIGHTING CONTROLLER, SPECIAL	EACH	1
X8360120	LIGHT POLE FOUNDATION, SPECIAL	EACH	22
XX003303	CONCRETE LIGHT POLE	EACH	8
XX007797	LUMINAIRE (SPECIAL)	EACH	8
XX008068	LUMINAIRE INSTALLATION, TYPE 1	EACH	15
XX008069	LUMINAIRE INSTALLATION, TYPE 2	EACH	8
	FIBER OPTIC CABLE IN CONDUIT, SPECIAL	FOOT	3187

Clark Dietz ENGINEERS



FILE NAME = p:\c0010720_mcore\Plans\sheets\Project1\PI-sht-lighting.dgn
 PLOT DATE = 7/18/2016 1:39:39 PM

DESIGNED - M.L.S. REVISED - 7/18/2016
 DRAWN - L.F.D. REVISED -
 CHECKED - L.M.Z. REVISED -
 DATE - MARCH 2016 REVISED -

STATE OF ILLINOIS
 DEPARTMENT OF TRANSPORTATION

ROADWAY LIGHTING PLANS - GENERAL PLAN

SCALE: 1"=100' SHEET NO. 115 OF 239 SHEETS STA. TO STA.

F.A.U. RTE.	SECTION	COUNTY	TOTAL SHEETS	SHEET NO.
	15-00304-01-PV	CHAMPAIGN	239	115
MCORE PROJECT 1		CONTRACT NO. 91539		
JOB NO. C-95-305-16 ILLINOIS FED. AID PROJECT TIG-5181057				

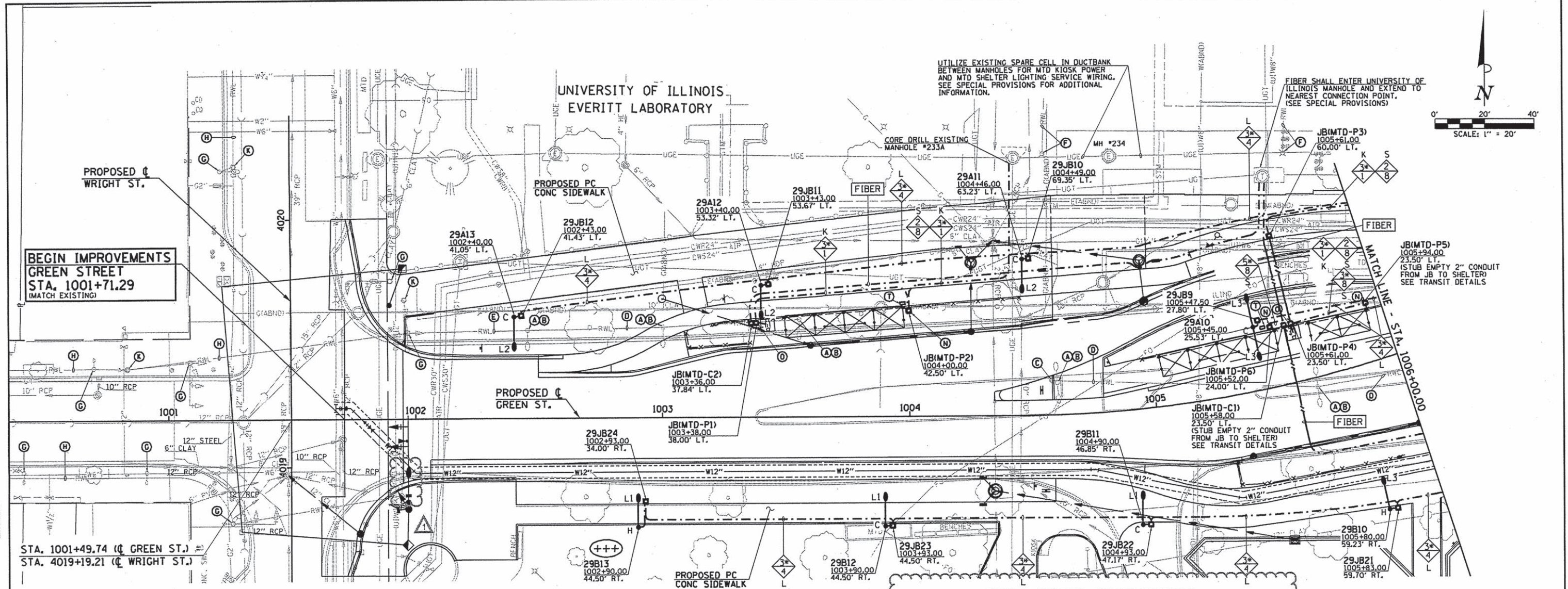
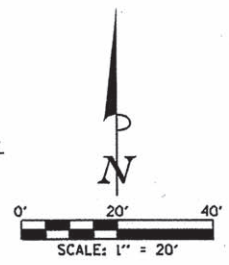

BEGIN IMPROVEMENTS GREEN STREET STA. 1001+71.29 (MATCH EXISTING)

STA. 1001+49.74 (GREEN ST.)
STA. 4019+19.21 (WRIGHT ST.)

CIRCUIT DESIGNATION SCHEME

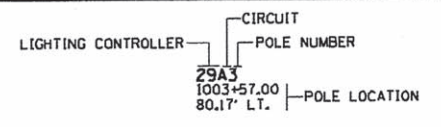

NOTE: THE CONTRACTOR SHALL PROVIDE A PERMANENT STICKER INSIDE HAND HOLE OF EACH LIGHT POLE INDICATING THE LIGHTING CONTROLLER, CIRCUIT AND POLE NUMBER.

CONDUCTOR SYMBOL SCHEME

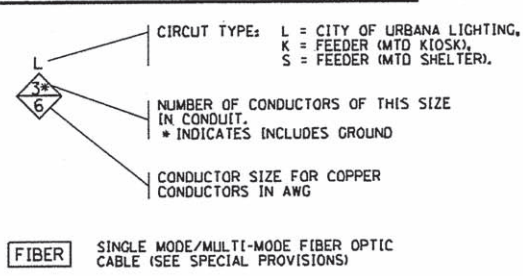

JUNCTION BOX DESIGNATION SCHEME

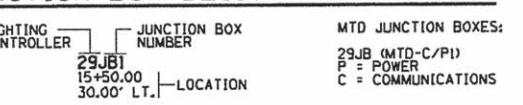

ROADWAY LIGHTING LEGEND

EXISTING	PROPOSED	DESCRIPTION
X	L ^H H	ROADWAY LED LUMINAIRE ("L" INDICATES LUMINAIRE TYPE, SEE SPECIAL PROVISIONS FOR DESCRIPTION OF LUMINAIRE TYPE). LUMINAIRE MOUNTED ON 10' DAVIT ARM MOUNTED ON 30' ALUMINUM LIGHT POLE MOUNTED ON CONCRETE TYPE FOUNDATION. "H" INDICATES HELIX FOUNDATION, "C" INDICATES CONCRETE FOUNDATION.
X	X	PEDESTRIAN LED LUMINAIRE. LUMINAIRE MOUNTED ON A DIRECTLY IMBEDDED 13' PRE-STRESSED CONCRETE LIGHT POLE. LUMINAIRE SHALL BE CONNECTED TO U OF I FACILITIES AND WILL BE MAINTAINED BY THE U OF I.
X	X	TWO (2) ROADWAY LED LUMINAIRES ("L" INDICATES LUMINAIRE TYPE, SEE SPECIAL PROVISIONS FOR DESCRIPTION OF LUMINAIRE TYPE). LUMINAIRES MOUNTED ON TWIN 10' DAVIT ARMS MOUNTED ON 30' ALUMINUM LIGHT POLE MOUNTED ON CONCRETE TYPE FOUNDATION.
X	X	ROADWAY LED LUMINAIRE (SEE SPECIAL PROVISIONS FOR DESCRIPTION OF LUMINAIRE TYPE). LUMINAIRE MOUNTED ON 15' ALUMINUM TRUSS ARM MOUNTED ON 35' TRAFFIC SIGNAL MAST ARM POLE. TRUSS ARM, POLE AND FOUNDATION TO BE PROVIDED AND INSTALLED AS PART OF THE TRAFFIC SIGNAL INSTALLATION. COORDINATE LUMINAIRE INSTALLATION WITH POLE AND SIGNAL INSTALLATION.
X	X	ROADWAY LIGHTING UNIT WITH LUMINAIRE AND POLE
X	X	PORTLAND CEMENT CONCRETE HANDHOLE
X	X	PROPOSED LIGHTING CONTROLLER (* AS NOTED)
X	X	COMPOSITE TYPE JUNCTION BOX, SPECIAL (12"W x 12"L x 12"D)
X	X	GULFBOX JUNCTION, COMPOSITE CONCRETE (13"W x 24"L x 12"D)
X	X	2" PVC CONDUIT (SCHEDULE 80), AUGURED
X	X	2" PVC CONDUIT (SCHEDULE 40), TRENCHED
X	X	UNDERGROUND CONDUIT
X	X	OVERHEAD ELECTRICAL CONDUCTORS
X	X	ROADWAY LIGHTING CONDUIT/CONDUCTORS

KEYED NOTES (THIS SHEET)

- (A) EXISTING LIGHTING UNIT (POLE AND LUMINAIRE) TO BE REMOVED COMPLETE.
- (B) EXISTING CONCRETE FOUNDATION TO BE REMOVED COMPLETE.
- (C) EXISTING JUNCTION BOX TO BE REMOVED COMPLETE.
- (D) EXISTING CONDUIT AND CONDUCTORS TO BE CUT OFF BELOW GRADE AND ABANDONED IN PLACE.
- (E) REMOVE EXISTING CONDUCTORS BACK TO NEAREST JUNCTION BOX OR LIGHTING UNIT TO REMAIN. CUT OFF CONDUIT BELOW GRADE AND ABANDON IN PLACE.
- (F) UNIVERSITY OF ILLINOIS EXISTING LIGHTING EQUIPMENT AND SYSTEM TO REMAIN AS PRESENTLY INSTALLED.
- (G) EXISTING LIGHTING UNIT (POLE AND LUMINAIRE) TO REMAIN.
- (H) EXISTING CONDUIT AND CONDUCTORS TO REMAIN.
- (K) EXISTING HANDHOLE TO REMAIN.
- (L) CONNECT ILLUMINATED STREET SIGN TO SAME ROADWAY LIGHTING CIRCUIT THAT IS SERVING ROADWAY LIGHTING LUMINAIRE ON THIS SIGNAL POLE.
- (N) PROVIDE COMPOSITE TYPE JUNCTION BOX FOR LIGHTING CONNECTION TO MTD BUS SHELTER. PROVIDE 2" CONDUIT TO REAR LEG OF SHELTER FOR LIGHTING WIRING. COORDINATE WITH SHELTER MANUFACTURER. CONNECT SHELTER LIGHTING TO MTD SHELTER LIGHTING CIRCUIT FROM ELECTRONIC TIME SWITCH PEDESTAL. PROVIDE IN-LINE FUSE HOLDER WITH 15A FUSE FOR SHELTER LIGHTING DISCONNECT.
- (O) PROVIDE TWO COMPOSITE TYPE JUNCTION BOXES FOR POWER AND COMMUNICATIONS CONNECTIONS TO MTD KIOSK. PROVIDE TWO 2" CONDUITS TO KIOSK FOR POWER AND COMMUNICATIONS WIRING. COORDINATE WITH KIOSK MANUFACTURER.
- (T) PROVIDE ELECTRONIC TIME SWITCH FOR MTD BUS SHELTER CONSISTING OF 18" PEDESTAL WITH LOCKABLE COVER AND ELECTRONIC TIME SWITCH. SEE DETAILS FOR ADDITIONAL INFORMATION.
- (I) (J) (M) (P) (R) (S) NOT USED

(+++)
THE CONTRACTOR WILL BE RESPONSIBLE FOR PROTECTING THE EXISTING HEDGE FROM DAMAGE DURING THE INSTALLATION OF THE PROPOSED LIGHTING SYSTEM. THE CONTRACTOR WILL BE ALLOWED TO REMOVE THE EXISTING HEDGE A MAXIMUM OF 30" WIDE ONLY WHERE IT CONFLICTS WITH THE PROPOSED LIGHT POLE AND FOUNDATION INSTALLATIONS. THE CONTRACTOR WILL BE RESPONSIBLE FOR ANY DAMAGES AS DETERMINED BY THE ENGINEER.

REMOVE TO EXISTING LIGHT POLE APPROXIMATELY 100' NORTH. REMOVE ASSOCIATED EXISTING LIGHTING CONTROLLER AND SERVICE INSTALLATION LOCATED JUST NORTH OF EXISTING LIGHT POLE. LIGHT POLE TO REMAIN AND BE REUSED. SEE SPECIAL PROVISIONS.

EXTEND TO EXISTING LIGHT POLE APPROXIMATELY 100' TO NORTH. REPLACE EXISTING LIGHT ON POLE WITH A TYPE L1 ROADWAY LIGHTING FIXTURE. CONNECT TO NEW ROADWAY LIGHTING CIRCUIT. LABEL POLE 29C10.

UNIVERSITY OF ILLINOIS ASTRONOMY BUILDING

PROPOSED GREGORY ST.

HENDRICK HOUSE 904 W. GREEN

PROPOSED LINCOLN AVE.

MOBIL 810 W. GREEN

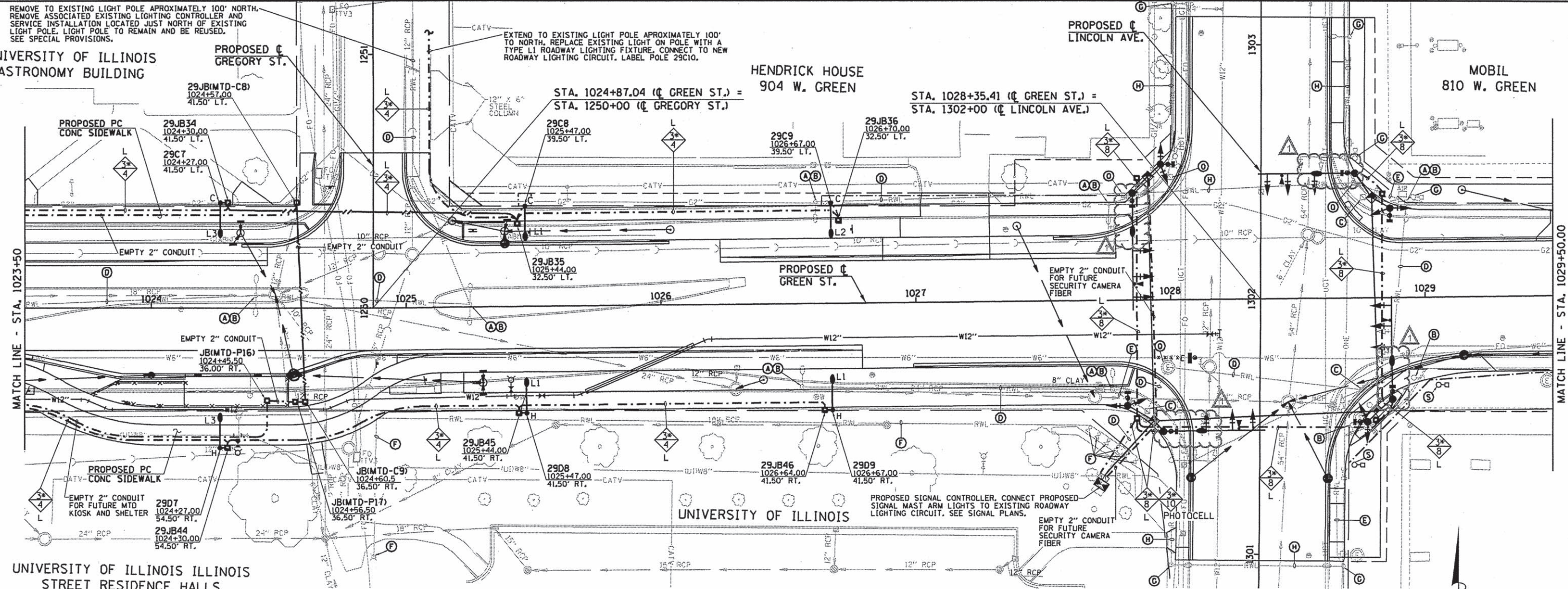

CIRCUIT DESIGNATION SCHEME

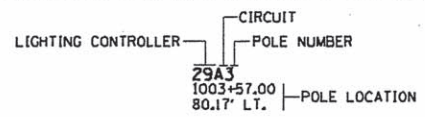

NOTE: THE CONTRACTOR SHALL PROVIDE A PERMANENT STICKER INSIDE HAND HOLE OF EACH LIGHT POLE INDICATING THE LIGHTING CONTROLLER, CIRCUIT AND POLE NUMBER.

CONDUCTOR SYMBOL SCHEME

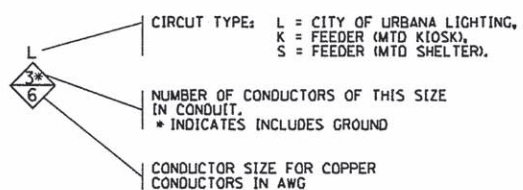

FIBER SINGLE MODE/MULTI-MODE FIBER OPTIC CABLE (SEE SPECIAL PROVISIONS)

JUNCTION BOX DESIGNATION SCHEME

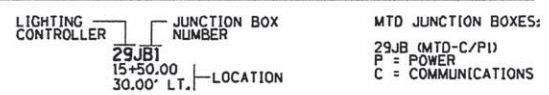

ROADWAY LIGHTING LEGEND

EXISTING	PROPOSED	DESCRIPTION
(Symbol)	(Symbol)	ROADWAY LED LUMINAIRE ("L" INDICATES LUMINAIRE TYPE, SEE SPECIAL PROVISIONS FOR DESCRIPTION OF LUMINAIRE TYPE). LUMINAIRE MOUNTED ON 10' DAVIT ARM MOUNTED ON 30' ALUMINUM LIGHT POLE MOUNTED ON CONCRETE FOUNDATION. "H" INDICATES HELIX FOUNDATION, "C" INDICATES CONCRETE FOUNDATION.
(Symbol)	(Symbol)	PEDESTRIAN LED LUMINAIRE. LUMINAIRE MOUNTED ON A DIRECTLY IMBEDDED 13' PRE-STRESSED CONCRETE LIGHT POLE. LUMINAIRE SHALL BE CONNECTED TO U OF I FACILITIES AND WILL BE MAINTAINED BY THE U OF I.
(Symbol)	(Symbol)	TWO (2) ROADWAY LED LUMINAIRES ("L" INDICATES LUMINAIRE TYPE, SEE SPECIAL PROVISIONS FOR DESCRIPTION OF LUMINAIRE TYPE). LUMINAIRES MOUNTED ON TWIN 10' DAVIT ARMS MOUNTED ON 30' ALUMINUM LIGHT POLE MOUNTED ON CONCRETE TYPE FOUNDATION.
(Symbol)	(Symbol)	ROADWAY LED LUMINAIRE (SEE SPECIAL PROVISIONS FOR DESCRIPTION OF LUMINAIRE TYPE). LUMINAIRE MOUNTED ON 15' ALUMINUM TRUSS ARM MOUNTED ON 35' TRAFFIC SIGNAL MAST ARM POLE. TRUSS ARM, POLE AND FOUNDATION TO BE PROVIDED AND INSTALLED AS PART OF THE TRAFFIC SIGNAL INSTALLATION. COORDINATE LUMINAIRE INSTALLATION WITH POLE AND SIGNAL INSTALLATION.
(Symbol)	(Symbol)	ROADWAY LIGHTING UNIT WITH LUMINAIRE AND POLE
(Symbol)	(Symbol)	PORTLAND CEMENT CONCRETE HANDHOLE
(Symbol)	(Symbol)	PROPOSED LIGHTING CONTROLLER (* AS NOTED)
(Symbol)	(Symbol)	COMPOSITE TYPE JUNCTION BOX, SPECIAL (12"W x 12"L x 12"D)
(Symbol)	(Symbol)	GULFBOX JUNCTION, COMPOSITE CONCRETE (13"W x 24"L x 12"D)
(Symbol)	(Symbol)	2" PVC CONDUIT (SCHEDULE 80), AUGURED
(Symbol)	(Symbol)	2" PVC CONDUIT (SCHEDULE 40), TRENCHED
(Symbol)	(Symbol)	UNDERGROUND CONDUIT
(Symbol)	(Symbol)	OVERHEAD ELECTRICAL CONDUCTORS
(Symbol)	(Symbol)	ROADWAY LIGHTING CONDUIT/CONDUCTORS

KEYED NOTES (THIS SHEET)

- (A) EXISTING LIGHTING UNIT (POLE AND LUMINAIRE) TO BE REMOVED COMPLETE.
- (B) EXISTING CONCRETE FOUNDATION TO BE REMOVED COMPLETE.
- (C) EXISTING HANDHOLE TO BE REMOVED COMPLETE.
- (D) EXISTING CONDUIT AND CONDUCTORS TO BE CUT OFF BELOW GRADE AND ABANDONED IN PLACE.
- (E) REMOVE EXISTING CONDUCTORS BACK TO NEAREST JUNCTION BOX OR LIGHTING UNIT TO REMAIN. CUT OFF CONDUIT BELOW GRADE AND ABANDON IN PLACE.
- (F) UNIVERSITY OF ILLINOIS EXISTING LIGHTING EQUIPMENT AND SYSTEM TO REMAIN AS PRESENTLY INSTALLED.
- (G) EXISTING LIGHTING UNIT (POLE AND LUMINAIRE) TO REMAIN.
- (H) EXISTING CONDUIT AND CONDUCTORS TO REMAIN.
- (O) EXISTING JUNCTION BOX TO BE ADJUSTED AND REMAIN IN SERVICE.
- (S) RELOCATE EXISTING LIGHTING UNIT. PROVIDE NEW CONCRETE FOUNDATION TO MATCH EXISTING CONCRETE FOUNDATION. EXTEND ROADWAY LIGHTING CIRCUIT (CONDUIT AND WIRING) TO NEW LOCATION TO MAINTAIN SERVICE TO RELOCATED LIGHTING UNIT. NEW LOCATION TO BE VERIFIED BY ENGINEER IN THE FIELD.

(I) (J) (K) (L) (M) (N) (P) (R) (T) NOT USED

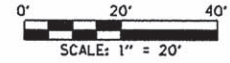

FILE NAME = p:\c0010720_mcore\Plans\sheets\Project1\P1-sht-lighting.dgn
 PLOT DATE = 7/18/2016 1:42:38 PM

DESIGNED - M.L.S. REVISION 7/18/2016
 DRAWN - L.F.D. REVISION -
 CHECKED - L.M.Z. REVISION -
 DATE - MARCH 2016 REVISION -

STATE OF ILLINOIS DEPARTMENT OF TRANSPORTATION

ROADWAY LIGHTING PLANS - GREEN STREET

SCALE: 1"=20' SHEET NO. 120 OF 239 SHEETS STA. 1023+50 TO STA. 1029+50

F.A.U. RTE.	SECTION	COUNTY	TOTAL SHEETS	SHEET NO.
	15-00304-01-PV	CHAMPAIGN	239	120
MCORE PROJECT 1		CONTRACT NO. 91539		
JOB NO. C-95-305-16 ILLINOIS FED. AID PROJECT TIG-5181057				