

F.A.P. RTE.	SECTION	COUNTY	TOTAL SHEETS	SHEET NO.
VARIOUS	2009-106 I	COOK & WILL	24	1
FED. ROAD DIST. NO. 1	ILLINOIS	CONTRACT NO. 60J05		

STATE OF ILLINOIS
DEPARTMENT OF TRANSPORTATION
DIVISION OF HIGHWAYS

**PROPOSED
HIGHWAY PLANS**

VARIOUS ROUTES
SECTION 2009-106 I
VARIOUS LOCATIONS
RIPRAP, SCOUR COUNTERMEASURES
COOK AND WILL COUNTIES
C-91-158-10

FOR INDEX OF SHEETS, SEE SHEET NO. 2

IMPROVEMENT LOCATED IN THE

VILLAGE OF MOUNT PROSPECT
CITY OF DES PLAINES
VILLAGE OF BEECHER
VILLAGE OF PARK FOREST
VILLAGE OF NILES
VILLAGE OF FRANKFORT

D-91-158-10

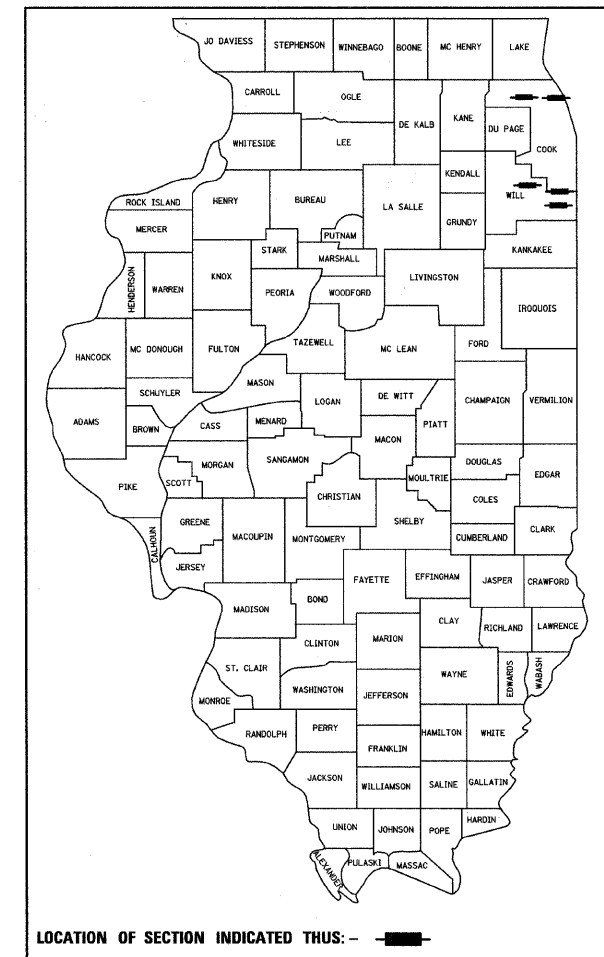

LOCATION OF SECTION INDICATED THUS: —

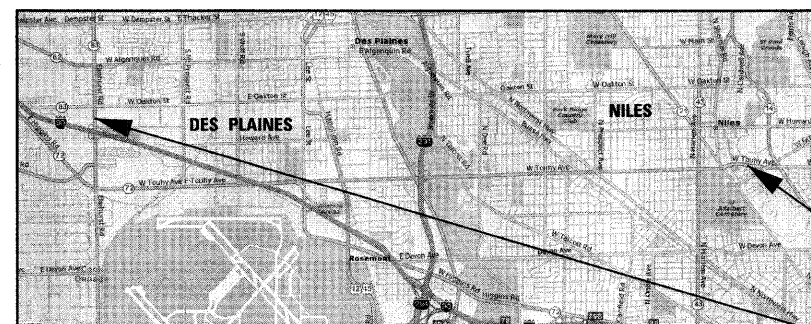

LOCATION 4: S.N. 016-0363, TOUHY AVENUE
OVER N. BR. CHICAGO RIVER

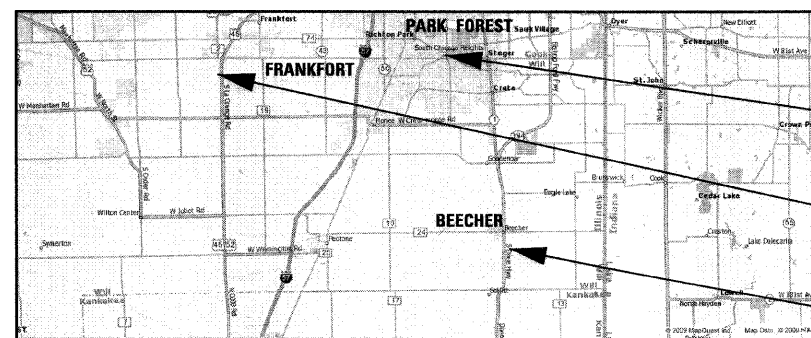

LOCATION 1: S.N. 016-0677, IL 83
OVER HIGGINS CREEK

LOCATION 3: S.N. 016-2415, WESTERN AVENUE
OVER THORN CREEK

LOCATION 5: S.N. 099-0119, US 45
OVER PRAIRIE CREEK

LOCATION 2: S.N. 099-0079, IL 1
OVER TRIM CREEK

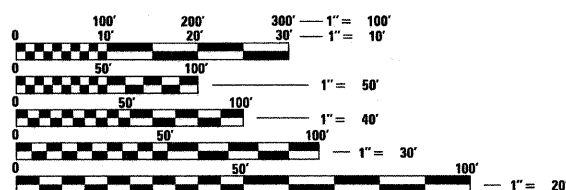

FULL SIZE PLANS HAVE BEEN PREPARED USING STANDARD
ENGINEERING SCALES. REDUCED SIZED PLANS WILL NOT
CONFORM TO STANDARD SCALES. IN MAKING MEASUREMENTS
ON REDUCED PLANS, THE ABOVE SCALES MAY BE USED.

J.U.L.I.E.
JOINT UTILITY LOCATING INFORMATION FOR EXCAVATORS
1-800-892-0123
OR 811

DISTRICT ONE - PLAN PREP ENGINEER: KEN ENG (847) 705-4247

CONTRACT NO. 60J05



Birinder S. Sachdeva 5/10/10
BIRINDER S. SACHDEVA, P.E. DATE
EXPIRES: 11-30-2011



CHRISTIAN-ROGE & ASSOCIATES, INC.
ENGINEERS - PLANNERS - SURVEYORS
211 W. WACKER DRIVE CHICAGO, IL 0 0
TELEPHONE 312-2-2023

PRINTED BY THE AUTHORITY
OF THE STATE OF ILLINOIS

INDEX OF SHEETS

1	COVER SHEET
2	INDEX OF SHEETS, LIST OF STATE STANDARDS AND GENERAL NOTES SCOUR COUNTERMEASURES - VARIOUS LOCATIONS
3	SUMMARY OF QUANTITIES SCOUR COUNTERMEASURES - VARIOUS LOCATIONS
4	LOCATION MAPS
5 - 6	SITE PLAN & EROSION AND SEDIMENT CONTROL - ELMHURST ROAD (IL 83) OVER HIGGINS CREEK
7 - 8	SITE PLAN & EROSION AND SEDIMENT CONTROL - IL 1 OVER TRIM CREEK
9 - 10	SITE PLAN & EROSION AND SEDIMENT CONTROL - WESTERN AVENUE OVER THORN CREEK
11 - 12	SITE PLAN & EROSION AND SEDIMENT CONTROL - TOUHY AVENUE OVER N. BR. CHICAGO RIVER
13 - 14	SITE PLAN & EROSION AND SEDIMENT CONTROL - US 45 OVER PRAIRIE CREEK
15 - 19	CROSS SECTIONS - VARIOUS LOCATIONS
20	ARTERIAL ROAD INFORMATION SIGN
21	TRAFFIC CONTROL & PROTECTION FOR SIDEROADS, INTERSECTIONS AND DRIVEWAYS
22 - 24	DEWATERING SYSTEM DETAILS SCOUR COUNTERMEASURES - VARIOUS LOCATIONS

LIST OF STATE STANDARDS

STANDARD NO.	DESCRIPTION
701426 - 03	LANE CLOSURE, MULTILANE INTERMITTENT OR MOVING OPERATIONS ONLY, FOR SPEEDS ≥ 45 MPH
701501 - 05	URBAN LANE CLOSURE, 2L, 2W, UNDIVIDED
701606 - 06	URBAN LANE CLOSURE, MULTILANE, 2W WITH MOUNTABLE MEDIAN
701901 - 01	TRAFFIC CONTROL DEVICES

NOTE: NIGHT TIME LANE CLSURES WILL NOT BE REQUIRED FOR THIS PROJECT.

GENERAL NOTES

1. BEFORE STARTING ANY EXCAVATION, THE CONTRACTOR SHALL CALL "J.U.L.I.E." (JOINT UTILITY LOCATING INFORMATION FOR EXCAVATORS) AT (800) 892-0123 OR 811 FOR FIELD LOCATIONS OF BURIED ELECTRIC, TELEPHONE & GAS FACILITIES. (48 HOURS NOTIFICATION IS REQUIRED.)
2. THE CONTRACTOR WILL NOT BE ALLOWED TO SET UP A YARD OF FIELD OFFICE ON STATE PROPERTY WITHOUT WRITTEN PERMISSION FROM THE DEPARTMENT.
3. EXCAVATION INTO THE STREAM BED FOR STONE RIPRAP INSTALLATION SHALL NOT BE DEEPER THAN THE BOTTOM OF THE FOOTING ON THE PIER OR ABUTMENT TO BE PROTECTED.
4. DEBRIS REMOVAL, IF ENCOUNTERED, SHALL BE INCLUDED IN THE COST OF THE STONE RIPRAP.
5. IT SHALL BE THE CONTRACTOR'S RESPONSIBILITY TO VERIFY ALL DIMENSIONS & CONDITIONS EXISTING IN THE FIELD PRIOR TO CONSTRUCTION ORDERING OF MATERIAL.
6. THE CONTRACTOR SHALL CONTACT THE DISTRICT ONE ARTERIAL TRAFFIC CONTROL SUPERVISOR AT (847) 705-4470 A MINIMUM OF 72 HOURS IN ADVANCE OF BEGINNING WORK.
7. ALL AREAS (INCLUDING WETLAND AREAS) OUTSIDE THE LIMITS OF RIPRAP PLACEMENT AND/OR EXCAVATION WHICH ARE DISTURBED (WHERE EXISTING SOIL CONTOURS HAVE BEEN ALTERED AND/OR EXISTING VEGETATION HAD BEEN DESTROYED BY THE CONTRACTOR'S OPERATIONS) SHALL BE RESTORED BY REGRADING TO THE ORIGINAL CONTOURS AND/OR SEEDING WITH SEEDING, CLASSES 4 AND 5, AND MULCHING WITH EROSION CONTROL BLANKET. PLACE TEMPORARY SEEDING AND TEMPORARY EROSIONS CONTROL BLANKET AS NEEDED. THIS WORK WILL NOT BE PAID FOR SEPARATELY, BUT THE COSTS SHALL BE CONSIDERED INCLUDED IN THE CONTRACT UNIT PRICES FOR THE CONSTRUCTION ITEMS INVOLVED, AND NO ADDITIONAL COMPENSATION WILL BE ALLOWED.
8. THE CONTRACTOR IS ADVISED TO AVOID OR MINIMIZE ANY DISTURBANCE TO EXISTING VEGETATION OUTSIDE THE LIMITS OF RIPRAP PLACEMENT AND CHANNEL EXCAVATION.
9. THE CONTRACTOR MUST PROTECT PAVEMENT WHEN DUMPING RIPRAP ONTO PAVEMENT AND WILL BE RESPONSIBLE FOR RESTORING PAVEMENT MARKINGS AND REFLECTORS.
10. ANY GUARDRAIL OR SIGNS DAMAGED BY THE CONTRACTOR'S OPERATIONS SHALL BE REPLACED IN KIND AT THE CONTRACTOR'S EXPENSE.
11. THE CONTRACTOR SHALL BE REQUIRED TO PROVIDE ACCESS TO ABUTTING PROPERTY AT ALL TIMES DURING THE CONSTRUCTION OF THIS PROJECT.
12. DO NOT SCALE PLANS FOR CONSTRUCTION DIMENSIONS.
13. THE CONTRACTOR SHALL SUBMIT DEWATERING AND SEDIMENT CONTROL PLANS FOR EACH SITE.
14. THE CONTRACTOR SHALL CONTACT THE ENGINEER AFTER DEWATERING FOR FINAL RIPRAP OR SLOPE MATTRESS PLACEMENT.

FILE NAME = D160J05-ah-gennote.dgn
PLOT DATE = 5/10/2010



CHRISTIAN-ROGE & ASSOCIATES, INC.
ENGINEERS-PLANNERS-SURVEYORS
211 WEST WACKER DRIVE
CHICAGO, ILLINOIS 60606
PHONE: (312)372-2023 FAX: (312)372-5274

DESIGNED - G.F.L.	REVISED - APRIL 28, 2010
DRAWN - K.R.K.	REVISED -
CHECKED - M.P.	REVISED -
DATE - DECEMBER 2009	REVISED -

**STATE OF ILLINOIS
DEPARTMENT OF TRANSPORTATION**

**INDEX OF SHEETS, LIST OF STATE STANDARDS AND GENERAL NOTES
SCOUR COUNTERMEASURES - VARIOUS LOCATIONS**

SCALE: NONE SHEET NO. 1 OF 1 SHEETS STA. TO STA.

F.A.P. RTE.	SECTION	COUNTY	TOTAL SHEETS	SHEET NO.
VAR.	2009-106 I	COOK/WILL	24	2
CONTRACT NO. 60J05				
FED. ROAD DIST. NO. 1 ILLINOIS FED. AID PROJECT				

SUMMARY OF QUANTITIES			URBAN 100% STATE	SFTY-2A						
CODE NO	ITEM	UNIT	TOTAL QUANTITIES	LOCATION 1 IL 83 <i>COOK COUNTY</i>	LOCATION 2 IL 1 <i>WILL COUNTY</i>	LOCATION 3 WESTERN <i>COOK COUNTY</i>	LOCATION 4 TOUHY <i>COOK COUNTY</i>	LOCATION 5 US 45 <i>WILL COUNTY</i>		
20300100	CHANNEL EXCAVATION	CU YD	55			55				
28100107	STONE RIPRAP, CLASS A4	SQ YD	1,124		413	414		297		
28100109	STONE RIPRAP, CLASS A5	SQ YD	232	232						
28100111	STONE RIPRAP, CLASS A6	SQ YD	374				374			
67000400	ENGINEER'S FIELD OFFICE, TYPE A	CAL MO	5	1	1	1	1	1		
67100100	MOBILIZATION	L SUM	1	0.2	0.2	0.2	0.2	0.2		
70102620	TRAFFIC CONTROL AND PROTECTION, STANDARD 701501	L SUM	1		0.5			0.5		
70102625	TRAFFIC CONTROL AND PROTECTION, STANDARD 701606	L SUM	1	0.33		0.34	0.33			
X0301852	DEWATERING STRUCTURE NO. 1	EACH	1	1						
X0301853	DEWATERING STRUCTURE NO. 2	EACH	1		1					
X0301854	DEWATERING STRUCTURE NO. 3	EACH	1			1				
X0301855	DEWATERING STRUCTURE NO. 4	EACH	1				1			
X0301856	DEWATERING STRUCTURE NO. 5	EACH	1					1		
20030850	TEMPORARY INFORMATION SIGNING	SQ FT	257	51.4	51.4	51.4	51.4	51.4		

FILE NAME = D:\62\05-sht-500.dgn
PLOT DATE = 5/18/2010



CHRISTIAN-ROGE & ASSOCIATES, INC.
ENGINEERS-PLANNERS-SURVEYORS
211 WEST WACKER DRIVE
CHICAGO, ILLINOIS 60606
PHONE: (312)372-2023 FAX: (312)372-5274

DESIGNED - K.R.K.
DRAWN - J.V.
CHECKED - G.F.L.
DATE - DECEMBER, 2009

REVISED - APRIL 28, 2010
REVISED -
REVISED -
REVISED -

**STATE OF ILLINOIS
DEPARTMENT OF TRANSPORTATION**

**SUMMARY OF QUANTITIES
SCOUR COUNTERMEASURES - VARIOUS LOCATIONS**

SCALE: NONE SHEET NO. 1 OF 1 SHEETS STA. TO STA.

F.A.P. RTE.	SECTION	COUNTY	TOTAL SHEETS	SHEET NO.
VAR.	2009-106 I	COOK/WILL	24	3
FED. ROAD DIST. NO. 1 ILLINOIS FED. AID PROJECT			CONTRACT NO. 60J05	



LOCATION 1 - COOK COUNTY
STRUCTURE NUMBER: 016-0677
IL 83 OVER HIGGINS CREEK
LOCATED IN ELK GROVE TOWNSHIP

TRAFFIC DATA
SPEED LIMIT = 45 MPH
2007 ADT = 37,400

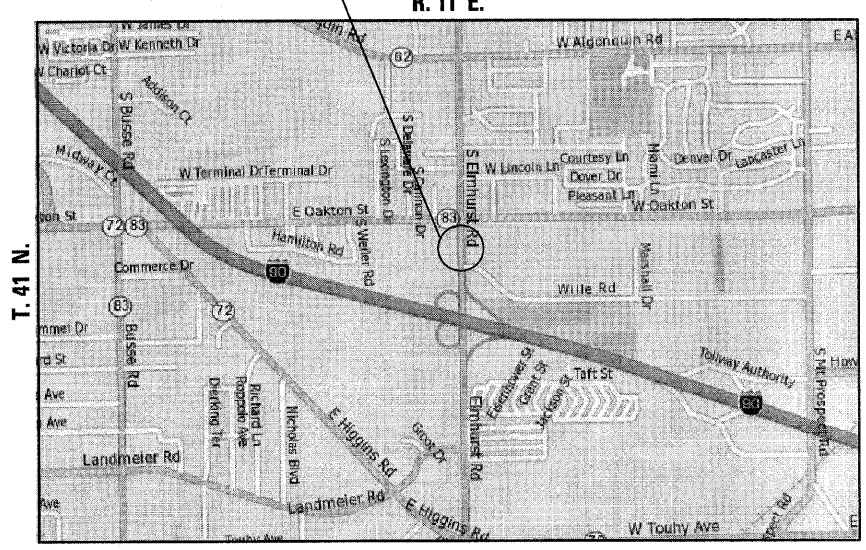

LOCATION 2 - WILL COUNTY
STRUCTURE NUMBER: 099-0079
IL 1 OVER TRIM CREEK
LOCATED IN WASHINGTON TOWNSHIP

TRAFFIC DATA
SPEED LIMIT = 40 MPH
2007 ADT = 5,800

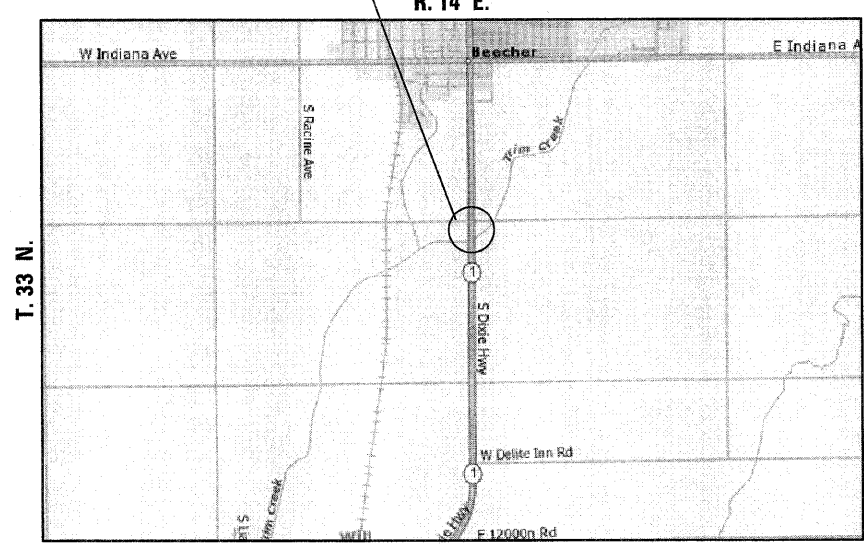

LOCATION 3 - COOK COUNTY
STRUCTURE NUMBER: 016-2415
WESTERN AVENUE OVER THORN CREEK
LOCATED IN RICH & BLOOM TOWNSHIP

TRAFFIC DATA
SPEED LIMIT = 40 MPH
2007 ADT = 22,600

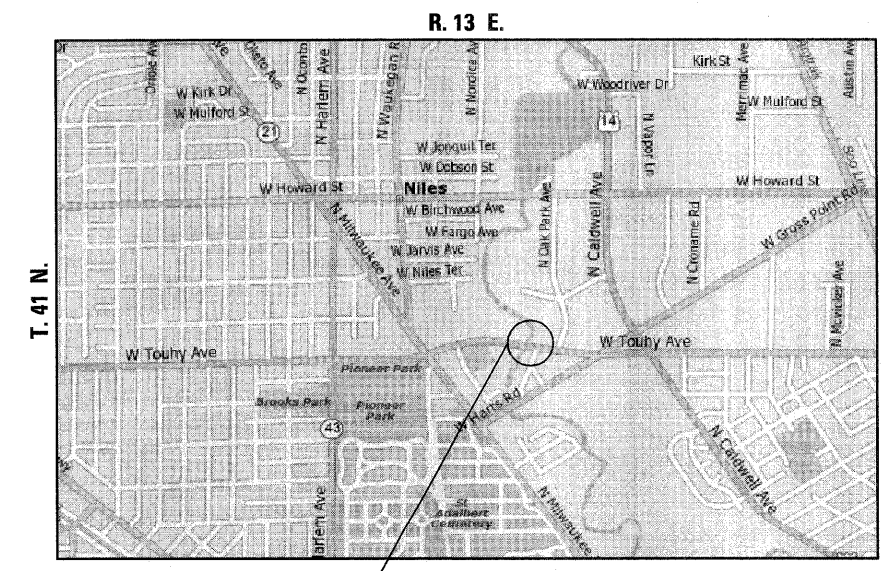
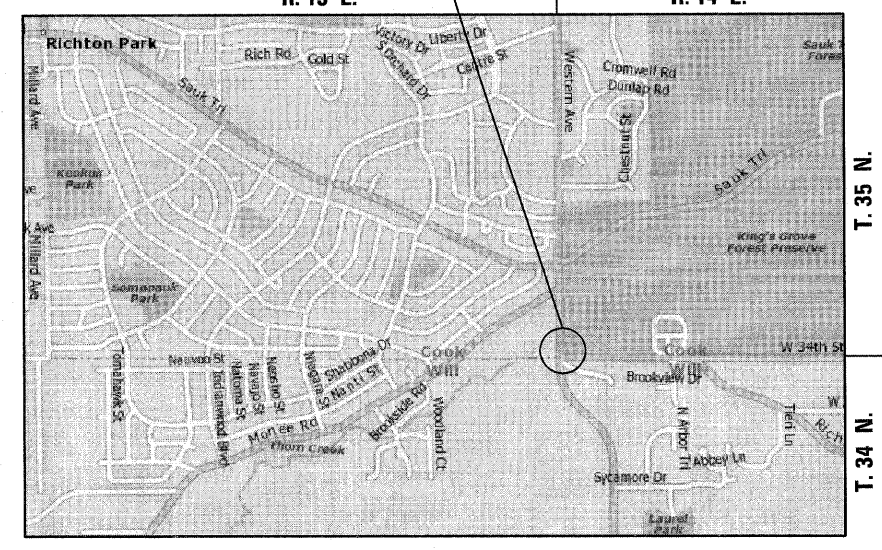

LOCATION 4 - COOK COUNTY
STRUCTURE NUMBER: 016-0363
TOUHY AVENUE OVER N. BR. CHICAGO RIVER
LOCATED IN NILES TOWNSHIP

TRAFFIC DATA
SPEED LIMIT = 35 MPH
2007 ADT = 25,800

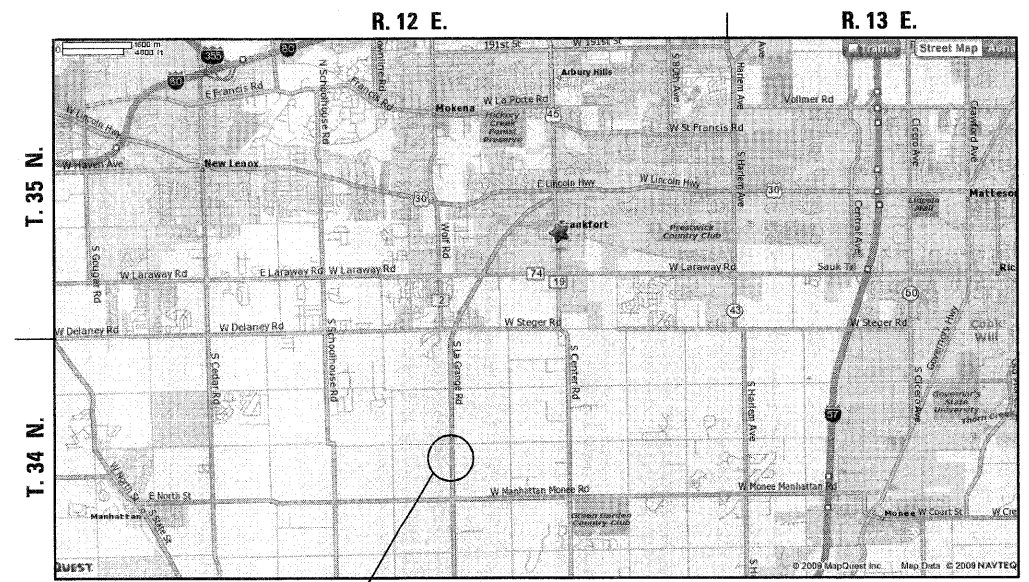

LOCATION 5 - WILL COUNTY
STRUCTURE NUMBER: 099-0119
US 45 OVER PRAIRIE CREEK
LOCATED IN GREEN GARDEN TOWNSHIP

TRAFFIC DATA
SPEED LIMIT = 50 MPH
2007 ADT = 5,900

FILE NAME = D168J05-ght-location.dgn
 PLOT DATE = 5/7/2010



DESIGNED - G.F.L.	REVISED - APRIL 28, 2010
DRAWN - K.R.K.	REVISED -
CHECKED - M.P.	REVISED -
DATE - DECEMBER 2009	REVISED -

STATE OF ILLINOIS
DEPARTMENT OF TRANSPORTATION

LOCATION MAPS
SCOUR COUNTERMEASURES - VARIOUS LOCATIONS

SCALE: NONE SHEET NO. 1 OF 1 SHEETS STA. TO STA.

F.A.P. RTE.	SECTION	COUNTY	TOTAL SHEETS	SHEET NO.
VAR.	2009-106 I	COOK/WILL	24	4
FED. ROAD DIST. NO. 1 (ILLINOIS) FED. AID PROJECT			CONTRACT NO. 60J05	

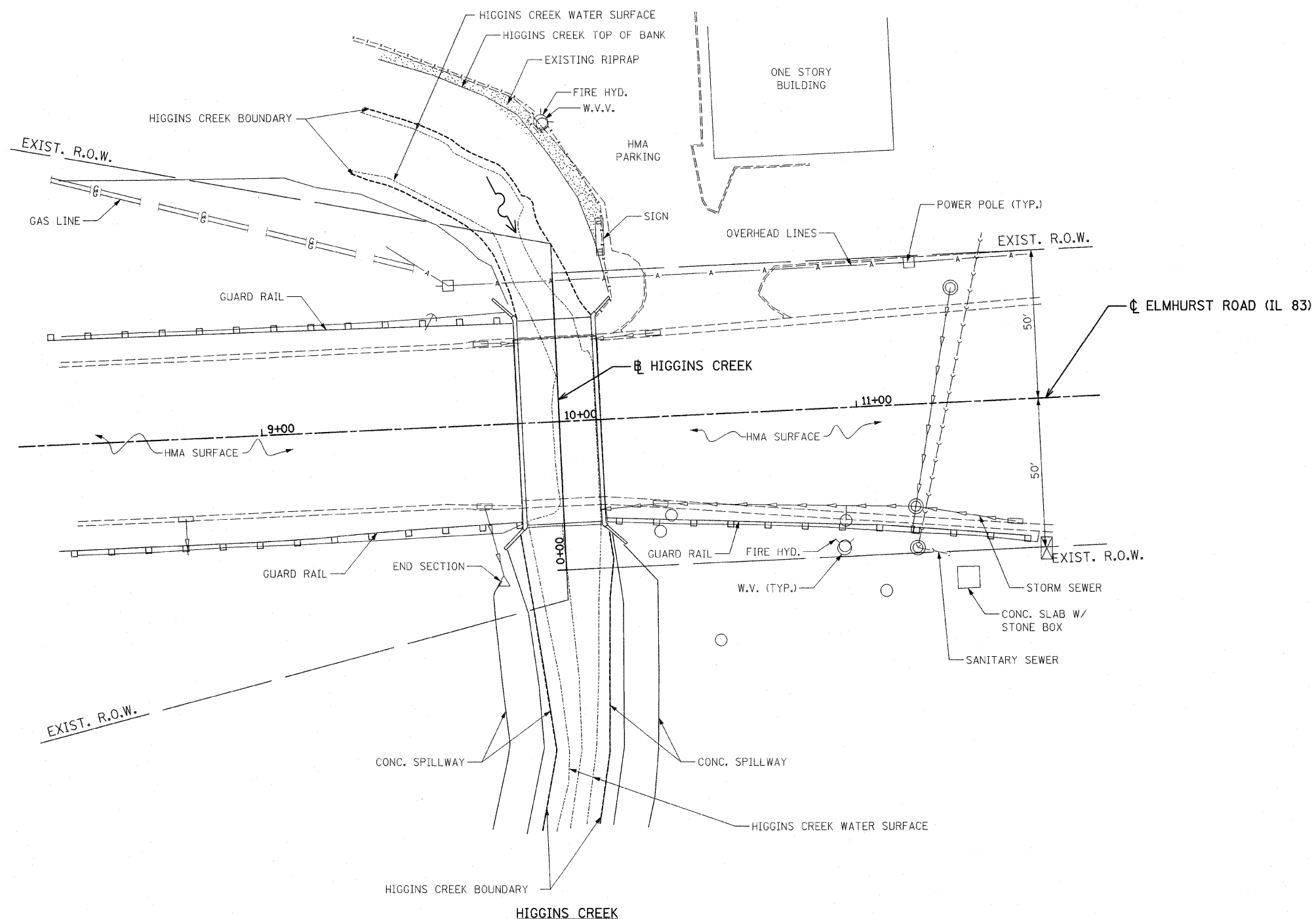

FILE NAME = D:\68\25-1-siteplan.dgn
PLOT DATE = 5/7/2010

CHRISTIAN-ROGE & ASSOCIATES, INC.
ENGINEERS-PLANNERS-SURVEYORS
211 WEST WACKER DRIVE
CHICAGO, ILLINOIS 60606
PHONE: (312)372-2023 FAX: (312)372-5274

DESIGNED - G.F.L.	REVISED - APRIL 28, 2010
DRAWN - J.V./K.R.K.	REVISED -
CHECKED - E.J.M.	REVISED -
DATE - DECEMBER 2009	REVISED -

**STATE OF ILLINOIS
DEPARTMENT OF TRANSPORTATION**

**SITE PLAN
ELMHURST ROAD (IL 83) OVER HIGGINS CREEK**

SCALE: 1" = 20' SHEET NO. 1 OF 2 SHEETS STA. 9+00 TO STA. 11+00

F.A.P. RTE.	SECTION	COUNTY	TOTAL SHEETS	SHEET NO.
VAR.	2009-106 I	COOK/WILL	24	5
CONTRACT NO. 60J05				
FED. ROAD DIST. NO. 1 ILLINOIS FED. AID PROJECT				

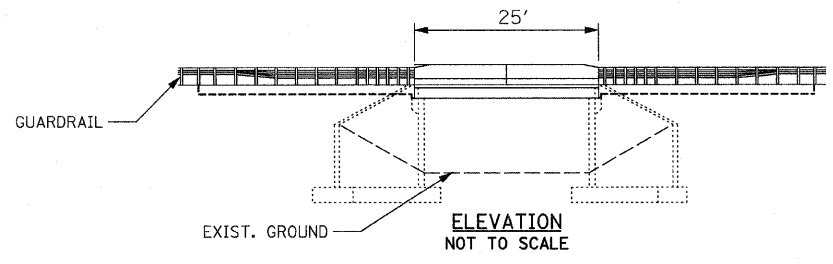
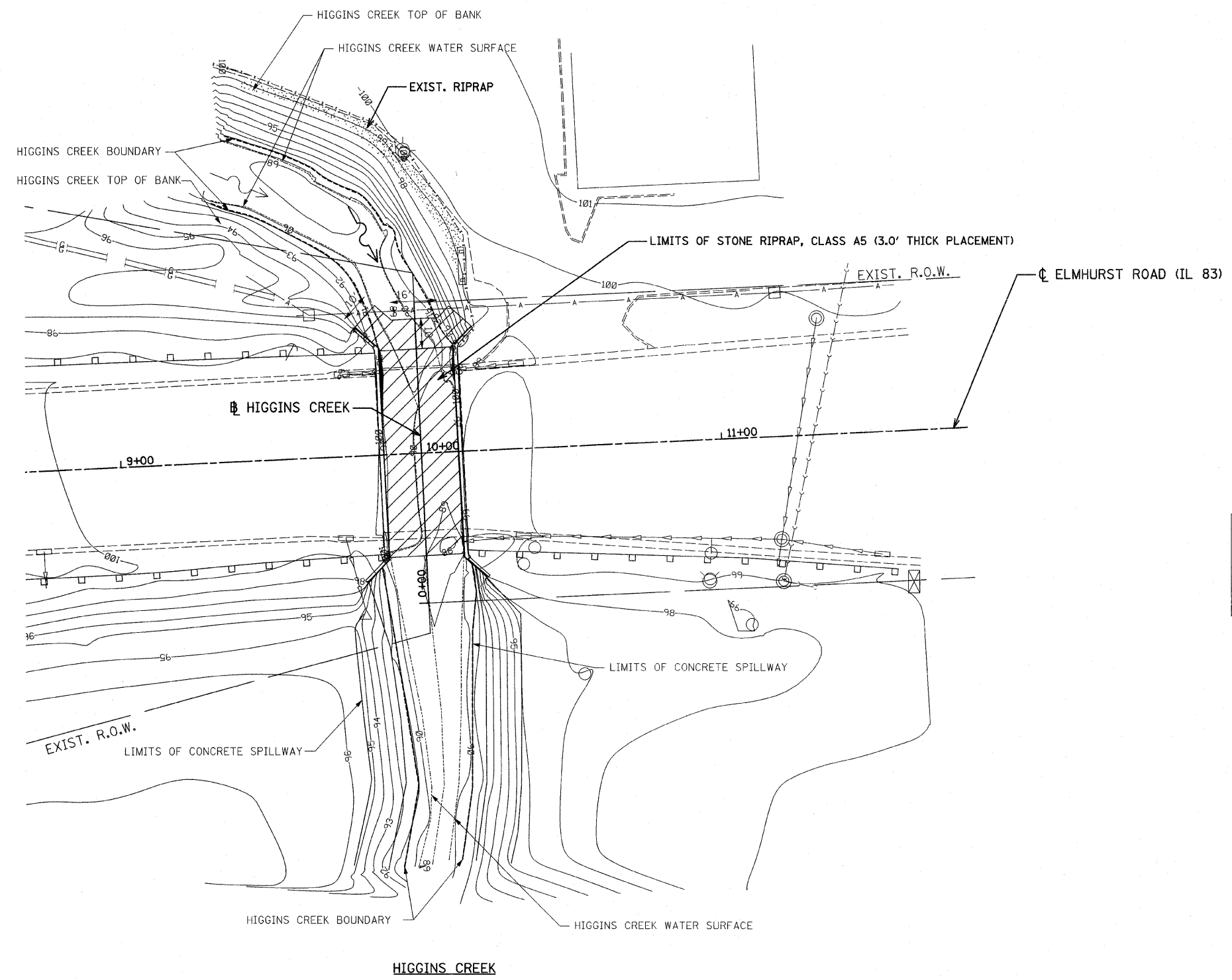

ACCESS TO THIS SITE IS LIMITED. THE CONTRACTOR SHALL ONLY ACCESS THIS SITE BY RAISING AND/OR LOWERING ALL EQUIPMENT AND MATERIAL OVER THE SIDES OF THE BRIDGE. THE CONTRACTOR WILL NOT BE ALLOWED OTHER ACCESS WITHOUT WRITTEN PERMISSION FROM THE ENGINEER. THIS WORK WILL NOT BE PAID FOR SEPARATELY, BUT SHALL BE CONSIDERED AS INCLUDED IN THE CONTRACT UNIT PRICES FOR THE CONSTRUCTION ITEMS INVOLVED AND NO ADDITIONAL COMPENSATION WILL BE ALLOWED.

LEGEND

 STONE RIPRAP, CLASS A5 (3.0' THICK)

BM 1: FOUND BRASS DISK S.E. CORNER OF BRIDGE ON BRIDGE WALK.
ELEV. = 100.00 (ASSUMED)

NOTE:
1. FOR CREEK CROSS SECTIONS SEE SHEET NO. 15.

FILE NAME = D168J05-1-sht-eros.dgn PLOT DATE = 5/10/2010	 CHRISTIAN-ROGE & ASSOCIATES, INC. ENGINEERS-PLANNERS-SURVEYORS 211 WEST WACKER DRIVE CHICAGO, ILLINOIS 60606 PHONE: (312)372-2023 FAX: (312)372-5274	DESIGNED - G.F.L.	REVISED - APRIL 28, 2010	STATE OF ILLINOIS DEPARTMENT OF TRANSPORTATION	EROSION AND SEDIMENT CONTROL PLAN ELMHURST ROAD (IL 83) OVER HIGGINS CREEK		F.A.P. RTE.	SECTION	COUNTY	TOTAL SHEETS	SHEET NO.
		DRAWN - J.V./K.R.K.	REVISED -		VAR.	2009-106 I	COOK/WILL	24	6		
CHECKED - E.J.M.	REVISED -				SCALE: 1" = 20' SHEET NO. 2 OF 2 SHEETS STA. 9+00 TO STA. 11+00		FED. ROAD DIST. NO. 1 ILLINOIS FED. AID PROJECT		CONTRACT NO. 60J05		
DATE - DECEMBER 2009	REVISED -										

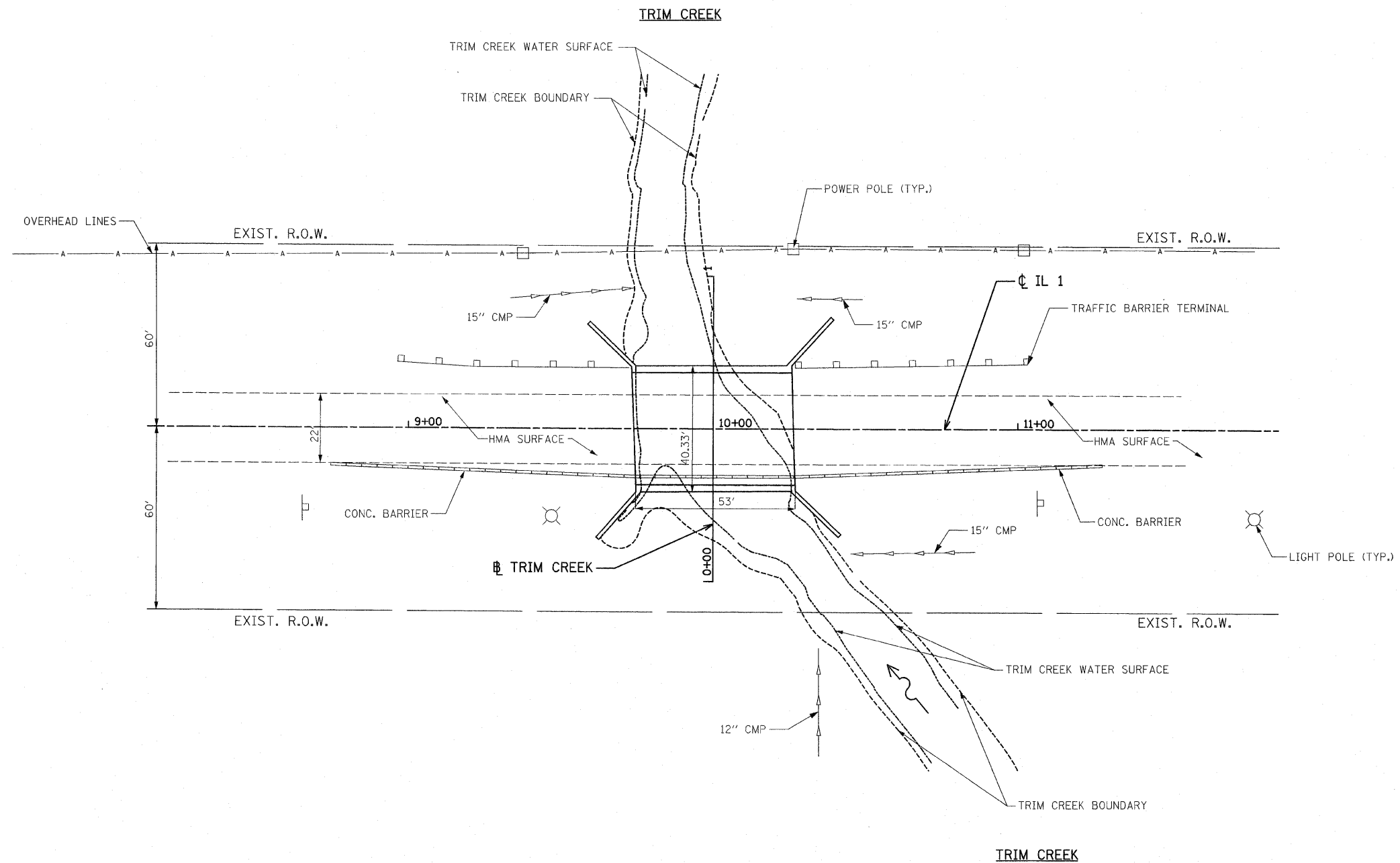

FILE NAME = 0168105-2-siteplan.dgn
 PLOT DATE = 5/10/2010

CHRISTIAN-ROGE & ASSOCIATES, INC.
 ENGINEERS-PLANNERS-SURVEYORS
 211 WEST WACKER DRIVE
 CHICAGO, ILLINOIS 60606
 PHONE: (312)372-2023 FAX: (312)372-5274

DESIGNED - G.F.L.	REVISED - APRIL 28, 2010
DRAWN - J.V./K.R.K.	REVISED -
CHECKED - E.J.M.	REVISED -
DATE - DECEMBER 2009	REVISED -

**STATE OF ILLINOIS
 DEPARTMENT OF TRANSPORTATION**

SITE PLAN IL 1 OVER TRIM CREEK	
SCALE: 1" = 20'	SHEET NO. 1 OF 2 SHEETS
STA. 9+00	TO STA. 11+00

F.A.P. RTE.	SECTION	COUNTY	TOTAL SHEETS	SHEET NO.
VAR.	2009-106 I	COOK/WILL	24	7
FED. ROAD DIST. NO. 1 ILLINOIS FED. AID PROJECT			CONTRACT NO. 60J05	

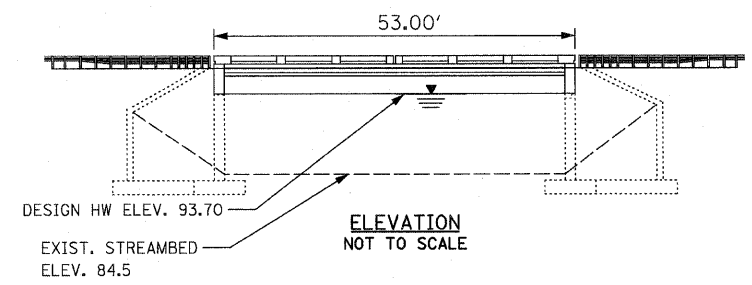
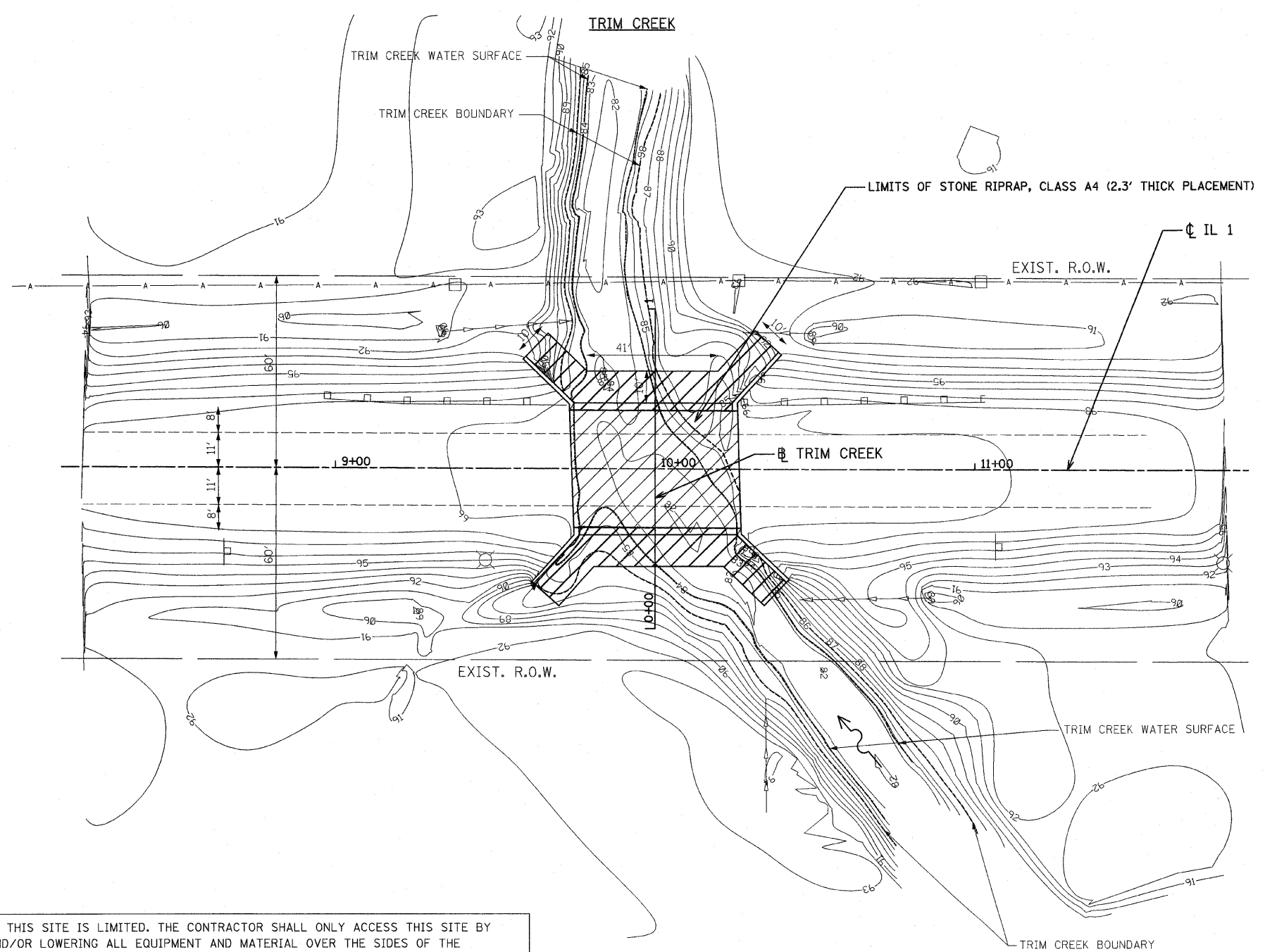

LEGEND

STONE RIPRAP, CLASS A4 (2.3' THICK)

BM 1: SQUARE CUT ON TOP OF N.W. WINGWALL (ASSUMED DATUM).
ELEV. = 99.85

NOTE:
1. FOR CREEK CROSS SECTIONS SEE SHEET NO. 16.

ACCESS TO THIS SITE IS LIMITED. THE CONTRACTOR SHALL ONLY ACCESS THIS SITE BY RAISING AND/OR LOWERING ALL EQUIPMENT AND MATERIAL OVER THE SIDES OF THE BRIDGE. THE CONTRACTOR WILL NOT BE ALLOWED OTHER ACCESS WITHOUT WRITTEN PERMISSION FROM THE ENGINEER. THIS WORK WILL NOT BE PAID FOR SEPARATELY, BUT SHALL BE CONSIDERED AS INCLUDED IN THE CONTRACT UNIT PRICES FOR THE CONSTRUCTION ITEMS INVOLVED AND NO ADDITIONAL COMPENSATION WILL BE ALLOWED.

FILE NAME = D162J05-2-shr-eros.dgn PLOT DATE = 5/10/2010	CHRISTIAN-ROGE & ASSOCIATES, INC. ENGINEERS-PLANNERS-SURVEYORS 211 WEST WACKER DRIVE CHICAGO, ILLINOIS 60606 PHONE: (312)372-2023 FAX: (312)372-5274	DESIGNED - G.F.L.	REVISED - APRIL 28, 2010	STATE OF ILLINOIS DEPARTMENT OF TRANSPORTATION	EROSION AND SEDIMENT CONTROL PLAN IL 1 OVER TRIM CREEK			F.A.P. RTE.	SECTION	COUNTY	TOTAL SHEETS	SHEET NO.
		DRAWN - J.V./K.R.K.	REVISED -		SCALE: 1" = 20'	SHEET NO. 2 OF 2 SHEETS	STA. 9+00 TO STA. 11+00	VAR.	2009-106 I	COOK/WILL	24	8
CHECKED - E.J.M.	REVISED -				CONTRACT NO. 60J05 FED. ROAD DIST. NO. 1 ILLINOIS FED. AID PROJECT							
DATE - DECEMBER 2009	REVISED -											

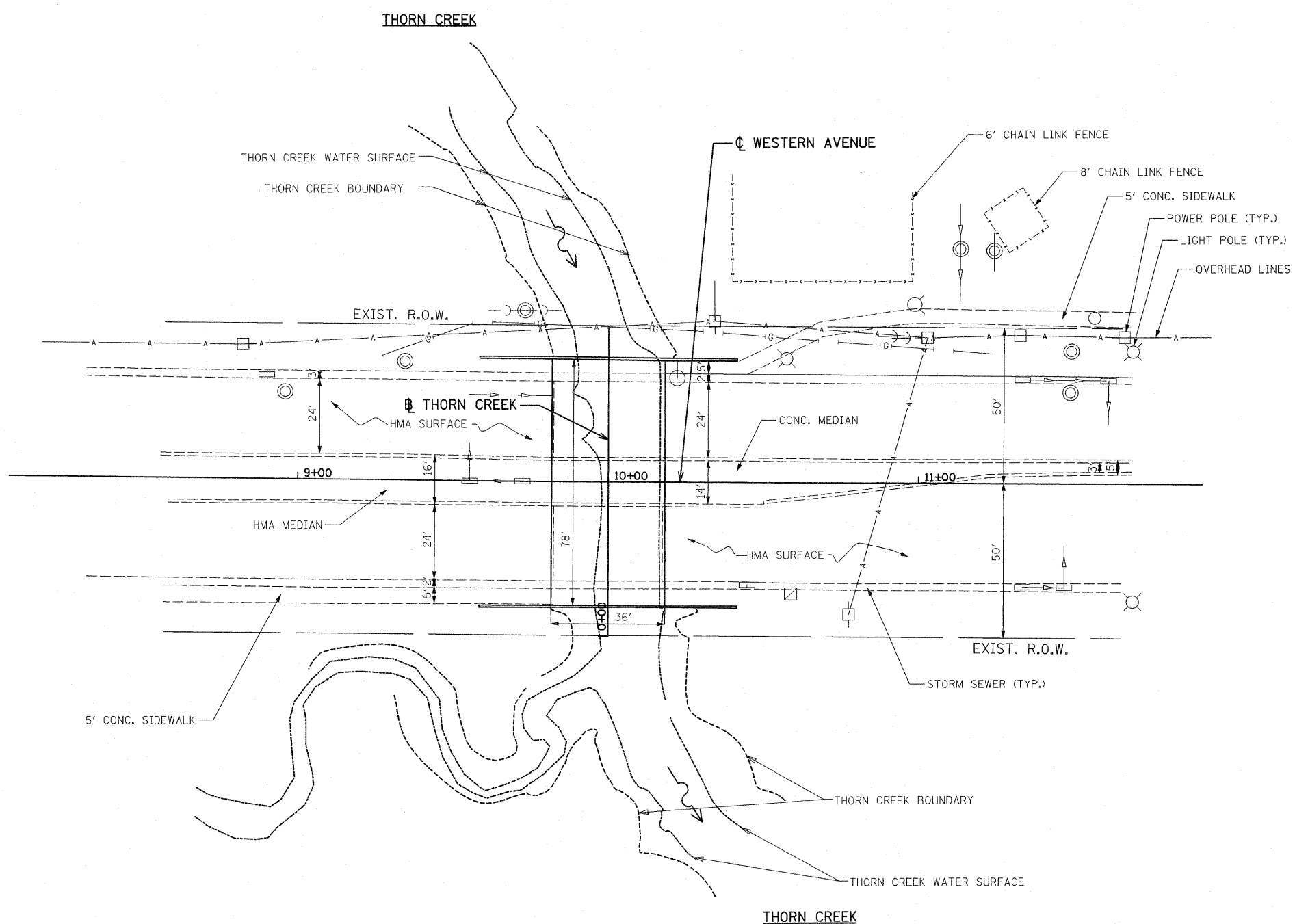

FILE NAME = D:\60J05-3-siteplan.dgn
 PLOT DATE = 5/18/2010

CHRISTIAN-ROGE & ASSOCIATES, INC.
 ENGINEERS-PLANNERS-SURVEYORS
 211 WEST WACKER DRIVE
 CHICAGO, ILLINOIS 60606
 PHONE: (312)372-2023 FAX: (312)372-5274

DESIGNED - G.F.L.	REVISED - APRIL 28, 2010
DRAWN - J.V./K.R.K.	REVISED -
CHECKED - E.J.M.	REVISED -
DATE - DECEMBER 2009	REVISED -



**STATE OF ILLINOIS
 DEPARTMENT OF TRANSPORTATION**

**SITE PLAN
 WESTERN AVENUE OVER THORN CREEK**
 SCALE: 1" = 20' SHEET NO. 1 OF 2 SHEETS STA. 9+00 TO STA. 11+00

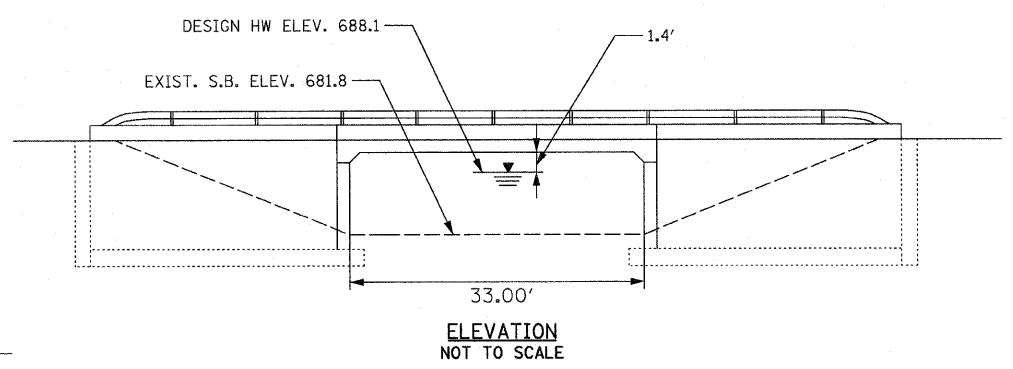
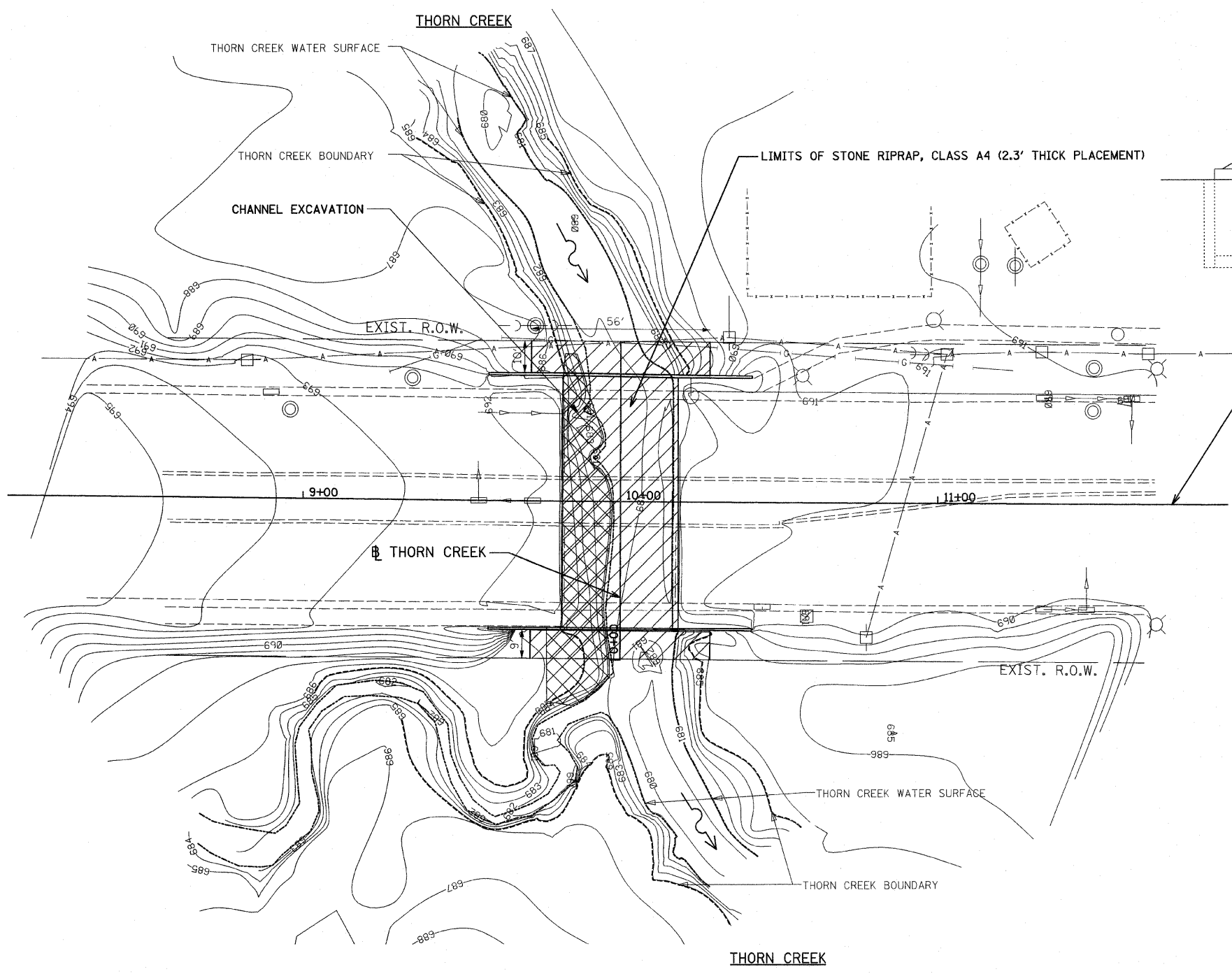
F.A.P. RTE.	SECTION	COUNTY	TOTAL SHEETS	SHEET NO.
VAR.	2009-106 I	COOK/WILL	24	9
FED. ROAD DIST. NO. 1 [ILLINOIS] FED. AID PROJECT			CONTRACT NO. 60J05	

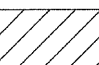

ACCESS TO THIS SITE IS LIMITED. THE CONTRACTOR SHALL ONLY ACCESS THIS SITE BY RAISING AND/OR LOWERING ALL EQUIPMENT AND MATERIAL OVER THE SIDES OF THE BRIDGE. THE CONTRACTOR WILL NOT BE ALLOWED OTHER ACCESS WITHOUT WRITTEN PERMISSION FROM THE ENGINEER. THIS WORK WILL NOT BE PAID FOR SEPARATELY, BUT SHALL BE CONSIDERED AS INCLUDED IN THE CONTRACT UNIT PRICES FOR THE CONSTRUCTION ITEMS INVOLVED AND NO ADDITIONAL COMPENSATION WILL BE ALLOWED.

- LEGEND**
-  STONE RIPRAP, CLASS A4 (2.3' THICK)
 -  CHANNEL EXCAVATION

- BM 1: SQUARE CUT ON N. W. CORNER OF N. PROFILE GRADE
ELEV. = 691.79
- BM 2: SQUARE CUT ON S. W. CORNER OF S. PROFILE GRADE
ELEV. = 692.18

NOTE:
1. FOR CREEK CROSS SECTIONS SEE SHEET NO. 17.

FILE NAME = D168J05-3-ah-eros.dgn
PLOT DATE = 5/10/2010

CHRISTIAN-ROGE & ASSOCIATES, INC.
ENGINEERS-PLANNERS-SURVEYORS
211 WEST WACKER DRIVE
CHICAGO, ILLINOIS 60606
PHONE: (312)372-2023 FAX: (312)372-5274

DESIGNED - G.F.L.	REVISED - APRIL 28, 2010
DRAWN - J.V./K.R.K.	REVISED -
CHECKED - E.J.M.	REVISED -
DATE - DECEMBER 2009	REVISED -

**STATE OF ILLINOIS
DEPARTMENT OF TRANSPORTATION**

**EROSION AND SEDIMENT CONTROL PLAN
WESTERN AVENUE OVER THORN CREEK**

SCALE: 1" = 20' SHEET NO. 2 OF 2 SHEETS STA. 9+00 TO STA. 11+00

F.A.P. RTE.	SECTION	COUNTY	TOTAL SHEETS	SHEET NO.
VAR.	2009-106 I	COOK/WILL	24	10
FED. ROAD DIST. NO. 1 ILLINOIS FED. AID PROJECT			CONTRACT NO. 60J05	

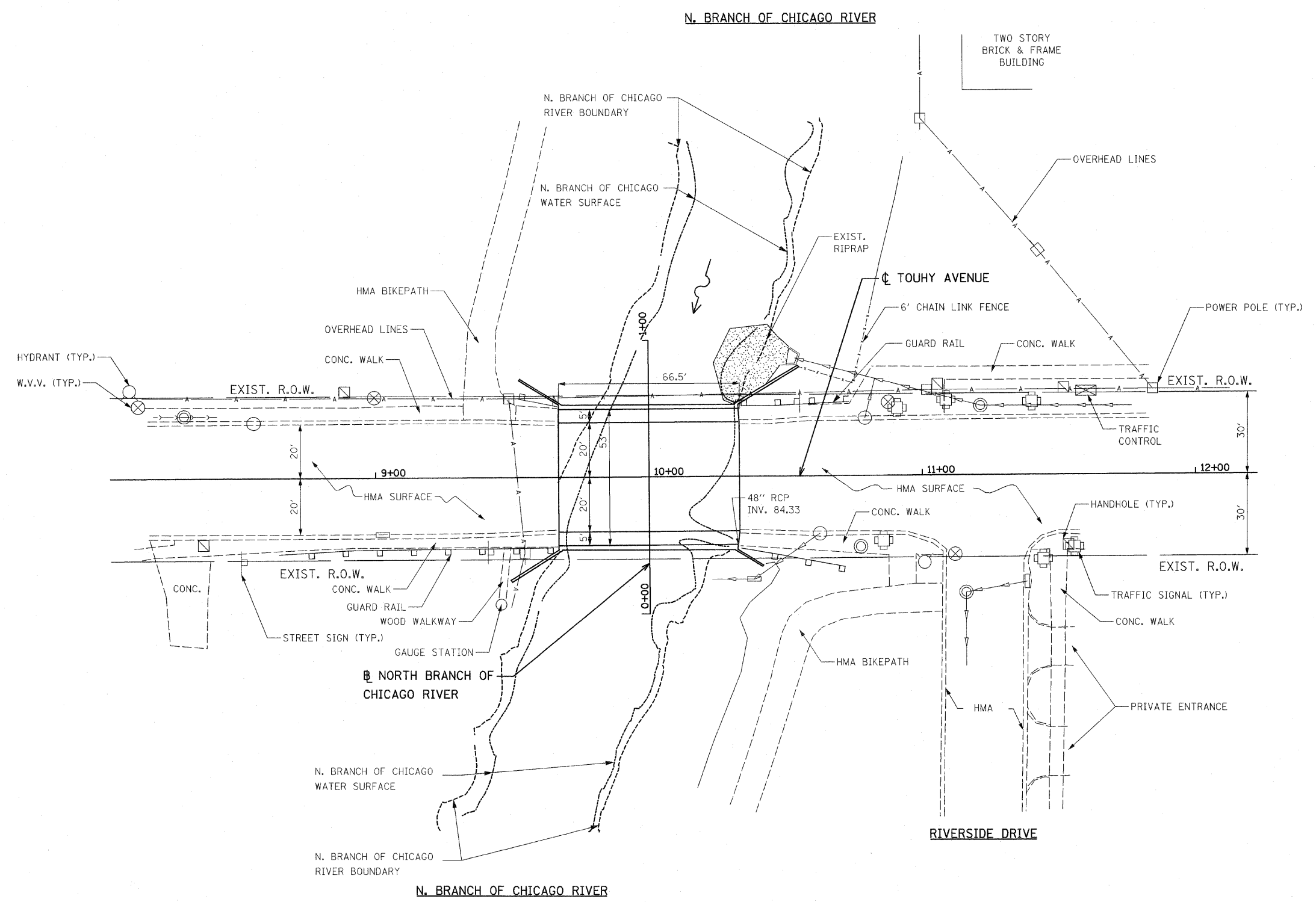

FILE NAME = D168J05-4-siteplan.dgn
 PLOT DATE = 5/10/2010

CHRISTIAN-ROGE & ASSOCIATES, INC.
 ENGINEERS-PLANNERS-SURVEYORS
 211 WEST WACKER DRIVE
 CHICAGO, ILLINOIS 60606
 PHONE: (312)372-2023 FAX: (312)372-5274

DESIGNED - G.F.L.	REVISED - APRIL 28, 2010
DRAWN - J.V./K.R.K.	REVISED -
CHECKED - E.J.M.	REVISED -
DATE - DECEMBER 2009	REVISED -

**STATE OF ILLINOIS
 DEPARTMENT OF TRANSPORTATION**

**SITE PLAN
 TOUHY AVENUE OVER N. BR CHICAGO RIVER**

SCALE: 1" = 20' SHEET NO. 1 OF 2 SHEETS STA. 9+00 TO STA. 12+00

F.A.P. RTE.	SECTION	COUNTY	TOTAL SHEETS	SHEET NO.
VAR.	2009-106 I	COOK/WILL	24	11
FED. ROAD DIST. NO. 1 ILLINOIS FED. AID PROJECT			CONTRACT NO. 60J05	

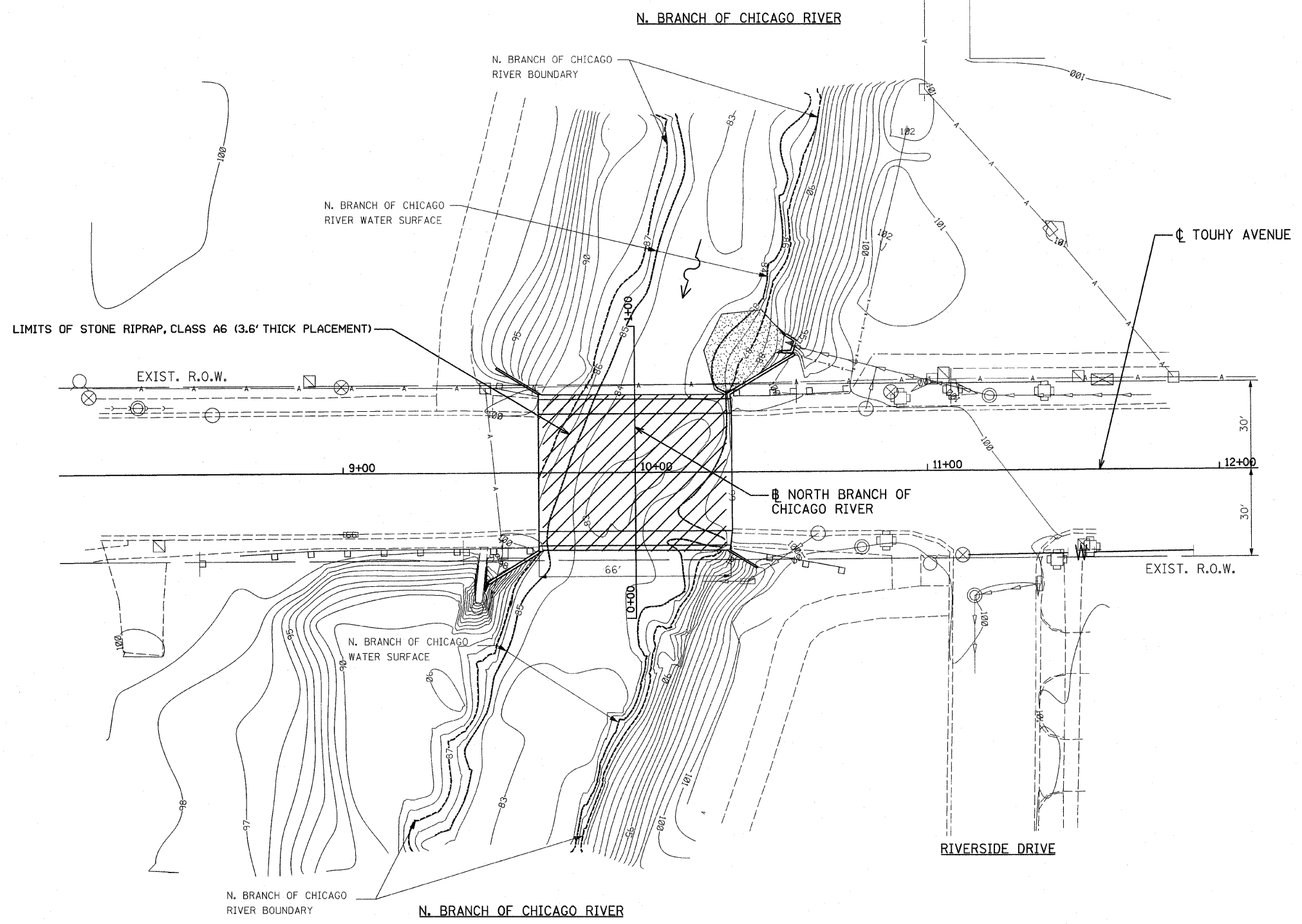

LEGEND

 STONE RIPRAP, CLASS A6 (3.6' THICK)

BM 1: SQUARE CUT ON TOP OF N.E. WINGWALL OF BRIDGE
ASSUMED ELEV. = 100.00

NOTE:
1. FOR RIVER CROSS SECTIONS SEE SHEET NO. 18.

LIMITS OF STONE RIPRAP, CLASS A6 (3.6' THICK PLACEMENT)

ACCESS TO THIS SITE IS LIMITED. THE CONTRACTOR SHALL ONLY ACCESS THIS SITE BY RAISING AND/OR LOWERING ALL EQUIPMENT AND MATERIAL OVER THE SIDES OF THE BRIDGE. THE CONTRACTOR WILL NOT BE ALLOWED OTHER ACCESS WITHOUT WRITTEN PERMISSION FROM THE ENGINEER. THIS WORK WILL NOT BE PAID FOR SEPARATELY, BUT SHALL BE CONSIDERED AS INCLUDED IN THE CONTRACT UNIT PRICES FOR THE CONSTRUCTION ITEMS INVOLVED AND NO ADDITIONAL COMPENSATION WILL BE ALLOWED.

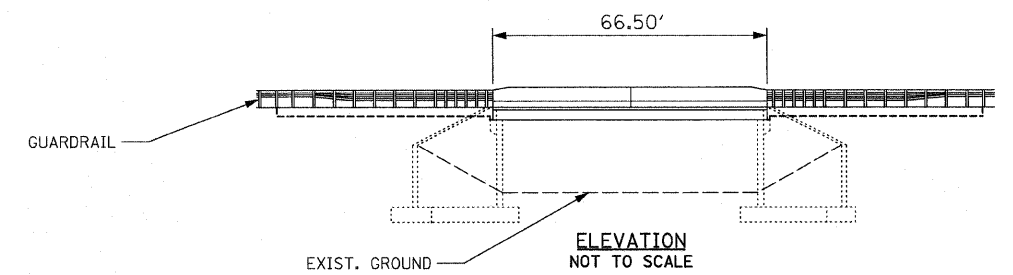

FILE NAME = D168J85-4-sht-eros.dgn
PLOT DATE = 5/10/2010

CHRISTIAN-ROGE & ASSOCIATES, INC.
ENGINEERS-PLANNERS-SURVEYORS
211 WEST WACKER DRIVE
CHICAGO, ILLINOIS 60606
PHONE: (312)372-2023 FAX: (312)372-5274

DESIGNED - G.F.L.	REVISED - APRIL 28, 2010
DRAWN - J.V./K.R.K.	REVISED -
CHECKED - E.J.M.	REVISED -
DATE - DECEMBER 2009	REVISED -

**STATE OF ILLINOIS
DEPARTMENT OF TRANSPORTATION**

**EROSION AND SEDIMENT CONTROL PLAN
TOUHY AVENUE OVER N. BR CHICAGO RIVER**

SCALE: 1" = 20' SHEET NO. 2 OF 2 SHEETS STA. 9+00 TO STA. 12+00

F.A.P. RTE.	SECTION	COUNTY	TOTAL SHEETS	SHEET NO.
VAR.	2009-106 I	COOK/WILL	24	12
CONTRACT NO. 60J05				
FED. ROAD DIST. NO. 1 ILLINOIS FED. AID PROJECT				

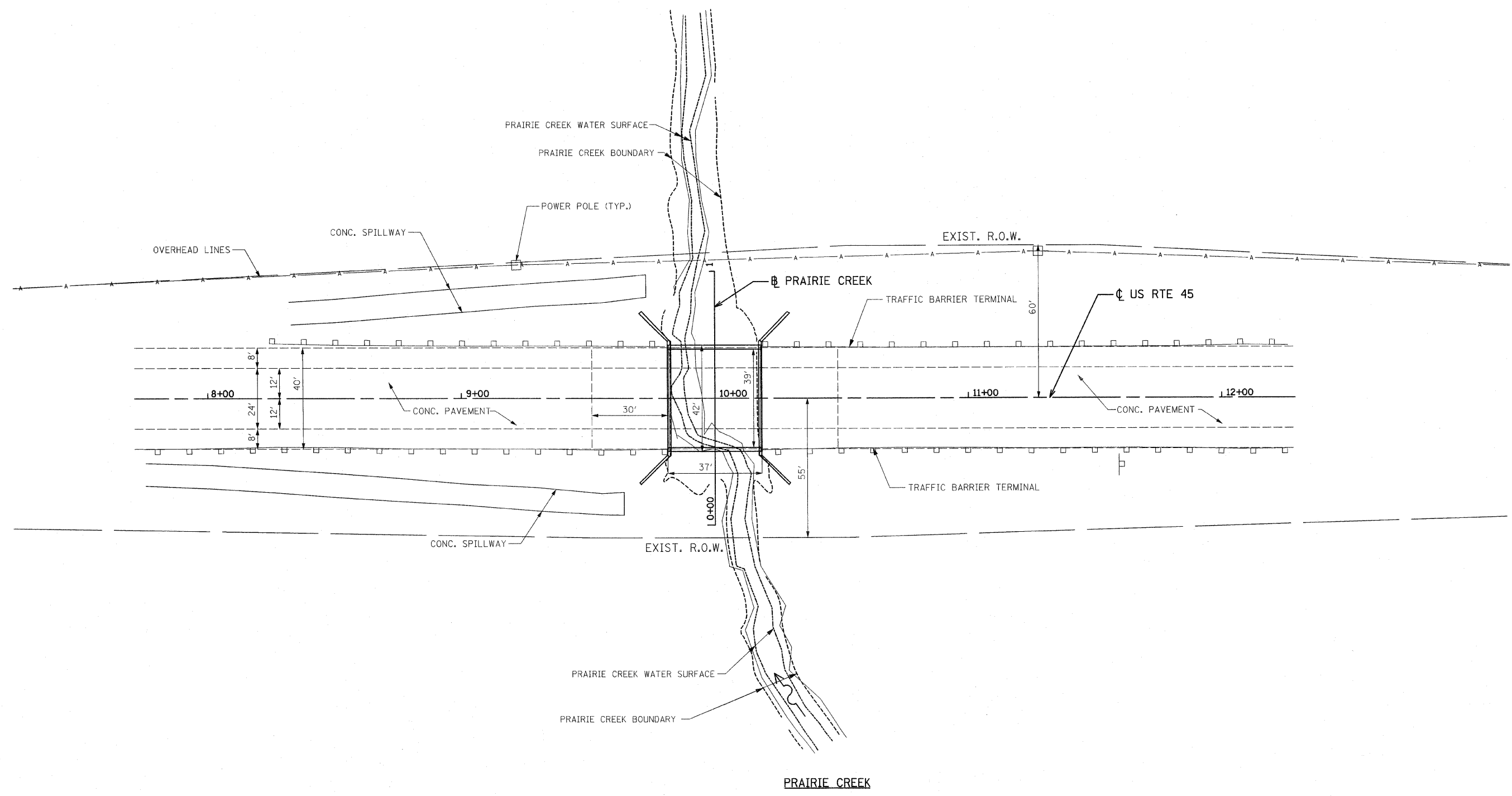
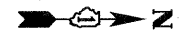

FILE NAME = D:\68105-5-siteplan.dgn PLOT DATE = 5/10/2010	 CHRISTIAN-ROGE & ASSOCIATES, INC. ENGINEERS-PLANNERS-SURVEYORS 211 WEST WACKER DRIVE CHICAGO, ILLINOIS 60606 PHONE: (312)372-2023 FAX: (312)372-5274	DESIGNED - G.F.L.	REVISED - APRIL 28, 2010	STATE OF ILLINOIS DEPARTMENT OF TRANSPORTATION	SITE PLAN US RTE 45 OVER PRAIRIE CREEK		F.A.P. RTE.	SECTION	COUNTY	TOTAL SHEETS	SHEET NO.
		DRAWN - J.V./K.R.K.	REVISED -		VAR.	2009-106 I	COOK/WILL	24	13		
CHECKED - E.J.M.	REVISED -	SCALE: 1" = 20' SHEET NO. 1 OF 2 SHEETS STA. 8+00 TO STA. 12+00					FED. ROAD DIST. NO. 1 ILLINOIS FED. AID PROJECT				
DATE - DECEMBER 2009	REVISED -						CONTRACT NO. 60J05				

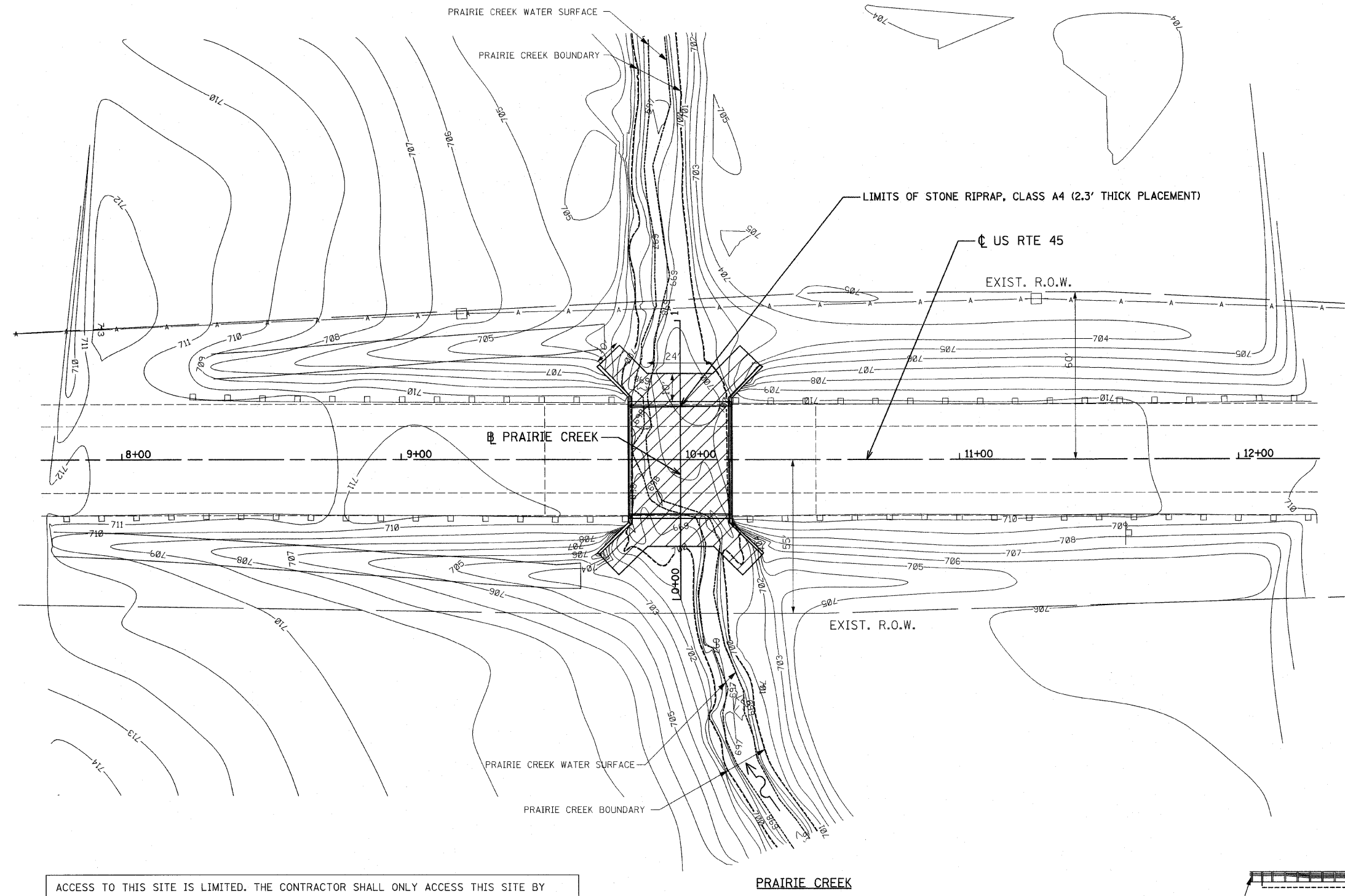

LEGEND

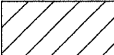
 STONE RIPRAP, CLASS A4 (2.3' THICK)

BM 1: SQUARE CUT ON TOP OF S.E. WINGWALL
OF BRIDGE 099-0119
ELEV. = 711.29

NOTE:
1. FOR CREEK CROSS SECTIONS SEE SHEET NO. 19.

ACCESS TO THIS SITE IS LIMITED. THE CONTRACTOR SHALL ONLY ACCESS THIS SITE BY RAISING AND/OR LOWERING ALL EQUIPMENT AND MATERIAL OVER THE SIDES OF THE BRIDGE. THE CONTRACTOR WILL NOT BE ALLOWED OTHER ACCESS WITHOUT WRITTEN PERMISSION FROM THE ENGINEER. THIS WORK WILL NOT BE PAID FOR SEPARATELY, BUT SHALL BE CONSIDERED AS INCLUDED IN THE CONTRACT UNIT PRICES FOR THE CONSTRUCTION ITEMS INVOLVED AND NO ADDITIONAL COMPENSATION WILL BE ALLOWED.

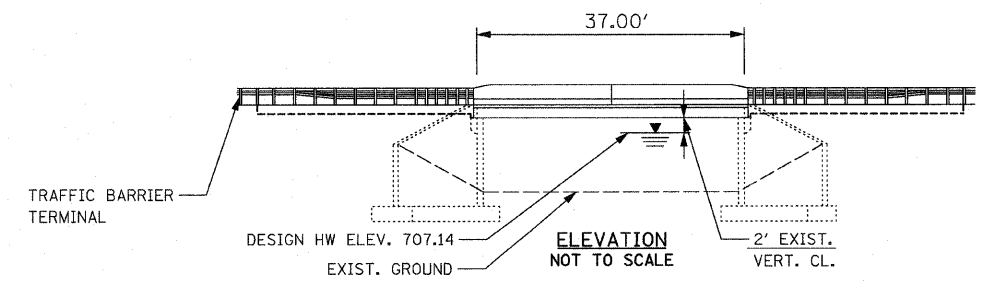

FILE NAME = D:\60J05-5-shr-eros.dgn PLOT DATE = 5/10/2010	 CHRISTIAN-ROGE & ASSOCIATES, INC. ENGINEERS-PLANNERS-SURVEYORS 211 WEST WACKER DRIVE CHICAGO, ILLINOIS 60606 PHONE: (312)372-2023 FAX: (312)372-5274	DESIGNED - G.F.L. DRAWN - J.V./K.R.K. CHECKED - E.J.M. DATE - DECEMBER 2009	REVISED - APRIL 28, 2010 REVISED - REVISED - REVISED -	STATE OF ILLINOIS DEPARTMENT OF TRANSPORTATION	EROSION AND SEDIMENT CONTROL PLAN US RTE 45 OVER PRAIRIE CREEK	SCALE: 1" = 20' SHEET NO. 2 OF 2 SHEETS STA. 8+00 TO STA. 12+00	F.A.P. RTE. SECTION COUNTY TOTAL SHEETS SHEET NO. VAR. 2009-106 I COOK/WILL 24 14 CONTRACT NO. 60J05	FED. ROAD DIST. NO. 1 ILLINOIS FED. AID PROJECT
--	---	--	---	---	---	---	--	---

DATE	
BY	
FINAL SURVEY	
SURVEYED	
NOTE BOOK	
PLOTTED	
TEMPLATE	
AREAS CHECKED	
NO.	

DATE	
BY	
ORIGINAL SURVEY	
SURVEYED	
NOTE BOOK	
PLOTTED	
TEMPLATE	
AREAS CHECKED	
NO.	

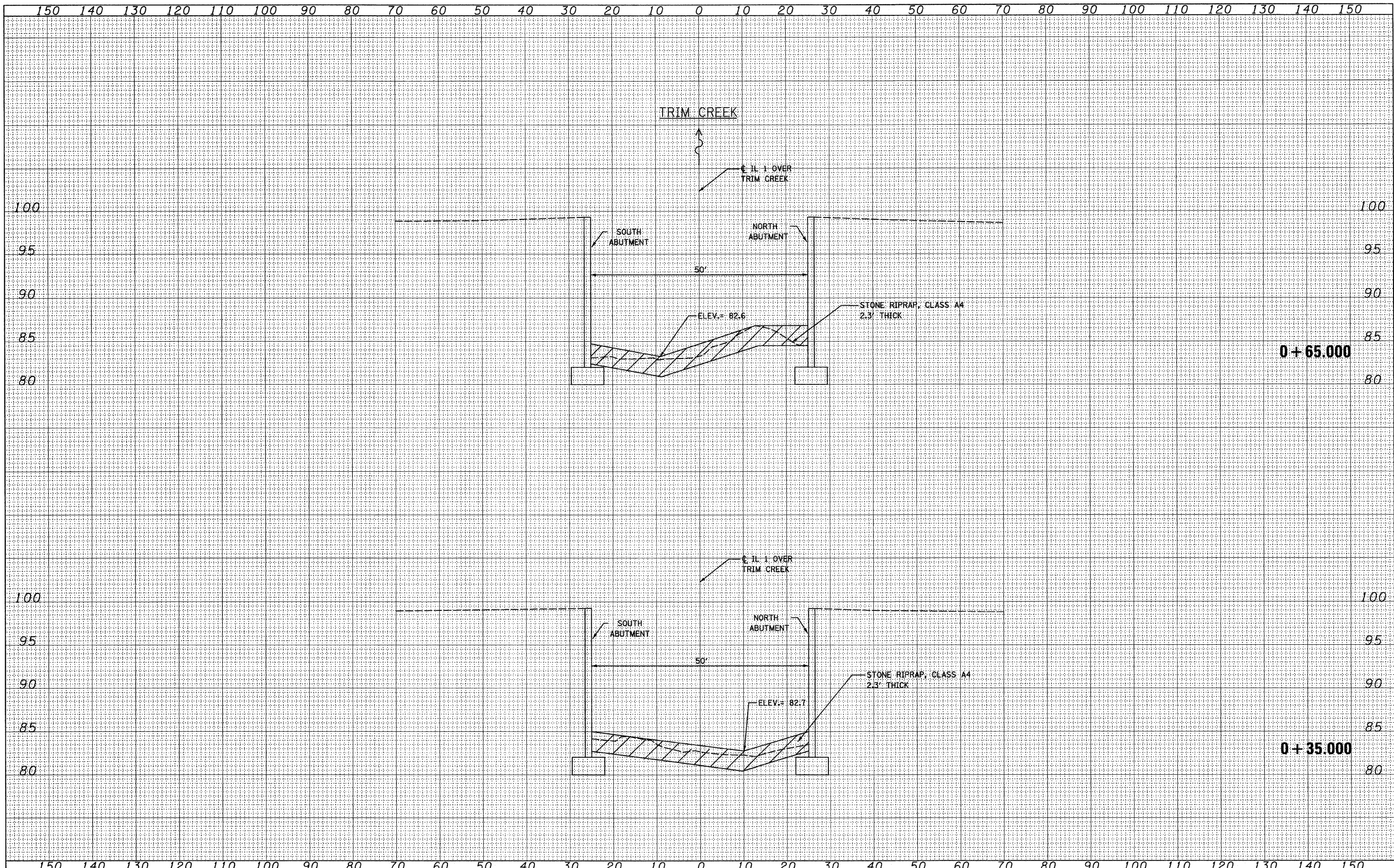

FILE NAME = I:\102466_Bridge\Source\2-IL1.Trim C-rk\CADD Sheets\DI100J05-2-shr-xsec.dgn	USER NAME = IDOT	DESIGNED - K.R.K.	REVISED -	STATE OF ILLINOIS DEPARTMENT OF TRANSPORTATION	IL 1 AT TRIM CREEK	F.A.P. RTE.	SECTION	COUNTY	TOTAL SHEETS	SHEET NO.	
PLOT SCALE = 1/8" = 1' / IN.	DRAWN - J.V.	CHECKED - G.F.L.	REVISED -			VAR	2009-106I	COOK	24	16	
PLOT DATE = 5/10/2010	DATE - DECEMBER, 2009	REVISED -	REVISED -			CONTRACT NO. 60J05					
SCALE: 1:10H, 1:5V SHEET NO. 1 OF 1 SHEETS STA. 00+35 TO STA. 00+65						FED. ROAD DIST. NO. ILLINOIS FED. AID PROJECT					

150 140 130 120 110 100 90 80 70 60 50 40 30 20 10 0 10 20 30 40 50 60 70 80 90 100 110 120 130 140 150

DATE	
BY	
FINISHED	
PLOTTED	
TEMPLATE	
AREAS CHECKED	
NO.	
FINAL SURVEY	
NOTE BOOK	
NO.	

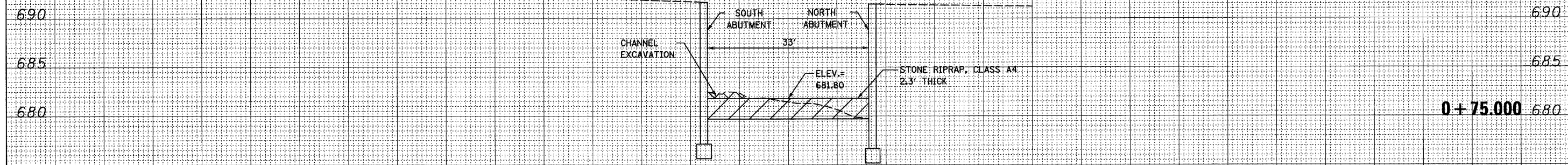

DATE	
BY	
FINISHED	
PLOTTED	
TEMPLATE	
AREAS CHECKED	
NO.	
ORIGINAL SURVEY	
NOTE BOOK	
NO.	

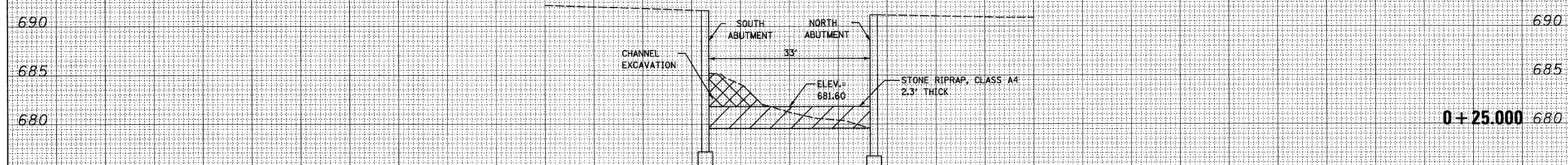

150 140 130 120 110 100 90 80 70 60 50 40 30 20 10 0 10 20 30 40 50 60 70 80 90 100 110 120 130 140 150

FILE NAME = I:\102466_BridgeScour\3-Western.ThornCrk\CADD	USER NAME = IDOT	DESIGNED - K.R.K.	REVISED -	STATE OF ILLINOIS DEPARTMENT OF TRANSPORTATION	WESTERN AVENUE AT THORN CREEK	F.A.P. RTE.	SECTION	COUNTY	TOTAL SHEETS	SHEET NO.
Sheets\DI60105-3-ah-xsec.dgn	DRAWN - J.V.	REVISED -	VAR.			2009-106I	COOK	24	17	
PLOT SCALE = 10.0000' / IN.	CHECKED - G.F.L.	REVISED -	CONTRACT NO. 60J05							
PLOT DATE = 5/10/2010	DATE - NOVEMBER, 2009	REVISED -	FED. ROAD DIST. NO. ILLINOIS FED. AID PROJECT							
SCALE: 1:10H, 1:5V						SHEET NO. 1 OF 1 SHEETS		STA. 00+25 TO STA. 00+75		

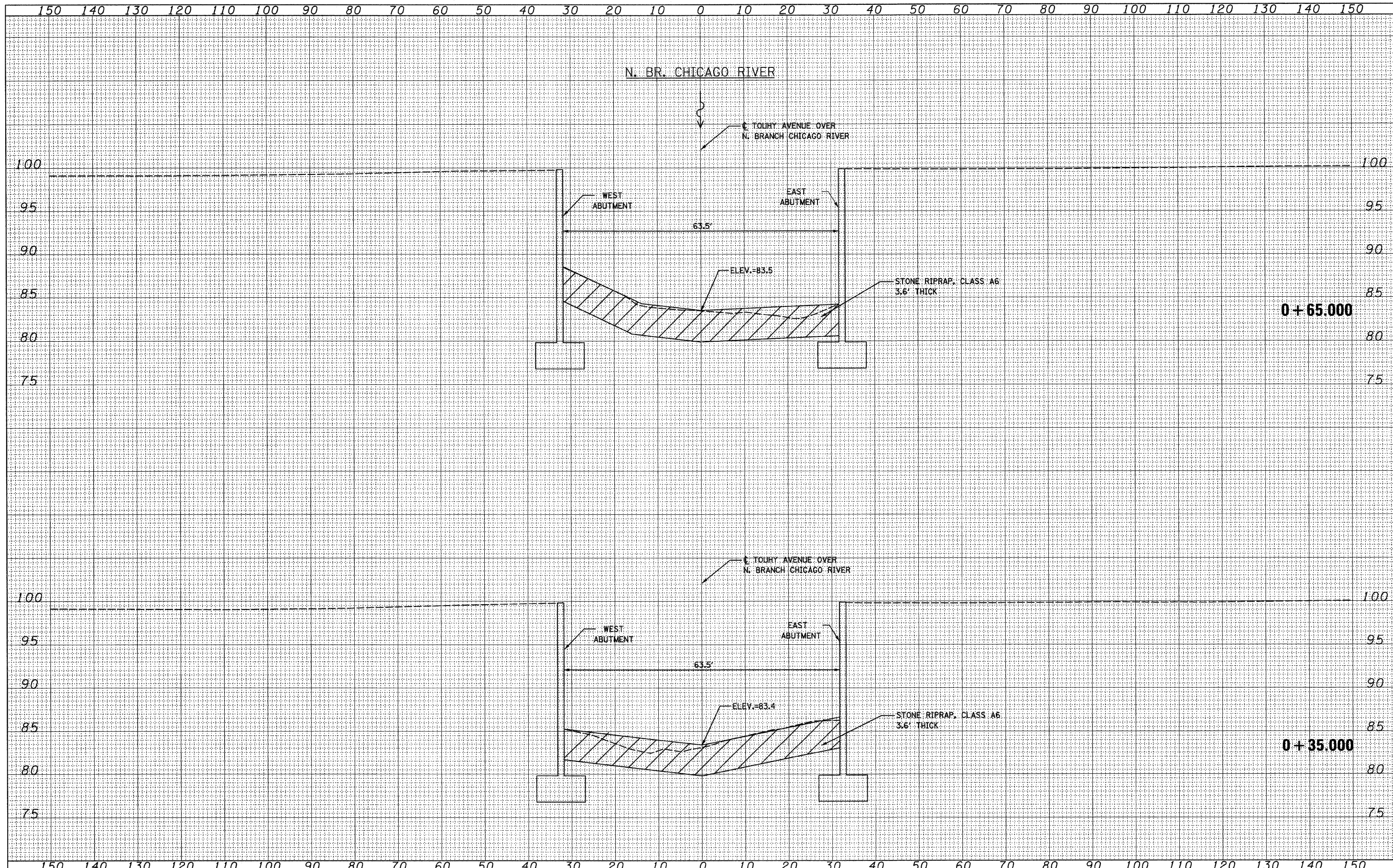

DATE	
BY	
REVISIONS	
PLOTTED	
TEMPLATE	
AREAS CHECKED	
FINAL SURVEY NOTE BOOK NO.	

DATE	
BY	
REVISIONS	
PLOTTED	
TEMPLATE	
AREAS CHECKED	
ORIGINAL SURVEY NOTE BOOK NO.	

FILE NAME = I:\102466.BridgeScour\4-Touhy_N Br Chicago R\CAD Sheets\102466-4-ht-xsec.dgn	USER NAME = 1001	DESIGNED - K.R.K.	REVISED -	STATE OF ILLINOIS DEPARTMENT OF TRANSPORTATION	TOUHY AVE OVER N. BR CHICAGO RIVER	F.A. RTE.	SECTION	COUNTY	TOTAL SHEETS	SHEET NO.	
PLOT SCALE = 10,0000' / IN.	CHECKED - G.F.L.	DATE - DECEMBER, 2009	REVISED -			VAR	2009-1061	COOK	24	18	
PLOT DATE = 5/10/2010			REVISED -			CONTRACT NO. 60J05					
						FED. ROAD DIST. NO. ILLINOIS FED. AID PROJECT					
SCALE: 1:10H, 1:5V						SHEET NO. 1 OF 1 SHEETS		STA. 00+35		TO STA. 00+65	

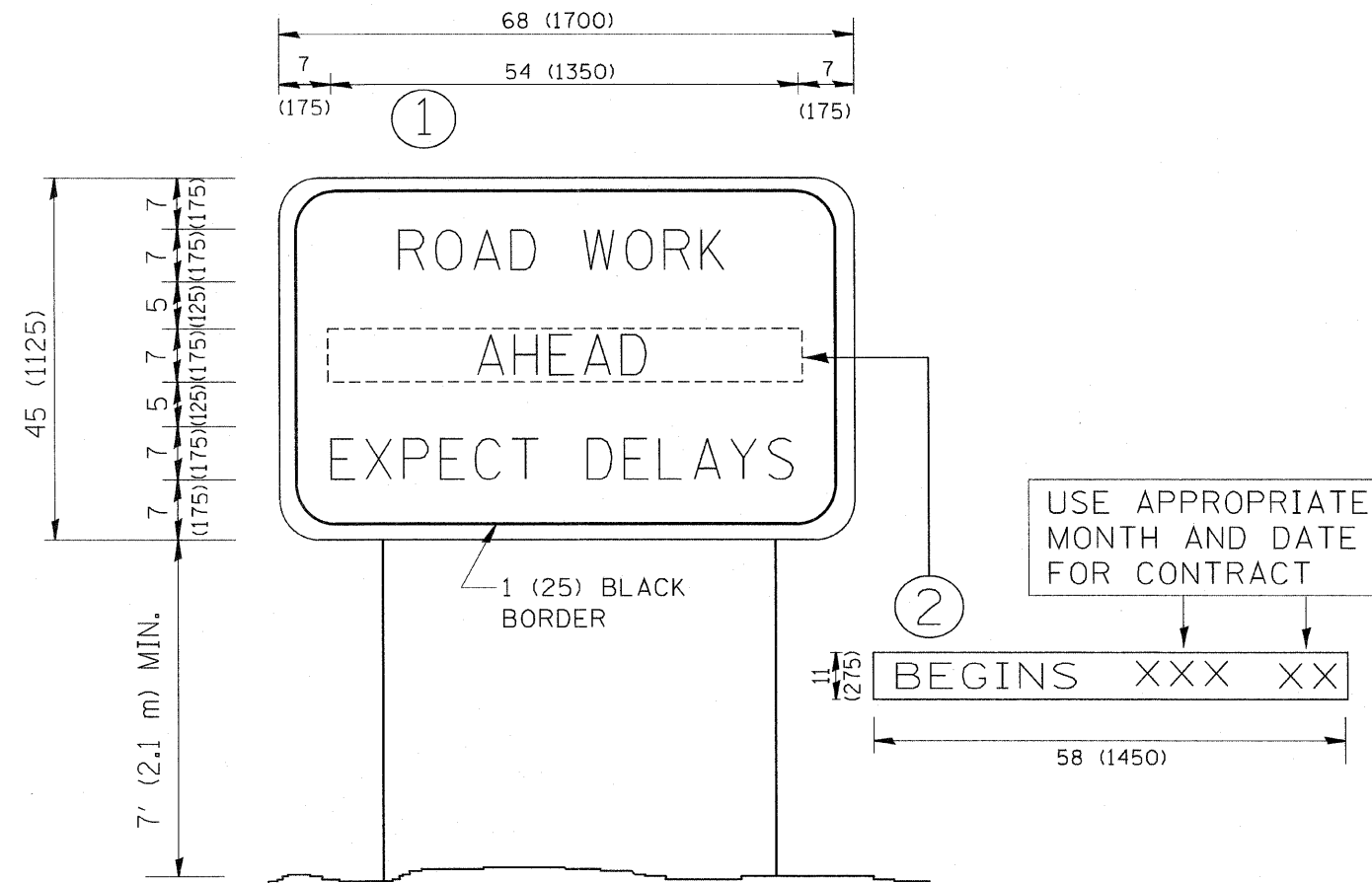

NOTES:

1. USE BLACK LETTERING ON ORANGE BACKGROUND.
2. ERECT SIGNS IN ADVANCE OF THE LOCATION FOR THE "ROAD CONSTRUCTION AHEAD" SIGN AT LOCATIONS AS DIRECTED BY THE ENGINEER.
3. ERECT SIGN ① WITH INSTALLED PANEL ② ONE WEEK PRIOR TO THE START OF CONSTRUCTION.
4. REMOVE PANEL ② SOON AFTER THE START OF CONSTRUCTION.
5. SEE SPECIAL PROVISION FOR "TEMPORARY INFORMATION SIGNING" FOR ADDITIONAL INFORMATION.
6. ONE SIGN ASSEMBLY EQUALS 25.70 SQ. FT. (2.3 SQ. M.)
7. SHALL BE PAID FOR AS TEMPORARY INFORMATION SIGNING.

ALL DIMENSIONS ARE IN INCHES (MILLIMETERS) UNLESS OTHERWISE SHOWN.

FILE NAME = W:\diststd\22x34\to22.dgn	USER NAME = geglinoht	DESIGNED -	REVISED - R. MIRS 09-15-97	STATE OF ILLINOIS DEPARTMENT OF TRANSPORTATION	ARTERIAL ROAD INFORMATION SIGN			F.A.P. RTE.	SECTION	COUNTY	TOTAL SHEETS	SHEET NO.	
	PLOT SCALE = 50,000 ' / IN.	DRAWN -	REVISED - R. MIRS 12-11-97		SCALE: NONE	SHEET NO. 1 OF 1 SHEETS	STA.	VAR.	2006-108-I	COOK/WILL	24	20	
	PLOT DATE = 1/4/2008	CHECKED -	REVISED - T. RAMMACHER 02-02-99						TC-22				
		DATE -	REVISED - C. JUCIUS 01-31-07						FED. ROAD DIST. NO. 1	ILLINOIS	FED. AID PROJECT		
								CONTRACT NO. 60J05					

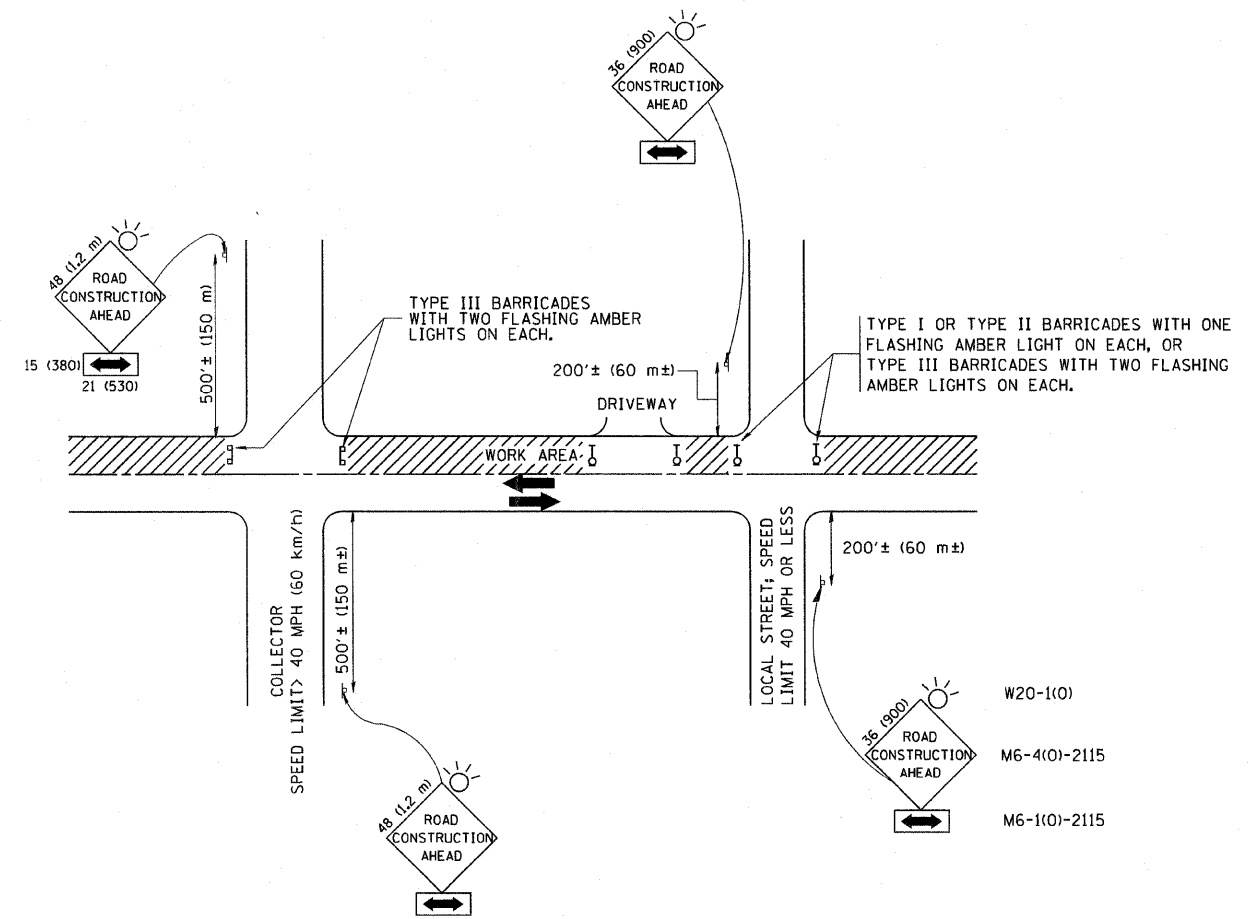

TRAFFIC CONTROL AND PROTECTION FOR SIDE ROADS, INTERSECTIONS, AND DRIVEWAYS

NOTES:

- A. FOR NO LANE RESTRICTION ON THE SIDE ROAD OR DRIVEWAYS
 - 1. SIDE ROAD WITH A SPEED LIMIT OF 40 MPH (60 km/h) OR LESS AS SHOWN ON THE DRAWING AND AS DIRECTED BY THE ENGINEER:
 - a) ONE ROAD CONSTRUCTION AHEAD SIGN 36 x 36 (900x900) WITH A FLASHER AND FLAG MOUNTED ON IT APPROXIMATELY 200' (60 m) IN ADVANCE OF THE MAIN ROUTE.
 - b) THE CLOSED PORTION OF THE MAIN ROUTE SHALL BE PROTECTED BY BLOCKING WITH TYPE I, TYPE II OR TYPE III BARRICADES, 1/3 OF THE CROSS SECTION OF THE CLOSED PORTION.
 - 2. SIDE ROAD WITH A SPEED LIMIT GREATER THAN 40 MPH (60 km/h) AS SHOWN ON THE DRAWING AND AS DIRECTED BY THE ENGINEER:
 - a) ONE ROAD CONSTRUCTION AHEAD SIGN 48 x 48 (1.2 m x 1.2 m) WITH A FLASHER MOUNTED ON IT APPROXIMATELY 500' (150 m) IN ADVANCE OF THE MAIN ROUTE.
 - b) THE CLOSED PORTION OF THE MAIN ROUTE SHALL BE PROTECTED BY BLOCKING WITH TYPE III BARRICADES, 1/2 OF THE CROSS SECTION OF THE CLOSED PORTION.
 - 3. WHEN THE SIDE ROAD LIES BETWEEN THE BEGINNING OF THE MAINLINE SIGNING AND THE WORK ZONE, A SINGLE HEADED ARROW (M6-1) SHALL BE USED IN LIEU OF THE DOUBLE HEADED ARROW (M6-4).
- B. FOR A LANE CLOSURE ON A SIDE ROAD OR DRIVEWAY:
 - USE APPLICABLE PORTIONS OF THE TYPICAL APPLICATION OF TRAFFIC CONTROL DEVICES (STD. 701501, STD. 701606 OR THE APPROPRIATE STANDARD). THE SPACING OF SIGNS AND BARRICADES SHALL BE ADJUSTED FOR FIELD CONDITIONS AS DIRECTED BY THE ENGINEER. THE DIRECTIONAL ARROW SHALL BE COVERED OR REMOVED WHEN NO LONGER CONSISTENT WITH THE SIDE ROAD LANE CLOSURE.
- C. ADVANCE WARNING SIGNS ARE TO BE OMITTED ON DRIVEWAY UNLESS OTHERWISE NOTED.
- D. THE TRAFFIC CONTROL AND PROTECTION FOR SIDE ROADS, INTERSECTIONS, AND DRIVEWAYS SHALL BE INCIDENTAL TO THE COST OF SPECIFIED TRAFFIC CONTROL STANDARDS OR ITEMS.

All dimensions are in millimeters (inches) unless otherwise shown.

FILE NAME = W:\distatd\22x34\col8.dgn	USER NAME = geglennobt	DESIGNED - LHA	REVISED - J. OBERLE 10-18-95	STATE OF ILLINOIS DEPARTMENT OF TRANSPORTATION	TRAFFIC CONTROL AND PROTECTION FOR SIDE ROADS, INTERSECTIONS, AND DRIVEWAYS			F.A.P. RTE.	SECTION	COUNTY	TOTAL SHEETS	SHEET NO.
	PLOT SCALE = 50,000 / / IN.	CHECKED -	REVISED - A. HOUSEH 03-06-96		SCALE: NONE	SHEET NO. 1 OF 1 SHEETS	STA.	TO STA.	2009-108-4	COOK/WILL	24	21
	PLOT DATE = 1/4/2008	DATE - 06-89	REVISED - T. RAMMACHER 01-06-00					TC-10		CONTRACT NO. 60J05		

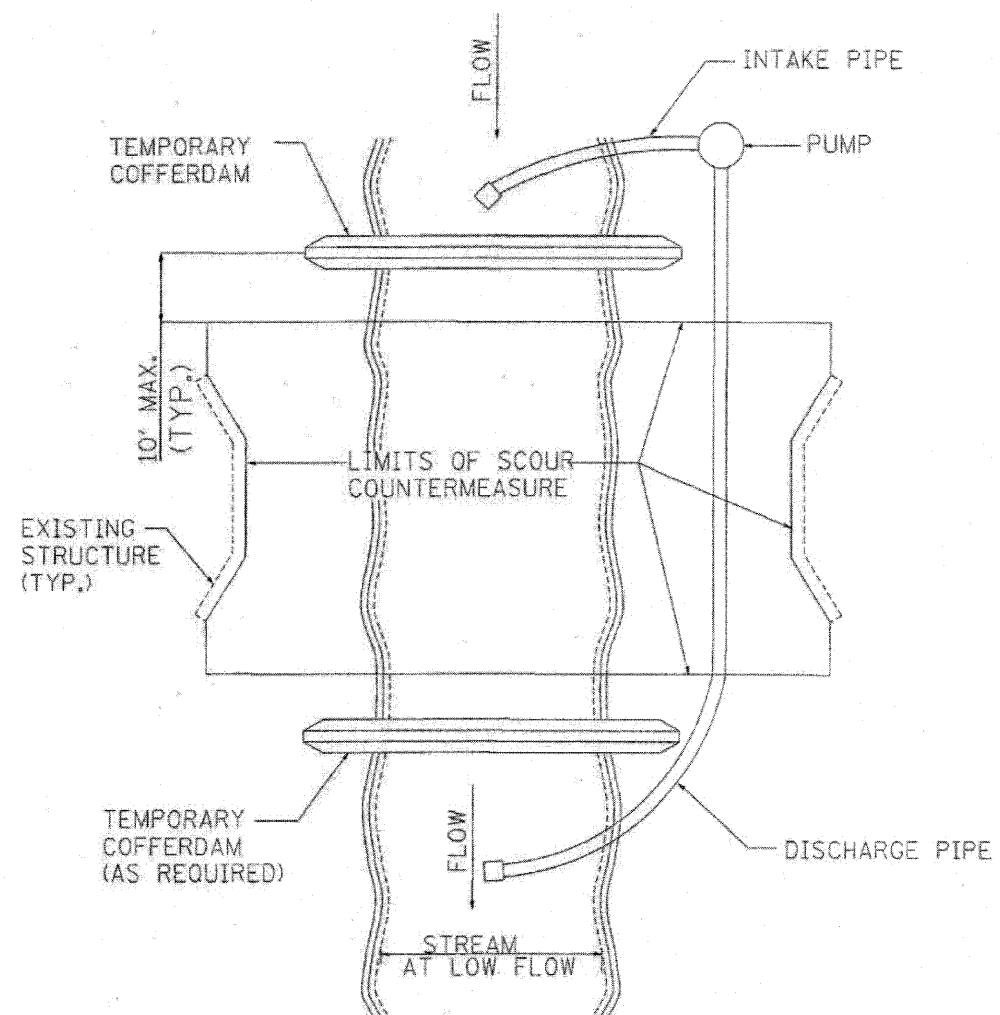

FIGURE D1. TEMPORARY COFFERDAM WITH PUMP BYPASS

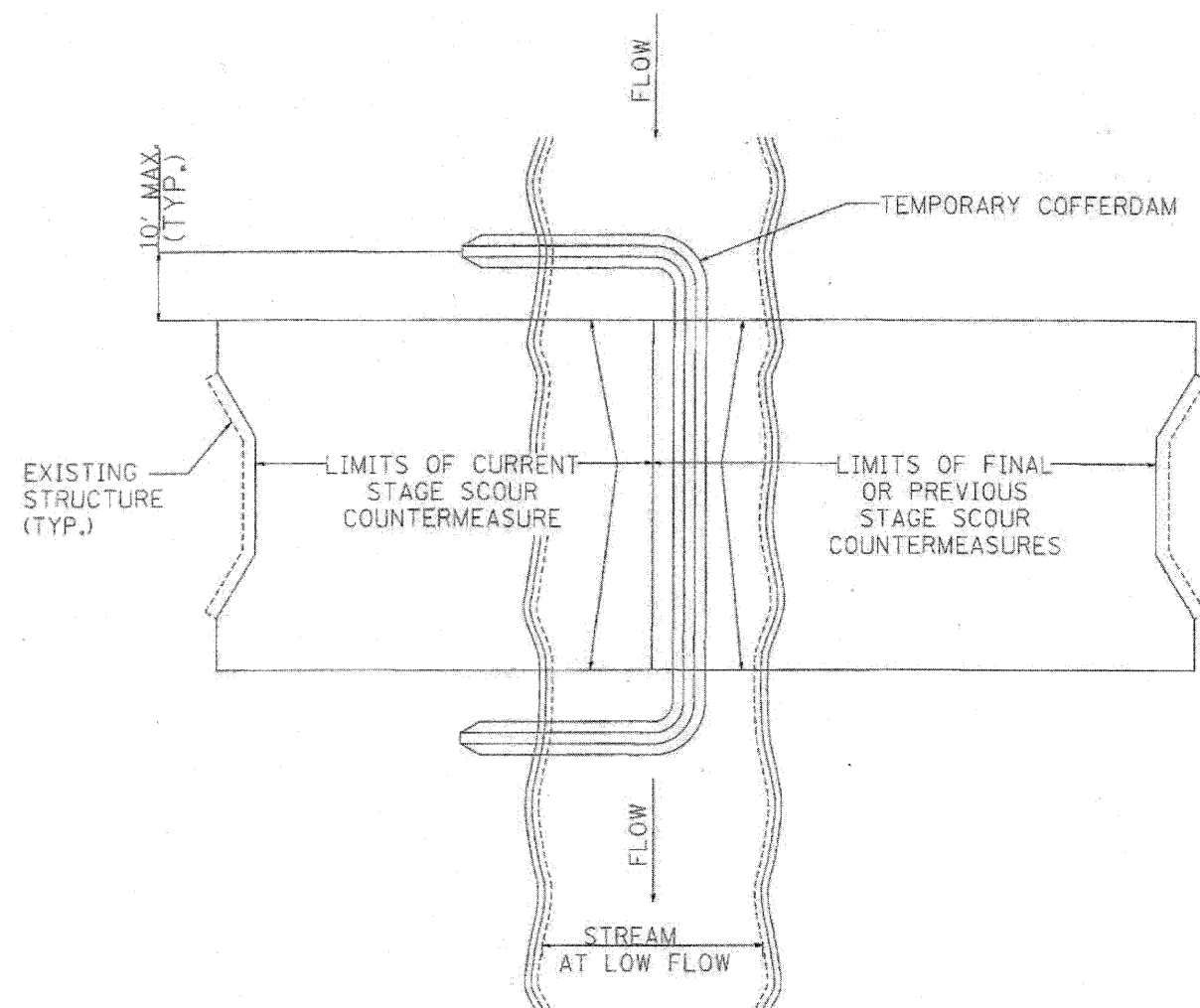

FIGURE D2. STAGED IN-STREAM COFFERDAM DIVISION

NOTE: DEWATERING SYSTEM DETAILS SHALL BE USED IN CONJUNCTION WITH THE PROJECT SPECIAL PROVISIONS.

FILE NAME = D160J05-sht-details.dgn
PLOT DATE = 5/10/2010

CHRISTIAN-ROGE & ASSOCIATES, INC.
ENGINEERS-PLANNERS-SURVEYORS
211 WEST WACKER DRIVE
CHICAGO, ILLINOIS 60606
PHONE: (312)372-2023 FAX: (312)372-5274

DESIGNED - G.F.L.	REVISED - APRIL 28, 2010
DRAWN - J.V./K.R.K.	REVISED -
CHECKED - G.F.L.	REVISED -
DATE - DECEMBER 2009	REVISED -

STATE OF ILLINOIS
DEPARTMENT OF TRANSPORTATION

DEWATERING SYSTEM DETAILS
SCOUR COUNTERMEASURES - VARIOUS LOCATIONS

SCALE: NONE SHEET NO. OF SHEETS STA. TO STA.

F.A.P. RTE.	SECTION	COUNTY	TOTAL SHEETS	SHEET NO.
VAR.	2009-106 I	COOK/WILL	24	22
CONTRACT NO. 60J05				
FED. ROAD DIST. NO. 1 ILLINOIS FED. AID PROJECT				

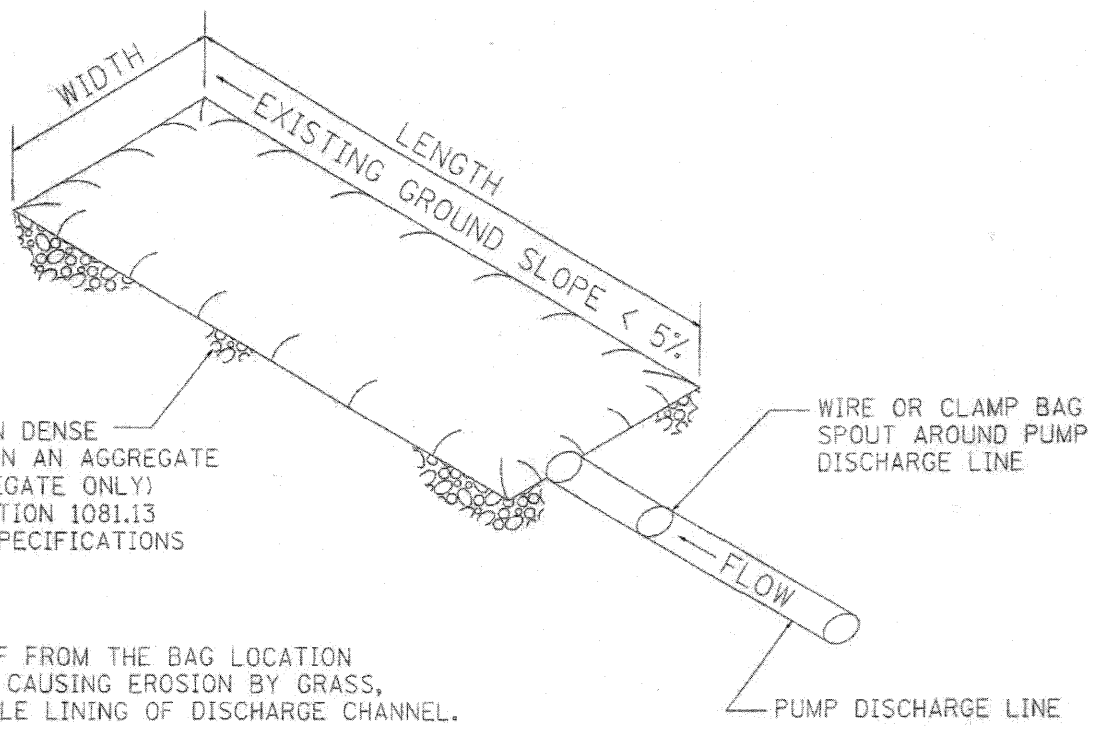

PLACE FILTERBAG ON DENSE MATURE GRASS OR ON AN AGGREGATE BASE (COARSE AGGREGATE ONLY) CONFORMING TO SECTION 1081.13 OF THE STANDARD SPECIFICATIONS

ENSURE THAT RUNOFF FROM THE BAG LOCATION IS PREVENTED FROM CAUSING EROSION BY GRASS, STONE, OR GEOTEXTILE LINING OF DISCHARGE CHANNEL.

REMOVE SILT WHEN BAG IS HALF FULL OR MORE OFTEN IF RECOMMENDED BY THE MANUFACTURER. DISPOSE OF SILT BY TRANSPORTING THE FILLED BAG TO DISPOSAL AREA. SLIT THE BAG, BLEND SILT INTO EXISTING TOPOGRAPHY, SEED AND MULCH

MAINTAIN EXTRA FILTER BAGS ON SITE. REPLACE DAMAGED BAGS PROMPTLY

TYPICAL FLOW RATE: 10 GPM x W x L

FIGURE S1. SEDIMENT FILTER BAG

NOTE: DEWATERING SYSTEM DETAILS SHALL BE USED IN CONJUNCTION WITH THE PROJECT SPECIAL PROVISIONS.

FILE NAME = 0168J85-shr-details2.dgn PLOT DATE = 5/18/2010	 CHRISTIAN-ROGE & ASSOCIATES, INC. ENGINEERS-PLANNERS-SURVEYORS 211 WEST WACKER DRIVE CHICAGO, ILLINOIS 60606 PHONE: (312)372-2023 FAX: (312)372-5274	DESIGNED - G.F.L.	REVISED - APRIL 28, 2010	STATE OF ILLINOIS DEPARTMENT OF TRANSPORTATION	DEWATERING SYSTEM DETAILS SCOUR COUNTERMEASURES - VARIOUS LOCATIONS		F.A.P. RTE.	SECTION	COUNTY	TOTAL SHEETS	SHEET NO.
		DRAWN - J.V./K.R.K.	REVISED -		SCALE: NONE	SHEET NO. OF SHEETS	STA. TO STA.	VAR.	2009-106 I	COOK/WILL	24
		CHECKED - G.F.L.	REVISED -				CONTRACT NO. 60J05				
		DATE - DECEMBER 2009	REVISED -				FED. ROAD DIST. NO. 1 ILLINOIS FED. AID PROJECT				

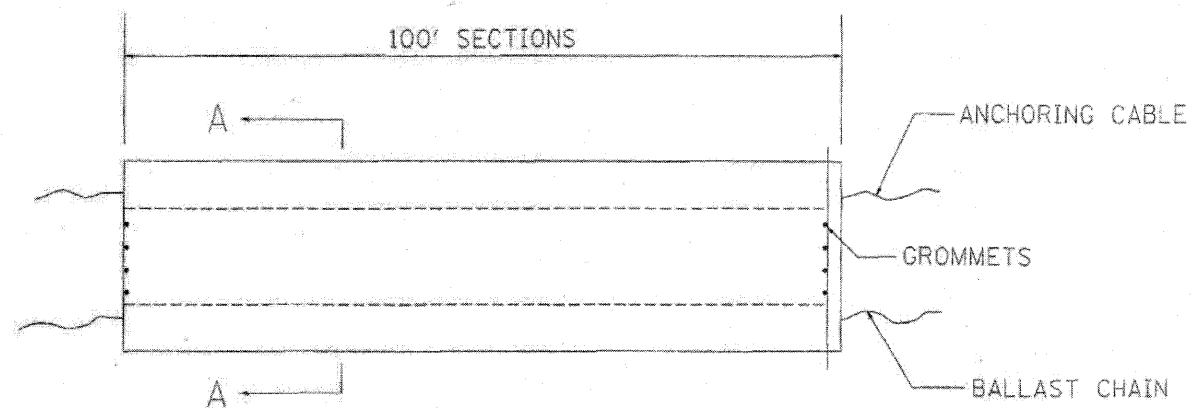

ELEVATION

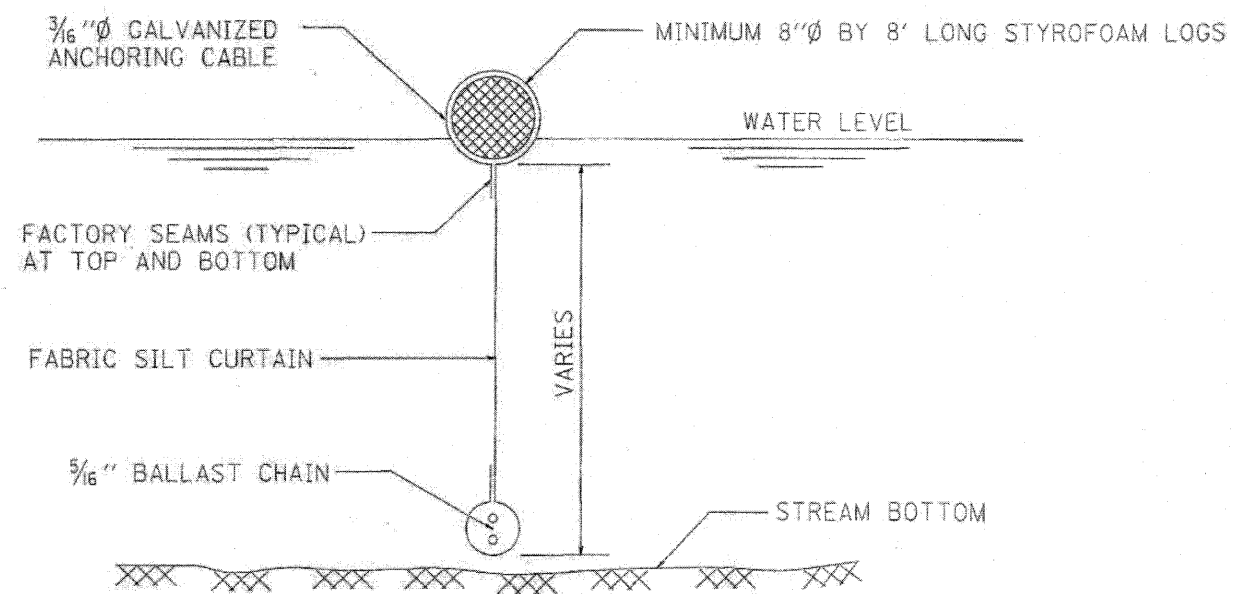

SECTION A-A

FLOTATION BOOM

NOTES:

1. FLOTATION BOOM SHALL BE ANCHORED TO PREVENT DRIFT SHOREWARD OR DOWNSTREAM. ANCHORAGES SHALL BE INSTALLED ON BOTH SHORE AND STREAM SIDE.
2. SHORE ANCHORS SHALL CONSIST OF A POST WITH DEADMAN OR APPROVED EQUAL. STREAM ANCHORS SHALL BE OF SUFFICIENT SIZE TO STABILIZE THE BARRIER WITH NUMBER AND SPACING DEPENDENT ON WATERWAY VELOCITIES.
3. FABRIC SECTIONS SHALL BE CONNECTED END TO END WITH MINIMUM 5/8" DIAMETER POLYPROPYLENE ROPE.
4. DESIGN OF BOOM AND ANCHORAGE SHALL BE IN ACCORDANCE WITH MANUFACTURER'S RECOMENDATIONS. BOTTOM OF BOOM SHALL REACH BOTTOM OF WATERWAY USING ONE OR TWO VERTICAL SECTIONS AS REQUIRED.
5. MAINTENANCE SHALL BE PERFORMED AS NEEDED. CONTRACTOR SHALL REMOVE THE BOOM AT COMPLETION OF WORK IN A MANNER THAT WILL PREVENT SILTATION OF THE WATERWAY.

APPLICATION: FLOTATION BOOMS TO BE USED TO CONTROL EROSION, TURBIDITY AND DEBRIS WHEN WORKING IN WATERWAYS.

FILE NAME = D160J05-shr-details3.dgn
PLOT DATE = 5/12/2010

CHRISTIAN-ROGE & ASSOCIATES, INC.
ENGINEERS-PLANNERS-SURVEYORS
211 WEST WACKER DRIVE
CHICAGO, ILLINOIS 60606
PHONE: (312)372-2023 FAX: (312)372-5274

DESIGNED - G.F.L.	REVISED - APRIL 28, 2010
DRAWN - J.V./K.R.K.	REVISED -
CHECKED - G.F.L.	REVISED -
DATE - DECEMBER 2009	REVISED -

STATE OF ILLINOIS
DEPARTMENT OF TRANSPORTATION

DEWATERING SYSTEM DETAILS
SCOUR COUNTERMEASURES - VARIOUS LOCATIONS

SCALE: NONE SHEET NO. OF SHEETS STA. TO STA.

F.A.P. RTE.	SECTION	COUNTY	TOTAL SHEETS	SHEET NO.
VAR.	2009-106 I	COOK/WILL	24	24
				CONTRACT NO. 60J05
FED. ROAD DIST. NO. 1 [ILLINOIS] FED. AID PROJECT				