

F.A.U. RTE.	SECTION	COUNTY	TOTAL SHEETS	SHEET NO.
1297	09-00173-00-RS	COOK	18	1
FED. ROAD DIST. NO. 1	ILLINOIS	CONTRACT NO. 63361		

INDEX OF SHEETS

SHEET NO.	TITLE
1	COVER SHEET
2	GENERAL NOTES AND VILLAGE LEGEND
3	SUMMARY OF QUANTITIES
4	TYPICAL SECTIONS
5 - 6	PROPOSED RESURFACING PLANS
7 - 8	PROPOSED PAVEMENT MARKING PLANS
9 - 10	VILLAGE OF GLENVIEW STANDARD DETAILS
11 - 17	IDOT DISTRICT 1 STANDARD DETAILS

FOR LIST OF STATE AND LOCAL STANDARDS, SEE SHEET NO. 2

PROJECT LOCATED WITHIN THE VILLAGE OF GLENVIEW

TRAFFIC DATA - GLENVIEW ROAD

POSTED SPEED: 35MPH
CURRENT ADT: 14,900 VPD (2009)

ROAD DESIGNATION

COLLECTOR ROAD

STATE OF ILLINOIS
DEPARTMENT OF TRANSPORTATION
DIVISION OF HIGHWAYS

PLANS FOR PROPOSED FEDERAL AID HIGHWAY

FAU ROUTE 1297 GLENVIEW ROAD (EAST)
WAUKEGAN ROAD TO CHATHAM ROAD
ROADWAY RESURFACING PROJECT

SECTION NO.: 09-00173-00-RS

PROJECT: ARA-9003(481)

JOB NO.: 91-052-10

VILLAGE OF GLENVIEW
COOK COUNTY

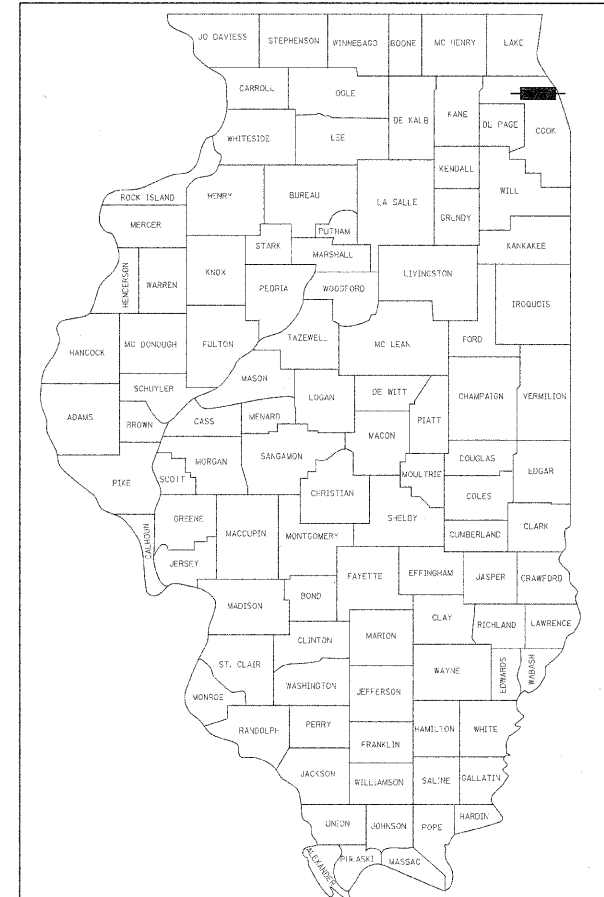

LOCATION OF SECTION INDICATED THUS: - [black rectangle] -

STATE OF ILLINOIS
DEPARTMENT OF TRANSPORTATION
DIVISION OF HIGHWAYS
Approved: *[Signature]* 5-5-10
Local Agency, Village Engineer
Passed: *[Signature]* MAY 27, 2010
District 1 Engineer of Local Roads & Streets
Releasing for Bid Based on Limited Review: *[Signature]* MAY 27, 2010
Deputy Director of Highways, Region 1 Engineer

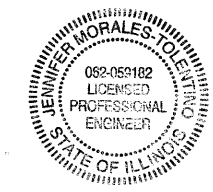

[Signature]
JENNIFER MORALES-TOLENTINO, P.E.
ILLINOIS REGISTRATION NO. 062-059182
EXPIRATION DATE: 11/30/2011

TOWNSHIP: NORTHFIELD, T42N, R12E

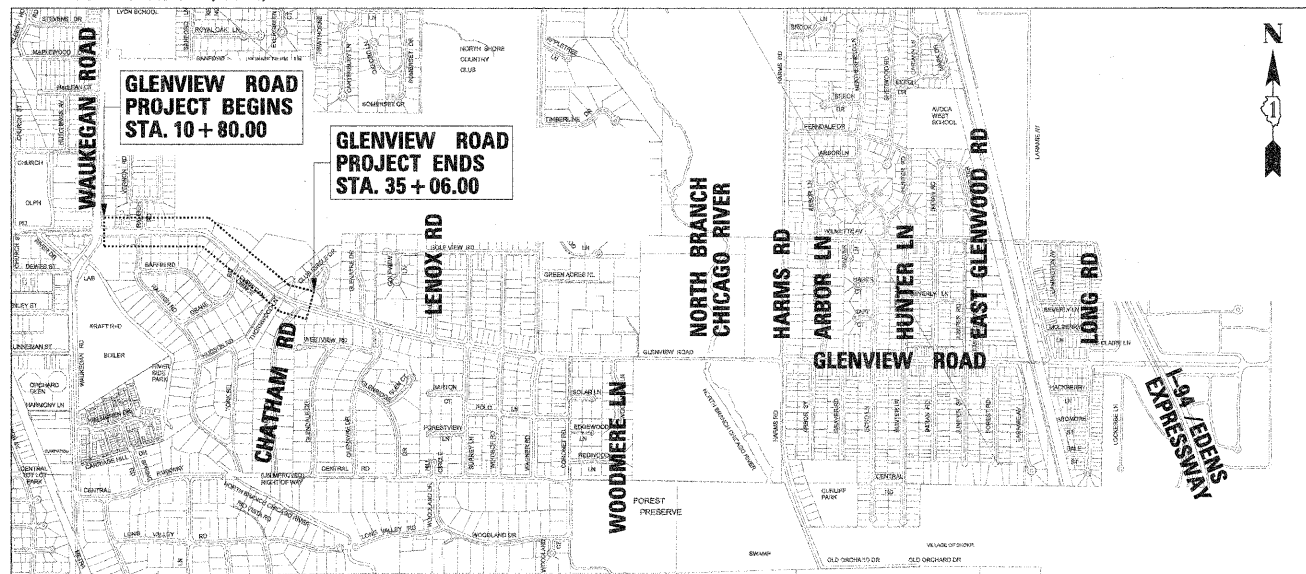

LOCATION MAP

NOT TO SCALE

GROSS LENGTH OF PROJECT = 2,425 LINEAL FEET (0.46 MILES)
NET LENGTH OF PROJECT = 2,425 LINEAL FEET (0.46 MILES)

IL DESIGN FIRM
NO. 184-001310



EXP. 04/30/2011

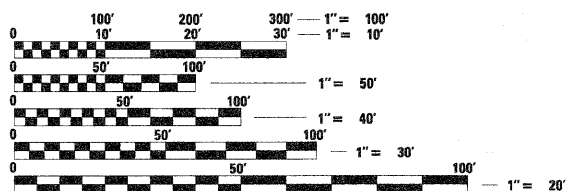

FULL SIZE PLANS HAVE BEEN PREPARED USING STANDARD ENGINEERING SCALES. REDUCED SIZED PLANS WILL NOT CONFORM TO STANDARD SCALES. IN MAKING MEASUREMENTS ON REDUCED PLANS, THE ABOVE SCALES MAY BE USED.

J.U.L.I.E.
JOINT UTILITY LOCATION INFORMATION FOR EXCAVATION
1-800-892-0123
OR 811

CONTRACT NO. 63361

ASSOCIATE FIELD ENGINEER: KEVIN STALLWORTH (847) 705-4169

EXISTING		PROPOSED		EXISTING		PROPOSED	
	WATERMAIN (WM)		VALVE VAULT (VV)		CURB & GUTTER		RIGHT OF WAY (ROW)
	B. BOX		FIRE HYDRANT (FH)		PUBLIC UTILITY EASEMENT		FENCE
	SANITARY SEWER (SANS)		SANITARY MANHOLE (SMH)		SILT FENCE		GUARDRAIL
	CLEAN OUT (CO)		STORM SEWER (SS)		WOODS & BUSH LINE		EVERGREEN TREE
	STORM MANHOLE (STMH)		CATCHBASIN (CB)		DECIDUOUS TREE		SPOT ELEVATIONS
	INLET (INL)		INLET (INL)		SPOT ELEVATIONS		SPOT ELEVATIONS
	CULVERT END SECTION (FES)		INLET (INL)		SPOT ELEVATIONS		SPOT ELEVATIONS
	DITCH FLOW		INLET (INL)		SPOT ELEVATIONS		SPOT ELEVATIONS
	SWALE (DITCH FLOW)		INLET (INL)		SPOT ELEVATIONS		SPOT ELEVATIONS
	PIPE UNDERDRAIN		INLET (INL)		SPOT ELEVATIONS		SPOT ELEVATIONS
	HEADWALL (HW)		INLET (INL)		SPOT ELEVATIONS		SPOT ELEVATIONS
	LINE TO BE ABANDONED		INLET (INL)		SPOT ELEVATIONS		SPOT ELEVATIONS
	GAS PIPE *		INLET (INL)		SPOT ELEVATIONS		SPOT ELEVATIONS
	CABLE TV *		INLET (INL)		SPOT ELEVATIONS		SPOT ELEVATIONS
	TELEPHONE CABLE *		INLET (INL)		SPOT ELEVATIONS		SPOT ELEVATIONS
	ELECTRIC CABLE *		INLET (INL)		SPOT ELEVATIONS		SPOT ELEVATIONS
	LIGHT POLE (LP)		INLET (INL)		SPOT ELEVATIONS		SPOT ELEVATIONS
	TELEPHONE POLE (TP)		INLET (INL)		SPOT ELEVATIONS		SPOT ELEVATIONS
	POWER POLE (PP)		INLET (INL)		SPOT ELEVATIONS		SPOT ELEVATIONS
	MAIL BOX (MB)		INLET (INL)		SPOT ELEVATIONS		SPOT ELEVATIONS
	SIGN		INLET (INL)		SPOT ELEVATIONS		SPOT ELEVATIONS
	TRAFFIC SIGNAL		INLET (INL)		SPOT ELEVATIONS		SPOT ELEVATIONS
	CONTROLLER		INLET (INL)		SPOT ELEVATIONS		SPOT ELEVATIONS
	HAND HOLE		INLET (INL)		SPOT ELEVATIONS		SPOT ELEVATIONS
	CONTOUR		INLET (INL)		SPOT ELEVATIONS		SPOT ELEVATIONS
	SEWER SECTION TO BE REPLACED. DISTANCES ARE MEASURED FROM THE UPSTREAM MANHOLE		INLET (INL)		SPOT ELEVATIONS		SPOT ELEVATIONS
	CULVERT		INLET (INL)		SPOT ELEVATIONS		SPOT ELEVATIONS
	RETAINING WALL (RW)		INLET (INL)		SPOT ELEVATIONS		SPOT ELEVATIONS

NOTE:
 1007 STANDARD 000001 (LATEST EDITION) SHALL BE USED FOR STANDARD SYMBOLS & ABBREVIATIONS NOT INDICATED ON THIS SHEET
 * APPROXIMATE LOCATION ONLY. THE EXACT LOCATIONS TO BE FIELD DETERMINED.

REVISED: 01-01-09 **LEGEND & ABBREVIATIONS**

GENERAL NOTES:

- THE WORK SHALL BE PERFORMED IN ACCORDANCE WITH THE LATEST EDITIONS OF THE IDOT STANDARD SPECIFICATIONS FOR ROAD AND BRIDGE CONSTRUCTION, THE MANUAL ON UNIFORM TRAFFIC CONTROL DEVICES, FHWA, AND THE IDOT HIGHWAY STANDARDS.
- THE CONTRACTOR SHALL MAINTAIN ALL ROADWAYS OPEN TO TRAFFIC AS SHOWN IN THE MAINTENANCE OF TRAFFIC STANDARDS.
- PRIOR TO CONSTRUCTION AND AFTER J.U.L.I.E. LOCATES, THE CONTRACTOR SHALL MEET IN THE FIELD WITH REPRESENTATIVES OF THE VILLAGE OF GLENVIEW AND ENGINEER. NO WORK SHALL BE DONE WITHOUT PRIOR MEETINGS ON THE SITE.
- THE CONTRACTOR SHALL ACQUIRE ANY NECESSARY PERMITS FROM THE VILLAGE OF GLENVIEW.
- THESE NOTES ARE SUPPLEMENTED BY ADDITIONAL NOTES LOCATED ON THE SHEETS.
- THE CONTRACTOR SHALL ENSURE THAT ANY SIGN INSTALLED DOES NOT BLOCK OR OBSCURE ANY EXISTING TRAFFIC SIGN, SIGNAL, OR OTHER TRAFFIC CONTROL DEVICE. IF A SIGN WILL BLOCK OR OBSCURE AN EXISTING TRAFFIC SIGN, SIGNAL, OR OTHER TRAFFIC CONTROL DEVICE, THE ENGINEER SHALL BE CONTACTED BEFORE THAT SIGN IS INSTALLED.
- BEFORE STARTING ANY EXCAVATION, THE CONTRACTOR SHALL CALL J.U.L.I.E. AT (800) 892-0123 OR 811 FOR FIELD LOCATIONS OF BURIED UTILITIES (48 HOURS NOTIFICATION IS REQUIRED).
- THE EXACT LOCATIONS OF TEMPORARY FENCE SHALL BE DETERMINED BY THE ENGINEER IN THE FIELD.
- THE USE OF FERTILIZER NUTRIENTS (NITROGEN, PHOSPHORUS, AND POTASSIUM), AND SUPPLEMENTAL WATERING SHALL BE CONSIDERED INCIDENTAL TO SODDING, SALT TOLERANT.
- A 3-FOOT WIDE STRIP OF TOPSOIL, FURNISH AND PLACE, 4" AND SODDING, SALT TOLERANT SHALL BE PLACED ON EACH SIDE OF CONCRETE SIDEWALK REPLACEMENT, 5". A 3-FOOT WIDE STRIP OF TOPSOIL AND SOD SHALL ALSO BE PLACED ADJACENT TO ALL CONCRETE CURB AND GUTTER REPLACEMENT.
- THE CONTRACTOR SHALL BE RESPONSIBLE FOR THE PROTECTION OF ALL UNDERGROUND AND SURFACE UTILITIES EVEN IF THEY ARE NOT SHOWN ON THE PLANS. ANY UTILITY THAT IS DAMAGED DURING CONSTRUCTION SHALL BE REPAIRED OR REPLACED AT THE CONTRACTOR'S EXPENSE TO THE SATISFACTION OF THE ENGINEER OR THE VILLAGE IN ACCORDANCE WITH 105.07 AND 107.31.
- THE LOCATION OF EXISTING DRAINAGE STRUCTURES AND ANY OTHER PUBLIC UTILITIES AS SHOWN ON THE PLANS IS APPROXIMATE AND THEIR EXACT LOCATION TO BE DETERMINED IN THE FIELD BY THE CONTRACTOR. THIS WORK SHALL BE CONSIDERED AS INCLUDED IN THE UNIT BID PRICES OF THE CONTRACT, AND NO ADDITIONAL COMPENSATION WILL BE ALLOWED. STORM SEWER FIELD REPORTS WILL BE PROVIDED TO THE AWARDED CONTRACTOR.
- THE CONTRACTOR SHALL USE ALL NECESSARY PRECAUTIONS AND PROTECTION MEASURES REQUIRED TO MAINTAIN EXISTING UTILITIES, SEWERS, AND APPURTENANCES THAT MUST BE KEPT IN OPERATION.
- THE CONTRACTOR SHALL ENSURE THAT ALL WATER SYSTEM VALVES, VALVE VAULTS, AND SANITARY SEWER MANHOLES REMAIN READILY ACCESSIBLE TO THE VILLAGE FOR EMERGENCY OPERATIONS. THE LOCATION OF ALL WATER AND SANITARY FACILITIES SHALL BE MARKED AND READILY VISIBLE AT ALL TIMES.
- ANY LOOSE MATERIAL DEPOSITED IN THE FLOW LINE OF DRAINAGE STRUCTURES, WHICH OBSTRUCTS THE NATURAL FLOW OF WATER SHALL BE REMOVED AT THE CLOSE OF EACH WORKING DAY. PRIOR TO THE ACCEPTANCE OF THE IMPROVEMENT, ALL DRAINAGE STRUCTURES SHALL BE FREE OF DIRT AND DEBRIS. THIS WORK WILL NOT BE PAID FOR SEPARATELY, BUT SHALL BE CONSIDERED AS INCLUDED IN THE UNIT BID PRICES OF THE CONTRACT.
- BUTT JOINTS WILL BE INSTALLED AT THE ENDS OF RESURFACING (WHERE RESURFACING MEETS EXISTING PAVEMENT) AS SHOWN ON THE PLANS AND IN ACCORDANCE WITH THE "BUTT JOINT AND HMA TAPER DETAILS" SHEET INCLUDED IN THE PLANS, UNLESS OTHERWISE SPECIFIED BY THE ENGINEER.
- EXISTING PAVEMENT AND DRIVEWAY PAVEMENT TO REMAIN IN PLACE SHALL BE SAW CUT FULL DEPTH TO PROVIDE A NEAR VERTICAL FACE BETWEEN THE PROPOSED AND EXISTING, AND WILL BE CONSIDERED INCIDENTAL TO THE CONTRACT.
- IT WILL BE THE CONTRACTOR'S RESPONSIBILITY TO NOTIFY RESIDENTS AND THE VILLAGE WHEN ACCESS TO THEIR DRIVEWAYS WILL BE TEMPORARILY CLOSED DUE TO DRIVEWAY REPLACEMENT. CONTRACTOR SHALL DISTRIBUTE NOTICES TO THE RESIDENTS. EVERY EFFORT SHALL BE MADE TO ACCOMMODATE ACCESS TO THESE PROPERTIES.
- THE CONTRACTOR WILL BE REQUIRED TO TEMPORARILY RESET ALL SUCH SIGNS THAT INTERFERE WITH CONSTRUCTION OPERATIONS. ALL SUCH SIGNS MUST BE MAINTAINED STRAIGHT AND CLEAN FOR THE DURATION OF THE TEMPORARY SETTING AND MUST BE ERECTED AT A TEMPORARY LOCATION IN A WORKMANLIKE MANNER AND BE VISIBLE TO THE TRAFFIC FOR WHICH INTENDED. THIS WORK WILL NOT BE PAID FOR SEPARATELY, BUT SHALL BE INCLUDED IN THE UNIT BID PRICES OF THE CONTRACT.
- QUANTITIES FOR CLASS D PATCHING AND CURB AND GUTTER REMOVAL AND REPLACEMENT AS WELL AS SIDEWALK REMOVAL AND REPLACEMENT SHALL NOT EXCEED THOSE PROVIDED IN THE SUMMARY OF QUANTITIES UNLESS APPROVED BY THE ENGINEER. LOCATIONS OF CLASS D PATCHING, COMBINATION OF CURB AND GUTTER REMOVAL AND REPLACEMENT, AND SIDEWALK REMOVAL AND REPLACEMENT TO BE DETERMINED IN THE FIELD BY THE ENGINEER.
- THE LOCATION OF EXISTING DETECTOR LOOPS AS SHOWN ON THE PLANS IS APPROXIMATE AND THEIR EXACT LOCATION TO BE DETERMINED IN THE FIELD. LOCATIONS OF THE PROPOSED DETECTOR LOOPS SHALL BE DETERMINED IN ACCORDANCE WITH THE DISTRICT 1 "DETECTOR LOOP INSTALLATION DETAILS FOR ROADWAY RESURFACING" AND APPROVED IN THE FIELD BY THE ENGINEER PRIOR TO FINAL INSTALLATION.

INDEX OF STATE STANDARDS

DRAWING NUMBER	TITLE	DRAWING NUMBER	TITLE
000001-05	STANDARD SYMBOLS, ABBREVIATIONS AND PATTERNS	720001-01	SIGN PANEL MOUNTING DETAILS
424001-05	CURB RAMPS FOR SIDEWALKS	720006-02	SIGN PANEL ERECTION DETAILS
442201-03	CLASS C AND D PATCHES	780001-02	TYPICAL PAVEMENT MARKINGS
701311-03	LANE CLOSURE, 2L, 2W, MOVING OPERATIONS - DAY ONLY	781001-03	TYPICAL APPLICATIONS RAISED REFLECTIVE PAVEMENT MARKERS
701501-05	URBAN LANE CLOSURE, 2L, 2W, UNDIVIDED	886001-01	DETECTOR LOOP INSTALLATIONS
701701-06	URBAN LANE CLOSURE, MULTILANE INTERSECTION	886006-01	TYPICAL LAYOUT FOR DETECTION LOOPS
701801-04	LANE CLOSURE, MULTILANE 1W OR 2W CROSSWALK OR SIDEWALK CLOSURE		
701901-01	TRAFFIC CONTROL DEVICES		

PLOT DATE = #DATES
 USER NAME = #USERS
 PLOT SCALE = #SCALES
 FILE NAME = #FILES

BURNS & McDONNELL
 1431 OPUS PLACE, SUITE 400
 DOWNERS GROVE, IL 60515
 PHONE: (630) 724-3200
 FAX: (630) 724-3201
 WEB: WWW.BURNSMCD.COM

DESIGNED - RB	REVISED -	REVISED -
CHECKED - JMT	REVISED -	REVISED -
DRAWN - RB	REVISED -	REVISED -
CHECKED - 08/19/09	REVISED -	REVISED -

**VILLAGE OF GLENVIEW
 GLENVIEW ROAD RESURFACING
 PROJECT (EAST)**

GENERAL NOTES AND VILLAGE LEGEND

SCALE: SHEET NO. OF SHEETS STA. TO STA.

F.A.U. RITE.	SECTION	COUNTY	TOTAL SHEETS	SHEET NO.
1297	09-00173-00-RS	LAKE	15	2
FED. ROAD DIST. NO.			ILLINOIS FED. AID PROJECT	
CONTRACT NO. 63361				

SUMMARY OF QUANTITIES

ROADWAY 1000-2A					
SP	DDOT PAY ITEM NUMBER	DESCRIPTION	UNIT OF MEASURE	TOTAL QUANTITY	PARTICIPATING
	25000110	SEEDING, CLASS 1A	ACRE	0.03	0.03
	40600100	BITUMINOUS MATERIALS (PRIME COAT)	GALLON	1,100	1,100
	40600300	AGGREGATE (PRIME COAT)	TON	30	30
	40600982	HOT-MIX ASPHALT SURFACE REMOVAL - BUTT JOINT	SQ YD	145	145
	40601005	HOT-MIX ASPHALT REPLACEMENT OVER PATCHES	TON	10	10
	40603340	HOT-MIX ASPHALT SURFACE COURSE, MIX "D", N70	TON	1,350	1,350
	42001300	PROTECTIVE COAT	SQ YD	50	50
	42400800	DETECTABLE WARNINGS	SQ FT	60	60
	44000159	HOT-MIX ASPHALT SURFACE REMOVAL, 2 1/2"	SQ YD	9,450	9,450
	44001700	COMBINATION CONCRETE CURB AND GUTTER REMOVAL AND REPLACEMENT	FOOT	750	750
	44000600	SIDEWALK REMOVAL	SQ FT	500	500
	44200200	PC CONCRETE SIDEWALK 5"	SQ FT	500	500
	44201789	CLASS D PATCHES, TYPE II, 12 INCH	SQ YD	5	5
	44201794	CLASS D PATCHES, TYPE III, 12 INCH	SQ YD	15	15
	44201796	CLASS D PATCHES, TYPE IV, 12 INCH	SQ YD	25	25
	60252800	CATCH BASINS TO BE RECONSTRUCTED	EACH	1	1
	60257900	MANHOLES TO BE RECONSTRUCTED	EACH	1	1
	60262700	INLETS TO BE RECONSTRUCTED	EACH	1	1
	60300305	FRAMES AND LIDS TO BE ADJUSTED	EACH	41	41
	60406500	FRAMES AND LIDS, SPECIAL	EACH	2	2
	67100100	MOBILIZATION	L SUM	1	1
	70102620	TRAFFIC CONTROL AND PROTECTION, STANDARD 701501	L SUM	1	1
	70102635	TRAFFIC CONTROL AND PROTECTION, STANDARD 701701	L SUM	1	1
	70102640	TRAFFIC CONTROL AND PROTECTION, STANDARD 701801	L SUM	1	1
	70300220	TEMPORARY PAVEMENT MARKING - LINE 4"	FOOT	700	700
△	78000100	THERMOPLASTIC PAVEMENT MARKING - LETTERS AND SYMBOLS	SQ FT	150	150

ROADWAY 1000-2A					
SP	DDOT PAY ITEM NUMBER	DESCRIPTION	UNIT OF MEASURE	TOTAL QUANTITY	PARTICIPATING
△	78000200	THERMOPLASTIC PAVEMENT MARKING - LINE 4"	FOOT	5,700	5,700
△	78000400	THERMOPLASTIC PAVEMENT MARKING - LINE 6"	FOOT	930	930
△	78000600	THERMOPLASTIC PAVEMENT MARKING - LINE 12"	FOOT	290	290
△	78000650	THERMOPLASTIC PAVEMENT MARKING - LINE 24"	FOOT	50	50
	78300100	PAVEMENT MARKING REMOVAL	SQ FT	100	100
△	78300200	RAISED REFLECTIVE PAVEMENT MARKER REMOVAL	EACH	100	100
△	88600600	DETECTOR LOOP REPLACEMENT	FOOT	324	324
	X0322256	TEMPORARY INFORMATION SIGNING	SQ FT	52	52
	21101615	TOPSOIL FURNISH AND PLACE, 4"	SQ YD	130	130
	Z0004522	HOT-MIX ASPHALT DRIVEWAY PAVEMENT, 6"	SQ YD	100	100

△ SPECIALTY ITEMS

PLOT DATE = 08/19/09
 USER NAME = RUSBY
 PLOT SCALE = 8/SCALE
 FILE NAME = 07FILEP

Burns & McDonnell
 1431 OPUS PLACE, SUITE 400
 DOWNERS GROVE, IL 60515
 PHONE: (630) 724-3200
 FAX: (630) 724-3201
 WEB: WWW.BURNSMCD.COM

DESIGNED - RB	REVISED -	REVISED -
CHECKED - JMT	REVISED -	REVISED -
DRAWN - RB	REVISED -	REVISED -
CHECKED - 08/19/09	REVISED -	REVISED -

**VILLAGE OF GLENVIEW
 GLENVIEW ROAD RESURFACING
 PROJECT (EAST)**

SUMMARY OF QUANTITIES

SCALE: SHEET NO. OF SHEETS STA. TO STA.

F.A.U. RTE.	SECTION	COUNTY	TOTAL SHEETS	SHEET NO.
1297	09-00173-00-RS	LAKE	15	3
FED. ROAD DIST. NO. ILLINOIS FED. AID PROJECT			CONTRACT NO. 63361	

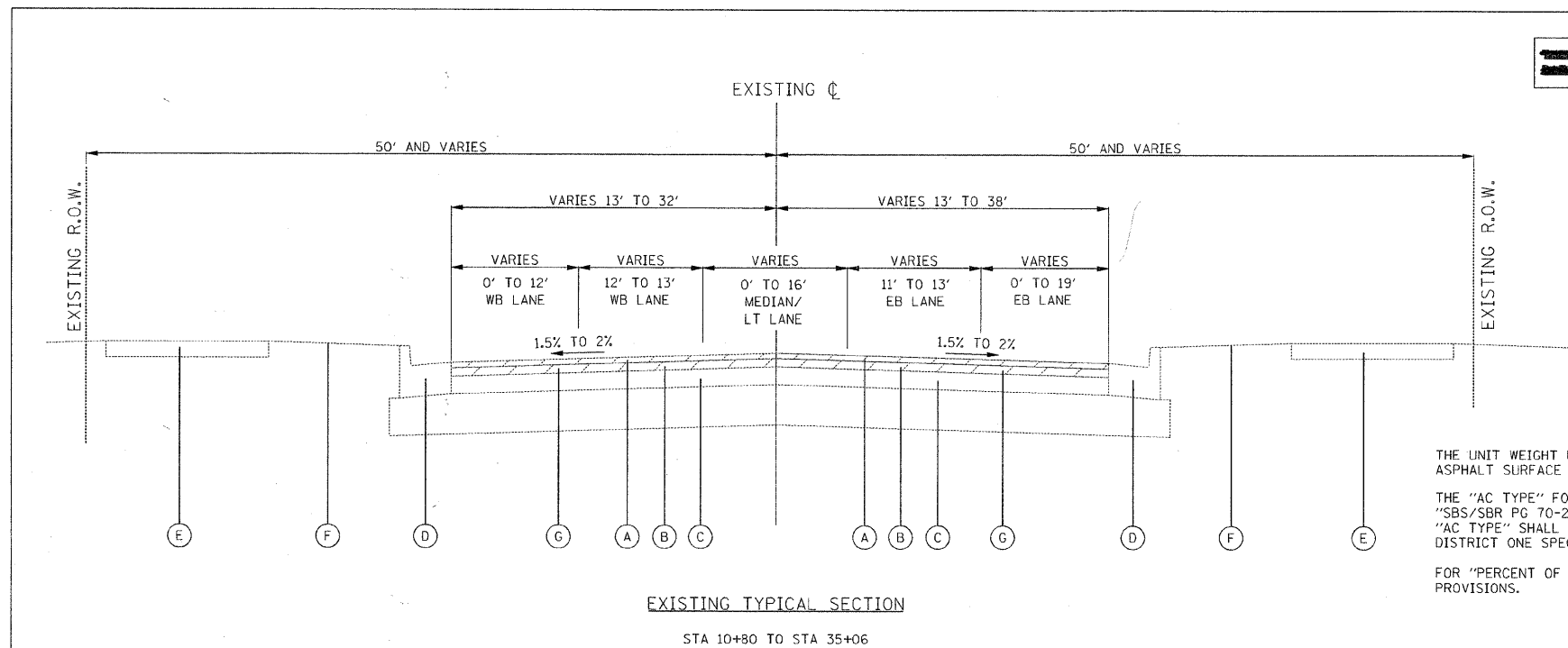

THE UNIT WEIGHT USED TO CALCULATE ALL HOT-MIX ASPHALT SURFACE MIXTURE QUANTITIES IS 112 LB/SY-IN.

THE "AC TYPE" FOR POLYMERIZED HMA MIXES SHALL BE "SBS/SBR PG 70-22" AND FOR NON-POLYMERIZED HMA THE "AC TYPE" SHALL BE "PG 64-22" UNLESS MODIFIED BY DISTRICT ONE SPECIAL PROVISIONS.

FOR "PERCENT OF RAP" SEE DISTRICT ONE SPECIAL PROVISIONS.

- EXISTING LEGEND:**
- (A) EXISTING SURFACE COURSE, 1 1/2"
 - (B) EXISTING BINDER COURSE, 3"
 - (C) EXISTING BASE COURSE, 7 1/2"
 - (D) EXISTING CURB AND GUTTER, TYPE B-6.24
 - (E) EXISTING PCC SIDEWALK
 - (F) EXISTING LANDSCAPED PARKWAY
 - (G) HOT-MIX ASPHALT SURFACE REMOVAL, 2 1/2"

- PROPOSED LEGEND:**
- (1) HOT-MIX ASPHALT SURFACE COURSE, MIX "D", N70, 2 1/2"
 - (2) CLASS "D" PATCHES

HOT-MIX ASPHALT MIXTURE REQUIREMENTS

ITEM	VOIDS
RESURFACING	
HOT-MIX ASPHALT SURFACE COURSE, MIX "D", N70, 2 1/2" (IL 9.5mm)	4% @ 70 GYR.
PATCHING	
CLASS D PATCHES (HMA BINDER IL-19 mm)	4% @ 70 GYR.
HOT-MIX ASPHALT REPLACEMENT OVER PATCHES	4% @ 70 GYR.
HMA DRIVEWAY REPLACEMENT	
HOT-MIX ASPHALT SURFACE COURSE, MIX "C", N50, (IL-9.5mm), 2"	4% @ 50 GYR.
HOT-MIX ASPHALT BASE COURSE (HMA BINDER IL-19mm), 4"	4% @ 50 GYR.

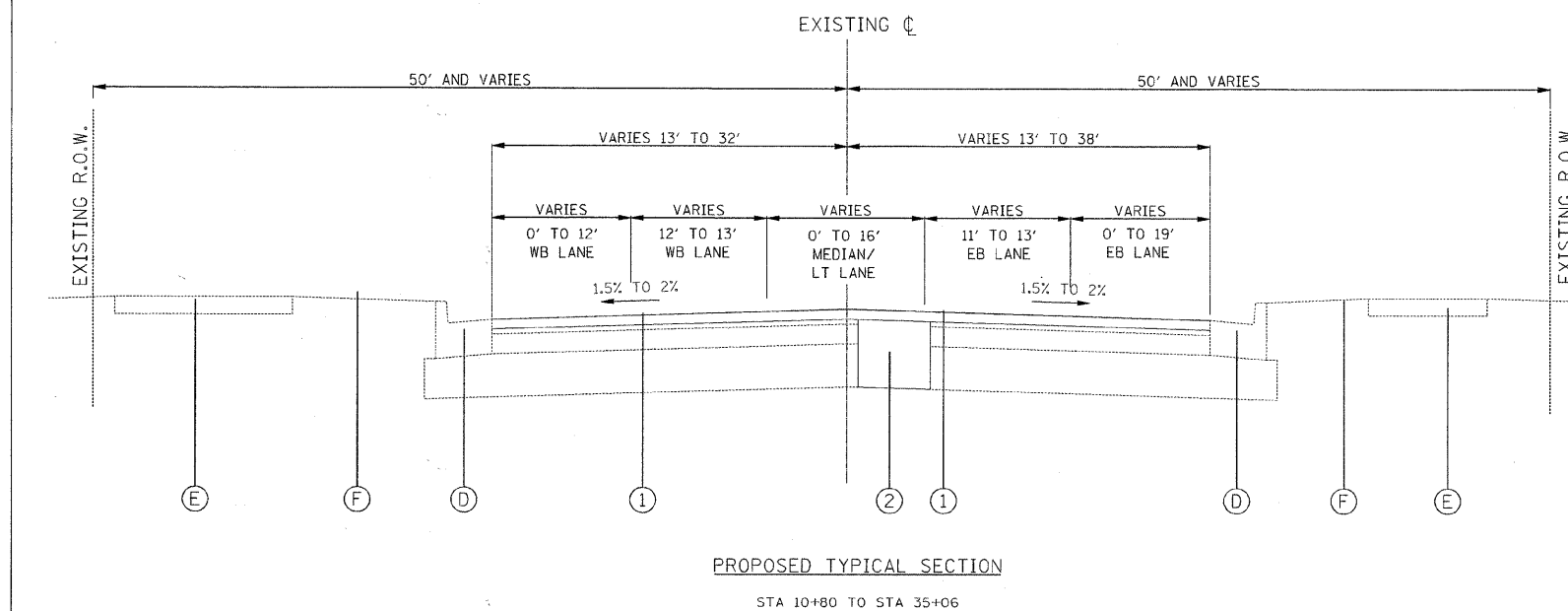

SIZE AND LOCATION OF DETECTOR LOOPS SHALL BE FIELD VERIFIED. REPLACEMENT SHALL BE INSTALLED IN ACCORDANCE WITH IDOT DISTRICT ONE STANDARD TS-07 FOR DETECTOR LOOP INSTALLATION DETAILS FOR ROADWAY RESURFACING. SEE SHEET 17.

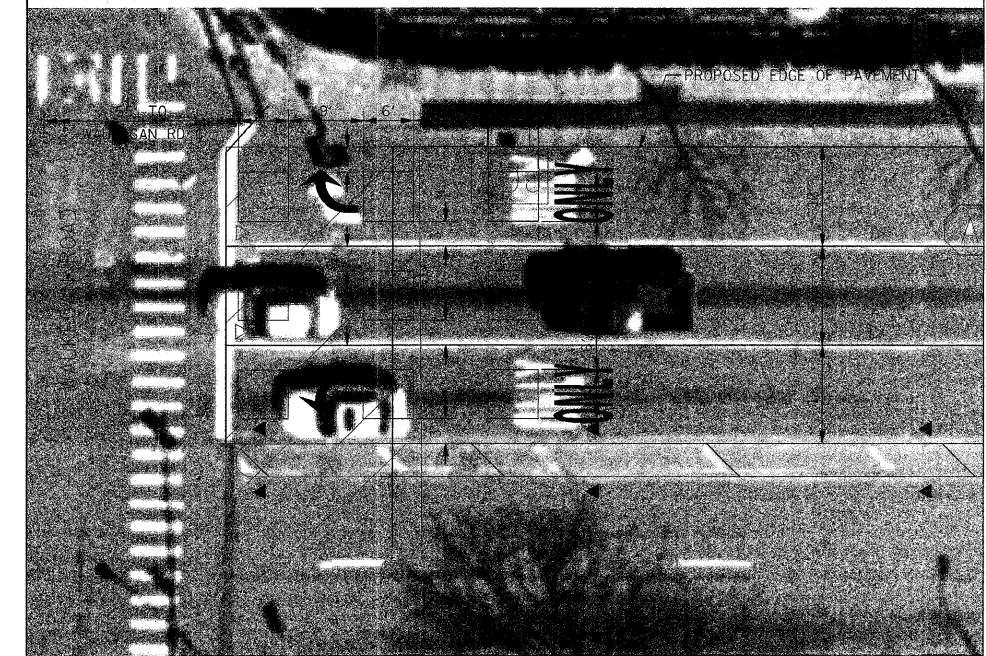

PLOT DATE * * * * *
USER NAME * * * * *
PLOT SCALE * * * * *
FILE NAME * * * * *

Burns & McDonnell
1431 OPUS PLACE, SUITE 400
DOWNERS GROVE, IL 60515
PHONE: (630) 724-3200
FAX: (630) 724-3201
WEB: WWW.BURNSMCD.COM

DESIGNED - RB	REVISED -	REVISED -
CHECKED - JMT	REVISED -	REVISED -
DRAWN - RB	REVISED -	REVISED -
CHECKED - 08/19/09	REVISED -	REVISED -

**VILLAGE OF GLENVIEW
GLENVIEW ROAD RESURFACING
PROJECT (EAST)**

TYPICAL SECTIONS

SCALE:	SHEET NO.	OF SHEETS	STA.	TO STA.
--------	-----------	-----------	------	---------

F.A.U. RTE.	SECTION	COUNTY	TOTAL SHEETS	SHEET NO.
1297	09-00173-00-RS	LAKE	18	4
FED. ROAD DIST. NO.			ILLINOIS FED. AID PROJECT	
			CONTRACT NO. 63361	

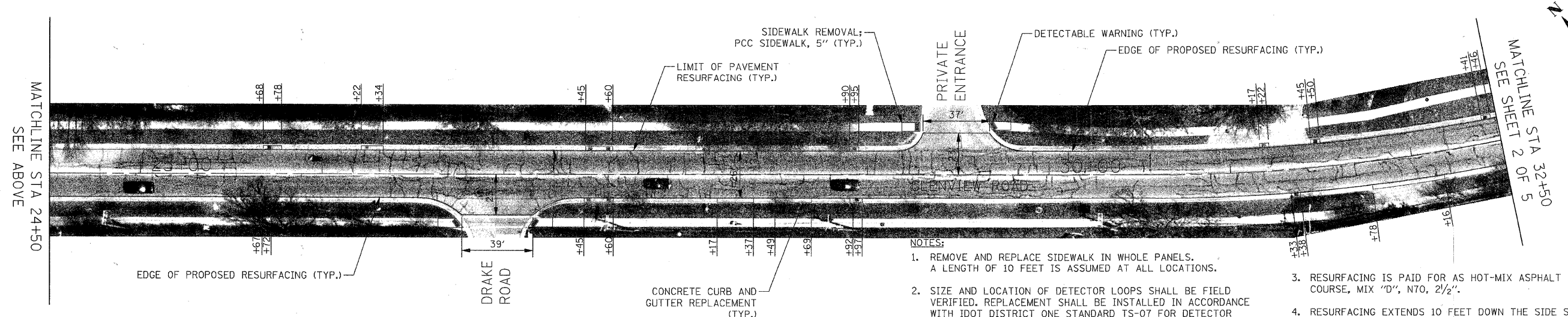
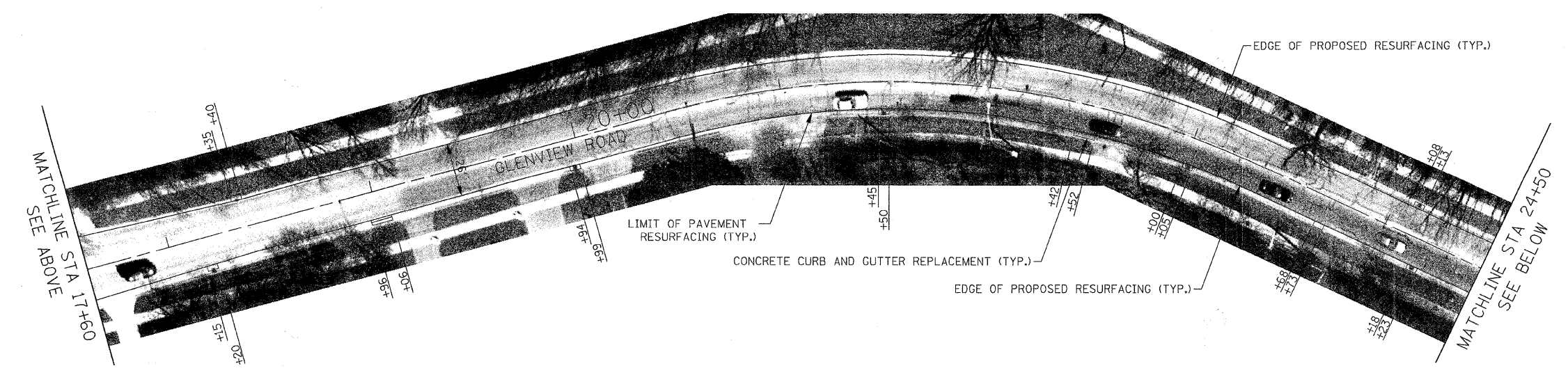
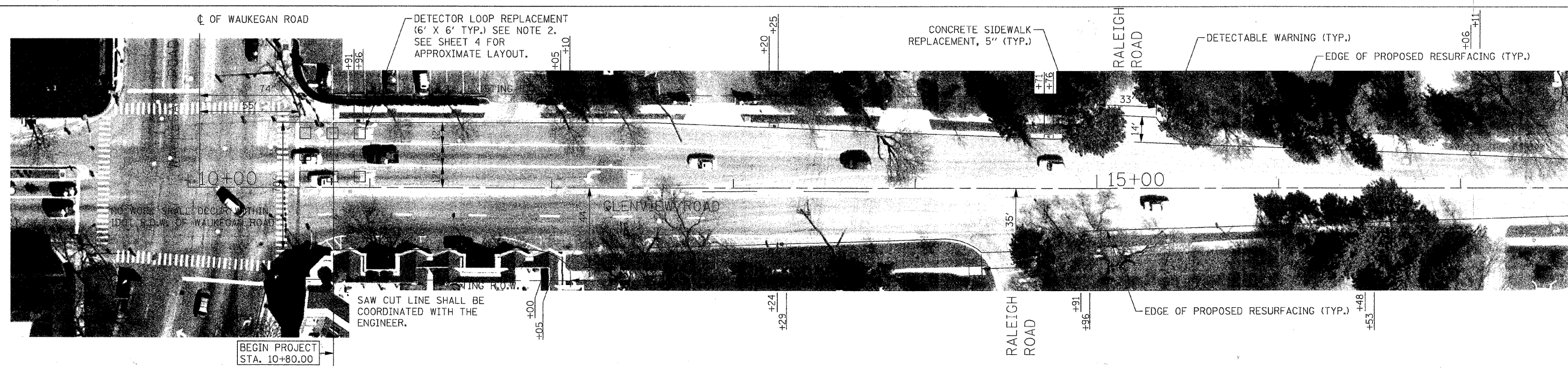

- NOTES:**
1. REMOVE AND REPLACE SIDEWALK IN WHOLE PANELS. A LENGTH OF 10 FEET IS ASSUMED AT ALL LOCATIONS.
 2. SIZE AND LOCATION OF DETECTOR LOOPS SHALL BE FIELD VERIFIED. REPLACEMENT SHALL BE INSTALLED IN ACCORDANCE WITH IDOT DISTRICT ONE STANDARD TS-07 FOR DETECTOR LOOP INSTALLATION DETAILS FOR ROADWAY RESURFACING. SEE SHEET 17.
 3. RESURFACING IS PAID FOR AS HOT-MIX ASPHALT SURFACE COURSE, MIX "D", N70, 2 1/2".
 4. RESURFACING EXTENDS 10 FEET DOWN THE SIDE STREETS UNLESS OTHERWISE NOTED.

PLOT DATE = #DATE#
 USER NAME = #USER#
 PLOT SCALE = #SCALE#
 FILE NAME = #FILE#

Burns & McDonnell
 1431 OPUS PLACE, SUITE 400
 DOWNERS GROVE, IL 60515
 PHONE: (630) 724-3200
 FAX: (630) 724-3201
 WEB: WWW.BURNSMCD.COM

DESIGNED - RB	REVISED -	REVISED -
CHECKED - JMT	REVISED -	REVISED -
DRAWN - RB	REVISED -	REVISED -
CHECKED - 08/19/09	REVISED -	REVISED -

**VILLAGE OF GLENVIEW
 GLENVIEW ROAD RESURFACING
 PROJECT (EAST)**

PROPOSED RESURFACING PLAN
 SCALE: 1"=30' SHEET NO. 1 OF 5 SHEETS STA. 10+00.00 TO STA. 32+50.00

F.A.J. RTE.	SECTION	COUNTY	TOTAL SHEETS	SHEET NO.
1297	09-00173-00-RS	LAKE	16	5
CONTRACT NO. 63361			ILLINOIS FED. AID PROJECT	

NOTES:

1. REMOVE AND REPLACE SIDEWALK IN WHOLE PANELS. A LENGTH OF 10 FEET IS ASSUMED AT ALL LOCATIONS.
2. FOLLOW IDOT DISTRICT ONE STANDARD TS-07 FOR DETECTOR LOOP INSTALLATION DETAILS FOR ROADWAY RESURFACING.
3. RESURFACING IS PAID FOR AS HOT-MIX ASPHALT SURFACE COURSE, MIX "D", N70, 2 1/2".
4. RESURFACING EXTENDS 10 FEET DOWN THE SIDE STREETS UNLESS OTHERWISE NOTED.

MATCHLINE STA 32+50
SEE SHEET 1 OF 5

EDGE OF PROPOSED RESURFACING (TYP.)

CONCRETE SIDEWALK REPLACEMENT, 5" (TYP.)
DETECTABLE WARNING (TYP.)

END PROJECT STA. 35+06.00

NOT INCLUDED IN THIS CONTRACT.



MATCHLINE STA 40+50
SEE BELOW

MATCHLINE STA 40+50
SEE ABOVE

NOT INCLUDED IN THIS CONTRACT.

MATCHLINE STA 48+50
SEE BELOW



NOT INCLUDED IN THIS CONTRACT.

MATCHLINE STA 48+50
SEE ABOVE

MATCHLINE STA 56+50
SEE SHEET 3 OF 5



PLOT DATE = #DATE#
USER NAME = #USER#
PLOT SCALE = #SCALE#
FILE NAME = #FILE#

Burns & McDonnell
1431 OPIUS PLACE, SUITE 400
DOWNERS GROVE, IL 60515
PHONE: (630) 724-3200
FAX: (630) 724-3201
WEB: WWW.BURNSMCD.COM

DESIGNED - RB	REVISED -	REVISED -
CHECKED - JMT	REVISED -	REVISED -
DRAWN - RB	REVISED -	REVISED -
CHECKED - 08/19/09	REVISED -	REVISED -

**VILLAGE OF GLENVIEW
GLENVIEW ROAD RESURFACING
PROJECT (EAST)**

PROPOSED RESURFACING PLAN

SCALE: 1"=30' SHEET NO. 2 OF 5 SHEETS STA. 32+50.00 TO STA. 56+50.00

F.A.U. RTE.	SECTION	COUNTY	TOTAL SHEETS	SHEET NO.
1297	09-00173-00-RS	LAKE	18	6
FED. ROAD DIST. NO.			ILLINOIS FED. AID PROJECT	
			CONTRACT NO. 63361	

ADVANCE WARNING SIGNS PER IDOT STANDARDS AND TEMPORARY INFORMATION SIGNING SPECIFICATIONS.

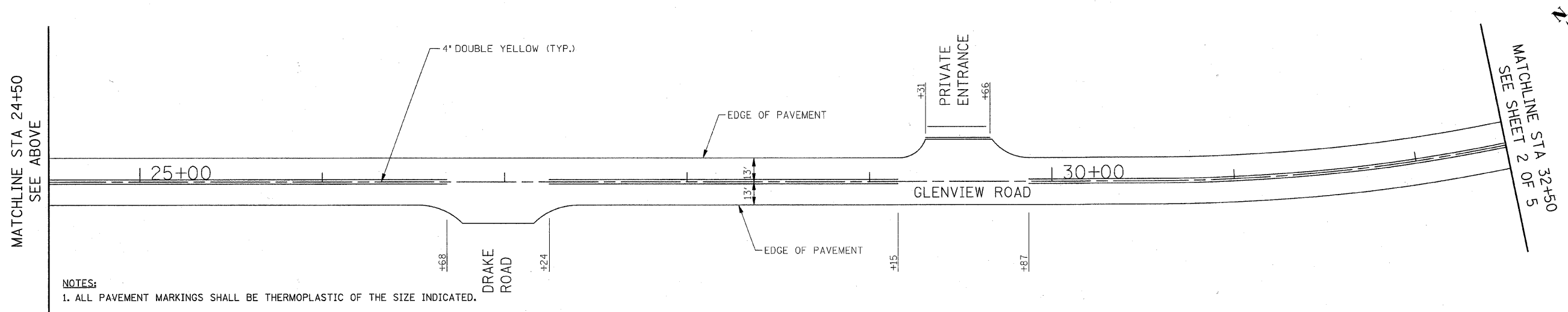
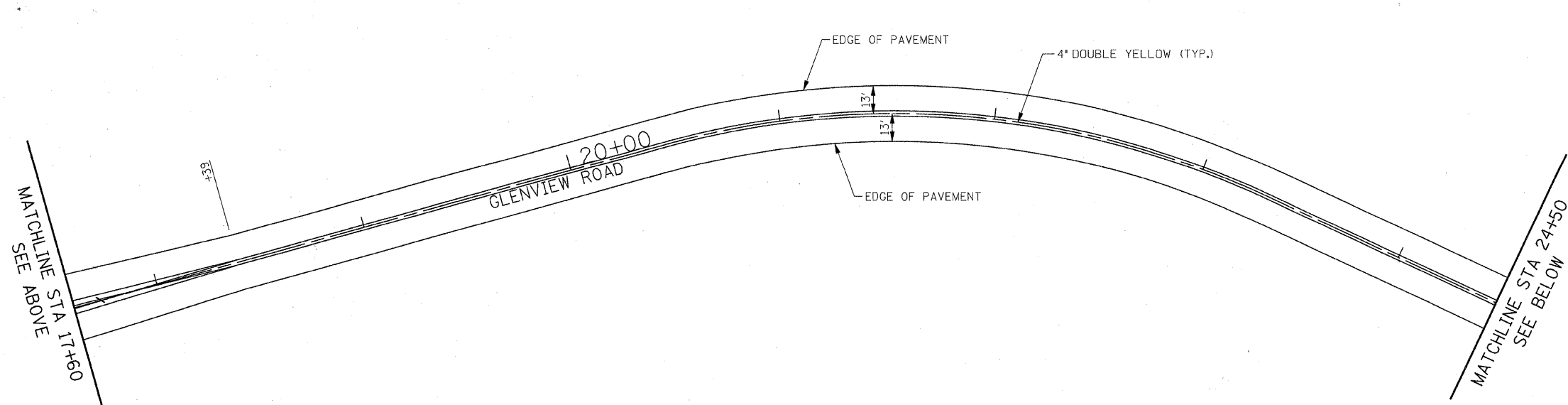
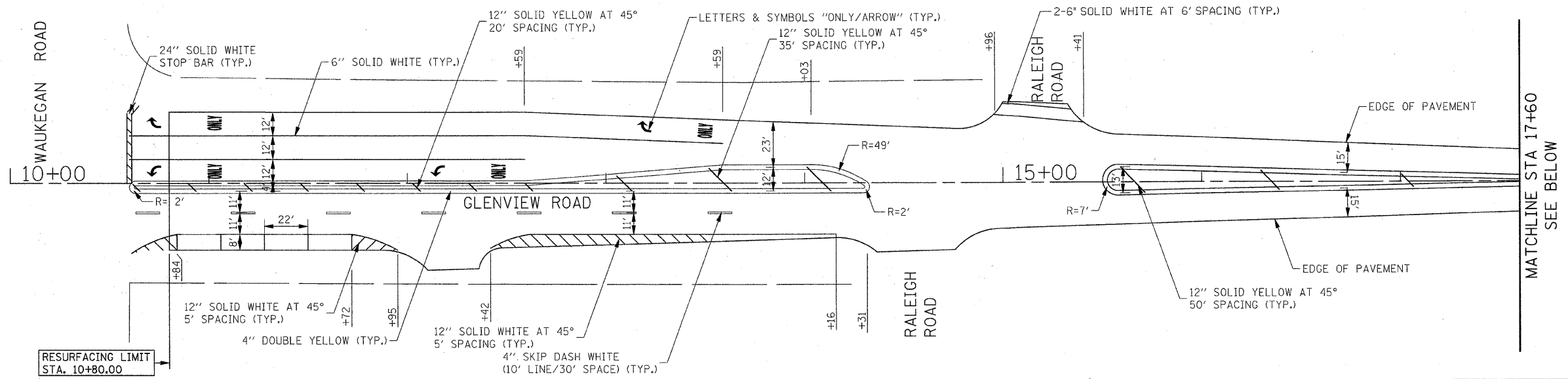

NOTES:
1. ALL PAVEMENT MARKINGS SHALL BE THERMOPLASTIC OF THE SIZE INDICATED.

PLOT DATE = 08/19/09
USER NAME = RUSFER
PLOT SCALE = AS CALLED
FILE NAME = 63361.dwg

Burns & McDonnell
1431 OPUS PLACE, SUITE 400
DOWNERS GROVE, IL 60515
PHONE: (630) 724-3200
FAX: (630) 724-3201
WEB: WWW.BURNSMCD.COM

DESIGNED - RB	REVISED -	REVISED -
CHECKED - JMT	REVISED -	REVISED -
DRAWN - RB	REVISED -	REVISED -
CHECKED - 08/19/09	REVISED -	REVISED -

**VILLAGE OF GLENVIEW
GLENVIEW ROAD RESURFACING
PROJECT (EAST)**

PROPOSED PAVEMENT MARKING AND SIGNING PLAN

SCALE: 1"=30' SHEET NO. 1 OF 5 SHEETS STA. 10+00.00 TO STA. 32+50.00

F.A.U. RTE.	SECTION	COUNTY	TOTAL SHEETS	SHEET NO.
1297	09-00173-00-RS	LAKE	8	7
FED. ROAD DIST. NO. [ILLINOIS] FED. AID PROJECT				
CONTRACT NO. 63361				

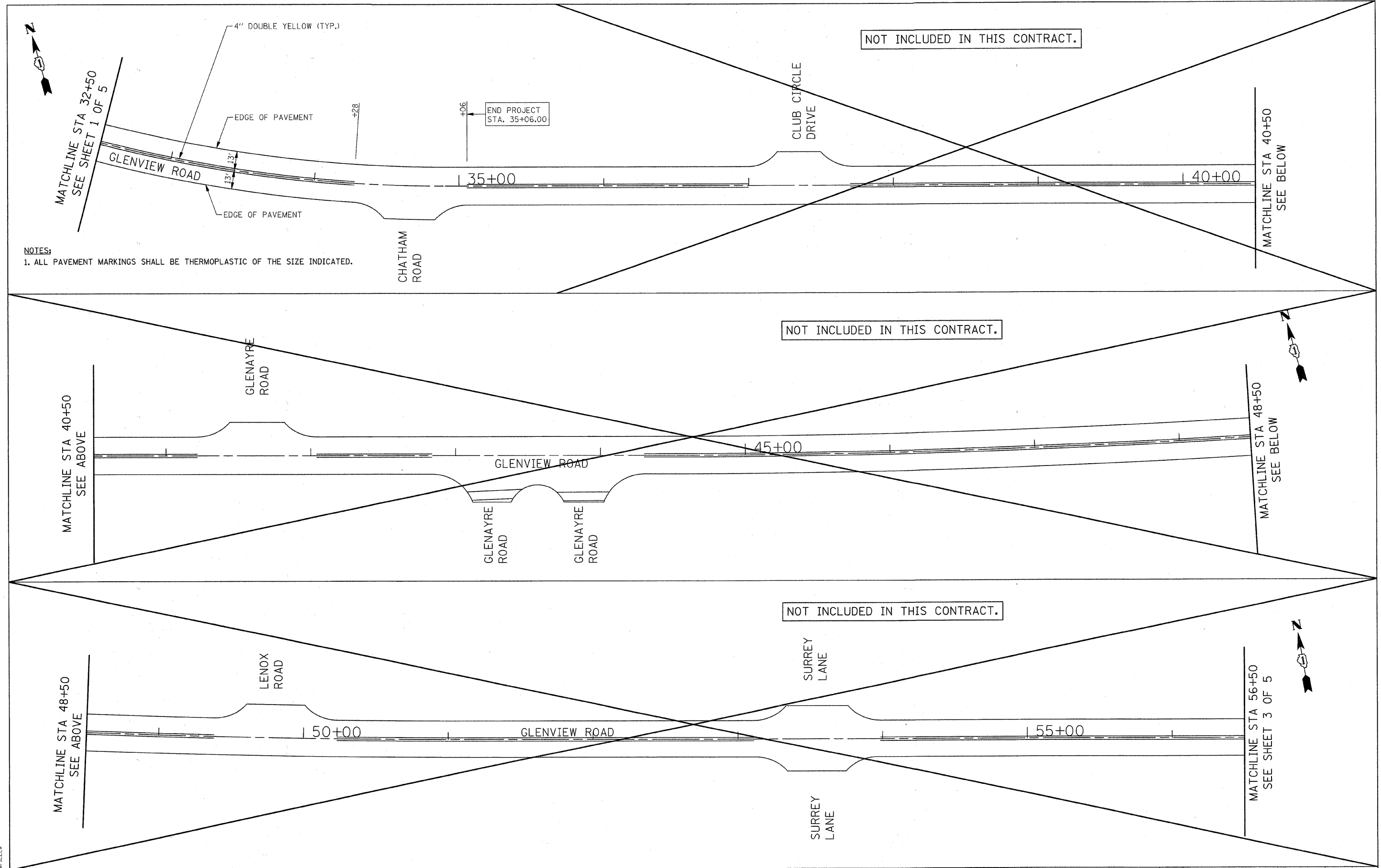

NOTES:
 1. ALL PAVEMENT MARKINGS SHALL BE THERMOPLASTIC OF THE SIZE INDICATED.

PLOT DATE = #DATE#
 USER NAME = #USER#
 PLOT SCALE = #SCALE#
 FILE NAME = #FILE#

Burns & McDonnell
 1431 OPUS PLACE, SUITE 400
 DOWNERS GROVE, IL 60515
 PHONE: (630) 724-3200
 FAX: (630) 724-3201
 WEB: WWW.BURNSMCD.COM

DESIGNED - RB	REVISED -	REVISED -
CHECKED - JMT	REVISED -	REVISED -
DRAWN - RB	REVISED -	REVISED -
CHECKED - 08/19/09	REVISED -	REVISED -

**VILLAGE OF GLENVIEW
 GLENVIEW ROAD RESURFACING
 PROJECT (EAST)**

PROPOSED PAVEMENT MARKING AND SIGNING PLAN
 SCALE: 1"=30' SHEET NO. 2 OF 5 SHEETS STA. 32+50.00 TO STA. 56+50.00

F.A.U. RTE.	SECTION	COUNTY	TOTAL SHEETS	SHEET NO.
1297	09-00173-00-RS	LAKE	18	8
FED. ROAD DIST. NO.		ILLINOIS FED. AID PROJECT		
		CONTRACT NO. 63361		

U-1

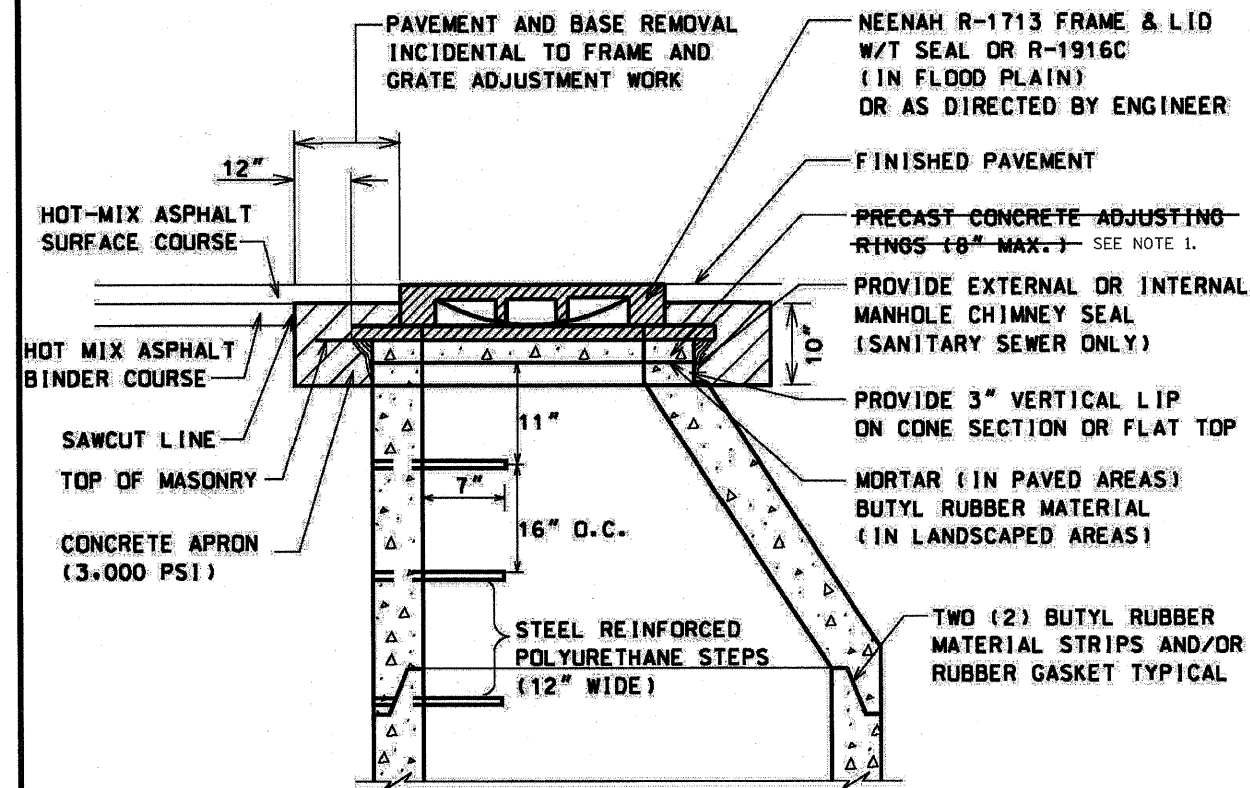

NOTE:

THE REQUIRED MANHOLE FRAME AND GRATE ADJUSTMENTS, DUE TO THE PAVEMENT RESURFACING, INCLUDING POURING OF CONCRETE APRON, SHALL BE PERFORMED BEFORE PLACING HOT-MIX ASPHALT SURFACE COURSE.

NOTE 1.
CONTRACTOR SHALL USE HIGH DENSITY POLYETHYLENE (HDPE) PLASTIC ADJUSTING RINGS IN ACCORDANCE WITH THE APPLICABLE SECTIONS OF THE IDOT STANDARD SPECIFICATIONS, INCLUDING SECTION 1043.02.

NOT TO SCALE

**STRUCTURE
FRAME & GRATE
ADJUSTMENT
DETAIL**

REVISED: 01-01-09

U-6

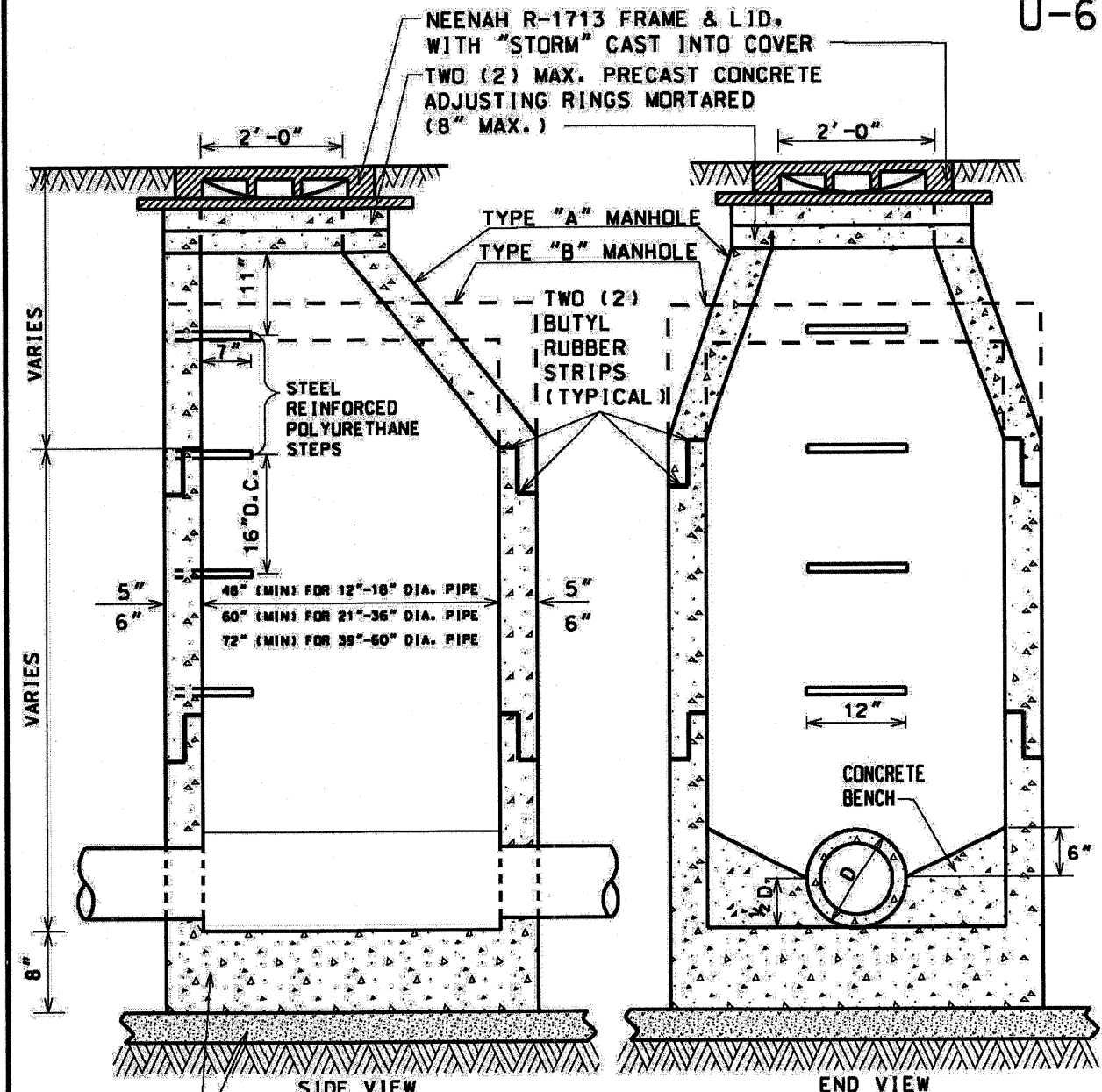

NOTES:

1. MANHOLES MUST CONFORM TO ASTM C-478.
 2. MANHOLE SECTIONS TO BE TONGUE AND GROOVED.
 3. BENCHES MUST BE PROVIDED IN ALL STORM SEWER MANHOLES.
 4. ALL PIPE PENETRATIONS OCCURRING WITHIN (OR BELOW) GROUNDWATER TABLE AND ALL NON-PRECAST OPENINGS SHALL BE CORED, RUBBER BOOTED AND INTERIOR MORTARED AROUND PIPE.*
 5. USE ECCENTRIC CONE ONLY.
- * SEE PIPE CONNECTION TO STRUCTURE DETAIL U-5.

NOT TO SCALE

**STORM
MANHOLE
DETAIL**

REVISED: 01-01-09

PLOT DATE = 08/19/09
USER NAME = RUSBY
PLOT SCALE = 8/16/09
FILE NAME = 8/16/09

Burns & McDonnell
1431 OPUS PLACE, SUITE 400
DOWNERS GROVE, IL 60515
PHONE: (630) 724-3200
FAX: (630) 724-3201
WEB: WWW.BURNSMCD.COM

DESIGNED - RB	REVISED -	REVISED -
CHECKED - JMT	REVISED -	REVISED -
DRAWN - RB	REVISED -	REVISED -
CHECKED - 08/19/09	REVISED -	REVISED -

**VILLAGE OF GLENVIEW
GLENVIEW ROAD RESURFACING
PROJECT (EAST)**

VILLAGE OF GLENVIEW STANDARD DETAILS

SCALE: SHEET NO. 1 OF 2 SHEETS STA. TO STA.

F.A.U. RTE. 1297	SECTION 09-00173-00-RS	COUNTY LAKE	TOTAL SHEETS 18	SHEET NO. 9
FED. ROAD DIST. NO. ILLINOIS FED. AID PROJECT CONTRACT NO. 63361				

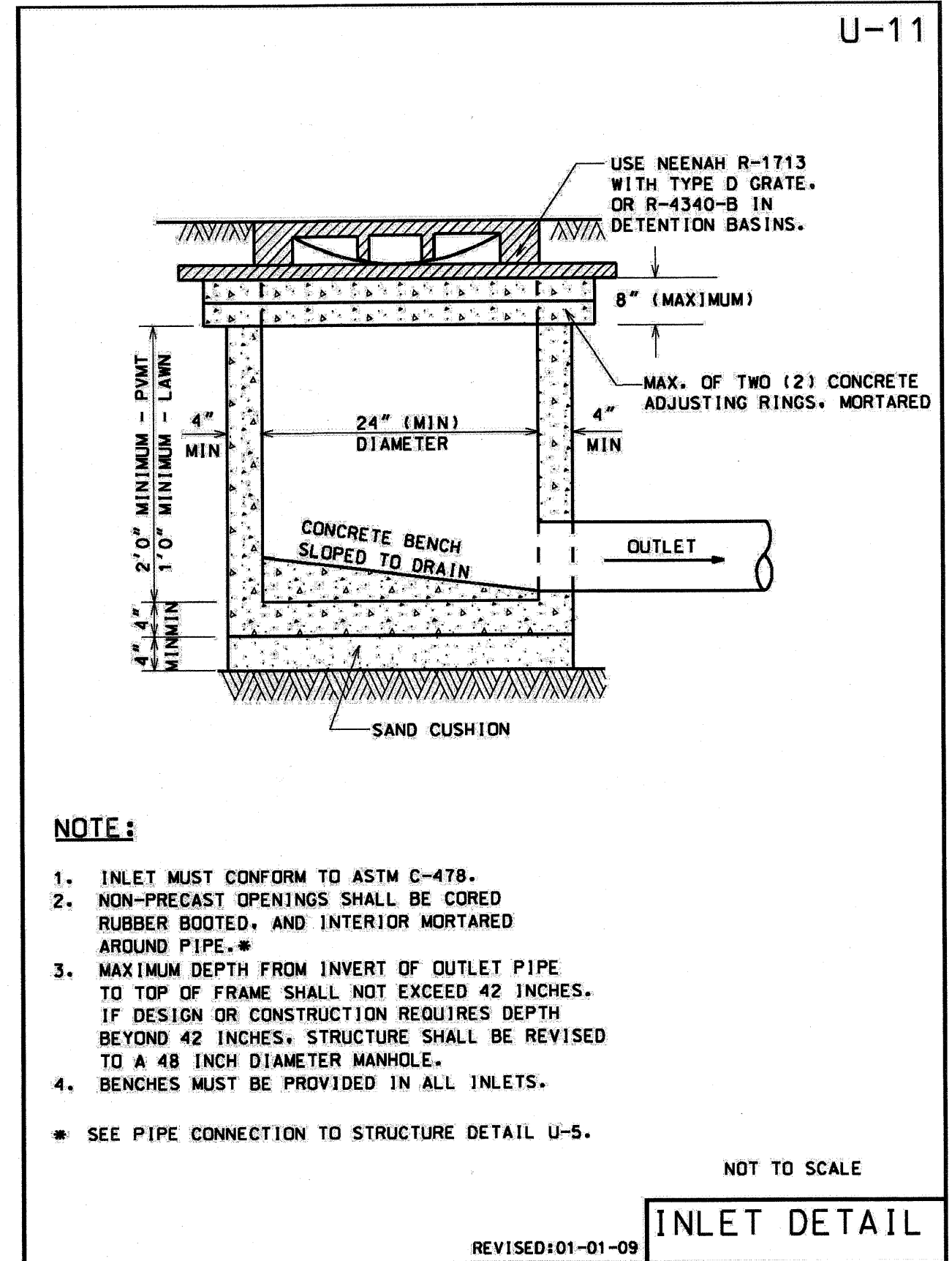
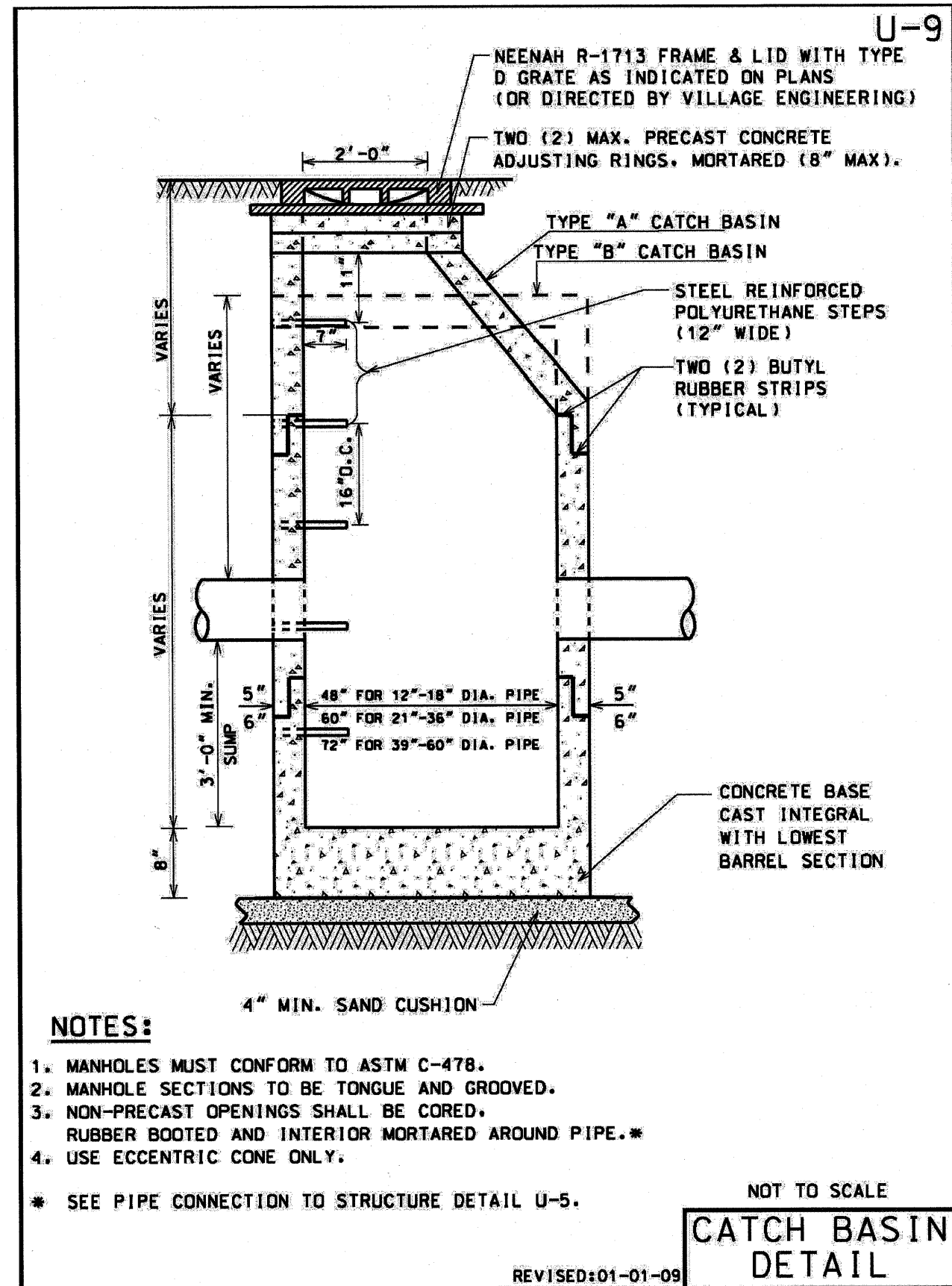

PLOT DATE = #DATE#
 USER NAME = #USER#
 PLOT SCALE = #SCALE#
 FILE NAME = #FILE#



1431 OPIUS PLACE, SUITE 400
 DOWNERS GROVE, IL 60515
 PHONE: (630) 724-3200
 FAX: (630) 724-3201
 WEB: WWW.BURNSMCD.COM

DESIGNED - RB	REVISED -	REVISED -
CHECKED - JMT	REVISED -	REVISED -
DRAWN - RB	REVISED -	REVISED -
CHECKED - 08/19/09	REVISED -	REVISED -

VILLAGE OF GLENVIEW
 GLENVIEW ROAD RESURFACING
 PROJECT (EAST)

VILLAGE OF GLENVIEW STANDARD DETAILS

SCALE: SHEET NO. 1 OF 2 SHEETS STA. TO STA.

F.A.U. RTE.	SECTION	COUNTY	TOTAL SHEETS	SHEET NO.
1297	09-00173-00-RS	LAKE	18	10
FED. ROAD DIST. NO. [ILLINOIS] FED. AID PROJECT			CONTRACT NO. 63361	

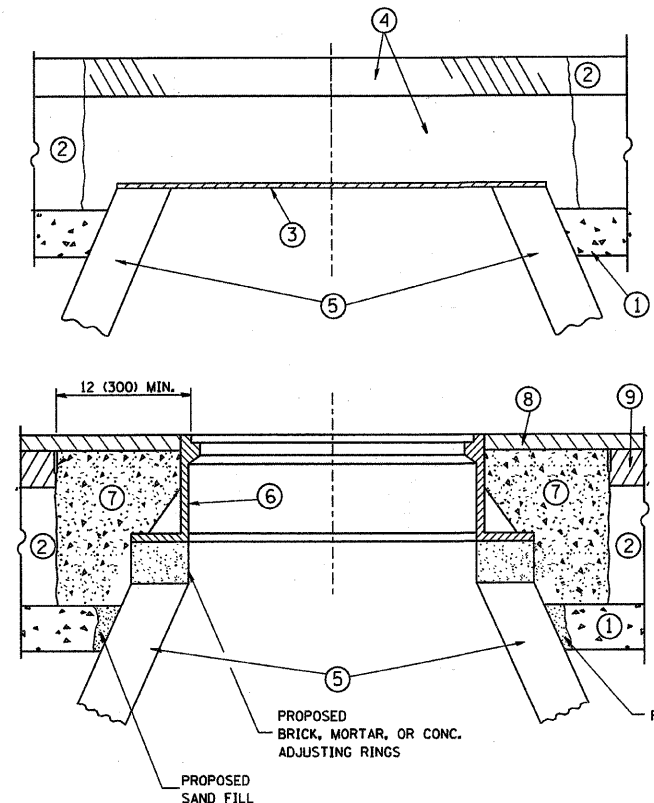

CONSTRUCTION PROCEDURES

- STAGE 1 (BEFORE PAVEMENT MILLING)**
- A) REMOVE A MINIMUM OF 12 (300) OF THE PAVEMENT FROM AROUND THE STRUCTURE.
 - B) REMOVE THE EXISTING FRAME AND LID FROM THE STRUCTURE.
 - C) COVER THE STRUCTURE OPENING WITH A 36 (900) DIAMETER METAL PLATE.
 - D) BACKFILL WITH CRUSHED STONE AND A MINIMUM 1 1/2 (40) THICK HMA SURFACE MIX APPROVED BY THE ENGINEER.
- STAGE 2 (AFTER PAVEMENT MILLING)**
- A) REMOVE THE HMA SURFACE MIX AND CRUSHED STONE.
 - B) INSTALL THE FRAME AND LID; ADJUST THE FRAME TO ITS FINAL SURFACE ELEVATION.
 - C) THE SURROUNDING SPACE SHALL BE FILLED WITH CLASS SI CONCRETE, OR HMA SURFACE COURSE OR HMA BINDER COURSE TO THE ELEVATION OF THE SURFACE OF THE EXISTING BASE COURSE OR THE BINDER COURSE.

THE PROCEDURE EXPLAINED ABOVE SHALL CONFORM TO THE APPLICABLE PORTIONS OF SECTIONS 353, 406, 602, AND 603 OF THE STANDARD SPECIFICATIONS.

LEGEND

- ① SUB-BASE GRANULAR MATERIAL
- ⑥ FRAME AND LID (SEE NOTES)
- ② EXISTING PAVEMENT
- ⑦ CLASS SI CONCRETE, HMA SURFACE COURSE OR HMA BINDER COURSE
- ③ 36 (900) DIAMETER METAL PLATE
- ⑧ PROPOSED CRUSHED STONE AND HMA SURFACE MIX
- ④ PROPOSED CRUSHED STONE AND HMA SURFACE MIX
- ⑨ PROPOSED HMA BINDER COURSE
- ⑤ EXISTING STRUCTURE

LOCATION OF STRUCTURES:

THE CONTRACTOR WILL BE REQUIRED TO KEEP A RECORD OF THE LOCATIONS OF THE BURIED STRUCTURES ACCORDING TO THE STATION AND DISTANCE LEFT OR RIGHT OF THE CENTERLINE OF PAVEMENT. UPON COMPLETION OF THE WORK, THE CONTRACTOR WILL DELIVER THE RECORD TO THE ENGINEER.

BASIS OF PAYMENT: THIS WORK WILL BE PAID FOR AT THE CONTRACT UNIT PRICE PER EACH FOR "FRAMES AND LIDS TO BE ADJUSTED, SPECIAL"
NEW FRAMES AND LIDS, WHEN SPECIFIED, WILL BE PAID FOR SEPARATELY.

NOTES:

EXISTING BROKEN FRAMES AND LIDS SHALL BE REMOVED AND DISPOSED OF BY THE CONTRACTOR AND SHALL BE REPLACED AS DIRECTED BY THE ENGINEER. REPLACEMENT FRAMES AND LIDS WILL BE PAID FOR IN ACCORDANCE WITH ARTICLE 109.04 OF THE STANDARD SPECIFICATIONS UNLESS A SEPARATE PAY ITEM HAS BEEN PROVIDED.

IF THE EXISTING LIDS ARE OPEN, THE FRAME WILL BE ADJUSTED TO THE ELEVATION OF THE MILLED PAVEMENT SURFACE PRIOR TO THE MILLING OPERATION. THE FRAME WILL NOT BE REMOVED AND COVERED BY THE METAL PLATE.

CITY OF CHICAGO CASTINGS ARE THE PROPERTY OF THE CITY AND THE CONTRACTOR SHALL NOTIFY THE CITY FOR REMOVAL AND DISPOSITION OF THE CASTINGS.

THE METAL PLATE USED TO COVER THE STRUCTURE SHALL REMAIN THE PROPERTY OF THE CONTRACTOR.

WHEN STRUCTURES ARE TO BE ADJUSTED OR RECONSTRUCTED, THE LOWERING AND RAISING OF THE FRAMES AND LIDS WILL NOT BE PAID FOR SEPARATELY BUT WILL BE INCLUDED IN THE COST OF THE CORRESPONDING PAY ITEM.

DETAILS FOR FRAMES AND LIDS ADJUSTMENT WITH MILLING

ALL DIMENSIONS ARE IN INCHES (MILLIMETERS) UNLESS OTHERWISE SHOWN

FILE NAME = W:\dststd\22x34\bd08.dgn	USER NAME = goglionobt	DESIGNED - R. SHAH	REVISED - R. SHAH 03-10-95	STATE OF ILLINOIS DEPARTMENT OF TRANSPORTATION	DETAILS FOR FRAMES AND LIDS ADJUSTMENT WITH MILLING	F.A.D. RTE. 1297	SECTION 09-00173-00-RS	COUNTY LAKE	TOTAL SHEETS 18	SHEET NO. 11
		DRAWN -	REVISED - A. ABBAS 03-21-97		SCALE: NONE	SHEET NO. 1 OF 1 SHEETS	STA. TO STA.	BD600-03 (BD-8) CONTRACT NO. 63361 FED. ROAD DIST. NO. 1 ILLINOIS FED. AID PROJECT		
	PLOT SCALE = 50.0000' / IN.	CHECKED -	REVISED - R. WIEDEMAN 05-14-04							
	PLOT DATE = 1/4/2008	DATE - 10-25-94	REVISED - R. BORO 01-01-07							

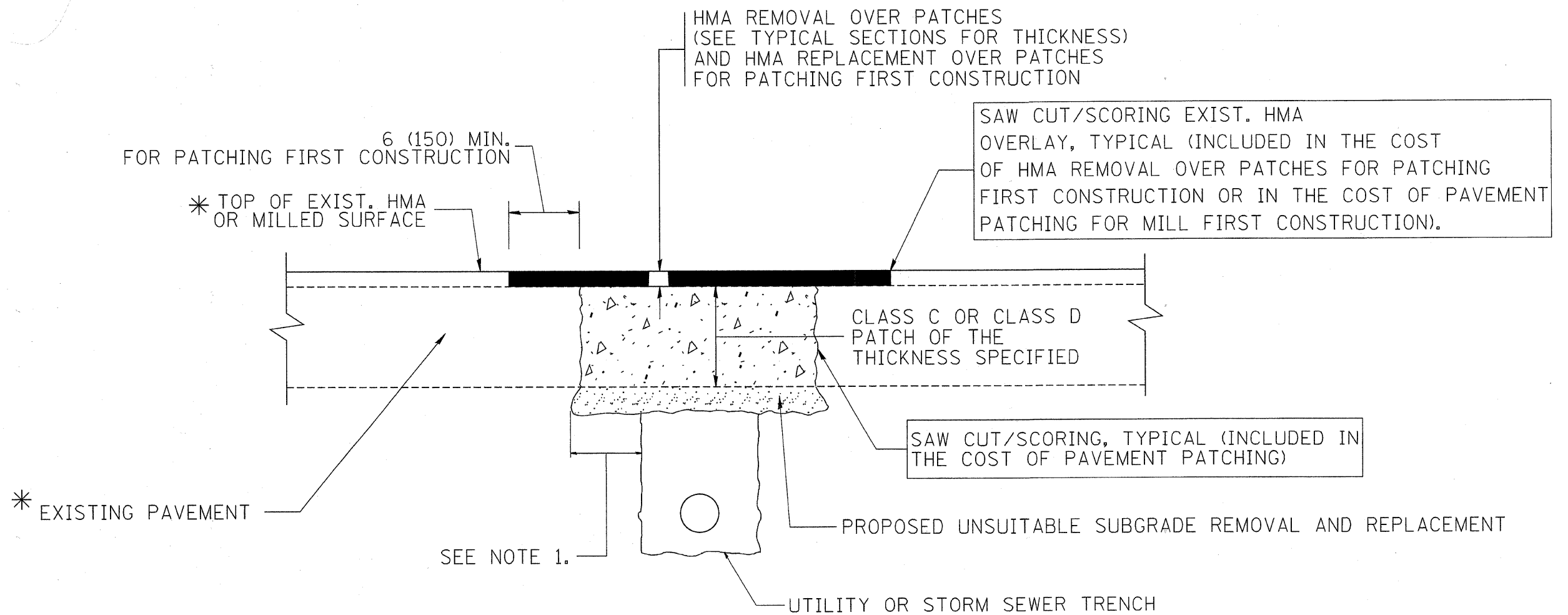

* SEE TYPICAL SECTIONS FOR THICKNESS AND MATERIALS

NOTES:

1. THE WIDTH OF THE FULL DEPTH PATCH OVER A TRENCH SHALL BE 12 (300) WIDER ON EACH SIDE OF THE TRENCH.
2. FOR METHOD OF MEASUREMENT AND BASIS OF PAYMENT, SEE RECURRING SPECIAL PROVISION "PATCHING WITH HOT-MIX ASPHALT OVERLAY REMOVAL".

SEQUENCE OF CONSTRUCTION (PATCHING FIRST)

1. REMOVE THE EXISTING HMA MATERIAL OVER THE AREA TO BE PATCHED.
2. REMOVE AND REPLACE WITH CLASS C OR D PATCH.
3. REPLACE HMA MATERIAL OVER THE AREA TO BE PATCHED.

SEQUENCE OF CONSTRUCTION (MILLING FIRST)

1. MILL HMA FIRST IF THERE IS AT LEAST 4 1/2 INCHES OR MORE OF HMA MATERIAL ON TOP OF THE EXISTING PAVEMENT OR IF THE PAVEMENT IS FULL DEPTH HMA. A MINIMUM OF 2 INCHES OF HMA MATERIAL SHALL BE IN PLACE AFTER MILLING.
2. REMOVE AND REPLACE WITH FULL DEPTH CLASS D PATCHES TO TOP OF MILLED SURFACE.

ALL DIMENSIONS ARE IN INCHES (MILLIMETERS) UNLESS OTHERWISE SHOWN.

FILE NAME = c:\projects\dststd22x34\bd22.dgn	USER NAME = bouerd1	DESIGNED - R. SHAH	REVISED - A. ABBAS 04-27-98	STATE OF ILLINOIS DEPARTMENT OF TRANSPORTATION	PAVEMENT PATCHING FOR HMA SURFACED PAVEMENT			F.A.D. RTE.	SECTION	COUNTY	TOTAL SHEETS	SHEET NO.
		DRAWN -	REVISED - R. BORO 01-01-07		1297	09-00173-00-RS	LAKE	18	12			
		CHECKED -	REVISED - R. BORO 09-04-07		BD400-04 (BD-22)			CONTRACT NO. 63361				
		DATE - 10-25-94	REVISED - K. ENG 10-27-08		SCALE: NONE	SHEET NO. 1 OF 1 SHEETS	STA. TO STA.	FED. ROAD DIST. NO. 1 ILLINOIS FED. AID PROJECT				

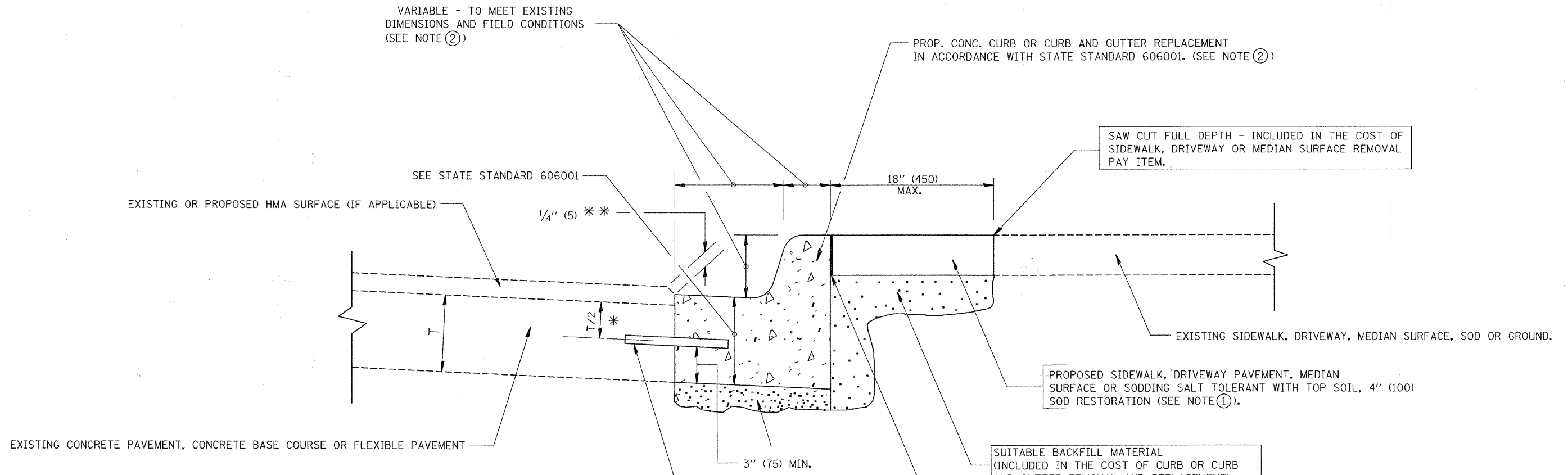

- * 3" (75) MINIMUM FROM TOP AND BOTTOM OF THE CONCRETE PAVEMENT OR BASE COURSE.
- * * IF THE FINAL SURFACE OF THE PAVEMENT IS CONCRETE, THE GUTTER IS TO BE FLUSH WITH THE PAVEMENT.

- NOTE: ① SIDEWALK, DRIVEWAY PAVEMENT OR MEDIAN SURFACE SHALL BE SIMILAR TO THE MATERIAL BEING REMOVED AND WILL BE PAID FOR SEPARATELY. SODDING, SALT TOLERANT AND TOP SOIL, FURNISH AND PLACE 4" WILL BE PAID FOR SEPARATELY.
- ② FERTILIZER FOR THE PLACEMENT OF THE SOD IS NOT REQUIRED
- ③ CURB OR CURB AND GUTTER REPLACEMENT SHALL MATCH THE SHAPE OF THE EXISTING CURB OR CURB AND GUTTER UNLESS OTHERWISE SPECIFIED.
- ④ FOR CURB OR CURB AND GUTTER REMOVAL AND REPLACEMENT ADJACENT TO FLEXIBLE PAVEMENT DELETE EPOXY COATED TIE BARS.
- ⑤ LONGITUDINAL BARS, IF ENCOUNTERED IN THE EXISTING CURB OR CURB AND GUTTER, ARE NOT TO BE REPLACED. CUTTING AND REMOVING LONGITUDINAL BARS SHALL BE INCLUDED IN THE COST OF CURB OR CURB AND GUTTER REMOVAL AND REPLACEMENT.
- ⑥ THE COST OF HMA SURFACE REMOVAL IN THE EXISTING GUTTER FLAG SHALL BE INCLUDED IN THE COST OF THE CURB AND GUTTER REMOVAL AND REPLACEMENT.
- ⑦ THE REMOVAL AND REPLACEMENT OF THE EXISTING CURB OR CURB AND GUTTER SHALL BE DONE IN ACCORDANCE WITH THE APPLICABLE PORTIONS OF SECTION 440 AND 606 OF THE STANDARD SPECIFICATIONS.
- ⑧ THE LOCATIONS OF REMOVAL AND REPLACEMENT OF EXISTING CURB OR CURB AND GUTTER SHALL BE DETERMINED BY THE RESIDENT ENGINEER AT THE TIME OF CONSTRUCTION.

UNSUITABLE SUB-BASE MATERIAL TO BE REMOVED, IF DIRECTED BY THE ENGINEER, SHALL BE REPLACED WITH EITHER SUB-BASE GRANULAR MATERIAL, TYPE B OR ADDITIONAL THICKNESS OF CONCRETE.

REMOVAL AND REPLACEMENT 4" (100) OR LESS IS INCLUDED IN THE COST OF CURB OR CURB AND GUTTER REMOVAL AND REPLACEMENT.

REMOVAL AND REPLACEMENT IN EXCESS OF 4" (100) WILL BE PAID FOR IN ACCORDANCE WITH ARTICLE 109.04 OF THE STANDARD SPECIFICATIONS.

PROPOSED #6 (20) EPOXY COATED TIE BARS 24" (600) LONG AT 24" (600) CENTERS WILL NOT BE PAID FOR SEPARATELY. DELETE EPOXY COATED TIE BARS IF EXISTING TIE BARS ARE USUABLE AS DETERMINED BY THE ENGINEER. (SEE NOTE ③).

BASIS OF PAYMENT:
THIS WORK WILL BE PAID FOR AT THE CONTRACT UNIT PRICE PER FOOT (METER) FOR "CURB REMOVAL AND REPLACEMENT" OR "COMBINATION CONCRETE CURB AND GUTTER REMOVAL AND REPLACEMENT".

CURB OR CURB AND GUTTER REMOVAL AND REPLACEMENT

ALL DIMENSIONS ARE IN INCHES (MILLIMETERS) UNLESS OTHERWISE SHOWN.

FILE NAME =	USER NAME = drvakosgn	DESIGNED - A. HOUSEH	REVISED - R. SHAH 10-03-96	STATE OF ILLINOIS DEPARTMENT OF TRANSPORTATION	CURB OR CURB AND GUTTER REMOVAL AND REPLACEMENT	F.A. RTE. 1297	SECTION 09-00173-00-RS	COUNTY COOK	TOTAL SHEETS 13	SHEET NO. 13	
es:\pw_work\pudot\drvakosgn\d8188315\bd24.dgn	DRAWN -	REVISOR - A. ABBAS 03-21-97	REVISOR - M. GOMEZ 01-22-01			SCALE: NONE	SHEET NO. 1 OF 1 SHEETS	STA. TO STA.	BD600-06 (BD-24)		CONTRACT NO. 63361
PLOT SCALE = 50.000' / IN.	CHECKED -	REVISOR - R. BORO 12-15-09						FED. ROAD DIST. NO. 1 ILLINOIS FED. AID PROJECT			
PLOT DATE = 12/15/2009	DATE - 03-11-94										

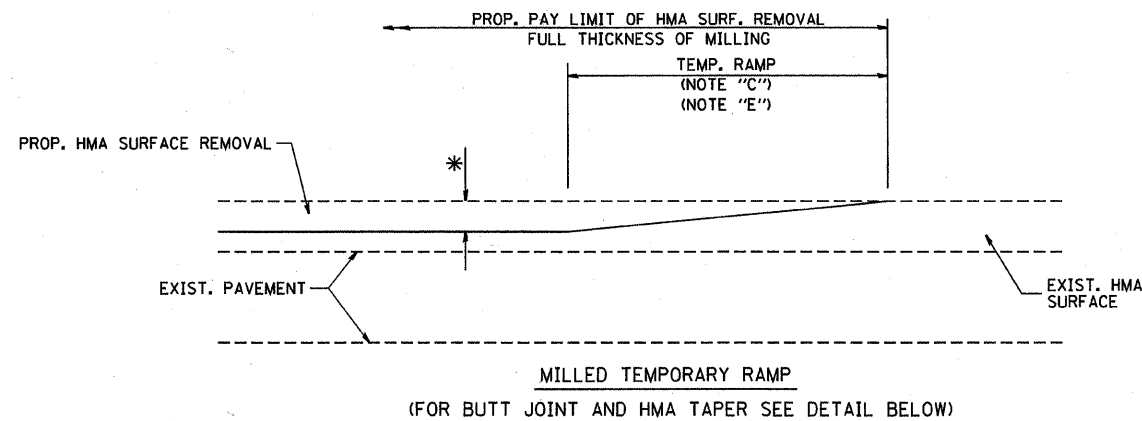

OPTION 1

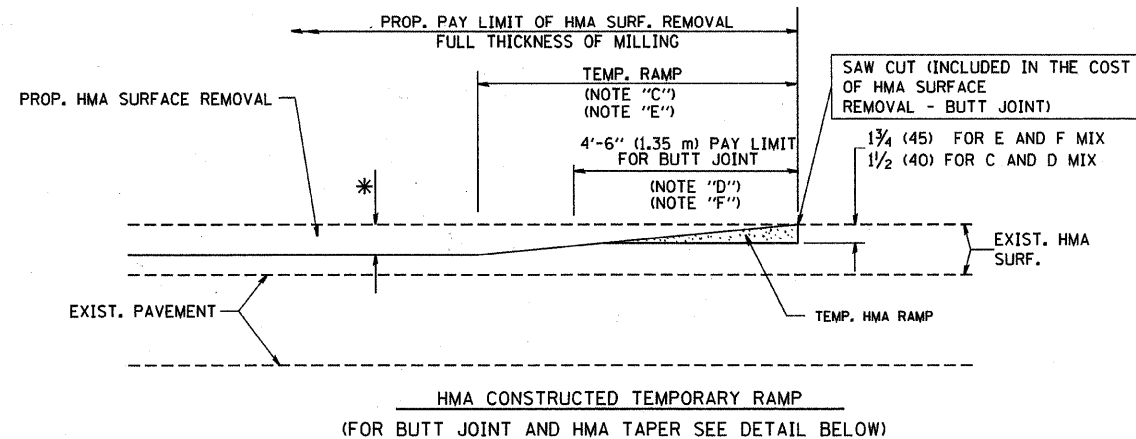

**OPTION 2
TYPICAL TEMPORARY RAMP**

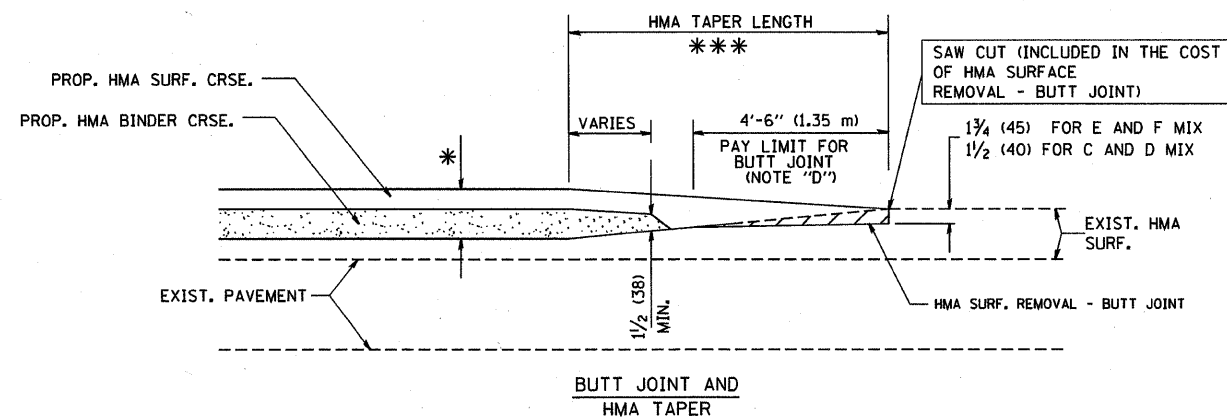

**TYPICAL BUTT JOINT AND HMA TAPER
FOR MILLING AND RESURFACING**

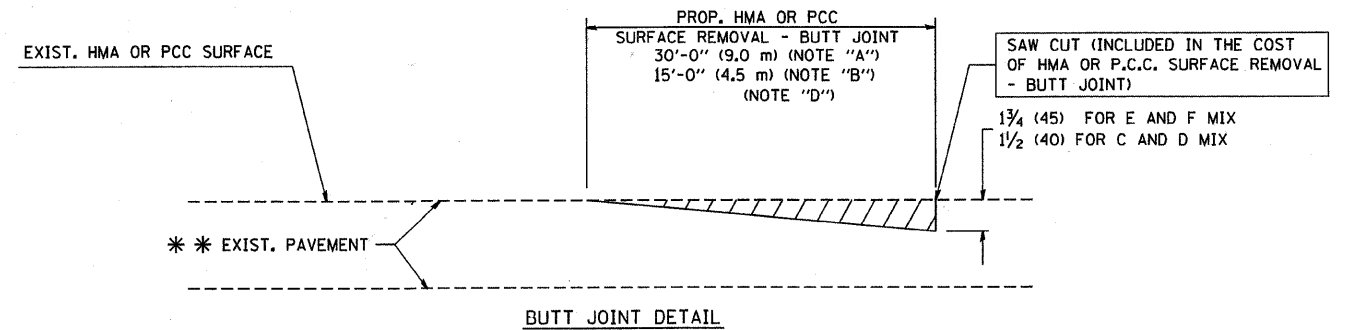

BUTT JOINT DETAIL

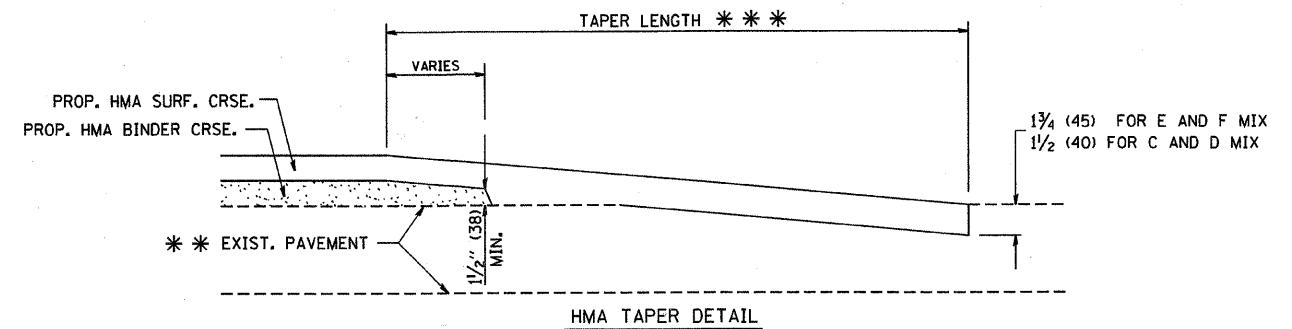

**TYPICAL BUTT JOINT AND HMA TAPER
FOR RESURFACING ONLY**

*** PC CONCRETE, HMA OR HMA RESURFACED PAVEMENT.

NOTES

- A: MAINLINE ROADWAYS AND MAJOR SIDE ROADS.
 - B: MINOR SIDE ROADS.
 - C: THE TEMP. RAMP SHALL BE CONSTRUCTED IMMEDIATELY UPON REMOVAL OF THE EXISTING HMA SURFACE.
 - D: THE BUTT JOINT SHALL BE CONSTRUCTED IMMEDIATELY PRIOR TO PLACING THE PROPOSED HMA COURSES.
 - E: TAPER THE TEMP. RAMP AT A RATE OF 3'-0" (900 mm) PER 1 INCH (25 mm) OF MILLING THICKNESS.
 - F: INSTALLATION AND REMOVAL OF THE 4'-6" (1.35 m) TEMP. RAMP IS INCLUDED IN COST OF HMA SURFACE REMOVAL - BUTT JOINT
 - G: SEE ARTICLE 406.08 AND 406.14 OF THE STANDARD SPECIFICATIONS FOR "HMA AND/OR PCC SURFACE REMOVAL, BUTT JOINT".
- * SEE TYPICAL SECTIONS FOR MILLING THICKNESS.
- *** 20'-0" (6.1 m) PER 1 (25) RESURFACING (NOTE "A")
10'-0" (3.0 m) PER 1 (25) RESURFACING (NOTE "B")

BASIS OF PAYMENT:

THE BUTT JOINT WILL BE PAID FOR AT THE CONTRACT UNIT PRICE PER SQUARE YARD (SQUARE METER) FOR "HOT-MIX ASPHALT SURFACE REMOVAL - BUTT JOINT" OR FOR "PORTLAND CEMENT CONCRETE SURFACE REMOVAL - BUTT JOINT".

ALL DIMENSIONS ARE IN INCHES (MILLIMETERS) UNLESS OTHERWISE SHOWN.

FILE NAME = W:\diststd\22x34\bd32.dgn	USER NAME = gegionobt	DESIGNED - M. DE YONG	REVISED - R. SHAH 10-25-94
		DRAWN -	REVISED - A. ABBAS 03-21-97
	PLOT SCALE = 50,0000 ' / IN.	CHECKED -	REVISED - M. GOMEZ 04-06-01
	PLOT DATE = 1/4/2008	DATE - 06-13-90	REVISED - R. BORO 01-01-07

**STATE OF ILLINOIS
DEPARTMENT OF TRANSPORTATION**

BUTT JOINT AND HMA TAPER DETAILS	
SCALE: NONE	SHEET NO. 1 OF 1 SHEETS STA. TO STA.

F.A.U. RTE.	SECTION	COUNTY	TOTAL SHEETS	SHEET NO.
1297	09-00173-00-RS	LAKE	18	14
BD400-05 BD32			CONTRACT NO. 63361	
FED. ROAD DIST. NO. 1 ILLINOIS FED. AID PROJECT				

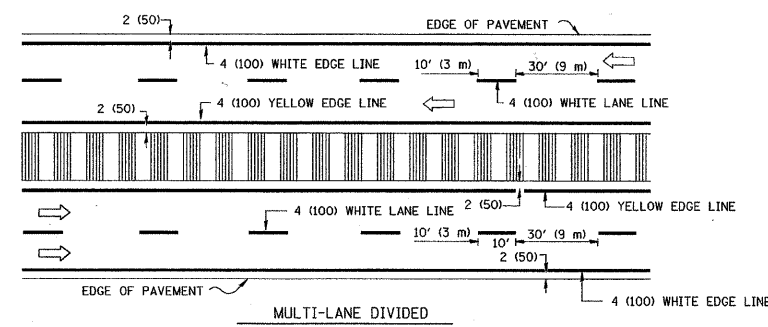
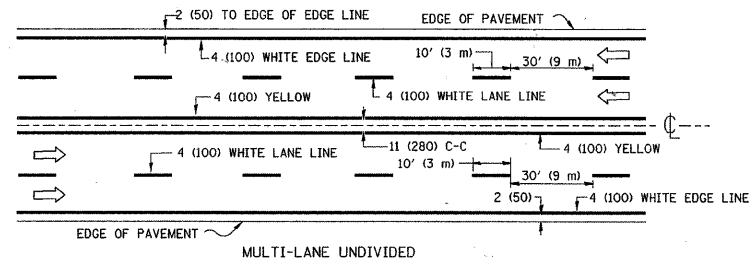
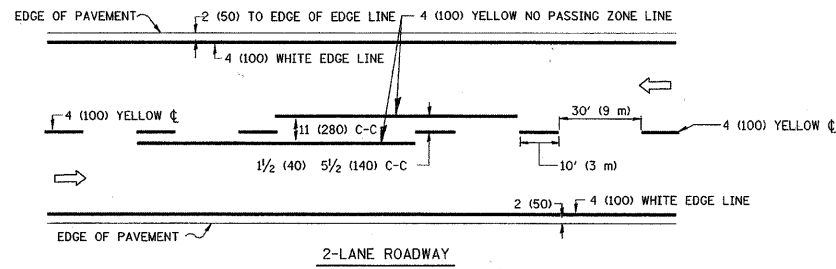

NOTE: MEDIANS WITH BARRIER CURB DO NOT REQUIRE AN EDGE LINE

TYPICAL LANE AND EDGE LINE MARKING

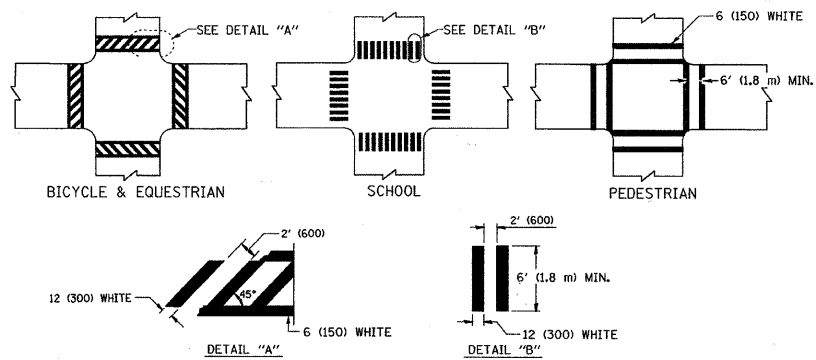

TYPICAL CROSSWALK MARKING

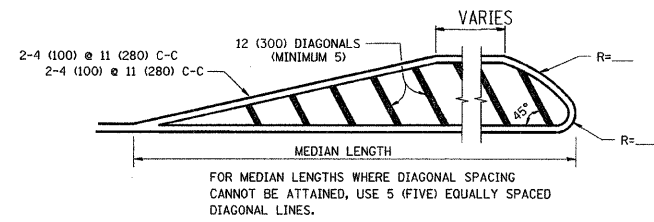
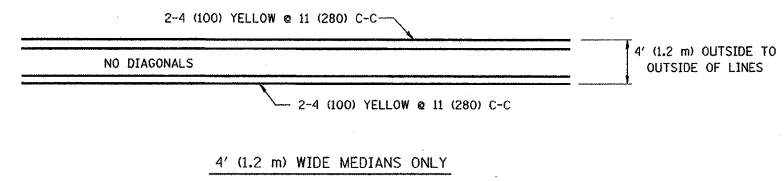

DIAGONAL LINE SPACING: 50' (15 m) C-C (LESS THAN 30MPH (50 km/h))
75' (25 m) C-C 30MPH (50 km/h) TO 45MPH (70 km/h)
150' (45 m) C-C (MORE THAN 45MPH (70 km/h))

MEDIANS OVER 4' (1.2 m) WIDE

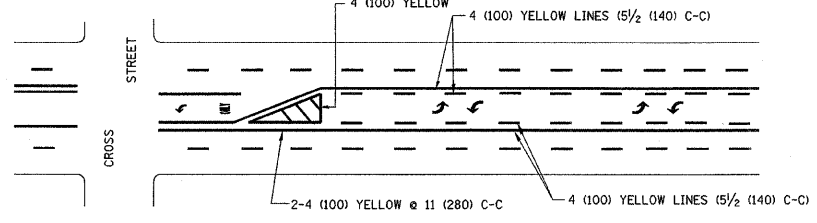

A MINIMUM OF TWO PAIRS OF TURN ARROWS SHALL BE USED, WHITE IN COLOR. ADDITIONAL PAIRS SHALL BE PLACED AT 200' (60 m) TO 300' (90 m) INTERVALS.

MEDIAN WITH TWO-WAY LEFT TURN LANE

TYPICAL PAINTED MEDIAN MARKING

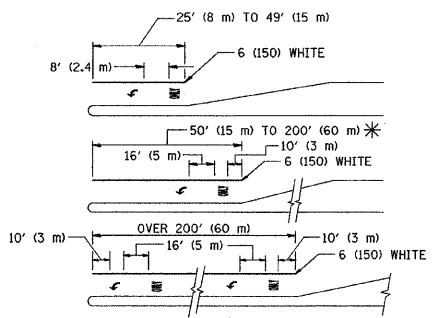

FULL SIZE LETTERS 8' (2.4 m) AND ARROWS SHALL BE USED.
AREA = 15.6 SQ. FT. (1.5 m²) ONLY AREA = 20.8 SQ. FT. (1.9 m²)
* TURN LANES IN EXCESS OF 400' (120 m) IN LENGTH MAY HAVE AN ADDITIONAL SET OF ARROW - "ONLY" INSTALLED MIDWAY BETWEEN THE OTHER TWO SETS OF ARROW - "ONLY".

TYPICAL LEFT (OR RIGHT) TURN LANE

TYPICAL TURN LANE MARKING

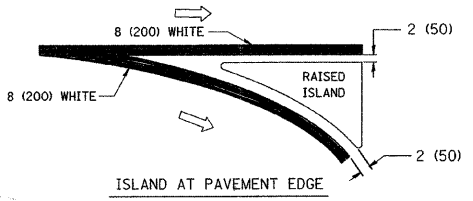
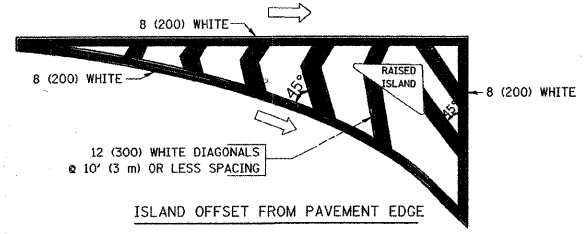

TYPICAL ISLAND MARKING

TYPE OF MARKING	WIDTH OF LINE	PATTERN	COLOR	SPACING / REMARKS
CENTERLINE ON 2 LANE PAVEMENT	4 (100)	SKIP-DASH	YELLOW	10' (3 m) LINE WITH 30' (9 m) SPACE
CENTERLINE ON MULTI-LANE UNDIVIDED PAVEMENT	2 @ 4 (100)	SOLID	YELLOW	11 (280) C-C
NO PASSING ZONE LINES: FOR ONE DIRECTION	4 (100)	SOLID	YELLOW	5 1/2' (140) C-C FROM SKIP-DASH CENTERLINE
FOR BOTH DIRECTIONS	2 @ 4 (100)	SOLID	YELLOW	11 (280) C-C OMIT SKIP-DASH CENTERLINE BETWEEN
LANE LINES	4 (100) 5 (125) ON FREEWAYS	SKIP-DASH SKIP-DASH	WHITE WHITE	10' (3 m) LINE WITH 30' (9 m) SPACE
DOTTED LINES (EXTENSIONS OF CENTER, LANE OR TURN LANE MARKINGS)	SAME AS LINE BEING EXTENDED	SKIP-DASH	SAME AS LINE BEING EXTENDED	2' (600) LINE WITH 6' (1.8 m) SPACE
EDGE LINES	4 (100)	SOLID	YELLOW-LEFT WHITE-RIGHT	OUTLINE MOUNTABLE MEDIANS IN YELLOW; EDGE LINES ARE NOT USED NEXT TO BARRIER CURB
TURN LANE MARKINGS	6 (150) LINE; FULL SIZE LETTERS & SYMBOLS (8' (2.4m))	SOLID	WHITE	SEE TYPICAL TURN LANE MARKING DETAIL
TWO WAY LEFT TURN MARKING	2 @ 4 (100) EACH DIRECTION	SKIP-DASH AND SOLID	YELLOW	10' (3 m) LINE WITH 30' (9 m) SPACE FOR SKIP-DASH 5 1/2' (140) C-C BETWEEN SOLID LINE AND SKIP-DASH LINE
	8' (2.4m) LEFT ARROW	IN PAIRS	WHITE	SEE TYPICAL TWO-WAY LEFT TURN MARKING DETAIL
CROSSWALK LINES (PEDESTRIAN) A. DIAGONALS (BIKE & EQUESTRIAN) B. LONGITUDINAL BARS (SCHOOL)	2 @ 6 (150) 12 (300) @ 45° 12 (300) @ 90°	SOLID SOLID SOLID	WHITE WHITE WHITE	NOT LESS THAN 6' (1.8 m) APART 2' (600) APART SEE TYPICAL CROSSWALK MARKING DETAILS.
STOP LINES	24 (600)	SOLID	WHITE	PLACE 4' (1.2 m) IN ADVANCE OF AND PARALLEL TO CROSSWALK, IF PRESENT. OTHERWISE, PLACE AT DESIRED STOPPING POINT, PARALLEL TO CROSSROAD CENTERLINE, WHERE POSSIBLE
PAINTED MEDIANS	2 @ 4 (100) WITH 12 (300) DIAGONALS @ 45° NO DIAGONALS USED FOR 4' (1.2 m) WIDE MEDIANS	SOLID	YELLOW; TWO WAY TRAFFIC WHITE; ONE WAY TRAFFIC	11 (280) C-C FOR THE DOUBLE LINE SEE TYPICAL PAINTED MEDIAN MARKING.
GORE MARKING AND CHANNELIZING LINES	8 (200) WITH 12 (300) DIAGONALS @ 45°	SOLID	WHITE	DIAGONALS: 15' (4.5 m) C-C (LESS THAN 30MPH (50 km/h)) 20' (6 m) C-C 30MPH (50 km/h) TO 45MPH (70 km/h) 30' (9 m) C-C (OVER 45MPH (70 km/h))
RAILROAD CROSSING	24 (600) TRANSVERSE LINES; "RR" IS 6' (1.8 m) LETTERS; 16 (400) LINE FOR "X"	SOLID	WHITE	SEE STATE STANDARD 780001 AREA OF: "R"=3.6 SQ. FT. (0.33 m ²) EACH "X"=54.0 SQ. FT. (5.0 m ²)
SHOULDER DIAGONALS	12 (300) @ 45°	SOLID	WHITE - RIGHT YELLOW - LEFT	50' (15 m) C-C (LESS THAN 30MPH (50 km/h)) 75' (25 m) C-C (30 MPH (50 km/h) TO 45MPH (70 km/h)) 150' (45 m) C-C (OVER 45MPH (70 km/h))

FOR FURTHER DETAILS ON PAVEMENT MARKING REFER TO STANDARD SPECIFICATIONS FOR ROAD AND BRIDGE CONSTRUCTION AND STATE STANDARD 780001.

All dimensions are in inches (millimeters) unless otherwise shown.

FILE NAME =	USER NAME = drivakosgn	DESIGNED - EVERS	REVISED - T. RAMMACHER 10-27-94
or\pwwork\pwwid\drivakosgn\d0108315\to3.dgn		DRAWN -	REVISED - C. JUCIUS 09-09-09
	PLOT SCALE = 50,000' / IN.	CHECKED -	REVISED -
	PLOT DATE = 9/9/2009	DATE - 03-19-90	REVISED -

STATE OF ILLINOIS
DEPARTMENT OF TRANSPORTATION

DISTRICT ONE		F.A. R.T.E.	SECTION	COUNTY	TOTAL SHEETS	SHEET NO.
TYPICAL PAVEMENT MARKINGS		1297	09-00173-00-25	COOK	18	15
SCALE: NONE	SHEET NO. 1 OF 1 SHEETS	STA.	TO STA.	CONTRACT NO. 63361		

F.A. R.T.E.	SECTION	COUNTY	TOTAL SHEETS	SHEET NO.
1297	09-00173-00-25	COOK	18	15
CONTRACT NO. 63361				

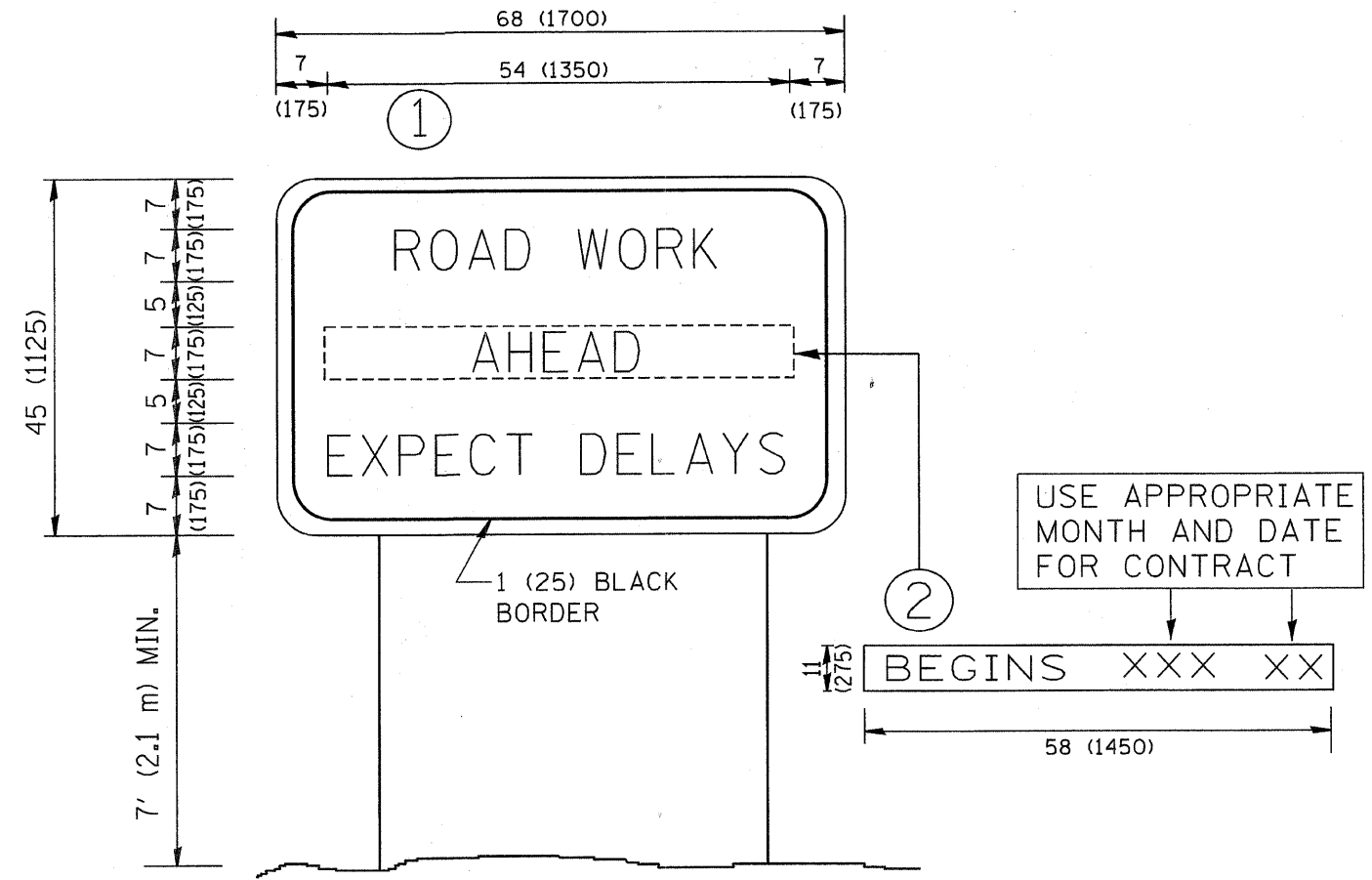

NOTES:

1. USE BLACK LETTERING ON ORANGE BACKGROUND.
2. ERECT SIGNS IN ADVANCE OF THE LOCATION FOR THE "ROAD CONSTRUCTION AHEAD" SIGN AT LOCATIONS AS DIRECTED BY THE ENGINEER.
3. ERECT SIGN ① WITH INSTALLED PANEL ② ONE WEEK PRIOR TO THE START OF CONSTRUCTION.
4. REMOVE PANEL ② SOON AFTER THE START OF CONSTRUCTION.
5. SEE SPECIAL PROVISION FOR "TEMPORARY INFORMATION SIGNING" FOR ADDITIONAL INFORMATION.
6. ONE SIGN ASSEMBLY EQUALS 25.70 SQ. FT. (2.3 SQ. M.)
7. SHALL BE PAID FOR AS TEMPORARY INFORMATION SIGNING.

ALL DIMENSIONS ARE IN INCHES (MILLIMETERS) UNLESS OTHERWISE SHOWN.

FILE NAME = W:\diststd\22x34\to22.dgn	USER NAME = gegl1mobt	DESIGNED -	REVISED - R. MIRS 09-15-97	STATE OF ILLINOIS DEPARTMENT OF TRANSPORTATION	ARTERIAL ROAD INFORMATION SIGN			F.A.U. RTE. 1297	SECTION 09-00173-00-RS	COUNTY LAKE	TOTAL SHEETS 18	SHEET NO. 16
	PLOT SCALE = 50.000' / IN.	DRAWN -	REVISED - R. MIRS 12-11-97		SCALE: NONE	SHEET NO. 1 OF 1 SHEETS	STA.	TO STA.	TC-22		CONTRACT NO. 63361	
	PLOT DATE = 1/4/2008	CHECKED -	REVISED - T. RAMMACHER 02-02-99		FED. ROAD DIST. NO. 1 [ILLINOIS] FED. AID PROJECT							
		DATE -	REVISED - C. JUCIUS 01-31-07									

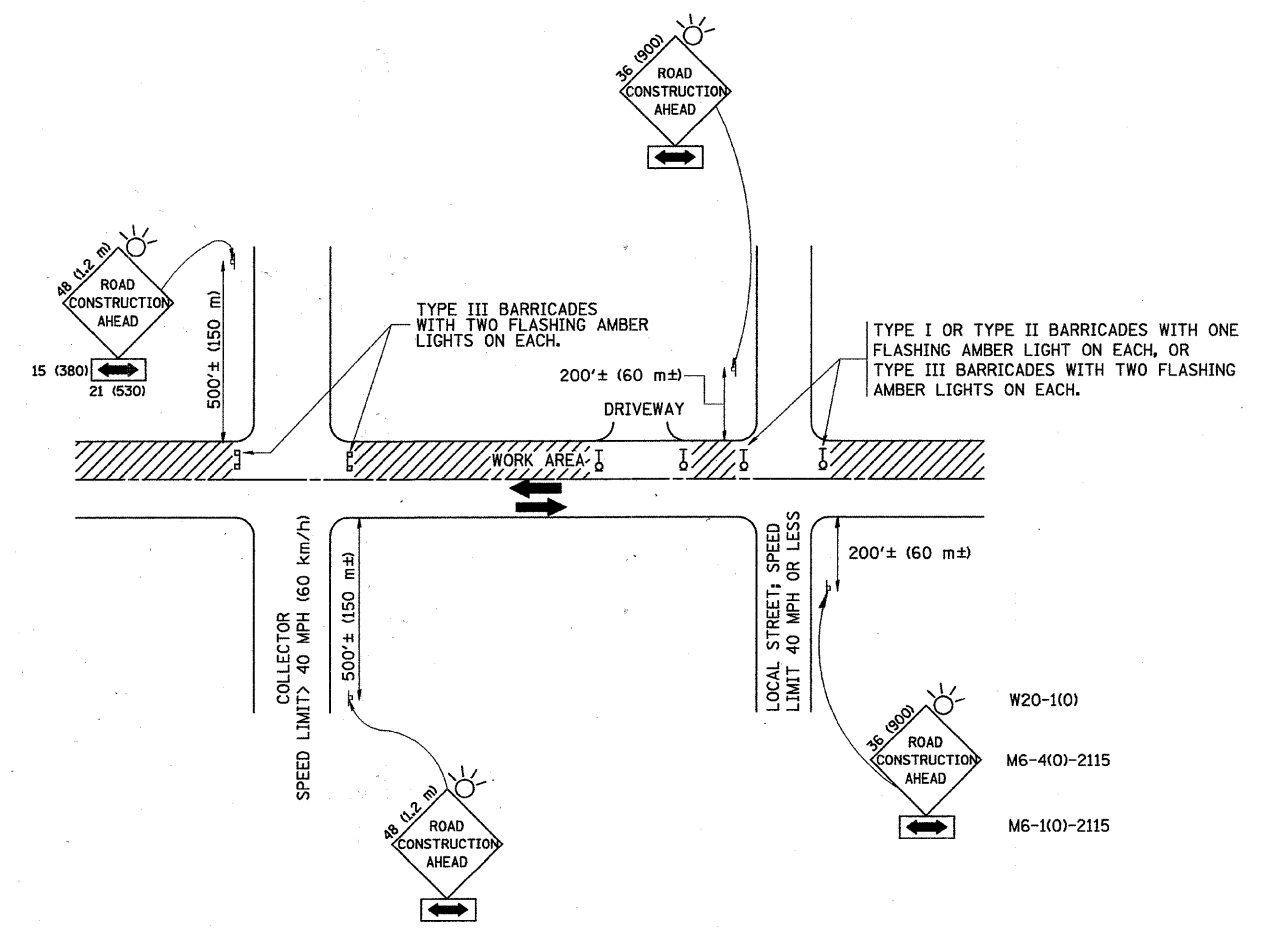

TRAFFIC CONTROL AND PROTECTION FOR SIDE ROADS, INTERSECTIONS, AND DRIVEWAYS

NOTES:

- A. FOR NO LANE RESTRICTION ON THE SIDE ROAD OR DRIVEWAYS
- SIDE ROAD WITH A SPEED LIMIT OF 40 MPH (60 km/h) OR LESS AS SHOWN ON THE DRAWING AND AS DIRECTED BY THE ENGINEER:
 - ONE ROAD CONSTRUCTION AHEAD SIGN 36 x 36 (900x900) WITH A FLASHER AND FLAG MOUNTED ON IT APPROXIMATELY 200' (60 m) IN ADVANCE OF THE MAIN ROUTE.
 - THE CLOSED PORTION OF THE MAIN ROUTE SHALL BE PROTECTED BY BLOCKING WITH TYPE I, TYPE II OR TYPE III BARRICADES, 1/3 OF THE CROSS SECTION OF THE CLOSED PORTION.
 - SIDE ROAD WITH A SPEED LIMIT GREATER THAN 40 MPH (60 km/h) AS SHOWN ON THE DRAWING AND AS DIRECTED BY THE ENGINEER:
 - ONE ROAD CONSTRUCTION AHEAD SIGN 48 x 48 (1.2 m x 1.2 m) WITH A FLASHER MOUNTED ON IT APPROXIMATELY 500' (150 m) IN ADVANCE OF THE MAIN ROUTE.
 - THE CLOSED PORTION OF THE MAIN ROUTE SHALL BE PROTECTED BY BLOCKING WITH TYPE III BARRICADES, 1/2 OF THE CROSS SECTION OF THE CLOSED PORTION.
3. WHEN THE SIDE ROAD LIES BETWEEN THE BEGINNING OF THE MAINLINE SIGNING AND THE WORK ZONE, A SINGLE HEADED ARROW (M6-1) SHALL BE USED IN LIEU OF THE DOUBLE HEADED ARROW (M6-4).
- B. FOR A LANE CLOSURE ON A SIDE ROAD OR DRIVEWAY:
- USE APPLICABLE PORTIONS OF THE TYPICAL APPLICATION OF TRAFFIC CONTROL DEVICES (STD. 701501, STD. 701606 OR THE APPROPRIATE STANDARD). THE SPACING OF SIGNS AND BARRICADES SHALL BE ADJUSTED FOR FIELD CONDITIONS AS DIRECTED BY THE ENGINEER. THE DIRECTIONAL ARROW SHALL BE COVERED OR REMOVED WHEN NO LONGER CONSISTENT WITH THE SIDE ROAD LANE CLOSURE.
- C. ADVANCE WARNING SIGNS ARE TO BE OMITTED ON DRIVEWAY UNLESS OTHERWISE NOTED.
- D. THE TRAFFIC CONTROL AND PROTECTION FOR SIDE ROADS, INTERSECTIONS, AND DRIVEWAYS SHALL BE INCIDENTAL TO THE COST OF SPECIFIED TRAFFIC CONTROL STANDARDS OR ITEMS.

All dimensions are in millimeters (inches) unless otherwise shown.

FILE NAME = W:\dststd\22x34\to18.dgn	USER NAME = gaglianobt	DESIGNED - LHA	REVISED - J. OBERLE 10-18-95
		DRAWN -	REVISED - A. HOUSEH 03-06-96
	PLOT SCALE = 50.000 / / IN.	CHECKED -	REVISED - A. HOUSEH 10-15-96
	PLOT DATE = 1/4/2008	DATE - 06-89	REVISED - T. RAMMACHER 01-06-00

STATE OF ILLINOIS
DEPARTMENT OF TRANSPORTATION

TRAFFIC CONTROL AND PROTECTION FOR
SIDE ROADS, INTERSECTIONS, AND DRIVEWAYS

SCALE: NONE SHEET NO. 1 OF 1 SHEETS STA. TO STA.

F.A. RTE.	SECTION	COUNTY	TOTAL SHEETS	SHEET NO.
197	09-0113-00-25	COOK	10	10
TC-10			CONTRACT NO. 6261	
FED. ROAD DIST. NO. 1 ILLINOIS FED. AID PROJECT				