

F.A.P. RTE.	SECTION	COUNTY	TOTAL SHEETS	SHEET NO.
537	10-00002-00-BS	KANE	13	7
CONTRACT NO. 63474				

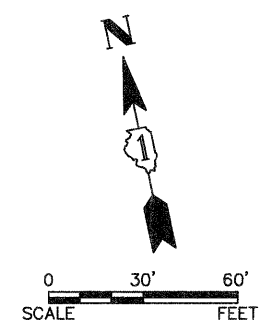

LEGEND

	HOT-MIX ASPHALT OVERLAY
	CLASS D PATCHES
	HOT-MIX ASPHALT SURFACE REMOVAL - BUTT JOINT
	HOT-MIX ASPHALT DRIVEWAY PAVEMENT, 5"
	AGGREGATE WEDGE SHOULDER, TYPE "B"
	EXISTING GRAVEL DRIVEWAY
	ADDRESSES

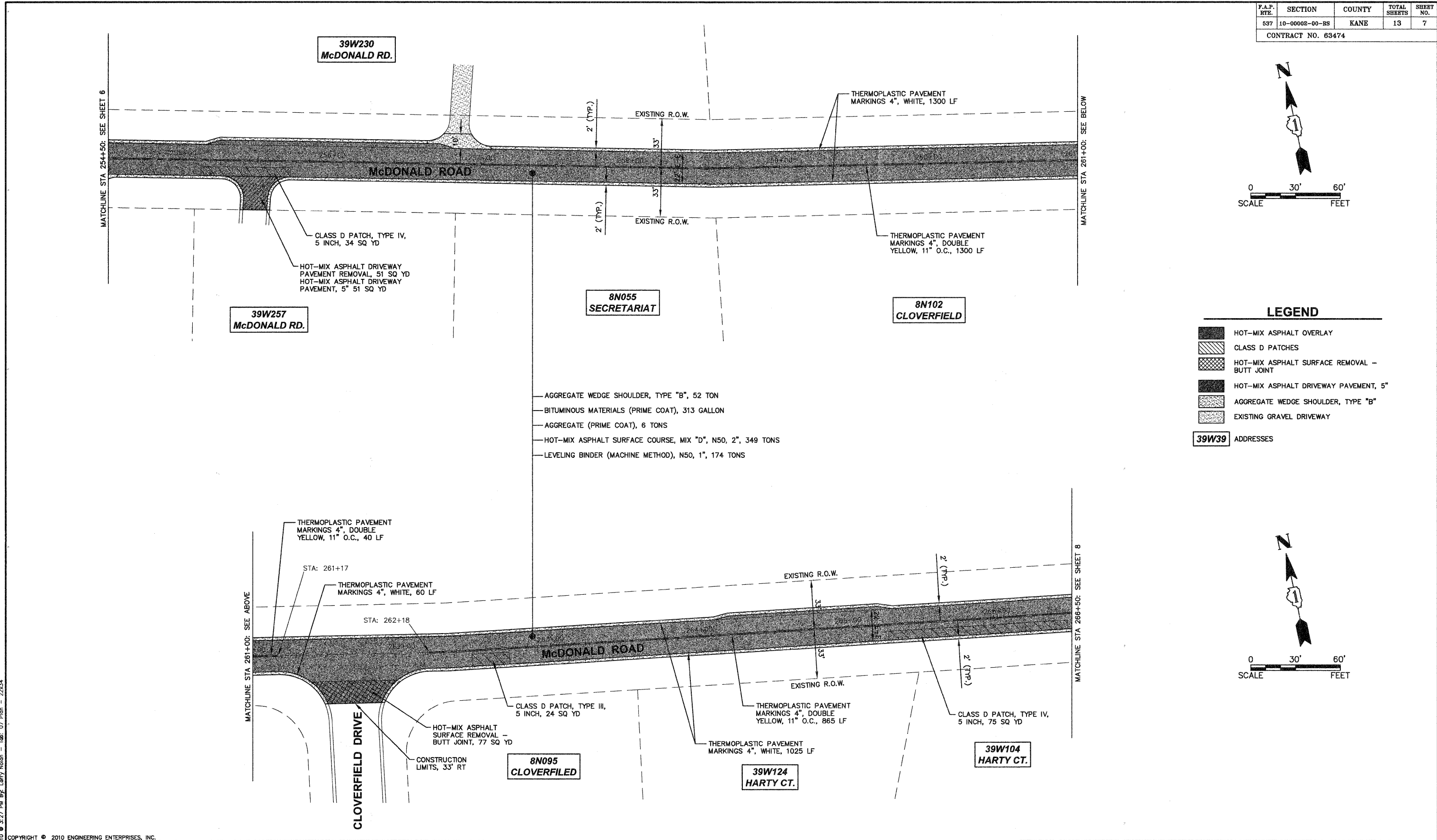
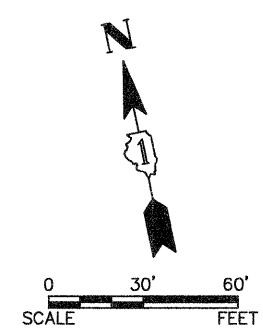

Engineering Enterprises, Inc.
 CONSULTING ENGINEERS
 52 Wheeler Road
 Sugar Grove, Illinois 60554
 630.466.6700 / www.eelweb.com

VILLAGE OF CAMPTON HILLS

NO.	DATE	REVISIONS

McDONALD ROAD
 LAPP IMPROVEMENTS

PLAN, CONSTRUCTION
 NOTES, AND DETAILS

DATE:	MARCH 2010
PROJECT NO:	CH0903
FILE:	CH0903-PLAN
SHEET	7 OF 13

Plotted: April 6, 2010 3:27 PM By: Larry Nolan - Tab: 07 Plan - 22x34
 COPYRIGHT © 2010 ENGINEERING ENTERPRISES, INC.

Path: H:\SISKIPROJ\CH0903\DWG\DWG_FINAL_ENG\CH0903-PLAN